



**WARNING**



BE SURE TO USE SAFETY GLASSES AND GLOVES AT ALL TIMES WHEN INSTALLING THIS PRODUCT.

12V Wireless Switch

PART #: 78391S

INSTALLATION INSTRUCTIONS

12V Wireless Switch is a wiring harness designed to connect any automotive accessory that functions on 12V DC to a power source (typically the vehicle battery). The relay and wiring have a distinct maximum amperage noted below and on the relay.

If you are not confident in your ability to install the 12V Wireless Switch, please consult a licensed mechanic.

WARNING: FAILURE TO FOLLOW THESE INSTRUCTIONS WHEN INSTALLING THE 12V WIRELESS SWITCH MAY CAUSE ELECTRIC PROBLEMS IN YOUR VEHICLE WHICH COULD CAUSE VEHICLE DAMAGE, ELECTRICAL SYSTEM DAMAGE, FIRE, ELECTRICAL SHOCK, PERSONAL INJURY OR DEATH.

INSTALLATION GUIDELINE

The relay and wiring has specific voltage and amperage ratings for power input. DO NOT EXCEED THESE RATINGS. The kit must be installed in a properly functioning vehicle electrical system. It is the user's responsibility to connect functional and compatible 12V accessories using this kit. The intended use of this kit is to connect power to 12V DC automotive accessories within the amperage ratings provided. These ratings must be followed. Do not connect a malfunctioning 12V accessory using the kit.

Before permanently mounting light to vehicle, test fit to ensure optimal beam pattern, height, and width and that wiring is long enough to be safely installed and does not obstruct any operating functions of the vehicle. These lights should not be installed whereby the operation hinders the visibility of the driver or other drivers.

INSTALLATION STEPS

- 1) Test fit to ensure adequate wire length, proper aiming of light output, and correct location before connecting to light and battery.
- 2) Connect the RED 12V + from the lights to the RED 12V + wire as shown in the diagram using the provided crimp connector.
- 3) Connect the BLACK ground wire from the lights to the BLACK wire of the harness as shown in the diagram using the provided crimp connector.
- 4) Ensure all wire connections are secure and safe - take care to seal connections to prevent damage from the elements and to prevent contact with any other wires or surfaces.
- 5) Prepare your car for installation by disconnecting the battery. Follow the procedure in your owner's manual and always disconnect the ground (BLACK or '-') terminal first, followed by the positive (RED or '+') wire. Reconnect in reverse order.
- 6) Run the switch harness wiring into the cabin through a grommet of the hole in the engine bay, unplug the connection if needed.
- 7) Reconnect your batteries Positive (RED or '+') along with the RED 12V+ Ring terminal from the harness. Make sure the terminal connections are secure and clean.
- 8) Power on your vehicle to test and align the lighting units.

FIGURE 1. FULL WIRING DIAGRAM

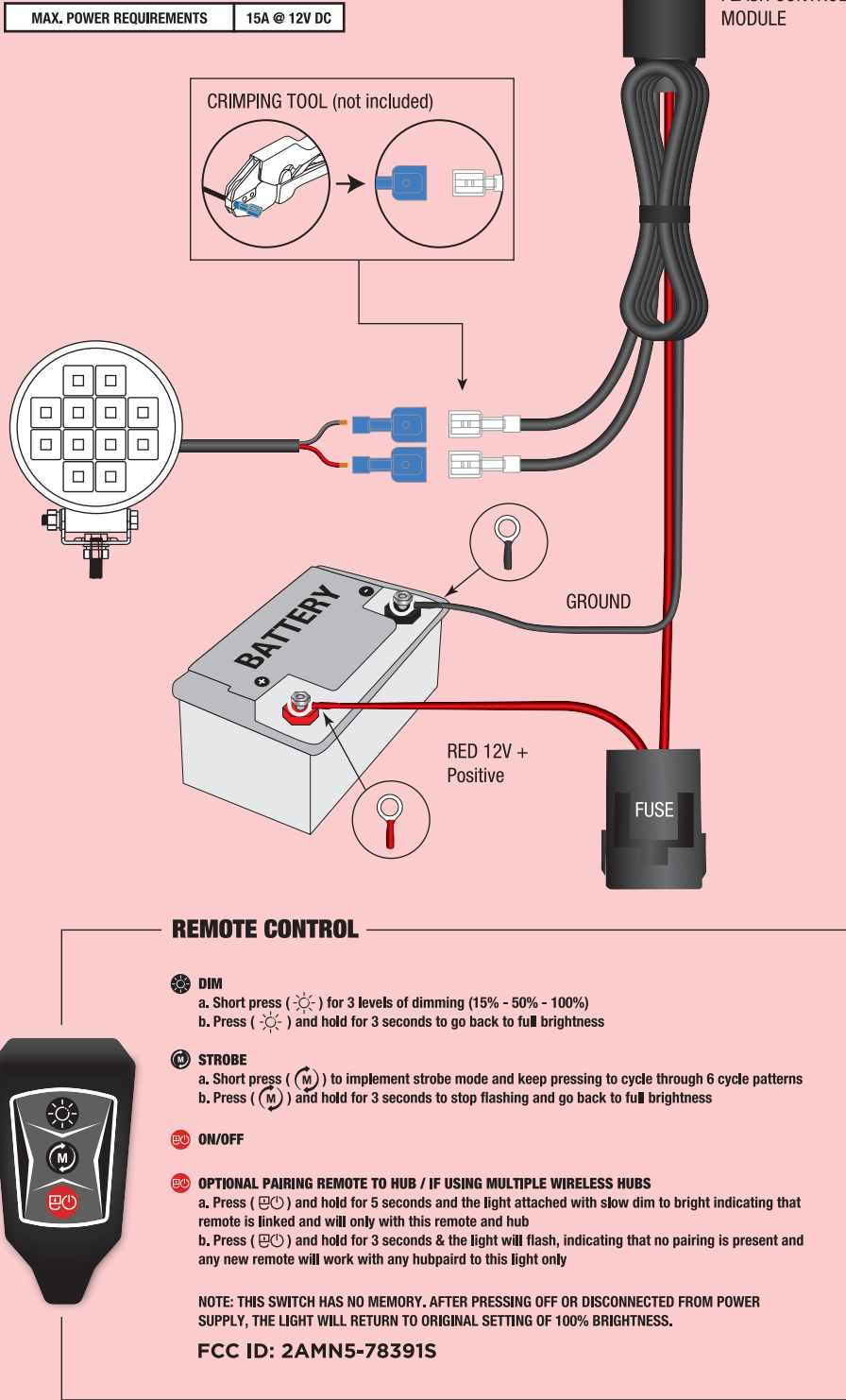

Federal Communications Commission (FCC) Interference Statement

This equipment has been tested and found to comply with the limits for a Class B digital device, pursuant to Part 15 of the FCC Rules.

These limits are designed to provide reasonable protection against harmful interference in a residential installation. This equipment generates, uses and can radiate radio frequency energy and, if not installed and used in accordance with the instructions, may cause harmful interference to radio communications.

There is no guarantee that interference will not occur in a particular installation. If this equipment does cause harmful interference to radio or television reception, which can be determined by turning the equipment off and on, the user is encouraged to try to correct the interference by one of the following measures:

- Reorient or relocate the receiving antenna.
- Increase the separation between the equipment and receiver.
- Connect the equipment into an outlet on a circuit different from that to which the receiver is connected.
- Consult the dealer or an experienced radio/TV technician for help.

This device complies with Part 15 of the FCC Rules. Operation is subject to the following two conditions: (1) This device may not cause harmful interference, and (2) this device must accept any interference received, including interference that may cause undesired operation.

FCC Caution: Any changes or modifications not expressly approved by the party responsible for compliance could void the user's authority to operate this equipment.

RF exposure warning

This equipment complies with FCC radiation exposure limits set forth for an uncontrolled environment. The equipment must not be co-located or operating in conjunction with any other antenna or transmitter.

ALPENA® LIMITED WARRANTY

This Limited Warranty covers defects in materials or workmanship of this product for one (1) year from the date of purchase. Normal wear and tear over time are not product defects. Product problems caused by not following the product instructions, abuse, misuse, alteration, accident and/or use beyond the product's intended purpose are not covered. This warranty is valid for the original owner and is not transferable. Proof of purchase is required.

Any implied warranties and conditions, such as merchantability and fitness for a particular purpose are hereby excluded, or if not excludable under law, are limited to one (1) year period. Some jurisdictions do not allow limitations on how long an implied warranty lasts, so this limitation may not apply to you

NO INCIDENTAL, CONSEQUENTIAL OR SPECIAL DAMAGES ARE RECOVERABLE. SOME JURISDICTIONS DO NOT ALLOW THE EXCLUSION OF INCIDENTAL, CONSEQUENTIAL OR SPECIAL DAMAGES, SO THE ABOVE LIMITATION OR EXCLUSION MAY NOT APPLY TO YOU. THIS WARRANTY GIVES YOU SPECIFIC LEGAL RIGHTS AND YOU MAY HAVE OTHER RIGHTS WHICH VARY DEPENDING ON THE JURISDICTION.

We will replace any product we determine to be defective provided you follow our product return directions. Please note that replacement product may not be exact due to style changes to our products. We will cover the mailing expense to send you a replacement product. However, mailing costs to return to us the original product which is claimed to be defective must be paid by you. If a replacement product is not available at the time you submit your warranty request, we will issue a credit.

For warranty service, please see below.

WE CAN HELP
Installation support available



@AlpenaAutomotive
#AlpenaAutomotive
1-800-387-3217