

# Instruction Manual

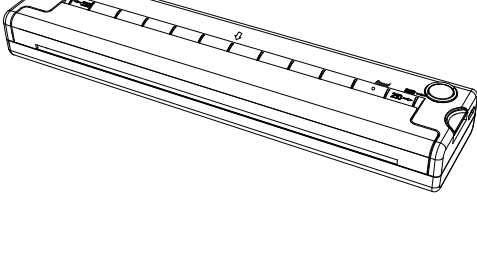

## APP Download



ios



Android

## Driver Download



<https://www.luckjingle.com/driverDetail?id=7>

## Product Information

Product model:	A46PRO
Product weight:	516g
Product size:	266mm*59mm*31mm
Print type:	Thermal print
Input voltage:	5V $\equiv$ 2A
Battery capacity:	2600mAh(7.4V)
Automatic shut-down:	30min
Standby time:	About 30 days
Charging time:	About 3 hours
Continuous printing:	90 sheets of tattoo printing paper
Paper width specifications:	210mm or 216mm
Charging port:	USB-C

EN

## Product introduction

Power button Long press for 3 seconds to turn on/off



## App download

### Mobile Download

Search“Luck Jingle” in the App Store

Download on the  
**App Store**

Get it on  
**Google Play**



ios



Android

## Setting the paper for printing tattoos

Pull out the interlayer paper in the middle of the tattoo printing paper then tear off the yellow paper, put the white front side neatly into the printer input port, and the printing paper will be sucked in automatically.



## Connect application

After the device is switched on, open the APP, click the button in the upper right corner, enter the ‘Add Device’ list, click the device you want to connect to Bluetooth, and then you can print.

★Tips: When connecting, please make sure that the Bluetooth of the mobilephone is turned on, and the device is close to the mobile phone

## Safety and precautions

- 1 Do not charge or use the printer in high temperature, humid or dusty places.
- 2 Please use 5V2A input to charge, you can use mobile phone power adapter to charge.
- 3 After printing, do not touch the print head directly to prevent overheating and scalding.
- 4 Please insert or pull out the charging cable gently to avoid damage to the interfacel due to excessive force.
- 5 Improper charging may cause print head damage.
- 6 Unplug the charging cable in time after charging is completed.
- 7 Place the machine on a firm and stable level to prevent the machine from slipping and being damaged.
- 8 When not using the machine for a long time. please turn off the power of the machine.
- 9 Prevent foreign matter from entering the machine, so as not to cause malfunction or other risks.

## FCC Statement

1.This device complies with Part 15 of the FCC Rules. Operation is subject to the following two conditions:  
(1)This device may not cause harmful interference.  
(2)This device must accept any interference received, including interference that may cause undesired operation  
2. Changes or modifications not expressly approved by the party responsible for compliance could void the user's authority to operate the equipment. Note: This equipment has been tested and found to comply with the limits for a class B digital device, pursuant to Part 15 of the FCC Rules. These limits are designed to provide reasonable protection against harmful interference in a residential installation. This equipment generates uses and can radiate radio frequency energy and, if not installed and used in accordance with the instructions, may cause interference to radio communications. However, there is no guarantee that interference will not occur in a particular installation if this equipment does cause harmful interference to radio or television reception, which can be determined by turning the equipment off and on, the user is encouraged to try to correct the interference by one or more of the following measures.  
· Reorient or relocate the receiving antenna.  
· Increase the separation between the equipment and receiver.  
· Connect the equipment into an outlet on a circuit different from that to which the receiver is connected.  
· Consult the dealer or an experienced radio/TV technician for help.  
The device has been evaluated to meet general RF exposure requirement  
The device can be used in portable exposure condition without restriction.

## Tattoo Paper Operating Procedure

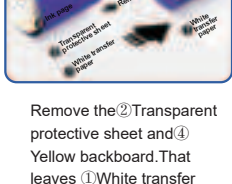

Remove the ② Transparent protective sheet and ④ Yellow backboard. That leaves ① White transfer paper and ③ Ink page



Open the printer, Insert the ① White transfer paper and ③ Ink page, with the White transfer paper facing up

Note: Tattoo printer in the absence of paper, the indicator light will blink, this is a normal phenomenon. The quality of the transfer paper will affect the printing effect (the quality of the transfer paper is determined by the uniformity of the ink sheet)

## Large multi-copy printing clipping function



Select image crop vertical plus 1, cross plus 1, you can print 4 pieces of Mosaic pattern

