

Safety Tips

- *Do not touch or look directly at the laser head with your hands to avoid damaging the equipment and damaging vision.*Do not expose to direct sunlight or install or use near hot objects such as heat sinks.
- *Stay away from environments such as bathrooms and swimming pools. Do not use in environments with water or moisture.
- *For the sake of environmental protection and safety, if not used for a long time, put back the CD circular cardboard to protect the laser head, Please unplug the power adapter.*The adapter is limited to an output voltage of 5V, and using an adapter with incorrect parameters can cause damage to the machine.
- *Please place the product out of reach of young children.
- *Please handle and place the plastic bags in the product packaging box properly.
- *This product is not intended for children to come into contact with or play with to prevent suffocation and injury.

Troubleshooting

When the machine malfunctions, please confirm the following information

1. Remote control not workingThe insulation plate of the remote control battery was not removed, and the remote control battery was dead. The remote control was aimed at the remote control signal sensing position of the host, and the distance between the remote control and the host exceeded 6 meters. The remote control does not need to be pressed continuously (for example, to switch to the next song, press once)
2. CD disc cannot be playedWhen the disc is loaded into the host, the label side is not facing upwards, the disc has dirt or scratches, is not a standard disc, the disc type is incorrect, or the file format is incorrect.
3. The alternating flashing of blue and red lights on the machine indicates low battery power. It is not that the machine is damaged (it can be used by charging). When using it by plugging it in, it is necessary to ensure that the machine still has power (when the machine runs out of battery, if it needs to be plugged in for use, it needs to be charged for a while).
4. Bluetooth connection needs to ensure that the phone's Bluetooth is disconnected from other devices, and when connecting to the machine's Bluetooth (Apple phones cannot open various music and video software at the same time)

This device complies with part 15 of the FCC Rules. Operation is subject to the following two conditions: (1) this device may not cause harmful interference, and (2) this device must accept any interference received, including interference that may cause undesired operation.

Any changes or modifications not expressly approved by the party responsible for compliance could void the user's authority to operate the equipment.

NOTE: This equipment has been tested and found to comply with the limits for a Class B digital device, pursuant to Part 15 of the FCC Rules. These limits are designed to provide reasonable protection against harmful interference in a residential installation. This equipment generates, uses and can radiate radio frequency energy and, if not installed and used in accordance with the instructions, may cause harmful interference to radio communications. However, there is no guarantee that interference will not occur in a particular installation.

If this equipment does cause harmful interference to radio or television reception, which can be determined by turning the equipment off and on, the user is encouraged to try to correct the interference by one or more of the following measures:

- Reorient or relocate the receiving antenna.
- Increase the separation between the equipment and receiver.
- Connect the equipment into an outlet on a circuit different from that to which the receiver is connected.
- Consult the dealer or an experienced radio/TV technician for help.

The device has been evaluated to meet general RF exposure requirement. The device can be used in portable exposure condition without restriction

CD player user manual

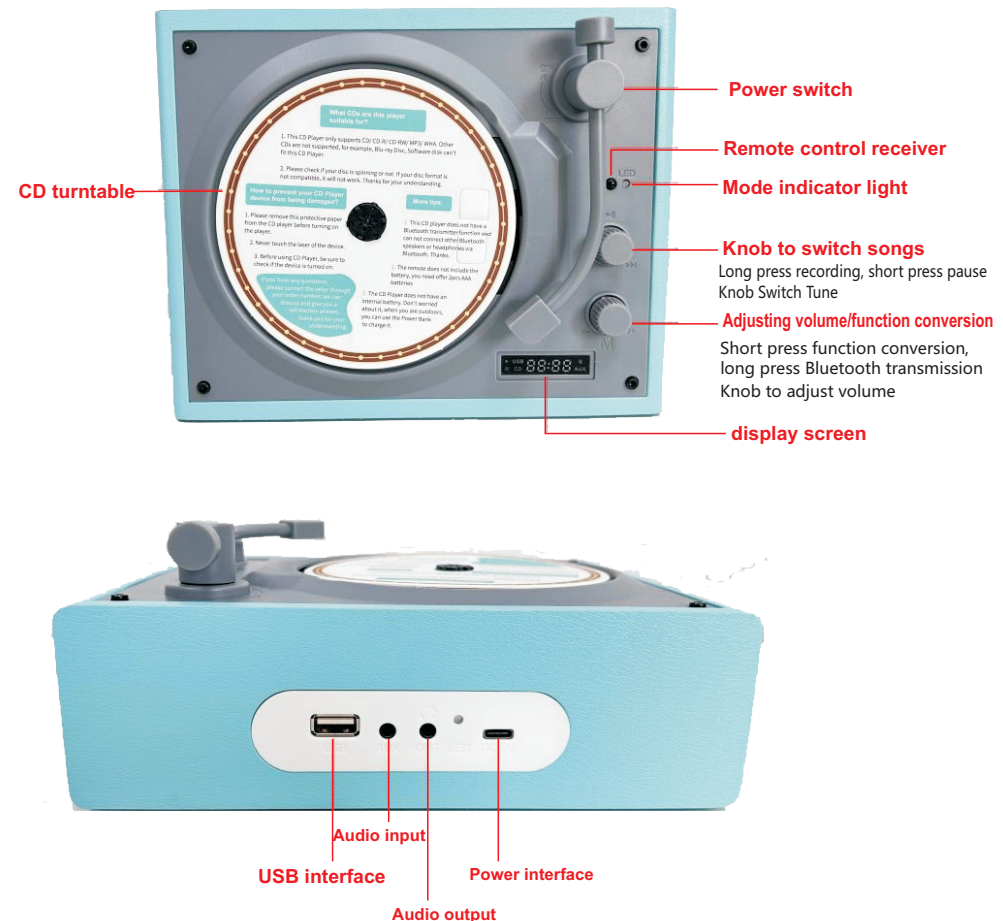

CD player operation steps

Take out the CD circular cardboard, place the CD disc, turn the joystick switch (on/off), and wait for a few seconds to read the disc. When playing music, the first knob on the panel can be rotated to switch between the up and down keys. Press once to pause the playback.

The knob M key is used to adjust the volume level. Press and hold the M key to switch functions, and long press the M key to transmit Bluetooth in both directions, which can be connected to Bluetooth earphones (also operated by the remote control) Long press the play button while playing the CD disc to copy the CD song to the USB drive. Long press the mode button while playing a CD disc, and the CD song will emit. Start up external Bluetooth wireless headphones to answer Overall functions of CD player: CD/USB/BT reception/BT transmission/SPDIF output/mirrorless lighting control CD player support: USB playback, Bluetooth playback, CD playback, AUX audio input, audio output (wired headphone output) Attention:

After receiving the device, it can be charged before use

Specification parameters

Packaging list: CD all-in-one machine x 1, charging cable x 1, remote control x 1, instruction manual x 1. (Self provided 5V charging head is required)

Distortion limited output power: 5W+5W

Rated audio frequency response range: 95Hz

Noise level: $\leq 25\text{Db}-15\text{KHz}$

Charging voltage input: (TYPE-C) DC 5V-1.5A 5V-2A

Power interface: TYPE-C (universal Android phone charging cable)

Battery: 2000MA

Charging

Connect the TYPE-C charging cable to the power interface, and the red indicator light will be on (red light during charging, green light when fully charged) Charging time: about 4 hours to fully charge.

*Attention: Please use a 5V power adapter. Generally, Android phone chargers can be used interchangeably.

Adapters that output voltage exceeding 5V can cause damage to the product.

Bluetooth connectivity

Turn the singing arm switch, rotate the M key, and the mode indicator light will flash blue, Open your phone's Bluetooth and search for "HYLS" and select pairing connection. Once pairing is successful, you can proceed. Bluetooth: Dual mode 5.4 version, stereo output

CD playback

1. Insert the CD disc, clip it onto the movement and hear a click to indicate proper installation
2. Turn on the music stick and default to CD mode. The red indicator light is on. At this point, the disc begins to rotate and enters the read state. After reading the data for about 10 seconds, it begins to play.
3. The volume, playback pause, and mode switching functions can be adjusted through the panel knob or remote control. CD supports playback formats: CD/CD-R/CD RW/MP3/WMA/DVD/VCD

USB playback

Turn on the singing stick, insert the USB flash drive, and adjust the function keys to USB to read the contents of the USB flash drive.

USB supports a maximum capacity of 64GB.

USB supports playback format: MP3 WMA FLAC APE

Attention: Audio files cannot be placed in folders. It is recommended to use MP3 format music

Audio input

Rotate the mode M key, the blue indicator light is on. Insert the 3.5mm audio cable into the back audio output interface, which can be used as a speaker for devices such as computers. (The audio cable needs to be provided or purchased) If you need to switch to other modes, you need to unplug the audio cable.

Audio output

1. This device supports connecting active speakers or amplifiers Connecting an active speaker: Insert a 3.5mm audio cable into the back audio output interface (audio cable needs to be provided or purchased)
2. Connecting headphones: Insert headphones into audio output