



PRIVORO®

To avoid damaging your
SafeCase, read the enclosed
information before using.

SAFECASE QUICK START GUIDE

For use with iPhone® 7 or 8

1. INSERTING THE IPHONE INTO THE SAFECASE

NOTE: Screen protectors and protective cases should not be used with SafeCase. These will interfere with the audio masking feature.

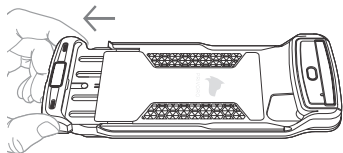

- 1 Pinch the sides of the base tray and slide open.

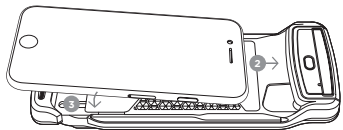

- 2 Place the iPhone into the tray, sliding the top of the phone slightly beneath the hood.
- 3 Rest the phone into the case.

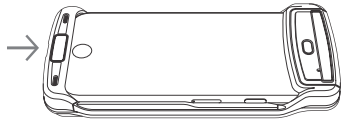

- 4 Close the base tray.

2. ATTACHING THE LOCK PANEL

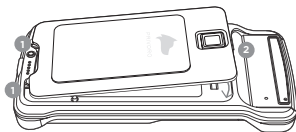

- 1 Ensure the base tray is closed. Place the hooks at the bottom of the lock panel into the hook cradles on the back of the SafeCase.
- 2 Press the Lock Panel to the SafeCase until the latch snaps the panel into place.

3. POWERING THE SAFECASE ON

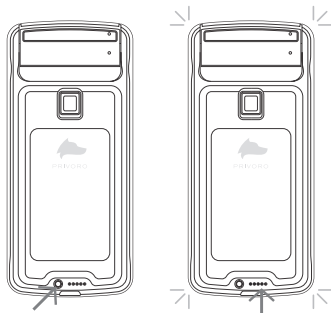

To power on the SafeCase, press and hold the back button for 3 seconds.

The corner indicator lights and battery status lights will blink green 5 times.

NOTE: If the case does not power on - using the charging cable provided - charge the case until one battery status light illuminates, then power the SafeCase on.

4. PAIRING THE SAFECASE WITH THE PRIVORO APP



From the iPhone, download the PRIVORO app from the Apple App store. Once downloaded, open the app and sign in with the credentials provided by your system administrator or directly from Privoro.

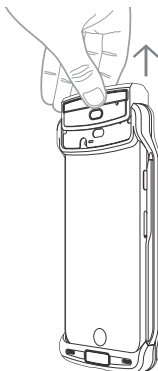

Unprotected Mode

Pinch and pull gently at the top to raise the hood

- For placing/answering call, using camera, recording audio?
- Audio and video protections are disengaged
- Corner indicator lights pulse red

5. USING YOUR SAFECASE

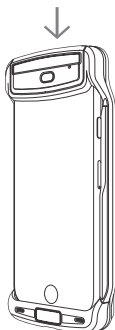

Protected Mode

Hood is in the down position

- Default use
- Audio and video protections are engaged
- Corner indicator lights pulse green



Audio Passthrough Mode

Press and hold the front button for audio passthrough

- For using digital assistants such as Siri
- Audio protections are disengaged, video protections are engaged
- Corner indicator lights blink red

SAFECASE GLOSSARY

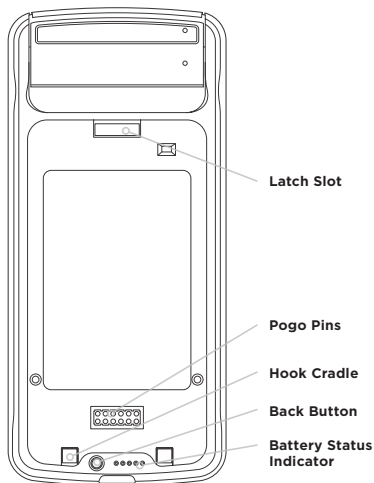
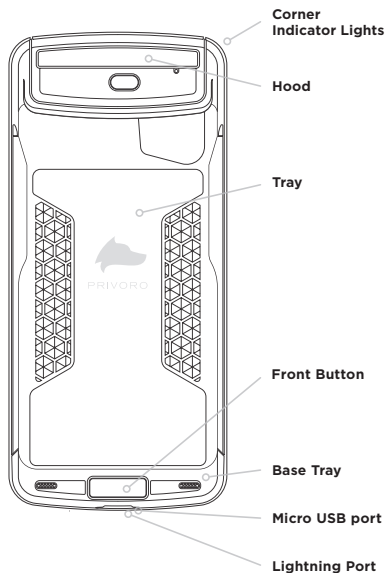

ADDITIONAL INFORMATION

A User Manual is available online at privoro.com/manual. It contains user instructions for installation and use. This Quick Start Guide is intended to provide instructions and get users up and running quickly. See the User Manual for complete usage, safety and regulatory information.



PRIVORO®

© 2018 PPIP LLC. All rights reserved. PRIVORO and the PRIVORO DOG LOGO are trademarks of PPIP LLLC, registered in the U.S. and other countries.

A04-0004