



OPERATING MANUAL

Manuel d'utilisation

Bedienungsanleitung

Manual de instrucciones

Manuale d'uso

取扱説明書

Инструкция по эксплуатации

H600

Taiwan Proscenic Polytron Technologies Inc

Service support

E-mail: service@proscenic.tw

www.proscenic.tw

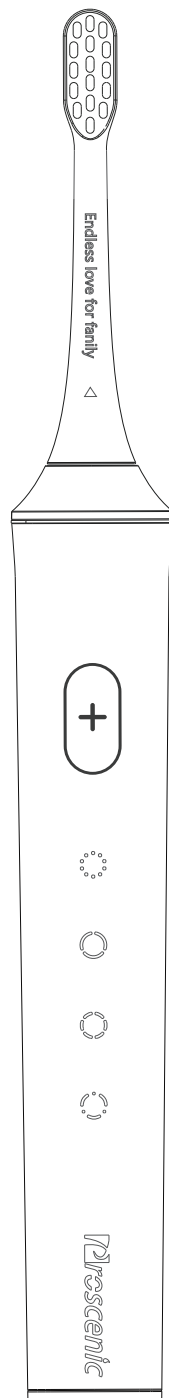

English

Important

Read this user manual carefully before you use the appliance and save it for future reference.

Danger

–Keep the charger away from water. Do not place or store it over or near water contained in a bathtub, washbasin, sink etc. Do not immerse the charger in water or any other liquid. After cleaning, make sure the charger is completely dry before you connect it to the mains.

Warning

- The main cord cannot be replaced. If the main cord is damaged, discard the charger.
- Always have the charger replaced with one of the original type in order to avoid a hazard.
- Do not use the charger outdoors or near heated surfaces. If the appliance is damaged in any way (brush head, toothbrush handle or charger), stop using it. This appliance contains no serviceable parts. If the appliance is damaged, contact the Consumer Care Center in your country (see 'Warranty and support').
- This appliance can be used by children aged from 8 years and above and by persons with reduced physical, sensory or mental capabilities or lack of experience and knowledge if they have been given supervision or instruction concerning use of the appliance in a safe way and if they understand the hazards involved. Children should not play with the appliance. Cleaning and user maintenance shall not be made by children unless they are older than 8 and supervised.
- In order to effectively charge your Proscenic electronic toothbrush handle do not place your charger base on a magnetic metal surface.

Caution

- Do not clean the brush head, the handle or the charger in the dishwasher. If you have had oral or gum surgery in the previous 2 months, consult your dentist before you use the toothbrush.
- Consult your dentist if excessive bleeding occurs after using this toothbrush or if bleeding continues to occur after 1 week of use. Also consult your dentist if you experience discomfort or pain when you use the Proscenic electronic toothbrush.
- The Proscenic electronic toothbrush complies with the safety standards for electromagnetic devices. If you have a pacemaker or other implanted device, contact your physician or the device manufacturer of the implanted device prior to use.
- If you have medical concerns, consult your doctor before you use the Proscenic electronic toothbrush.
- This appliance has only been designed for cleaning teeth, gums and tongue. Do not use it for any other purpose. Stop using the appliance and contact your doctor if you experience any discomfort or pain. The Proscenic electronic toothbrush is a personal care device and is not intended for use on multiple patients in a dental practice or institution.
- Stop using a brush head with crushed or bent bristles. Replace the brush head every 3 months or sooner if signs of wear appear. Do not use other brush heads than the ones recommended by the manufacturer.
- If your toothpaste contains peroxide, baking soda or bicarbonate (common in whitening toothpastes), thoroughly clean the brush head with soap and water after each use. This prevents possible cracking of the plastic.
- The appliance shall be used only with cold or warm water.
- It must only be supplied at safety extra low voltage corresponding to the marking on the appliance.

Electromagnetic fields (EMF)

This Proscenic appliance complies with all applicable standards and regulations regarding exposure to electromagnetic fields.

Note: This equipment has been tested and found to comply with the limits for a Class B digital device, pursuant to part 15 of the FCC Rules. These limits are designed to provide reasonable protection against harmful interference in a residential installation. This equipment generates, uses and can radiate radio frequency energy and, if not installed and used in accordance with the instructions, may cause harmful interference to radio communications. However, there is no guarantee that interference will not occur in a particular installation. If this equipment does cause harmful interference to radio or television reception, which can be determined by turning the equipment off and on, the user is encouraged to try to correct the interference by one or more of the following measures:

- Reorient or relocate the receiving antenna.
- Increase the separation between the equipment and receiver.
- Connect the equipment into an outlet on a circuit different from that to which the receiver is connected.
- Consult the dealer or an experienced radio/TV technician for help.

Modification: Any changes or modifications not expressly approved by the grantee of this device could void the user's authority to operate the device.)

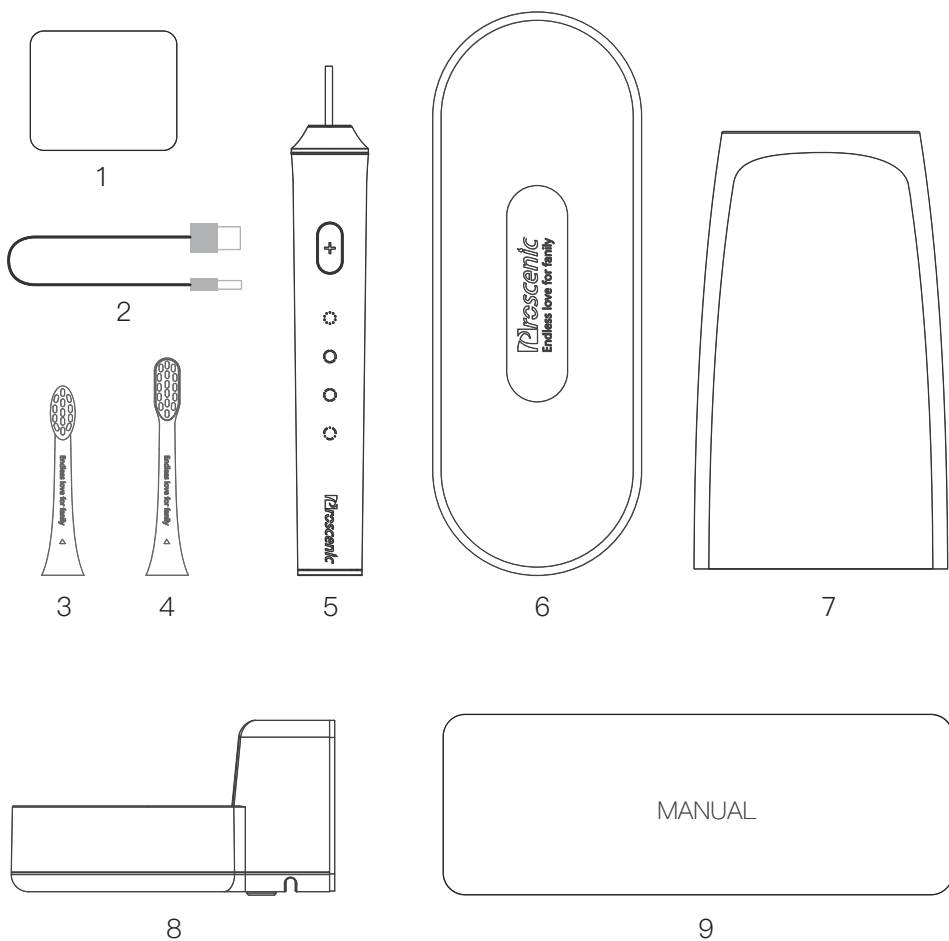

Your proscenic electronic toothbrush

- | | |
|------------------------------|------------------|
| 1.Assemble accessory | 2.USB cable |
| 3.Little brush head | 4.Big brush head |
| 5.Electronic toothbrush body | 6.Travel case |
| 7.Acrylic cup | 8.Charging base |
| 9.Manual | |

Brushing modes

Your power toothbrush is equipped with 4 different modes to accommodate all your oral care needs (some models come with 4 brushing modes only).

The following modes are available:

Clean mode (L1)

Clean is your toothbrush' workhorse mode. At 31,000 brush strokes per minute, it removes plaque with superior efficiency in a two-minute program. The Clean mode is the base setting on every electric toothbrush. If you're going to stick to one mode, make it this one

White mode (L2)

In White mode, your toothbrush works a bit harder to remove surface stains caused by things like coffee and tea.

Polish mode (L3)

Getting ready for a night out? Select the Polish mode for a quick two-minute touch up of your front teeth. It's all you need to make a dazzling entrance.

Massage mode (L4)

It can promote the blood circulation of the periodontal, improve the nutrition of the pulp and periosteum of the teeth, thereby preventing the shrinkage of the gums of the elderly and the loosening of the teeth, making the teeth strong, enhancing the defense ability and chewing ability of the periodontal tissues, and preventing The role of periodontal disease

Using your Proscenic Brushing instructions

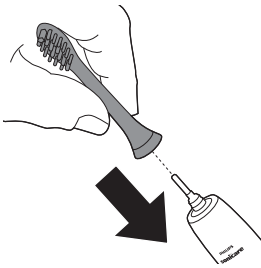

1. Attach your desired brush head. Align the brush head so the bristles point in the same direction as the front of the handle.

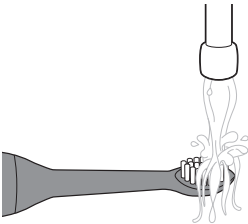

2. Wet the bristles.

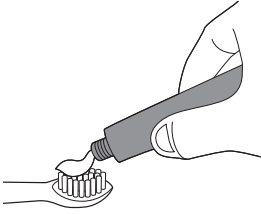

3. Apply a small amount of toothpaste on the bristles.

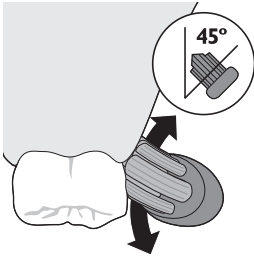

4. Place the toothbrush bristles against the teeth at a slight angle (45 degrees), pressing firmly to make the bristles reach the gum line or slightly beneath the gum line.

Note: Keep the center of the brush in contact with the teeth at all times.

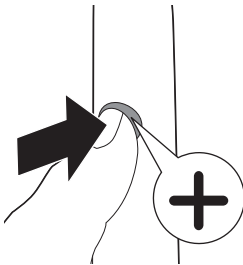

5. Press the power on/off button to switch on the Proscenic Brushing

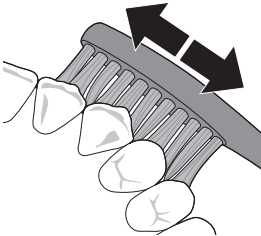

6. Apply light pressure to maximize Proscenic Brushing your teeth with a small back and forth motion so the bristles reach between the teeth. Continue this motion throughout the brushing cycle.

Note: The bristles should flare slightly. Do not scrub.



7. To clean the inside surfaces of the front teeth,

Features and accessories

A App

Your electric toothbrush is Bluetooth enabled and allows you to achieve superior oral health care with the Proscenichome app.

Using the Proscenichome app will help you to improve your oral health care habits. It gives you real-time feedback while brushing, informs you if you missed any spots when brushing, tracks your brushing behavior over time and provides useful tips and tricks for your healthiest mouth ever. we advise you to follow these steps:

Connecting your toothbrush

1. Download the Proscenichome app from Apple Store / Google Play
2. Login account . Go to the app main page
3. Connect the electric toothbrush, first turn on the mobile phone Bluetooth, then press and hold the electric toothbrush power button for 3 seconds, when the Bluetooth symbol on the handle flashes, at this time.The toothbrush can be connected to the mobile app.
4. Click "Add Device" on the app to enter the interface and select electronic toothbrush. click on "Search Device" to start searching (the host must be next to the phone), Proscenic Bluetooth--** clicks the device to connect successfully. If you can't connect to confirm whether the host is next to the mobile phone, if the host Bluetooth symbol is flashing, and the mobile phone Bluetooth is enabled, please follow the above steps to reconnect.



(APP)

Note: For optimal data capture, keep your mobile near by.

B Button usage guide

Manual mode (default)

1. The handle is turned off, and no LED is lit in the body;
2. Short press once/twice/three time/four time enter L1/L2/L3/L4, LED white light is on. Automatically stop in the middle without pressing the button for two minutes, and the LED light is off;
3. Press 5 times to return to L1 mode. The sequence of consecutive presses is: (wake up) – L1 – L2 – L3 – L4 – L1 – cycle;
4. In the default setting, start timing after selecting any mode after waking up, the middle shift does not interfere with the timing, and automatically stops after 2 minutes;
5. Press and hold button 2S to turn off in any gear position. The handle has a memory function, and it stops at the last time when it was turned off.

Favorite mode (select different brushing schemes in the app, custom brushing^a duration and gear^b position)

1. The handle is off and the body is not lit;
2. Short press 1 time, enter the automatic brushing mode to brush your teeth, the button on the handle is invalid (can not manually select the gear position);
4. Short press again 1 time to shut down;
5. In this mode, press and hold the power button 5S to restore the factory mode (manual mode)

Battery status and charging

Charging with wall charger

The wall-mounted charging stand adopts stress induction. The weak blue light is brightened when the cup placed to the charging base after about 5 minutes. Extinguished (antibacterial effect)

Charging process: When the handle is placed in the charging stand for charging, 0% – 95% red light flashing; 95% – 100% white flashing solid.

low power prompt : The battery power is less than 5%, the charging indicator flashes red to remind you to charge.

Working time: 60 days per charger

Important: The wall adapter must be a safe extra low voltage source, compatible with the electrical ratings marked on the device.

Note: It takes at least 24 hours to fully charge your Proscenic electric brushing. You do not have to fully charge your handle before first use, as the handle is pre-charged for first use. However, it is recommended to fully charge it after first use.

Note: This charger is designed to properly charge only one handle at a time. This charger is not compatible with other models of Proscenic electric brushing.

Wall charging installation steps

1. Screw fixing (Suitable screws for fixed walls)

a. Take out the hanging plate

b. Punch the hole according to the hole of the sticker, and fix the hanging plate to the wall with screws.

c. Hang the wall charging on the hanging plate

d. Insert the electric toothbrush from the hole and put the cup on the top to charge.

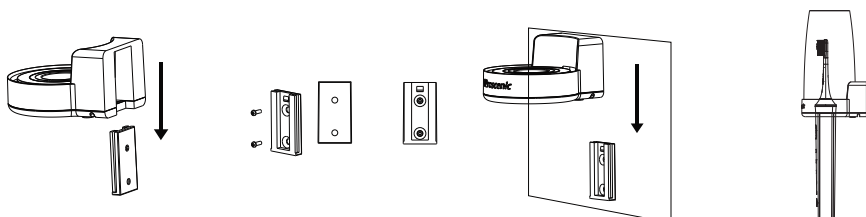

2. Glue fixing

- a. Take out the hanging plate
- b. Glue the hanging plate to the wall with glue (install wall charging after 3 days later, Glue takes 3 days to dry)
- c. Hang the wall charging on the hanging plate
- d. Insert the electric toothbrush from the hole and put the cup on the top to charge

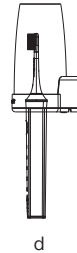
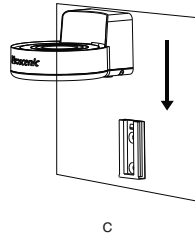
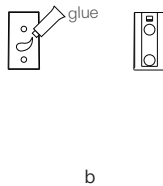
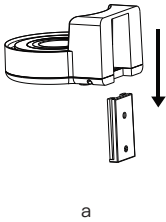

Cleaning Toothbrush handle

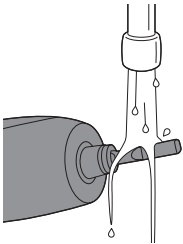

- 1 Remove the brush head and rinse the metal shaft area with warm water. Make sure you remove any residual toothpaste.

Caution: Do not push on the rubber seal on the metal shaft with sharp objects, as this may cause damage.

- 2 Wipe the entire surface of the handle with a damp cloth.

Note: Do not use isopropyl rubbing alcohol, vinegar or bleach to clean handle as this may cause discoloration.

Brush head

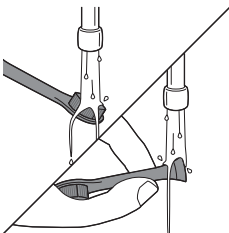

- 1 Rinse the brush head and bristles after each use.
- 2 Remove the brush head from the handle and rinse the brush head connection with warm water at least once a week.

Acrylic cup

- 1 Clean the Acrylic cup with water and some mild soap.
- 2 Dry them with a soft towel.

The acrylic cup are dishwasher-safe.

Storage

If you are not going to use your Proscenic electric brushing for an extended period of time, unplug the charger from the wall socket, clean it and store it in a cool and dry place away from direct sunlight.

Recycling

This symbol means that this product shall not be disposed of with normal household waste (2012/19/EU).

–This symbol means that this product contains a built-in rechargeable battery which shall not be disposed of with normal household waste (2006/66/EC). We strongly advise you to take your product to an official collection point or a Proscenic service center to have a professional remove the rechargeable battery.



–Follow your country's rules for the separate collection of electrical and electronic products and rechargeable batteries. Correct disposal helps prevent negative consequences for the environment and human health.

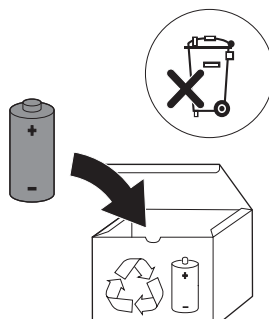
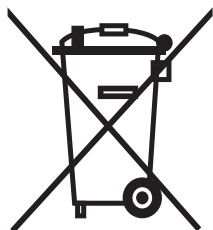

Warranty and support

If you need information or support, please read the international warranty leaflet.

Warranty restrictions

The terms of the international warranty do not cover the following:

- Brush heads.
- Damage caused by use of unauthorized replacement parts.
- Damage caused by misuse, abuse, neglect, alterations or unauthorized repair.
- Normal wear and tear, including chips, scratches, abrasions, discoloration or fading.

Customer Service

✉ Email:service@proscenic.tw

☎ Customer service hotline:

(DE)+49 202 75886417	Mon~Fri 13:00-16:00	English & German
(JP)+04 63-68-7447	月曜~金曜 9:00-17:00	Japanese
(CN)+86 400-0097-087	周一~周五 9:00-17:00	Chinese

 @proscenic  @proscenicofficial  @proscenicofficial  @proscenicglobal

Shenzhen Proscenic Technology Co.,Ltd

5th floor,Jinshun Building, No 287 Ruy Road, Ailian Community,Longgang District Shenzhen city,China

 **roscenic**

China : Shenzhen Pusensi Technology Co., Ltd
502, Block A,Jinshun Building ,Ruyi Road,
Longgang District,Shenzhen
www.proscenic.tw

Taiwan : Taiwan Proscenic Technology Co., Ltd.
yingyi street 121 lane 3rd lingya area,
gaoxiong,taiwan
www.proscenic.tw