

# PHILIPS

Boombox CD Player

3300 Series

TAZ3300B TAZ3300W



## User manual

Register your product and get support at:  
[www.philips.com/support](http://www.philips.com/support)

# Contents

1	Important	3
	Safety	3
	Notice	4
2	Your CD Soundmachine	5
	What's in the box	5
	Overview of the main unit	6
3	Get started	7
	Connect power	7
	Turn on/ Standby	7
	App download	7
4	Play from CD	8
5	Listen to the radio	9
6	Play from Bluetooth	9-10
7	Play from USB	10
8	Listen to an external- device	11
9	Connect with headphone	11
10	Product Specification	12
	USB playability information	12
	Supported MP3 disc formats	13
11	Troubleshooting	14-15
12	Trademarks	15

# 1 Important

## Safety

Read and understand all instructions before you use this CD soundmachine system.

If damage is caused by failure to follow the instructions, the warranty does not apply.



This 'bolt of lightning' indicates uninsulated material within the device may cause an electrical shock. For the safety of everyone in your household, please do not remove the covering.

The 'exclamation mark' calls attention to features for which you should read the enclosed literature closely to prevent operating and maintenance problems.

**WARNING:** To reduce the risk of fire or electric shock, the device should not be exposed to rain or moisture and objects filled with liquids, such as vases, should not be placed on the device.

**CAUTION:** To prevent electric shock, fully insert the plug. (For regions with polarized plugs: To prevent electric shock, match wide blade to wide slot.)



### Warning

- Never remove the casing of this apparatus.
- Never lubricate any part of this apparatus.
- Never look into the laser beam inside this apparatus.
- Never place this apparatus on other electrical equipment.
- Keep this apparatus away from direct sunlight, naked flames or heat.
- Ensure that you always have easy access to the power cord, plug or adaptor to disconnect the apparatus from the power

- Make sure that there is enough free space around the product for ventilation.
- Only use attachments/accessories specified by the manufacturer.
- Battery usage **CAUTION**-to prevent battery leakage which may result in bodily injury, property damage, or damage to the product:
  - Install the battery correctly, + and - as marked on the product.
  - The battery (packed or installed) shall not be exposed to excessive heat such as sunshine, fire or the like.
  - Remove the battery when the product is not used for long time.
- The product shall not be exposed to dripping or splashing.
- Do not place any source of danger on the product (e.g. liquid filled objects, lit candles).
- Where the MAINS plug or an appliance coupler is used as the disconnect device, the disconnect device shall remain readily operable.
- Please use the product safely in an environment with temperature between 0 °C and 40 °C.

## Notice

Any changes or modifications made to this device that are not expressly approved by MMD Hong Kong Holding Limited may void the user's authority to operate the equipment.

## Compliance

Hereby, TP Vision Europe B.V. declares that this product is in compliance with the essential requirements and other relevant provisions of Directive 2014/53/EU. You can find the Declaration of Conformity on [www.philips.com/support](http://www.philips.com/support).

## Care of the environment

Disposal of your old product and battery



Your product is designed and manufactured with high quality materials and components, which can be recycled and reused.



This symbol on a product means that the product is covered by European Directive 2012/19/EU.



This symbol means that the product contains batteries covered by European Regulation (EU) 2023/1542 which cannot be disposed of with normal household waste.

Inform yourself about the local separate collection system for electrical and electronic products and batteries. Follow local rules and never dispose of the product and batteries with normal household waste. Correct disposal of old products and batteries helps prevent negative consequences for the environment and human health.

Removing the disposable batteries  
To remove the disposable batteries, see battery installation section.

Environmental information  
All unnecessary packaging has been omitted.  
Your system consists of materials which can be recycled and reused if disassembled by a specialized company. Please observe the local regulations regarding the disposal of packaging materials, exhausted batteries and old equipment.

## Care for your product

- Do not insert any objects other than discs into the disc compartment.
- Do not insert warped or cracked discs into the disc compartment.
- Remove the discs from the disc compartment if you are not using the product for an extended period of time.
- Only use microfiber cloth to clean the product.

This apparatus includes this label:



Note

- The type plate is located on the bottom of the product.

# 2 Your CD Soundmachine

Congratulations on your purchase, and welcome to Philips! To fully benefit from the support that Philips offers, register your product at [www.philips.com/support](http://www.philips.com/support).

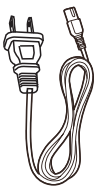

Power cord

## Introduction

With this CD Sound machine, you can:

- Listen to FM radio;
- Enjoy audio from discs, and other external audio devices;

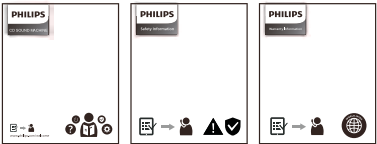

Quick Start Guide  
Safety sheet/Warranty card

## What's in the box

Check and identify the contents of your package:

- |                     |     |
|---------------------|-----|
| • Main unit         | × 1 |
| • Power cord        | × 1 |
| • Quick Start Guide | × 1 |
| • Safety sheet      | × 1 |
| • Warranty card     | × 1 |

- Power cord quantity and plug type vary by regions.
- Images, illustrations and drawings shown on this user manual are for reference only, actual product may vary in appearance.



Main unit

# Overview of the main unit

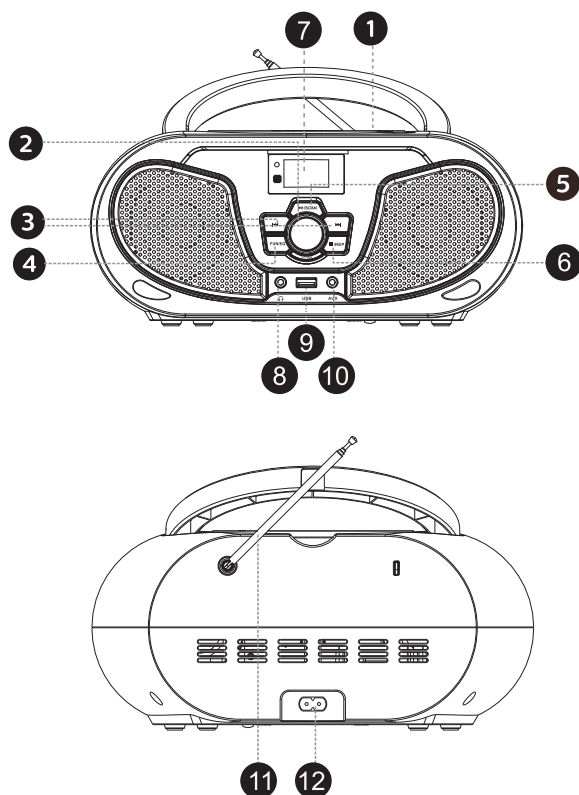

1. Disc tray  
Disc compartment.
2. **POWER/VOL**  
Push to turn on or turn off;  
Rotate to increase the volume
3. **PREV/NEXT**  
Skip the previous/next album/navigate  
preset station.
4. **INPUT/EQ**  
Press to switch input modes;  
Long press to switch between equaliser  
modes.
5. **PLAY/PAUSE**  
Start and pause play.
6. **REPEAT/MEMORY PLAY**  
Stop the play & Repeat play & memory play
7. **Display screen**  
Display play information.
8. **STOP**  
Connect external audio device.
9. **USB**  
Connect USB storage device.
10. **EXTERNAL EARPHONE JACK**  
Connect the external earphone device.
11. **ANTENNA**  
FM antenna.
12. **AC IN**  
Insert power cable plug to AC IN socket.

## 3 Get started

### ! Caution

- Use of controls or adjustments or performance of procedures other than herein may result in hazardous radiation exposure or other unsafe operation.

Always follow the instructions in this chapter in sequence.

## Connect power

The unit can be powered by either AC power or batteries.

### Option 1 : AC power

#### ! Warning

- Risk of product damage! Make sure that the power supply voltage corresponds to the voltage printed on the back or the underside of the unit.
- Risk of electric shock! When you disconnect the AC power, always pull the plug from the socket. Never pull the cord.

Connect the AC power cord to the wall socket.

#### ≡ Note

- To save energy, turn the unit off after use.

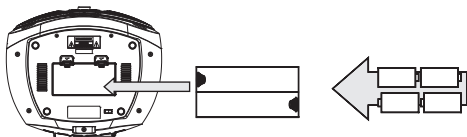
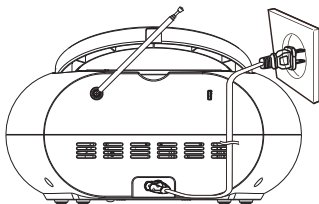

#### ≡ Note

- The batteries are not supplied, the user needs to purchase them.

## Turn on/Standby

Press the Standby button on the unit to turn on and switch to last source, press it again to turn off.

Switch to standby mode

- The product switches to standby mode automatically when there is no audio detected for over 15 minutes.
- Press Standby button to wake up the product from standby mode.

### Option 2 : Battery power

### ! Caution

- Batteries contain chemical substances, so they should be disposed of properly.

- 1 Open the battery compartment.
- 2 Insert 4 batteries (type : 1.5V R14/UM2/CELL) with correct polarity (+/-) as indicated.
- 3 Close the battery compartment.

## 4 Play from CD

### Play a CD



#### Note

- You cannot play CDs encoded with copyright protection technologies.
- When an audio-in cable is plugged, CD playback stops, and the unit switches to audio in mode automatically.
- Make sure that no external device is connected with the CD sound machine through AUDIO IN socket before you play a CD.

You can play commercially available audio CDs:

- CD-Recordables(CD-R)
- CD-Rewritables(CD-RW)
- MP3 discs

- 1 Switch the source selector to CD.  
↳ CD displays on the screen.
  - 2 Open the CD compartment.
  - 3 Insert a CD with the printed side facing up and close the CD lid gently.  
↳ Your CD sound machine starts to play automatically.
- To select a track, press ◀◀ / ▶▶.
  - To pause CD play, press ▶||.
  - To resume CD play, press ▶|| again.
  - To stop CD play, press ■.

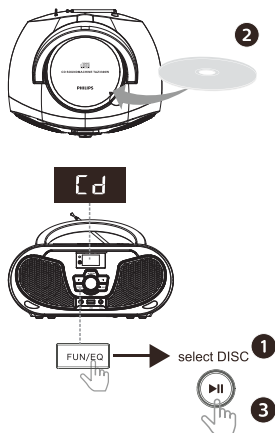

### CD Play

Push OPEN, place a disc in the CD compartment, and then close the cover.

NOTE: The label side should face up.

2. Press the FUN/EQ button and select Cd to enter the CD mode. The disc will load, display the total number of tracks on the screen and start playing.
3. Press ▶||/SCAN button to pause playback. Press again to restart playback.
4. Press the ◀◀ or ▶▶ button to skip to previous or next track, respectively. Press and hold the same button to rewind or fast-forward a track, respectively.
5. Press ■ /RPT button to set Repeat function: One, All, Off. Press and hold the button to stop playback.



## 5 Listen to the radio

With this product, you can listen to FM radio.

### Note

- Position the antenna as far as possible from TV, or other radiation source.
- For optimal reception, fully extend and adjust the position of the antenna.

1. Press the FUN/EQ button and select rad to enter the FM radio mode.

2. Press and hold the ►/SCAN button to automatically scan the frequency range for radio stations and store them in presets.

3. Press the ►/SCAN button to select the next preset radio station.

4. Press the or button to manually search radio stations. Each press will move the frequency up/down by 0.01 MHz. Press and hold the buttons to search for the previous/next station.

5. To begin manually assigning a preset number to a radio station, press the ■ /RPT/MEM button. Press the ►/SCAN button to pick a preset number. Press the ■ /RPT/MEM button again to save the station to the preset.

### Note

- You can store a maximum of 20 FM radio stations.

## 6 Play from Bluetooth

### Play from classic bluetooth

#### Note

- Compatibility with all Bluetooth devices is not guaranteed.
- Any obstacle between the unit and the device can reduce the operational range.
- The effective operation range between this unit and your Bluetooth enabled device is approximately 10 meters (30 feet).
- The unit can memorize up to 8 previously connected Bluetooth devices.

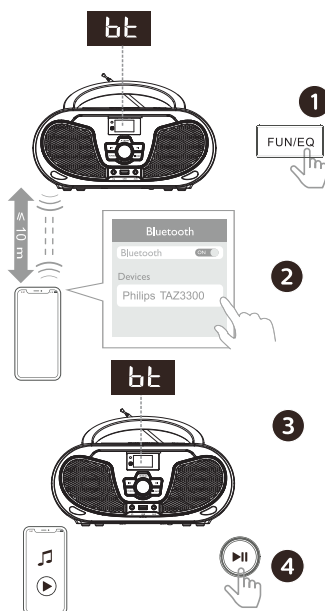

## 7 Play from USB

1. Press the FUN/EQ button and select bt to enter Bluetooth mode.

2. On your connecting device, enable Bluetooth.

3. In the Bluetooth settings, search for nearby devices.

4. Look for Philips TAZ3300 in the list of available devices. If it doesn't appear, return to step 1.

5. When you see Philips TAZ3300 in the list, select it to start the Bluetooth pairing process, and confirm.

6. Once pairing is successful, any audio played on your device should now come through the boombox.

7. Adjust the volume on the external device and on the boombox to get the desired sound level.

8. Use the controls on the boombox or your external music player to play, pause or skip tracks.



### Note

- Make sure that the USB device contains playable audio content.
- **Support FAT16/FAT32 file format.**  
Support ≤ 128G.

1. Plug in your USB flash drive with music files.

2. Press the FUN/EQ button and select USB to enter USB mode. The playback will begin automatically.

3. Press the ◀◀ or ▶▶ button to skip to previous or next track, respectively. Press and hold the same button to rewind or fast-forward a track, respectively.

4. Press the ■/RPT button to set Repeat function: One, File, All, Off.

5. Press and hold the ■/RPT button to stop playback.

6. Press the ▶||/SCAN button to restart playback.



### Note

Turn off playback and then switch to a different input mode or turn off the device before removing the USB flash drive. Removing the USB flash drive without following these steps may result in data corruption or USB flash drive damage.

## 8 Listen to an external device

Connect one end of an AUX audio cable (not supplied) to the 3.5mm AUX port on the boombox.

2. Connect the other end to the headphone jack on the external device (e.g., smartphone, MP3 player, records player).

3. Press the FUN/EQ button and select AUX.

4. Turn on the external music player and start playing music. You should now be able to hear the music from the external music player playing through the boombox.

5. Adjust the volume on the external device and on the boombox to get the desired sound level.

6. Use the controls on your external music player to play, pause or skip tracks.

## 9 Connect with headphone

To listen through headphones 

Connect headphones to the (headphones) jack.

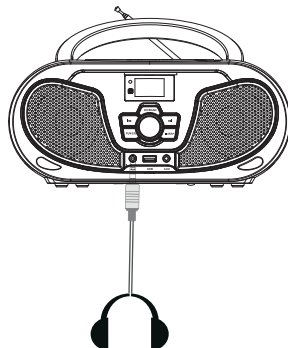

### Note

- The AUDIO-IN socket is not for headphones.

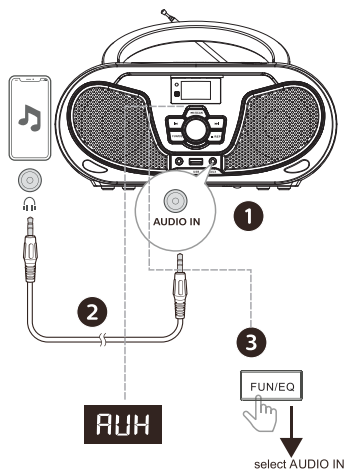

# 10 Product Specification



## Note

- Product information is subject to change without prior notice.

## Bluetooth

Bluetooth profiles	A2DP, AVRCP
Bluetooth version	V 5.3
Bluetooth frequency range / Transmitter power (EIRP)	2402 ~ 2480MHz < 9dBm

## CD soundmachine

Power :	100-240V~, 50/60 Hz( AC Input)
---------	-----------------------------------

Rated output power:	Total 4W (RMS)
---------------------	----------------

Acoustic frequency response:	125Hz-20KHz
------------------------------	-------------

Speaker driver:	2 x 2.5" full range, 4Ω
-----------------	-------------------------

Operation power consumption:	13 W
------------------------------	------

Standby power consumption:	< 0.5W (The display off)
----------------------------	--------------------------

AUDIO IN input level : 500mV

Tuner frequency range :	FM 87.5-108MHz
-------------------------	----------------

Dimensions (W x H x D):	285 x238x128 mm (Main unit)
-------------------------	--------------------------------

Weight :	1.30 kg (Main unit)
----------	---------------------

## Supported audio formats

USB playback:	Type A, USB Direct 2.0,5V/500mA, MSC file format, FAT16/32
---------------	---

## Disc

Laser Type :	semiconductor
Disc Diameter :	12cm/8cm
Support Disc :	CD-DA, CD-R CD-RW, CD-MP3
Audio DAC :	24Bits/44.1kHz
Total Harmonic Distortion :	< 1%
Frequency Response :	125-16000Hz(-3dB)
S/N Ratio :	> 55 dBA

Measured by Philips standards, Philips battery C LR14 1.5V, the actual battery life may vary depending on the circumstances of the unit or operating conditions.

# USB playability information

Extension	Codec	Sample Rate	Bitrate
.mp3	MPEG 1 Layer 1	32~48 kHz	44.1~320 kbps
	MPEG 1 Layer 2	32~48 kHz	44.1~320 kbps
	MPEG 1 Layer 3	32~48 kHz	44.1~320 kbps
.wav	WAV	8~48 kHz	Up to 1536 kbps
.wma	WMA	8~48 kHz	48~192 kbps

## Compatible USB devices:

- USB flash memory (USB2.0 or USB1.1)
- USB flash players (USB2.0 or USB1.1)
- memory cards (requires an additional card reader to work with this unit)

## Supported USB formats:

- USB or memory file format: FAT12, FAT16, FAT32 (sector size: 512 bytes)
- MP3 bit rate (data rate): 48-320 Kbps and variable bit rate
- WMA bit rate (data rate) : 48~192 kbps
- WAV bit rate (data rate) : Up to 1536 kbps
- Directory nesting up to a maximum of 8 levels
- Number of albums/folders: maximum 99  
Number of tracks/titles : maximum 999  
File name in Unicode UTF8 (maximum length : 32 bytes)

## Unsupported USB formats:

- Empty albums : an empty album is an album that does not contain MP3 files, and will not be shown in the display.
- Unsupported file formats will be skipped. For example, MP3 files with the extension dif will be ignored and will not be played.
- WMA, AAC, WAV, PCM audio files: DRM protected WMA files. (Note: only support some wav audio files).
- WMA files in lossless format.

# Supported MP3 disc formats

- IS09660, Joliet
- Maximum title number : 128 (depending on file name length)
- Maximum album number : 99
- Supported sampling frequencies: 44.1 kHz, 48 kHz
- Supported Bit-rates: 44.1~256(kbps), variable bitrates

# 11 Troubleshooting



## Warning

- Never remove the casing of this device.

To keep the warranty valid, never try to repair the system yourself.

If you encounter problems when using this device, check the following points before requesting service. If the problem remains unsolved, go to the Philips Web page ([www.philips.com/support](http://www.philips.com/support)). When you contact Philips, make sure that the device is nearby and the model number and serial number are available.

### No power

- Make sure that the AC power cord of the device is connected properly.
- Make sure that there is power at the AC outlet.

### No sound or poor sound

- Adjust the volume.

### No response from the unit

- Disconnect and reconnect the AC power plug, then turn on the unit again.

### No disc detected

- Insert a disc.
- Check if the disc is inserted upside down.
- Wait until the moisture condensation at the lens has cleared.
- Replace or clean the disc.
- Use a finalized CD or correct format disc.

### Cannot display some files in USB device

- The number of folders or files in the USB device has exceeded a certain limit. This phenomenon is not a malfunction.
- The formats of these files are not supported.

### USB device not supported

- The USB device is incompatible with the unit. Try another one.

### Poor radio reception

- Fully extend the radio antenna.

Music playback is unavailable on this unit even after successful Bluetooth connection.

- The device cannot be used to play music through this unit wirelessly.

The audio quality is poor after connection with a Bluetooth-enabled device.

- The Bluetooth reception is poor. Move the device closer to this unit or remove any obstacle between them.

Bluetooth cannot be connected with this unit.

- The device does not support the profiles required for this unit.
- The Bluetooth function of the device is not enabled. Refer to the user manual of the device to find out how to enable the function.
- This unit is not in pairing mode.
- This unit is already connected with another Bluetooth-enabled device. Disconnect that device and then try again.

The paired mobile device connects and disconnects constantly.

- The Bluetooth reception is poor. Move the device closer to this unit or remove any obstacle between them.
- Some mobile phones may connect and disconnect constantly when you make or end calls. This does not indicate any malfunction of this unit.

## 12 Trademarks

The Bluetooth word mark and logos are registered trademarks owned by Bluetooth SIG, Inc. and any use of such marks by MMD Hong Kong Holding Limited is under license.

The making of unauthorized copies of copy-protected material, including computer programs, files, broadcasts and sound recordings, may be an infringement of copyrights and constitute a criminal offence. This equipment should not be used for such purposes.

Blue text should be changed to applicable value for your product (red text should be removed, only for your information):

Operating ambient temperature: 0 - 40°C,  
Storage and transportation ambient temperature: -10 - 50°C,  
altitude not higher than 2000m (air pressure not less than 80kPa),

### WARNING:

- replacement of a battery with an incorrect type may defeat a safeguard;
- disposal of a battery into fire or a hot oven, or mechanically crushing or cutting of a battery, may result in an explosion;
- leaving a battery in an extremely high temperature surrounding environment, such as sunshine, fire, or hot surface may result in an explosion or the leakage of flammable liquid or gas;
- a battery subjected to extremely low air pressure may result in an explosion or the leakage of flammable liquid or gas.

### CAUTION

Risk of fire or explosion if the battery is replaced by an incorrect type!

#### Warning

To assure continued compliance, any changes or modifications not expressly approved by the party responsible for compliance could void the user's authority to operate this equipment.

#### FCC Statement

This equipment complies with Part 15 of the FCC Rules. Operation is subject to the following two conditions:

- (1) This device may not cause harmful interference, and
- (2) This device must accept any interference received, including interference that may cause undesired operation.

NOTE: This equipment has been tested and found to comply with the limits for a Class B digital device, pursuant to part 15 of the FCC rules. These limits are designed to provide reasonable protection against harmful interference in a residential installation. This equipment generates, uses and can radiate radio frequency energy and, if not installed and used in accordance with the instructions, may cause harmful interference to radio communications.

However, there is no guarantee that interference will not occur in a particular installation. If this equipment does cause harmful interference to radio or television reception, which can be determined by turning the equipment off and on, the user is encouraged to try to correct the interference by one or more of the following measures:

- Reorient or relocate the receiving antenna.
- Increase the separation between the equipment and receiver.
- Connect the equipment into an outlet on a circuit different from that to which the receiver is connected.
- Consult the dealer or an experienced radio/TV technician for help.

#### FCC Radiation Exposure Statement:

The device has been evaluated to meet general RF exposure requirement.

The device can be used in the portable exposure condition without restriction.



This device complies with Industry Canada licence-exempt RSS standard(s).

Operation is subject to the following two conditions: (1) This device may not cause interference, and (2) This device must accept any interference, including interference that may cause undesired operation of the device.

- French:

Le présent appareil est conforme aux CNR d'Industrie Canada applicables aux appareils radio exempts de licence. L'exploitation est autorisée aux deux conditions suivantes:

- (1) l'appareil ne doit pas produire de brouillage, et
- (2) l'utilisateur de l'appareil doit accepter tout brouillage radioélectrique subi, même si le brouillage est susceptible d'en compromettre le fonctionnement.

The device has been evaluated to meet general RF exposure requirement.

The device can be used in portable exposure condition without restriction.

le dispositif a été évalué à satisfaire l'exigence générale de l'exposition aux rf.

l'appareil peut être utilisé dans des conditions d'exposition portatif sans restriction.



Specifications are subject to change without notice.  
2024 © Philips and the Philips Shield Emblem are registered trademarks of Koninklijke Philips N.V. and are used under license. This product has been manufactured by and is sold under the responsibility of MMD Hong Kong Holding Limited or one of its affiliates, and MMD Hong Kong Holding Limited is the warrantor in relation to this product.

TAZ4300\_10\_UM\_V1.0

