



SMD CERAMIC ANTENNA

Data Sheet

HZ3215WA01

CA-2450-31-SE

For 2400-2484MHz
3.2x1.6mm [EIA1206]

■ FEATURES

- Light weight,compact
- Wide bandwidth,lowcost
- Built-in antenna with high gain

■ APPLICATIONS

- Bluetooth
- IEEE802.11g/b
- Zigbee systems,etc...

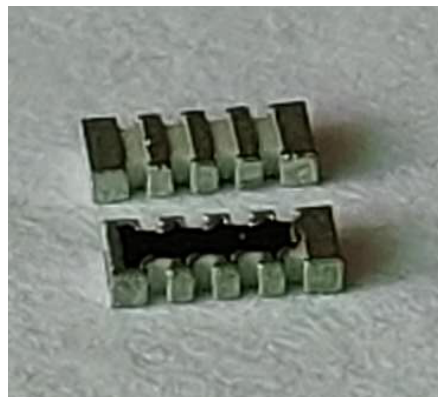

■ SHAPES AND DIMENSIONS Dimensions in mm

[Top view]

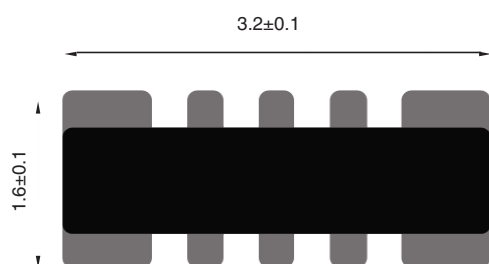

[Bottom view]

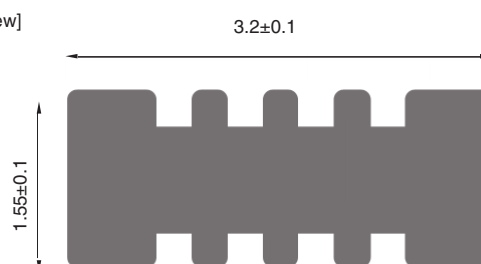

[Side view]

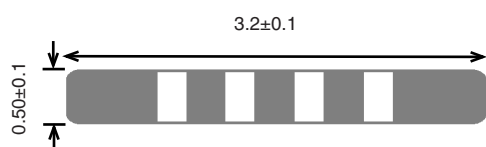

■ RECOMMENDED LAND PATTERN



Dimensions in mm

■ OLDER RESIST PATTERN

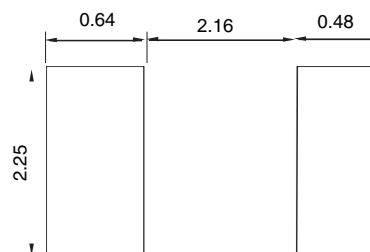

Dimensions in mm



ELECTRIC SPECIFICATIONS

Product type	CA-2450-31-SE
Center Frequency Range	2450MHZ
Peak Gain	1.7dBi
Input Impedance	50 Ω

PART NUMBERING SYSTEM

CA	-	2450	-	31	-	SE
Material		Frequency		Size		Series

■ **EVALUATION BOARD**

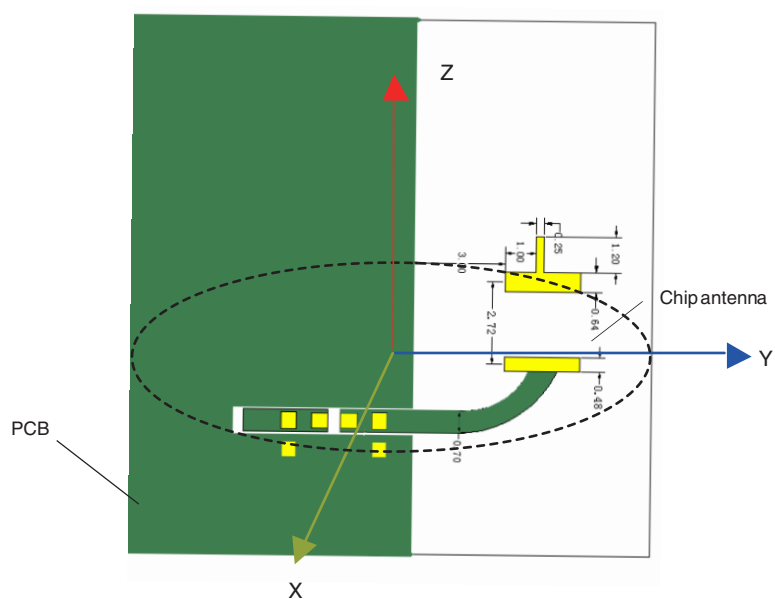
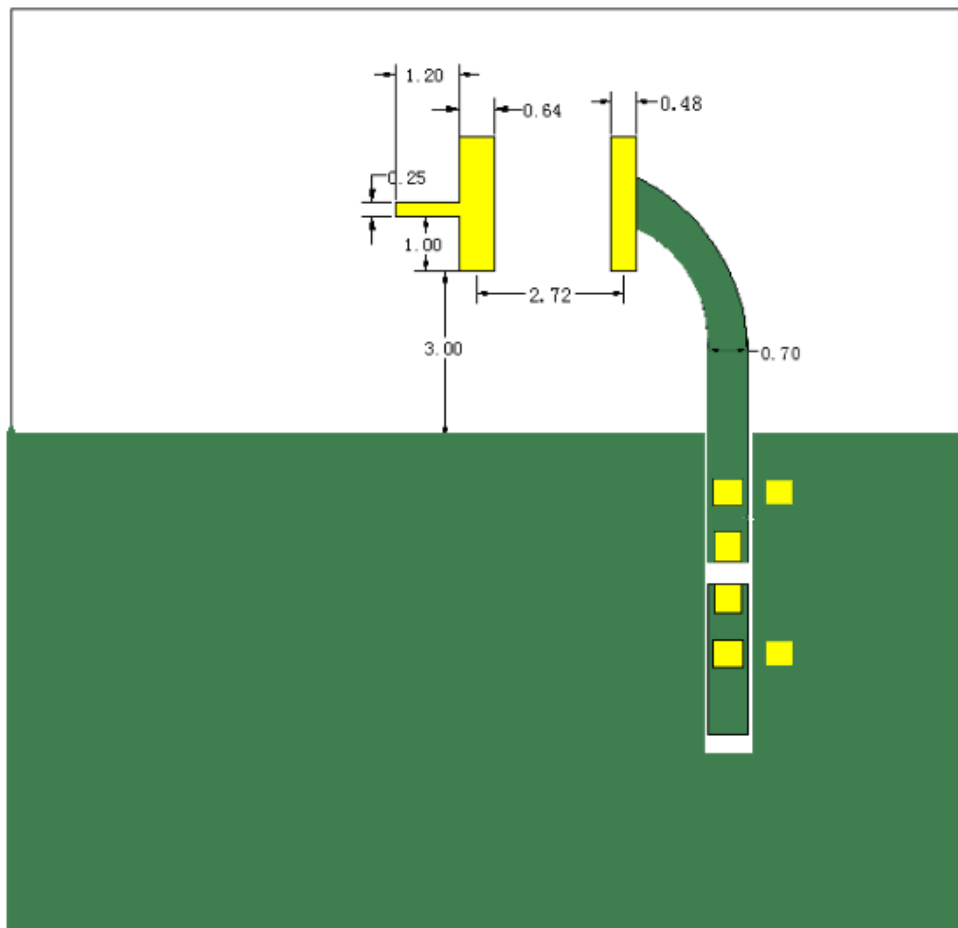

■ RADIATION PATTERNS

■ 2.4GHz WLAN BAND

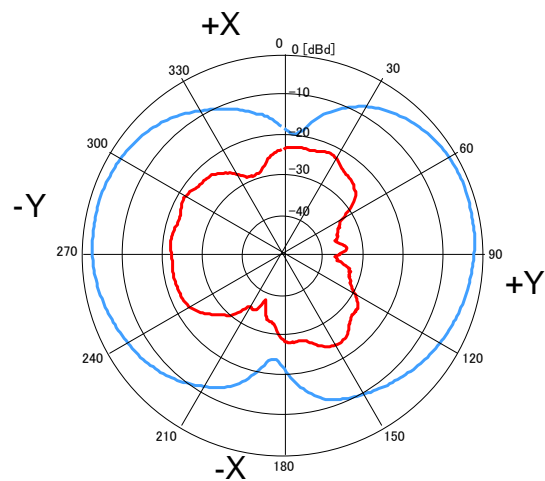
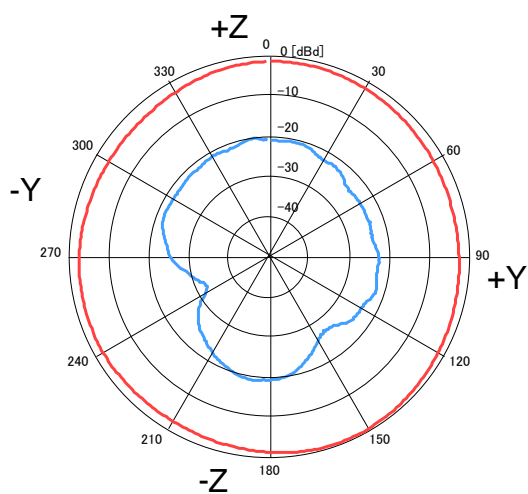

■ FREQUENCY CHARACTERISTICS

□ EFFICIENCY AND VSWR

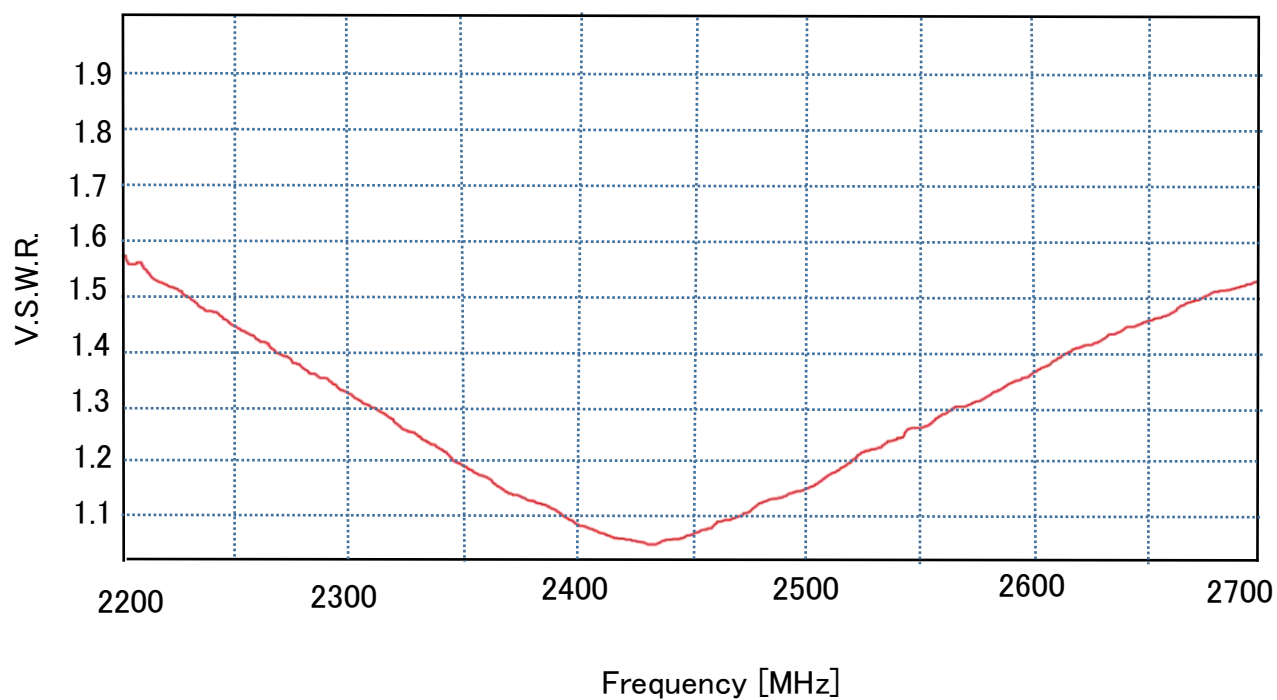

■ **RECOMMENDED REFLOW PROFILE**

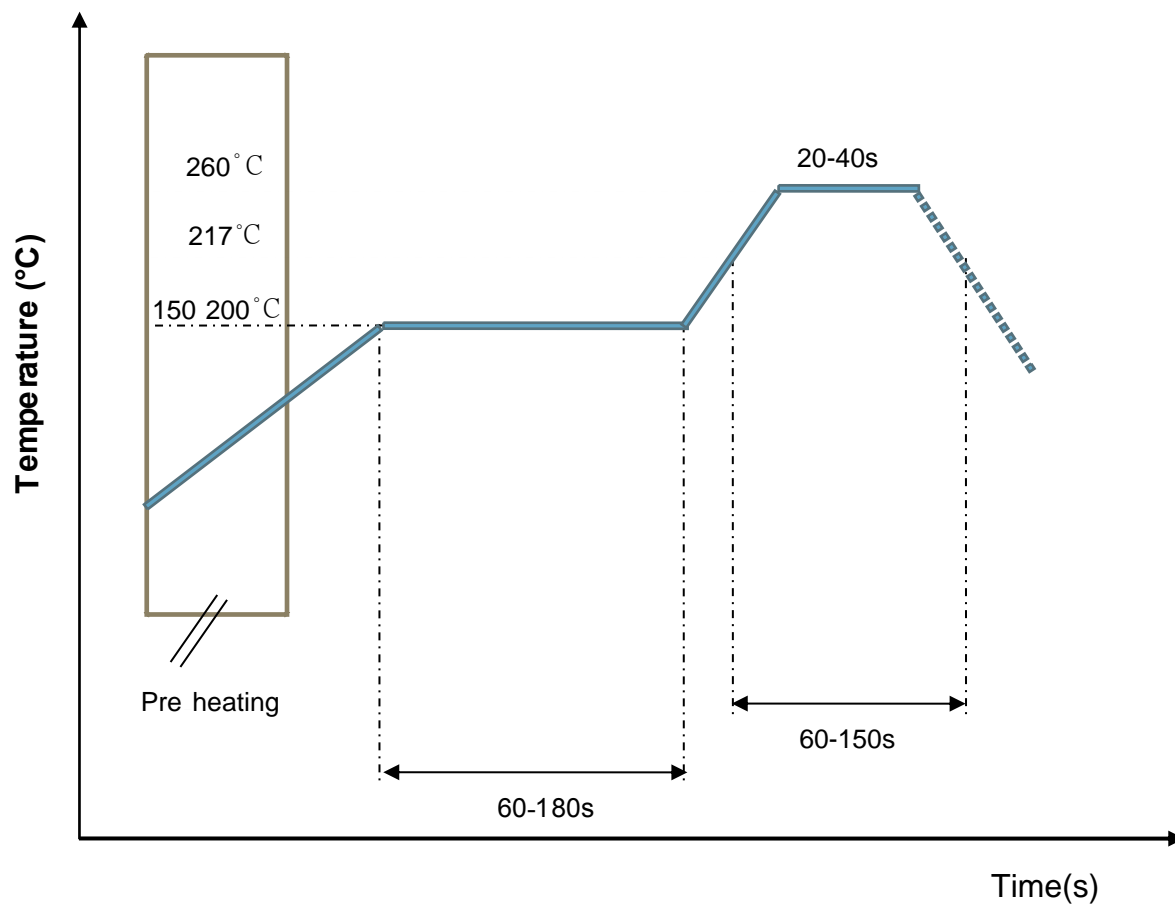

■ PACKAGING STYLE

□ REEL DIMENSIONS

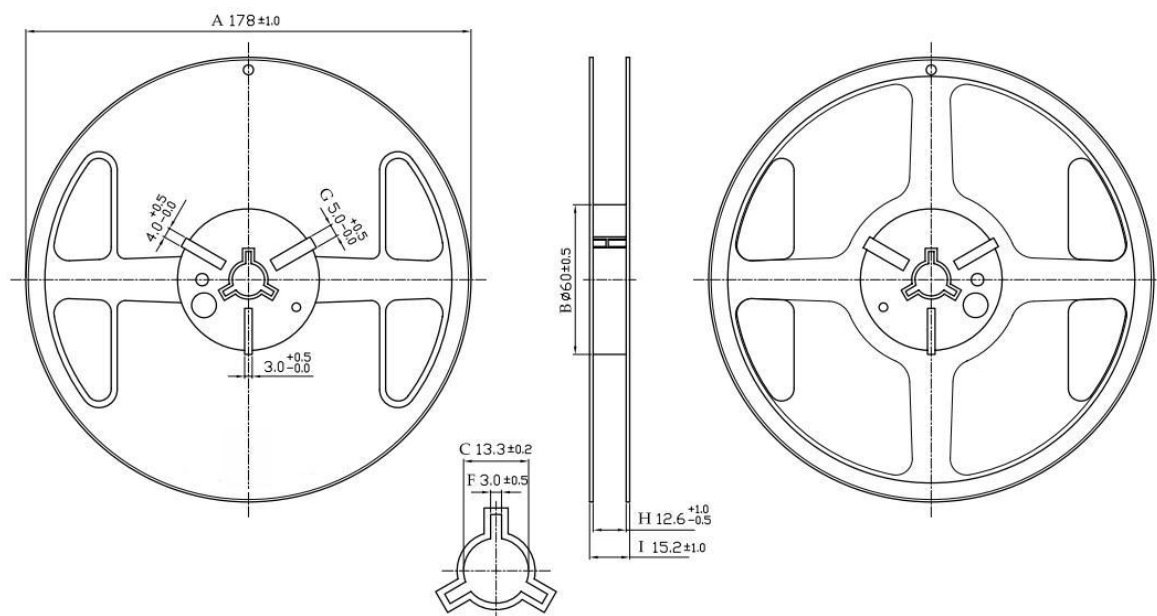

□ TAPE DIMENSIONS

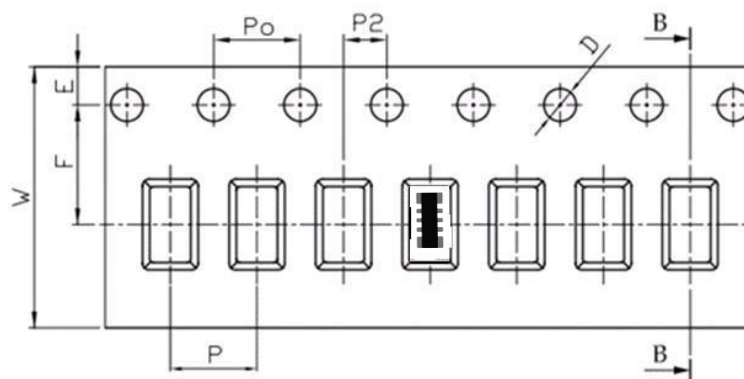

Feature	Specifications	Tolerances
W	12.00	±0.30
P	4.00	±0.10
E	1.75	±0.10
F	5.50	±0.10
P2	2.00	±0.10
D	1.50	+0.10 -0.00
P0	4.00	±0.10
10P0	40.00	±0.20

Typing Quantity: 5000 pieces per 7" reel