

4.65 inches

6.5 inches

# Retro Speaker

Wireless Portable Design

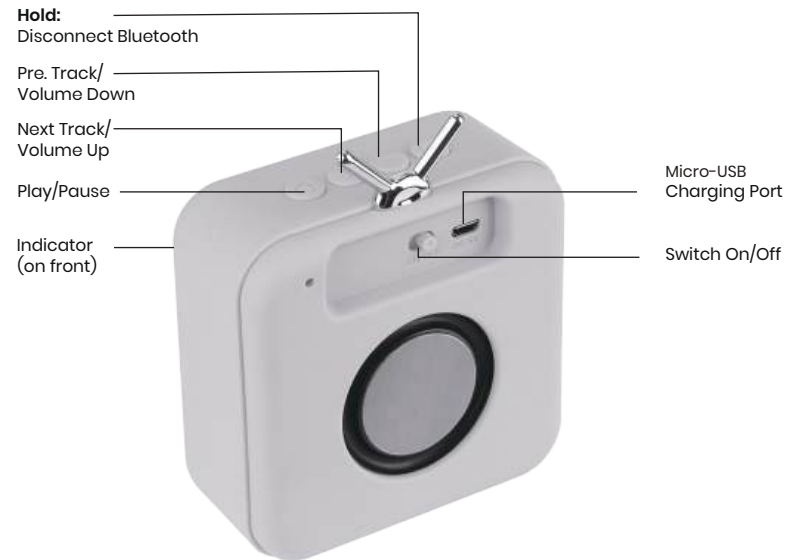

## Whats Included:

- Wireless Speaker
- Micro-USB to USB-A Charging Cable

## Indicator:

- Solid Red – Charging
- No Red Light – Fully Charged
- Flashing Blue – Pairing Mode/Play Music
- Solid Blue – Bluetooth Connected
- Bing Bong Tone – Power On
- Double Beeps – Ready to Pair
- Electric Tone – Paired
- Double Dial Beeps – Low Battery
- Double beeps followed by a descending chime – Disconnect

## Pairing:

- Switch the speaker to on, the indicator on front flashes blue when ready to pair.
- Use Bluetooth settings on your phone to pair with **Speaker 02**
- Blue light turns solid followed by a chime – pairing successful.

## Charging:

- Full charge requires approximately 4 hours.
- Using the Micro-USB cable provided, plug Micro-USB end into speaker and USB-A end into a USB power supply of at least DC 5V 1A **warning:** please use UL compliant power supply.
- The indicator light will turn red when charging, the indicator light will turn off when charging is complete.

## Troubleshooting:

- If the speaker is not working correctly, turn it on/off to reset.
- If the speaker won't turn on, recharge the battery and try again.
- If the speaker won't charge, make sure the supply works, is 5V 1A, and not damaged.
- If the speaker makes no sound or does not show as an available device, make sure it is not paired with another device, if so unpair the device and repair the desired device.

## Safety:

- Do not modify or repair this device.
- Do not use in high temperatures or extreme weather.
- Do not use chemical detergents to clean your device, use a soft dry cloth.

SAVE THESE INSTRUCTIONS

FCC ID:2A023-BTSP10 Model: BTSP10 Input: 5V  $\pm$  1A Made in China

This device complies with part 15 of the FCC Rules. Operation is subject to the following two conditions: 1) This device may not cause harmful interference, and 2) this device must accept any interference received, including interference that may cause undesired operation. Warning: Changes or modifications to this unit not expressly approved by the party responsible for compliance could void the user's authority to operate the equipment.

NOTE: This equipment has been tested and found to comply with the limits for a Class B digital device, pursuant to Part 15 of the FCC Rules. These limits are designed to provide reasonable protection against harmful interference in a residential installation. This equipment generates, uses and can radiate radio frequency energy and, if not installed and used in accordance with the instructions, may cause harmful interference to radio communications.

However, there is no guarantee that interference will not occur in a particular installation. If this equipment does cause harmful interference to radio or television reception, which can be determined by turning the equipment off and on, the user is encouraged to try to correct the interference by one or more of the following measures:

- Reorient or relocate the receiving antenna.
- Increase the separation between the equipment and receiver.
- Connect the equipment into an outlet on a circuit different from that to which the receiver is connected.
- Consult the dealer or an experienced radio/TV technician for help.

The device has been evaluated to meet general RF exposure requirements. The device can be used in portable exposure conditions without restriction.

7157 Shady Oak Rd., Eden Prairie MN 55344 Distributed by Chug, Inc.

For qualified repair specialists requesting repair information and parts please contact the original manufacturer at [customersupport@gemsfindyours.com](mailto:customersupport@gemsfindyours.com)



FRONT

BACK