

SAFE PETS
PetSafe
HAPPY PEOPLE

NEW

Teach & Treat
Remote Reward Trainer





Any Size Dog
3+ Months



Reward-Based
Training



Scan for details

Teach your dog new behaviors
with this versatile training tool

SAFE PETS
PetSafe
HAPPY PEOPLE

NEW

Teach & Treat
Remote Reward Trainer





Any Size Dog
3+ Months



Reward-Based
Training



Expert Training
Content



Scan for details

Teach your dog new behaviors
with this versatile training tool

SAFE PETS
PetSafe
HAPPY PEOPLE

Teach & Treat
Remote Reward Dog Trainer

One training tool. Limitless potential.

Teach basic commands
Train for skills like sit, stay and more complex behaviors by rewarding your dog for responding to commands.

Encourage calm behavior
Prevent jumping, begging, bolting and more by rewarding your dog for remaining calm in stimulating situations.

Reduce excessive barking
Train your dog to bark less by rewarding him for staying quiet in situations where he's normally vocal.



SAFE PETS
PetSafe
HAPPY PEOPLE

Teach & Treat
Remote Reward Trainer

We're here to help!



U.S.-Based
Customer Care
1-800-732-2677
petsafe.com

Radio Systems Corporation
10427 PetSafe Way
Knoxville, TN 37932 USA

For a list of patents protecting this product, please visit:
<https://www.radiosystemscorporation.com/patents>

Made in China

This package may contain Lithium Batteries.
Perchlorate Material – special handling may apply.
See www.dhs.gov/hazardouswaste/perchlorate.



POT00-17709



7 29849 17709 3

©2022 Radio Systems Corporation
XX415-2147

SAFE PETS
PetSafe
HAPPY PEOPLE

Teach & Treat
Remote Reward Trainer

1

Dispenser lets you reward your dog instantly from up to 30 feet away

2

Handheld remote allows precise timing for consistent training

3

Adjustable target for training, games and advanced activities

4

Dispenser holds up to 3 cups of kibble or treats

5

Removable treat tray liner is dishwasher safe

6

Small or large-sized kibble can be used with interchangeable food disks.





Expert Training Content

The Teach & Treat is more than just a handy training tool. With a complete selection of comprehensive video and illustrated training guides created by experts, you'll have everything you need for a lifetime of fun, effective, reward-based training with your dog.

SAFE PETS
PetSafe
HAPPY PEOPLE

Teach & Treat
Remote Reward Trainer

Build a better bond with your best friend

Whether you're a first-time pet parent or a seasoned pro, the Teach & Treat will give you the tools, knowledge and ability to train your dog more effectively.

You will become a more confident trainer and your dog will become better-behaved as your relationship becomes stronger than ever.

Training based on how your dog really learns

Reward-based training uses your food-motivated dog's desire for treats.

With the remote, you can consistently deliver treats without having to be next to your dog.

Turn every mealtime into a thorough training session, or train using treats for fast, focused lessons.

The adjustable target and tone settings make learning a multi-sensory experience for your dog.



Get Started!



Discover our full
training course online



FPO

What you have

Teach & Treat

Remote Reward Trainer

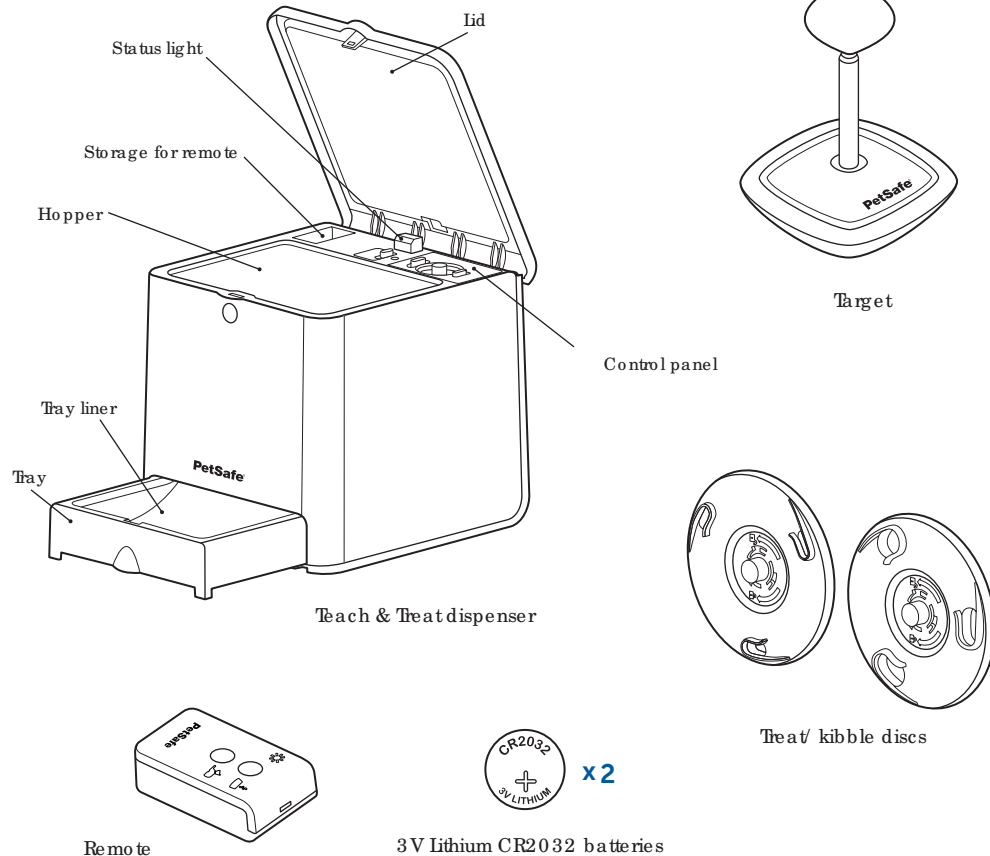

What you need

- 4 D-cell alkaline batteries
- Dry or semi-moist treats or kibble
- Phillips (cross head) screwdriver

How it works

The Teach & Treat is a reward system that reinforces good behavior by remotely dispensing dry treats/kibble at the push of a button. It can be used with or without an audible tone and also has a Fixed/Variable setting for the treats/kibble. The system is very effective in stopping problem behaviors such as begging and jumping on guests and teaching calm behaviors such as Down/Stay.

Nutritionally balanced diet for your dog

It is important that your dog is already on a nutritionally balanced feeding program before you begin using the Teach & Treat. If you are using dry dog food/kibble, ensure it is the correct size and can be used in the Teach & Treat for training.

Note: If you free feed your dog and he shows no interest in the kibble from the Teach & Treat, change to specific meal feeding times during the day while training with the Teach & Treat. This should make the dispensed kibble more enticing. If you use treats instead of kibble, your training sessions should be extended over a longer period, and the total calorie intake should be subtracted from your dog's daily intake of food. For most dogs, treats should make up less than 10% of a dog's daily food intake.