

- Circle View: logi.com/circleviewcamera/support
- Apple HomeKit: apple.com/ios/home

© 2019 Logitech, Logi and the Logitech Logo are trademarks or registered trademarks of Logitech Europe S.A. and/or its affiliates in the U.S. and other countries. Apple, the Apple logo, Apple HomeKit, iOS and iCloud are trademarks of Apple Inc., registered in the U.S. and other countries. App Store is a service mark of Apple Inc. Use of the Works with Apple HomeKit badge means that an accessory has been designed to work specifically with the technology identified in the badge and has been certified by the developer to meet Apple performance standards. Apple is not responsible for the operation of this device or its compliance with safety and regulatory stands. All other trademarks are the property of their registered owners. Logitech assumes no responsibility for any errors that may appear in this manual. Information contained herein is subject to change without notice.

© 2019 Logitech, Logitech, Logi et le logo Logitech sont des marques commerciales ou déposées de Logitech Europe S.A. et/ou de ses sociétés affiliées aux États-Unis et dans d'autres pays. Apple, le logo Apple, Apple HomeKit, iOS et iCloud sont des marques d'Apple Inc., déposées aux États-Unis et dans d'autres pays. App Store est une marque de service d'Apple Inc. L'utilisation du logo Works with Apple HomeKit indique qu'un accessoire a été conçu pour fonctionner spécifiquement avec la technologie identifiée sur le logo et que le fabricant certifie qu'il respecte les normes de performances d'Apple. Apple n'est pas responsable du fonctionnement de ce dispositif ou de sa conformité aux normes de sécurité et réglementaires. Toutes les autres marques déposées sont la propriété exclusive de leurs détenteurs enregistrés. Logitech décline toute responsabilité en cas d'erreurs susceptibles de s'être glissées dans le présent manuel. Les informations énoncées dans ce document peuvent faire l'objet de modifications sans préavis.

620-009561 002

CIRCLE VIEW

Camera | Cámara | Cámara | Câmera

Setup | Installer | Preparar | Instalação

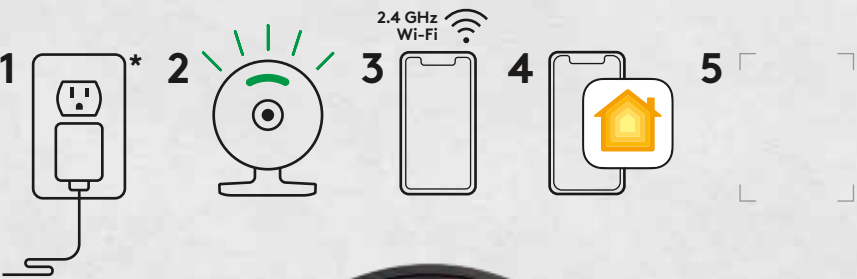

logitech®

Mounting and orientation Fixation et orientation Montaje y orientación Montagem e orientação

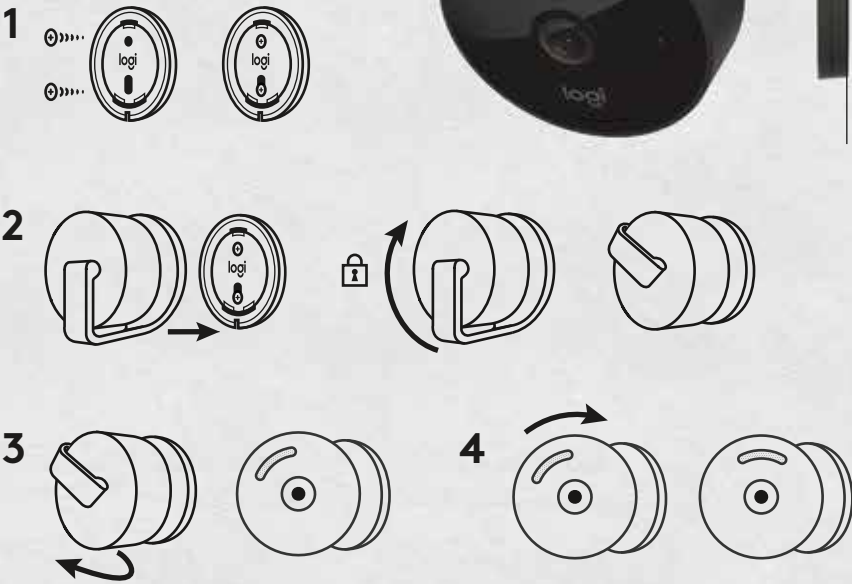

- * Installation guidance**
WARNING: The power supply is for INDOOR USE ONLY.
- * Conseils d'installation**
ATTENTION - Le boîtier d'alimentation est conçu EXCLUSIVEMENT POUR UNE UTILISATION EN INTÉRIEUR
- * Guía de instalación**
ADVERTENCIA - La fuente de alimentación es para USO SÓLO EN INTERIORES
- * Orientação de instalação**
AVISO - O sistema de alimentação deve ser usado apenas DENTRO DE CASA



Tilt to hide from view
Inclinez pour cacher la vue
Inclina para ocultarte de la vista
Incline para ocultá-la

Turn off | Mise hors tension | Apaga | Desligar



Resetting Camera | Réinitialisation de la caméra | Restablecimiento de la cámara | Redefinindo a câmera

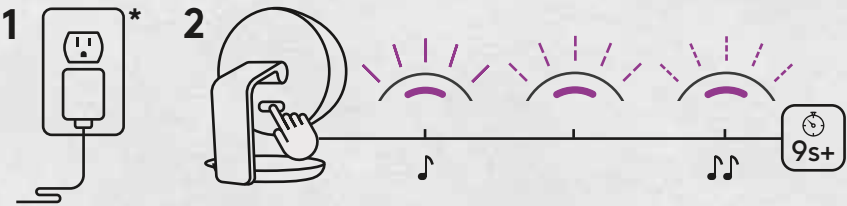

English

Read Manual Before Product Use.



POWER SUPPLY WARNING! The power supply is for INDOOR USE ONLY. Do not install the power supply outdoors. Only use the power supply included with your product. Do not attempt to repair or use a damaged power supply. Do not immerse the power supply in water or subject it to physical abuse. Inspect the power supply regularly for cable, plug, and casing damage.

Safe Usage Guidelines for Products

- Do not open or modify the product.
- Do not disassemble or attempt to service this product.
- If product is operating improperly, please contact Logitech support.
- Product must be returned to the manufacturer for any service or repair.
- Plug equipment in an indoor outlet that complies with national/local electrical wiring rules.
- For pluggable equipment, the socket-outlet shall be installed near the equipment and shall be easily accessible.
- This is not a Children's Product and is not intended for use by children under 14 years old.
- Warning: Not suitable for children under 36 months. Small parts. Choking hazard.
- Mount camera properly. Improperly mounted camera may fall and cause injury.

Logitech Compliance: For Product Safety, EMC, RF and Energy information, go to www.logitech.com/compliance. Maintenance is not required for product compliance.

This product complies with relevant legal requirements for Restriction of Hazardous Substances (RoHS) and management of waste electronic and electrical equipment (WEEE) in the EU, Turkey, Ukraine, United Arab Emirates, India, China and Taiwan. For RoHS and WEEE information, go to www.logitech.com/compliance.



Batteries, electronic and electrical equipment should not be disposed of with household waste. Wherever possible, they should be segregated and brought to an appropriate collection point to enable recycling and avoid potential impacts on the environment and human health. For more information, contact your local authorities or place of purchase, or visit www.logitech.com/recycling.

****If a Mobile Camera product does not have the product functions listed above,
please contact the Compliance team for a different IID.****

Legal Warning

Certain uses of camera products and audio devices, such as employee monitoring, surreptitious viewing and recording of images and/or audio, or the use, publication or distribution of image and/or audio recordings, are prohibited or restricted by country, state and local laws.

Be sure to comply with the laws in your country, state, and locality when using Logitech Alert products and services.

FCC statement

This device complies with Part 15 of the FCC Rules. Operation is subject to the following two conditions: 1) this device may not cause harmful interference, and 2) this device must accept any interference received, including interference that may cause undesired operation.

This equipment has been tested and found to comply with the limits for a Class B digital device, pursuant to part 15 of the FCC Rules. These limits are designed to provide reasonable protection against harmful interference in a residential installation. This equipment generates, uses and can radiate radio frequency energy. And, if not installed and used in accordance with the instructions, may cause harmful interference to radio communications. However, there is no guarantee that interference will not occur in a particular installation. If this equipment does cause harmful interference to radio or television reception, which can be determined by turning the equipment off and on, the user is encouraged to try to correct the interference by one or more of the following measures:

- Reorient or relocate the receiving antenna.
- Increase the separation between the equipment and receiver.
- Connect the equipment into an outlet on a circuit different from that to which the receiver is connected.
- Consult the dealer or an experienced radio/TV technician for help.

Warning: Where shielded interface cables or accessories have been provided with the product or specified additional components or accessories elsewhere defined to be used with the installation of the product, they must be used in order to ensure compliance with FCC. Changes or modifications to product not expressly approved by Logitech, Inc could void your right to use or operate your product by the FCC.

CAN ICES-3 (B) / NMB-3 (B)

This device contains licence-exempt transmitter(s)/receiver(s) that comply with Innovation, Science and Economic Development Canada's licence-exempt RSS(s). Operation is subject to the following two conditions: (1) This device may not cause interference. (2) This device must accept any interference, including interference that may cause undesired operation of the device.

Radiation Exposure Statement: This equipment complies with FCC and Industry Canada's RF exposure limits set forth for an uncontrolled environment. This equipment should be installed and operated with minimum distance 20cm between the radiator & your body. This transmitter must not be co-located or operating in conjunction with any other antenna or transmitter.

Logitech Limited Hardware Product Warranty – A Summary

Logitech warrants that its hardware product shall be free from defects in materials and workmanship for the length of time identified on your product package beginning from the date of the original retail purchase. See support.logitech.com for specific warranty information about your product and procedures to act on a warranty claim.

Logitech's entire liability and your exclusive remedy for any breach of warranty shall be, at Logitech's option, to repair or replace a functional equivalent of the product, or to refund the price paid, if the hardware is returned to the point of purchase or such other place as Logitech may direct along with a

****If a Mobile Camera product does not have the product functions listed above,
please contact the Compliance team for a different IID.****

receipt. Warranty protections are in addition to rights provided under local consumer laws and may vary among countries. See full warranty information to know your consumer rights and the additional protections provided by this product warranty.

Logitech Address: Logitech, Inc., 7700 Gateway Blvd. Newark, California 94560.

Full Warranty Information: support.logitech.com

[To be included in Mexico section ONLY:]

Mexico Statement:

La operación de este equipo está sujeta a las siguientes dos condiciones: (1) es posible que este equipo o dispositivo no cause interferencia perjudicial y (2) este equipo o dispositivo debe aceptar cualquier interferencia incluyendo la que pueda causar su operación no deseada.

For Mexico Consumers Only: Logitech de Mexico S.A. de C.V. via Antiguo Camino a la Lumbrera s/n Parcelas 51y 52, Edificio Mezquite 111 Col. San Martin Obispo Cuautitlán Izcalli, Edo. De México C.P. 54769 México. Teléfono: 01-800-800-4500.

[To be included in Brazil section ONLY:]

Brazil Statement:

Este equipamento não tem direito à proteção contra interferência prejudicial e não pode causar interferência em sistemas devidamente autorizados.

For Brazil Consumers Only: Esta ligação é gratuita -- 0800.761.8787

[To be included in Brazil section ONLY - If product includes a speakerphone, include the following:]



Warning! Exposure to noise above 85 decibels for long periods may cause hearing damage. Protect your hearing by establishing safe volumes.

****If a Mobile Camera product does not have the product functions listed above,
please contact the Compliance team for a different IID.****