

— |

| —

— |

| —

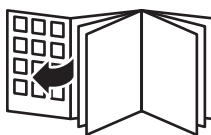

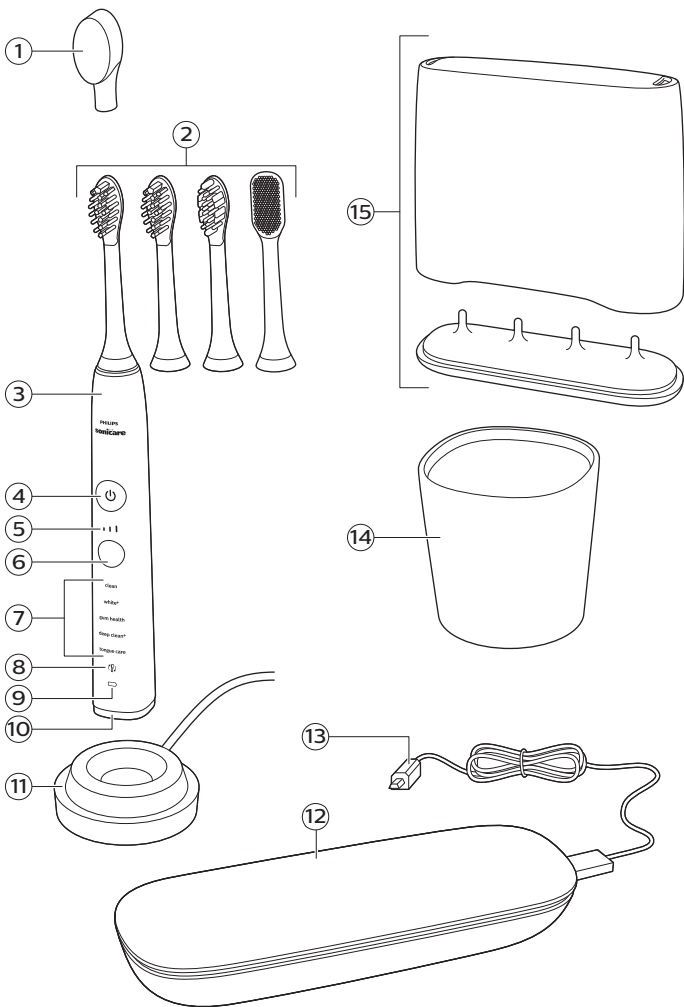

English 6

Introduction

Congratulations on your purchase and welcome to Philips! To fully benefit from the support that Philips offers, register your product at **www.philips.com/welcome** or via the Philips Sonicare app.

Important

Read this user manual carefully before you use the appliance and save it for future reference.

Danger

- Keep the charger away from water. Do not place or store it over or near water contained in a bathtub, washbasin, sink etc. Do not immerse the charger in water or any other liquid. After cleaning, make sure the charger is completely dry before you connect it to the mains.

Warning

- The mains cord cannot be replaced. If the mains cord is damaged, discard the charger.

- Always have the charger replaced with one of the original type in order to avoid a hazard.
- Do not use the charger outdoors or near heated surfaces.
- If the appliance is damaged in any way (brush head, toothbrush handle or charger), stop using it. This appliance contains no serviceable parts. If the appliance is damaged, contact the Consumer Care Centre in your country (see chapter 'Guarantee and support').

- This appliance can be used by children aged from 8 years and above and by persons with reduced physical, sensory or mental capabilities or lack of experience and knowledge if they have been given supervision or instruction concerning use of the appliance in a safe way and if they understand the hazards involved. Children shall not play with the appliance. Cleaning and user maintenance shall not be made by children unless they are older than 8 and supervised.
- In order to effectively charge your Philips Sonicare handle do not place your charger base on a magnetic metal surface.

Caution

- Do not clean the brush head, the handle or the charger in the dishwasher.

- If you have had oral or gum surgery in the previous 2 months, consult your dentist before you use the toothbrush.
- Consult your dentist if excessive bleeding occurs after using this toothbrush or if bleeding continues to occur after 1 week of use. Also consult your dentist if you experience discomfort or pain when you use the Philips Sonicare.
- The Philips Sonicare toothbrush complies with the safety standards for electromagnetic devices. If you have a pacemaker or other implanted device, contact your physician or the device manufacturer of the implanted device prior to use.
- If you have medical concerns, consult your doctor before you use the Philips Sonicare.

- This appliance has only been designed for cleaning teeth, gums and tongue. Do not use it for any other purpose. Stop using the appliance and contact your doctor if you experience any discomfort or pain.
- The Philips Sonicare toothbrush is a personal care device and is not intended for use on multiple patients in a dental practice or institution.
- Stop using a brush head with crushed or bent bristles. Replace the brush head every 3 months or sooner if signs of wear appear. Do not use other brush heads than the ones recommended by the manufacturer.

- If your toothpaste contains peroxide, baking soda or bicarbonate (common in whitening toothpastes), thoroughly clean the brush head with soap and water after each use. This prevents possible cracking of the plastic.

Electromagnetic fields (EMF)

This Philips appliance complies with all applicable standards and regulations regarding exposure to electromagnetic fields.

Radio Equipment Directive

- Radio Equipment in this product operates between 2402 – 2480 MHz
- Maximum RF power transmitted by the Radio Equipment is +3 dBm

Your Philips Sonicare (Fig. 1)

- 1 Hygienic travel cap
- 2 Brush heads
- 3 Handle
- 4 Power on/off button
- 5 Intensity light
- 6 Mode/intensity button
- 7 Mode light
- 8 Brush head replacement reminder light
- 9 Charge indicator
- 10 Light ring
- 11 Charging base
- 12 Travel case
- 13 USB cord

14 Charging glass

15 Brush head holder

Note: The content of the box may vary based on the model purchased.

Brush heads

Your Philips Sonicare comes with a range of brush heads which are designed to deliver superior results for your oral care needs.

The number and type of brush heads might change according to the toothbrush type you purchase.

- 1 Premium Clean brush head
- 2 Premium Gum Care brush head
- 3 Premium White brush head
- 4 TongueCare+ brush head (specific types only)

Smart brush head mode pairing

These brush heads are enabled with auto brush head recognition.

Via a sensor in the brush head the toothbrush recognizes the type of brush head selected and automatically sets the optimal mode and intensity settings for the best brushing experience and results. Philips Sonicare also keeps track of usage frequency for each brush head, so you will know when they need to be replaced. It is personalized brushing at its easiest and most effective.

Brushing modes

Your power toothbrush is equipped with 5 different modes to accommodate all your oral care needs (some models come with 4 brushing modes only). The following modes are available:

Clean mode

Clean is a 2-minute mode. It is recommended to be used with Premium Clean brush head. It gives you a thorough and complete clean. In order to reach optimal results, follow the instructions below.

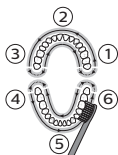

- 1 Begin brushing upper right teeth (segment 1) and brush for 20 seconds, on both the outer and inner surfaces, before you move to upper front teeth (segment 2). Continue doing this for segments 3 to 6 to ensure even brushing in all 6 segments of the mouth. You will hear a 'beep' after each 20-second interval, to indicate that you should move to the next segment.

White+ mode

White+ is a 2-minute 40-seconds mode. It is recommended to use the Premium White brush head for this mode. In order to reach optimal results, follow the instructions below.



- 1 Begin brushing the upper right teeth (segment 1) and brush for 20 seconds before you move to the upper front teeth (segment 2). Continue doing this for segments 3 to 6 to ensure even brushing in all 6 sections of the mouth.
- 2 After completing all 6 of these segments, the toothbrush switches to polishing mode automatically.

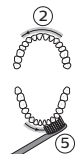

- 3 To polish your teeth, brush the outer surface of your upper teeth for 20 seconds (segment 2) and then brush the outer surface of your lower teeth for 20 seconds (segment 5). The polishing motion used in this part of the mode will feel and sound different from the first two minutes of the mode.

Gum Health mode

Gum Health is a 3-minutes 20-seconds mode. It is recommended to use the Premium Gum Care brush head for this mode. In order to reach optimal results, follow the instructions below:

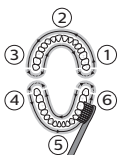

- 1 Begin brushing the upper right teeth (section 1) and brush for 20 seconds, on both the outer and inner surfaces, before you move to the upper front teeth (section 2). Continue doing this for section 3 to 6 to ensure even brushing in all 6 sections of the mouth.



- 2 Next, to take optimal care for your gums, brush the outer and inner surfaces of your upper right back teeth for 20 seconds (segment 1), then brush the outer and inner surfaces of your upper left back teeth for 20 seconds (segment 3). Continue brushing the outer and inner surfaces of your lower right back teeth for 20 seconds (segment 4), followed by another 20 seconds on the outer and inner surfaces of your lower left back teeth (segment 6). The brushing motion used in this part of the mode will feel and sound different from the first two minutes of the mode.

DeepClean+ mode

DeepClean+ mode length depends on whether or not the handle is connected to the app. In connected mode DeepClean+ runs for two minutes and provides brushpacer feedback every 20 seconds. In non-connected mode DeepClean+ runs for three minutes and provides brushpacer feedback every 30 seconds. In order to reach optimal results follow the instructions as below:

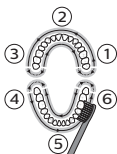

- 1 Begin brushing in the upper right teeth (section 1) and brush for 45 seconds, on both the outer and inner surfaces, before you move to the upper front teeth (section 2). Continue doing this for section 3 to 6 to ensure even brushing in all 6 sections of the mouth.

TongueCare+ mode

TongueCare+ is a 20-second mode and supposed to be used with your TongueCare+ brush head. In order to reach optimal results, follow the instructions below:

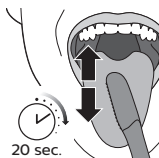

- 1 Wet the micro bristles and brush your tongue moving front to back. Clean as far back as comfortable. Rinse your mouth and repeat the procedure two more times.

Based on the brush head you attach, the mode will be selected automatically. When you change the mode, it will be remembered by the handle the next time you attach the same brush head.

Note: When the Philips Sonicare is used in clinical studies, it must be used at high intensity in the Clean mode, in White+ mode, in GumHealth mode, or in unconnected DeepClean+ mode to achieve the efficacy in plaque, stain removal, gum health or superiority (respectively).

Intensity Settings

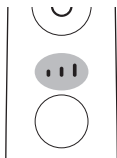

Your power toothbrush gives you the option to choose between 3 different intensity levels: low, medium, high. Based on the brush head you attach, the intensity will be selected automatically. If you wish to change to a different intensity you can do so by pressing the mode/Intensity button while brushing. For optimal results it is recommended to use the automatically chosen

intensity. The intensity cannot be changed as long as the handle is powered off or paused.

Using your Philips Sonicare

Brushing instructions



- 1 Attach your desired brush head (see 'Brush heads'). Align the brush head so the bristles point in the same direction as the front of the handle.

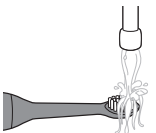

- 2 Wet the bristles.



- 3 Apply a small amount of toothpaste on the bristles.

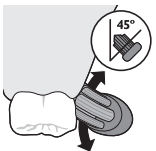

- 4 Place the toothbrush bristles against the teeth at a slight angle (45 degrees), pressing firmly to make the bristles reach the gumline or slightly beneath the gumline. A change in vibration (and a slight change in sound) and activation of the light ring alerts you when you apply too much pressure while brushing.

Note: Keep the center of the brush in contact with the teeth at all times.

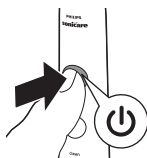

- 5 Press the power on/off button to switch on the Philips Sonicare.



- 6 Apply light pressure to maximize Philips Sonicare's effectiveness. Brush your teeth with a small back and forth motion so the bristles reach between the teeth. Continue this motion throughout the brushing cycle.

Note: The bristles should flare slightly. Do not scrub.



- 7 To clean the inside surfaces of the front teeth, tilt the brush handle semi-upright and make several vertical overlapping brushing strokes on each tooth.

Your Philips Sonicare is safe to use on:

- Braces (brush heads wear out sooner when used on braces).
- Dental restorations (fillings, crowns, veneers).

Brushpacer



The Brushpacer is an interval timer that has a short beep and pause to remind you to brush the different sections of your mouth. Depending on the brushing mode you have selected, the Brushpacer beeps at different intervals during the brushing cycle. Each brushing mode has its own sequence of sections to be brushed. (see 'Brushing modes')

Features & Accessories

- a App
- b Pressure sensor

- c Brush head replacement reminder
- d Brushpacer
- e Easy-start
- f Charging travel case/Non-charging travel case
- g Brush head holder

a. App

Your Philips Sonicare is Bluetooth enabled and allows you to achieve superior oral health care with the provided Philips Sonicare app.

Using the Philips Sonicare app will help you to improve your oral health care habits: It gives you real-time feedback while brushing, informs you if you missed any spots when brushing, tracks your brushing behavior over time and provides useful tips and tricks for your healthiest mouth ever. In order to fully benefit from your Philips Sonicare we recommend to follow these steps:

Connecting your toothbrush

- 1 When used in connected mode, the Philips Sonicare App gives you the opportunity to receive real time feedback on brushing, store and share brushing data with your dentist (if you so choose), and receive personalized coaching. If you wish to use the toothbrush in an unconnected mode, the toothbrush will still function. To use in connected mode, please follow the “connecting your toothbrush” directions below.
- 2 Download the Philips Sonicare app from the App Store or Google Play.

- 3 Confirm Bluetooth is switched on on your mobile device before you open the app. Check the settings on your mobile device to switch on Bluetooth.
- 4 To connect the toothbrush to the app, turn on the toothbrush by pressing either the power on/off button or the brushing mode button. Make sure the toothbrush is not on the charger when you switch it on.
- 5 Open the Sonicare app.
- 6 Follow the Sonicare app instructions displayed on your mobile device. The app automatically connects with the toothbrush. If the toothbrush does not connect, follow the troubleshooting steps provided in the app.

Note: For optimal data capture keep your mobile device close whilst brushing.

b. Pressure Sensor

Your Philips Sonicare is equipped with an advanced sensor that measures the pressure you apply while brushing. If you apply too much pressure, the toothbrush will provide immediate feedback to indicate that you need to reduce the pressure. The feedback is given in two different ways:

- 1 You experience a change in vibration and therefore brushing sensation.
- 2 The pressure warning light of the light ring will light up purple.

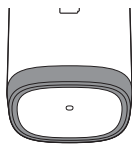

If you receive feedback that tells you that you apply too much pressure, reduce the pressure, the light will turn off and the brushing sensation will adjust to the original sensation.

Activating or deactivating the pressure sensor

- 1 Place the handle, with a brush head attached, in the plugged-in charger.
 - Pressure sensor is enabled by holding the routine/intensity button and by pressing the power button twice while on a charger.
 - Pressure sensor is disabled by holding the routine/intensity button and by pressing the power button twice while on a charger.

c. Brush head replacement reminder

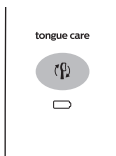

When it is time to replace your brush head, you will be notified by your handle: after brushing you will hear a beeping tone. Also the brush head replacement reminder icon and the light ring will start flashing amber. The amber light will remain until you replace your brush head. In addition you will receive repeatedly audible reminders with increasing frequency. If you wish to disable this feature for your current brush head, follow the instructions below.

Activating or deactivating the brush head replacement reminder

- 1 Place the handle in the plugged-in charger.
 - Brush head replacement reminder is enabled by holding the routine/intensity button and by pressing the power button three times while on the charger.
 - Brush head replacement reminder is disabled by holding the routine/intensity button and by pressing the power button three times while on the charger.

Once you replace your brush head, this feature will automatically be re-enabled.

d. Brushpacer



The brushpacer is an interval timer that has a short beep and pause to remind you to brush the different sections of your mouth. Depending on the brushing mode you have selected (see 'Brushing modes'), the brushpacer beeps at different intervals during the brushing cycle.

e. Easy-start

The Easy-start feature gently increases the power over the first 14 brushings to help you get used to the brushing with the Philips Sonicare. The Easy-start feature works in all modes other than TongueCare+ mode. This Philips Sonicare model comes with the Easy-start feature deactivated.

Activating or deactivating the Easy-start feature

- 1 Place the handle in the plugged-in charger.
 - Easy-start is enabled by holding the routine/intensity button and by pressing the power button once while on the charger.
 - Easy start is disabled by holding the routine/intensity button and by pressing the power button once while on the charger.

Note: Using the Easy-start feature beyond the initial ramp-up period is not recommended and reduces Philips Sonicare effectiveness in removing plaque.

Note: Each of the first 14 brushings must be at least 1 minute in length to properly move through the Easy-start ramp-up cycle.

f. Travel Case (specific types only)

Your Philips Sonicare comes with a travel case to make traveling with your power toothbrush more

convenient. It is designed to accommodate the power toothbrush handle and two brush heads.

g. USB charging travel case (specific types only)

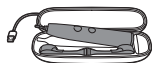

Some models come with an USB charging travel case which connects to your laptop via USB or can be plugged into a wall socket -which allows you to charge your Philips Sonicare when traveling. For information about charging your Philips Sonicare with the travel case, see 'Battery status and charging'.

h. Brush head holder (specific types only)

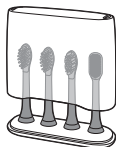

The brush head holder is designed to keep and store your brush heads.

Battery Status & Charging

Charging with glass (specific types only)

Follow these steps to charge your Philips Sonicare with the glass provided:

- 1 Plug the charger into a wall socket.
- 2 Place the charging glass on top of the charging base and place the handle in the glass.

The charging indicator flashes until your toothbrush is fully charged.

Charge with travel case (specific types only)

Follow these steps to charge your Philips Sonicare DiamondClean Smart with the charging travel case provided (specific types only):

- 1 Place the handle in the charging travel case.

- 2 Connect the charging travel case to a laptop, a wall-mounted USB socket or a suitable wall adapter.
- 3 The wall adapter must be a safe extra low voltage source, compatible with the electrical ratings marked on the device.
- 4 Only toothbrush model HX99 can be charged in the travel case. Other products and batteries are not compatible with the travel case.
- 5 The charge indicator flashes green until your toothbrush is fully charged.

Note: It takes about 24 hours to fully charge your Philips Sonicare. You do not have to fully charge your handle before first use, as the handle is pre-charged. However, it is recommended to fully charge it after first use.

Note: This charger is designed to properly charge only one handle at a time. This charger is not compatible with other models of Philips Sonicare.

Do not place metallic objects on the charging pad as handle charging may be affected and may cause the charger to overheat.

Cleaning

Note: Do not clean the brush head, handle, charging pad or travel case in the dishwasher.

Toothbrush handle

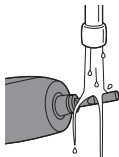

- 1 Remove the brush head and rinse the metal shaft area with warm water. Make sure you remove any residual toothpaste.

Caution: Do not push on the rubber seal on the metal shaft with sharp objects, as this may cause damage.

- 2 Wipe the entire surface of the handle with a damp cloth.

Note: Do not use isopropyl rubbing alcohol, vinegar or bleach to clean handle as this may cause discoloration.

Brush head

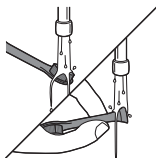

- 1 Rinse the brush head and bristles after each use.
- 2 Remove the brush head from the handle and rinse the brush head connection with warm water at least once a week.

Charger and travel case

- 1 Unplug the charger and travel case before you clean it.
- 2 Use a damp cloth to wipe the surface of the charger and travel case.

Glass and brush head holder

- 1 Clean the glass and the brush head holder with water and some washing-up liquid.
- 2 Dry them with a soft towel.

The glass and the brush head holder are dishwasher-safe.

Storage

If you are not going to use your Philips Sonicare for an extended period of time, unplug the charger from the wall socket, clean it and store it in a cool and dry place away from direct sunlight.

Locating the model number

Look on the bottom of the Philips Sonicare toothbrush handle for the model number (HX9383, HX9343, HX9333).

Recycling



- This symbol means that this product shall not be disposed of with normal household waste (2012/19/EU).



- This symbol means that this product contains a built-in rechargeable battery which shall not be disposed of with normal household waste (2006/66/EC). We strongly advise you to take your product to an official collection point or a Philips service centre to have a professional remove the rechargeable battery.
- Follow your country's rules for the separate collection of electrical and electronic products and rechargeable batteries. Correct disposal helps prevent negative consequences for the environment and human health.

Removing the rechargeable battery

Warning: Only remove the rechargeable battery when you discard the appliance. Make sure the battery is completely empty when you remove it.

To remove the rechargeable battery, you need a towel or cloth, a hammer and a flat-head (standard) screwdriver. Observe basic safety precautions when you follow the procedure outlined below. Be sure to protect your eyes, hands, fingers, and the surface on which you work.

- 1 To deplete the rechargeable battery of any charge, remove the handle from the charger, turn on the Philips Sonicare and let it run until it stops. Repeat this step until you can no longer turn on the Philips Sonicare.

26 English



- 2** Remove and discard the brush head. Cover the entire handle with a towel or cloth.

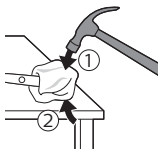

- 3** Hold the top of the handle with one hand and strike the handle housing 0.5 inch above the bottom end. Strike firmly with a hammer on all 4 sides to eject the end cap.

Note: You may have to hit on the end several times to break the internal snap connections.

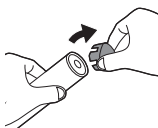

- 4** Remove the end cap from the toothbrush handle. If the end cap does not release easily from the housing, repeat step 3 until the end cap is released.

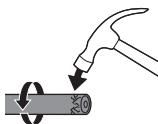

- 5** Holding the handle upside down, press the shaft down on a hard surface. If the internal components do not easily release from the housing, repeat step 3 until the internal components are released.

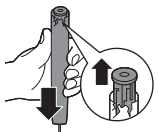

- 6** Remove the rubber battery cover.

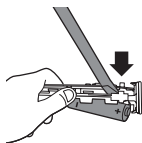

- 7 Wedge the screwdriver between the battery and the black frame at the bottom of the internal components. Then pry the screwdriver away from the battery to break the bottom of the black frame.

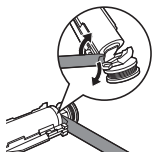

- 8 Insert the screwdriver between the bottom of the battery and the black frame to break the metal tab connecting the battery to the green printed circuit board. This will release the bottom end of the battery from the frame.

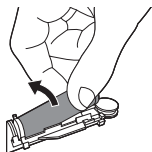

- 9 Grab the battery and pull it away from the internal components to break the second metal battery tab.

Caution: Be aware of the sharp edges of the battery tabs so as to avoid injury to your fingers.



- 10 Cover the battery contacts with tape to prevent any electrical short from residual battery charge. The rechargeable battery can now be recycled and the rest of the product discarded appropriately.

Warranty and support

If you need information or support, please visit **www.philips.com/support** or read the international warranty leaflet.

Guarantee restrictions

The terms of the international warranty do not cover the following:

- Brush heads.

28 English

- Damage caused by use of unauthorized replacement parts.
- Damage caused by misuse, abuse, neglect, alterations or unauthorized repair.
- Normal wear and tear, including chips, scratches, abrasions, discoloration or fading.

— |

| —

— |

| —

— |

| —

— |

| —



www.philips.com/Sonicare

©2016 Koninklijke Philips N.V. (KPNV). All rights reserved.

Philips and the Philips shield are trademarks of KPNV.

Sonicare and the Sonicare logo are trademarks

of Philips Oral Healthcare, LLC and/or KPNV.

©2016 Koninklijke Philips N.V. (KPNV). Tous droits réservés.

Philips et le blason Philips sont des marques de commerce de KPNV.

Sonicare et le logo Sonicare sont des marques de commerce

de Philips Oral Healthcare, LLC et (ou) KPNV.

4235.021.2500.1 (10/2016)



>75% recycled paper

>75% papier recyclé