

UBPet

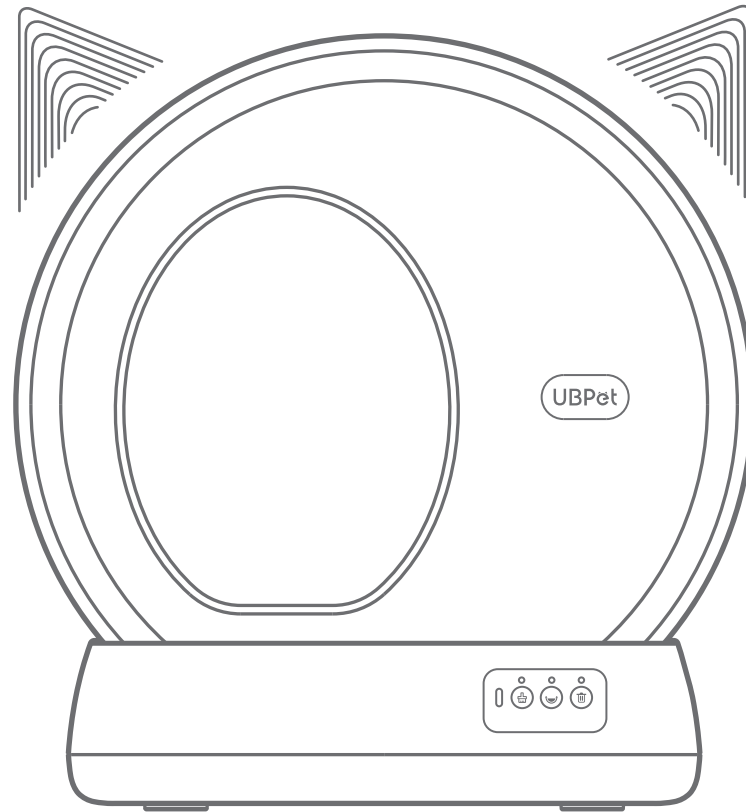

Smart Cat Litter Box

Please read this manual carefully before using the product and store it properly

Contents

Part I Important Safety Instructions / 01

Part II Product Introduction / 02

2.1 Product Structure / 02

2.2 Control Panel / 03

2.3 Status Indicators / 03

Part III Installation and Operation / 04

3.1 Setting Up / 04

3.2 Turn On / 04

3.3 Using With APP / 04

3.4 Replacing Litter Box Liner / 05

3.5 Replacing Litter / 05

3.6 Care and Cleaning / 06

Part IV Functional Parameters / 07

4.1 Operating Mode / 07

4.2 Function Details / 07

4.3 Multiple Protection Mechanism / 07

4.4 Specifications / 08

Part V Troubleshooting / 08

Part VI Warranty Terms / 09

Part I Important Safety Instructions

Read all instructions before use and save for future reference

	<p>Cat or kitten must weigh at least 3lbs and age 4 months or more to safely use the litter box.</p>
	<p>DO NOT place on carpet. Place on a firm, level surface with a little space around.</p>
	<p>DO NOT drag when moving the litter box. Move by lifting the base with both hands.</p>

Intended use

- Close supervision is necessary when any appliance is used by or near children. Children should be supervised to ensure that they do not play with, in or around the appliance.
- Use the appliance only for intended household purposes as described in this User Manual.

Electricity safety

- DO NOT operate the appliance if it has a damaged power cord or plug, or if it is malfunctioning or has been damaged in any manner.
- DO NOT use an external power supply other than the one provided with the appliance.
- DO NOT wet or submerge the bonnet or base, or allow moisture to come into contact with these parts.

- Always unplug when not in use, before putting on or taking off parts and before cleaning.

Related to use

- Always place the litter box on a firm, level surface. Avoid soft, uneven, or unstable flooring, which may affect the ability of the unit to detect your cat. If using litter mats or rugs, place in front of, or completely under, the unit. Do not place mats partially under the unit.
- Keep indoors in a cool, dry location. Reduce exposure to high temperature and humidity.
- Clean up the waste bin before replacing the litter.
- Make sure the deodorization cover is not stuck.
- DO NOT continue pushing the cover when already opened to the max.
- DO NOT sit on or place anything on top of the litter box.
- DO NOT put anything in the unit other than clumping litter or litter beads and crystals that are small enough to pass through the filter.
- DO NOT force your cat into the litter box.
- DO NOT open the top cover while the litter box is rotating.
- DO NOT attempt to disassemble, repair, modify or replace any part of your product. All servicing should be performed by qualified personnel only. No user serviceable parts inside.
- Dispose of all packaging materials properly. Keep away from children and pets.
- Always wash hands thoroughly after removing the waste. Pregnant women and those with suppressed immune systems should note that a parasite sometimes found in cat feces could cause toxoplasmosis.
- How often you will need to replace the litter box liner depends on the number and size of your cats. We recommend to replace every 3 to 5 days to avoid bacteria growth.

Part II Product Introduction

2.1 Product Structure

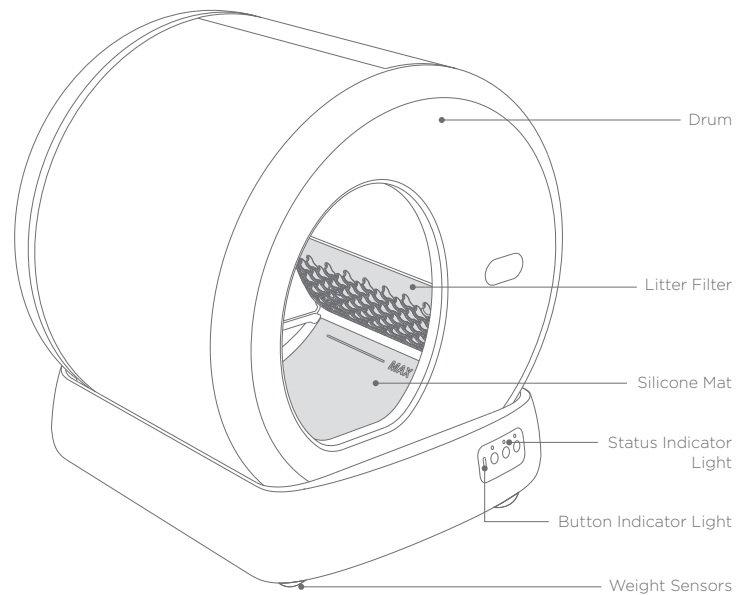
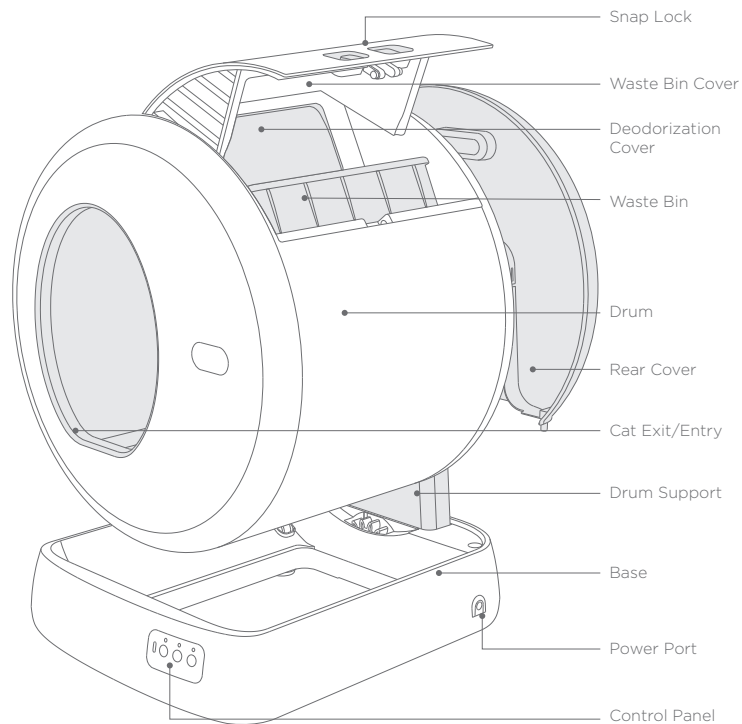

Other Accessories



1 x Power Adapter



1 x User Manual

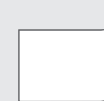

1 x Quick Start Guide

2.2 Control Panel



For all button indicators: When the selected process is engaged, the corresponding indicator stays solid on. If paused, it will flash.



Clean

- Press once to start a cleaning cycle. If already started, press it again to pause.

Set Up WiFi

- Hold for 3s to start connecting with WiFi (status indicator flashes blue).



Flatten

- Press once to start spreading the litter flat. If already started, press it again to pause.



Replace

- Hold for 3s to start emptying the litter. If already started, press it once to pause or resume.

Child Lock









- Press twice to lock or unlock (status indicator flashes green twice).



Restore to Factory Settings

- Hold  and  simultaneously for 5s to restore to factory settings.

2.3 Status Indicators

Status Indicators	Button Indicators	Function description
Solid Blue		Ready for use or working
		Firmware upgrading
	Flashing	Restoring to factory settings
Flashing Blue		Setting up WIFI
Solid Green		Cat / weight detected when stationary
Flashing Green		Drum returning to Home position
Flashing Green Twice		Child Lock on/off
Solid Red		Clean / Flatten / Replace paused
		Cat / weight detected when rotating
		Foreign object approached when rotating
		Rear cover opened
	Flashing	Drum not in place
		Motor error

Part III Installation and Operation

3.1 Setting Up



- Place the litter box indoors on a firm, level surface and in a cool, dry location. **Do not touch any walls.** Leave a little space around.

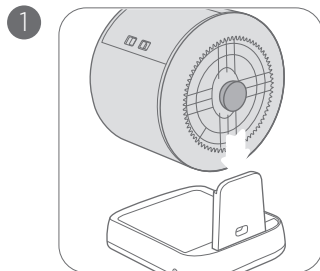

Place the drum on the base.
Note: The rotating shaft of the drum should be inserted into the slot of the base support.

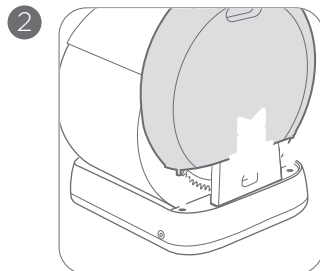

Insert the rear cover into the slot of the base.

3.2 Turn On

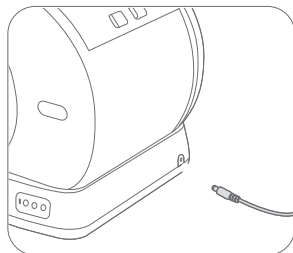

Plug in the litter box. The drum will rotate a full circle automatically. Wait for it to return to Home position, then the unit is ready for use.

Make sure the cable is not stuck in the rotating shaft.
Keep the cable away from cats.

3.3 Using With APP



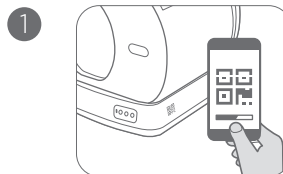

2.4GHz

- Make sure your smart device is connected to a secure 2.4GHz network and bluetooth is enabled.
- Make sure the drum is in the Home position before connecting.
- You can use your litter box with control buttons only or download APP for more customizable options.

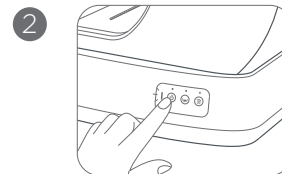

Scan QR code on the right side of the base to download APP, Register as instructed.



Hold  for 3s to bring the litter box into pairing mode (blue indicator flashing). Tap **Next** to continue.

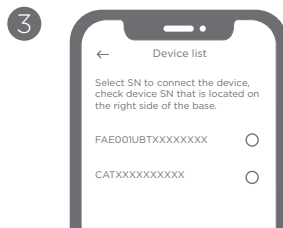

Select SN to connect the device, check device SN that is located on the right side of the base.

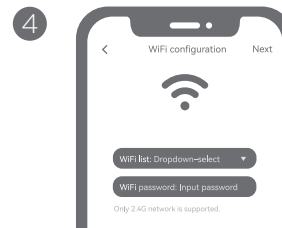

Select a 2.4GHz Wi-Fi network and enter password. Tap **Next** to complete connection.
Once successfully connected, the indicator will stay solid blue. If failed, follow the steps and retry.

3.4 Replacing Litter Box Liner



- How often you will need to replace the litter box liner depends on the number and size of your cats. We recommend to replace every 3 to 5 days to avoid bacteria growth.

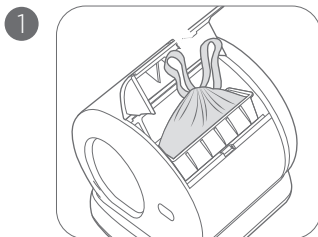

Pinch the snap lock inward to open the cover. Gather the edges of the liner and dispose. Take out the waste bin.

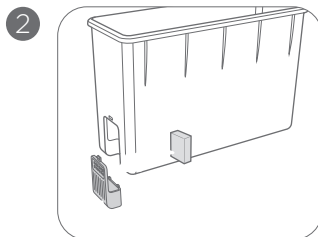

Slide out the deodorizer holder and place deodorizer in.

Note: the deodorizer needs to be purchased separately.

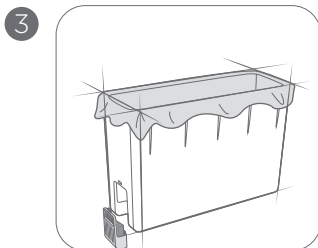

Slide the deodorizer holder back. Spread the new bag evenly inside and smooth out all edges.

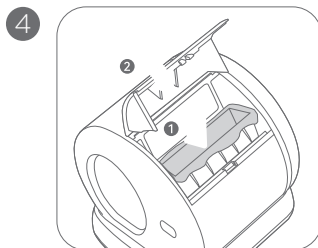

Place the waste liner back in place. Pinch the snap lock inward to lock the cover.

3.5 Replacing Litter



- **Always make sure the waste bin is empty before replacing the litter.**
- If litter replace is activated by mistake, unplug and reconnect the power supply to reset.

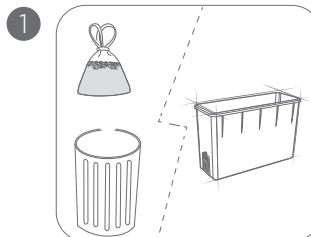

Empty and clean up the waste bin.

Then replace with a new litter box liner. Make sure the deodorization cover is not stuck.

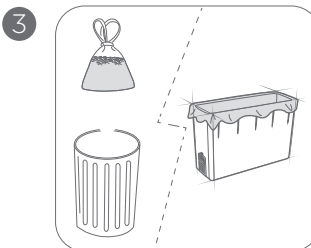

Wait until the empty cycle is done (drum stops rotating).

After the litter is emptied, clean up the waste bin. Then replace with a new liner.

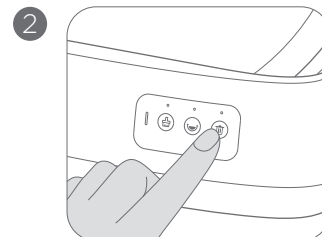

Hold for  3s to start emptying the litter. Press it once to pause if desired.



Add new clumping litter below the **MAX** fill line when spread flat. Do not overfill.

Note: clumping cat litter (length<15 mm).

3.6 Care and Cleaning



- How often you will need to clean on your personal preference and your cat's behavior. We recommend cleaning the inside every one to three months.

1

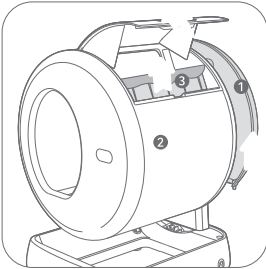

Clean up the waste bin, then unplug the litter box. Take out the rear cover first then hold to take out the drum.

2

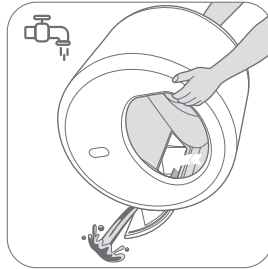

Rinse clean the drum and turn round the drum counterclockwise to drain any residual water.

3

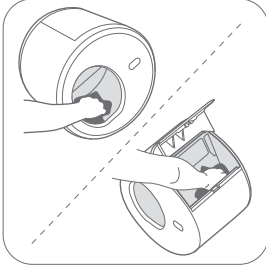

Wipe the inside of the drum and waste bin with a soft and damp cloth.

4

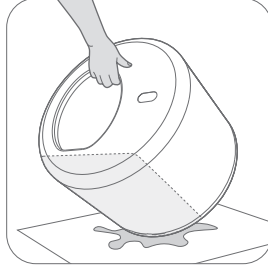

Tilt the drum to drain any residual water under the silicone pad. Air dry thoroughly before reassembling.

5

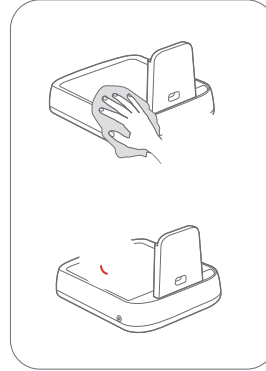

Wipe the base with a soft and damp cloth. Do not rinse or immerse in water.

6

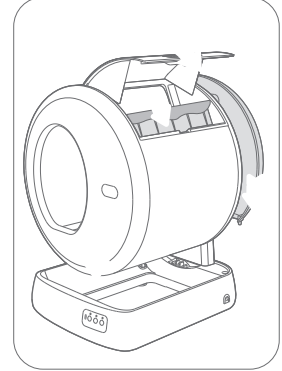

Install all parts back in place as instructed in "Setting Up" and "Replacing Litter Box Liner".

Part IV Functional Parameters

4.1 Operating Mode

Mode	Description
Automatic mode	When the cat leaves the drum, the machine will clean litter automatically according to selected time period.
Manual mode	The start, pause and automatic cleaning can be controlled via machine and App.
Timing mode	Set the time of automatic cleaning via app.
DND mode	Set no interference time period via app to avoid automatic cleaning.

4.2 Function Details

Function/Model	UCAT C10 PRO	UCAT C10
Weighing protection	●	●
Microwave radar	●	×
AI recognition	●	×
Drum's location detection	●	●
Rear cover's location detection	●	●
Anti-pinch protection	●	●
One-key litter replacement	●	●
2-step quick disassembly	●	●
Health management	●	●
Real-time view	●	×
Video recording	●	×

4.3 Multiple Protection Mechanism

Protection function	Priority	Description
Radar protection	Level 1	The radar protection is initially triggered. When something approaches, the drum stops rotating. The drum will continue to rotate if the object gets away or stay static.(only for UCAT C10 PRO)
Weighting protection	Level 2	The weighting protection will be triggered when an object more than 500g enters the drum or press the drum, the drum will stop rotating. The drum will continue to rotate if the gravity is disappearing.
Locked-motor protection	Level 3	The drum will stop rotating when the motor resistance suddenly increases during rotation, the lock-motor protection can be cancelled under human intervention.
Anti-pinch protection	Level 4	The structural design is innovative. When all sensors are abnormal and fail to work, it can still ensure that there is no risk of getting stuck.



4.4 Specifications

Product Name	Smart Cat Litter Box
Product Model	UCAT C10 PRO / UCAT C10
Main Material	PP
Product Size	520 x 530 x 555mm
Input	12V ===1A
Rated Power	12W
For Cat	Weight 3-22 lbs/ Age> 4 months
Machine Weight	9.5KG
Max Weight Capacity	44 lbs/20 kg
Waste Bin Capacity	5L/ 1.3 Gal
Applicable Litter	All clumping cat litter (length<15 mm)

Part V Troubleshooting

The troubleshooting guide addresses the most common problems. If problems persist, feel free to contact the Customer Support at aftersales@ubtrobot.com.

Q: I cannot connect the litter box with my smart device.

- A:**
- Make sure your device is connected to a secure 2.4GHz Wi-Fi network.
 - Make sure you have entered a correct Wi-Fi password and the litter box is within the signal coverage of the router.
 - Check if the litter box is connected to another device. Reset by holding  and  simultaneously for 5s and try again following the steps in "Using With APP".

Q: The drum does not rotate or stops rotating suddenly.

- A:**
- Disconnect from the power supply and remove the drum to check if there is any foreign object stuck at the gear of the base.
 - Make sure the drum is installed properly on the base. Reconnect it to the power supply and try again.
 - The drum stops rotating automatically when cat/ weight is detected or when object is approached. It will resume rotating after the cat exists, or the weight or object is removed. (only for UCAT C10 PRO)

Q: The waste cannot be cleaned.

- A:**
- Check if the deodorization cover is blocked by the litter box liner, cat litter or waste. Open the waste bin cover and remove any foreign objects.

Q: Can I use the litter box without APP?

- A:**
- Yes, you can use your litter box with control buttons only or download APP for more customizable options.

Q: I cannot weigh my cat.

- A:**
- Disconnect from the power supply and check if the litter box is placed on a firm and level surface with the four food pads at the same level.
 - Reconnect it to the power supply and weigh again.

Part VI Warranty Terms

6.1 Warranty Service

This product is provided with an after-sales warranty service according to the national Three Guarantees law. During the warranty period, if the product has performance faults not caused by human error, free maintenance will be provided after it is tested and confirmed by the UBTECH after-sales service personnel. This product is subject to the after-sales warranty service according to the national three-package law. If the product presents any non-human performance failure during the warranty period, free repair will be provided by the UBTECH after-sales service personnel following inspection and confirmation.

6.2 Warranty Period

The warranty period of the product: One year

6.3 The Warranty Scope Beyond The Warranty Period

The following cases are beyond and are not covered by the scope of warranty; however, UBTECH provides paid repair services. After the product is repaired by the paid service, UBTECH provides a 90-day warranty for the replaced parts.

- (1) When the products have exceeded their warranty period;
- (2) No warranty card or invoice is available, or the warranty card is inconsistent with the invoice information;
- (3) The contents on the Three Guarantees voucher are inconsistent with the physical identification of the product or have been altered;
- (4) Damage caused by private disassembly, private repair, repair or modification by after-sales service centers which are not authorized by Shenzhen Ubtch Robotics Corporation;
- (5) Failure or damage that is caused by the forced use of the product beyond the normal conditions of usage and non-compliant with the requirements of the Product's Operation Manual;
- (6) The damage is caused by immersion, dampness, mildew, falling or due to improper usage, such as breakage, deformation, wire fracture, crushing, etc.;
- (7) Natural aging, wear and consumption of plastic parts and other consumable materials;
- (8) Damage caused by force majeure.

6.4 Friendly Reminder

During the warranty period, consumers are provided with services in accordance with these provisions. The purchase invoice or voucher and warranty card shall be provided for maintenance. In case the purchase invoice or voucher and warranty card cannot be provided, the activation date of the product can be deemed as the purchase date, or the date after 90 days of the date of manufacture displayed by the SN number on the device can be considered as the initial date of the warranty period.

Product EU RF Information			
Intended Use/Category	802.11 b WIFI	802.11 g/n WIFI	BLE
RF output power	20dBm	20dBm	10dBm
Frequency range(MHz)	2412-2472MHz	2412-2472MHz	2402-2480MHz
Modulation	DSSS	OFDM	GFSK

FCC ID: 2AZRE-UCATC10

This device complies with Part 15 of the FCC Rules. Operation is subject to the following two conditions: (1) this device may not cause harmful interference, and (2) this device must accept any interference received, including interference that may cause undesired operation.

Any changes or modifications not expressly approved by the party responsible for compliance could void the user's authority to operate the equipment.

This equipment has been tested and found to comply with the limits for a Class B digital device, pursuant to part 15 of the FCC Rules. These limits are designed to provide reasonable protection against harmful interference in a residential installation. This equipment generates, uses and can radiate radio frequency energy and, if not installed and used in accordance with the instructions, may cause harmful interference to radio communications. However, there is no guarantee that interference will not occur in a particular installation. If this equipment does cause harmful interference to radio or television reception, which can be determined by turning the equipment off and on, the user is encouraged to try to correct the interference by one or more of the following measures:

- Reorient or relocate the receiving antenna.
- Increase the separation between the equipment and receiver.
- Connect the equipment into an outlet on a circuit different from that to which the receiver is connected.
- Consult the dealer or an experienced radio/TV technician for help.

FCC Radiation Exposure Statement

This equipment complies with FCC radiation exposure limits set forth for an uncontrolled environment.

This transmitter must not be co-located or operating in conjunction with any other antenna or transmitter.

This equipment should be installed and operated with minimum distance 20cm between the radiator & your body.



Declaration of conformity

In according with ISO/IEC 17050-1:2010

Manufacturer Name: (Or His authorized representative)	Best Epoch Technology Co.,LTD.
Manufacturer Address: (Or His authorized representative)	2201, Block C1, Nanshan I Park, No. 1001 Xueyuan Road, Nanshan District, Shenzhen City, China
Declare under our sole responsibility that the product	
Product Name:	Smart Cat Litter Box
Model:	UCAT C10 PRO, UCAT C10
Hardware version:	V1.0
Software version:	V1.0
Is in conformity with the following standards or other normative documents	
Test standards	Report number
EN IEC 55014-1:2021 EN IEC 61000-3-2:2019+A1:2021 EN 61000-3-3:2013+A1:2019 EN IEC 55014-2:2021	EED32080231601
ETSI EN 301 489-1 V2.2.3 (2019-11) ETSI EN 301 489-3 V2.1.1 (2019-03) ETSI EN 301 489-17 V3.2.4 (2020-09)	EED32080231602
ETSI EN 300 440 V2.2.1 (2018-07)	EED32080231701
EN 50665:2017	EED32080231702
EN 60335- 1:2012 + A11:2014 + A13:2017 + A1:2019 + A14:2019+ A2:2019 and EN 62233: 2008	EED310802315
We hereby declare that all essential radio test suites have been carried out and that the above named product is in conformity to all the essential requirement of Directive 2014/53/EU. The conformity assessment procedure referred to in Article 17 and Annex III of Directive 2014/53/EU has been followed with the involvement of the following Notified Body: CTI-CEM International Ltd Unit 200 Greenogue Business Park, Grants Lane, Rathcoole, Co. Dublin, Ireland NB No. : CE2845	
Name:	Wayne Cheng
Title :	Certification Manager
Address:	2201, Block C1, Nanshan I Park, No. 1001 Xueyuan Road, Nanshan District, Shenzhen City, China
Date: 2022/8/10	 Signature of Authorized Person



Warranty Card

User Information

Product Model: _____ Product No.: _____

Date of Purchase: _____ User Name: _____

Warranty Record

Warranty Date	Faults and Troubleshooting	Completion Date	User's Signature



UBPet

Best Epoch Technology Co., Ltd.

Add: 22nd Floor, Block C1, Nanshan I Park, No.1001 Xueyuan Road,
Nanshan District, Shenzhen, P.R.China

E-mail: aftersales@ubtrobot.com



A20383BHG