



Earphones

EPH-W53

Owner's Manual



Contents

Introduction	2
Features	2
Accessories	3
Part names	4
Preparation	7
Charging	7
Turning on/off	7
Pairing with a Bluetooth device	8
Establishing a Bluetooth connection	9
Ending a Bluetooth connection	9
Using earphones	10
Listening to music	10
Using the phone	11
Operating the connected Bluetooth device by voice commands	11
Troubleshooting	12



Introduction



Thank you for selecting for the Yamaha EPH-W53 Earphones. The EPH-W53 is a pair of earphones designed for use with a portable audio player or smartphone via Bluetooth connection.

This manual explains preparations and operations for everyday users of the unit.

Features

- **Enjoy music wirelessly via Bluetooth connection to a portable audio player or a smartphone.**
- **A built-in internal microphone lets you answer phone calls and carry on conversations.**

■ About content in this manual and the “Safety Brochure”

- To ensure optimum performance, please read this manual carefully.
- Please read the included "Safety Brochure" before using the device.
- The illustrations in this manual are for instructional purposes only.
- The company names and product names in this manual are the trademarks or registered trademarks of their respective companies.
- The “ **WARNING**” icon indicates points that may lead to death or serious injury if not properly observed.
- The “ **CAUTION**” icon indicates points that may lead to injury if not properly observed.
- The “**NOTICE**” sections contain points that you must observe to prevent product failure, damage or malfunction and data loss.
- The “**Note**” sections contain important or detailed supplementary information.

Responsible Use

Do not use the earphones at high volume in a public place. Sound leakage from the earphones may be a nuisance to people around you.

Accessories

This product includes the following accessories.

**CAUTION**

Keep small parts out of the reach of infants. Your children may accidentally swallow them.

- Quick Manual

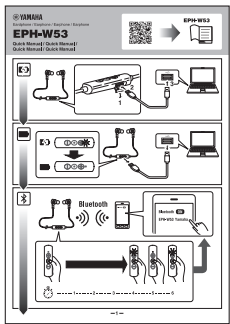

- Safety Brochure



- USB power cable

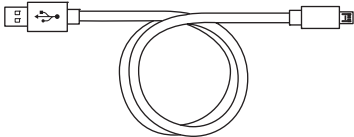

- Eartips

Included with the unit are pairs of eartips in various sizes (LL, L, M, S, and SS). The M-size eartips are already attached to the earphones when shipped from the factory.

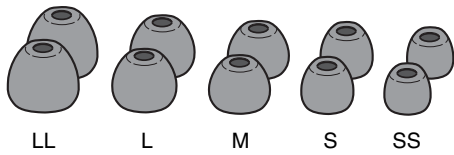

- Ear stabilizers

Included with the unit are pairs of ear stabilizers in various sizes (L, M, and S). The M-size ear stabilizers are attached to the earphones when shipped from the factory.

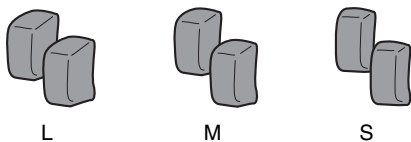

- Carrying case

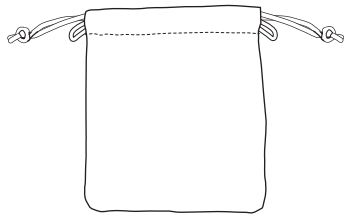

Part names

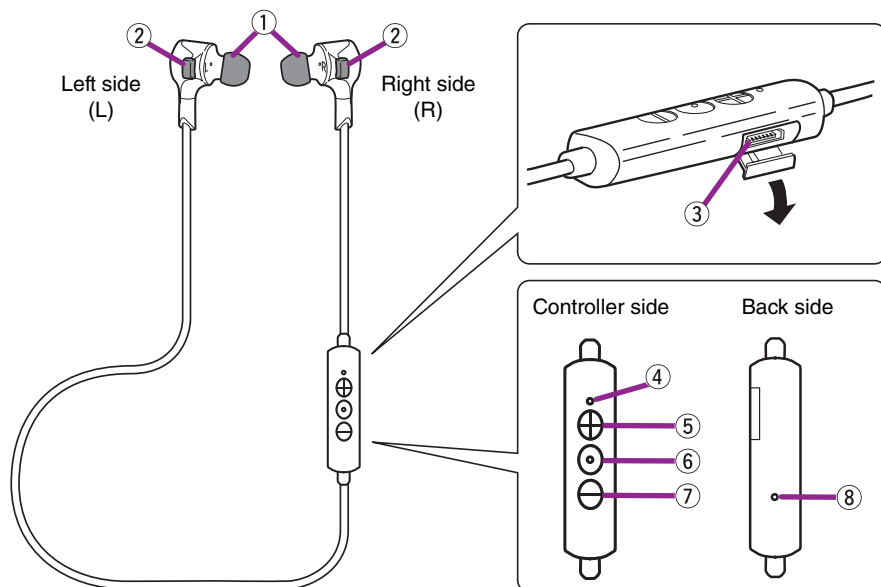

① Eartips

Attach eartips of the size that best fits your ears. The M-size eartips are already attached to the earphones when shipped from the factory.

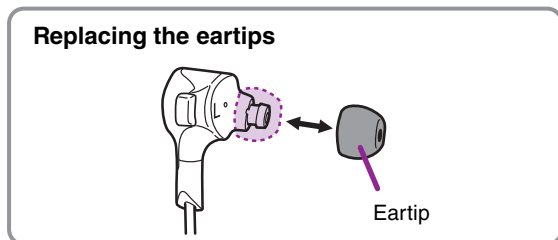

⚠ CAUTION

- Do not use the earphones with detached or broken eartips. Doing so may cause injury or illness.
- Securely attach the eartips to the earphones. If the eartips detach from the earphones and lodge in your ears, they may cause injury or illness.

Note

- If the eartips are not securely positioned in your ears, you may not hear the bass range clearly. To enjoy optimum sound quality, adjust the eartips so they will fit in your ears perfectly. Also, try replacing poor-fitting eartips with eartips of an appropriate size.

② Ear stabilizers

Attach ear stabilizers of the size that best fits your ears. The M-size ear stabilizers are attached to the earphones when shipped from the factory.

NOTICE

When attaching the ear stabilizers, do not confuse the front and the back.

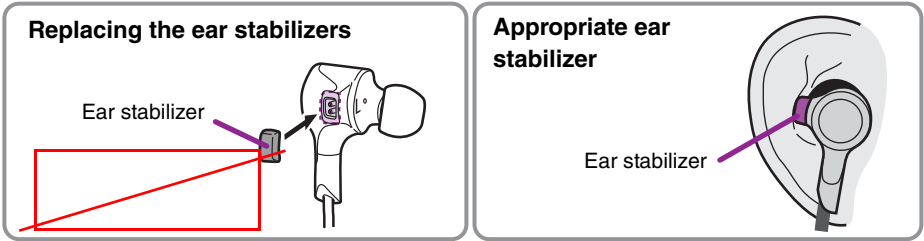

③ Charging connector

Connect the included USB power cable to charge. Open the cover to connect the cable.

④ Indicator

Indicates the status of the device by lighting or flashing.



Status	Indicator		Reference page
When pushing the function key in the power-on state		Lights in blue (turns off in 0.5 seconds)	Page 8
When turning on		Lights in blue (turns off in two seconds)	Page 7
When turning off		Lights in orange (turns off in one second)	Page 7
During Bluetooth pairing		Flashes in blue and orange alternately	Page 8
When Bluetooth pairing is completed		Lights in blue (turns off in two seconds)	Page 8
When the battery is less than 10% charged		Flashes in orange	Page 7
During battery charging		Lights in orange (turns off when the charging is completed)	Page 7

⑤ + key

Press to raise the volume.

Press and hold more than three seconds to forward one song.

⑥ Function key

Enables you to perform the following operations.

- Turning on/off (press and hold for three seconds)
- Pairing with a Bluetooth device (press and hold more than five seconds)
- Playing back music and pausing (press briefly)

⑦ - key

Press to lower the volume. Press and hold more than three seconds to reverse to the top of the song. Press and hold more than three seconds immediately again to go back one song.

⑧ Microphone

Used in conversation or voice controls.

Preparation

Charging

- 1 Open the cover of the controller section.
- 2 Connect the charging connector to a computer, etc., with the included USB power cable.

The indicator lights in orange.

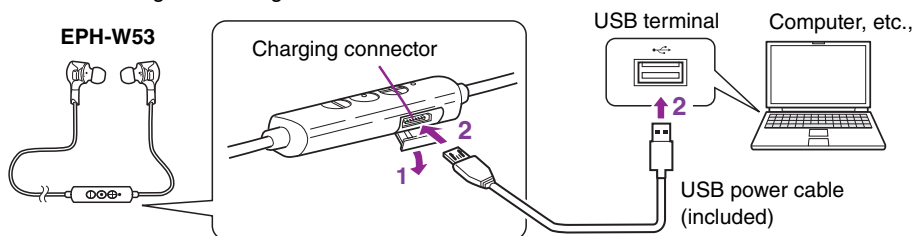

Note

- Make sure to charge the earphones before using them for the first time.
- When charged in a place where the temperature is extremely high or low, charging may be completed quickly or charging may not be possible.
- To maintain optimum performance, charge the earphones at least once every six months.
- Batteries have a finite lifetime. The battery capacity is reduced gradually by the number of times it is used and the elapsed time of use.
- The actual lifetime of a battery differs depending on how it is stored, how it is used, the surrounding environment, etc.
- When the battery is charging, the indicator lights in orange. When charging is completed, the indicator turns off.
- A full charge cycle takes about three hours.

Turning on/off

Press and hold the function key more than three seconds.

When turning on, the indicator lights in blue for two seconds.

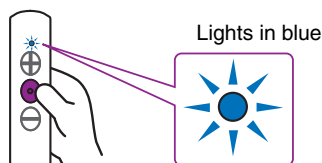

Press and hold more than three seconds

When turning off, the indicator lights in orange for one second.

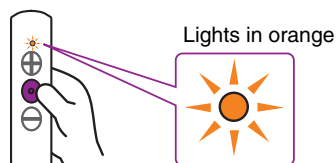

Press and hold more than three seconds

Note

If the earphones are left with no Bluetooth connection for ten minutes, they automatically turn off.

Pairing with a Bluetooth device

“Pairing” is the process of registering Bluetooth devices each other. Pairing must be performed when you use a Bluetooth connection for the first time, or if the pairing data has been deleted.

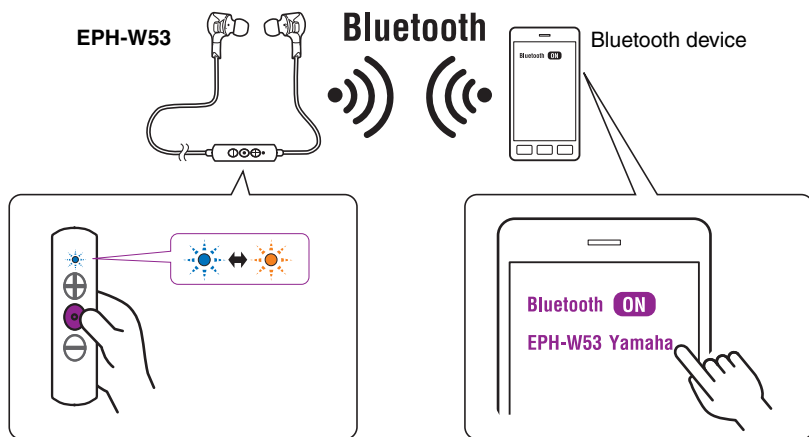

- 1 If the earphones turn on, turn off to press and hold the function key until the indicator lights in orange.

Note

- When the earphones turn on, the indicator lights briefly when the function key is pressed briefly.

- 2 Press and hold the function key until the indicator flashes in blue and orange alternately. (more than five seconds)

The earphones are waiting for pairing.

- 3 Perform the pairing process on the Bluetooth device.

For details, refer to the owner's manual of the Bluetooth device.

- 3-1. Access the Bluetooth setting screen on the Bluetooth device.
- 3-2. If the Bluetooth setting is disabled, enable it.
- 3-3. In the list of detected devices, tap “EPH-W53 Yamaha” to select it.

Pairing is completed.

When pairing is completed, the indicator lights in blue for two seconds.

Note

- These earphones can be paired with up to eight Bluetooth devices. When pairing has succeeded with the ninth device, pairing data is deleted for the oldest paired device.
- If two minutes elapse before pairing is completed, the receiver stops waiting for pairing.
- If you are asked to enter a pass key, enter the numerals “0000.”

Establishing a Bluetooth connection

Press and hold the function key until the indicator lights in blue (for about three or four seconds).

The earphones turn on and a Bluetooth connection is established with the most-recently connected Bluetooth device.

Note

- If you continue to press and hold the function key, the earphones are waiting for pairing. If a pairing operation is not needed, immediately stop pressing after the indicator lights in blue.
- Some Bluetooth devices may not connect automatically.
- If the Bluetooth device does not connect to the earphones automatically, operate the device to connect to the earphones.
- If you turn off the Bluetooth setting of the Bluetooth device, a Bluetooth connection is not established with that device when you turn on the power of the receiver.
- The earphones can establish a Bluetooth connection with two devices simultaneously (multi-point connection). To establish a Bluetooth connection with the second device, perform the process also on that Bluetooth device. Audio from the connected Bluetooth devices can be switched by playing or stopping music from the connected Bluetooth devices.

Ending a Bluetooth connection

If a Bluetooth connection exists, you can end it in either of the following ways.

- Turn off the power of the earphones.
- End the Bluetooth connection on the Bluetooth device.

Using earphones

Wear the earphones with the L mark in your left ear, and the one with the R mark in your right ear.

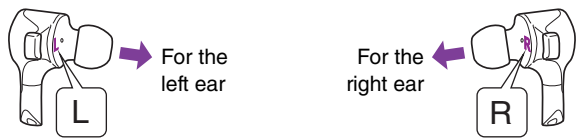

Listening to music

The controller section on the earphones enables playback operation of the connected Blue-tooth device.

	Play	Press the function key once briefly. If you want to select a specific song and play it, perform the appropriate operations on the Blue-tooth device.
	Pause	While the song is playing, press the function key once briefly.
	Skipping forward to the next song	Press and hold the + key more than three seconds.
	Reversing to the top of the song (while in the middle of the song) / skipping back to the previous song (when at the beginning of the song)	Press and hold the - key more than three seconds.
	Raising the volume	Press the + key once briefly.
	Lowering the volume	Press the - key once briefly.

Using the phone

The controller section on the earphones enables the following operations when a phone call comes in.

	Receiving a phone call	When a call comes in, press the function key once briefly.
	Ending a call	During the conversation, press the function key once briefly.
	Ignoring a call	When a call comes in, press and hold the function key more than three seconds.
	Raising the conversation volume	Press the + key once briefly.
	Lowering the conversation volume	Press the - key once briefly.

Operating the connected Bluetooth device by voice commands

If the connected Bluetooth device has a voice control feature/app (Siri, etc.), you can control the Bluetooth device from the earphones.

Press the function key twice briefly.

Voice control (Siri, etc.) starts and the Bluetooth device can be operated by voice commands.

Note

This works only for devices that have Siri or another voice control feature.

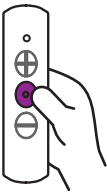

Troubleshooting

If the situation does not improve even after trying the following actions, or if any abnormalities not listed below are observed, contact the nearest authorized Yamaha dealer or service center.

Symptom	Action
No sound	<ul style="list-style-type: none">• Make sure that the volume is not set too low on the portable audio player or smartphone.• Make sure that the portable audio player or smartphone is not paused.• Make sure that the portable audio player or smartphone is turned on.• Make sure that the Bluetooth connection with the portable audio player or smartphone is established.
Cannot be operated	<ul style="list-style-type: none">• Make sure that the Bluetooth connection with the portable audio player or smartphone is established.• An incompatible portable audio player or smartphone has been connected.
Unusual sounds are heard	Check the indicator. If the indicator flashes in orange, the battery is less than 10% charging.
Cannot establish a Bluetooth connection	<ul style="list-style-type: none">• Make sure that the Bluetooth function of the portable audio player or smartphone is turned on.• If you can't establish a connection, try performing the pairing operation once again.