

PHILIPS

NORELCO

Tripleheader shaver

S9000 series



BC

PHILIPS

Series 9000

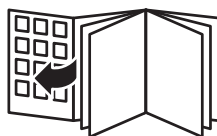

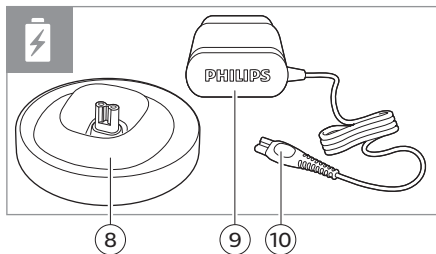
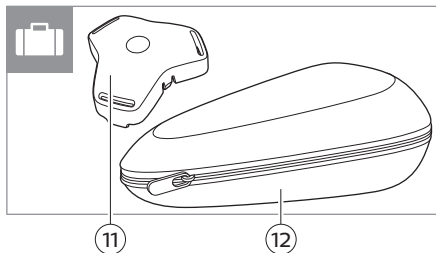
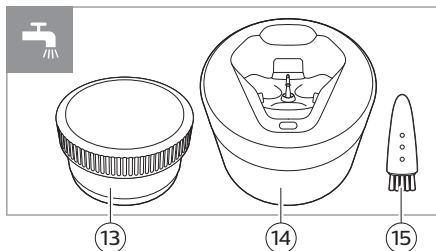
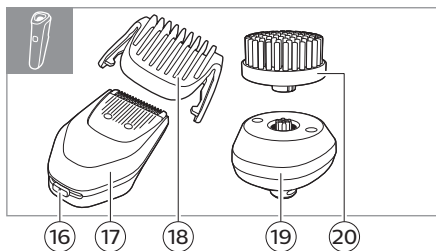
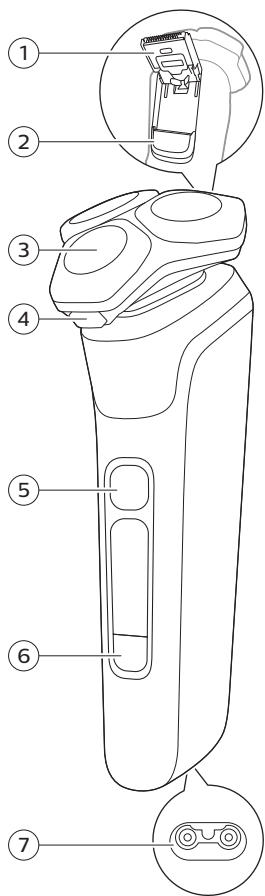

English 6

Contents

IMPORTANT SAFETY INSTRUCTIONS_____	6
General description_____	12
Introduction_____	13
What do the icons on the display mean?_____	13
What is my shaver telling me?_____	15
How do I charge my product?_____	19
How do I use my appliance and the attachments?_____	21
How do I clean my appliance and the attachments?_____	33
How do I use the Quick Clean Pod?_____	39
How do I connect my shaver and smartphone?_____	43
How do I replace the shaving heads?_____	45
Accessories_____	47
Assistance_____	47
Full Two-Year Warranty_____	48
45-DAY MONEY-BACK GUARANTEE_____	49
Trademarks_____	50

IMPORTANT SAFETY INSTRUCTIONS

When using an electric product, basic precautions should always be followed, including the following:

Read all instructions before using this product.

DANGER

To reduce the risk of electric shock:

- Do not reach for a corded product or charging stand that has fallen into water. Unplug immediately from the power outlet.
- Keep the power cord dry.



- Do not place or store the product or charging stand where it can fall or be pulled into a tub or sink. Do not place or drop the product or charging stand into water or other liquid.
- This product does not work while it is connected to the power outlet. Except when charging, always unplug this product from the power outlet.
- Remove power cord from power outlet and product before cleaning.

WARNING

To reduce the risk of burns, fire, electric shock, or injury to persons:

- Close supervision is required when this product is used by, on, or near children, or persons with limited physical, sensory, or mental capabilities or invalids.
- Use this product only for its intended household use as described in this manual. Do not use attachments not recommended by Philips North America LLC.
- Never operate this product if it has a damaged power cord, if it is not working properly, after it has been dropped or damaged, or after the product or power cord has been dropped into water. For assistance call 1-8xx-xxx-xxxx.
- Keep the power cord away from heated surfaces.
- Never drop or insert any object into any opening.

8 English

- Do not use the power cord in or near a power outlet that contains an electric air freshener to prevent damage to the power cord.
- Be careful when handling your smartphone near water and in moist environments.
- The shortwave radio frequency signals of a Bluetooth® product may impair the operation of other electronic and medical devices.
- Switch off Bluetooth where it is prohibited.
- Do not use the product in medical facilities, aircraft, refuelling points, close to automatic doors, automatic fire alarms or other automatically controlled devices.
- Keep this product at least 8 inches from pacemakers and other medical devices. Radio waves may impair the operation of pacemakers and other medical devices.
- Do not charge or plug in product or charging stand outdoors or operate where aerosol (spray) products are being used or where oxygen is being administered.
- Always check shaving heads (caps and cutters) before using the product. Do not use the product if cutters or caps are damaged, as injury may occur.
- Always attach power cord to product or charging stand first, then to power outlet. To disconnect, set all controls to 'off' position. Then remove power cord from power outlet.
- Plug power cord directly into power outlet. Do not use an extension cord.
- Unplug power cord before plugging in or unplugging the product.
- Only use the power cord (XXxxxx) and other accessories supplied with the product.
- Do not attempt to open the product to remove or replace the built-in rechargeable battery.

- The batteries used in this product may present a fire or chemical burn hazard if mistreated. Do not disassemble, heat above 100 °C (212 °F) or incinerate.

IMPORTANT: The power plug contains a transformer. Do not cut off the power plug to replace it with another plug as this will cause a hazardous condition.

Philips Norelco Quick Clean Pod Cartridge fluid

- Do not swallow.
- Keep out of reach of children.
- In case of eye contact, rinse with plenty of water.

Battery safety instructions

- Charge, use and store the product at a temperature between 5 °C and 35 °C.
- Do not burn products and their batteries and do not expose them to direct sunlight or to high temperatures (e.g. in hot cars or near hot stoves). Batteries may explode if overheated.
- If the product becomes abnormally hot, gives off an abnormal smell, changes color or if charging takes much longer than usual, stop using and charging the product and contact your local Philips dealer.
- Do not place products and their batteries in microwave ovens or on induction cookers.
- When you handle batteries, make sure that your hands, the product and the batteries are dry.
- To prevent batteries from heating up or releasing toxic or hazardous substances, do not modify, pierce or damage products and batteries and do not disassemble, short-circuit, overcharge or reverse charge batteries.

10 English

- To avoid accidental short-circuiting of batteries after removal, do not let battery terminals come into contact with metal objects (e.g. coins, hairpins, rings). Do not wrap batteries in aluminum foil. Tape battery terminals or put batteries in a plastic bag before you discard them.
- If batteries are damaged or leaking, avoid contact with the skin or eyes. If this occurs, immediately rinse well with water and seek medical care.

Electromagnetic fields (EMF)

This Philips product complies with all applicable standards and regulations regarding exposure to electromagnetic fields.

FCC Compliance



- The frequency band in which the appliance operates is 2.4 GHz.
- This appliance is equipped with Bluetooth class 2
- The maximum radio frequency power radiated in the frequency band in which the appliance operates is less than 20 dBm
- This device complies with the FCC RF exposure limits and has been evaluated in compliance with portable exposure condition.

Changes or modifications not expressly approved by Philips could void the user's authority to operate the equipment.

This device complies with Part 15 of the FCC Rules. Operation is subject to the following two conditions: (1) this device may not cause harmful interference, and (2) this device must accept any interference received, including

interference that may cause undesired operation.

This equipment has been tested and found to comply with the limits for a Class B digital device, pursuant to Part 15 of the FCC Rules. These limits are designed to provide reasonable protection against harmful interference in a residential installation. This equipment generates, uses and can radiate radio frequency energy and, if not installed and used in accordance with the instructions, may cause harmful interference to radio communications. However, there is no guarantee that interference will not occur in a particular installation. If this equipment does cause harmful interference to radio or television reception, which can be determined by turning the equipment off and on, the user is encouraged to try to correct the interference by one or more of the following measures:

- Reorient or relocate the receiving antenna.
- Increase the separation between the equipment and receiver.
- Connect the equipment into an outlet on a circuit different from that to which the receiver is connected.
- Consult the dealer or an experienced radio/TV technician for help.

The Bluetooth® wordmark and logos are registered trademarks owned by Bluetooth SIG, Inc. and any use of such marks by Koninklijke Philips N.V. is under license.

- There is no limitation as to which distance can be used from the human body.

SAVE THESE INSTRUCTIONS

General description

- 1 Pop-up trimmer
- 2 Trimmer release slide
- 3 Shaving unit
- 4 Shaving unit release button
- 5 On/off button
- 6 Menu button
- 7 Socket for small plug
- 8 Charging stand
- 9 Power plug
- 10 Small plug
- 11 Protection cap
- 12 Pouch
- 13 Philips Quick Clean Pod cartridge
- 14 Quick Clean Pod
- 15 Cleaning brush
- 16 Length settings
- 17 Click-on beard styler attachment
- 18 Comb for beard styler attachment
- 19 Attachment holder
- 20 Click-on cleansing brush attachment

The accessories supplied may vary for different products. The box shows the accessories that have been supplied with your product.

Introduction

Congratulations on your purchase and welcome to Philips Norelco! To fully benefit from the support that Philips offers, register your product at **www.philips.com/welcome** or via the app.

What do the icons on the display mean?

- Main Menu



You can toggle through the menu items by pressing the menu button.

Icon

Meaning



The main menu shows the status of the battery in percentages.



The Pressure Guard sensor menu tells you if the pressure you applied to your skin during the shave was good, too low or too high (see 'Shaving').



The Motion Control sensor menu tells you if the motion during your shave was good or needs to be improved (see 'Shaving').



You can activate the travel lock in this menu (see 'Travel lock').



Here the display shows that your shaver is not paired to your smartphone (see 'Pair the shaver and smartphone').

14 English



The display shows that your shaver is paired to your smartphone (see 'Pair the shaver and smartphone').

- Switching the shaver on



Press the on/off button to switch on the shaver.

Icon	Meaning
------	---------



When you switch on the shaver, a short animation shows which pressure feedback setting you activated (see 'When your shaver is switched on').

- Warnings and notifications

Icon	Meaning
------	---------



The battery is almost empty and you need to charge your shaver (see 'How do I charge my product?').



When the data storage is almost full, you receive a notification reminding you to synchronize your shaves. To prevent data loss, synchronize the shaver with the app (see 'How do I connect my shaver and smartphone?').







The shaving unit is soiled or damaged to such an extent that the motor cannot run. Clean the shaving heads thoroughly.



You are using the wrong adapter (see 'How do I charge my product?'). Only use the adapter that is supplied with the shaver.

- *Cleaning the shaver*

Icon	Meaning
	A reminder: clean your shaver in the quick cleaning pod (see 'How do I use the Quick Clean Pod?').
	A reminder: clean your shaver.
22  ⌚/22 	The cleaning process is in progress and the display shows the remaining cleaning time in seconds, or as a clock if you press the menu button.
	The cleaning process is interrupted.

- *Unplug for use*

Icon	Meaning
	Unplug the shaver before you use it.

What is my shaver telling me?

When your shaver is switched on

During your shave, you receive feedback on how much pressure you are applying via the light ring at the top of your shaver handle. The light ring on the handle lights up various colors during your shave to give you feedback

on how much pressure you are exerting. These are the default settings:



- When you don't apply enough pressure, the light ring lights up blue.
- When you apply the correct amount of pressure, the light ring lights up green.
- When you apply too much pressure, the light ring lights up orange.

When your shaver is switched on, you can customize the type of pressure feedback you receive.

1 Switch on the shaver.

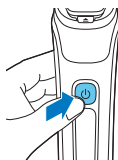

2 Press the menu button to toggle through the pressure feedback options. The table below shows what pressure feedback you receive with each option.



Too little pressure is being applied

The right amount of pressure is being applied

Too much pressure is being applied

Full pressure
feedback



Partial pressure
feedback



No feedback No feedback



No pressure
feedback



No feedback No feedback No feedback

Note: Pressure feedback is only available when the shaving head is attached to the handle.

When the beard styler or cleansing brush attached to the handle, the motion and pressure feedback is switched off automatically.

When your shaver is switched off

- 1 After you finish shaving and switch off your shaver, you will see the post-shave feedback from your shave on the handle.
- 2 You can toggle through the post-shave feedback by pressing the menu button. When your shaver is switched off, you can also toggle through the five functions by pressing the menu button.



Remaining battery charge

This menu item shows the remaining battery charge.



Pressure Guard sensor

This menu item shows the pressure feedback from your last shave.



Motion Control sensor

This menu item shows the motion feedback from your last shave.



Travel lock

From this menu item, you can lock and unlock your shaver by pressing and holding the menu button for 3 seconds. When you are going to travel, you can lock the shaver to prevent it from accidentally switching on.

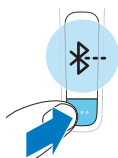

Bluetooth

From this menu item, you can unpair your shaver and smartphone.

Note: Make sure your smartphone is equipped with *Bluetooth®* 4.2 or higher.

This shaver is equipped with *Bluetooth®* 4.2 and higher to connect to the app. When you have paired your shaver and smartphone, Bluetooth on your shaver is switched on automatically, even when the shaver is switched off. This allows your shave data to be synced later so you don't need to take your smartphone with you when you shave. For information about the benefits of pairing your shaver and smartphone, see 'Benefits of connecting your shaver to the app'.

Note: You can switch off Bluetooth on your shaver by activating the travel lock.

How do I charge my product?

Note: This product is waterproof. It is suitable for use in the bath or shower and for cleaning under the tap. This product can only be used without cord.

- Charge the product before you use it for the first time and when the remaining battery charge (see 'Remaining battery charge') indicates that the battery is almost empty.
- Charging takes approx. 1 hour.
- Quick Charge: After approx. 5 minutes of charging, the battery contains enough energy for one full shave. When the battery is charged to 10 %, you can complete one full shave.

- When the product is fully charged it has a cordless operating time of up to 60 minutes.

Note: You cannot use the appliance while it is charging.

Charging with the power cord

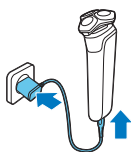

- 1 Make sure that the product is switched off.
- 2 Insert the small plug into the product and put the power plug in the wall outlet.
 - While the product is charging, an animation appears on the display showing the progress.
 - When the product is fully charged, the battery percentage shows 100% and the battery icon shows the battery being full.
- 3 After charging, remove the power plug from the power outlet and pull the small plug out of the product.

'Unplug for use' symbol

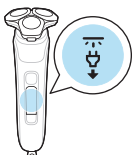

The 'unplug for use' symbol flashes to remind you to disconnect the power cord from the power outlet and remove the small plug from the product before you switch it on.

Charging in the charging stand (specific models only)

- 1 Make sure that the product is switched off.

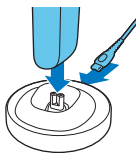

- 2 Put the small plug in the charging stand and put the power cord in the power outlet.
- 3 Put the product in the charging stand.
Specific models only: The light ring on the bottom of the charging stand lights up and rotates quickly.
 - After approximately 5 minutes, the light ring rotates slower.
 - As the product continues to charge, the light ring becomes brighter and rotates slower.
 - When the product is fully charged, the light ring lights up fully and stops rotating.
- 4 After charging, remove the power cord from the power outlet and pull the small plug out of the charging stand.

How do I use my appliance and the attachments?

Always check the product and all accessories before using. Do not use the product or any accessory if it is damaged, as this may cause injury. Always replace a damaged part with one of the original type.

Note: This product is waterproof. It is suitable for use in the bath or shower and for cleaning under the tap with water. For safety reasons, this product can only be used without cord.

Use this product for its intended household use as described in this manual.

For hygienic reasons, the product should only be used by one person.

SkinIQ



This product is equipped with SkinIQ technology which intelligently detects your hair density and shaving technique. For a better technique, you can get personalized shaving advice in the app.

You get advice in 2 ways: guided shaves in real time and synchronized shaves. We advise you to start with the guided shave to enhance your shaving experience.

- Correct handling of your product will contribute to the best shaving result.
- Follow the advice obtained from the synchronized shaves and the personalized programs.

Shaving

You can use this appliance either wet or dry, or even under the shower. For a wet shave, apply some water and shaving foam or gel to your skin and rinse the shaving heads under the tap with warm water before following the steps below.

- 1** Switch on the appliance.



- 2 Move the shaving heads over your skin in circular movements (See 'Motion Control sensor' below) to catch all hairs growing in different directions. Make sure each shaving head is fully in contact with the skin. Exert gentle pressure for a close, comfortable shave.

Note: Do not press too hard, as this can cause skin irritation. When you apply too much pressure, the orange light ring lights up (see 'What is my shaver telling me?').



Note: If you are shaving with gel or foam, rinse the shaving unit regularly during your shave to ensure that it continues to glide smoothly over your skin.

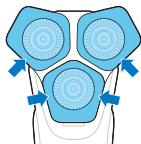

- 3 Use the narrow sides of the shaving unit to shave in hard-to-reach areas such as along your jawline and under your nose.
- 4 Switch off and clean the appliance after each use.

Note: Make sure you rinse all foam or shaving gel off the appliance.

SkinIQ: When you are finished shaving and switch off your shaver you also receive

feedback about your overall shave on the handle. You can toggle through the feedback by pressing the menu button.

Pressure Guard sensor

- When you apply the correct amount of pressure during your shave, the Pressure Guard sensor icon will display with a check mark.



- When your shaving pressure can be improved, the Pressure Guard sensor icon displays with an exclamation mark.



Motion Control sensor

- When you shave in the correct motion (circular movements), the Motion Control sensor icon displays with a check mark.
- When your shaving motion can be improved, the Motion control sensor icon displays with an exclamation mark.



In the menu on your shaver, you can view the pressure feedback (see 'Pressure Guard sensor') and motion feedback (see 'Motion Control sensor') from your last shave.

You can personalize your feedback settings, see more detailed feedback and get personalized advice via the app.

You can use this product either wet or dry, or even in the shower.

For a wet shave, apply some water and shaving foam or gel to your skin and rinse the shaving heads under the tap with warm water before following the steps below.



- 1 Switch on the product.
- 2 Move the shaving heads over your skin in circular movements (See 'Motion Control sensor' below) to catch all hairs growing in different directions. Make sure each shaving head is fully in contact with the skin. Exert gentle pressure for a close, comfortable shave.

Note: Do not press too hard, as this can cause skin irritation. When you apply too much pressure, the orange light ring lights up (see 'What is my shaver telling me?').



Note: If you are shaving with gel or foam, rinse the shaving unit regularly during your shave to ensure that it continues to glide smoothly over your skin.

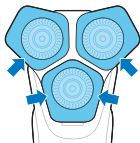



- 3 Use the narrow sides of the shaving unit to shave in hard-to-reach areas such as along your jawline and under your nose.
- 4 Switch off and clean the product after each use.

Note: Make sure you rinse all foam or shaving gel off the product

SkinIQ: When you are finished shaving and switch off your shaver you also receive feedback about your overall shave on the handle. You can toggle through the feedback by pressing the menu button.

Pressure Guard sensor

- When you apply the correct amount of pressure during your shave, the Pressure Guard sensor icon will display with a check mark.
- When your shaving pressure can be improved, the Pressure Guard sensor icon displays with an exclamation mark.

Motion Control sensor

- When you shave in the correct motion (circular movements), the Motion Control sensor icon displays with a check mark.
- When your shaving motion can be improved, the Motion control sensor icon displays with an exclamation mark.





In the menu on your shaver, you can view the pressure feedback (see 'Pressure Guard sensor') and motion feedback (see 'Motion Control sensor') from your last shave.

You can personalize your feedback settings, see more detailed feedback and get personalized advice via the app.

21-Day adaptation process

- 21 Day Trial and Conversion Process. It is a fact that your skin and beard need time to adjust to a new grooming system.
- Use your new shaver exclusively for 3 weeks to fully enjoy the closeness of a Philips Norelco shave.
- At first you may not get as close a shave as you expect, or your face may even become slightly irritated. This is normal since your beard and skin will need time to adjust. Invest 3 weeks and you'll soon experience the full joy of your new shaver.
- Stick with it! If you alternate shaving methods during the adjustment period, it may make it more difficult to adapt to the Philips Norelco shaving system.

- If you are still not convinced after 21 days, Philips Norelco will refund you the full purchase price as long as the request is received within 45 days of purchase.

Cleaning reminder



When you switch off the product, the cleaning reminder flashes to remind you to clean the product.

- Clean the product (see 'How do I use the Quick Clean Pod?') and attachments after each use to prevent clogging and damage.
- Clean the shaving heads thoroughly once a month or when the product does not shave as well as it used to.

Trimming

You can use the pop-up trimmer to groom your sideburns and moustache.

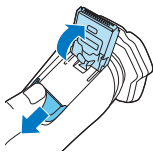

- 1 Push the trimmer release slide downwards to open the trimmer.
- 2 Switch on the product.



- 3 Hold the trimmer perpendicular to the skin and move it downwards while exerting gentle pressure.



- 4 You can also use the trimmer under your nose.
- 5 Switch off the product and clean the trimmer after each use to prevent clogging and damage.
- 6 Close the trimmer.

Using the click-on attachments

Note: The accessories supplied may vary for different products. The box shows the accessories that have been supplied with your product.

Note: When the beard styler or cleansing brush attached to the handle, the motion and pressure feedback is switched off automatically.

Using the beard styler attachment with comb

You can use the beard styler attachment with the comb attached to style your beard at one fixed setting or at different length settings. You can also use it to pre-trim any long hairs before shaving for a more comfortable shave.

The length settings on the beard styler attachment correspond to the remaining hair length after cutting and range from 1 to 5 mm (3/64 - 3/16 in).



- 1 Twist the shaving head or other attachment to remove it from the handle and press the beard styler attachment onto the handle.



- 2 Slide the comb straight into the guiding grooves on both sides of the beard styler attachment.



- 3 Press the length selector and then push it to the left or right to select the desired hair length setting.

- 4 Switch on the product.

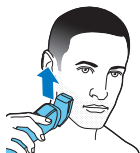

- 5 Move the product upwards while you exert gentle pressure. Make sure the front of the comb is in full contact with the skin.

- 6 Switch off the product and clean the attachment after each use.

Using the beard styler attachment without comb

You can use the beard styler attachment without the guard to contour your beard, moustache, sideburns or neckline to a length of 0.5 mm (1/32 in).

You can use the beard styler attachment with the comb attached to style your beard at one fixed setting or at different length settings. You

can also use it to pre-trim any long hairs before shaving for a more comfortable shave.

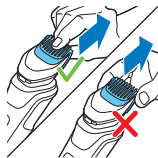

- 1 Pull the comb off the beard styler attachment.

Note: Grab the comb in the center to pull it off the beard styler attachment. Do not pull at the sides of the comb.



- 2 Switch on the product.
- 3 Hold the beard styler attachment perpendicular to the skin and move the product downwards while you exert gentle pressure.
- 4 Switch off the product and clean the attachment after each use.

Using the cleansing brush attachment

Use the cleansing brush with your daily cleansing cream to remove oil and dirt.

We advise you to use it no more than once a week.

Caution: Do not use the product on damaged or irritated skin or on wounds.



- 1 Twist the shaving head or other attachment to remove it from the handle and press the cleansing brush attachment onto the handle.
- 2 Moisten the cleansing brush with water.

Do not use the cleansing brush dry as this can irritate the skin.



- 3 Moisten your face with water and apply a cleanser to your face.
- 4 Place the cleansing brush on your cheek.
- 5 Switch on the product.
- 6 Gently move the brush across your skin from the nose towards the ear. Do not press too hard. Make sure that the treatment remains comfortable.

Do not cleanse the sensitive area around your eyes.

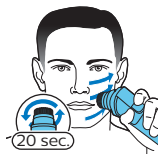

- 7 After approx. 20 seconds, move the appliance to your other cheek and start cleansing this part of your face.



- 8 After approx. 20 seconds, move the appliance to your forehead and start cleansing this part of your face. Gently move the brush head from left to right.

We advise you to not overdo the cleansing and to not cleanse any zone longer than 20 seconds.

- 9 Switch off the product and clean the attachment after each use.
- 10 After the treatment, rinse and dry your face. Your face is now ready for the next step of your daily skincare routine.

Storage

- Be sure the product is switched off. Remove the power cord from power outlet and the product before storing it in a safe, dry location where it will not be crushed, banged, or subject to damage.
- Do not wrap cord around the product when storing.
- Store cord and other accessories in a safe location where these will not be cut or damaged.
- Do not place or store the product where it can fall or be pulled into a tub or sink, water or other liquid while plugged in.

Note: We advise you to let the product and its attachments dry completely before you store them for the next use.

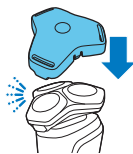

- Store the product in the pouch (if supplied).
- Put the protection cap (if supplied) on the shaver to protect it from dirt accumulation.
- Alternatively, store the shaver on the charging stand (if supplied) or in the Philips Quick Clean Pod (if supplied).

How do I clean my appliance and the attachments?

Clean the product and the attachments after each use for optimal performance.

Cleaning the shaver under the tap

Clean the shaver after each use to prevent clogging and damage.

Never dry the shaving unit with a towel or tissue, as this may damage the shaving heads.

While rinsing the shaving unit, water may drip out of the base of the shaver. This is a normal occurrence.



- 1 Switch on the shaver.
- 2 Rinse the shaving unit under a warm tap.



- 3 Switch off the shaver. Press the release button to open the shaving unit.



- 4 Rinse the hair chamber under a warm tap.



- 5 Rinse the shaving head holder under a warm tap.
- 6 Carefully shake off excess water and let the shaving head holder air-dry completely.



- 7 Close the shaving unit.

Thorough cleaning

We advise you to clean the shaving heads thoroughly once a month or when the shaver does not shave as well as it used to.

- 1 Make sure that the product is switched off and disconnected from the power outlet.
- 2 Press the release button on the shaving unit and pull the shaving head holder off the shaving unit.



- 3 Rinse the hair chamber and shaving head holder under the tap.
- 4 Remove the shaving heads. For detailed instructions, see 'How do I replace the shaving heads?.'

Note: Do not clean more than one cutter and guard at a time, since they are all matching sets. If you accidentally put a cutter in the wrong shaving guard, it may

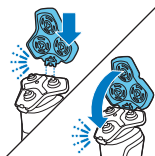
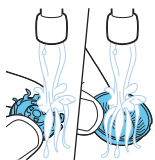

take several weeks before optimal shaving performance is restored.

- 5 Clean the cutter and guard under the tap.
- 6 Shake off excess water.
- 7 Put the shaving heads back into the shaving unit. For detailed instructions, see 'How do I replace the shaving heads?.'
- 8 Insert the hinge of the shaving head holder into the slot in the top of the shaving unit and close the shaving unit.

Cleaning the pop-up trimmer

Clean the trimmer after each use to prevent clogging and damage.

Never dry the trimmer teeth with a towel or tissue, as this may damage the trimmer teeth.

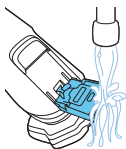
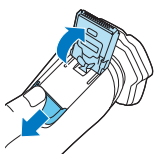

- 1 Make sure that the product is switched off and disconnected from the power outlet.
- 2 Push the trimmer release slide down to open the pop-up trimmer.
- 3 Switch on the product and rinse the pop-up trimmer with warm water.
- 4 After cleaning, switch off the product.
- 5 Carefully shake off excess water and let the pop-up trimmer air dry.
- 6 Close the trimmer.

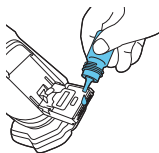

Tip: For optimal performance, lubricate the teeth of the pop-up trimmer with a drop of mineral oil every six months (oil not included).

Cleaning the click-on attachments

Never dry the trimmer or beard styler attachments with a towel or tissue, as this may damage the trimming teeth.

The accessories supplied may vary for different products. The box shows the accessories that have been supplied with your product.

Cleaning the cleansing brush attachment

Clean the cleansing brush attachment after each use.

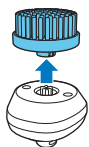

- 1 Switch off the product.
- 2 Remove the attachment from the attachment holder.
- 3 Clean the parts thoroughly with warm water and soap.
- 4 Dry the attachment with a towel.

Cleaning the beard styler attachment

Clean the beard styler attachment after each use.

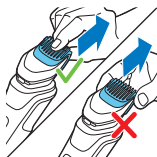

- 1 Pull the comb off the beard styler attachment.

Note: Grab the comb in the center to pull it off the beard styler attachment. Do not pull at the sides of the comb.

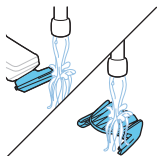

- 2 Rinse the cut hairs off the cutting unit with lukewarm water.

- 3 Rinse the cut hairs off the comb.



- 4 Remove the cutting unit from the beard styler attachment. By pushing the cutting unit from the beard styler attachment you can remove any hairs that have accumulated inside the beard styler. You can also rinse the back of the cutting unit.



- 5 Rinse cut hairs out of the beard styler attachment.

- 6 Carefully shake off excess water and leave the comb, cutting unit and beard styler attachment to air-dry before next use.

Never dry the cutting unit with a towel or tissue, as this may damage the trimming teeth.

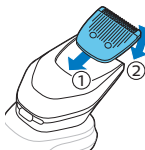

- 7 When the cutting unit is dry attach it to the beard styler attachment.



- 8 When the comb is dry, re-attach it to the beard styler.

Tip: For optimal performance, lubricate the teeth of the beard styler attachment with a drop of sewing machine oil regularly.

How do I use the Quick Clean Pod?

What does the icon on my Quick Clean Pod mean?

Icon	Behavior	Meaning
	Becomes visible on the Quick Clean Pod	The Quick Clean Pod Cartridge needs to be replaced (see 'How do I use the Quick Clean Pod?').

Preparing the Quick Clean Pod for use

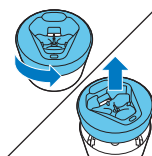

- 1 Twist and remove the top of the Quick Clean Pod.

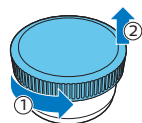

- 2 Twist the lid off of the Quick Clean Pod Cartridge.

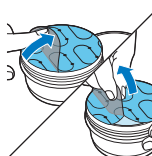

- 3 Lift the tab on the seal and pull it by the corner to remove the seal from the Quick Clean Pod Cartridge.

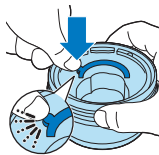

- 4 Press the small circular piece on the handle of the Quick Clean Pod Cartridge to break the snap hook on the handle.

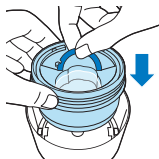

- 5 Place the Quick Clean Pod Cartridge into the Quick Clean Pod.

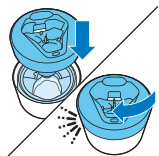

- 6 Put the top of the Quick Clean Pod back onto the base and turn it clockwise until you hear a click.



Do not tilt the Quick Clean Pod to prevent leakage.

Using the Quick Clean Pod

Note: If you use the shaver with shaving foam, shaving gel or pre-shave products, thoroughly rinse the shaving heads before you use the Quick Clean Pod.

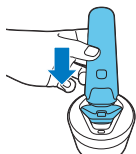

Always shake excess water off the shaver before you place it in the Quick Clean Pod.

- 1** Place the shaver upside down into the Quick Clean Pod. The shaver automatically detects that it is in the Quick Clean Pod.
- 2** Switch on the shaver to start the cleaning program.

Each cleaning program takes approximately one minute. During the cleaning program the remaining time is displayed as a countdown clock on the handle.

- 3** Let the shaver air-dry completely in the Quick Clean Pod before storing it.

Replacing the Quick Clean Pod Cartridge



Replace the Quick Clean Pod Cartridge immediately when the cartridge replacement icon on the Quick Clean Pod becomes visible or follow the table below.

Frequency of use	Cycles	When to replace the Quick Clean Pod Cartridge
Every day	About 30	Every month
A few times per week	About 20	Every 2 months
Every week	About 13	Every 3 months
Every month	About 3	Every 3 months

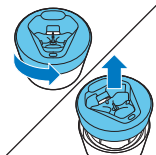

- 1 Twist and remove the top of the Quick Clean Pod.

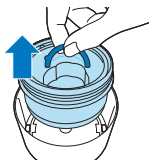

- 2 Lift the Quick Clean Pod Cartridge out of the Quick Clean Pod by the handle.



- 3 Pour any remaining fluid down a drain and recycle the empty cartridge in accordance with local waste regulations.



- 4 Place a new Quick Clean Pod Cartridge into the Quick Clean Pod (see 'Preparing the Quick Clean Pod for use').

Scan the QR code to the left or visit
www.philips.com/cleaning-cartridge to
order replacement Quick Clean Pod
Cartridges.

How do I connect my shaver and smartphone?

Pair the shaver and smartphone



The app is compatible with a wide range of iPhone and Android™ smartphones.

More information is available at **www.philips.com**.

- 1 Download the app.
- 2 Make sure Bluetooth on your smartphone is switched on.
- 3 Switch on the shaver.
- 4 Open the app and follow the instructions to start the pairing process.
- 5 Once paired, the shaver and app connect automatically when the app is open and Bluetooth on your phone is switched on.

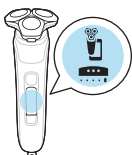
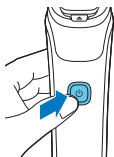

Synchronize your shaves

This shaver stores your shave data so you don't need to take your smartphone with you when you shave or want to check your shave data at a later stage.

When the data storage is almost full, you receive a notification reminding you to synchronize your shaves. To prevent data loss, synchronize the shaver with the app (see 'How do I connect my shaver and smartphone?').

- 1 Make sure you are close to the shaver and open the app.
- 2 The app connects automatically and synchronizes your last shaves.

Unpair the shaver and smartphone

You can pair your shaver with only one smartphone at a time. To unpair your shaver from your smartphone (e.g. when you get a new smartphone), follow these steps:

Unpair the shaver



- 1 Toggle through the menu items by pressing the menu button until you reach the Bluetooth menu (the fifth menu).
- 2 Press and hold the menu button until you are presented with a cross and check mark selection.
- 3 Select the check mark by pressing the menu button again to unpair your shaver.

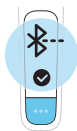

Note: When your shaver is successfully unpaired, you see the Bluetooth icon on your shaver handle shown to the left.

Unpair your smartphone

- 1 Go to the settings on your smartphone and select Bluetooth.
- 2 Tap on the name of the shaver.
- 3 Tap 'forget' or 'unpair'.

Note: The unpairing procedure may vary by smartphone. Please check your smartphone manual for more information.

How do I replace the shaving heads?

For maximum shaving performance, replace the shaving heads once a year. Replace damaged shaving heads immediately.

Always replace the shaving heads with original Philips Norelco shaving heads (see 'Accessories').

Replacing the shaving heads

- 1 Switch off the shaver.
- 2 Press the release button on the shaving unit and pull the shaving head holder off the shaving unit.



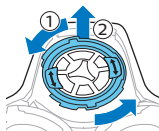

- 3** Turn the retaining rings counterclockwise and remove them. Place them aside in a safe place.

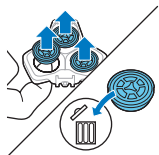

- 4** Remove the shaving heads from the shaving head holder.
Discard the used shaving heads immediately to avoid mixing them with the new shaving heads.



- 5** Place new shaving heads in the holder.

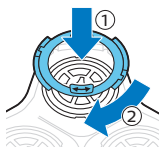

- 6** Place the retaining rings back onto the shaving heads and turn them clockwise to reattach the retaining ring.

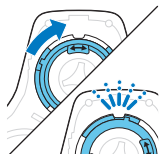

- Each retaining ring has two recesses that fit exactly into the projections of the shaving head holder. Turn the ring clockwise until you hear a click to indicate that the ring is fixed.

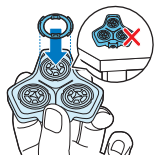

Note: Hold the shaving head holder in your hand when you reinsert the shaving heads and reattach the retaining rings. Do not place the shaving head holder on a surface, as this may cause damage to the shaving heads.

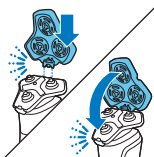

- 7 Insert the hinge of the shaving head holder into the slot in the top of the shaving unit and close the shaving unit.

Accessories



Replacement parts and accessories may be purchased at a store near you or on our website **www.philips.com/store**.

The following accessories and spare parts are available:

- SH71 Philips Norelco replacement shaving heads
- CC12 Philips Norelco Quick Clean Pod Cartridge 2-pack

Assistance

For assistance, visit our website: **www.philips.com/support** or call toll free 1-800-243-3050.

Online information is available 24 hours a day, 7 days a week.

Full Two-Year Warranty

Philips North America LLC warrants this new product (except shaving heads) against defects in materials or workmanship for a period of two years from the date of purchase, and agrees to repair or replace any defective product without charge.

IMPORTANT: This warranty does not cover damage resulting from accident, misuse or abuse, lack of reasonable care, the affixing of any attachment not provided with the product or loss of parts or subjecting the product to any but the specified voltage or batteries.*

NO RESPONSIBILITY IS ASSUMED FOR ANY SPECIAL, INCIDENTAL OR CONSEQUENTIAL DAMAGES.

In order to obtain warranty service, simply go to **www.philips.com/support**. It is suggested that for your protection you return shipments of product by insured mail, insurance prepaid. Damage occurring during shipment is not covered by this warranty.

NOTE: No other warranty, written or oral, is authorized by Philips North America LLC.

This warranty gives you specific legal rights, and you may also have other rights which vary from state to state. Some states do not allow the exclusion or limitation of incidental or consequential damages, so the above exclusion and limitations may not apply to you.

*Read enclosed instructions carefully.

45-DAY MONEY-BACK GUARANTEE

To enjoy the closest and most comfortable shave from your new Philips Norelco Men's Shaver, the shaver should be used exclusively for 3 weeks. This allows your hair and skin enough time to adapt to the Philips Norelco Shaving System. If, after that period of time, you are not fully satisfied with your Philips Norelco Men's Shaver, send the product back along with dated sales receipt and we'll refund you the full purchase price.

The product must be shipped prepaid by insured mail, insurance prepaid, have the original sales receipt, indicating purchase price and date of purchase, and the money-back guarantee return authorization form enclosed.

We cannot be responsible for lost mail.

The product must be postmarked no later than 45 days after the date of purchase. Philips reserves the right to verify the purchase price of the product and limit refunds not to exceed suggested retail price.

To obtain money-back guarantee service, please go to www.PhilipsMoneyBack.com.

Delivery of refund check will occur 6–8 weeks after receipt of returned product.

Supplier's Declaration of Conformity



This device complies with part 15 of the FCC Rules. Operation is subject to the following two conditions: (1) This device may not cause harmful interference, and (2) this device must accept any interference received, including interference that may cause undesired operation.

We, PHILIPS CONSUMER LIFESTYLE B.V., hereby declare that the equipment bearing the model name specified below was tested conforming to the applicable FCC Rules under the most accurate measurement standards possible, and that all the necessary steps have been taken and are in force to assure that production units of the same equipment will continue to comply with the Commissions requirements.

Unique Identifier: PHILIPS, NORELCO S7788, S7786, S7783, S7782

Responsible Party – U.S. Contact Information
Philips North America LLC

P.O. Box 10313

Stamford | CT 06904

1-800-243-3050

Trademarks

Apple, the Apple logo, iPad, and iPhone are trademarks of Apple Inc., registered in the U.S. and other countries. App Store is a service mark of Apple Inc.

Android is a trademark of Google Inc. Google Play and the Google Play logo are trademarks of Google Inc.

The Bluetooth® word mark and logos are registered trademarks owned by the Bluetooth SIG, Inc. and any use of such marks by Philips Personal Care is under license.

— |

| —

— |

| —

— |

| —

— |

| —

— |

| —

— |

| —

Manufactured for:
Philips Personal Health
a division of Philips North America LLC
P.O. Box 10313, Stamford, CT 06904



This symbol on the product's nameplate means it is listed
by Underwriters' Laboratories, Inc.

Norelco and Tripleheader are registered trademarks of Philips
North America LLC.

PHILIPS and Philips shield are registered trademarks of
Koninklijke Philips N.V.

©2021 Philips North America LLC. All rights reserved.

4222.002.5610.1 (1/11/2021)



>75 % recycled paper
>75 % papier recyclé