



Certified for

Microsoft Teams

WH64 Mono & WH64 Dual DECT Wireless Headset



Quick Start Guide



Please update the headset to the latest version via Yealink USB Connect (PC) or Yealink Connect (APP) before using.

Notes

1. The signal range of Bluetooth headset typically spans around 10 meters. Please ensure the distance between your device and the headset is close to prevent signal interruption or degradation.
2. It is advised to minimize proximity to other Bluetooth devices or wireless signal sources, such as Wi-Fi routers, to reduce the likelihood of interference.
3. Please do not place any metal and magnetic cards on the charging stand to avoid abnormalities and damage to the charger.
4. Please do not charge too far away from the charging sign to get a more efficient charging experience.

Safety Guide

1. Do not disassemble the product by yourself or bring it near fire and water to avoid short circuit leakage or damage to the product.
2. Do not use the product in high temperature, humidity, and corrosive environment to avoid damaging the circuit and causing failure to charge or other failures.
3. Do not expose the product to corrosive liquids. Otherwise, it will cause severe damage.
4. Do not disassemble or re-equip the product for any reason to avoid secondary failure and burnout.
5. Do not place the product below -10°C or above 60°C .
6. Do not knock, throw or shake the product because rough methods will damage the internal circuit board structure.

1 Package List



WHD642 Headset

or



WHM641 Headset

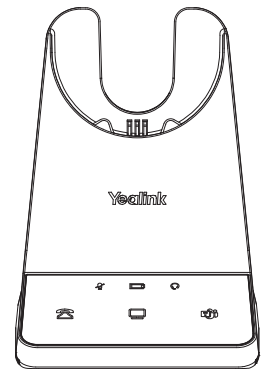

WHB640 Base

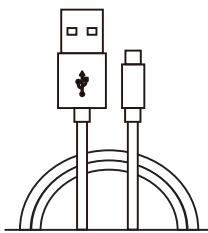

USB 3.0 Cable
(USB-A to USB-C)

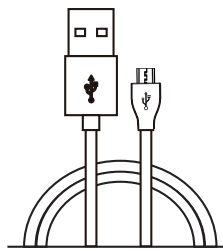

USB 2.0 Cable
(USB-A to USB-C)

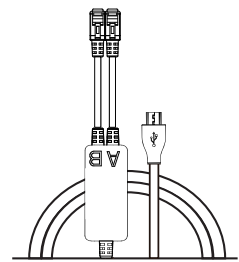

Telephone Cable

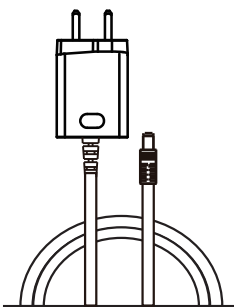

Power Adapter

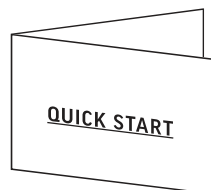

Quick Start Guide

Note: We recommend that you use the included accessories, and other accessories may have compatibility issues that prevent them from working properly.

2 Overview

 Microphone

 Teams button

 Voice Assistant button

 Call control

 Busylight

 Charging port



Volume + 

Next track 

Mute 

Volume - 

Previous track 

Power on/off 

Bluetooth 

3 Charging

USB Charging



Charging stand (optional)

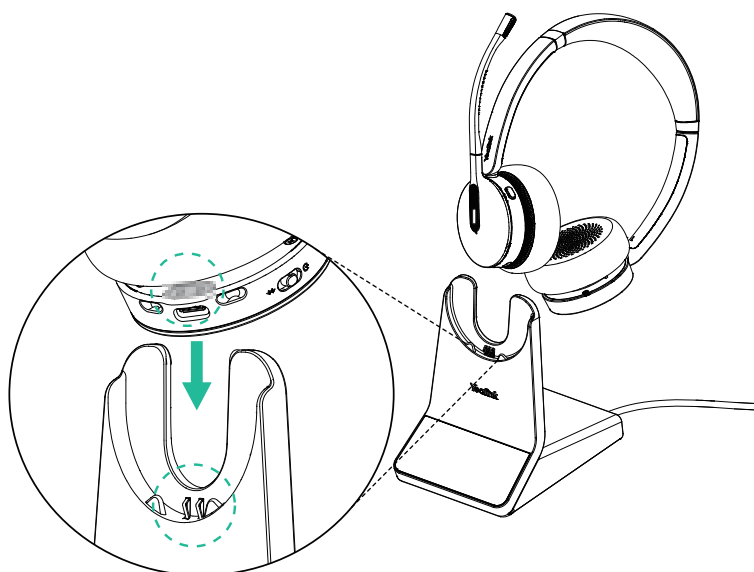

Note: We recommend to fully charge the headset when using it for the first time.

LED Indicator Status

Charging

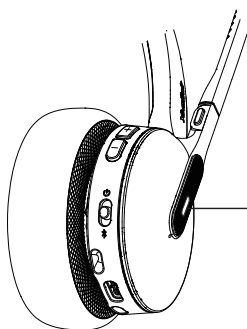

Breathing green LED indicator

Fully Charged

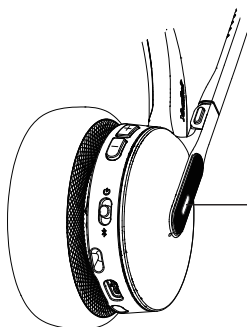





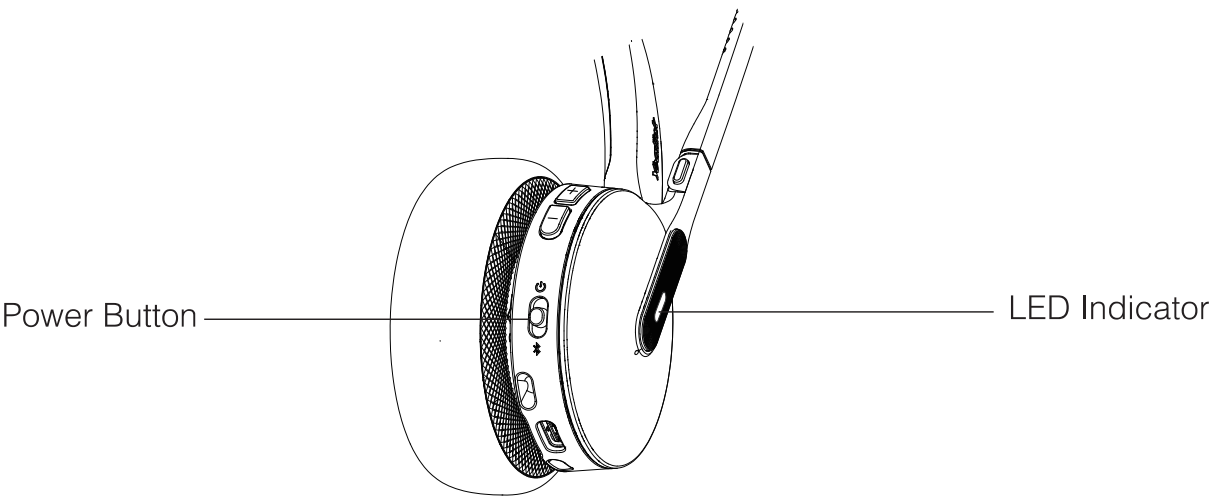

Solid green LED indicator

Note: It takes 1.5 hours to fully charge the headset.

4 Power on/off



Power Button	LED Indicator	Prompt Sound
 →  Power on	Solid green for 2 seconds	 "power on, battery low/medium/high"
 →  Power off	solid red for 2 seconds	 "power off"

5 Connecting Device

Using the diagram, connect your headset system.

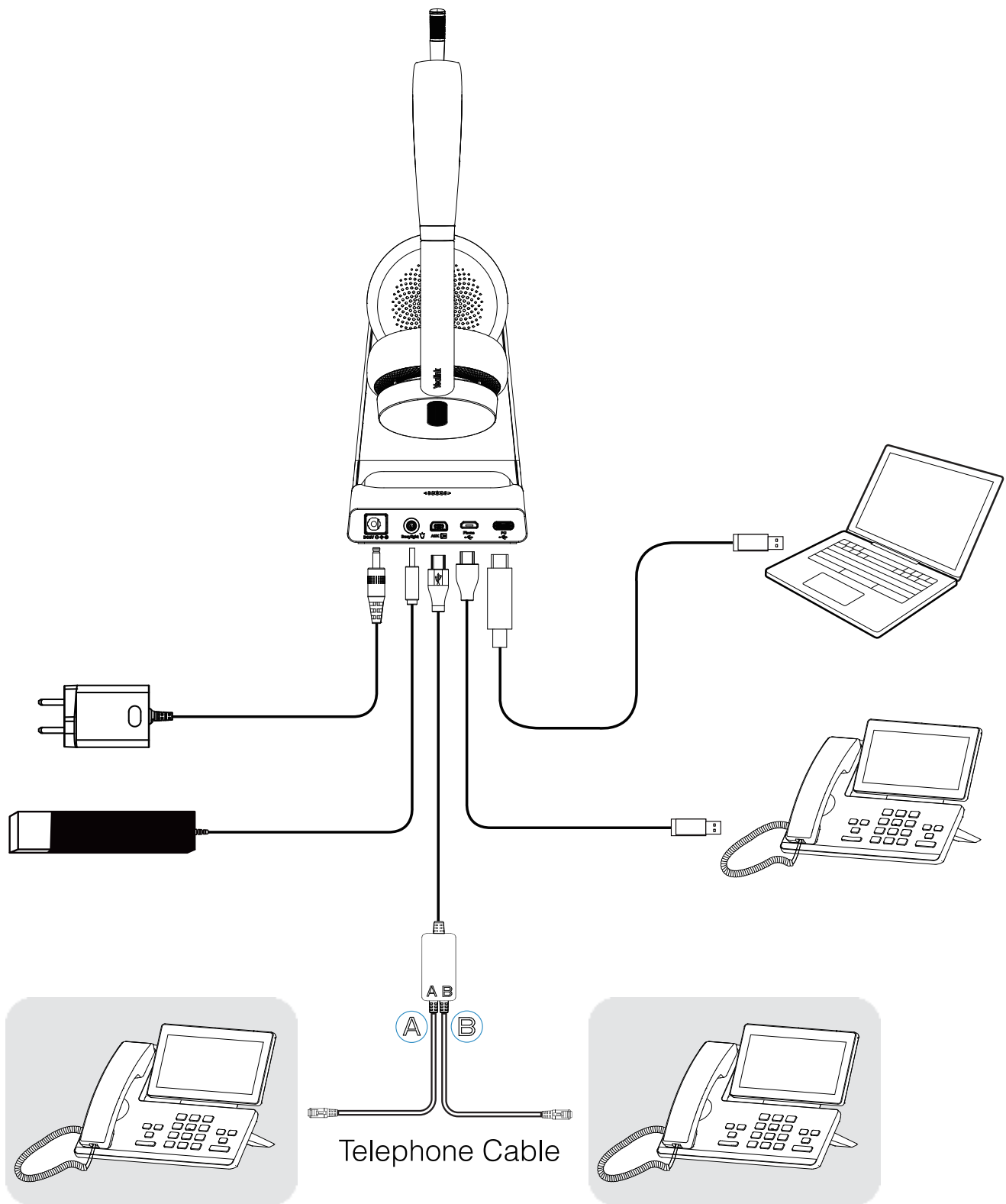

6 Call & Music Control

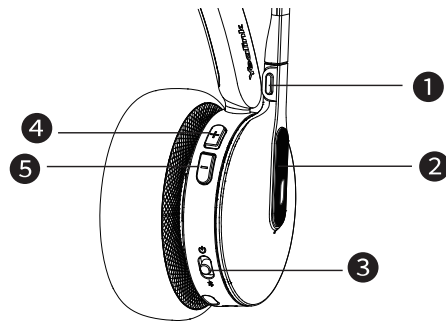

Item	Headset Action
Mute/unmute call	Press ❶ .
Volume up/down	Press ❹ / ❺ .
Answer call	Press ❷ .
End call	Press ❷ .
Reject call	Double-press ❷ .
Hold/unhold call	<ul style="list-style-type: none"> - Press ❷ for 2 sec to hold call. - Press ❷ for 2 sec or press once to unhold call.
Redial	Double-press ❷ .
Put the current call on hold and answer an incoming call	Double-press ❷ .
Reject the incoming call and continue the active call	Double-press ❷ .
Accept the incoming call and end the active call	Press ❷ .
Switch between held call and active call	Press ❷ for 2 sec.

7 Fit Headset

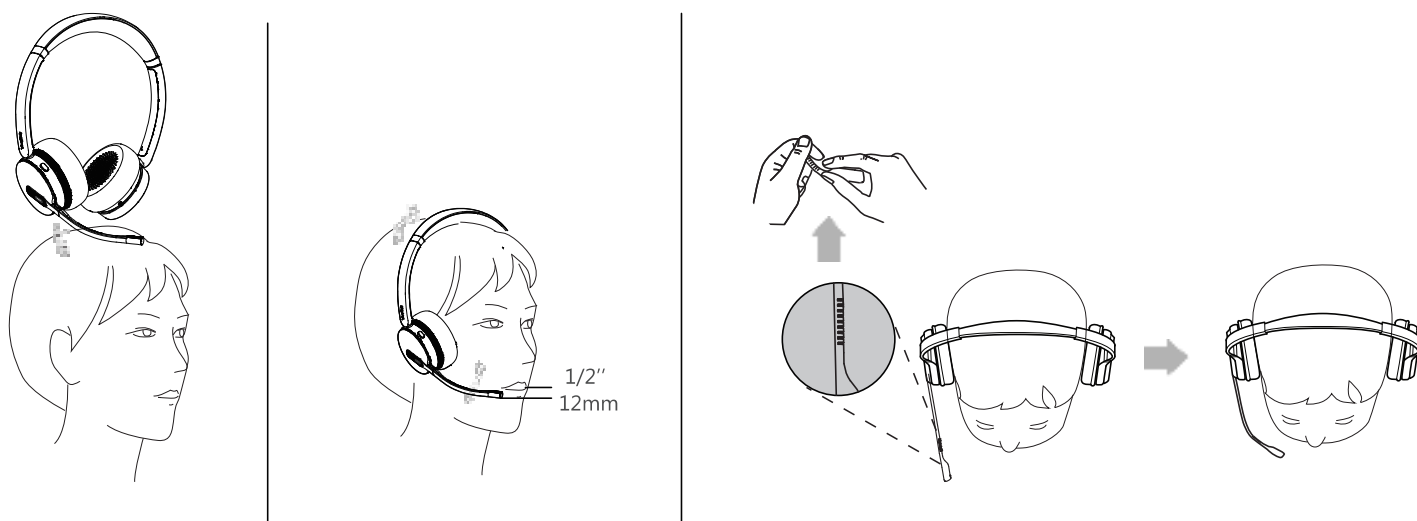

8 Replace Ear Cushions

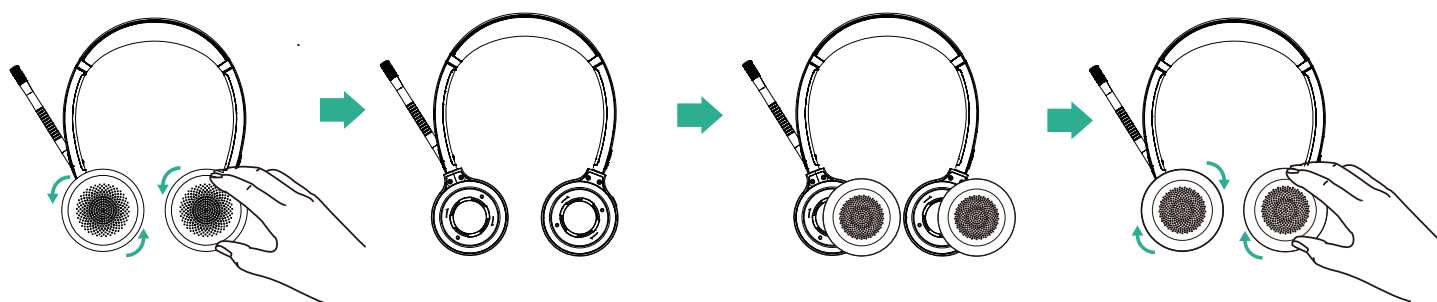

9 Software Management

- **Yealink USB Connect (PC)**

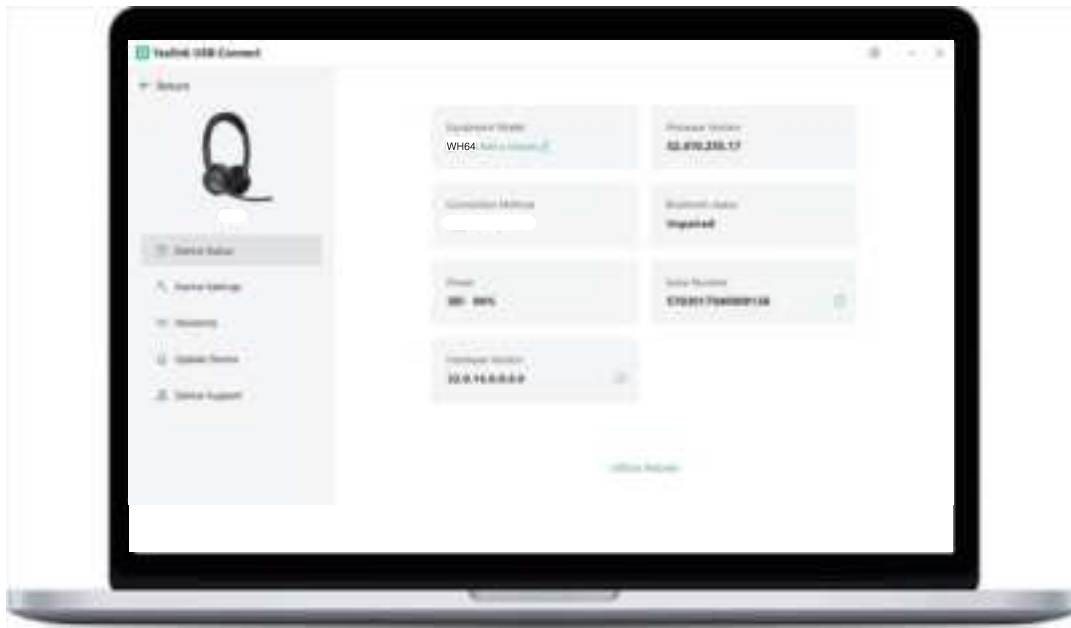

Download it from the Yealink website <https://www.yealink.com/product/yuc>.

Note: It needs to be used with Yealink USB Connect of version 0.36.x.x or later.

- **Yealink Connect App (Mobile)**

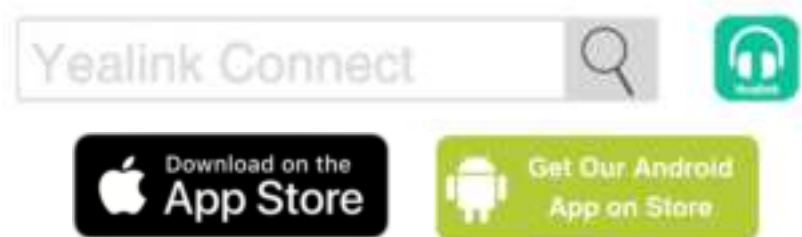

Apple and the Apple logo are trademarks of Apple Inc.

Download the Yealink Connect App from IOS App Store or Android App Store.

Regulatory Notices

Operating Ambient Temperatures

- Operating temperature: +14 to 113°F (-10 to 45°C)
- Relative humidity: 5% to 90%, noncondensing
- Storage temperature: -22 to +160°F (-30 to +70°C)

Warranty

Our product warranty is limited only to the unit itself, when used normally in accordance with the operating instructions and the system environment. We are not liable for damage or loss resulting from the use of this product, or for any claim from a third party. We are not liable for problems with Yealink device arising from the use of this product; we are not liable for financial damages, lost profits, claims from third parties, etc., arising from the use of this product.

Explanation of the symbols

- DC symbol
 is the DC voltage symbol.
- WEEE Warning symbol



To avoid the potential effects on the environment and human health as a result of the presence of hazardous substances in electrical and electronic equipment, end users of electrical and electronic equipment should understand the meaning of the crossed-out wheeled bin symbol. Do not dispose of WEEE as unsorted municipal waste and have to collect such WEEE separately.

Restriction of Hazardous Substances Directive (RoHS)

This device complies with the requirements of the EU RoHS Directive. Statements of compliance can be obtained by contacting support@yealink.com.

Safety Instructions

Save these instructions. Read these safety instructions before use!



General Requirements

- Before you install and use the device, read the safety instructions carefully and observe the situation during operation.
- During the process of storage, transportation, and operation, please always keep the device dry and clean, avoid collision and crash.
- Please attempt not to dismantle the device by yourself. In case of any discrepancy, please contact the appointed maintenance center for repair.
- Please refer to the relevant laws and statutes while using the device. Legal rights of others should be respected as well.



Environmental Requirements

- Do not cover ventilation openings, this equipment is not intended to be used on soft support.
- The marking information is located at the exterior of the bottom
- Place the device at a well-ventilated place. Do not expose the device under direct sunlight.
- Keep the device dry and free of dusts.
- Do not place the device on or near any inflammable or fire-vulnerable object, such as rubber-made materials.
- Keep the device away from any heat source or bare fire, such as a candle or an electric heater.



Operating Requirements

- Do not let a child operate the device without guidance.
- Do not let a child play with the device or any accessory in case of accidental swallowing.
- Please use the accessories provided or authorized by the manufacturer only.
- Do not spill liquid of any kind on the product or use the equipment near water, for example, near a bathtub, washbowl, kitchen sink, wet basement or near a swimming pool.
- When there is smoke emitted from the device, or some abnormal noise or smell, disconnect the device from the power supply, and unplug the power plug immediately.
- Contact the specified maintenance center for repair.
- Do not insert any object into equipment slots that is not part of the product or auxiliary product.



Battery Requirements

- Do not immerse the battery into water, which could short-circuit and damage the battery.
- Do not expose the battery to an open flame or leave the battery where it could be subjected to extremely high temperatures, which could cause the battery to explode.
- Do power the handset off before removing the battery.
- Do not try to use the battery for the power supply of any device other than this handset.
- Do not open or mutilate the battery, released electrolyte is corrosive and may cause damage to your eyes or skin.
- Use only the rechargeable battery pack delivered with the handset or those rechargeable battery packs expressly recommended by Yealink.
- Defective or exhausted battery should never be disposed of as municipal waste. Return old battery to the battery supplier, a licensed battery dealer or a designated collection facility.



Cleaning Requirements

- Use a piece of soft, dry and anti-static cloth to clean the device.

Troubleshooting

The usage environment is out of operating temperature range.

1. Use in the operating temperature range.

The cable between the unit and the Yealink device is connected incorrectly.

1. Connect the cable correctly.

You cannot connect the cable properly.

1. You may have connected a wrong Yealink device.
2. Use the correct power supply.

Some dust, etc., may be in the port.

1. Clean the port.

Contact your dealer or authorized service facility for any further questions.

FCC CAUTION:

This device complies with part 15 of the FCC Rules. Operation is subject to the following two conditions: (1) This device may not cause harmful interference, and (2) this device must accept any interference received, including interference that may cause undesired operation. Any changes or modifications not expressly approved by the party responsible for compliance could void the user's authority to operate the equipment.

Note: This equipment has been tested and found to comply with the limits for a Class B digital device, pursuant to part 15 of the FCC Rules. These limits are designed to provide reasonable protection against harmful interference in a residential installation. This equipment generates, uses and can radiate radio frequency energy and, if not installed and used in accordance with the instructions, may cause harmful interference to radio communications. However, there is no guarantee that interference will not occur in a particular installation. If this equipment does cause harmful interference to radio or television reception, which can be determined by turning the equipment off and on, the user is encouraged to try to correct the interference by one or more of the following measures:

- Reorient or relocate the receiving antenna.
- Increase the separation between the equipment and receiver.
- Connect the equipment into an outlet on a circuit different from that to which the receiver is connected.
- Consult the dealer or an experienced radio/TV technician for help.

ISED WARNING:

This device complies with Innovation, Science and Economic Development Canada licence-exempt RSS standard(s). Operation is subject to the following two conditions: (1) this device may not cause interference, and (2) this device must accept any interference, including interference that may cause undesired operation of the device. Le présent appareil est conforme aux CNR d'Industrie Canada applicables aux appareils radio exempts de licence. L'exploitation est autorisée aux deux conditions suivantes : (1) l'appareil ne doit pas produire de brouillage, et (2) l'utilisateur de l'appareil doit accepter tout brouillage radioélectrique subi, même si le brouillage est susceptible d'en compromettre le fonctionnement.

This Class B digital apparatus complies with Canadian ICES-003. Cet appareil numérique de la classe B est conforme à la norme NMB-003 du Canada. Les communications effectuées au moyen de cet appareil ne sont pas nécessairement protégées des indiscretions.

EU Regulatory Information

Support Frequency Bands and Power:

Bluetooth 2.4GHz < 20 dBm

Contact Information

YEALINK NETWORK TECHNOLOGY CO., LTD.

No.666 Hu'an Rd, Huli District Xiamen City, Fujian, P.R.C

YEALINK (EUROPE) NETWORK TECHNOLOGY B.V.

Keizersgracht 62, 1015CS Amsterdam

YEALINK (USA) NETWORK TECHNOLOGY CO., LTD.

999 Peachtree Street Suite 2300, Fulton, Atlanta, GA, 30309, USA

Made in China

About Yealink

Yealink (Stock Code: 300628) is a global-leading provider of Unified Communication & Collaboration Solutions specialized in video conferencing, voice communications, and collaboration, dedicated to helping every person and organization embrace the power of "Easy Collaboration, High Productivity".

With best-in-class quality, innovative technology, and user-friendly experiences, Yealink is one of the best providers in more than 140 countries and regions, ranks No.1 in the global market share of IP Phone, and is the Top 5 leader in the video conferencing market (Frost & Sullivan, 2021).

Copyright

Copyright © 2023 YEALINK(XIAMEN) NETWORK TECHNOLOGY CO., LTD.

All rights reserved. No parts of this publication may be reproduced or transmitted in any form or by any means, electronic or mechanical, photocopying, recording, or otherwise, for any purpose, without the express written permission of Yealink(Xiamen) Network Technology CO., LTD.

Need more help?



Yealink Knowledge
Base



Yealink Documentation
& Video



Yealink Headset
Compatibility Guide

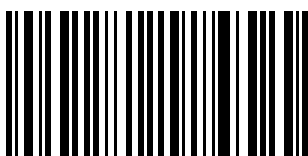

430104002481

YEALINK(XIAMEN) NETWORK TECHNOLOGY CO.,LTD.

Web: www.yealink.com

Copyright©2023YEALINK(XIAMEN) NETWORK
TECHNOLOGY CO.,LTD. All rights reserved.

Radiation Exposure Statement

For Base:

This equipment complies with FCC and IC radiation exposure limits set forth for an uncontrolled environment. This equipment should be installed and operated with minimum distance 20cm between the radiator and your body.

Cet émetteur ne doit pas être Co-placé ou ne fonctionnant en même temps qu'aucune autre antenne ou émetteur. Cet équipement devrait être installé et actionné avec une distance minimum de 20 centimètres entre le radiateur et votre corps.

For Headset:

The device has been tested and comply with FCC/ISED SAR limits.

L'Unité a été testée et répond aux limites FCC/ISED SAR.

This device meets HAC and CS03 Part V.

This device meets the applicable Innovation, Science and Economic Development Canada technical specifications.

Ce produit répond à la innovation, des sciences et de Développement économique Canada spécifications techniques applicables.

FCC part 68 Warning

1. This equipment complies with Part 68 of the FCC rules and the requirements adopted by the ACTA. On the bottom of this equipment is a label that contains, among other information, a product identifier in the format US: T2LIPNANMP56E2. If requested, this number must be provided to the telephone company.
2. A plug and jack used to connect this equipment to the premises wiring and telephone network must comply with the applicable FCC Part 68 rules and requirements adopted by the ACTA. A compliant telephone cord and modular plug is provided with this product. It is designed to be connected to a compatible modular jack that is also compliant. See installation instructions for details.
3. If this equipment [US: T2LIPNANMP56E2] causes harm to the telephone network, the telephone company will notify you in advance that temporary discontinuance of service may be required. But if advance notice isn't practical, the telephone company will notify the customer as soon as possible. Also, you will be advised of your right to file a complaint with the FCC if you believe it is necessary.
4. The telephone company may make changes in its facilities, equipment, operations or procedures that could affect the operation of the equipment. If this happens the telephone company will provide advance notice in order for you to make necessary modifications to maintain uninterrupted service.
5. If trouble is experienced with this equipment [US: T2LIPNANMP56E2], for repair or warranty information, Service can be facilitated through our office at:

U.S. Agent Company name: **888VoIP / American Technologies, LLC**

Address: **611 Jamison Rd Suite 1059 Elma NY 14059 USA**

Tel: **+1 716-714-8002**

If the equipment is causing harm to the telephone network, the telephone company may request that you disconnect the equipment until the problem is resolved.

6. Please follow instructions for repairing if any (e.g. battery replacement section); otherwise do not alternate or repair any parts of device except specified. For repair procedures, follow the instructions outlined under the limited warranty.
7. Connection to party line service is subject to state tariffs. Contact the state public utility commission, public service commission or corporation commission for information.
8. If your home has specially wired alarm equipment connected to the telephone line, ensure the installation of this [IP] does not disable your alarm equipment. If you have questions about what will disable alarm equipment, consult your telephone company or a qualified installer.
9. If the telephone company requests information on what equipment is connected to their lines, inform them of:
 - a) The ringer equivalence number [NAN]
 - b) The USOC jack required [N/A]
 - c) Facility Interface Codes ("FIC") [N/A]

- d) Service Order Codes (“SOC”) [N/A]
 - e) The FCC Registration Number [US: T2LIPNANMP56E2]
10. The REN is used to determine the number of devices that may be connected to a telephone line. Excessive RENs on a telephone line may result in the devices not ringing in response to an incoming call. In most but not all areas, the sum of RENs should not exceed five (5.0). To be certain of the number of devices that may be connected to a line, as determined by the total RENs, contact the local telephone company. The REN for this product is part of the product identifier that has the format US: T2LIPNANMP56E2. The digits represented by ## are the REN without a decimal point. For this product the FCC Registration number is [US: T2LIPNANMP56E2] indicates the REN would be NAN.
11. We suggest the customers use a surge arrestor to protect the device.