

FCC Statement

Changes or modifications not expressly approved by the party responsible for compliance could void the user's authority to operate the equipment.

This equipment has been tested and found to comply with the limits for a Class B digital device, pursuant to Part 15 of the FCC Rules. These limits are designed to provide reasonable protection against harmful interference in a residential installation. This equipment generates uses and can radiate radio frequency energy and, if not installed and used in accordance with the instructions, may cause harmful interference to radio communications. However, there is no guarantee that interference will not occur in a particular installation. If this equipment does cause harmful interference to radio or television reception, which can be determined by turning the equipment off and on, the user is encouraged to try to correct the interference by one or more of the following measures:

- Reorient or relocate the receiving antenna.
- Increase the separation between the equipment and receiver.
- Connect the equipment into an outlet on a circuit different from that to which the receiver is connected.
- Consult the dealer or an experienced radio/TV technician for help

This device complies with part 15 of the FCC rules. Operation is subject to the following two conditions

(1) this device may not cause harmful interference, and (2) this device must accept any interference received, including interference that may cause undesired operation.

NOBLE

True Wireless Stereo Earbuds

Model: FALCON MAX

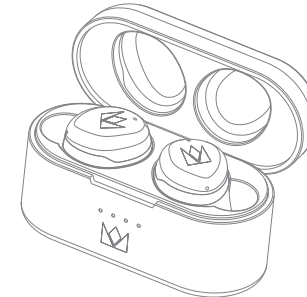

Thanks for purchasing Noble FALCON MAX bluetooth 5.3 true wireless earbuds.
Please read carefully the instruction manual before use.

Packing List



Noble FALCON MAX TWS Earbuds x 1 set

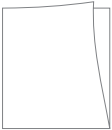

Instruction Manual x 1



Ear tips x 3 pairs



USB charging cable x 1

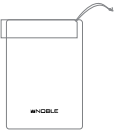

Storage bag x1

Product Overview

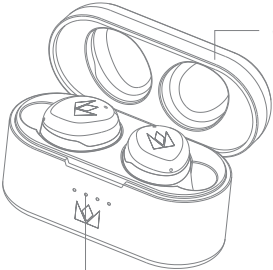

Charging case

LED light



Charging port



Earbuds LED light

Multifunction button (MFB)

Microphone

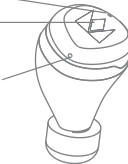

Power On

Before first use, please charge your Noble FALCON MAX TWS Earbuds to make sure there is sufficient charge for pairing and use.

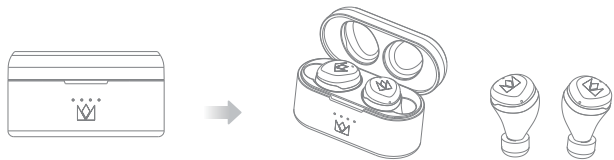

1. If there is sufficient charge, take out the earbuds from the charging case, the earbuds will be power on automatically. The white indicator light will light up for one second.

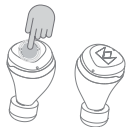

2. If the earbuds are power off, press both earbuds MFB button lightly to boot up, you will hear a "Power on" voice prompt.

Note: The earbuds will enter ANC mode automatically when turned on.

Power Off

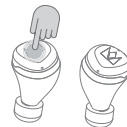

1. To turn off the earbuds, long press the MFB button for 5 seconds to hear "dong-dong dong" and release, you will hear a "Power off " voice prompt. The orange indicator light will light up for one second.

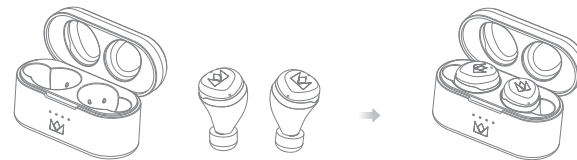

2. If the charging case has sufficient charge, the earbuds will automatically turn off when placed in the charging case after fully charged.

How to Pairing



Method 1

1. Take out the earbuds from the charging case, the earbuds will automatically power on and enter pairing mode with orange and white indicator lights twinkling alternately. .
2. Enable the bluetooth of your phone to search "FALCON MAX" and then click it for pairing, they will be connected.

Method 2

1. When the earbuds are not connected and in standby mode, double-tap the left or right MFB, they will enter pairing mode with orange and white indicator lights twinkling alternately.
2. Enable the bluetooth of your phone to search "FALCON MAX" and then click it for pairing, it will be connected.

Note: 1. If the earbuds are connected to one device already, put the earbuds into the charging case and take out, the earbuds will connect the device automatically;
If the connection is unsuccessful, the earbuds will go into pairing mode automatically.
2. Disconnect the earbuds from the connected device, the earbuds will go into pairing mode automatically.

Product Overview

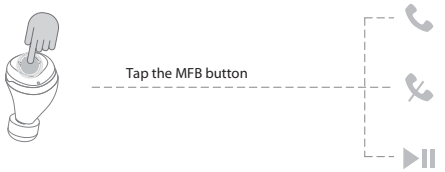

Mode	Function	L	R
Music	Play	Single tap	
	Pause	Single tap	
	Next Track	-	Double tap
	Previous Track	-	Triple tap
Phone	Answer Call	Single tap	
	Hang Up	Single tap	
	Reject Call	Long press for 1 second	
Siri	Enable	Long press for 2s to hear "dong" and release	-
Volume	Up +	Triple tap	-
	Down -	Double tap	-
Hear Through	Enable	-	Long press for 2s to hear "dong" and release
ANC	Enable / Disable	-	Long press for 2s to hear "dong" and release

Reset

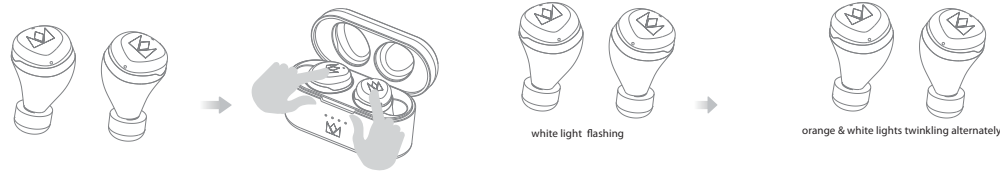

When the charging case has sufficient charge, put your earbuds into the charging case and make sure its orange LED light is on. Then press and hold the left and right MFB for 10s and release, you will see the orange light is off and the white light is on; Then take out the earbuds from the charging case, you will notice the white light flashing quickly, and few seconds later, the earbuds will enter pairing mode with one earbud's white and orange lights flashing alternately.

(Note: When only one earbud's white light flash quickly or only one earbud can be connected or the earbuds can not be used normally, you can try this reset method to restore.)

Hear-through function & ANC function



<Active Noise Cancellation (ANC) Mode>

When both earbuds are turned on, the earbuds will enter ANC mode automatically.

< Hear-through mode>

After entering ANC mode, press and hold the right MFB for 2s to hear "dong" and release, you will hear a "Ambient Mode" voice prompt, that means hear-through mode on. Then press and hold for 2s again to hear "dong" and release, you will hear a "Noise canceling off" voice prompt, that means both hear-through and ANC mode are off.

Switch in the order : ANC On → Hear-through mode → Off

Note: The noise reduction function (ANC) is only available when both earbuds are used at the same time.

The LED Indicator for FALCON MAX

User Scenario	LED
Power on	White LED light is on for 1 second
Standby (both connected and disconnected)	White LED flashes twice every 5 seconds
Pairing	White and orange LED lights flash alternatively
Reset	White LED flash quickly → orange & white LED twinkling → reset done
Power off	Orange LED light on for 1 second
Charging	Orange LED on
Full charged	Orange LED off
Battery low	Orange LED light flashes twice every second

Charging Case Button Fuction

Before use, please ensure the charging case has sufficient charge, and put both earbuds into the charging case and make sure its orange LED light is on.



Charging Case Button Operation	Function
Click once	The charging case LEDs will indicate the current battery level of the charging case.
Double click	The earbuds will enter pairing mode
Press and hold for 8s	The earbuds will be reset successfully.

Note: The above functions cannot be realised when the charging case is charged.

Charging

■ Battery Indicator :

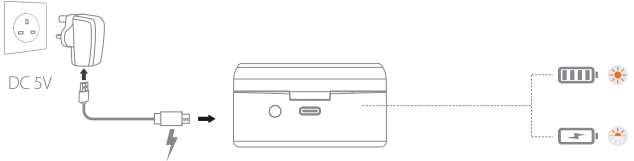

● ● ● ● 0% - 25%	● ● ● ● 25% - 50%
● ● ● ● 50% - 75%	● ● ● ● 75% - 100%

Case Charging		Earbuds Charging	
Charging	White LED ON	Charging	Orange LED ON
Fully Charged	All LED On	Fully Charged	Orange LED Off

Specification

Product Model	FALCON MAX
Bluetooth Version	Bluetooth V5.3
Driver Unit	MEMS Driver & $\phi 10$ Dynamic Driver
Frequency Response	20Hz~40KHz
Sensitivity	104 \pm 2dB
Impedance	16 \pm 15 % Ω
Bluetooth Profile	A2DP/AVRCP/HFP/SPP
Bluetooth Codec	SBC/AAC/aptX-Lossless/LDAC/aptX Adaptive 24/96kHz & Lossless/aptX Adaptive low latency
Earbuds Battery	52mAh
Charging case Battery	550mAh
Playing time when ANC On (60% volume at AAC code)	
Playing time when ANC Off (60% volume at AAC code)	
Charging time of earbuds	≤ 2 hours
Charging time of charging case	USB cable: ≤ 2 hours; Wireless charging: ≤ 4 hours
Waterproof	IP54

Declarations and Warning

- Disconnect previous devices before pairing a new device.
- **WARNING!** Long-term exposure to high noise volumes may cause permanent hearing loss.
- Do not use the NOBLE FALCON MAX earbuds in locations prohibiting the use of electronic equipment.
- Consult your physician prior to using your NOBLE FALCON MAX earbuds if you have a pacemaker or other electrical medical device.
- This package may contain small parts, which may pose a hazard to small children.
- Do not disassemble the FALCON MAX as it contains lithium batteries, and disassembly could result in electric shock or fire or serious injury.
- Any disassembly of the FALCON MAX, or attempt to replace or repair the FALCON MAX by an unauthorized person, will void the NOBLE Falcon's warranty.
- This product is not designed for use in water, keep product away from water and liquids. Failure to do so may cause permanent damage to the product.

Label

