



PD 515

DOG TRAINING COLLAR

User Guide

REF.NO.P20P25M01D14

CONTENTS

STATEMENT	01
SAFETY INSTRUCTION	01
REINFORCE LEARNING BEHAVIOURS	01
Tips	02
BEFORE USING THE DOG TRAINING COLLAR	02
WHEN USING THE DOG TRAINING COLLAR	02
PACKAGE CONTENTS	03
MAINTENANCE	03
SPECIFICATIONS	04
INTRODUCTION FOR THE BUTTONS	04
OPERATION AND CHARGING	05
How to choose USB charger	06
Charge the remote transmitter	06
Charge the receiver	06
Turn the receiver on and off	06
Check the receiver power	06
HOW TO WEAR RECEIVER COLLAR CORRECTLY	07
PAIRING AND TESTING	07
REFERENCE SIZE FOR DIFFERENT DOGS	08
FAQ	09
WARRANTY	11

STATEMENT

Thank you for purchasing the remote dog training collar PD 515, this product has been tested to meet your stringent quality standards, and also covered with warranty for 12 months from the date of its original purchase. Please contact us with your order ID and problem or issue, we will respond within 24 hours.

This warranty is void if the defect is caused by accidental damage, misuse, abuse, neglect, improper repair or alteration by unauthorized persons, or a failure to follow operating instructions provided with the product including adding essential oils directly into the tank and base.

This warranty does not apply to normal wear and tear or commercial use. In no event shall liability exceed the purchase price paid by the purchaser of the product. under no circumstances shall there be liability for any loss-direct, indirect or incidental-or consequential damage arising out of, or in connection with the use of the product.

SAFETY INSTRUCTION

Training collars are used to train the dogs and not for punishment. Use properly with care and the collar can be a safe and effective tool to train. Building communication and strengthen your bond with your best friend. Obey all safety messages that follow this instruction to avoid possible injury.

If your dog has heart disease, high blood pressure, cerebral thrombosis, skin allergies, etc., please do not use it.

REINFORCE LEARNING BEHAVIOURS

If your dog knows the command but responds inconsistently with your requirement, a training collar can sharpen his skill. For example, you have taught your dog to come when calling, but over time he responds slower. You can communicate with him via the remote transmitter, so that he respond to your call immediately.

1. Set the collar to initial stimulation level and test it.
2. Fit the collar on your dog's neck along with his regular collar.
3. Let him roam around the training area. Then give the command and press the stimulation button simultaneously .
4. If your dog moves toward you, stop the stimulation and praise him.

5. If he stops before he reaches you or turns away, repeat the command and continue the stimulation. Again, stop at the instant he runs to you and rewards him by praising him or feeding him a treat. Repeat this for 3 or 4 times.

Tips

1. If he doesn't get it for the first few times, don't give up and do not increase the stimulation. Try to work on this a few times.
 2. During the training period never give the command if you are not able to enforce it. Your dog has to make the mental connection between the static shock/vibration/tone to his behavior (may take a week or more for some dogs).
- Altogether, both methods of stopping unwanted behavior and reinforcing learning behaviors can be applied to nearly every training scenario.

BEFORE USING THE DOG TRAINING COLLAR

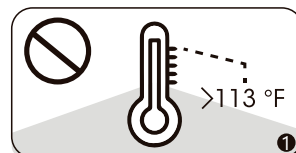

1. Do not expose to extreme heat or store at the temperatures above 113°F or 45°C.
2. Please always keep the dog training collar out of reach of children.
3. Charge the remote transmitter and receiver at least 2 hours when receive them. The collar can't receive any signals while it is being charged.

WHEN USING THE DOG TRAINING COLLAR

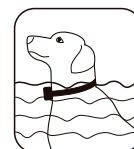

1. Avoid leaving the collar on the dog for more than 18 hours per day.
2. If possible, please reposition the collar on the dog's neck every 1 to 2 hours.

3. Check the fit to prevent excessive pressure.
4. The charging rubber cap must be closely covered when your dog is swimming or the receiver will get broken when getting into water from the interface. Taking off the receiver is recommended.
5. The receiver will turn off automatically after 10 seconds "beep" sound when battery is low.

PACKAGE CONTENTS

PD 515-1 (For 1 dog)

1 x Remote Transmitter	1 x Receiver
1 x Collar Strap	2 x Long Contact Points
1 x USB Charging Cable	2 x Short Contact Points
1 x Lanyard	1 x Test Lamp
2 x Long Conductive Silicone Caps	1 x User Manual
2 x Short Conductive Silicone Caps	

PD 515-2 (For 2 dogs)

1 x Remote Transmitter	2 x Receivers
2 x Collar Straps	4 x Long Contact Points
1 x Lanyard	4 x Short Contact Points
1 x USB Charging Cable	1 x Test Lamp
4 x Long Conductive Silicone Caps	1 x User Manual
4 x Short Conductive Silicone Caps	

PD 515-3 (For 3 dogs)

1 x Remote Transmitter	3 x Receivers
3 x Collar Straps	6 x Long Contact Points
1 x Lanyard	6 x Short Contact Points
1 x USB Charging Cable	1 x Test Lamp
6 x Long Conductive Silicone Caps	1 x User Manual
6 x Short Conductive Silicone Caps	

MAINTENANCE

1. Please examine regularly to ensure tightness of the receiver and eliminate any external damages.
2. Clean the screw caps with alcohol weekly.
3. Examine your dog's neck and clean up weekly.
4. The battery is rechargeable. In order to maintain battery life, please charge it every 2 months if it is not often used.

03

④ Charging Port Of The Remote Transmitter

⑤ LED Light

- ⑥ Power/Keylock Switch: Switch to turn the remote transmitter on or off, all keys function will be void except LED light when switch off.

Signal Channel Button: Press this button, choose channel 1, 2 or 3 as the signal channel of dog training before connecting the signals between remote transmitter and receiver.

⑦

Note:

PD 515-1: For 1 dog only, 1 receiver, you can choose any channel as the signal channel for training your dog, please remember the signal channel you choose, otherwise you have to connect the signal again when training your dog;

PD 515-2: For 2 dogs, 2 receivers, you can choose the same signal channel for the 2 receivers, or you can choose 2 different signal channels, please remember the signal channel of each receiver;

PD 515-3: For 3 dogs, 3 receivers, you can choose the same signal channel for the 3 receivers, or you can choose 3 different signal channels, please remember the signal channel of each receiver;

- ⑧ Static Shock Button: Press the static shock button and the receiver will emit a mild static shock.

- ⑨ Vibration Button: Press the vibration button and the receiver will vibrate.

- ⑩ Tone Button: Press the tone button and the receiver will emit a tone, with 9 tone types to choose from.

- ⑪ Contact Points: Choose a suitable length to fit for different thickness of dog's hair.

Power Button Of The Receiver

- ⑫ Indicator Light Of The Receiver

⑬

OPERATION AND CHARGING

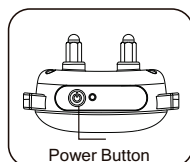
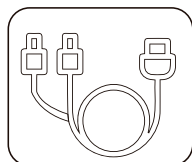

05

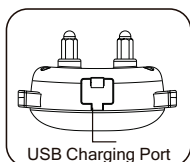

USB Charging Port

SPECIFICATIONS

Model	PD 515
Function	Training Dogs
Working Modes	Tone, Vibration, Static Shock
Tone Modes	9 Tone Types
Static Shock Levels	1-16 Levels
Vibration Levels	1-9 Levels
Net Weight	Remote Transmitter: 91g Receiver: 52g
Channels	3 Channels
Remote Range	1000m /1100yds/3300ft
Battery Capacity	Remote Transmitter: 300mAh Receiver: 650mAh
Working Time	Remote Transmitter: 180 days Receiver: 25-40 days
Waterproof Level	Remote Transmitter: IPX3 Receiver: IPX7

INTRODUCTION FOR THE BUTTONS

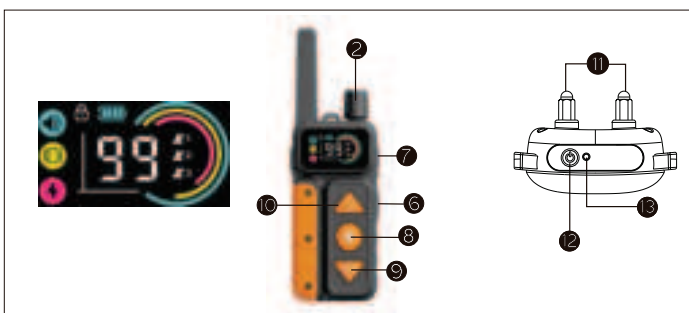

- ① LED Light Button

- ② The +/- Button: Increase or decrease the vibration and static shock level, or change the 9 tone types.

- ③ Static Shock Double Level Button: Press this button and the receiver will emit double level static shock.

04

How to choose USB charger

Please choose the USB charger with the parameters below (we can charge the device by the charger of smart phone or laptop/computer USB interface, before that please check if the charger is with the following parameters):

Input: 100-240V ~ 50-60Hz

Output: 5V 1000mA (or 300mA/500mA)

Charge the remote transmitter

1. Connect the charger cable to the charging port.
2. Plug the charger into a standard socket.
3. The battery icon will flash during charging and be solid when charging is completed.

Charge the receiver

1. Remove the rubber cover, connect the receiver to a charger into a standard socket.
2. The red indicator will flash slowly when the receiver is charging, and the green indicator will stay on after it is fully charged.

Turn the receiver on and off

1. Turn On: Press the power button once, the receiver will make a short "beep" sound, means that the receiver is turned on.
2. Turn Off: Press the power button once, the receiver will make a long "beep" sound and the indicator light is not flash any more.

Check the receiver power

When the receiver is turned on, press the power button twice quickly to check the power:

Receiver beeps 5 times, representing 100% (80-100%)

Receiver beeps 4 times, representing 80% (60-80%)

Receiver beeps 3 times, representing 60% (40-60%)

Receiver beeps 2 times, representing 40% (20-40%)

Receiver beeps 1 time, representing 20% (1-20%)

06

HOW TO WEAR RECEIVER COLLAR CORRECTLY

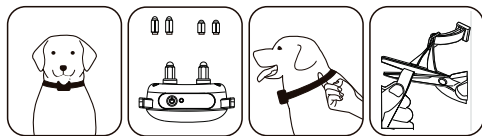

Wearing the correct position helps healthy and effective dog training.

1. The receiver shall be placed at the bottom of dog's neck, and the screw caps must contact the dog's skin directly.
2. If your dog has thick hair, please use longer screw caps.
3. The space between receiver collar and the dog's neck shall be maintained to a finger distance, which can't be too loose, otherwise static shock effectiveness shall be badly influenced.
4. The extra part of the strap can be trimmed, or be handled with other methods.

PAIRING AND TESTING

How to pair the remote transmitter and receiver

1. Turn on the remote transmitter, press the (CH) button to choose a signal channel you want to use.
2. Hold power button on the receiver for 2 seconds, when the indicator light keeps flashing, press one of the function button like tone, vibration or static shock on remote transmitter to pair.
3. If you do not press the function button within 10 seconds, please pair them again.
4. If you have multiple receivers, you can choose the same signal channel or choose different channel for pairing.

Test the dog training collar

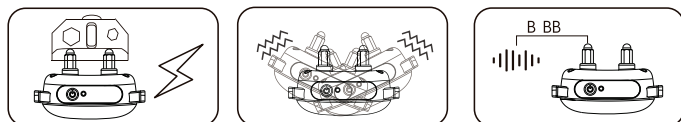

07

1. Static shock function test

Static shock function can not be seen with the naked eye, please use our test lamp. Press the static shock function button, the test lamp will blink.

2. Vibration function test

Press the vibration function button, the receiver will vibrate.

3. Tone function test

Press the tone button, the receiver will emit a tone.

1. You need to pair the remote transmitter and receiver before using it on the dog. Please follow the manual for the first time use.
2. Please remember the channel you choose and do not change to other one, or the receiver will not receive signals.
3. When the remote transmitter is turned off, all the functions are locked except LED light function.

REFERENCE SIZE FOR DIFFERENT DOGS

Reference weight for dogs

Large Dog (Body height above 24 inch, Weight above 88 lbs)

Medium Dog (Height 16-24 inch, Weight 24.2-66 lbs)

Small Dog (Height 10-16 inch, Weight 8.8-22 lbs)

Mini Dog (Height under 10 inch, Weight under 8.8 lbs)

Size (Dog)	Neck (In)	Chest Measurement (In)	Back Length (In)	Type
Mini	7.8-8.6	9.8-11.8	17.5	Chihuahua, Yorkshire Terrier
Small	7.8-9.5	11.4-14.2	9	Chihuahua, Yorkshire Terrier, Poodle, Pomeranian
Medium	9.0-11.0	13.7-16.5	11	Maltese Dog, Shih Tzu
Large	9.6-12.2	16.2-18.5	12.2	Miniature Schnauzer, Pekingese
Large	11.8-13.4	18.1-20.8	13.8	Schnauzer, English Cocker Spaniel
Large	13.0-14.5	20.5-23.2	15.7	Beagle
Huge	17.0-18.9	30.0-33.0	23.6	Husky

08

FAQ

Q: How old my dog can use dog training collar?

A: DO NOT use on puppies younger than 6 months.

Q: Can I use dog training collar for more than one dog?

A: Yes, you can simply add one or two receiver collars to the system to control two or three dogs, because three dog channels are available with one remote transmitter.

Q: What should I do if my dog's neck becomes red and irritated?

A: Stop using the dog training collar for a few days. If the condition persists beyond 48 hours, please ask your veterinarian to check. Continue to monitor your dog's skin condition closely even if the skin becomes normal.

Q: Can I attach a leash to the receiver?

A: NO. This will result in pulling the screw caps (contact points) too tightly against your dog's neck. Use a separate collar placed above the receiver.

Q: How do I know when to charge the batteries of the dog training collar?

A: For Remote Transmitter: The battery level icon will be displayed on the LCD screen. For Receiver: press the power button twice quickly to check the battery level, if only one beep is emitted, charge it in time.

Q: How long can I leave receiver on my dog?

A: The receiver collar is not designed to be worn constantly. We recommend to wear the collar on your dog less than 18 hours per day.

Q: How long should I process my training session for my dog?

A: Training sessions should be kept positive and short, it is better for about 10-15 minutes each time.

Q: What are the proper levels of static shock for my dog?

A: Try to find the best suitable levels of static shock for your dog starting from the lowest level. Excessive levels of stimulation will cause strong response from your dog.

Q: What is the effective distance of your dog training collar?

A: Without obstacles, the effective distance could be as far as 1000 meters between remote transmitter and receiver collar. However in reality, a list of factors, including telecom signal station, magnetic field, obstacle, battery volume, other wireless devices nearby, land form, vegetative cover, etc, will influence transmission of signals from remote transmitter and the actual effective distance of the remote transmitter.

Q: Once my dog is trained and has obeyed to my commands, is it still necessary for my dog to continue wearing the receiver?

A: Yes, you may need to reinforce your dog's memory with the receiver from time to time.

Q: Any other better training methods?

A: You can prepare some dog food for training incentive to achieve better training outcomes. Each time after you restrain your dog's misbehavior, you can tell your dog what is supposed to do and what is not. And after a few times of repetitions, your dog will understand what you like and what you don't like.

Q: I want to test static shock function of receiver myself, but it does not work, is anything wrong?

A: If you test receiver collar by your hand or leg, please touch the 2 screw caps (contact points) at the same time, touching only one screw cap (contact points) will not work.

09

10

Q: The dog training collar does not work, or my dog does not respond after correct installation of the dog training collar, how should I solve this problem?

- 1. Make sure the battery of remote transmitter and receiver collar have enough power to operate.
- 2. Check to see if receiver collar is turned on.
- 3. Check signal channel button on remote transmitter to ensure signal channels are correctly configured.
- 4. Try to pair the remote transmitter and receiver again.
- 5. Take off receiver collar and test all of the three functions work properly.
- 6. Make sure receiver collar is properly worn and the receiver collar is not loose.
- 7. Trim your dog's hair where the screw caps (contact points) can touch the neck.

WARRANTY

This product is covered with warranty for 12 months from the date of its original purchase.

Any defective part will be repaired or replaced at no charge if the appliance has not been tampered with and has been used according to these printed directions.

If any problems occur, please contact the local dealer immediately to launch a warranty claim. Our consumer service representative will respond within 1 business day, advise you how to correct the problem yourself or instruct you on how to return the defective unit back to us for repair or replacement.



FCC Caution:

This device complies with part 15 of the FCC Rules. Operation is subject to the following two conditions:

- (1) This device may not cause harmful interference, and
- (2) this device must accept any interference received, including interference that may cause undesired operation.

Any Changes or modifications not expressly approved by the party responsible for compliance could void the user's authority to operate the equipment.

Note: This equipment has been tested and found to comply with the limits for a Class B digital device, pursuant to part 15 of the FCC Rules. These limits are designed to provide reasonable protection against harmful interference in a residential installation.

This equipment generates uses and can radiate radio frequency energy and, if not installed and used in accordance with the instructions, may cause harmful interference to radio communications. However, there is no guarantee that interference will not occur in a particular installation. If this equipment does cause harmful interference to radio or television reception, which can be determined by turning the equipment off and on, the user is encouraged to try to correct the interference by one or more of the following measures:

- Reorient or relocate the receiving antenna.
- Increase the separation between the equipment and receiver.
- Connect the equipment into an outlet on a circuit different from that to which the receiver is connected.
- Consult the dealer or an experienced radio/TV technician for help.

The device has been evaluated to meet general RF exposure requirement. The device can be used in portable exposure condition without restriction.