

ROOF SPEAKER SYSTEM PRODUCT MANUAL

SKU: B0112-06311-BK
MODEL: KM-RWS-XP1

BEFORE YOU BEGIN

1. Please read the instructions carefully and verify that each item is in the list.
2. Please retain these installation instructions for further reference and parts ordering information.

Estimated installation time:

60 minutes

IMPORTANT

1. Please read the installation instructions carefully before you start.
2. If the vehicle is clean and free of other debris, it will be easy to install.
3. For your safety and to ensure a satisfactory installation, please complete all the installation steps in the order shown below.

PRODUCT INFORMATION

- | | |
|---|-----|
| ① Plastic Roof Split Part, Front | x1 |
| ② Plastic Roof Split Part, Middle | x1 |
| ③ Plastic Roof Split Part, Rear | x1 |
| ④ Horn, Panel, Bracket Assembly | x1 |
| ⑤ Full-Range Horn Mounting Bracket | x1 |
| ⑥ Subwoofer Mounting Bracket | x1 |
| ⑦ Bracket 4 | x2 |
| ⑧ Bracket 3 | x2 |
| ⑨ Bracket 2 | x2 |
| ⑩ Bracket 1 | x1 |
| ⑪ U-shaped Clamp | x9 |
| ⑫ $\phi 25^* \phi 6^* 1.5$ round washer | x20 |
| ⑬ M6*25 Screw | x10 |
| ⑭ M6*20 Screw | x80 |
| ⑮ M6 Flanged Lock Nut | x62 |
| ⑯ M8 Flanged Lock Nut | x10 |
| ⑰ Composite Gasket | x99 |
| ⑱ Hexagonal Handle | x1 |
| ⑲ Open-Ended Wrench | x1 |
| ⑳ Zip Tie | x10 |

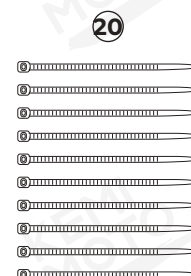
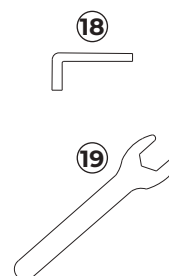
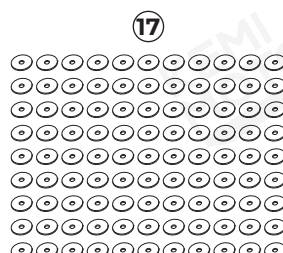
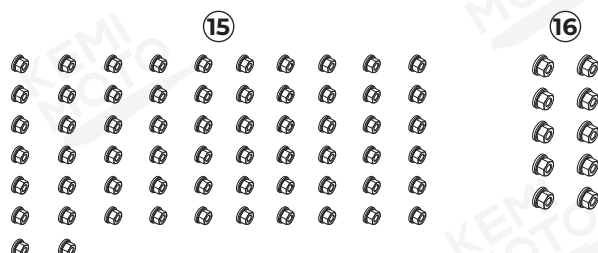
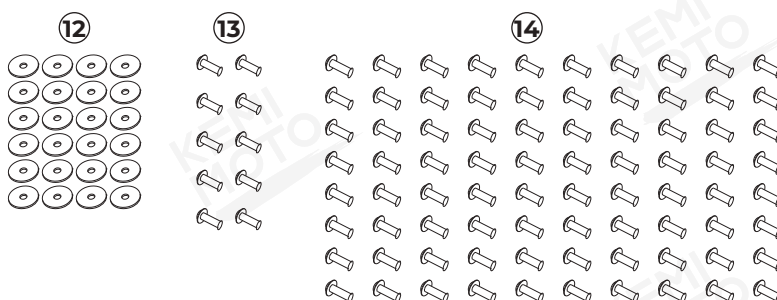
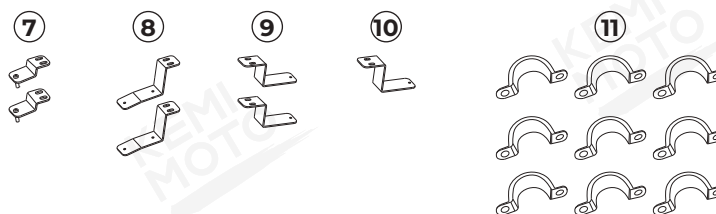
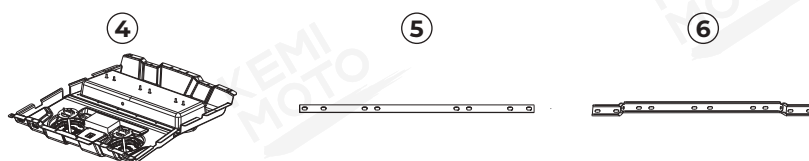
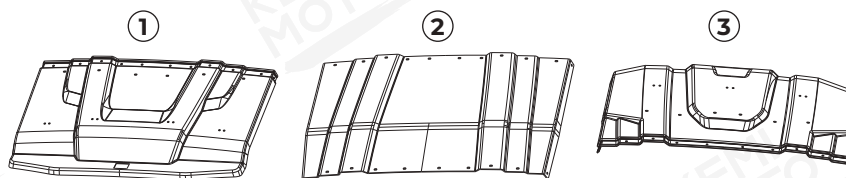

INSTALLATION TIPS

Step 1: Hang the Horn, Panel, Bracket Assembly [4] on the roof of the vehicle.

Note: Start on the one side first.

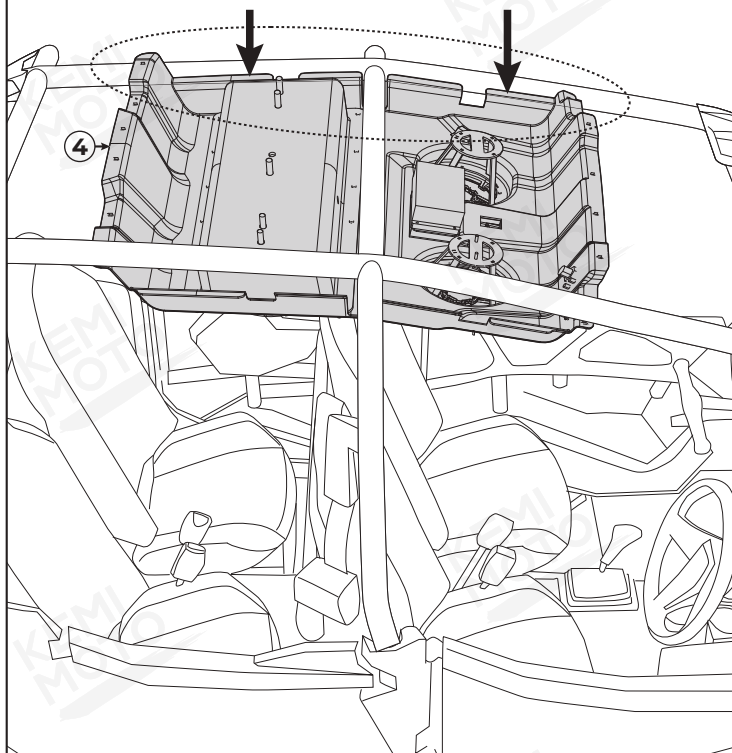

Step 1.1: Effect after installation

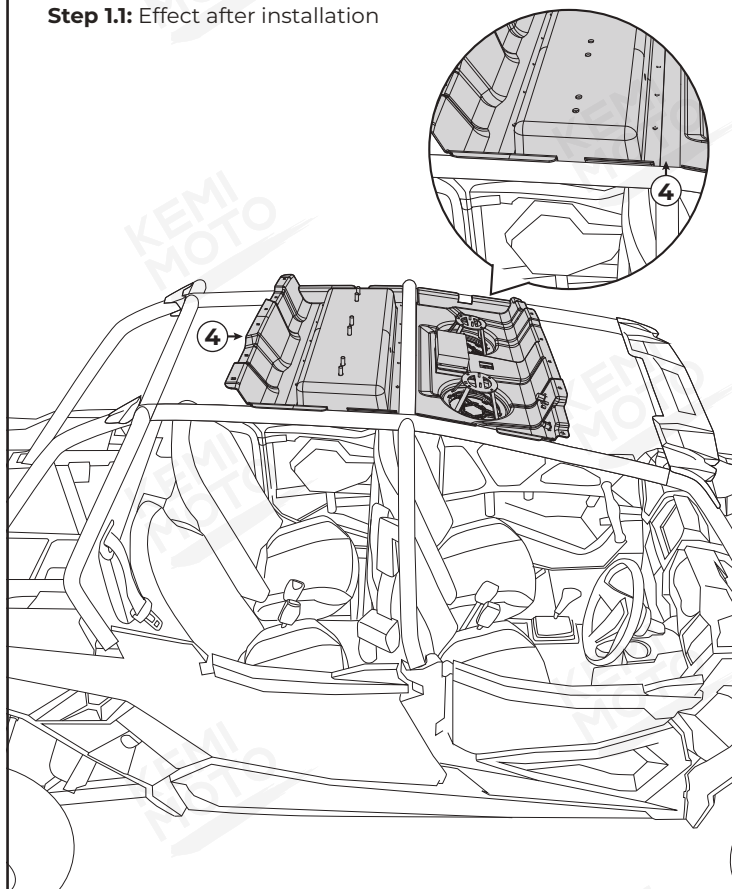

Step 2: Using 4 M8 Flanged Lock Nuts [16] and 4 round washers [12], attach the full-range speaker bracket to the speaker mounting bracket.

Note:

1. It is necessary to use washers during installation.
2. Do not tighten the 4 nuts; keep them loose.
3. No screws are required in this step.

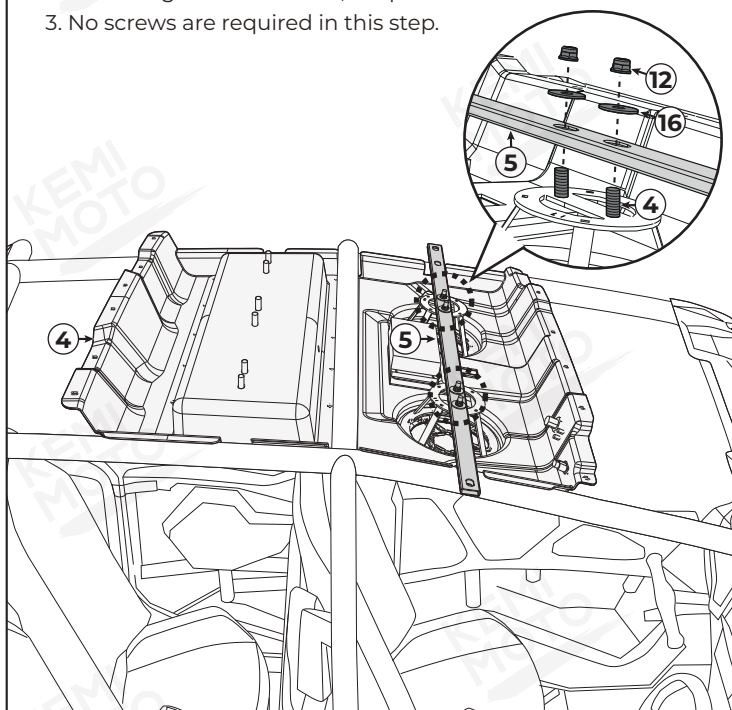

Step 3: Install 2 U-shaped Clamps [11] onto the full-range speaker mounting bracket using 4 Screws [13], 4 M6 Flanged Lock Nuts [15], and 4 round washers [12].

Note:

1. It is necessary to add washers during installation.
2. Tighten all nuts on the bracket in sequence.

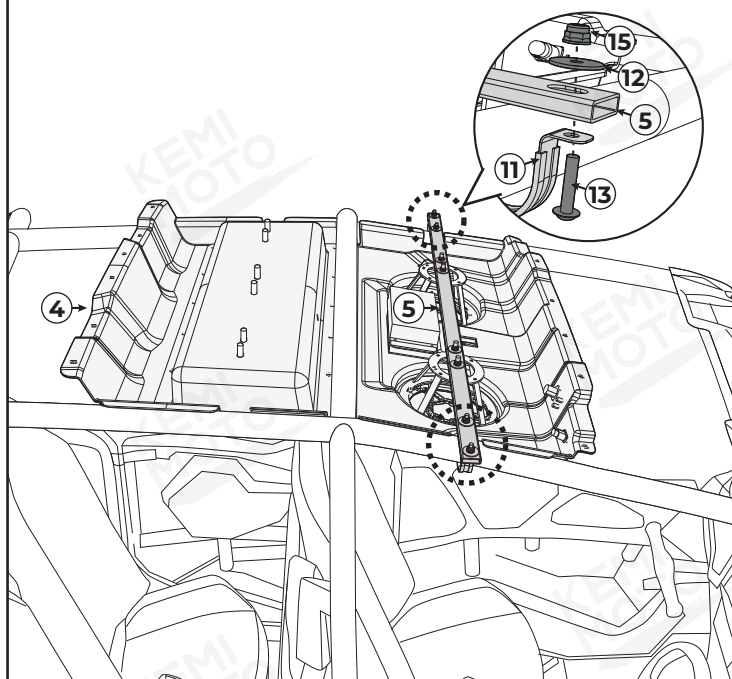

Step 4: Using 6 M8 flanged lock nuts [16] and 6 round washers [12], install the full-range speaker bracket onto the speaker mounting bracket.

Note:

1. When installing, it is necessary to add a washer.
2. The 6 M8 flanged lock nuts should not be tightened, keep them loose.
3. Screws are not required for this step.

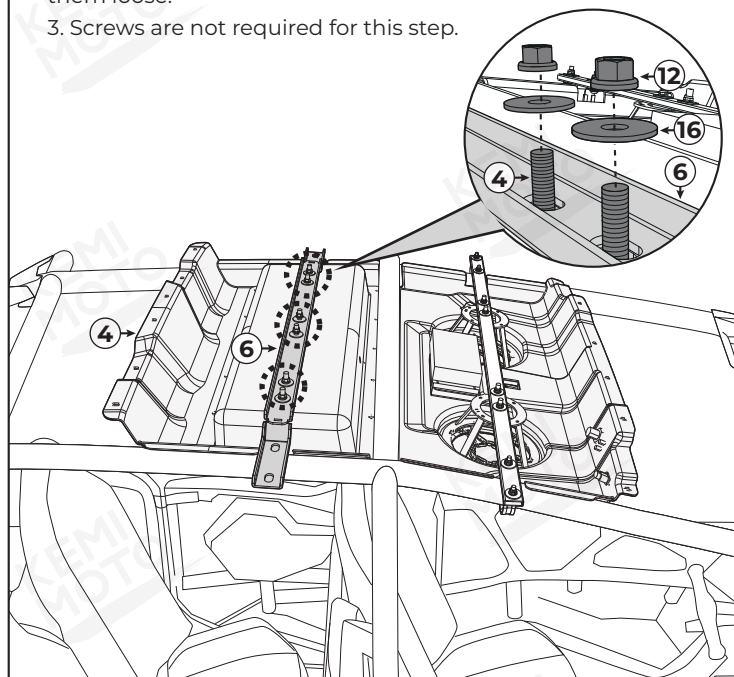

Step 5: Using 4 Screws [13], 4 M6 Flanged Lock Nuts [15], and 4 round washers [12], install the 2 U-shaped Clamps [11] onto the full-range speaker mounting bracket.

Note:

1. It is necessary to use washers during installation.
2. Tighten all the nuts on the bracket in sequence.

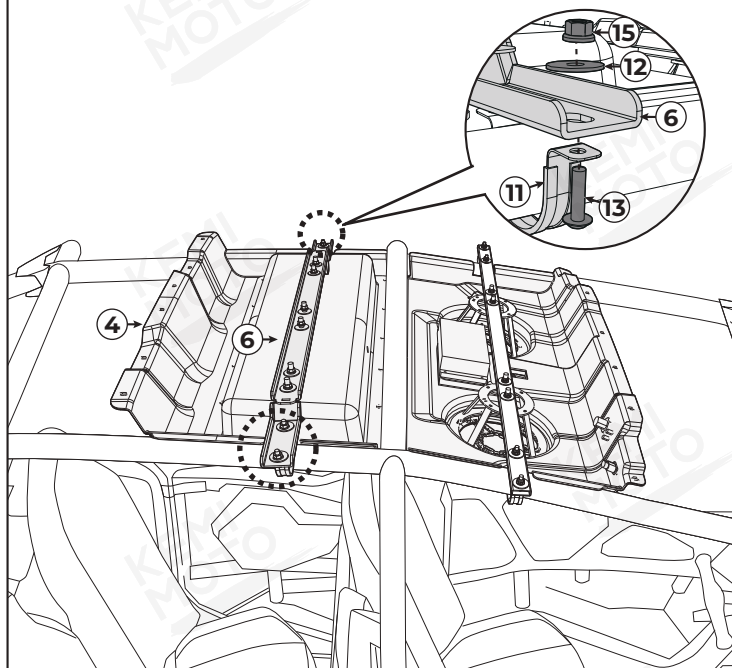

Step 6: Secure the Plastic Roof Split Part, Front [1] and Plastic Roof Split Part, Middle [2] together from bottom to top using 12 Screws [14], M6 Flanged Lock Nuts [15], and Composite Gaskets [17].

Note:

1. Make sure that the screws are on the outer side.
2. Start locking from the positioning round hole on the side.
3. Always use the composite gasket during installation.

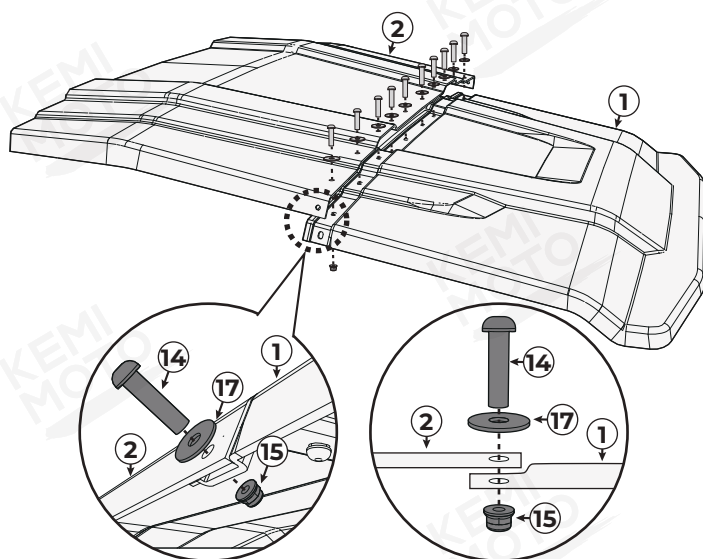

Step 7: Plastic Roof Split Part, Front [1], Plastic Roof Split Part, Middle [2], and Plastic Roof Split Part, Rear [3] are secured from bottom to top using 10 screws [14], M6 flanged lock nuts [15], and composite gaskets [17].

Note:

1. Make sure the screws are on the outer side.
2. Start locking them from the side positioning circular hole.
3. When installing, be sure to use the composite gasket.

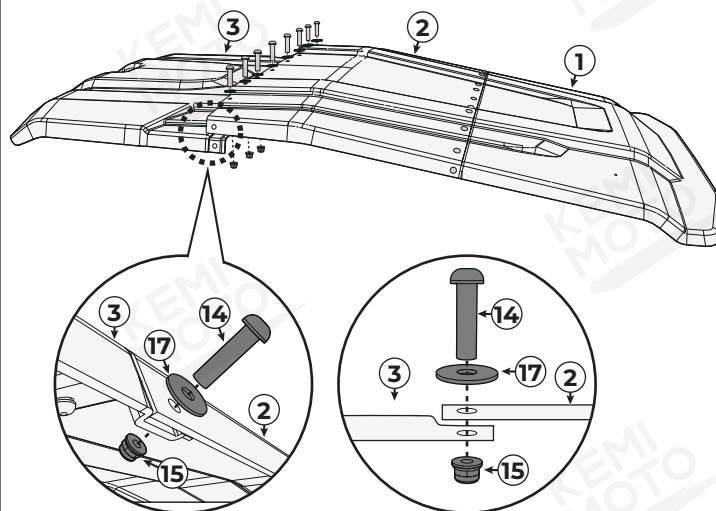

Step 8: As indicated in the diagram, place the brackets 1-4 into their corresponding positions in order. Secure them in place using the Screw [14], M6 Flanged Lock Nut [15], and Composite Gasket [17].

Note:

1. Do not tighten the nuts, keep them loose.
2. Make sure to use the composite gasket.
3. Align and install Bracket [7] [8] [9] [10] with the dents on the roof.

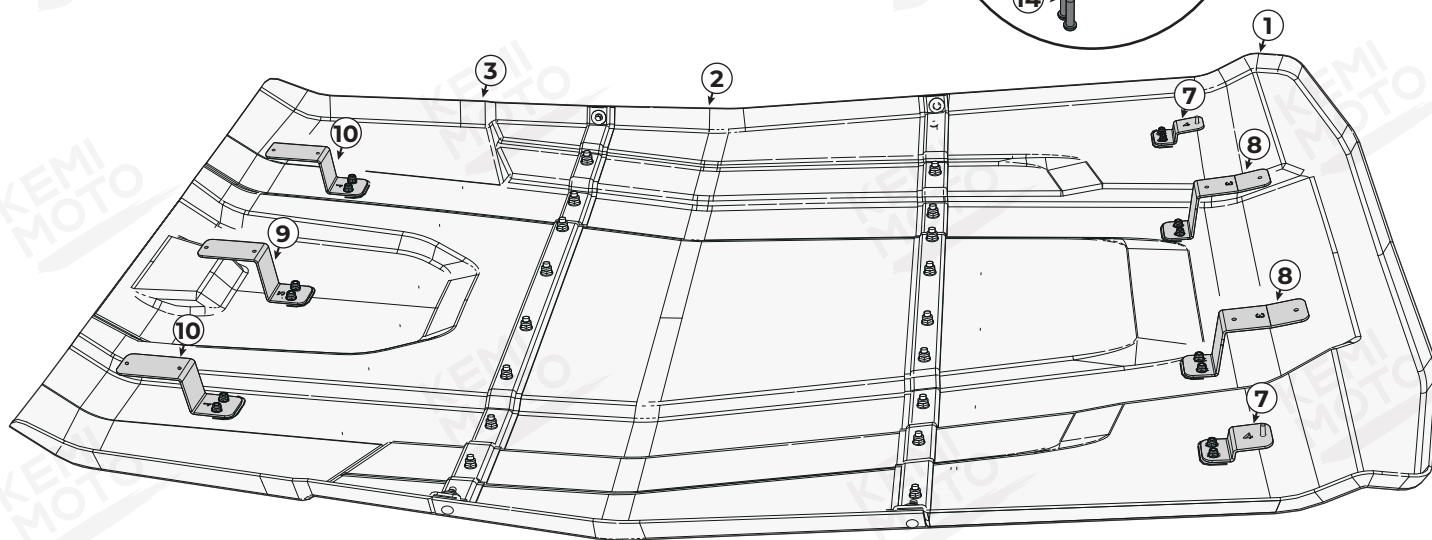
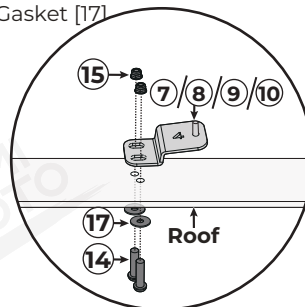

Step 9: Bracket [7] passes through the original vehicle hole.

Note: The M6 Flanged Lock Nut [15] should not be tightened, keep it loose.

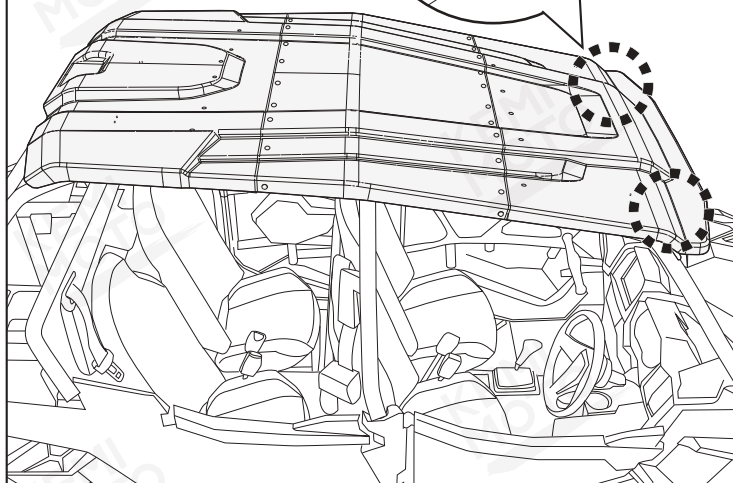
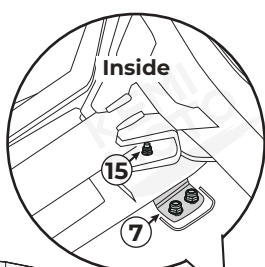

Step 10: Using the number: Attach the entire roof to the crossbar using the Screw [14].

Note:

1. The U-shaped clamp should not be tightened, keep it loose.
2. Do not add compound washers.

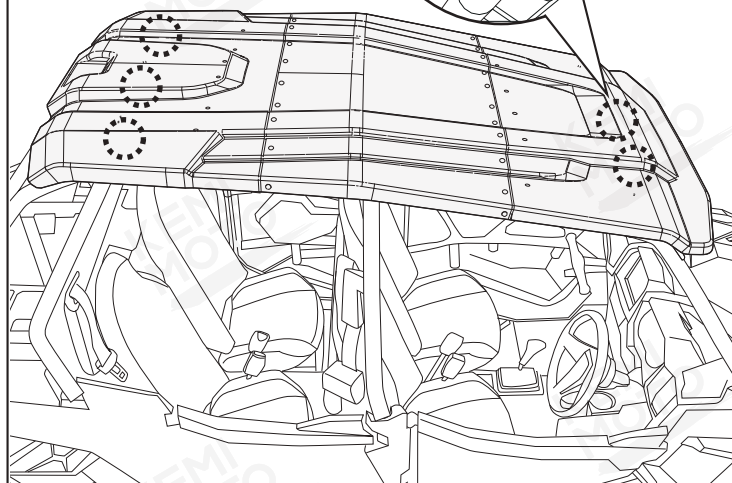
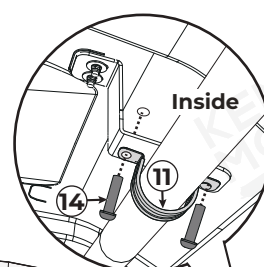

Step 11: Align the installation holes of the horn, panel, and bracket assembly with the holes on the roof, then secure the holes at both ends using Screws [14], M6 Flanged Lock Nuts [15], and Composite Gasket [17].

Note:

1. Make sure the screws are on the outer side.
2. Be sure to add the composite gasket.

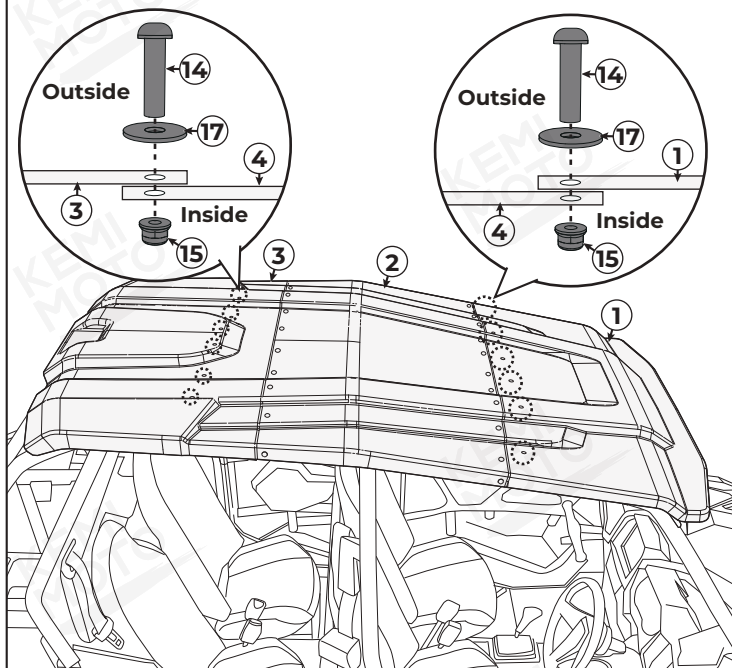

Step 12: Finally, tighten the screws of the roof rack bracket, as well as the screws of the U-shaped clamp and nuts.

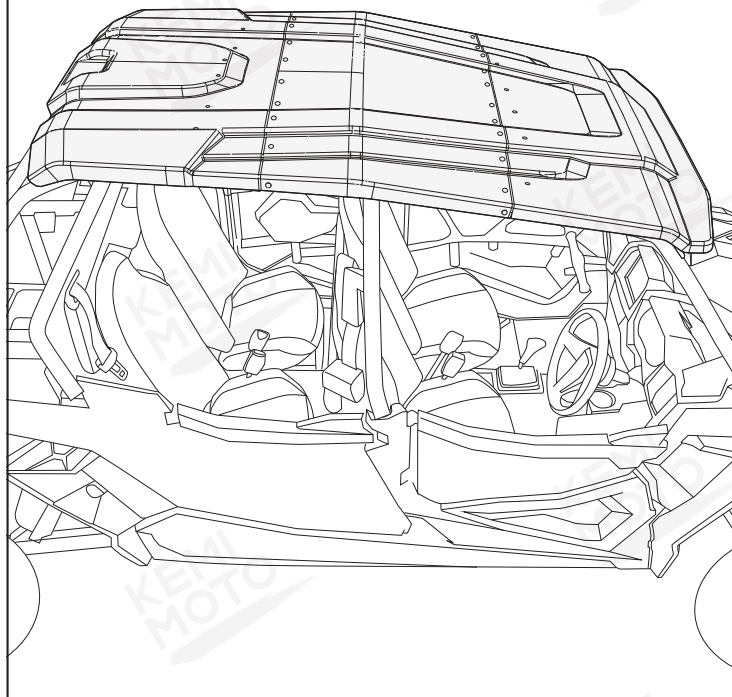

Step 13: Connect the wiring harness.

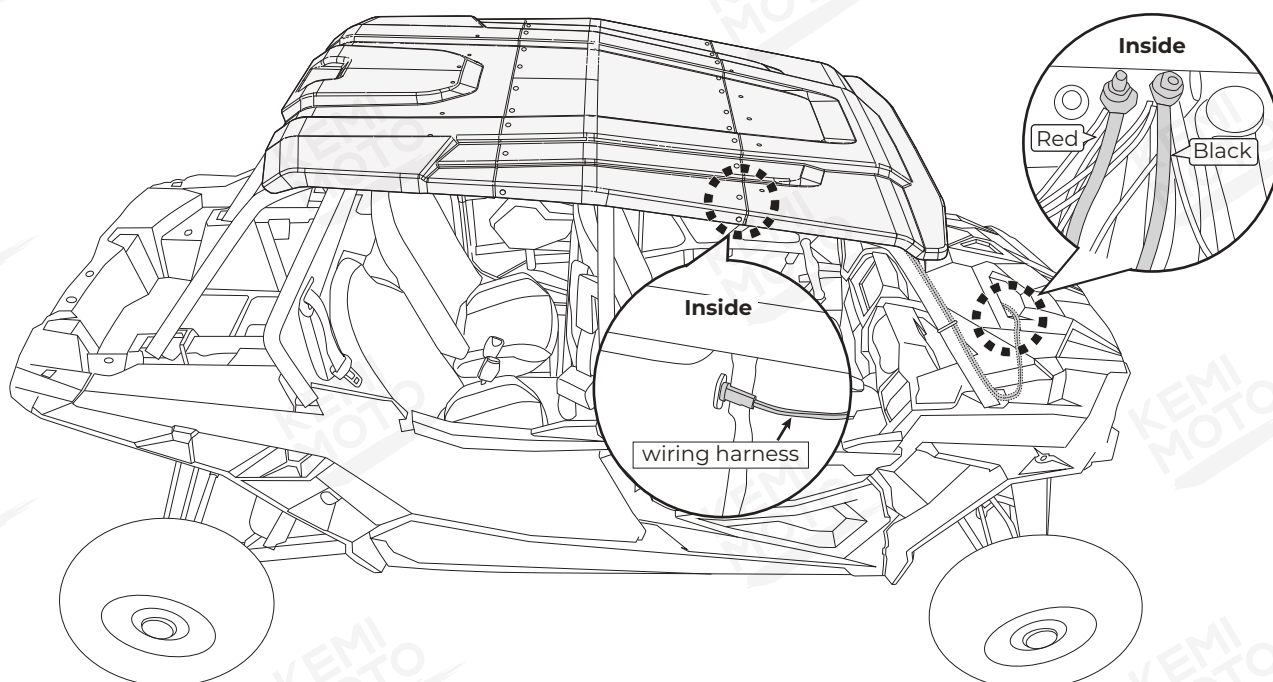

FUNCTION

PLAYBACK

- 1 **Power On/Off**, Press and hold to turn on/off the speaker
- 2 **Previous sound track**
- 3 **Play & pause the music**
- 4 **Volume decrease**
- 5 **Trigger/clear the sync pairing**
- 6 **LED button**, Press and hold to turn on/off the LED strips, click to circle the 19 sequences
- 7 **Next sound track**
- 8 **Volume increase**
- 9 **Audio sources selecting**, cycles in BT/AUX/USB mode
- 10 **Sound source indicator:**
Blue: Bluetooth mode
Green: Auxiliary input mode
Red: USB mode
Purple: TWS mode
- 11 2 x 6.5 Mid-treble speaker
- 12 2 x 6.5 woofer speaker
- 13 **USB port**, accept USB thumb and decode the music stored, as well it provide DC5V charging power for phone, maximumly 2A@5V
- 14 **Auxiliary input port**
- 15 **DC12V input port** (eg. vehicle battery)
- 16 **Auxiliary output port** (eg. subwoofer)

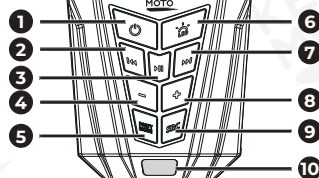

CONTROL PANEL

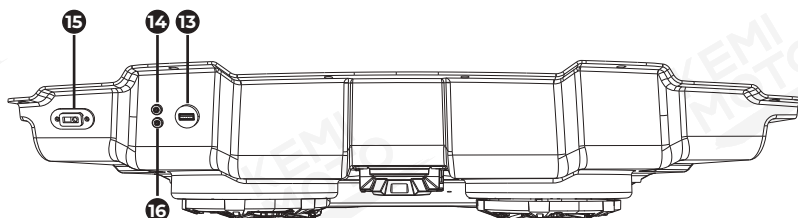
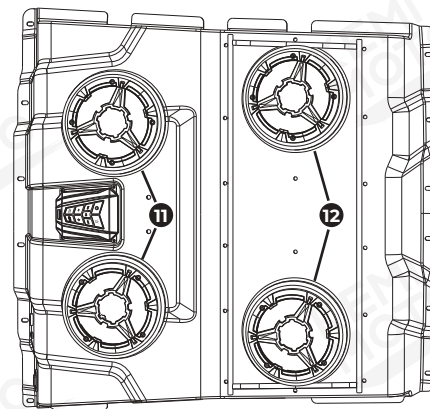

PLAYBACK

Step 1: Press and hold the power button on speaker or remote control to turn on the speaker you will hear the voice prompt "Hello Kemimoto" and the LED indicator will show flashing blue that means Bluetooth is under standby waiting for connection.

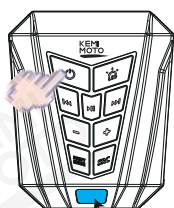

"Hello! Kemimoto Bluetooth mode"

Blue indicator flashing

Step 3: Once the Bluetooth connected, the voice prompt "connected" will come out, and the LED will be static blue.

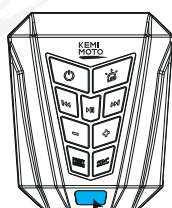

"Connected"

Static blue light

Step 2: Scan for the devices named "KM-Midnight 60/80" in your smart phone Bluetooth list, click it to wait for connection.



Step 4: Run the playlist in application on your smart phone, control the speaker playback with previous/next/play/pause volume +/- on front panel.

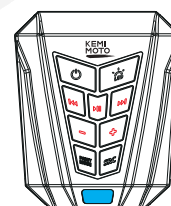

PLAYBACK

USB MUSIC

Step 1: Insert the USB thumb, with MP3/WMA format music stored, into the USB acceptance at back of connecting panel. The mode will automatically turn to USB mode, and start playing USB music after voice prompt "USB mode".

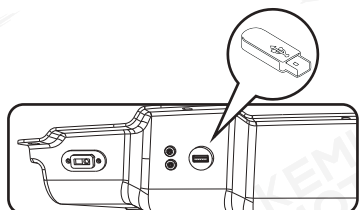

Step 3: Control the speaker USB music playback with previous/next/play/pasue volume+/-on front panel.

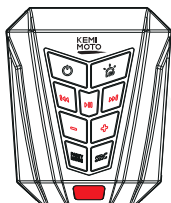

Step 2: Press the SRC button on speaker panel cycle select the speaker mode until you hear the voice prompt "Hello Kemimoto" and the LED indicator will show static red that means the system is under USB mode.

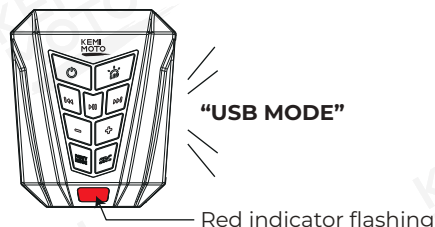

Note:

1. The system support hot swap of USB thumb, you are allowed to plug out/in the USB during the working status.
2. Make sure there (is) are at lease one piece of music file stored in the USB thumb, or the decode might not recognize the USB.
3. The system will kick into USB mode directly once the USB thumb is inserted and successfully recognized.
4. The USB port can provide 5V power to mobile phone or other appliance charging, with maximumly 2A output current.

COORDINATE WITH EXTERNAL SIGNAL

AUX-IN

Step 1: If you want the soundbar speaker work with your existing vehicle radio or Mp3 player that have got no Bluetooth audio function, you may use the auxiliary input function.

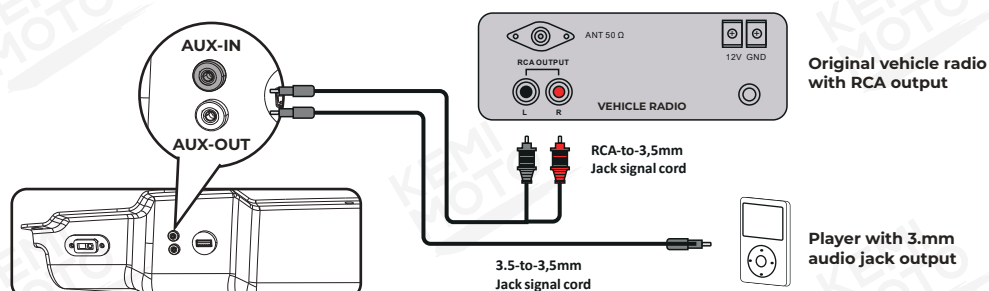

NOTE: only low level output from vehicle radio is s allowed to connect to the speaker, the output level should be less than 1000mV.

Step 2: Press the SRC button on speaker panel cycle select the speaker mode until you hear the voice prompt "Auxiliary input mode" and the LED indicator will show static green that means the system is under Aux-in mode.

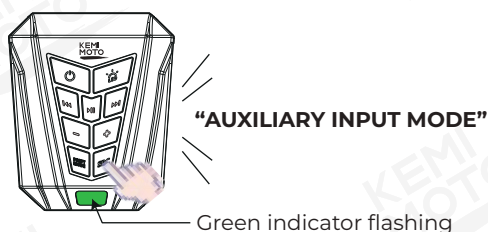

Step 3: Control the speaker USB music playback with volume +/- on front panel, play/pasue button functions as MUTE/UNMUTE process of the audio input.

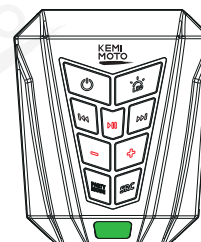

COORDINATE WITH EXTERNAL SIGNAL

AUX-OUT

If you want the soundbar speaker coordinately work with your existing subwoofer or other speaker system, you may use the auxiliary output function, Wire the audio signal into external speaker unit through RCA conversing cord or 3.5mm-to-3.5mm audio cord.

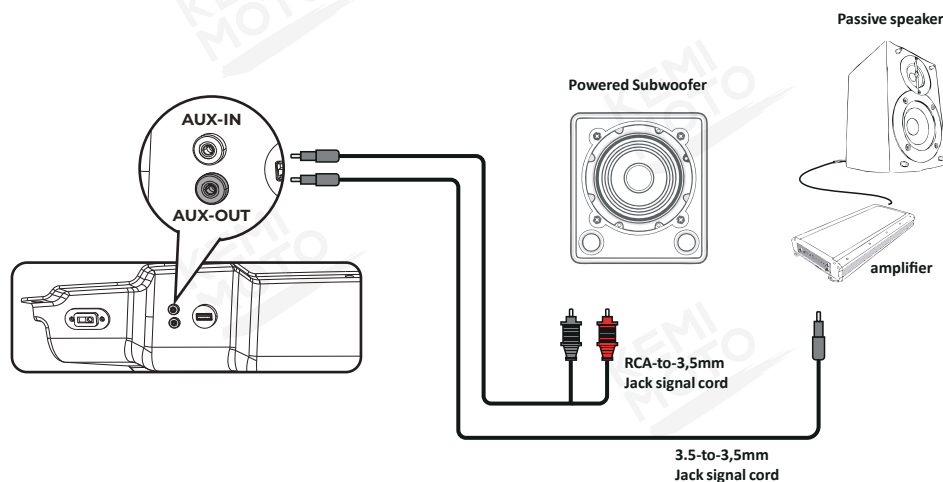

NOTE:

- The auxiliary output port provide low level stereo audio signal.
- Gain of the output signal < 600mV.
- The output gain is controlled and synchronized with control panel volume buttons.

FCC STATEMENT

This device complies with Part 15 of the FCC Rules. Operation is subject to the following two conditions:

- (1) This device may not cause harmful interference, and
- (2) This device must accept any interference received, including interference that may cause undesired operation.

Warning: Changes or modifications not expressly approved by the party responsible for compliance could void the user's authority to operate the equipment.

NOTE: This equipment has been tested and found to comply with the limits for a Class B digital device, pursuant to Part 15 of the FCC Rules. These limits are designed to provide reasonable protection against harmful interference in a residential installation.

This equipment generates uses and can radiate radio frequency energy and, if not installed and used in accordance with the instructions, may cause harmful interference to radio communications. However, there is no guarantee that interference will not occur in a particular installation. If this equipment does cause harmful interference to radio or television reception, which can be determined by turning the equipment off and on, the user is encouraged to try to correct the interference by one or more of the following measures:

- Reorient or relocate the receiving antenna.
- Increase the separation between the equipment and receiver.
- Connect the equipment into an outlet on a circuit different from that to which the receiver is connected.
- Consult the dealer or an experienced radio/TV technician for help.

FCC RADIATION EXPOSURE STATEMENT

This equipment complies with FCC radiation exposure limits set forth for an uncontrolled environment. This equipment should be installed and operated with minimum distance 20cm between the radiator & your body