

# Hisense

---

2.1CH Soundbar with Wireless Subwoofer  
Model: HS218



- ✓ Simple setup
- ✓ One remote
- ✓ Quick settings



---

## USER MANUAL

---



Before using the sound bar, please read this manual thoroughly and retain it for future reference.

# Contents

<b>Important Safety Instructions</b>	<b>3</b>
Safety .....	3
Warning.....	4
<b>What's in the Box</b>	<b>6</b>
<b>Identifying the Parts</b>	<b>7</b>
Main Unit .....	7
Wireless Subwoofer .....	7
Remote Control .....	8
<b>Preparations</b>	<b>8</b>
Prepare the Remote Control.....	8
Replace the Remote Control Battery .....	8
Placement and Mounting.....	9
Wall Mounting (if using option-B) .....	9
<b>Connections</b>	<b>10</b>
Connect to HDMI (ARC) Socket .....	10
Connect to OPTICAL Socket .....	10
Connect to COAXIAL Socket.....	10
Connect to LINE IN Socket.....	11
Connect Power .....	11
Pair up with the subwoofer.....	11
<b>Basic Operation</b>	<b>12</b>
Standby/ON.....	12
Select Modes.....	12
Adjust the Bass/Treble Level.....	12
Turn the Surround Sound ON/OFF.....	12
Adjust the Volume.....	12
Adjust the Brightness.....	12
Select a Preset Sound Effect .....	12
<b>LINE IN / OPTICAL / COAXIAL / HDMI ARC Operation</b>	<b>13</b>
<b>Bluetooth Operation</b>	<b>13</b>
Pair Bluetooth-enabled Devices.....	13
Listen to Music from Bluetooth Device .....	13
<b>USB Operation</b>	<b>14</b>
<b>Troubleshooting</b>	<b>14</b>
<b>Specifications</b>	<b>15</b>

## Important Safety Instructions





The lightning flash with arrowhead symbol, within an equilateral triangle, is intended to alert the user to the presence of uninsulated "dangerous voltage" within the product's enclosure that may be of sufficient magnitude as to constitute a risk of electric shock to persons.



The exclamation point within an equilateral triangle is intended to alert the user to the presence of important operating and maintenance (servicing) instructions in the literature accompanying the appliance.

### Safety

- Read these instructions** – All the safety and operating instructions should be read before this product is operated.
- Keep these instructions** – The safety and operating instructions should be retained for future reference.
- Heed all warnings** – All warnings on the appliance and in the operating instructions should be adhered to.
- Follow all instructions** – All operating and usage instructions should be followed.
- Do not use this apparatus near water** – The appliance should not be used near water or moisture – for example, in a wet basement or near a swimming pool and the like.
- Clean only with a dry cloth.**
- Do not block any ventilation openings.** Install in accordance with the manufacturer's instructions.
- Do not install near any heat sources such as radiators, heaters, stoves, or other apparatus (including amplifiers) that produce heat.
- Do not defeat the safety purpose of the polarized or grounding plug. A polarized plug has two blades with one wider than the other. A grounding plug has two blades and a third grounding prong. The wide blade or the third prong is provided for your safety. If the provided plug does not fit into your outlet, consult an electrician for replacement of the obsolete outlet.
- Protect the power cord from being walked on or pinched particularly at plugs, convenience receptacles, and the point where they exit from the apparatus.
- Only use attachments/accessories specified by the manufacturer.
-  Use only with the cart, stand, tripod, bracket or table specified by the manufacturer, or sold with the apparatus. When a cart or rack is used, use caution when moving the cart/apparatus combination to avoid injury from tip-over.
- Unplug the apparatus during lightning storms or when unused for long periods of time.
- Refer all servicing to qualified personnel. Servicing is required when the apparatus has been damaged in any way, such as power supply cord or plug is damaged, liquid has been spilled or objects have fallen into the apparatus, the unit has been exposed to rain or moisture, does not operate normally, or has been dropped.
-  This equipment is a Class II or double insulated electrical appliance. It has been designed in such a way that it does not require a safety connection to electrical earth.
- The apparatus shall not be exposed to dripping or splashing. No objects filled with liquids, such as vases, shall be placed on the apparatus.
- Minimum distance around the apparatus for sufficient ventilation is 5cm.
- The ventilation should not be impeded by covering the ventilation openings with items, such as newspapers, table-cloths, curtains, etc.
- No naked flame sources, such as lighted candles, should be placed on the apparatus.
- Batteries should be recycled or disposed of as per state and local guidelines.
- The use of apparatus in moderate or tropical climates.

### Caution:

- Use of controls or adjustments or performance of procedures other than those described herein, may result in hazardous radiation exposure or other unsafe operation.
- To reduce the risk of fire or electric shock, do not expose this apparatus to rain or moisture. The apparatus must not be exposed to dripping or splashing and objects filled with liquids, such as vases, must not be placed on apparatus.
- The mains plug/appliance coupler is used as the disconnect device, the disconnect device must remain readily operable.
- Danger of explosion if battery is incorrectly replaced. Replace only with the same or equivalent type.

### Warning

- The battery (batteries or battery pack) shall not be exposed to excessive heat such as sunshine, fire or the like.
- Before operating this system, check the voltage of this system to see if it is identical to the voltage of your local power supply.
- Do not place this unit close to strong magnetic fields.
- Do not place this unit on the amplifier or receiver.
- Do not place this unit close to damp areas as the moisture will affect the life of the laser head.
- If any solid object or liquid falls into the system, unplug the system and have it checked by qualified personnel before operating it any further.
- Do not attempt to clean the unit with chemical solvents as this may damage the finish. Use a clean, dry or slightly damp cloth.
- When removing the power plug from the wall outlet, always pull directly on the plug, never yank on the cord.
- Changes or modifications to this unit not expressly approved by the party responsible for compliance will void the user's authority to operate the equipment.
- The rating label is pasted on the bottom or back of the equipment.



**WARNING:** This product contains chemicals known to the State of California to cause cancer and birth defects or other reproductive harm. For more information: [www.watts.com/prop65](http://www.watts.com/prop65)



### Battery usage CAUTION

To prevent battery leakage which may result in bodily injury, property damage, or damage to the apparatus:

- Install all batteries correctly, + and - as marked on the apparatus.
- Do not mix old and new batteries.
- Do not mix alkaline, standard (Carbon-Zinc) or rechargeable (Ni-Cd, Ni-MH, etc.) batteries.
- Remove batteries when the unit is not used for a long time.



Correct Disposal of this product. This marking indicates that this product should not be disposed with other household wastes throughout the EU.

To prevent possible harm to the environment or human health from uncontrolled waste disposal, recycle it responsibly to promote the sustainable reuse of material resources. To return your used device, please use the return and collection systems or contact the retailer where the product was purchased. They can take this product for environmental safe recycling.

We hereby declares that this product is in compliance with the essential requirements and other relevant provisions of Directive 2014/53/EU.



The Bluetooth word mark and logos are registered trademarks owned by Bluetooth SIG., Inc.



The terms HDMI and HDMI High-Definition Multimedia Interface, and the HDMI Logo are trademarks or registered trademarks of HDMI Licensing Administrator, Inc.



Manufactured under license from Dolby Laboratories. Dolby, Dolby Audio, and the double-D symbol are trademarks of Dolby Laboratories.



- ✓ Simple setup
- ✓ One remote
- ✓ Quick settings

Roku TV Ready and the Roku TV Ready logo are trademarks of Roku, Inc.



## FCC INFORMATION (for US customers)

### Warning:

- This equipment should be installed and operated with minimum distance 20cm between the radiator & your body.
- Changes or modifications to this unit not expressly approved by the party responsible for compliance could void the user's authority to operate the equipment."

### NOTE:

- This equipment has been tested and found to comply with the limits for a Class B digital device, pursuant to Part 15 of the FCC Rules. These limits are designed to provide reasonable protection against harmful interference in a residential installation. This equipment generates, uses and can radiate radio frequency energy and, if not installed and used in accordance with the instructions, may cause harmful interference to radio communications.
- However, there is no guarantee that interference will not occur in a particular installation. If this equipment does cause harmful interference to radio or television reception, which can be determined by turning the equipment off and on, the user is encouraged to try to correct the interference by one or more of the following measures:
  - Reorient or relocate the receiving antenna.
  - Increase the separation between the equipment and receiver.
  - Connect the equipment into an outlet on a circuit different from that to which the receiver is connected.
  - Consult the dealer or an experienced radio / TV technician for help.

This device complies with Part 15 of the FCC Rules.

Operation is subject to the following two conditions:

- (1) this device may not cause harmful interference, and
  - (2) this device must accept any interference received, including interference that may cause undesired operation.
- Shielded cables must be used with this unit to ensure compliance with the Class B FCC limits.

### IC Notice:

This device contains licence-exempt transmitter(s)/receiver(s) that comply with Innovation, Science and Economic Development Canada's licence-exempt RSS(s). Operation is subject to the following two conditions:

1. This device may not cause interference.
2. This device must accept any interference, including interference that may cause undesired operation of the device.

## Règlement de la FCC (pour les clients américains)

### Avertissement :

- Pour rester en conformité avec les consignes d'exposition aux RF, placez le produit à au moins 20 cm des personnes proches.
- Les changements ou modifications de cet appareil non expressément approuvés par la partie responsable de la conformité pourraient annuler l'autorisation de l'utilisateur à utiliser l'équipement.

### REMARQUE :

- Ce dispositif a été testé et déclaré conforme aux limites d'un dispositif numérique de classe B, conformément à la partie 15 des règles de la FCC.  
Ces limites sont conçues pour fournir une protection raisonnable contre les interférences nuisibles dans une installation résidentielle. Cet appareil génère, utilise et peut émettre de l'énergie radiofréquence et, s'il n'est pas installé et utilisé conformément aux instructions, il peut causer de l'interférence nuisible aux communications radio.
- Cependant, il n'est pas garanti que des interférences ne se produiront pas dans une installation particulière. Si cet appareil provoque des interférences nuisibles à la réception radio ou de télévision, ce qui peut être déterminé en mettant l'appareil hors tension, l'utilisateur est encouragé à essayer de corriger l'interférence par une ou plusieurs des mesures suivantes :
  - Réorienter ou déplacer l'antenne de réception.
  - Augmenter la distance entre l'appareil et le récepteur.
  - Brancher l'appareil à une prise sur un circuit différent de celui sur lequel le récepteur est branché.
  - Consulter le revendeur ou un technicien radio/TV expérimenté.

Cet appareil est conforme à la partie 15 des règles de la FCC. Son fonctionnement est soumis aux deux conditions suivantes :

- (1) ce dispositif ne peut pas causer d'interférences nuisibles et
  - (2) cet appareil doit accepter toute interférence reçue, y compris les interférences qui peuvent causer un mauvais fonctionnement.
- Des câbles blindés doivent être utilisés avec cet appareil pour assurer la conformité avec les limites de la classe B de la FCC. fonctionnement de l'appareil.

## Avis d'Industrie Canada

L'émetteur/récepteur exempt de licence contenu dans le présent appareil est conforme aux CNR d'Innovation, Sciences et Développement économique Canada applicables aux appareils radio exempts de licence. L'exploitation est autorisée aux deux conditions suivantes :

1. L'appareil ne doit pas produire de brouillage;
2. L'appareil doit accepter tout brouillage radioélectrique subi, même si le brouillage est susceptible d'en compromettre le fonctionnement.

## What's in the Box



Main Unit

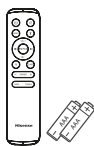

Remote Control /  
AAA Batteries x 2



Wireless Subwoofer

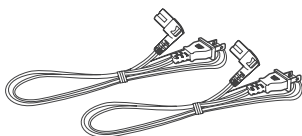

AC Power Cord  
x 2



Optical Cable

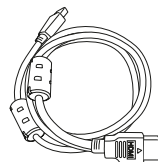

HDMI Cable



Bracket(x2) / Wall Plug(x2) / screw(x2) /  
bracket screw(x2)

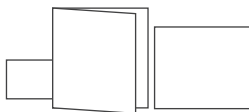

User Manual/Quick Start Guide/  
Wall Mount Guide

- Design and specifications are subject to change without notice.

# Identifying the Parts

## Main Unit

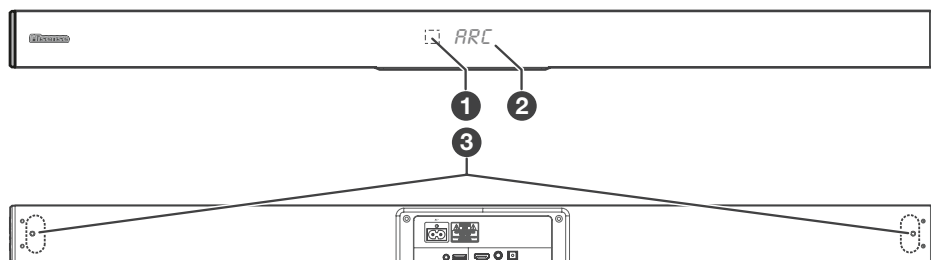

### 1 Remote Control Sensor

Receive signal from the remote control.

### 2 Display Window

Show the current status.

### 3 Screws

Remove the screws then install the wall mounting screws into the back of the unit.

### 4 (ON/OFF) Button

Switch the unit between ON and Standby mode.

### 5 +/- (Vol+/Vol-) Buttons

Increase/decrease the volume level.

### 6 (SOURCE) Button

Select the play function.

### 7 AC~ Socket

Connect to the power supply.

### 8 LINE IN Socket

Connect to an external audio device.

### 9 USB Socket

Insert the USB device to play music.

### 10 HDMI ARC Socket

Connect to a TV via HDMI cable.

### 11 COAXIAL Socket

Connect to a coaxial audio output on the TV.

### 12 OPTICAL Socket

Connect to an optical audio output on the TV.

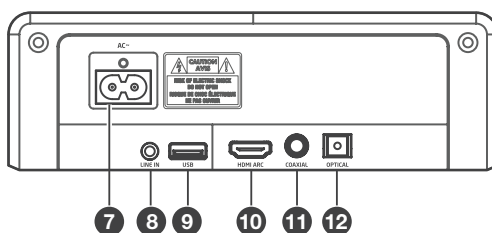
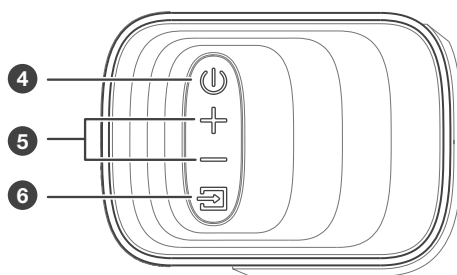

## Wireless Subwoofer

### 1 AC~ Socket

Connect to power supply.

### 2 PAIR Button

Press activate the pairing function between the main unit and the subwoofer.

### 3 PAIR Indicator

Light up solidly when the pairing succeed.

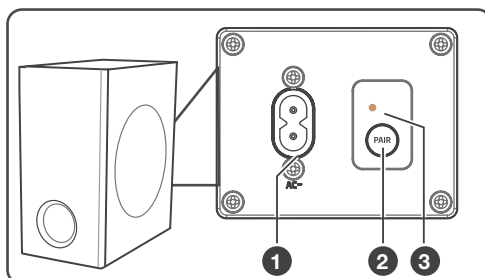

## Remote Control

- 1 Switch the unit between ON and STANDBY mode.
- 2 Mute or resume the sound.
- 3 **SOURCE** Select the play function.
- 4 Select the Bluetooth mode.
- 5 **VOL+/VOL-** Increase/decrease the volume level.
- 6 Skip to previous/next track in BT/USB mode.
- 7 Play/pause/resume playback in BT/USB mode. Press and hold to activate the pairing function in Bluetooth mode or disconnect the existing paired Bluetooth device.
- 8 **EQ** Select a preset sound effect.
- 9 **SURR** Adjust the surround ON/OFF.
- 10 **DIMMER+/-** Adjust display brightness.
- 11 **BASS** Press "BASS" then press VOL+/- button to increase or decrease the bass.
- 12 **TREBLE** Press "TREBLE" then press VOL+/- button to increase or decrease the treble.

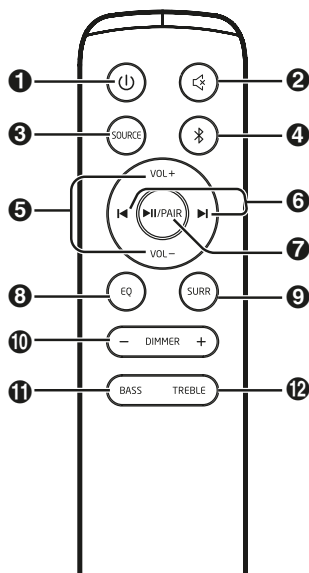

## Preparations

### Prepare the Remote Control

The provided Remote Control allows the unit to be operated from a distance.

- Even if the Remote Control is operated within the effective range 19.7 feet (6m), remote control operation may be impossible if there are any obstacles between the unit and the remote control.
- If the Remote Control is operated near other products which generate infrared rays, or if other remote control devices using infra-red rays are used near the unit, it may operate incorrectly. Conversely, the other products may operate incorrectly.

### Replace the Remote Control Battery

- 1 Press and slide the back cover to open the battery compartment of the remote control.
- 2 Insert two **AAA** size batteries (included). Make sure the (+) and (-) ends of the batteries match the (+) and (-) ends indicated in the battery compartment.
- 3 Close the battery compartment cover.

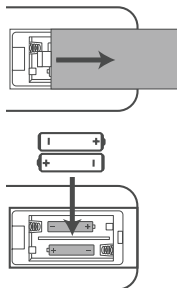

### Precautions Concerning Batteries

- Be sure to insert the batteries with correct positive "+" and negative "-" polarities.
- Use batteries of the same type. Never use different types of batteries together.
- Either rechargeable or non-rechargeable batteries can be used. Refer to the precautions on their labels.
- Be aware of your fingernails when removing the battery cover and the battery.
- Do not drop the remote control.
- Do not allow anything to impact the remote control.
- Do not spill water or any liquid on the remote control.
- Do not place the remote control on a wet object.
- Do not place the remote control under direct sunlight or near sources of excessive heat.
- Remove the battery from the remote control when not in use for a long period of time, as corrosion or battery leakage may occur and result in physical injury, and/or property damage, and/or fire.
- Do not use any batteries other than those specified.
- Do not mix new batteries with old ones.
- Never recharge a battery unless it is confirmed to be a rechargeable type.



# Placement and Mounting

## Placement

- A If your TV is placed on a table, you can place the unit on the table directly in front of the TV stand, centered with the TV screen.
- B If your TV is attached to a wall, you can mount the unit on the wall directly below the TV screen.

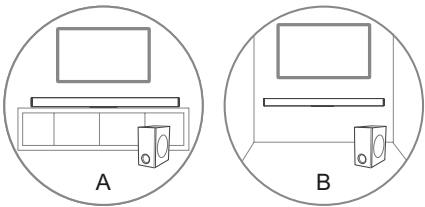

## Wall Mounting (if using option-B)

### Note:

- Installation must be carried out by qualified personnel only. Incorrect assembly can result in severe personal injury and property damage (if you intend to install this product yourself, you must check for installations such as electrical wiring and plumbing that may be buried inside the wall). It is the installer's responsibility to verify that the wall will safely support the total load of the unit and wall brackets.
- Additional tools (not included) are required for the installation.
- Do not overtighten screws.
- Keep this instruction manual for future reference.
- Use an electronic stud finder to check the wall type before drilling and mounting.

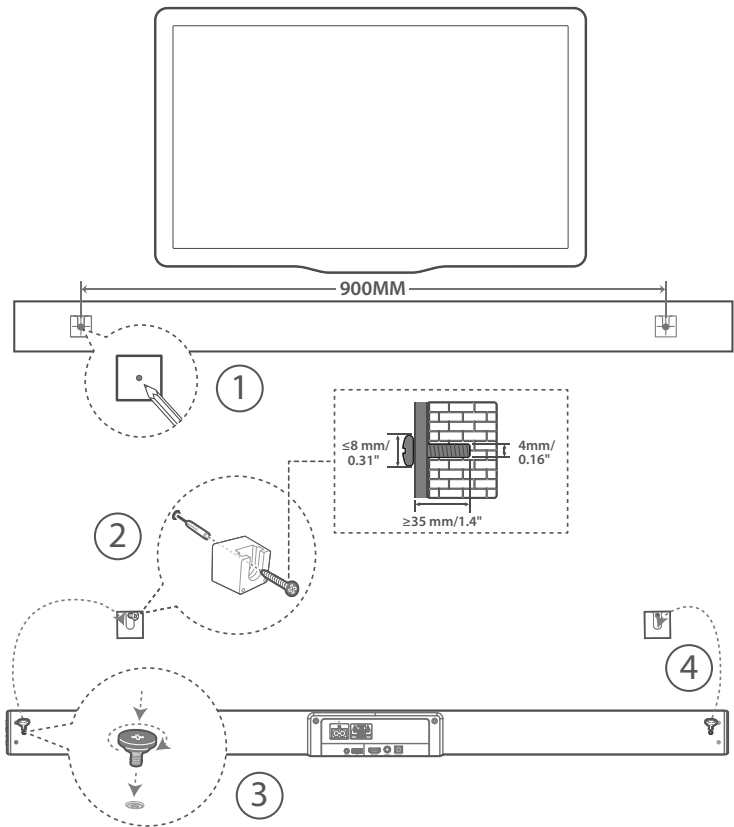

## Connections

### Connect to HDMI (ARC) Socket

Your Soundbar supports HDMI with Audio Return Channel (ARC). If your TV is HDMI ARC compliant, you can hear the TV audio through your Soundbar by using a single HDMI cable.

- 1 Using a High Speed HDMI cable (not included), connect the HDMI OUT (ARC)-TO TV connector on your Soundbar to the HDMI ARC connector on the TV.
- The HDMI ARC connector on the TV might be labeled differently. For details, see the TV user manual.
- 2 On your TV, turn on HDMI-CEC operations. For details, see the TV user manual.

#### Tips:

- Your TV must support the HDMI-CEC and ARC function. HDMI-CEC and ARC must be set to On.
- The setting method of HDMI-CEC and ARC may differ depending on the TV. For details about ARC function, please refer to your TV owner's manual.
- Only HDMI 1.4 compatible cables can support the ARC function.

### Connect to OPTICAL Socket

- Remove the protective cap of the **OPTICAL** socket, then connect an OPTICAL cable (included) to the TV's OPTICAL OUT socket and the **OPTICAL** socket on the unit.

### Connect to COAXIAL Socket

- You also can use the COAXIAL cable (not included) to connect the TV's COAXIAL OUT socket and COAXIAL socket on the unit.

**Tip:** The unit may not be able to decode all digital audio formats from the input source. In this case, the unit will mute. This is NOT a defect. Ensure that the audio setting of the input source (e.g. TV, game console, DVD player, etc.) is set to **PCM** or **Dolby Digital** (Refer to the user manual of the input source device for its audio setting details) with HDMI / OPTICAL / COAXIAL input.

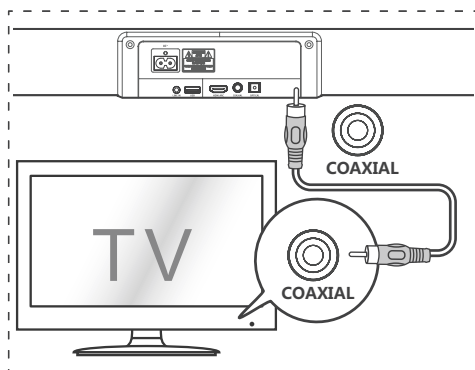
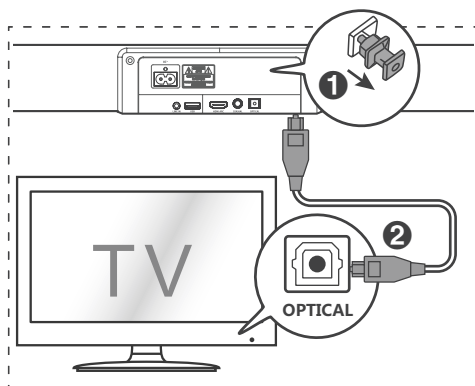
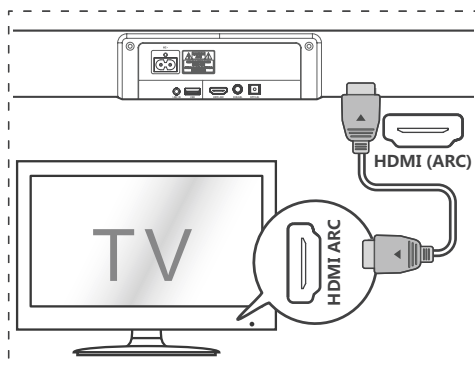

## Connect to LINE IN Socket

- A Use a RCA to 3.5mm audio cable (not included) to connect the TV's audio output sockets to the **LINE IN** socket on the unit.
- B Use a 3.5mm to 3.5mm audio cable (not included) to connect the TV's or external audio device headphone socket to the **LINE IN** socket on the unit.

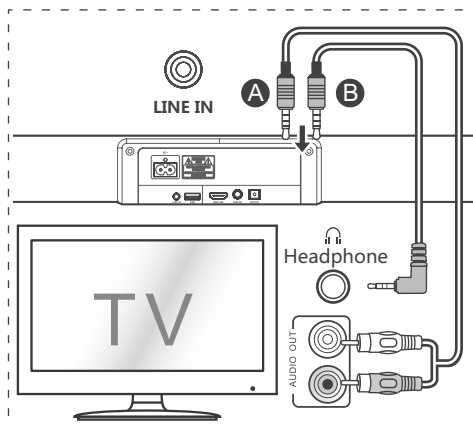

## Connect Power

### Risk of product damage!

- Ensure that the power supply voltage corresponds to the voltage printed on the back or the underside of the unit.
- Before connecting the AC power cord, ensure you have completed all other connections.

### Subwoofer

- Connect the mains cable to the **AC~** Socket of the subwoofer and then into a mains socket.

### Soundbar

- Connect the mains cable to the **AC~** Socket of main unit and then into a mains socket.

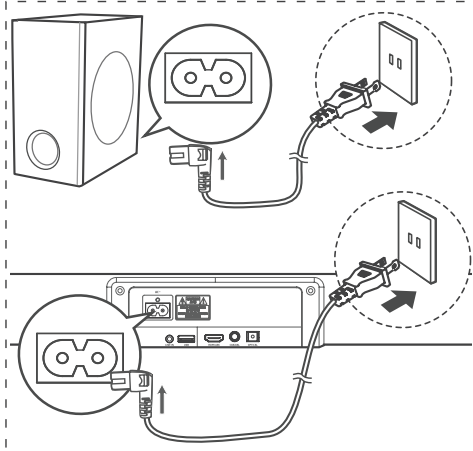

## Pair up with the subwoofer

### Automatic pairing

Plug the soundbar and the subwoofer into the mains sockets and then press on the unit or remote control to switch the unit to ON mode. The subwoofer and soundbar will automatically pair.

- When the subwoofer is pairing with the main unit, the Pair Indicator will flash fast.
- When the subwoofer is paired with the main unit, the Pair Indicator will light up.

### NOTE:

- Do not press the **Pair** button on the subwoofer, except for manual pairing.

- If the automatic pairing fails, pair the subwoofer with the main unit manually.

### Manual pairing

If no audio from the wireless subwoofer can be heard, manually pair up the subwoofer.

- 1 Unplug both units from the mains sockets again, then plug them in again after 3 minutes.
- Press and hold the **PAIR** button on the subwoofer for a few seconds.
  - The Pair indicator on the subwoofer will rapidly blink.

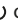
- 2 Then press  on the unit or remote control to switch the unit **ON**.
- 3 The Pair indicator on the subwoofer will become solid when successful.
- 4 If the Pair indicator still keeps blinking, repeat step 1-3.



#### NOTE:

- The subwoofer should be within 6 m of the soundbar in an open area (the closer the better).
- Remove any objects between the subwoofer and the soundbar.
- If the wireless connection fails again, check if there is a conflict or strong interference (e. g. interference from an electronic device) around the location. Remove these conflicts or strong interferences and repeat the above procedures.
- If the main unit is not connected with the subwoofer and it is in ON mode, the unit's POWER indicator will flash.

## Basic Operation

### Standby/ON

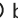
When you first connect the main unit to the mains socket, the main unit will be in Standby mode.

- Press the  button on the unit or on the remote control to switch the unit ON.
- Press the  button again to switch the unit back to STANDBY mode.
- Disconnect the mains plug from the mains socket if you want to switch the unit OFF completely.

### Auto Wake

- If a TV or an external device is connected (LINE IN / OPTICAL / COAXIAL / HDMI ARC), the unit will switch on automatically when the TV or the external device is switched on.

### Automatic Power Off Function

The unit automatically turns to **Standby** mode after about **15** minutes if the TV or the external unit is disconnected, switched off.

- To switch the unit off completely, remove the mains plug from the mains socket.

- Please turn the unit off completely to save energy when not in use.

### Select Modes

Press the  (SOURCE) button repeatedly on the unit or the **SOURCE** buttons on the remote control to select the **LINE IN**, **OPTICAL**, **COAXIAL**, **HDMI ARC**, **USB** and **BT** (Bluetooth) mode.

The selected mode will show on the display.

### Adjust the Bass/Treble Level

- Press **TREBLE** then press **VOL+/-** button to increase or decrease the treble.  
(treble+5 / treble-5)
- Press **BASS** then press **VOL+/-** button to increase or decrease the bass.  
(bass+5 / bass-5)
- After about 5 seconds, the unit will exit from bass/treble setting. The display will show the current selected mode. You may now press the **VOL+ / -** buttons to adjust volume.

### Turn the Surround Sound ON/OFF

- Press the **SURR** button on the remote control to turn on the surround sound. Press this button again to turn off the surround sound.

### Adjust the Volume

- Press the **VOL+ / VOL-** buttons on the unit or on the remote control to adjust the volume.
- If you wish to turn the sound off, press the  (MUTE) button on the remote control. Press the (MUTE) button again or press the **VOL+ / VOL-** buttons to resume normal listening.

### Adjust the Brightness

- Press the **DIMMER +/-** buttons on the remote control to select brightness level.

### Select a Preset Sound Effect

- While playing, press the **EQ** button on the remote control to select desired preset equalizers: **MOVIE**, **MUSIC**, **NEWS**.

## LINE IN / OPTICAL / COAXIAL / HDMI ARC Operation

- 1 Ensure that the unit is connected to the TV or audio device.
- 2 Press the  button repeatedly on the unit or the **SOURCE** button on the remote control to select the **LINE, OPTICAL, COAXIAL, HDMI ARC** mode.
- 3 Operate your audio device directly for playback features.
- 4 Press the **VOL +/-** button to adjust the volume to your desired level.

### Tip:

- The unit may not be able to decode all digital audio formats from the input source. In this case, the unit will mute. This is NOT a defect. Ensure that the audio setting of the input source (e.g. TV, game console, DVD player, etc.) is set to **PCM** or **Dolby Digital** (Refer to the user manual of the input source device for its audio setting details) with **HDMI ARC / OPTICAL / COAXIAL** input.

## Bluetooth Operation

### Pair Bluetooth-enabled Devices

The first time you connect your bluetooth device to this player, you need to pair your device to this player.

#### Note:

- The operational range between this player and a Bluetooth device is approximately 26 feet (8m) (without any object between the Bluetooth device and the unit).
  - Before you connect a Bluetooth device to this unit, ensure you know the device's capabilities.
  - Compatibility with all Bluetooth devices is not guaranteed.
  - Any obstacle between this unit and a Bluetooth device can reduce the operational range.
  - If the signal strength is weak, your Bluetooth receiver may disconnect, but it will re-enter pairing mode automatically.
- 1 During ON mode, press the  button repeatedly on the unit or the **BT** button on the remote control to select Bluetooth mode. **"NO BT"** will show on the display if the unit is not paired to any Bluetooth device.

- 2 Activate your Bluetooth device and select the search mode. **"Hisense HS218"** will appear on your Bluetooth device list.
- If you cannot find the unit, press and hold the **▶/|| /PAIR** button on the remote control to be searchable. The display will show **"PAIR"** and you will hear **"Pairing"** from the unit.
- 3 Select **"Hisense HS218"** in the pairing list. After successful pairing, you will hear **"Paired"** from the unit, and the display panel shows **"BT"**.
- 4 Play music from the connected Bluetooth device.

#### To disconnect the Bluetooth function, you can :

- Switch to another function on the unit.
- Disable the function from your Bluetooth device. The Bluetooth device will be disconnected from the unit after the **"Disconnected"** voice prompt.
- Press and hold the **▶/|| /PAIR** button on the remote control.

#### Tips:

- Enter "0000" for the password if necessary.
- If no other Bluetooth device pairs with this player within two minutes, the player will recover its previous connection.
- The player will also be disconnected when your device is moved beyond the operational range.
- If you want to reconnect your device to this player, place it within the operational range.
- If the device is moved beyond the operational range, when it is brought back, please check if the device is still connected to the player.
- If the connection is lost, follow the instructions above to pair your device to the player again.

### Listen to Music from Bluetooth Device

- If the connected Bluetooth device supports Advanced Audio Distribution Profile (A2DP), you can listen to the music stored on the device through the player.
  - If the device also supports Audio Video Remote Control Profile (AVRCP), you can use the player's remote control to play music stored on the device.
- 1 Pair your device with the player.
  - 2 Play music via your device (if it supports A2DP).
  - 3 Use supplied remote control to control play (if it supports AVRCP).
- To pause/resume play, press the **▶/|| /PAIR** button on the remote control.
  - To skip to a track, press the **◀ / ▶** buttons on the remote control.

## USB Operation

- 1 Insert the USB device.

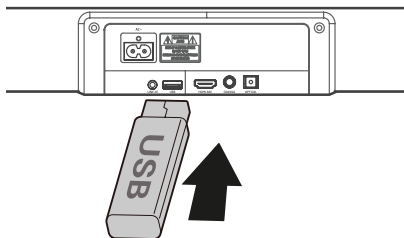

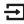
- 2 Press the  button repeatedly on the unit or press the **SOURCE** button on the remote control to select **USB** mode.
- 3 During playback:
  - To pause or resume play, press the **▶II / PAIR** button on the remote control.
  - To skip to the previous/next file, press the **◀▶** buttons on the remote control.

### Tips:

- The unit can support USB devices with up to 32 GB of memory.
- This unit can play MP3/WAV/WMA.
- The unit support FAT32.

## Troubleshooting

To keep the warranty valid, never try to repair the system yourself. If you encounter problems when using this unit, check the following points before requesting service.

### No power

- Ensure that the AC cord of the apparatus is properly connected.
- Ensure that there is power at the AC outlet.
- Press standby button to turn the unit on.

### Remote control does not work

- Before you press any playback control button, first select the correct source.
- Reduce the distance between the remote control and the unit.

- Insert the battery with its polarities (+/-) aligned as indicated.
- Replace the battery.
- Aim the remote control directly at the sensor on the front of the unit.

### No sound

- Increase the volume. Press Volume Up on the remote control or on the soundbar.
- Press MUTE on the remote control to ensure the soundbar is not muted.
- Press source buttons to select a different input source.
- When using either of the Digital inputs, if there is no audio:
  - Try setting the TV output to PCM or
  - Connect directly to your Blu-ray/other source, some TVs do not pass through digital audio.
- Your TV may be set to variable audio output. Confirm that the audio output setting is set to FIXED or STANDARD, not VARIABLE. Consult your TV's user manual for more detailed information.
- If using Bluetooth, ensure that the volume on your source device is turned up and that the device is not muted.

### I can't find the Bluetooth name of this unit on my Bluetooth device for Bluetooth pairing

- Ensure the Bluetooth function is activated on your Bluetooth device.
- Ensure you have paired the unit with your Bluetooth device.

### This is a 15 mins power off function, one of the ERPII standard requirement for saving power

- When the unit's external input signal level is too low, the unit will be turned off automatically in 15 minutes. Please increase the volume level of your external device.

### The subwoofer is idle or the indicator of subwoofer do not light up.

- Please unplug power cord from the mains socket, and plug it in again after 4 minutes to reset the subwoofer.

## Specifications

<b>Model Name</b>	HS218
-------------------	-------

<b>Soundbar</b>	
Power Supply	AC100-240V~ 50/60Hz
Power Consumption	30W
Standby Power	< 0.5 W
USB port for playback	5V --- 0.5A
USB Compatibility	Hi-Speed USB (2.0) / FAT32
USB Playback support / file formats	32G (max) , MP3/WAV/WMA
Dimension (WxHxD)	37.8 x 2.3 x 3.2 inches / (960 x 58 x 82 mm)
Net weight	4.4 lbs / (2.0 kg)
Audio input sensitivity	500mV
Frequency Response	120Hz - 20KHz

<b>Wireless Specification</b>	
Bluetooth Version	V 4.2
Bluetooth Maximum power transmitted &S'	5 dBm
Frequency bands	2402 MHz ~ 2480 MHz
2.4G wireless maximum power transmitted &S'	6 dBm
2.4G wireless frequency bands	2400 MHz ~ 2483 MHz

<b>Subwoofer</b>	
Power Supply	AC100-240V~ 50/60Hz
Power Consumption	30W
Standby Power	< 0.5 W
Dimension (WxHxD)	6.7 x 13.5 x 12.3 inches / (170 x 342 x 313 mm)
Net weight	12.1 lbs / (5.5 kg)
Frequency Response	40Hz - 120Hz

<b>Amplifier (Outputpower)</b>	
Sound bar	120W, 30W x 4 (@10%THD)
Subwoofer	80W (@10%THD)
Total	200W

<b>Remote Control</b>	
Distance/Angle	6m / 30°
Battery type	AAA (1.5V X 2)

**Hisense**

---

HS218