



Contents

1	Product Introduction	12
2	Function settings	14
3	Explanation of each part	16
4	Battery description	16
5	Accessories description	16
6	Product Specifications	17
7	APP instruction	17



1 Product introduction

- AC6000BT is a high-quality and high-accuracy BB projectile speed meter, and its models are AC6000 MKII, AC6000 BT and AC6000 BT luxurious edition; The details are as follows:

	AC6000 MKII	AC6000 BT	AC6000 BT (luxurious edition)
Bluetooth	✗	✓	✓
Tachymeter	Plastics	Plastics	Aluminum
Cloth box	✗	✗	✓

EN

- Using 128x128pixel OLED as display interface to provide detailed information of test data

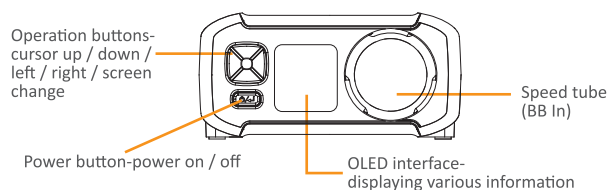

- Providing micro USB power input, rechargeable

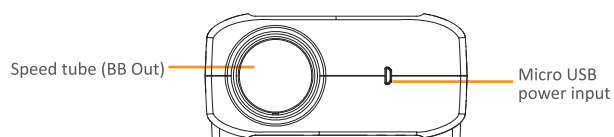

12 EN

- SCR1: Speed measurement screen, providing speed, ROF continuous transmission speed, kinetic energy test data and AMOO quick selection

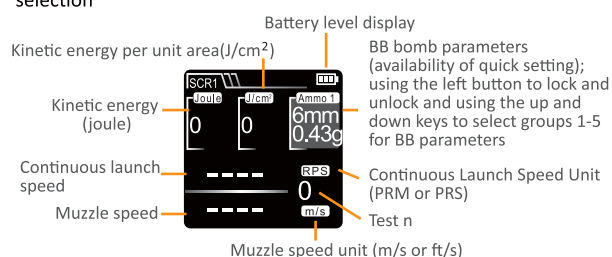

※When measuring ROF speed, you must fire more than 10 rounds to measure the ROF value.

- SCR2 provides 25 latest continuous firing speed and muzzle speed test data for users to analyze the performance of BB guns

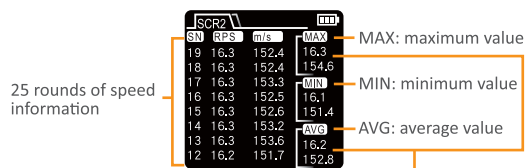

Note: The upper column of MAX, MIN, and AVG is the continuous launch speed, and the lower column is the initial speed.

※ Use the up and down buttons to view 25 rounds of speed measurement data.

※ Clearing the History: Press and hold the up button for 3 seconds to clear the history.

- APO idle automatic shutdown function and low voltage automatic shutdown function
- The diameter of aluminum alloy speed measuring tube is 36mm, which is suitable for 4.5mm, 6mm, 9mm and 8mm BB bullet specifications currently on the market.
- Using the included lithium battery, you can charge through micro USB to avoid the cost of replacing the battery, and the battery can last about 24 hours after being fully charged.
- You can use Bluetooth to connect with ACESoft APP, and you can use Bluetooth to update, record test data, and test data with available graphics.

13 EN

2 Function setting instructions

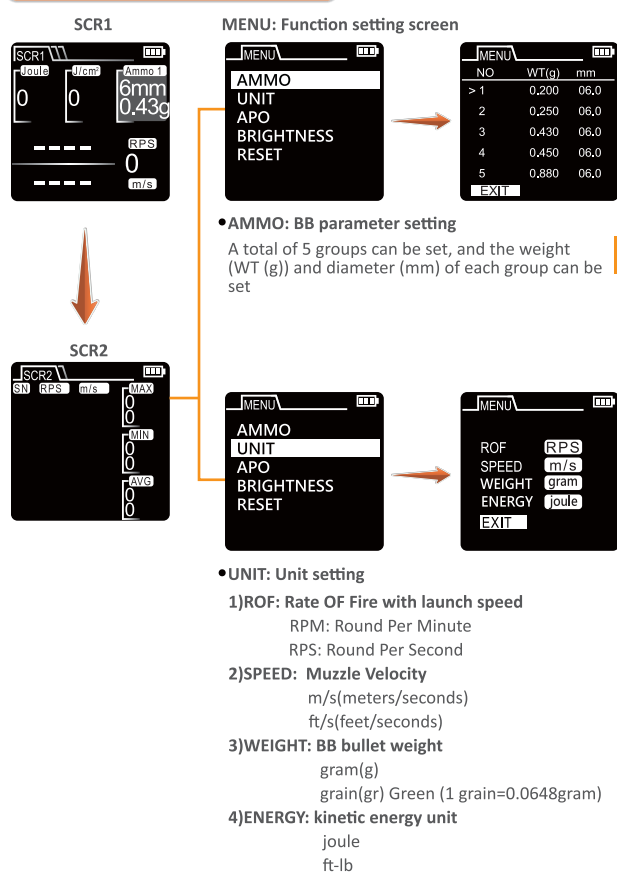

14 EN

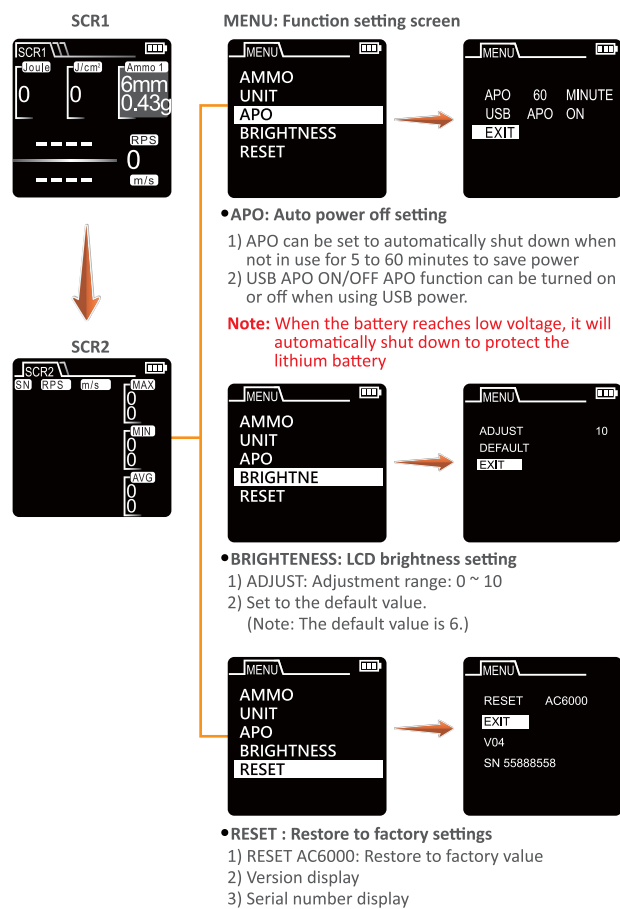

15 EN

3 Explanation of each part

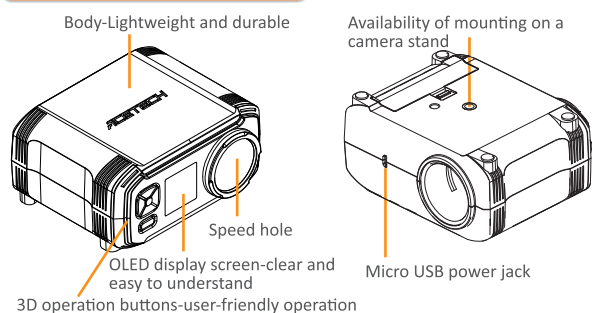

EN

4 Battery description

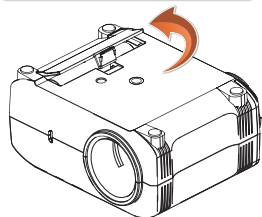

When not using it for a long time, you must charge it every 2 months. Failure to charge it for more than 2 months may cause the battery to over-discharge and reduce the life or even damage. Damage caused by over discharge is not covered by the warranty.

5 Accessories description

1. Elegant cloth box x1



2. Micro USB power cable x1



3. 18650 lithium battery x1
(Already installed in the machine)



※The cloth box is only available for AC6000BT (luxurious edition)

16 EN

6 Product Specifications

1. Muzzle speed measurement range: 30.00 ~ 400.0 (m/s)
2. Burst speed measurement range: 100 ~ 5000 (rounds/minute)
3. Speed measuring tube diameter: 36mm
4. Camera tripod screw hole for fixing to camera tripod
5. 18650 lithium battery x 1
6. Supporting micro USB external power input for charging
7. Size: 130 (L) x 108 (W) x 61 (H) mm
8. Weight: 312g (without battery)

Note 1: When using an external power supply, use a 5V adapter with a current of 0.5A or more.

Note 2: Avoid using the BB bomb to accidentally hit the panel and buttons during use to avoid OLED or button damage.

7 APP Instructions

1. Go to the APP store and search for AceSoft and install it.

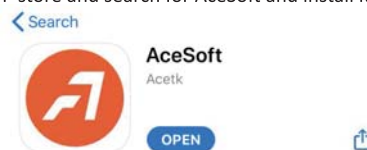

2. Start APP, AC6000BT and mobile phone Bluetooth.
3. Please refer to the figure below for the first time use. Click on the AC6000BT icon and a reminder icon will appear during pairing. At this time, press the AC6000BT power button to complete the pairing.



17 EN

4. After the pairing is successful, you will see the following screen. The gray area is the speed measurement result.
5. From left to right, the blue boxes above are No/Time switching, RPS/RPM switch, m/s and ft/s, and Joule/ft-lb/J/cm².
6. The orange blocks on the right from the top to the bottom are respectively Ammo 1 ~ 6 for selection to test at the highest speed/RPS, average speed/RPS and lowest speed/RPS.
7. From left to right in the green box below, the shooting data is stored, the shooting data is cleared, and the data chart is switched.

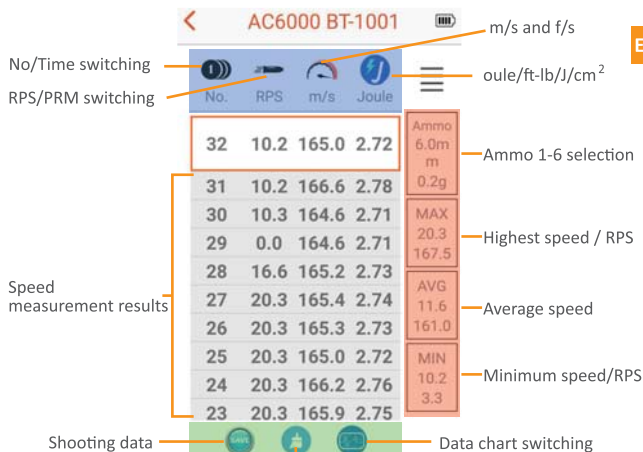

8. Tap the icon on the top right of the screen to enter the setting page.

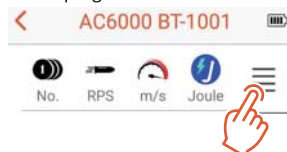

9. The setting page is as follows:

- a) Ammunition can be set.
- b) Updating the device (you can upgrade here if new firmware is released).
- c) Restore to the default.
- d) The current version of the device
- e) The current serial number of the device
- f) Device; tap to jump to the homepage.
- g) Records; read the pre-stored shooting data
- h) Store; tap to enter the ACETECH homepage.

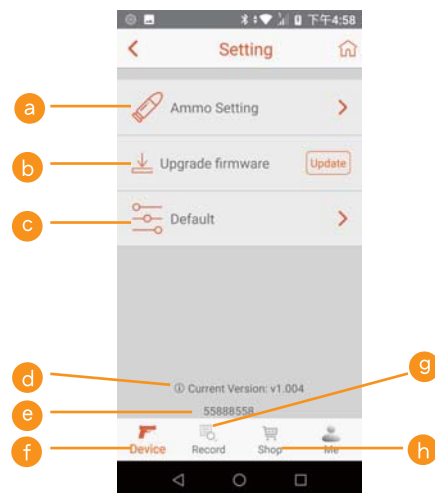

- All contents and functional specifications described in this manual are subject to change without notice.
- All contents and functional specifications in this manual will be based on the actual product.

FEDERAL COMMUNICATIONS COMMISSION INTERFERENCE STATEMENT

This equipment has been tested and found to comply with the limits for a Class B digital device, pursuant to Part 15 of the FCC Rules. These limits are designed to provide reasonable protection against harmful interference in a residential installation. This equipment generates, uses and can radiate radio frequency energy and, if not installed and used in accordance with the instructions, may cause harmful interference to radio communications. However, there is no guarantee that interference will not occur in a particular installation.

If this equipment does cause harmful interference to radio or television reception, which can be determined by turning the equipment off and on, the user is encouraged to try to correct the interference by one or more of the following measures:

- Reorient or relocate the receiving antenna.
- Increase the separation between the equipment and receiver.
- Connect the equipment into an outlet on a circuit different from that to which the receiver is connected.
- Consult the dealer or an experienced radio/TV technician for help.

CAUTION:

Any changes or modifications not expressly approved by the party responsible for compliance could void the user's authority to operate the equipment. This device complies with part 15 of the FCC Rules. Operation is subject to the following two conditions:

- (1) This device may not cause harmful interference, and
- (2) this device must accept any interference received, including interference that may cause undesired operation.

RF Exposure Warning

The equipment complies with RF exposure limits set forth for an uncontrolled environment. The antenna(s) used for this transmitter must not be co-located or operating in conjunction with any other antenna or transmitter.

EN



www.acetk.com



acetech007

FC CE RoHS