

earfun

# EarFun Air Pro SV

ANC Wireless Earbuds

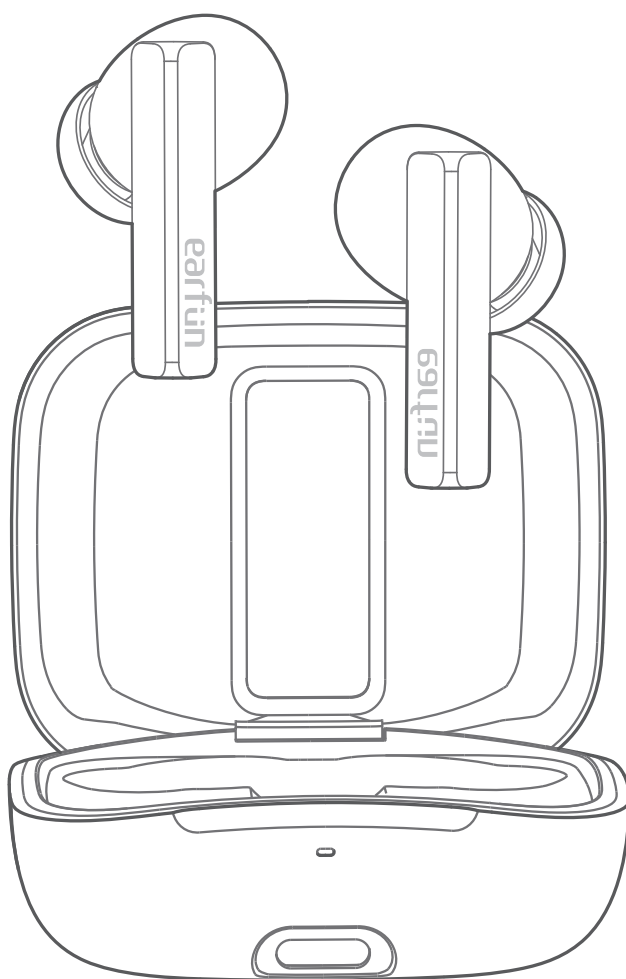

BC

## User Manual

English	01
Deutsch	14
Français	27
Español	40
日本語	53

## 1 What's in the Box

EarFun Air Pro SV

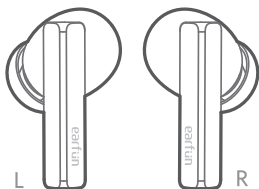

Charging Case



Ear Tips (S, M, L)

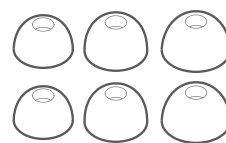

USB-C Cable

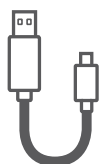

User Manual

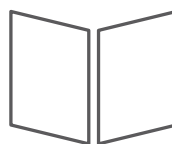

## 2 Product Diagram

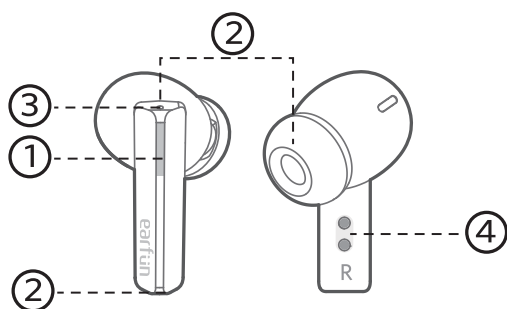

- ① Touch control zone
- ② Microphone
- ③ Earbuds LED indicator
- ④ Charging contactor
- ⑤ USB-C charging port
- ⑥ Charging case
- ⑦ Charging case indicator

## 3 Charging

1. Remove the insulating film on the earbuds before use this device.
2. Open or close the charging case to activate the case battery level LED indicator.

3. Place earbuds back into the charging case and the earbuds will start charging.
4. Fully charge both the earbuds and the charging case before the first-time usage.
5. Fully dry off the earbuds and the USB port before charging.

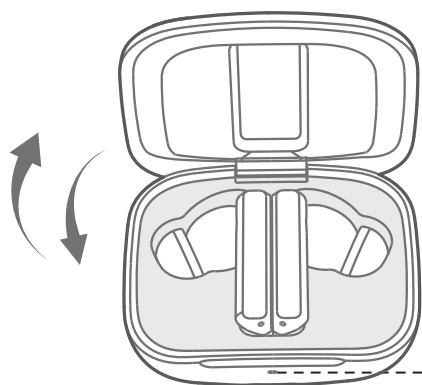

Battery level :

- ☀ Green > 30%
- 🌅 Orange < 30%
- 🔴 Red < 10%
- 🔴 flash < 5% Please charge

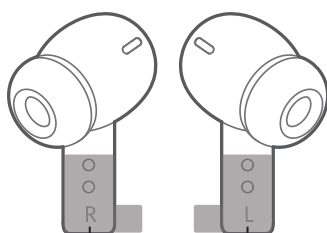

Remove the insulating film on the earbuds for the first time.

- Connect USB-C cable for charging
- Wireless charging(not included)

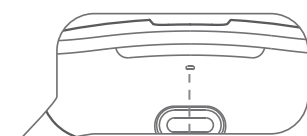
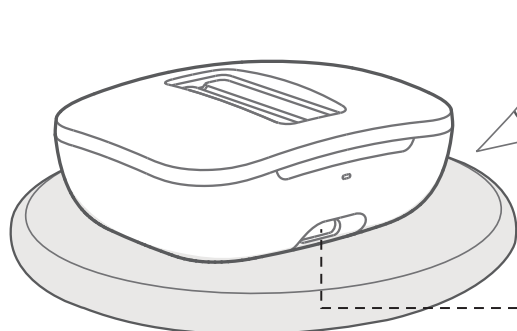

- 🔴 -Charging
- ☀ -Charging complete

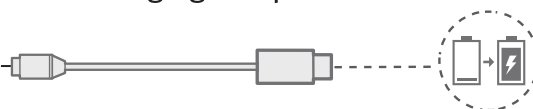

## ④ Specifications

Bluetooth version	V5.2
Bluetooth frequency	2.402GHz-2.48GHz
Bluetooth transmitted power	<7dBm (for EU)
Bluetooth profile	A2DP, AVRCP, HFP, HSP
Maximum working range	15m(without obstacle)
Battery capacity	35mAh x 2(earbuds); 380mA(charging case)
Charging time	1 hour(for earbuds); 2 hours(for charging case via USB-C); 4 hours(for charging case via wireless charger)
Playtime	ANC OFF--Up to 6 hours, Totally 24 hours with the charging case; (varies by volume level and audio content) ANC ON--Up to 4.5 hours, Totally 18 hours with the charging case; (varies by volume level and audio content)
Input	5V  1A
Dimentions	56.6mm x 46mm x 21.6mm
Weight	45g

## ⑤ How to Fit

Note: it may affect the noise cancelling effect if you are not wearing the earbuds correctly.

- 1.Take tip fit test to ensure the correct size.
- 2.Identify the left and right earbuds.
- 3.Place the earbuds in your canal and rotate to lock.

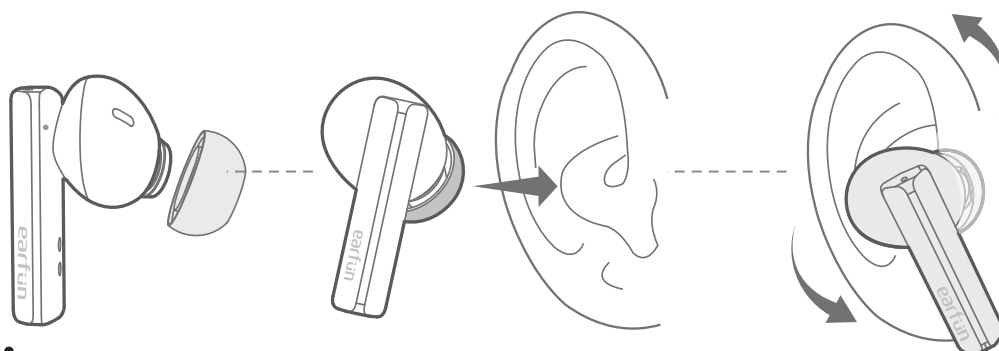

## 6 Pairing

### 1. First-time Pairing with Device

**Step 1:** Open the charging case, the earbuds will automatically power on and enter into pairing mode.

**Step 2:** Activate Bluetooth on your Bluetooth-enabled device and search for other Bluetooth devices.

**Step 3:** Select "EarFun Air Pro SV" from the list of Bluetooth devices shown (if a password is needed, type '0000').

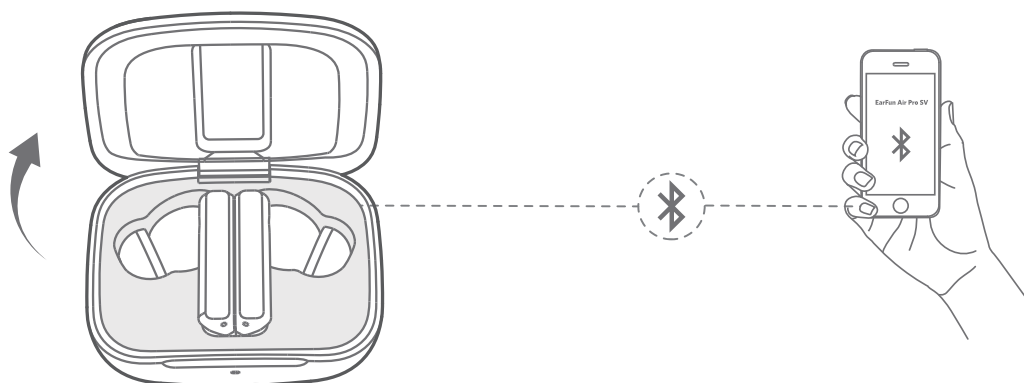

### Notes:

- The earbuds will automatically connect with the device they were last paired with when the case is open.
- Each earbud could be used independently.

### 2. Connect to a New Device

#### Option A

**Step 1:** Unpair the earbuds from the Bluetooth-enabled device that's connected. The earbuds will disconnect from the current device and enter into pairing mode for another pair.

**Step 2:** Search on the new device and connect.

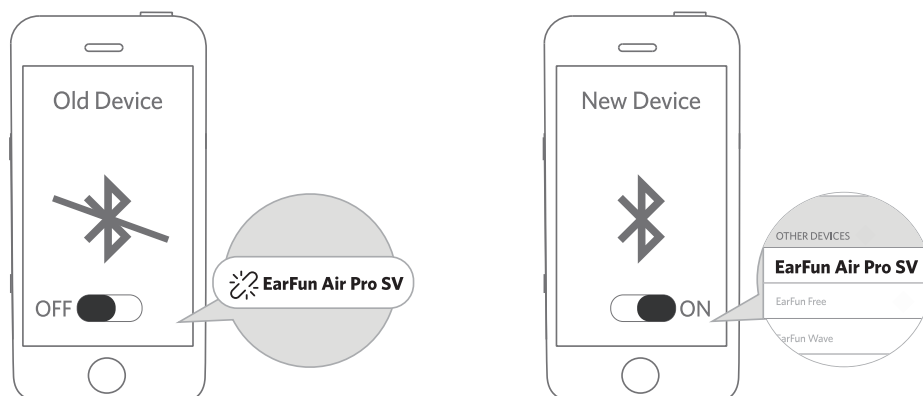

### Option B

**Step 1:** Make sure the earbuds are powered on, and then touch and hold the both earbuds button at the same time for at least 3 seconds until they flash in blue light, after that the earbuds will enter into pairing mode.

**Step 2:** Search on the new device and connect.

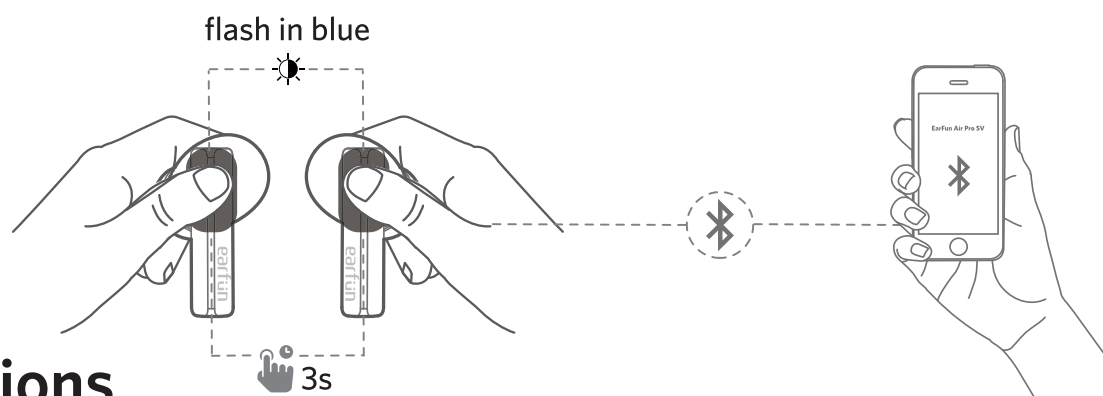

## 7 Functions

### Power on/off

Open the charging case, the earbuds will automatically power on. Place the earbuds back into the charging case. Close the case and the earbuds will automatically power off.

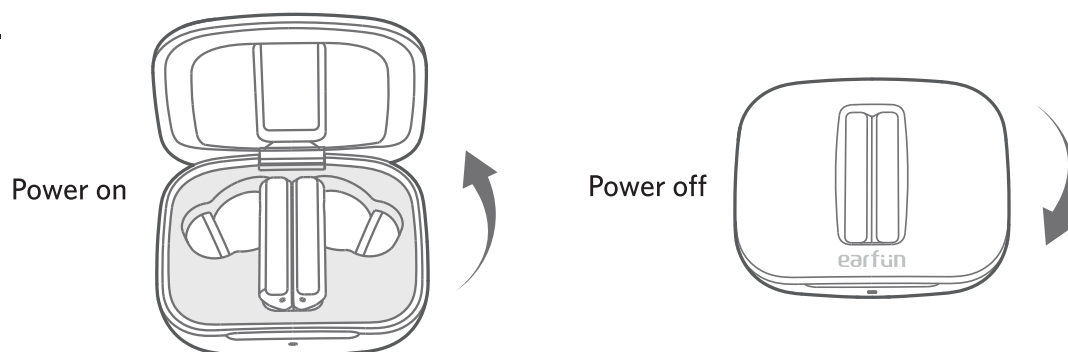

## Note:

If the earbuds is not connected to any device, it will automatically power off after 30 minutes for save the battery life.

### Playing music

Play/Pause

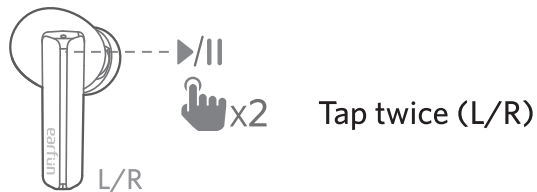

Next track

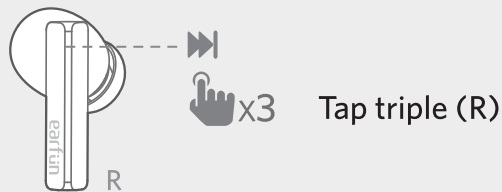

Volume up

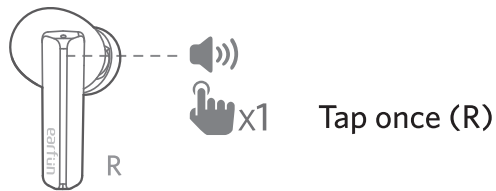

Volume down

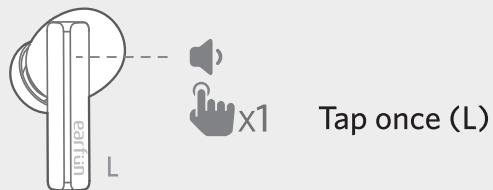

### Hands free conversation

Answer/End a call

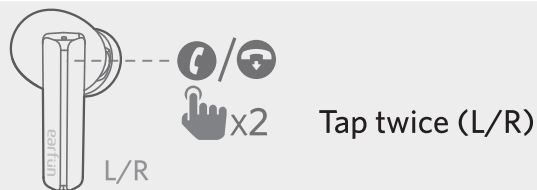

Reject a call

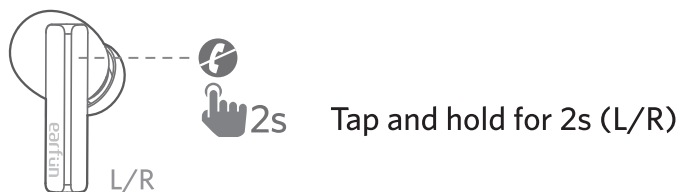





Answer and transfer two calls

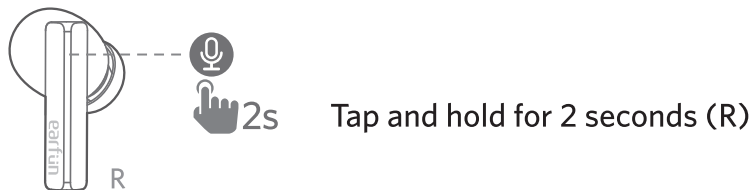

 Activate The Voice Assistant

Voice assistant



 Noise cancelling control

Noise Cancelling/  
Ambient sound/  
Normal

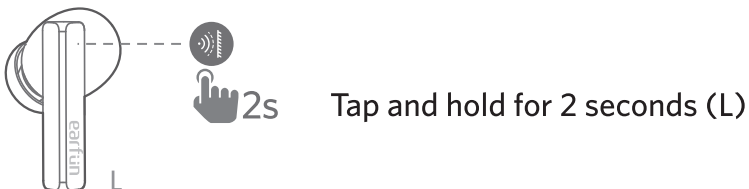

 Game Mode

Game Mode ON/OFF



### Note:

- Turn on the game mode can drop latency to as low as 80ms and improve the playing game and video experience, but it will shorten the connection distance. We suggest you turn off the game mode when you use the earbuds for music.
- The normal mode provide latency about 200ms.
- Bluetooth technology can't eliminate latency.

## 8 Earbuds LED Indicator

Power on

Blue indicator flashes 1 second

Power off

White indicator flashes 1 second

Pairing mode

Indicator flashes blue

Successfully connected

Indicator goes out

Factory reset

Indicator flashes alternately in blue and white

## 9 Reset and Reconnecting

**If you fail to build connection between two earbuds, or between earbuds and Bluetooth device, please try the following steps:**

1. Keep the earbuds out of the charging case, touch and hold the earbuds button for at least 8 seconds to power off both earbuds and make sure the both earbuds powered off.
2. In power-off mode, touch and hold the button on each earbud at the same time for at least 10 seconds until they flash alternately in blue and white, then earbuds have been reset successfully.
3. Delete the old connection from the Bluetooth device and reconnect "EarFun Air Pro SV".

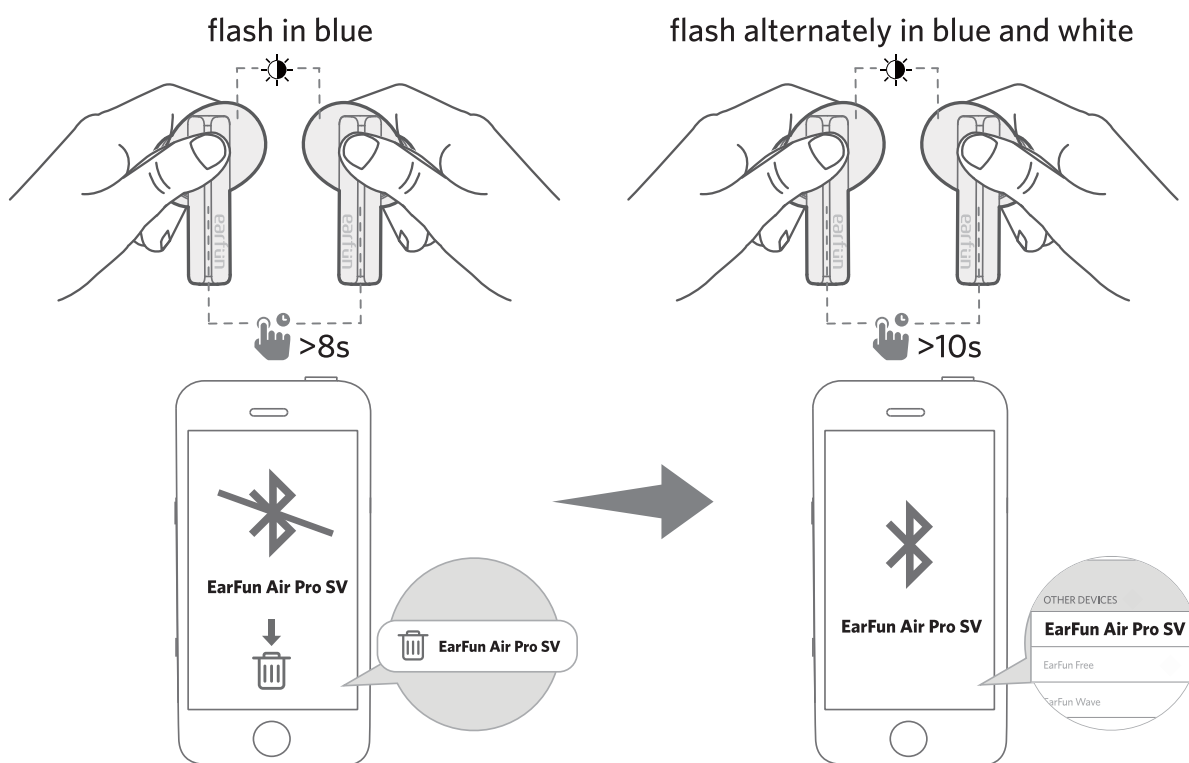

## 10 Troubleshooting

Q: Can I use both earphones separately?

A: Yes, each earbud could be used independently.

Q: The earphones are turning on, but it doesn't connect to my device?

A: To connect the earbuds to your device, please check if the Bluetooth of the device is on at first, then select 'EarFun Air Pro SV' on the Bluetooth list to get paired. If the earbuds still can't connect to your device, please try to reset it, or contact our customer support.

Q: Why the connection is not stable and cuts out intermittently?

A: Please make sure there are no objects between the earphones and your Bluetooth device, and make sure there is no radio or WIFI interference nearby.

Q: What is the range of Bluetooth earphones?

A: Bluetooth earphones have maximum range of 49 feet (15m, no obstacle). However, the actual range will depend on usage and environment.

Q: Is there volume control on the earphones?

A: Yes, touch L earbud once decreases the volume and touch R once could increase it.

Q: My earphones will not switch on.

A: Please recharge it and make sure it has enough battery power. If it is fully charged and still nothing happens or if you are not able to charge the unit, please contact our customer support for warranty cover.

Q: Is the charging case waterproof?

A: No, the charging case is not waterproof.

Q: Will the earbuds shut off automatically?

A: The earbuds will remain on as long as they are connected to a device. If no audio is in use, they will enter power-saving mode and wake up once audio is played. If the earbuds are not connected with any devices, they will automatically shut off in 30 minutes.

## Customer Service

For FAQs and more information:

Please Email to: [service@myearfun.com](mailto:service@myearfun.com)

[www.myearfun.com](http://www.myearfun.com)

## FCC Statement

---

Changes or modifications not expressly approved by the party responsible for compliance could void the user's authority to operate the equipment. This equipment has been tested and found to comply with the limits for a Class B digital device, pursuant to Part 15 of the FCC Rules. These limits are designed to provide reasonable protection against harmful interference in a residential installation. This equipment generates uses and can radiate radio frequency energy and, if not installed and used in accordance with the instructions, may cause harmful interference to radio communications. However, there is no guarantee that interference will not occur in a particular installation. If this equipment does cause harmful interference to radio or television reception, which can be determined by turning the equipment off and on, the user is encouraged to try to correct the interference by one or more of the following measures:

- Reorient or relocate the receiving antenna.
- Increase the separation between the equipment and receiver.
- Connect the equipment into an outlet on a circuit different from that to which the receiver is connected.
- Consult the dealer or an experienced radio/TV technician for help.

This device complies with part 15 of the FCC rules. Operation is subject to the following two conditions:

- (1) This device may not cause harmful interference.
- (2) This device must accept any interference received, including interference that may cause undesired operation.

## RF Exposure Compliance

---

This equipment complies with FCC radiation exposure limits set forth for an uncontrolled environment. This transmitter must not be co-located or operating in conjunction with any other antenna or transmitter.

## CAUTION

Risk of explosion if the battery is replaced by an incorrect type

Disposal of a battery into fire or a hot even, or mechanically crushing or cutting of a battery, that can result in an explosion; Leaving a battery in an extremely high temperature surrounding environment that can result in an explosion or the leakage of flammable liquid or gas; A battery subjected to extremely low air pressure that may result in an explosion or the leakage of flammable liquid or gas.



To prevent possible hearing damage, do not listen at high volume levels for long periods.



The Bluetooth word mark and logos are registered trademarks owned by Bluetooth SIG, Inc. and any use of such marks by Earfun Technology (HK) Limited is under license.

Other trademarks and trade names are those of their respective owners.

## EU Declaration of Conformity

Earfun Technology (HK) Limited hereby declares that this equipment is in compliance with the essential requirements and other relevant provisions of Directive 2014/53/EU and RoHS 2011/65/EU Directive. The declaration of conformity may be consulted in the support section of our Web site, accessible from [www.myearfun.com](http://www.myearfun.com)

## UK Declaration of Conformity

Hereby, [Earfun Technology (HK) Limited] declares that the radio equipment type [TW306] is in compliance with UK Radio Equipment Regulations (SI 2017/1206). The full text of the declaration of conformity is available at the following internet address: [www.myearfun.com](http://www.myearfun.com)



型號 /MODEL: TW306  
FCC ID: 2AVIT-TW306

