

# AI Voice Recorder

## User Manual

WhatsApp QR code  
WhatsApp ID:86 18820461144



 **support@vormor.cn**

Please read this instruction manual carefully  
and keep it properly before you use the product.

# Before Using

## .Device Charging:

We suggest charging the device before using, normally 2 hour for fully charged. Only supports 5V 1A, does not support fast charging.



## .WIFI Connecting:

Please prioritize using online translation, it can connect to the WIFI or mobile HotSpot. (Note: Route WiFi Please choose a wireless network in the 2.4GHz/ 5 GHz band, mobile hotspot: Android mobile hotspot setting 2.4GHz/ 5 GHz, Please turn on maximum compatibility in Apple mobile phone hotspot settings.



# Booting

Long press the on/off button to turn on the device and enter boot-up guidance

The steps are as follows:

(1) Select the language.

(2) Enter the welcome page and start activation.

(3) After successfully connecting to the network, the next step in the upper right corner will light up. If the network is not good or the network connection is unsuccessful, it will be gray and you cannot proceed to the next step.



(1) Select a language

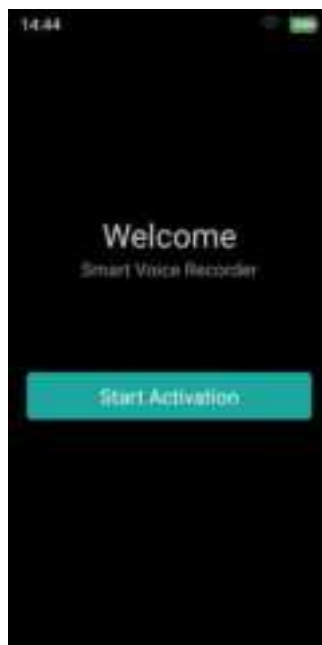

(2) Start activation

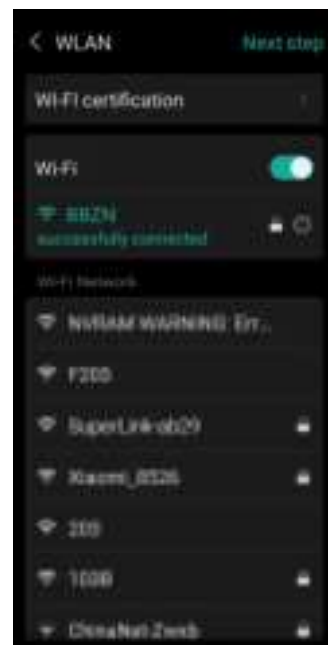

(3) Connect to the Internet

(4) Click next after the time and time zone are updated.

(5) Next, you can choose to register an account or select "Not log in yet" in the upper right corner. Of course, if you choose to register an account, you need to enter the correct email address and password.

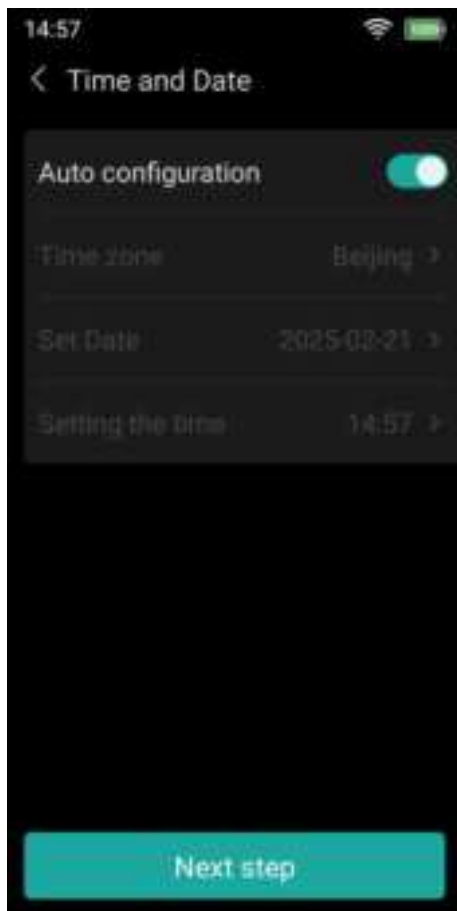



(4) Time and time zone updates



(5) Sign up for an account

# 01.Recording function

## Turn on recording

- (1). Click on the recording mode on the home page to start the recording directly, please select the corresponding language before opening the recording.
- (2). In the high-end version, you can click the REC button in the upper right corner of the device or press the button  to confirm the transcription language, and click the REC button or press the button  again to start recording.

## Differences in recording scenes

(The high-end version has the following recording scene options)

- (1). General mode: applicable to most recording scenarios, best compatibility, high sound restoration.
- (2). Meeting mode: Suitable for conferences, forums, seminars and other multi-person speaking scenarios.
- (3). Interview mode: suitable for one-to-one or three-person interviews, such as face-to-face interviews and company interviews and street visits.
- (4). Speech mode: For large classrooms, press conferences or large lectures with large venues and large numbers of people, etc. Such as university lecture halls, large-scale press conferences and large-scale knowledge lectures.

## Recording quality

32KHz/512kbps-Standard/Interview/Conference/  
Presentation

## Recording duration

- (1). Recording > 2.5 hours with the screen on
- (2). Recording > 6.5 hours with screen off

\*The above are all laboratory test data, Subject to the actual usage data of the user.

## **Insert a picture while recording**

During the recording process, click the photo button in the lower left corner to take a picture, and click the OK button to insert the captured picture

## **Distinguish speakers**

Before recording, please click "mine" - "Transcription Settings", choose online transcription", and "automatic speaker identification" switch will be turn on. So the recording can automatically distinguish the speakers in real time). To get a more accurate result of distinguishing speakers, please go back to "Document" page, and click the file for accurate transcription.

# **02. Transcription services**

## **Online/offline transcription**

(1). Online transcription

during the recording process, your audio will be uploaded to the cloud engine for transcription, and you can manually upload the whole audio for transcription after the recording is finished. Please connect to Internet to use this function, and the transcription rate is more accurate.

(2). Offline transcription

uses the local engine to transcribe, no data will be uploaded, and it can be used even without internet connection.

## **Online/offline transcription settings**

You can choose the transcription mode in [Mine] -

[Transcription Settings], After setted, the recording will be transcribed using the selected transcription mode by default

## **Multilingual transcription**

You can choose the language to transcribe before recording  
(It should be noted that you can only transcribe a recording once after recording)

## **View the transcription results**

After the transcription is completed, you can open the recording file in document to view the audio transcription result

## **Transcription accuracy**

(1). Chinese transcription: Clear sound quality and standard pronunciation of Mandarin audio, the transcription accuracy can reach up to 98%.

(2). Other languages are generally above 90%.

\*The above are all laboratory test data, and the actual usage data of users shall prevail

## **Solution of transcription failed**

If the transcription failed due to network or other reasons, you can click the "Transcription" again to complete the accurate transcription.

## **Share the transcription**

(1). Click "Documents", open the file you want to share, click the "share" button in the upper right corner. Then you will enter the sharing page, and you choose two ways for sharing: QR code sharing and email sharing.

(2). Connect the voice recorder to the computer with a USB cable when the device is turned on (For MAC computer, you need to install Android file transfer tool, like "Android File Transfer", etc) You can check the transcription content on your "computer" - "device and drive" - "Vormor M5" and export to computer.

## 03.AI Interpretation(Please make sure your network is successfully connected before use)

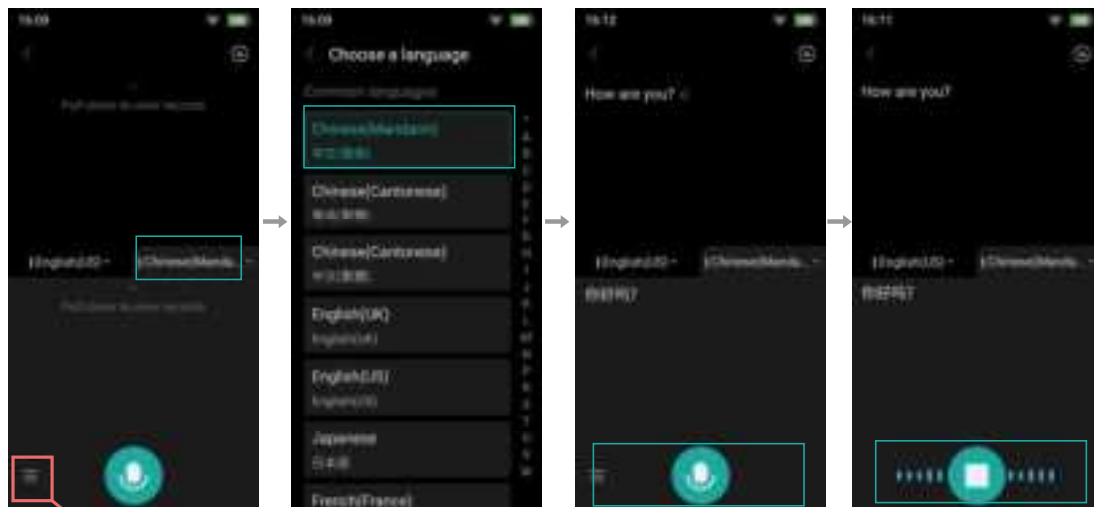

Offline Interpreting: Click this button and turn on Offline Interpretation

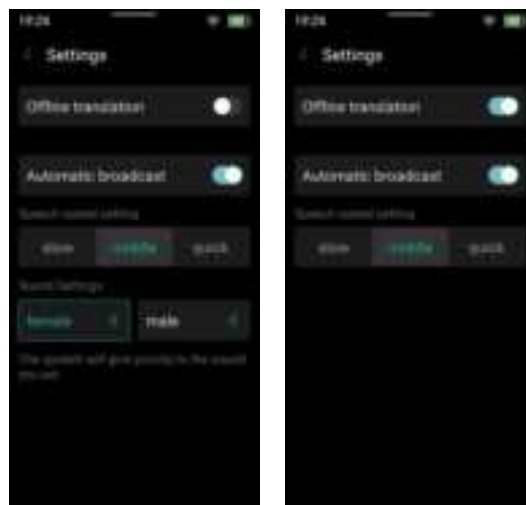

- (1). Language Selection: Click the language bar. You can select the original language (left one in red), and translation language (right one in blue).
- (2). Voice Input: One click the voice button to start speaking.
- (3). One click the button again to end speaking, and the voice will be automatically recognized for translation and conversion. Tap the voice on the screen to playback conversation.



## 04.AI Translation(Please make sure your network is successfully connected before use)

Offline Translation: Click this button and turn on Offline Translation

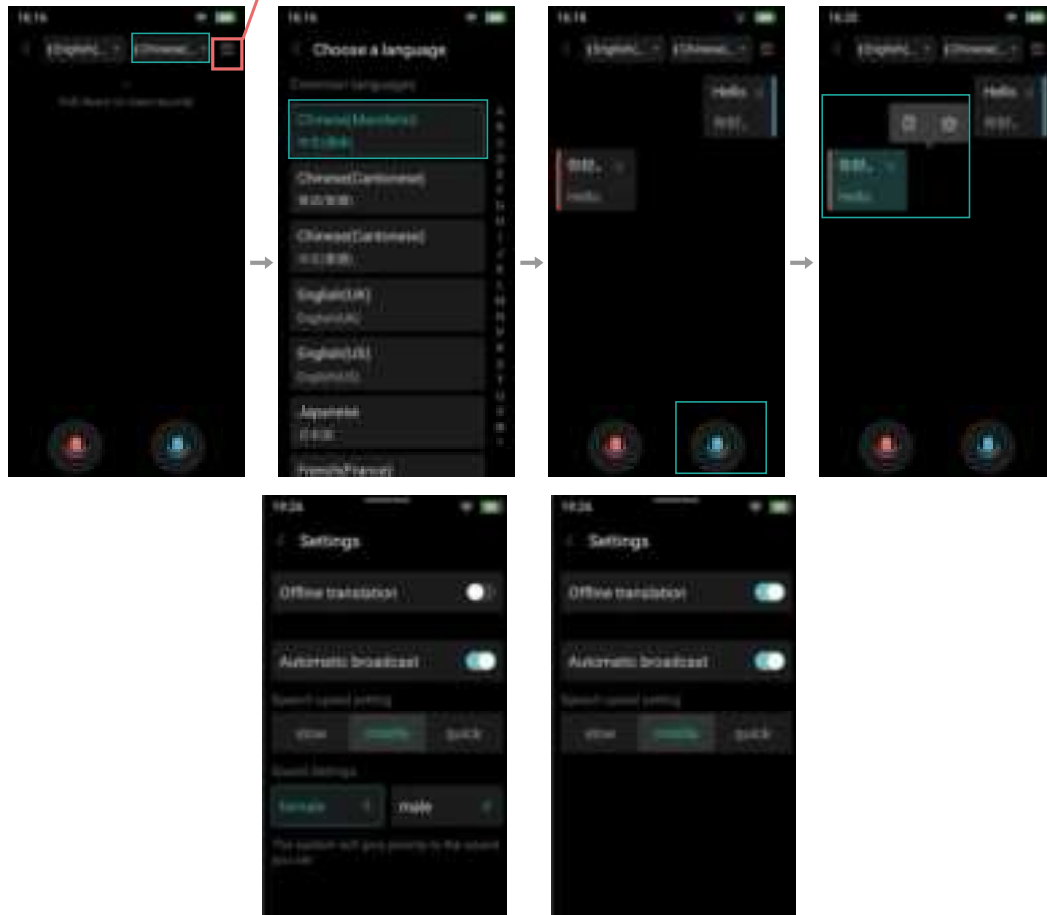

- (1). Language Selection: Click the language bar. You can select the original language (left one in red), and translation language (right one in blue).
- (2). Voice Input: Long press the red/blue button and start talking when you hear a "beep" sound, red is the original language, blue is the translation language. Be sure to speak the corresponding language you choosed, otherwise it will not be recognized.
- (3). Release your hand to end the conversation, and the voice will be automatically recognized, translate and convert. Tap the voice on the screen to playback the conversation.

## 05.Photo Translation(Please make sure your network is successfully connected before use)



Offline translation: Click the menu button in the upper right corner and turn on Offline Translation.

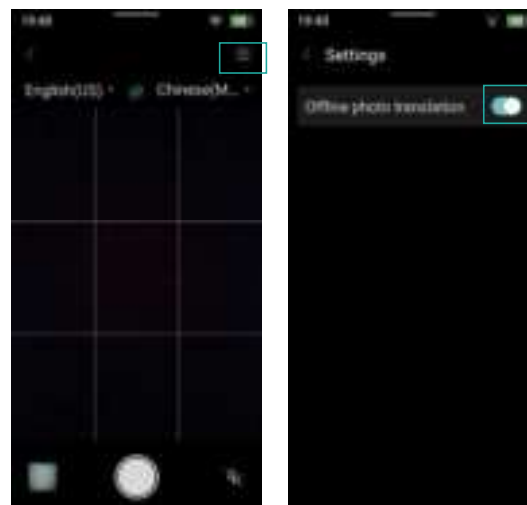

- (1). Language Selection: Click the language bar. You can select the original language (left one), and translation language (right one).
- (2). Photo Translation: Point the camera at the photo or text, then tap the screen to focus it and press the "Photo" button to take a photo. The photo will be recognized, and the translation result will be displayed on the screen after the analysis is completed.

# **06.Powered by ChatGPT**

## **AI Question Answering**

AI Q&A, your smart Q&A expert! It possesses extraordinary comprehension and memory, both in learning difficult problems, or troubles in life, as long as you ask , it can quickly give accurate and detailed answers. Make your journey to knowledge smoother and your life more convenient!

## **AI Voice**

AI voice, your intelligent voice-activated assistant! It's magical, and it responds to you quickly if you talk to it . AI voice can easily handle it. Make your life more convenient, smart and fun!

## **AI Characters**

Q&A Teachers, Interviewers, Programmers, Family Doctors, and Fitness Trainers play their own unique roles in different scenarios Yes, to provide users with convenient and efficient services.

## **AI Writing**

AI Writing, Your Smart Text Partner! With just one click, it weaves colorful texts with agility World. Whether it's the timeliness of news reports or the creativity of advertising copy, AI writing can be easily controlled. Make your writing journey efficient and fun.

## **AI recognition**

AI recognition, your intelligent visual housekeeper! Whether it's searching for products and recognizing plants in daily life, or detecting defects and managing inventory in milliseconds in industrial production, AI Litmap can transform images into valuable information through its

powerful algorithms. From the professional field to daily life, AI Litmap can break through visual boundaries and open up a more efficient and smarter “seeing” journey for you!

## **07.Cloud storage capabilities**

### **Cloud space pick-up**

After logging in for the first time, new users will manually receive 5G free cloud space.

### **Upload the cloud space**

In "Document", select "Batch Operation" button in the upper right corner to upload multiple files to the cloud.

### **View cloud space on the web side**

Log in to the web with the same account as the voice recorder to view cloud files on the web client.

Website: <https://r.vormor.cn/index>

On the device side, the cloud storage space can be viewed on the [Settings] page.

## **08. AI Member Services**

View member services

Open "Mine" and click the "Member Center" in gold color.

You can purchase the exclusive benefits for Xiaobei

AI members.

**FCC Warning:**

This equipment has been tested and found to comply with the limits for a Class B digital device, pursuant to part 15 of the FCC Rules. These limits are designed to provide reasonable protection against harmful interference in a residential installation. This equipment generates, uses and can radiate radio frequency energy and, if not installed and used in accordance with the instructions, may cause harmful interference to radio communications. However, there is no guarantee that interference will not occur in a particular installation. If this equipment does cause harmful interference to radio or television reception, which can be determined by turning the equipment off and on, the user is encouraged to try to correct the interference by one or more of the following measures:

- Reorient or relocate the receiving antenna.
- Increase the separation between the equipment and receiver.
- Connect the equipment into an outlet on a circuit different from that to which the receiver is connected.
- Consult the dealer or an experienced radio/TV technician for help.

**Caution:** Any changes or modifications to this device not explicitly approved by manufacturer could void your authority to operate this equipment.

This device complies with part 15 of the FCC Rules. Operation is subject to the following two conditions:

(1) This device may not cause harmful interference, and (2) this device must accept any interference received, including interference that may cause undesired operation.

This equipment complies with FCC radiation exposure limits set forth for an uncontrolled environment. This equipment should be installed and operated with minimum distance 0mm between the radiator and your body.