

# Linkind

# User Manual

## Smart solar spotlights

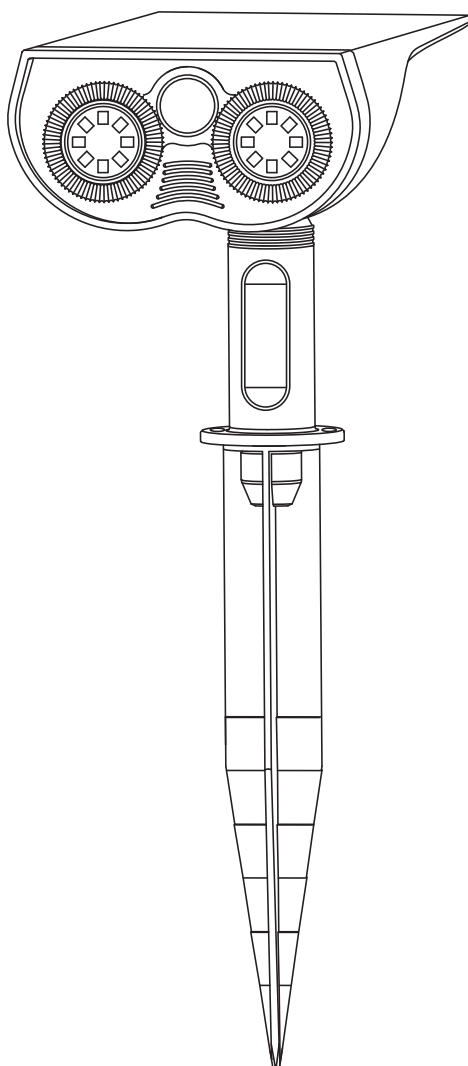

Scan the QR code  
to watch the  
How-To videos



Works  
with | **AiDot**

## SPECIFICATION

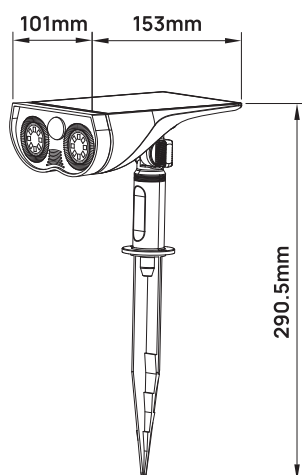

waterproof button switch

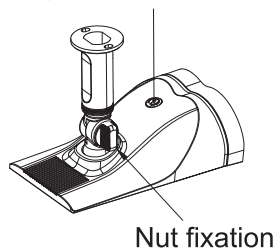

Nut fixation

LED	28LEDs
Location Type	Wet location
Working temperature	-10-40°C
Housing material	ABS
Induction mode	Light control +motion sensor
Illumination angle	90°

## INTRODUCTION

The solar landscape spotlights can automatically detect the changes in the brightness of the external environment. When the brightness is low enough, it will automatically switch from energy-saving mode to lighting mode without motion detection (Auto on at night / Auto off at sunrise).

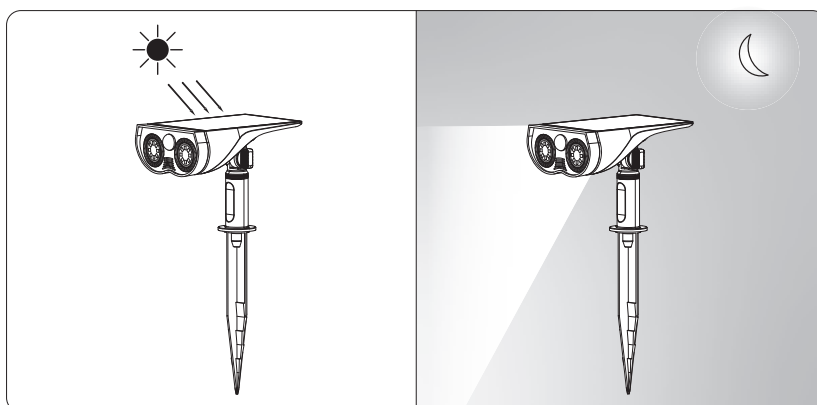

## PACKAGE CONTENTS

- A 2 x Solar Landscape Spotlights
- B 2 x Plastic Anchor
- C 2 x Plastic rod
- D 2 x turn-knob
- E 6 x Gecko screw
- F 6 x Screws
- G 1 x User Manual

**\*Note:** If 4 Pack, content A-F will double.  
If 6 Pack, content A-F will triple.

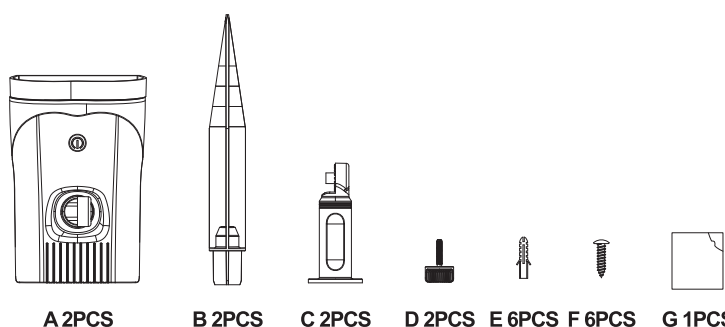

A 2PCS

B 2PCS

C 2PCS

D 2PCS

E 6PCS

F 6PCS

G 1PCS

## INSTALLATION

Press the red button and select a desired mode. Then choose a place that can get enough sunshine to install the light, the more sunshine it gets, the longer it can illuminate.

### Method 1: Ground Inserted

- ① Connect the ground stake with the light. Then, adjust the angle of lamp holder and tighten the knob.
- ② Insert the whole light into the ground vertically.

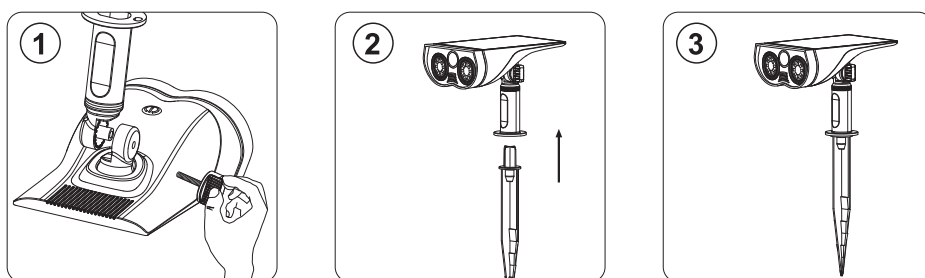

**Note:** Please insert the turn-knob from the correct side as shown above.

### Method 2: Wall Mounted

- ① Punch two holes on the wall with a drill bit and insert the attached wall plugs into holes. Then, twist the screws through the screw holes of holder into the wall plugs.
- ② Adjust the angle, then tighten the holder and the light through the knob screw. Adjustable Angle: horizontal 180°, vertical 90°

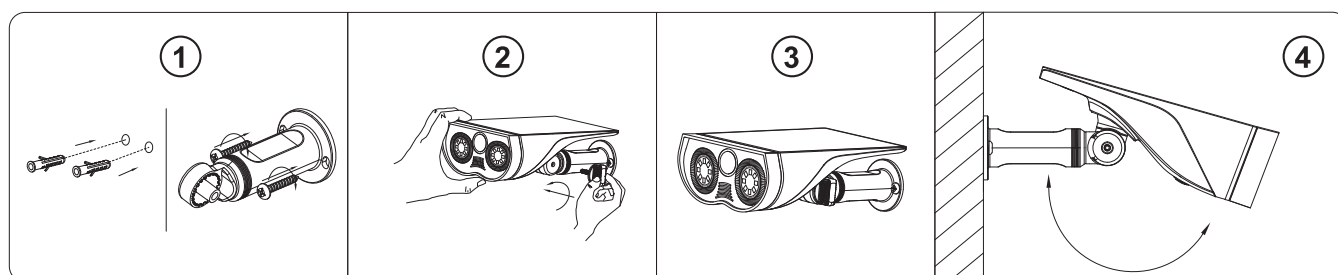

**Note:** Please insert the turn-knob from the correct side as shown above.

## OPERATION GUIDE

The default mode of the product is OFF mode. Press the power button to adjust modes when using the light.

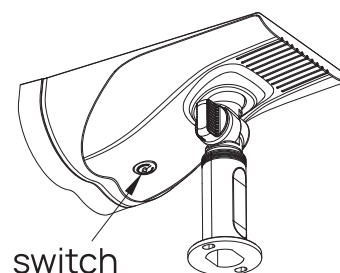

## LIGHTING MODES

### Click the button to switch colors

Devices :Click the button to switch the following colors Red/ Orange/Yellow/Green/Blue/Indigo/ Violet/2700K/6500K;

## APP BLUETOOTH MESH CONTROL:

1. The distance of AiDot APP to control Smart solar spot lights is 30m/98ft in open area.
2. After the smart spot lights is connected to the AiDot APP, the default detection mode of the smart solar spot lights is motion detection (30s lighting time). In the setting center of the smart solar spot lights, you can choose Motion Detection or Luminance Detection according to your needs, and edit 2 detections of lighting time.

## PAIRING TUTORIAL & IF THE SOLAR SPOT LIGHTS IS OFFLINE FROM THE APP

1. Light up the lights, and keep your phone and lights no more than 98ft (in open area) away, make sure your phone's Bluetooth is turned on.
2. Long press the red button of the 5s light until the solar spotlight enters the cycle: warm light/cool light. It is in pairing mood. After resetting, please re-add the light to APP.

## TIPS

Please turn off the light and charge it under direct sunlight or bright indoor/outdoor light source for about 48 hours before the time use. Please note that the charging of the solar panel may vary due to weather changes. On days where lighting source is not as bright, the charge of the spotlight will be affected and the working time will be shorter.

## TROUBLE SHOOTING

If the light failed to turn on, please

- a) check if there is any light source around;
- b) charge the light for a while and then cover the solar panel to have a test;
- c) make sure you hear a clear "click" sound when you press the button.

## APP CONTROL

Next, you can connect the solar lawn lights to the Aidot application using the following steps:

1. Scan the QR code below to download the AiDot APP.



Or search for "AiDot" in App Store or Google Play.



Google, Google Home and Google Play are trademarks of Google LLC.

2. Ensure that your phone's Bluetooth function is enabled and open the Aidot app. In the app, find the "Lighting & Control" entry, where you can locate the solar lawn lights.

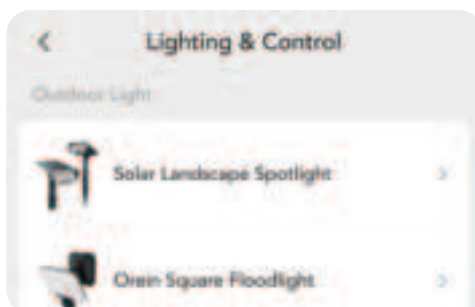

3. You can also try using the "Nearby" entry to search for the device you want to add. At this point, the app may request Bluetooth permissions on your phone.

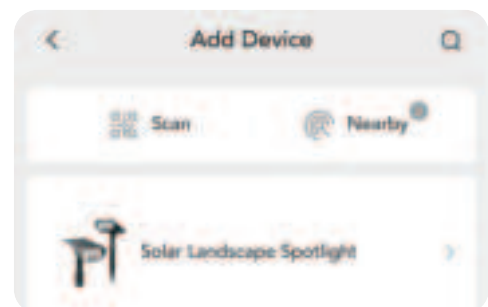

4. If you can't find your device, press and hold the red button on the bottom of the solar lawn light for more than 5 seconds. If you see the light on the solar lawn light alternating between white and warm light, this indicates that the device has been successfully reset and is now in the ready-to-connect state.

5. After a successful reset, you can try again in the Aidot app using the "Lighting & Control" entry or the "Nearby" entry to find and add the solar lawn lights.

## FUNCTION BUTTONS AND USAGE INSTRUCTIONS:

After successful installation, please locate the red button at the bottom of the device and follow these steps to activate the device: sequentially press the button, and the color will cycle through red, orange, yellow, green, blue, cyan, purple, warm white, and white. To turn off the lights, simply press the button again. This is the usage scenario before connecting to the Aidot app.

### Notice:

If you are testing our solar lawn lights during the day, you may encounter the following situation - the light turns on and then quickly goes off. This is because to conserve power, our solar lawn lights will remain lit for 30 seconds when used during the daytime. If you wish to keep the light continuously on, please cover the solar panel, which will keep the light on continuously. Our light sensor is located above the solar panel, and as soon as it detects that night is approaching, the light will turn on instantly.

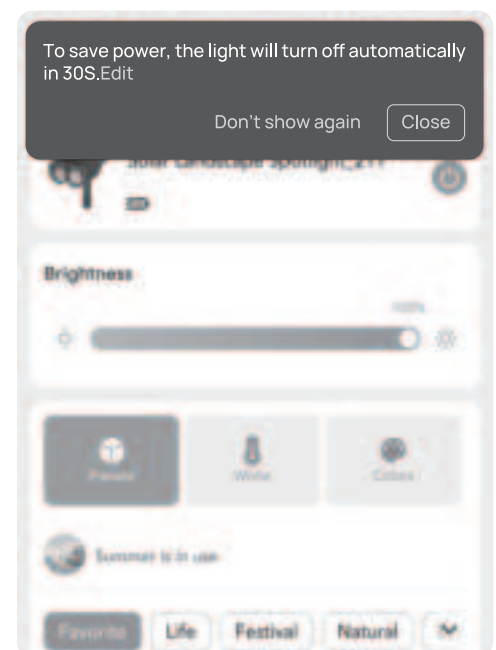

## EASILY MANAGE YOUR SOLAR SPOTLIGHT THROUGH THE AIDOT APP

After successfully adding the device, on the control interface of the Aidot app, you can easily manage your solar spotlight with the following features:

- a) Power Switch: Use the on/off button to control the device's power status, turning it on and off.
- b) Brightness Adjustment: You can flexibly adjust the brightness of the light within a range of 1% to 100%.





c) Presets Section: Here, you can find various light effect themes or scenarios. For example, during Christmas, you can switch to a Christmas-themed scenario with a single tap to create a cozier atmosphere.

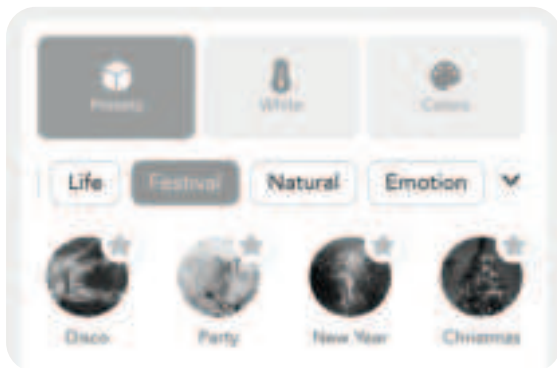

d) White Section: You can quickly switch the color temperature within a range from 2700K to 6500K to meet different lighting needs.



e) Colors Section: Using the circular mood color palette, you can swiftly choose your favorite colors to achieve personalized lighting effects.

**Solar lawn lights offer three main mode options to cater to different needs:**

1. Motion Detection Mode: In this mode, the light automatically turns on when someone approaches and turns off when they leave. This not only provides security lighting but also saves energy. This mode also includes a fantastic feature called "Dim Light Mode." When activated, the light will brighten when someone approaches at night and dim to a lower brightness when there's no one around. Additionally, there is a "Group Control" feature that allows multiple devices to trigger together. If one device detects someone nearby, the other devices will also light up simultaneously.

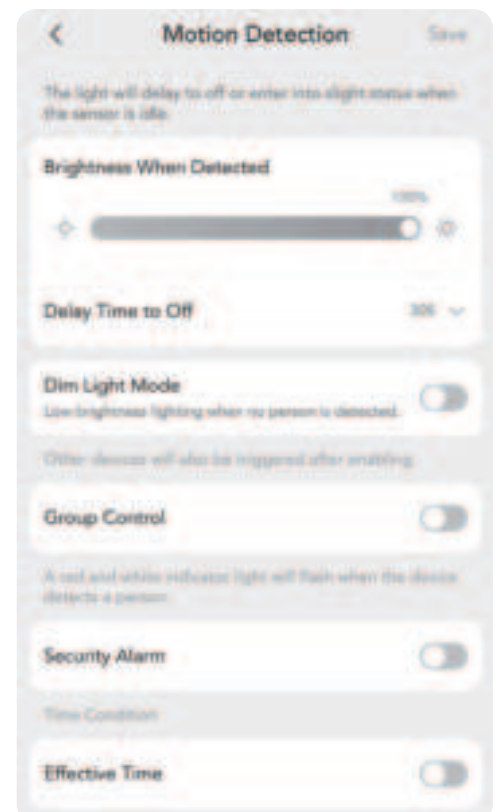

2. Luminance Detection Mode: In this mode, the light automatically turns on at dusk and remains off during daylight hours, eliminating the need for manual control. This mode offers convenient automatic illumination.



3. Light Mode: In this mode, the light remains continuously on, providing steady illumination for your space, suitable for situations requiring all-day lighting.



## GROUP SYNCHRONIZATION CONTROL

Create a group control to synchronize all the solar lawn lights to perform the following actions:

1. Synchronize the execution of Preset light effect scenarios to have them work with the same scenario effects.

2. Synchronize color temperature settings to ensure they have consistent white light temperatures.

3. Synchronize color selection to ensure they display the same color effects.

This group control allows your solar lawn lights to achieve coordinated lighting effects between different locations or areas.



### Note:

If, during the creation of a group, some products only light up for 30 seconds or fail to sync, it may be because your devices are in different modes (Motion Detection/Luminance Detection/Light Mode). Especially in a daytime setting, the Luminance Detection mode may only light up for 30 seconds. We recommend switching all devices to Light Mode to ensure the



group remains continuously lit, maintaining consistent ambient lighting effects. This will ensure that all devices in the group can work together harmoniously to achieve lasting ambient lighting effects.

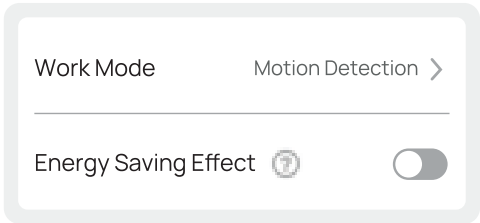

**THIS MUSIC RHYTHM FEATURE IS A LOT OF FUN:**

1. At the bottom of the device control page, you will find the 'Sync Lights with Music' music rhythm group entry, which you can use to create our music rhythm group. Additionally, you can also directly find the 'Sync Lights with Music' music rhythm group entry in the 'Automations' section on the home page to establish your music rhythm group.

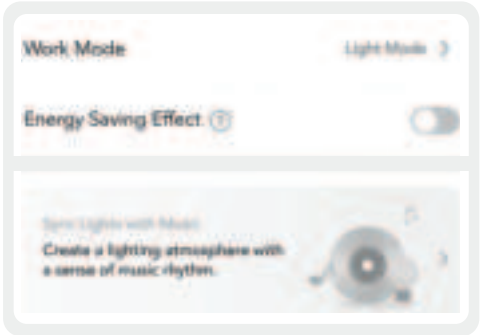

2. Using this feature, you can customize unique lighting effects based on different music light effect scenarios. This allows devices in the group to sync with the rhythm of the music, presenting a breathtaking music light show. You can choose from 'Calm,' 'Smooth,' 'Normal,' 'Lively,' 'Rapid,' or create your custom rhythm conditions to create the unique music light effect experience you desire, based on different ambient scene needs.

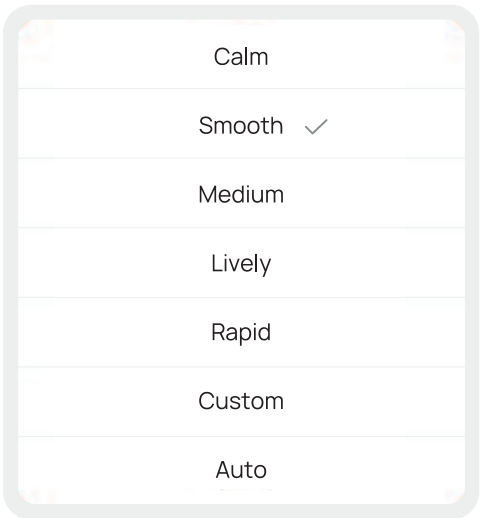

**Please note:**

To use the music rhythm feature, you need to grant the application Bluetooth permissions on your phone and ensure that the Bluetooth functionality on your phone is turned on.

**IDEAL INSTALLATION SCENARIOS**

1. Front or Back Yard: Align the solar lawn lights with plants, shrubs, or the lawn to enhance the aesthetics of your yard and provide soft illumination to the vegetation.

2. Wall Gradient Color Effects: Point the solar lawn lights toward the walls of your house to create gradient color effects, generating a layered ambient atmosphere.

3. Spaced 1.5-2 Meters Apart: Install each solar lawn light at intervals of approximately 1.5 to 2 meters to create a more unique and festive ambiance.

These recommended scenario setups allow solar lawn lights to achieve their best performance, bringing beautiful lighting and ambiance to your outdoor space.

### **RECOMMENDED GRADIENT LIGHT SHOW COLOR COMBINATIONS**

1. Blue and Green Gradient: This combination can create a fresh outdoor ambiance, especially suitable for courtyards or gardens.

2. Purple and Pink Gradient: This option adds a touch of romance and mystery to your outdoor space.

3. Orange and Red Gradient: These warm colors can create a cozy atmosphere for evening courtyards or patios.

4. Rainbow Gradient: Use a variety of colors such as red, orange, yellow, green, blue, and purple to create a colorful visual feast.

5. White and Warm White Gradient: This is a classic choice suitable for various occasions, providing soft and warm lighting effects.

### **RECOMMENDED HOLIDAY-SPECIFIC LIGHT COLOR COMBINATIONS:**

1. Independence Day (July 4th): The traditional red, white, and blue color scheme is a classic choice for Independence Day to commemorate the colors of the American flag. Combining red, white, and blue lights will help create a celebratory atmosphere for Independence Day.

2. Thanksgiving (4th Thursday of November): Thanksgiving is often associated with warm tones like orange, brown, and yellow to reflect the colors of the fall season.

3. Christmas (December 25th): The iconic colors of Christmas are red and green, so combining red, green, and white lights will create a festive atmosphere for the holiday season.

4. Halloween (October 31st): Halloween is typically associated with black, orange, and purple, and using these colors for your lights can add a touch of mystery to the holiday.

5. Valentine's Day (February 14th): Valentine's Day is usually associated with red and pink, so using red and pink lights will help create a romantic atmosphere for the holiday.

6. St. Patrick's Day (March 17th): St. Patrick's Day is typically themed around green, and using green and gold lights can emphasize this tradition.

7. Easter (date varies): Easter is often associated with bright colors like pink, yellow, and blue. Using lights in these colors can add a sense of joy to the holiday.

### **▲ FCC WARNING**

This device complies with part 15 of the FCC Rules. Operation is subject to the following two conditions: (1) this device may not cause harmful interference, and (2) this device must accept any interference received, including interference that may cause undesired operation.

Any changes or modifications not expressly approved by the party responsible for compliance could void the user's authority to operate the equipment.

**Note:** This equipment has been tested and found to comply with the limits for a Class B digital device, pursuant to Part 15 of the FCC Rules. These limits are designed to provide reasonable protection against harmful interference in a residential installation. This equipment generates, uses and can radiate radio frequency energy and, if not installed and used in accordance with the instructions, may cause harmful interference to radio communications.

However, there is no guarantee that interference will not occur in a particular installation. If this equipment does cause harmful interference to radio or television reception,

which can be determined by turning the equipment off and on, the user is encouraged to try to correct the interference by one or more of the following measures:

- Reorient or relocate the receiving antenna.
- Increase the separation between the equipment and receiver.
- Connect the equipment into an outlet on a circuit different from that to which the receiver is connected.
- Consult the dealer or an experienced radio/TV technician for help.

To maintain compliance with FCC's RF Exposure guidelines, This equipment should be installed and operated with minimum 20cm distance between the radiator and your body: Use only the supplied antenna.

### ⚠ Cautions

Solar lawn lights offer various installation methods, including wall mounting and direct ground insertion. During installation, make sure to ensure that the solar charging panel is not obstructed in any way to ensure smooth charging operations and maintain excellent battery life.

### ⚠ Cautions

To ensure you a longer battery life, we recommend for installing the solar light in a place with direct sunlight and no shade to let the solar spotlight fully charge for 2 days before the first use, which let you enjoy your colorful yard better.

## Linkind

Our goal is to bring you the best shopping experience on Amazon. If you have any questions about our product, please feel free to contact us. Our customer service is right here to resolve the case.



Mad in China

☎ 1 (877) 770-5727 (Mon.- Fri.9 to 5 PST)

✉ [service@linkind.com](mailto:service@linkind.com)

🏠 <http://www.linkind.com>

🗣 Why not share your stories to help other buyers?

📘 <https://www.facebook.com/linkind.lights>

📷 <https://www.instagram.com/linkindofficial>

📺 <https://www.youtube.com/@linkindofficial>

材质:105G铜版纸

尺寸:100\*138mm

印刷方式:单黑双面印刷

骑马钉:装订成册

\*红字部分不印刷

(该页不属于内容请删除后印刷)