

<p>Bluetooth Range: Up to 33 feet (10 meters)</p> <p>Charging Input/DCSV 1A max</p> <p>Memory Card Support: Up to 32GB</p> <p>Play Time: 6 Hours</p> <p>Average use at 50% of maximum volume. Results will be lower when volume is higher.</p>	<p>The Bluetooth® word mark and logos are registered trademarks owned by the Bluetooth SIG, Inc. and any use of such marks by Saker International is under license. Other trademarks and trade names are those of their respective owners.</p>
--	--

<p>Bluetooth Range: Up to 33 feet (10 meters)</p> <p>Charging Input/DCSV 1A max</p> <p>Memory Card Support: Up to 32GB</p> <p>Play Time: 6 Hours</p> <p>Average use at 50% of maximum volume. Results will be lower when volume is higher.</p>	<p>The Bluetooth® word mark and logos are registered trademarks owned by the Bluetooth SIG, Inc. and any use of such marks by Saker International is under license. Other trademarks and trade names are those of their respective owners.</p>
--	--

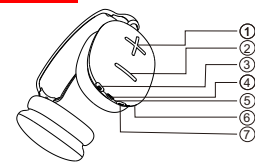

① :VOL+/Next Track
 ② :VOL- /Previous Track
 ③ :Power
 ④ :USB-C Charging Port
 ⑤ :Indicator light
 ⑥ :Pause/play/Answer
 ⑦ :Microphone hole



- ① :VOL+/Next Track
- ② :VOL-/Previous Track
- ③ :Power
- ④ :USB-C Charging Port
- ⑤ :Indicator light
- ⑥ :Pause/play/Answer
- ⑦ :Microphone hole

1. Insert the included charging cable's USB-C end into the charging port.
2. Insert the charging cable's standard USB end into the USB port of a computer or suitable wall adapter (not included).
3. The red LED Charging Indicator light will be on while the unit is charging and will be off when fully charged.

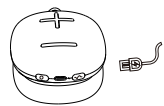
1. Insert the included charging cable's USB -C- end into the charging port.



2. Insert the charging cable's standard USB end into the USB port of a computer or suitable wall adapter (not included).

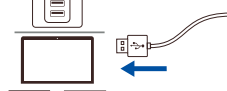

Charging
Charged

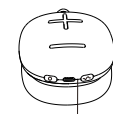

3. The red LED Charging Indicator light will be on while the unit is charging and will be off when fully charged.

1. Press and hold the power button for about 5 seconds to turn on your headphones. Once your headphones are turned on they will go into Bluetooth pairing mode. The red and blue indicator light start to flash.
2. On your phone, go to the Bluetooth page in the Settings app. Make sure Bluetooth is on before connecting to the available device "V80021 Headphones".
3. The blue light indicators will start to flash slowly after Bluetooth pairing is successful.

1. Press and hold the power button for about 5 seconds to turn on headphones. Once your headphones are turned on they will go into Bluetooth pairing mode. The red and blue indicator light start to



2. On your phone, go to the Bluetooth page in the Settings app. Make sure Bluetooth is on before connecting to the available device "V80021 Headphones".



3. The blue light indicators will start to flash slowly after Bluetooth pairing is successful.

Press to Play/Pause your track.
Press to pick up/end a call.
Press and hold to reject a call.

Press to switch between

Press to lower the volume.
Press and hold to go to the previous track.

Press to raise the volume.
Press and hold to go to the next track.



Press to Play/Pause your track.
Press to pick up/end a call.
Press and hold to reject a call.



Press to switch between

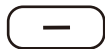

Press to lower the volume.
Press and hold to go to the previous track.



Press to raise the volume.
Press and hold to go to the next track.

This device complies with part 15 of the FCC Rules. Operation is subject to the following two conditions: (1) This device may not cause harmful interference, and (2) this device must accept any interference received, including interference that may cause undesired operation.

FCC warning:

Any Changes or modifications not expressly approved by the party responsible for compliance could void the user's authority to operate the equipment.

Note: This equipment has been tested and found to comply with the limits for a Class B digital device, pursuant to part 15 of the FCC Rules. These limits are designed to provide reasonable protection against harmful interference in a residential installation. This equipment generates uses and can radiate radio frequency energy and, if not installed and used in accordance with the instructions, may cause harmful interference to radio communications. However, there is no guarantee that interference will not occur in a particular installation. If this equipment does cause harmful interference to radio or television reception, which can be determined by turning the equipment off and on, the user is encouraged to try to correct the interference by one or more of the following measures:

- Reorient or relocate the receiving antenna.
- Increase the separation between the equipment and receiver.
- Connect the equipment into an outlet on a circuit different from that to which the receiver is connected.
- Consult the dealer or an experienced radio/TV technician for help.

The device has been evaluated to meet general RF exposure requirement. The device can be used in portable exposure condition without restriction.