

1.字体颜色: 黑色 Pantone Black 3 C
橙色 Pantone 1505C

2.单页尺寸: 140x144mm, (六折页) 展开尺寸: 840x144mm

3.材质: 128G双铜, 双面彩色印刷

折页首页

Automatic Pet Feeder Instruction Manual

Video Pro Edition

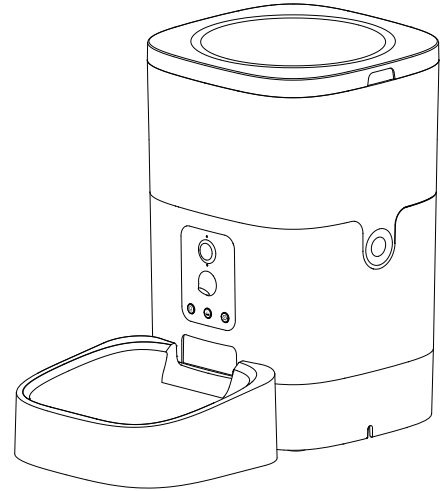

Please read the instruction manual carefully before using the product

- When children use this product, please use it under the accompany of their parents.
- Do not use the feeder for pets that cannot reach the food tray or have any physical disabilities.
- Do not immerse the base part in water at any time, as this may damage the electronic components such as the control panel.
- Do not place any foreign objects in the pet feeder.
- Do not use canned or moist food.
- Do not disassemble the device by yourself.
- Do not modify the pet feeder.
- If the device fails or is damaged, do not try to repair the pet feeder by yourself, contact the dealer immediately and solve it.
- Always unplug the power plug when not in use and before cleaning.
- Please switch off the power supply at the socket if the power plug of the appliance is damp. Do not attempt to unplug the unit.

- Do not allow your pet to chew or swallow any part. If you are concerned about the power cord, purchase a wire conduit (hard plastic protectors) at any hardware store to protect the power cord.
- Do not install or store the pet feeder where it will be exposed to weather or where the temperature drops below 0°C~40°C.
- Powered by alkaline D batteries. Do not use rechargeable batteries.
- Check the batteries regularly. Always replace with new batteries before leaving for a long time.
- Do not lift the pet feeder by the lid, food bucket or food tray. Lift and carry with both hands and the base while keeping the unit in an upright position.
- For dry food only, the size range is 2-12 mm in diameter. Larger food may get stuck in the food outlet.
- Read and follow all important instructions listed on the pet feeder and packaging.

After taking out the product, please confirm that the pet feeder and the accessories are complete or not.

Host

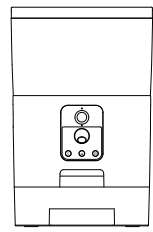

Accessories

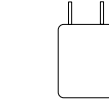

1 Food bowl

2 Power adapter

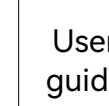
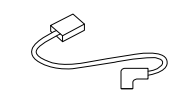

3 Power cord

4 User guide

*In order to provide better products, we will regularly improve our products. If the product image is different from the actual product, please refer to the actual one.

Front view

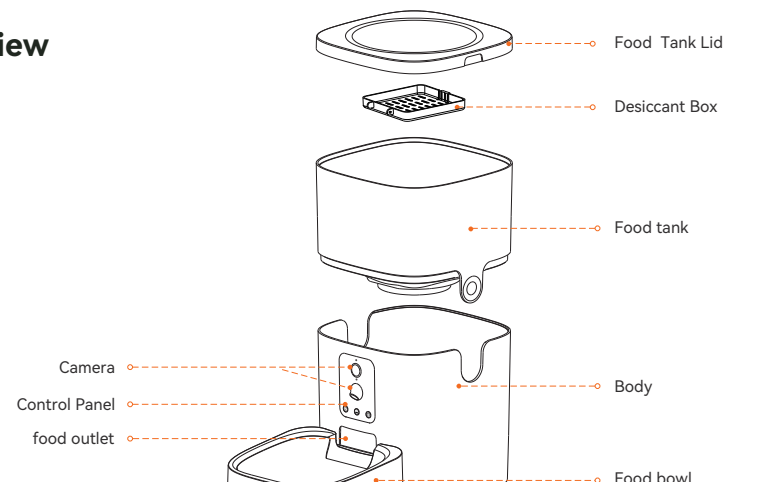

Bottom view

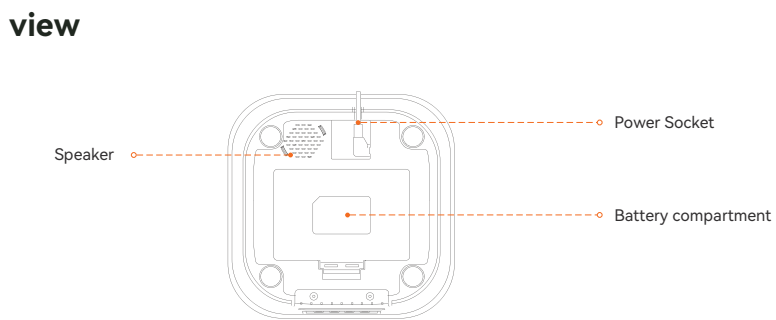

Installation sequence

(1) Installation of Food Tank Lid

Press down on the lid opening button, align it with the food tub snap, release the lid opening button to complete the installation.

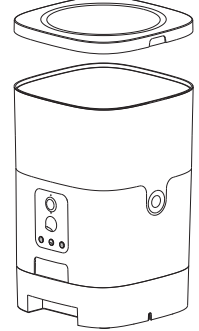

(2) Place the feeder base on a level surface and the food tub snaps onto the base.

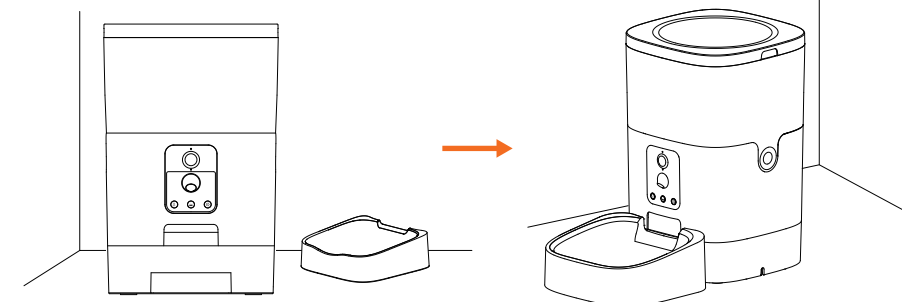

- For the health of your pet, it is recommended to clean the feeder regularly.
- When the device becomes dirty and there is a lot of loose food in the food trough, you can disconnect the power supply to clean the device.
- Use a soft damp cloth to clean the control panel and feeder base. The food bucket can be removed and washed with running water. Remember to dry it after cleaning before use.
- Do not put the product in the dishwasher, otherwise it will be permanently damaged!

Food tank capacity: 4L
Power supply: DC 5V/1A power adapter; 3pcs alkaline D batteries (batteries need to be purchased by yourself)
Power supply: AC110-240V input, DC5V output
Gross weight: 4L-2.06kg
Dimensions: 4L-19*19*30cm
BD-121-D

This device complies with part 15 of the FCC Rules. Operation is subject to the following two conditions: (1) this device may not cause harmful interference, and (2) this device must accept any interference received, including interference that may cause undesired operation.

Any changes or modifications not expressly approved by the party responsible for compliance could void the user's authority to operate the equipment.

NOTE: This equipment has been tested and found to comply with the limits for a Class B digital device, pursuant to Part 15 of the FCC Rules. These limits are designed to provide reasonable protection against harmful interference in a residential installation. This equipment generates, uses and can radiate radio frequency energy and, if not installed and used in accordance with the instructions, may cause harmful interference to radio communications. However, there is no guarantee that interference will not occur in a particular installation.

If this equipment does cause harmful interference to radio or television reception, which can be determined by turning the equipment off and on, the user is encouraged to try to correct the interference by one or more of the following measures:

- Reorient or relocate the receiving antenna.
 - Increase the separation between the equipment and receiver.
 - Connect the equipment into an outlet on a circuit different from that to which the receiver is connected.
 - Consult the dealer or an experienced radio/TV technician for help.
- To maintain compliance with FCC's RF Exposure guidelines, This equipment should be installed and operated with minimum distance between 20cm the radiator your body: Use only the supplied antenna.

Key Description

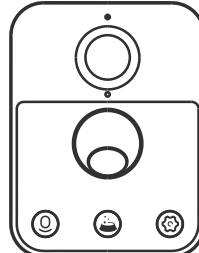

- Reset key:** Press and hold for 6 seconds to make a 'di di di' sound, the device will restart automatically after restoring the factory settings.
- Feed/Unlock key:** Manual feeding: short press to feed 1 portion of food and play 1 recording at the same time. Unlock: Long press for 3 seconds, the device is unlocked.
- Recording Key:** Record: Press and hold for 1 second to start recording, release to end recording with "di di". Recording time is up to 10 seconds. Delete Recording: Press and hold for 1 second to make a 'di' sound, release the recording button for 1S, and hear two 'di di' to end the recording. (In fact, it will overwrite the old recording with a short time blank recording.)

Indicator Colour	Indicator Signal	Device Status
White	Flashing	Waiting for network connection
	Ever Bright	Network Connection Successful
Red	Flashing	Abnormal limit switch detection (motor does not rotate)
	Slowly flashing	Battery backup low

Instructions for use

01 | Assembly

- Follow the installation order to complete the assembly.

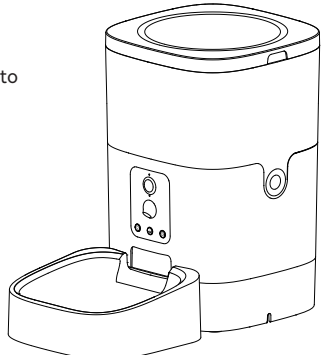

02 | Connect the power supply

- Plug the 5V/1A power adapter into a wall socket and connect the device.
- Open the battery compartment at the bottom of the device and install 3pcs alkaline D batteries (optional) to prevent power outages.
- The LED light turns on, indicating that the feeder is powered.

Note:
1) Batteries must be purchased by yourself.
2) Before connecting to the power supply, make sure all parts are clean and completely dry.

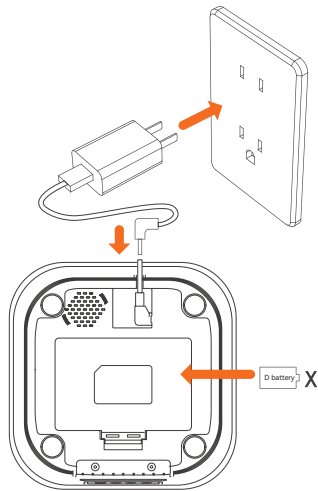

03 | Pouring pet food

- Fill the food tank with dry pet food and close the lid.

Note:

- Do not place wet or spoiled pet food.
- The recommended pet food size range is 2-12 mm.



04 | Reset

- Press and hold the button for 6 seconds to make a 'di di di' sound, and the device will restart automatically after restoring the factory settings.



05 | Feeding

- Manual feeding: 1 portion of food with a short press, 1 recording will be played at the same time.

Note:

- Please unlock the device before feeding.
- Feeding schedule will not be affected.



06 | Unlocking

- Long press for 3 seconds to unlock the device.



07 | Recording

- Recording: Press and hold for 1 second to start recording, release to end recording with two "di di". The maximum recording time is 10 seconds.

- Delete Recording: Press and hold for 1 second to make a 'di' sound, release the recording button in 1S, and hear two 'di di' to end the recording. (In fact, it will overwrite the old recording with a short period of blank recording.)

Note:

- It will play only if you press it when there is a recording.
- When the feeding time comes, the food comes out and 1 recording is played.



iCSee Home App download operation



1. Scan the QR code and download of the iCSee Home App.

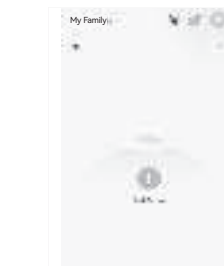

2. Enter the App main interface, add device.



3. First open the mobile phone Bluetooth and allow permissions, enter the interface, wait for the automatic discovery of the device and add.



4. Add the device successfully, tap Done.

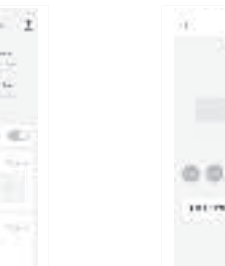

5. Tap "+" to add a new plan.

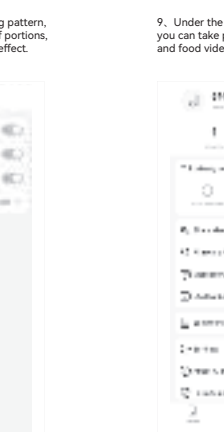
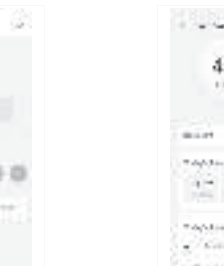

6. According to the pet's eating pattern, you can set the time, number of portions, food cycle, and save it to take effect.

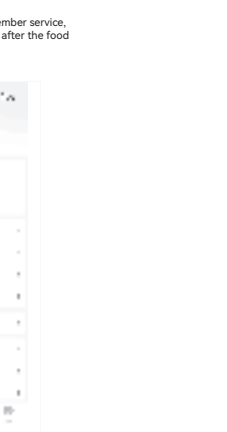

7. Under the opening of the receiver service, you can take photos before and after the food and food video.

Simple Troubleshooting

Problem Solution

Q1: App cannot connect to the device?

- A: 1) Do not use Chinese characters for the WiFi name and password, and do not exceed 12 characters. Please use a combination of numbers and letters. The device supports both 2.4G and 5GHz WiFi signals.
2) Conflicts in some software in the phone may also cause network connection failure. Please restart the phone, turn off non-system software that starts automatically, turn on the phone's Bluetooth and positioning, and then try to reconnect.

Q2: The feeder does not feed properly or does not feed at all.

- A: Please check whether there is too much food in the food tray and whether the food channel is blocked, clean the food outlet and food channel. When using battery power, please check whether the battery is dead or not, and whether the battery is leaking.

Q3: Feeder display offline

- A: Please check the distance between the feeder and the router at home, not more than 10 metres, and try not to separate walls in between. According to the characteristics of WiFi, the WiFi signal will drop sharply across the wall, resulting in unstable connection offline.

Q4: No response when switching on the router

- A: First check if the power is plugged in and the switch is on. If they are all plugged in, please check whether the power adapter and power cord are damaged and contact customer service to deal with it.