



Read all instructions before using



**CT 26 EI**

**CT 36 EI**

**CT 36 EI AC**

**CT 48 EI AC**

Festool GmbH  
Wertstraße 20  
73240 Wendlingen  
Germany  
[www.festoolusa.com](http://www.festoolusa.com)



10768084\_A / 2023-12-11

1

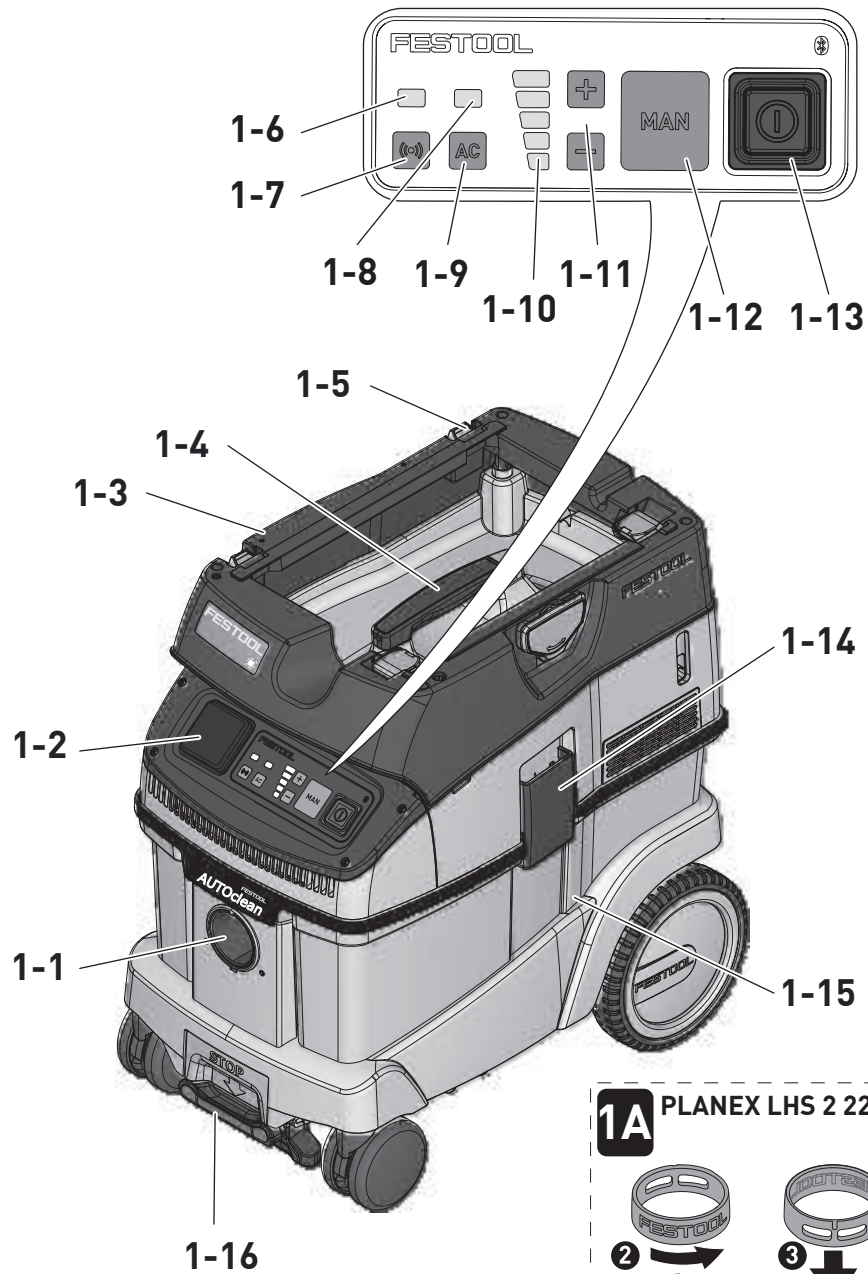

**1A** PLANEX LHS 2 225

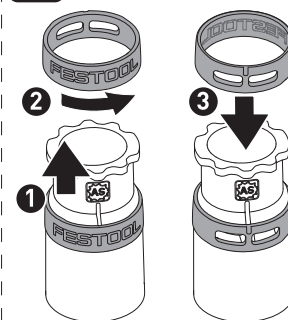

2

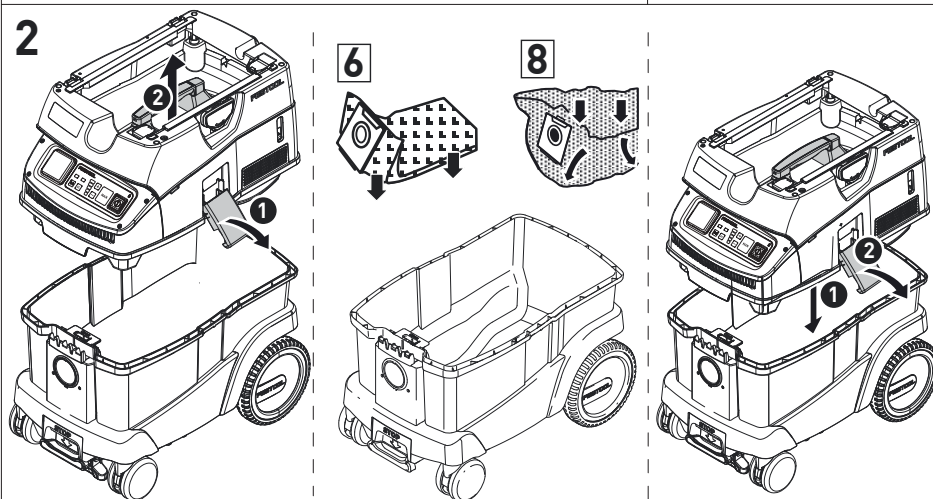

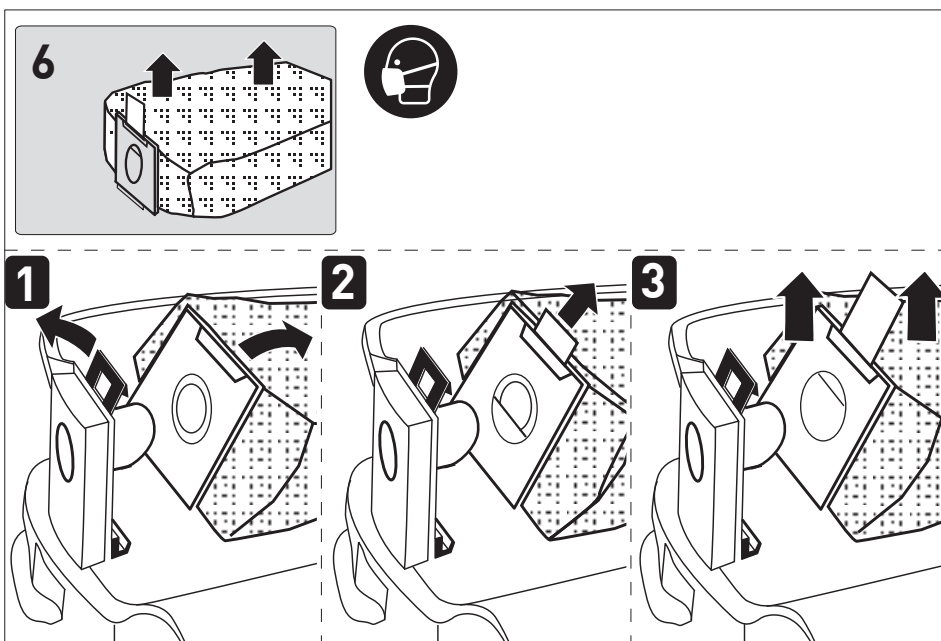
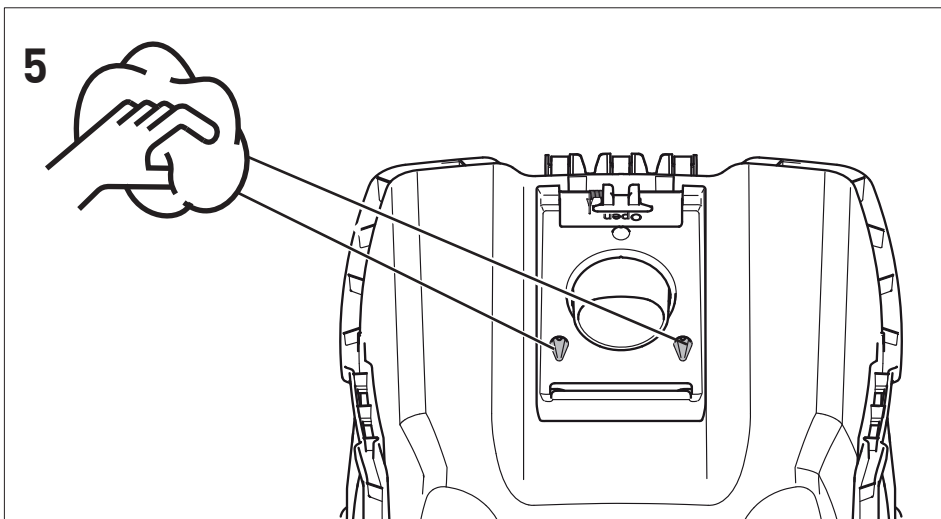
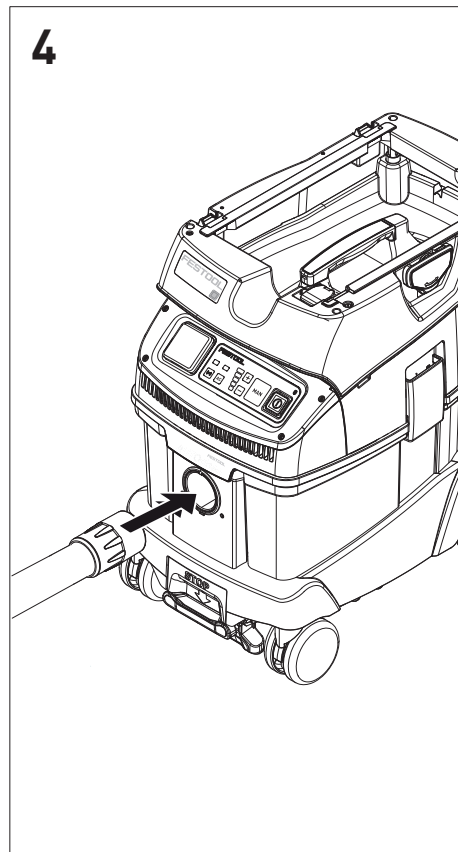
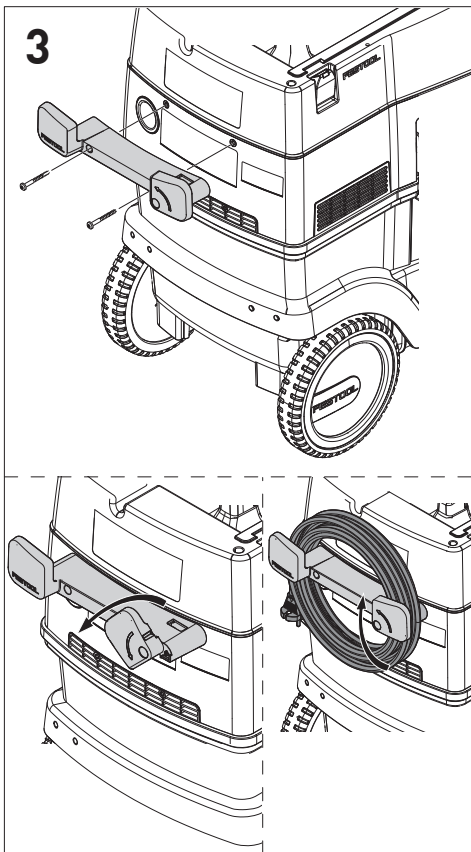

7

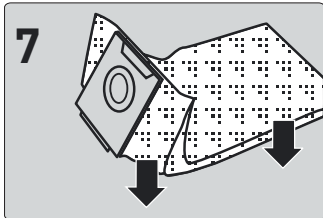

SC FIS-CT26  
SC FIS-CT36  
SC FIS-CT48

1

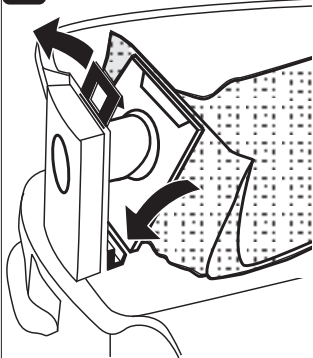

2

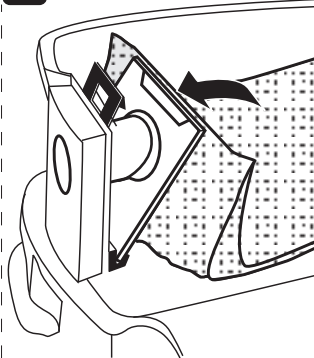

3

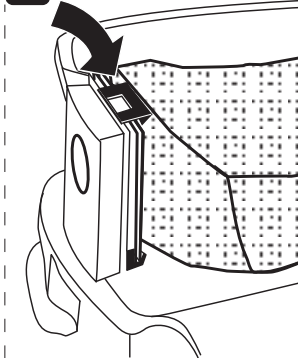

8

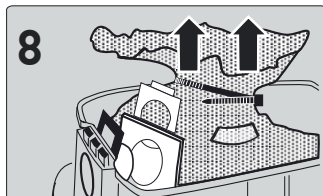

1

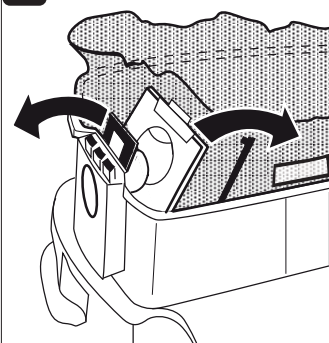

2

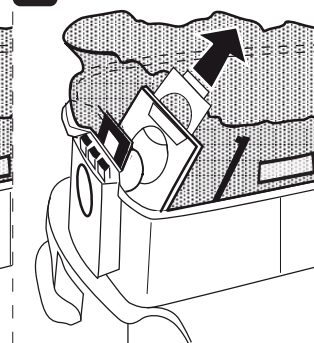

3

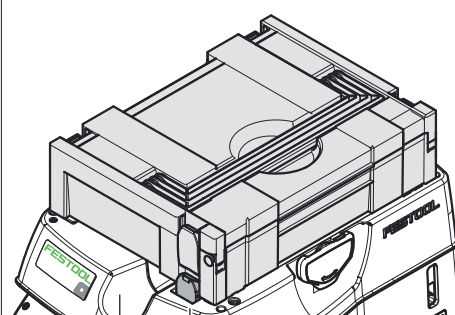
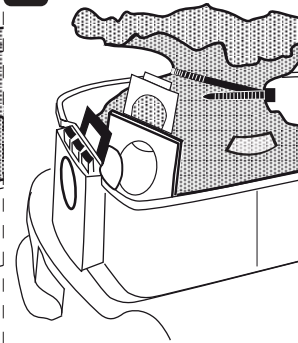

8-2

8-1

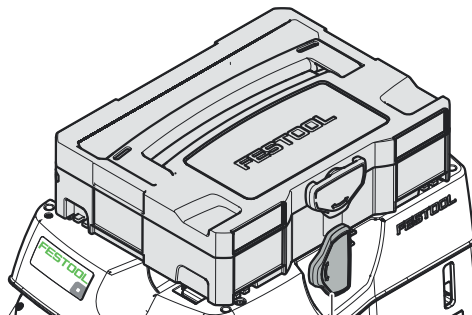



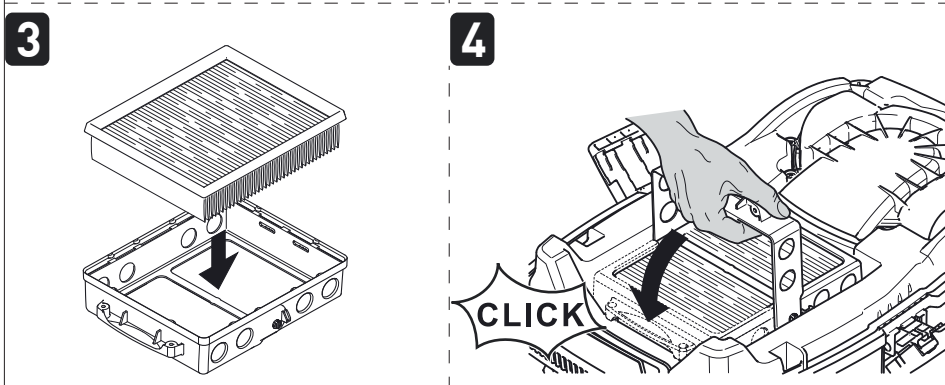
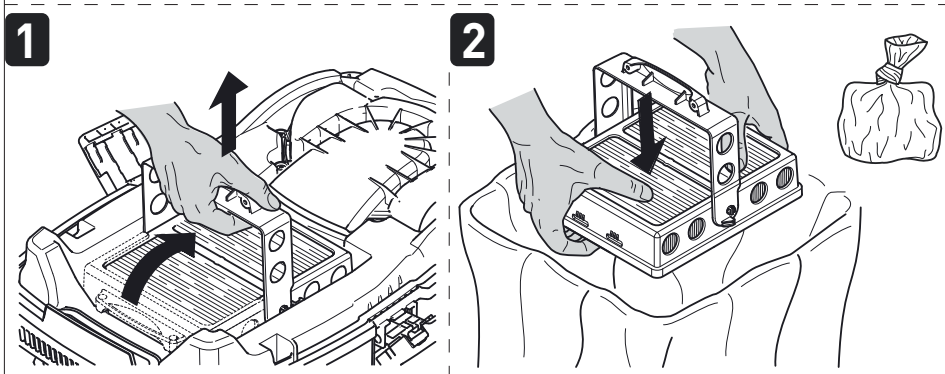
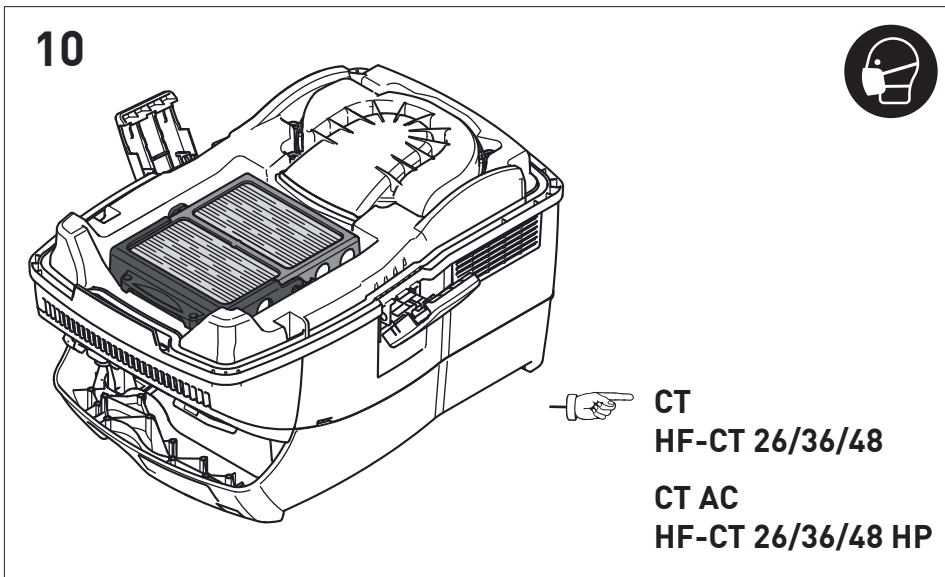
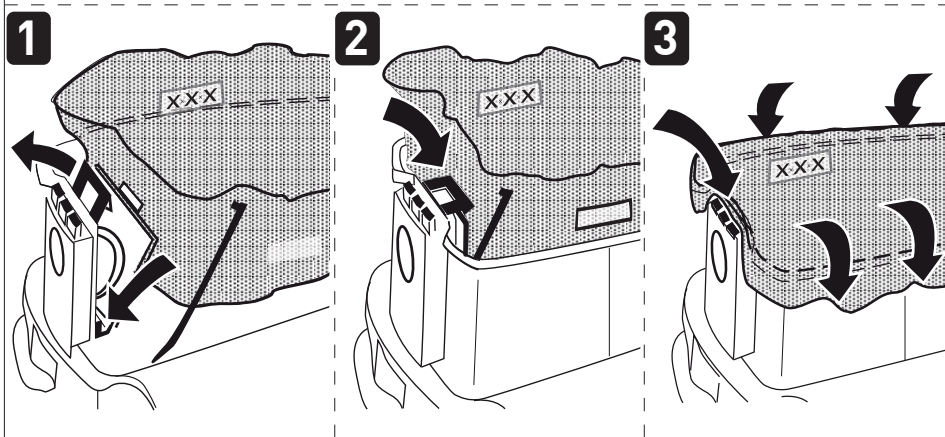
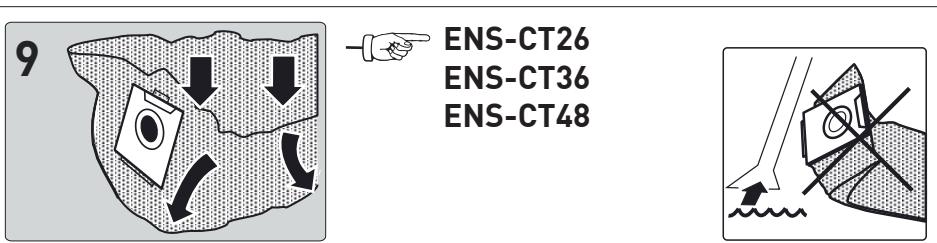



8-1



**Contents**





1	Symbols.....	6
2	About this manual.....	6
3	Safety warnings.....	7
4	Parts of the machine.....	10
5	Technical data.....	11
6	Intended use.....	11
7	Commissioning.....	12
8	Connecting a device.....	13
9	Settings.....	14
10	Working.....	14
11	Service and maintenance.....	15
12	Accessories.....	16
13	Environment.....	16
14	General information.....	16



**1 Symbols**

-  Warning of general danger
-  Warning of electric shock
-  Read the operating manual and safety warnings.
-  Pull out the mains plug
-  Wear a dust mask.
-  Machine contains a chip which stores data. See section 14.2
-  Tip or advice

**2 About this manual**

**Save these instructions**  
It is important for you to read and understand this manual. The information it contains relates to protecting **your safety** and **preventing problems**. The symbols below are used to help you recognize this information.

	DANGER	Description of imminent hazard and failure to avoid hazard will result in death.
	WARNING	Description of hazard and possible resulting injuries or death.
	CAUTION	Description of hazard and possible resulting injuries.
	NOTICE	Statement including nature of hazard and possible result.
	HINT	Indicates information, notes, or tips for improving your success using the tool.

-  Handling instruction
-  Diameter
-  Safety class II
- W Watt
- V Volt
- ~ Alternating current
- a.c. Alternating current
- Direct current
- d.c. Direct current
- n<sub>0</sub> No load speed
- rpm min<sup>-1</sup> Revolutions per minute
- A Amperes
- Hz Hertz
- h hours
- min Minutes
- s Seconds
- kg Kilogram
- lb. Pound
- " Inch
- Pa Pascal
- dB Decibel

### 3 Safety warnings



## IMPORTANT SAFETY INSTRUCTIONS

When using an electrical appliance, basic precautions should always be followed, including the following:

### **READ ALL INSTRUCTIONS**

### **BEFORE USING THIS DUST EXTRACTOR:**



## **WARNING** - To reduce the risk of fire, electric shock, or injury:

- Do not leave the dust extractor when plugged in. Unplug from outlet when not in use and before servicing.
- Use indoors only.
- Do not allow to be used as a toy. Close attention is necessary when used by or near children.
- Use only as describes in this manual. Use only manufacturer's recommended attachments.
- Do not use with damaged cord or plug. If the dust extractor is not working as it should, has been dropped, damaged, left outdoors, or dropped into water, return it to a service center.
- Do not pull or carry by cord, use cord as a handle, close a door on cord, or pull cord around sharp edges or corners. Do not run dust extractor over cord. Keep cord away from heated surfaces.
- Do not unplug by pulling on cord. To unplug, grasp the plug, not the cord.
- Do not handle plug or dust extractor with wet hands.
- Do not put any object into openings. Do not use with any opening blocked; keep free of dust, lint, hair, and anything that may reduce air flow.
- Keep hair, loose clothing, fingers, and all parts of body away from openings and moving parts.
- Turn off all controls before unplugging.
- Use extra care when cleaning on stairs.
- Do not use to pick up flammable or combustible liquids, such as gasoline, or use in areas where they may be present.
- Connect to a properly grounded outlet only. See Grounding instructions.
- Do not pick up anything that is burning or smoking, such as cigarettes, matches, or hot ashes, hot chips or particles, sparks.
- Do not use without dust bag and/or filters in place.

## **SAVE THESE INSTRUCTIONS**

## GROUNDING INSTRUCTIONS

This appliance must be grounded. If it should malfunction or breakdown, grounding provides a path of least resistance for electric current to reduce the risk of electric shock. This vacuum cleaner is equipped with a cord having an equipment-grounding conductor and grounding plug. The plug must be inserted into a appropriate outlet that is properly installed and grounded in accordance with all local codes and ordinances.

## WARNING

- Improper connection of the equipment grounding conductor can result in a risk of electric shock. Check with a qualified electrician or service person if you are in doubt as to whether the outlet is properly grounded. Do not modify the plug provided with the dust extractor - if it will not fit the outlet, have a proper outlet installed by a qualified electrician.

This appliance is for use on a nominal 120-V circuit and has a grounding attachment plug that looks like the plug illustrated in sketch A in Figure beside. Make sure that the appliance is connected to an outlet having the same configuration as the plug. No adaptor should be used with this appliance.

### GROUNDING METHODS - SKETCH A

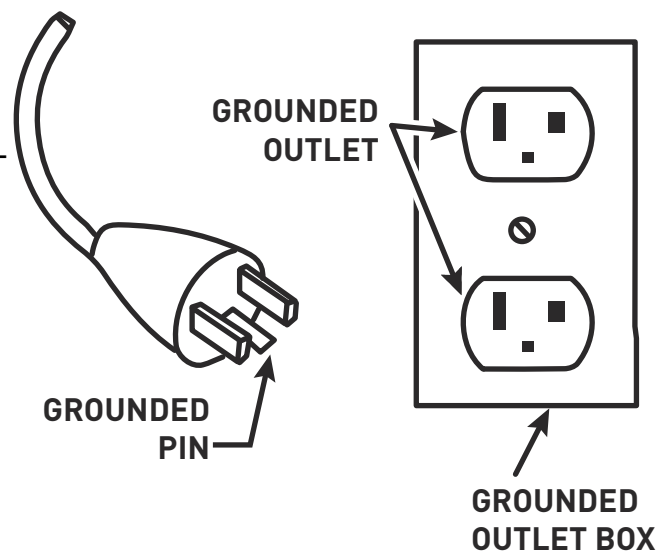

## Polarization Instructions

To reduce the risk of electric shock, this vacuum cleaner has a polarized plug (one blade is wider than the other). This plug will fit in a polarized outlet only one way. If the plug does not fit fully in the outlet, reverse the plug. If it still does not fit, contact a qualified electrician to install the proper outlet. Do not change the plug in any way.

### Health hazard by dust

## WARNING!

various dust created by power sanding, sawing, grinding, drilling and other construction activities contains chemicals known (to the State of California) to cause cancer, birth defects or other reproductive harm. Some examples of these chemicals are:

- lead from lead-based paints,
- crystalline silica from bricks and cement and other masonry products,
- and

- arsenic and chromium from chemically treated lumber.

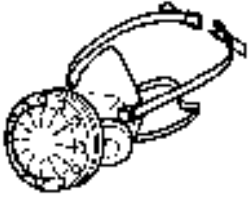

The risk from these exposures varies, depending on how often you do this type of work. To reduce your exposure to these chemicals: work in a well ventilated area, and work with approved safety equipment, such as dust masks that are specially designed to filter out microscopic particles. Wash hands after handling.



### WARNING

**TO REDUCE THE RISK OF INJURY, USER MUST READ INSTRUCTION MANUAL.**

### Further safety instructions

- This machine is not intended for use by persons (including children) with reduced physical, sensory or mental capabilities, or lack of experience and knowledge. **Children** should be supervised to ensure that they do not play with the appliance.

- **WARNING** Operators shall be adequately instructed on the use of these machines.
- Always operate with the filter system installed!
- The mains plug must always be disconnected from the socket before performing cleaning or maintenance tasks, when replacing consumables or when converting the machine.
- This machine must not be used by people who might have a particularly adverse reaction to an electric shock (e.g. **people with cardiac pacemakers**), because the possibility of the machine building up a static charge cannot be excluded.
- **Ensure you are on a firm base.** The effects of a shock moment, e.g. due to antistatic discharge, may lead to accidents.
- This machine must only be operated under constant supervision. To prevent potential hazards, never let it run unsupervised.
- If intact following a visual inspection, work in a dry environment according to instructions!

- **WARNING** Only use the socket outlet on the machine for purposes specified in the instructions.
- Check the plug, the electrical outlet module, the cable and the filter regularly in order to prevent a hazard. Damaged electrical components must be replaced by an authorised service workshop only.

- **CAUTION** Clean the water level limiting device regularly and examine it for signs of damage.
- **WARNING** If foam or liquid escapes from the machine, switch off immediately.
- Only carry the machine using the handle provided.
- Do not lift or transport using a crane hook or lifting gear.
- Use only the original Festool suction hose.
- **Pay attention to the work environment and watch out for your own safety and the safety of others when transporting or working with the machine.**

In this way, you can for example prevent tripping hazards caused by the suction hose or mains cable.

- **Keep packaging film away from children.**

There is a risk of suffocation.

- **CAUTION** This machine is for indoor use only. This machine shall be stored indoors only.

-  **WARNING!**

Do not extract embers or other ignition sources. Do not use in conjunction with machines that generate sparks!

Per NFPA 484, do not collect incompatible materials that may react with the metal particles and do not use the dust extractor to collect materials it was not designed to collect. Doing so can result in the contents of the dust extractor catching fire.

## 4 Parts of the machine

- [1-1]** Intake opening
- [1-2]** Electrical outlet module
- [1-3]** Hose holder
- [1-4]** Handle
- [1-5]** SYS dock
- [1-6]** Connection indicator
- [1-7]** Connection button
- [1-8]** AC indicator  
(variants with AUTOCLEAN only)
- [1-9]** AC button  
(variants with AUTOCLEAN only)

- [1-10]** Suction power adjustment status indicator
- [1-11]** Buttons for suction power adjustment
- [1-12]** MAN button
- [1-13]** Switch
- [1-14]** Locking clip
- [1-15]** Dirt trap
- [1-16]** Brake

The specified illustrations appear at the beginning of the operating manual.

Accessories shown or described are not always included in the scope of delivery.

## 5 Technical data

Mobile dust extractors		CT 26-48 EI CT 26-48 EI AC
Power consumption		2.9 - 8.3 A (350 – 1000 W)
Max. rating of connected Power Tool		3.7 A
Max. suction capacity (air), extractor/turbine		130 m³/h (4591 cu.ft./h) / 234 m³/h (8264 cu.ft./h)
Max. vacuum, turbine		240 hPa
Suction hose (depending on mobile dust extractor version)		D27/32x3.5m-AS/CTR D36x3.5-AS/KS/B/LHS 225 D36/32x3.5m-AS/R
Mains power cable length		7,5 m (24.6 ft.)
Sound pressure level as per EN 60704-2-1/uncertainty K		71 dB(A)/ 3 dB
Protection class		IP X4
Frequency		2402 Mhz – 2480 Mhz
Equivalent isotropically radiated power (EIRP)		< 10 dBm
Container capacity	CT 26	26 l (6.7 gal.)
	CT 36	36 l (9.5 gal.)
	CT 48	48 l (12.7 gal.)
Dimensions L x W x H	CT 26	630 x 365 x 540 mm (24.8 in. x 14.4 in. x 21.3 in.)
	CT 36	630 x 365 x 596 mm (24.8 in. x 14.4 in. x 23.4 in.)
	CT 48	630 x 406 x 686 (24.8 in. x 15.0 in. x 27.0 in.)
Weight	CT 26/CT 26 AC	13,0 kg (28.7 lbs) / 14,8 kg (32.6 lbs)
	CT 36/CT 36 AC	13,5 kg (29.8 lbs) / 15,3 kg (33.7 lbs)
	CT 48/CT 48 AC	19,1 kg (42.1 lbs) / 19.9 kg (43.9 lbs)

## 6 Intended use

The dust extractor is designed for use as specified for the aspiration and evacuation of non-noxious dusts, dirt, sand, shavings etc..

The dust extractor is designed as specified for vacuuming water.

The dust extractor is designed for commercial use.

The mobile dust extractor is only suitable for indoor use.

### CT 26 EI

### CT 36 EI

This extractor has been tested in accordance with EPA RRP. The HEPA Filter is tested and certified in accordance with IEST RP-CC-001, to filter and exhaust air particles to 0.3 microns with at least 99.97 % efficiency with no bypass leakage.

**CT 36 EI AC****CT 48 EI AC**

This extractor has been tested in accordance with OSHA 1926.1153. The HEPA Filter is tested and certified in accordance with IEST RPCC-001, to filter and exhaust air particles to 0.3 microns with at least 99.97 % efficiency with no bypass leakage.

**WARNING**

**The user will be liable for damage due to improper use.**

## 7 Commissioning

**WARNING**

**Unauthorised voltage or frequency!**

**Risk of accidents**

- Observe the specifications on the machine's name plate.
- Observe country-specific regulations.

### 7.1 Initial commissioning

- Insert the filter/disposal bag [2].
- Fit the cord holder [3].
- Connect the suction hose [4].

### 7.2 Connecting a mobile dust extractor

**WARNING**

**Risk of injury from tools starting up unexpectedly**

- Before switching on, ensure that the connected tool is switched off.

**WARNING**

**Risk of injury from electric current**

- Insert the mains plug into an earthed socket.
- Do not reach into the electrical outlet module on the mobile dust extractor.

- ① While the mobile dust extractor is connected to the mains socket, an electric current is running through the electrical outlet module on the mobile dust extractor at all times.

### Connecting the mobile dust extractor to a mains socket

The mobile dust extractor is switched off.

- Connect the power cable to a mains socket. The electrical outlet module [1-2] is live.

### Switching the mobile dust extractor to standby mode

- Press the on/off switch [1-13]. The electrical outlet module [1-2] is live.

- ① The green LED [1-10] indicates standby mode.

### Starting the mobile dust extractor automatically

The mobile dust extractor is in standby mode.

- To start the mobile dust extractor automatically: Switch on the connected tool.

### Starting the mobile dust extractor manually

The mobile dust extractor is in standby mode.

- Press the MAN button [1-12].



Pull the mains plug from the socket when you are not using the mobile dust extractor and before performing any cleaning and maintenance work.

### 7.3 Extension Cord

If an extension cord is required, it must have sufficient cross-section to prevent an excessive drop in voltage or overheating. An excessive drop in voltage reduces the output and can lead to failure of the motor. The table below shows you the correct cord diameter as a function of the cord length for this tool.

Total Extension Cord Length (feet)	25	50	100	150
Cable size (AWG)	14	12	not recommended	

Use only U.L. and CSA listed extension cords. Never use two extension cords together. Instead, use one long one.

- ① The lower the AWG number, the stronger the cord.

## 8 Connecting a device



### WARNING

#### Risk of injury from the mobile dust extractor starting up unexpectedly

- ▶ Before performing any work with the mobile dust extractor, check which remote control and which power tool are connected to the mobile dust extractor.
- ▶ The remote control must only be attached to the suction hose.
- ▶ A battery-powered power tool must always be connected to the mobile dust extractor via the suction hose. After finishing work, the connection to the mobile dust extractor must be disconnected.

### 8.1 Connecting a power tool



### WARNING

#### Risk of injury

- ▶ Observe the maximum electrical outlet module connected load (see "Technical data" section).
- ▶ Switch off the power tool.

#### Connecting a mains-powered power tool to the mobile dust extractor

- ▶ Connect the power tool to the electrical outlet module **[1-2]**.

*The power tool is connected to the mobile dust extractor via the power cable.*

#### Connecting a battery-powered power tool to the mobile dust extractor

- ▶ In standby mode, press the connection button **[1-7]**.  
The connection display **[1-6]** flashes slowly. For a period of 60 seconds, the mobile dust extractor is ready for connection.
- ▶ Turn on the battery-powered power tool.  
The mobile dust extractor starts up and the battery-powered power tool is connected until the mobile dust extractor is manually switched off or the mains plug is disconnected. The cordless tool must then be connected again.

Connecting a new battery-powered power tool overwrites the previous connection.

## 8.2 Connecting the CT-F I remote control

### Connecting the remote control and the mobile dust extractor

To be able to connect a remote control to a mobile dust extractor, the remote control must be reset (see "Resetting the remote control"). A remote control that has not been connected previously can be connected directly.

- ① A connection that has been created between remote controls and the mobile dust extractor will persist even after the mobile dust extractor has been manually switched off or the mains plug has been disconnected.
- ▶ Hold down the connection button **[1-7]** on the mobile dust extractor for three seconds in standby mode.  
The connection display **[1-6]** flashes rapidly.  
For a period of 60 seconds, the mobile dust extractor is ready for connection.
- ▶ Press the MAN button on the remote control.  
The remote control is permanently stored in the mobile dust extractor.

### Switching on/off

Once the remote control is connected to the mobile dust extractor, the mobile dust extractor can be switched on and off with the remote control.

- ▶ Press the MAN button on the remote control to switch the device on and off.

### Resetting on the remote control

Resetting deletes the connection between a remote control and the mobile dust extractor.

- ▶ Hold down the connection button and the MAN button for ten seconds.  
The LED indicator lights up purple if the reset has taken place.

## 8.3 Festool Work app\*

The mobile dust extractor can be configured with the Festool Work app.

- ▶ Hold down the connection button **[1-7]** on the mobile dust extractor for three seconds in standby mode.  
The connection display **[1-6]** flashes rapidly.  
For a period of 60 seconds, the mobile dust extractor is ready for connection.
- ▶ Follow the instructions provided in the Festool Work app.

\* Not available in all countries.

## 8.4 Deleting all saved devices

- Press and hold the connection button **[1-7]** for at least three seconds.  
The connection display **[1-6]** flashes rapidly.
- Release the connection button again.
- Within three seconds, press and hold the plus and minus button **[1-11]** simultaneously for at least three seconds.

The mobile dust extractor confirms the command by rapidly flashing three times.

## 9 Settings

### 9.1 Adjusting the suction power

- Press the plus or minus button **[1-11]** while extracting.

### 9.2 Connecting sleeve

The bypass function of the connecting sleeve prevents strong suction from sanding machines and floor nozzles on smooth surfaces.

#### Open

- Turn the adjusting ring to the "OPEN" position.

#### Close

- Turn the adjusting ring to the "CLOSE" position.

### 9.3 Applying the brake

Folding out the black brake lever **[1-16]** prevents the mobile dust extractor from rolling. To achieve this, lift the front end of the mobile dust extractor slightly and push the black brake lever downwards until it latches into place. Push the green lever **[1-17]** to release.

### 9.4 Temperature cut-out

A temperature cut-out switches the mobile dust extractor off when it reaches a critical temperature to prevent overheating. The bottom LED indicates a fault.

LED lights up red	Excessive temperature
-------------------	-----------------------

- Switch off the mobile dust extractor, let it cool down.
- Switch on the mobile dust extractor again after approx. five minutes.

## 10 Working

### 10.1 Handling

**Hose holder:** After finishing work, you can feed the suction hose through the opening **[8-2]** and place it in the hose holder.

**SYS-Dock Systainer storage area:** A Systainer can be fastened to the storage area with the four slides or the T-Loc lock **[8-1]**.

### 10.2 AutoClean – cleaning the main filter (variants with AUTOCLEAN only)



**Only in conjunction with a disposable bag** (to comply with dust class "L"). Not for use during wet extraction.

#### Switching automatic cleaning on and off

- In standby mode, press the AC button **[1-9]** to switch AUTOCLEAN on or off.

❶ The AC function can be configured using the Festool Work app\*.

\* Not available in all countries.

#### Manual cleaning

- Press the AC button **[1-9]** while extracting.

#### Full manual cleaning

- While extracting, cover the end of the nozzle or suction hose with your hand or CT-VS closing slide for three seconds.
- Press and hold the AC button **[1-9]** for at least three seconds.

### 10.3 Special features of the CT 36 E AC- LHS

To use the mobile dust extractor in combination with the **PLANEX**:

- Use kink-resistant suction hose D 36 mm x 3.5 m-AS.
- Use a special suction sleeve for connecting the **PLANEX**.
- Use closing slide CT-VS between the intake opening **[1-1]** and suction hose.
- Attach the tool holder.
- **Always use with a disposal bag!**

#### Bypass function

In tasks that require a low extraction setting (e.g. on soft surfaces).

- Activate bypass function on special extraction sleeve **[1A]**.

## 10.4 Extracting dry materials



### CAUTION

#### Hazardous dust

#### Damage to the respiratory passage

- Always use a filter or disposal bag.



When extracting dust that exceeds the limit value, only extract from one dust source (power or compressed-air tool).

**Observe the following** when extracting dust generated by operating electric power tools: If the exhaust air is discharged back into the room, the **air renewal rate L** within the room must be sufficient. The volume of air discharged back into the room must not exceed 50% of the fresh air volume flow (room volume  $V_R \times$  air renewal rate  $L_W$ ). In addition, observe the national regulations.

**Observe the following:** A moist main filter clogs more quickly when extracting dry materials. Therefore, dry the main filter before extracting dust or replace the damp filter with a dry one.

## 10.5 Extracting wet materials/liquids



Remove the filter/disposal bag.

Use a special wet filter (NF-CT).

The dust extraction stops automatically when the maximum fill level is reached.

The bottom LED [1-10] flashes red.

It must be ensured that the machine (main filter, suction hose, container, etc.) is sufficiently dried after extracting wet materials.



### CAUTION

#### Hazardous dust

#### Damage to the respiratory passage

- After extracting wet materials, remove the wet filter and replace it with the main filter for dry materials.



### CAUTION

#### Escaping foam and liquids

- Switch off and empty the machine immediately.

## 10.6 After finishing work

- **Variants with AUTOCLEAN only:** Clean the main filter automatically or manually (see section 10.2)
- Switch off the mobile dust extractor and pull out the mains plug.

- Wind up the mains power cable.
- Empty the dirt trap.
- Place the mobile dust extractor in a dry room inaccessible to unauthorised users.



Only store this machine indoors.

## 11 Service and maintenance



### WARNING

#### Risk of injury, electric shock

- Always pull the mains plug from the socket before performing any servicing and maintenance work.
- All maintenance and repair work which requires the motor housing to be opened should always be carried out by an authorised service workshop.



**Customer service and repairs** must only be carried out by the manufacturer or service workshops. Find the nearest address at:

[www.festoolusa.com/service](http://www.festoolusa.com/service)



Always use original Festool spare parts. Order no. at: [www.festoolusa.com/service](http://www.festoolusa.com/service)

- Regularly clean the fill level sensors [5] and empty the dirt trap.

#### Observe the following information:

- Dust-related inspection (e.g. for filter damage, tightness of the machine and function of the control devices) by the manufacturer or an instructed person at least once a year.
- Dispose of components that cannot be cleaned. Use impermeable bags to do so. Observe the applicable disposal provisions.
- Provided maintenance personnel or other persons in the vicinity are not endangered, the user must dismantle and clean the machine prior to performing maintenance work. Appropriate precautionary measures include decontaminating the machine prior to disassembly, making provisions for locally filtered forced ventilation at the location of machine disassembly, cleaning the maintenance area and appropriate personal protective equipment.

### 11.1 Filter bag / disposal bag / main filter

- Remove the filter bag [6].
- Insert the filter bag [7].

- Remove the disposal bag **[8]**.
- Insert the disposal bag **[9]**.
- Change the main filter **[10]**.

Dispose of the used filter in accordance with statutory regulations.

- i** The order numbers for accessories, filters and consumables can be found in the Festool catalogue or on the internet at [www.festool.com](http://www.festool.com).

## 12 Accessories

The order numbers for the accessories and filters can be found in the Festool catalogue or on the Internet at "[www.festool.com](http://www.festool.com)".

### 12.1 Modules

The following modules for extending the mobile dust extractor are available in the range of accessories, and can be connected to the electrical outlet module **[1-2]**:

- SD I-CT26-48 (socket module)
- DL I-CT26-48 (compressed-air module)

For more information about the modules, visit "[www.festool.com](http://www.festool.com)".

## 13 Environment

**Do not dispose of the device as domestic waste!** Dispose of machines, accessories and packaging at an environmentally responsible recycling centre. Observe the respective national regulations.

## 14 General information

### 14.1 Bluetooth®

The Bluetooth® word mark and the logos are registered trademarks of Bluetooth SIG, Inc.; they are used by TTS Tooltechnic Systems AG & Co. KG, and therefore by Festool, under licence.

### 14.2 Information on data privacy

The power tool contains a chip which automatically stores machine and operating data. The data saved cannot be traced back directly to an individual.

The data can be read in a contactless manner using special devices and shall only be used by Festool for fault diagnosis, repair and warranty processing and for quality improvement or enhancement of the power tool. The data shall not be used in any other way without the express consent of the customer.