

# Introduction Manual



## Invisible Wireless Charger

Model: C30

Alignment assistant × 1  
(With positioning  
light indicator)

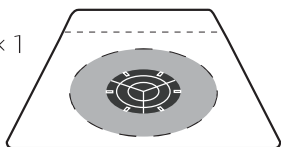

Power sticker × 1

Mount Bracket × 1

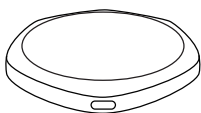

Wireless Charger × 1

Power cord × 1



### Warning

1. The KPON charger charges your phone when the distance between them is 13-30mm. A proper testing method is place your phone 13-30mm above the charger, NOT directly on the charger.
2. The Power Sticker is there to help you locate the charger and concentrate the energy that is needed to charge, when test, it is necessary to place it under your phone.
3. The different status of indicator light:
  - ① Green light always on - Power on, ready for charging.
  - ② Red light always on - Charging.
  - ③ Red light flashing - Foreign object detected or the adapter isn't QC3.0 certified that comes with the package.

### Product Introduction

C30 is a long-distance wireless charging device that can wirelessly charge mobile phones through surface of 13~30mm (0.51' - 1.18'). It works for non-metallic surface such as marble, wood, glass, quartz, etc., and can be placed under the desktop. It can be used at home, offices, hotels and many more. It can wirelessly charge mobile phones or other electronic devices that support the Qi standard. Enjoy the minimalist spark brought by technology.

### Before Installation Insurance

1. Please make sure you are using the QC 3.0 adapter that comes with the package.
2. Please check if your phone case doesn't contain metal, centrally located magnets, card holders, pop sockets and kick stands. If it does, charge your phone with the phone case off.

02

### Installation Steps

Please ensure the table surface is not made of metal, and thinner than 30mm.

1

#### mount the bracket

Rip off the protective layer of 3M tape, and mount the bracket in your favourite position under your desk.

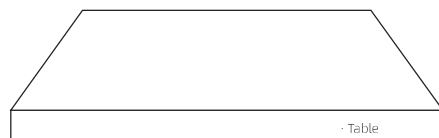

(Step 1)

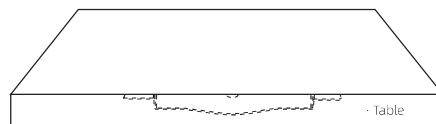

(Step 2)

2

#### Put the charger

Put the charger(transmitter) into the bracket, plug in and check if the green light is always on.

3

#### Fold the alignment assistant

Fold the "alignment assistant" up along the indentation line, and tear off the double-sided tape (notice: do not stick this part to the table at this time yet).

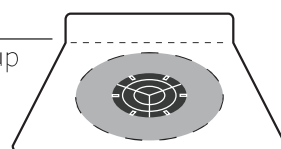

(Step 3)

## 4

### Locate the charging position

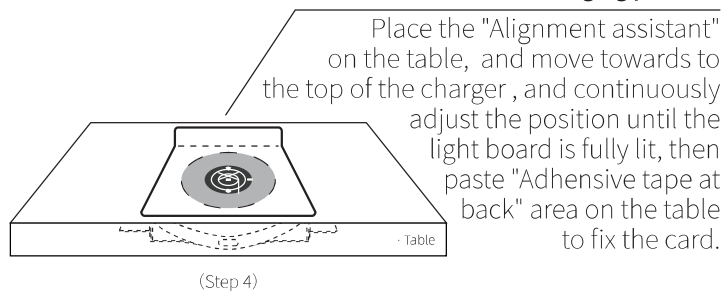

## 5

### Stick the power sticker

Tear off the circular installation prompt area in the center of the cardboard along the dotted line, and stick the power sticker on the blank area.

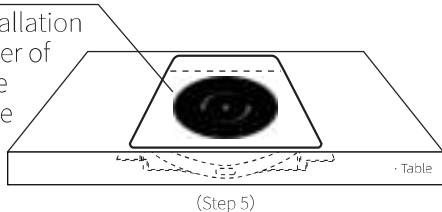

## 6

### Easy charging begins

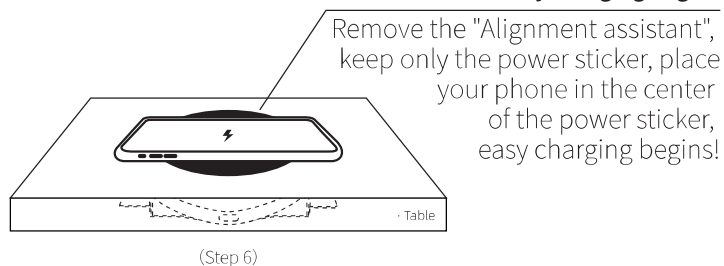

05

2. Doesn't charge fast enough and too sensitive.

For wireless charger, it is normal that the charging speed is slower than cable charger. We are experimenting new method and technology to create fast charging long distance wireless charger, you can follow us on [www.kpontech.com](http://www.kpontech.com) to learn more about the latest news.

3. Can't charge my phone even when I directly place my phone on the charger.

C30 is a long distance wireless charger that charged your phone between the distance of 13mm - 30mm, for accurate result, we suggest place a book between the charger and your phone, of course, the power sticker is necessary as well.

4. What should I do if I'm not satisfied with the product?

We are sorry to hear that you aren't satisfied with our product, We offer free exchange or refund service to all of our customers, and your feedback will give us great insight on how to improve our service and product.

5. The red light keeps flashing, and can't charge my phone.

Red light flashes is the result of foreign body indicator or low voltage warning. Remove the phone case which contain metal.

### Product After-sales Guide

Thanks for purchasing our C30 long range wireless charger, we are keen to provide you the best service we can, if you need assistance with exchange or refund service, please read the warranty instruction below.

07

### Specifications

Input: 12V1.5A

Charging distance: 13-30mm(0.51' - 1.18')

Output: 10W(MAX)

Size:  $\phi 110 \times 10\text{mm}$

**Note:** Please installed on non-metallic materials such as marble, wood, glass, etc., and the thickness is within 13-30mm.

### Safety Tips

1. Do not pull the power cord violently to avoid breaking the power cord.
2. Do not disassemble the C30 by yourself or throw it into fire or water.
3. Do not use C30 in severe high temperature, humid or corrosive environment to avoid leakage of electricity due to damage to the circuit.

### Precautions

1. Please use a power adapter that supports QC3.0 and above, QC3.0 adapter is necessary for C30.
2. Do not place metal debris between the wireless charger and the phone, which may cause damage to the charger or the charger will not work.
3. During use, if you feel like the phone is overheated, you can remove your phone and try again after it is cooled down.

### FAQs

1. The wireless charger doesn't work.

There are few common reasons for the product fail to function.

- (1). When the adapter you use isn't the one from the package. (QC 3.0 adapter)
- (2). When there is metal material on your phone case.
- (3). When the product is broken ( For this case, please contact kpon amazon team for a free exchange or refund).

06

### Warranty Scope

When the listed conditions are fulfilled, we provide free exchange service and refund service with no additional cost.

1. Product malfunction during normal use.
2. The product is still under the 1 year warranty.

The following conditions aren't covered by the 1 year warranty:

1. Use third party adapter that isn't QC 3.0 certified.
2. The product is damaged intentionally, such as disassembling the product without professional guidance.
3. Product damage that are caused by man-made accident.

### Extended Service

If the product exceeds the warranty period, the customer still enjoys maintenance service, but the maintenance cost is required.

### FCC Warning

This device complies with part 15 of the FCC Rules. Operation is subject to the following two conditions: (1) This device may not cause harmful interference, and (2) this device must accept any interference received, including interference that may cause undesired operation.

Any Changes or modifications not expressly approved by the party responsible for compliance could void the user's authority to operate the equipment. This equipment has been tested and found to comply with the limits for a Class B digital device, pursuant to part 15 of the FCC Rules. These limits are designed to provide reasonable protection against harmful interference in a residential installation. This equipment generates uses and can radiate radio frequency energy and, if not installed and used in accordance with the instructions, may cause

08

harmful interference to radio communications. However, there is no guarantee that interference will not occur in a particular installation. If this equipment does cause harmful interference to radio or television reception, which can be determined by turning the equipment off and on, the user is encouraged to try to correct the interference by one or more of the following measures:

- Reorient or relocate the receiving antenna.
- Increase the separation between the equipment and receiver.
- Connect the equipment into an outlet on a circuit different from that to which the receiver is connected.
- Consult the dealer or an experienced radio/TV technician for help.

The device has been evaluated to meet general RF exposure requirement.

FCC RF exposure statement

The equipment complies with FCC radiation exposure limits set forth for an uncontrolled environment. This equipment should be installed and operated with minimum distance between 20cm the radiator your body.

Contact us at  
www.kpontech.com  
✉ service@kpontech.com

安装步骤

安装前注意事项：  
请确保桌面是非金属材质，且厚度不超过 30mm。

1 安装支架

确认充电位置后，  
撕下 3M 胶，  
将支架安装在桌子背面；

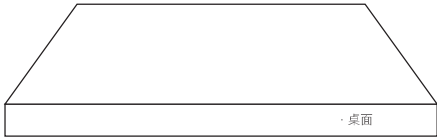

(安装步骤图一)

2 放入产品

将充电器放入支架，  
接通电源，  
确保绿灯常亮；

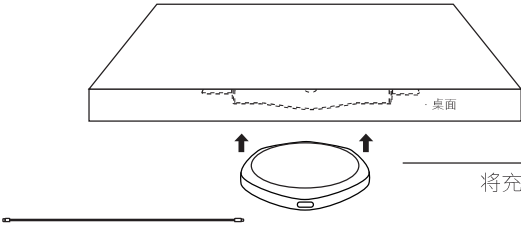

(安装步骤图二)

3 折起“辅助粘贴区”

将“辅助粘贴区”  
沿压痕线向上折起，  
并撕下双面胶  
(注：此时不要将该  
部分粘在桌上)；

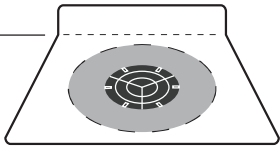

(安装步骤图三)

注意事项

1. 充电器的有效充电距离是 13-30mm. 测试的时候请不要将手机直接放置在充电器上，这样会触发充电器的异物检测功能(红灯闪烁,无法充电)。

2. 充电时需要使用功能桌贴。在测试环节请将厚度在 13-30mm 的书或者盒子置于桌贴和充电器之间，(以保证正常充电使用)。

3. 指示灯常见工作状态：  
红灯常亮 - 已通电，待机状态。  
绿灯常亮 - 正在充电。  
红灯闪烁 - 异物检测，输入电压不足或者其他故障。

产品介绍

C30 是一款隔空无线充电设备，可间隔 13~30mm 距离给手机进行无线充电，适用于大理石、木板、玻璃等非金属材质桌面，可放置于桌面上或安装于桌面底部，可在家庭、办公室、酒店等更多场所应用。可对支持 Qi 标准的手机或其他电子设备进行无线充电，充电稳定，放上即冲。不一样的充电方式，让您享受无限科技带来的精彩生活。

定位卡纸 \*3

(含定位灯板 \*1)

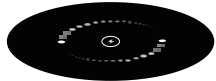
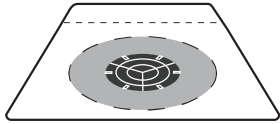

导磁桌贴 \*1

固定支架 \*1

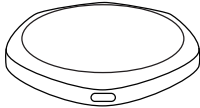

无线充电器 \*1

数据线 (type-c) \*1



4 找准充电位置

将定位卡纸放在桌上，  
缓慢移动至充电器上方，  
不断调整位置至灯板全亮后，  
将“辅助粘贴区”  
贴在桌上，  
固定卡纸；

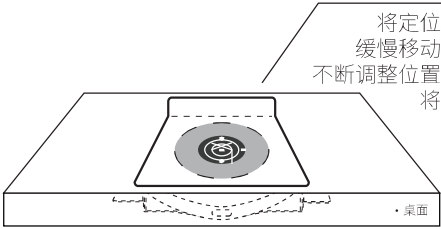

(安装步骤图四)

5

贴上桌贴

将卡纸中心圆形安装提示区  
沿着虚线撕下，  
并将桌贴贴在该  
空白区域；

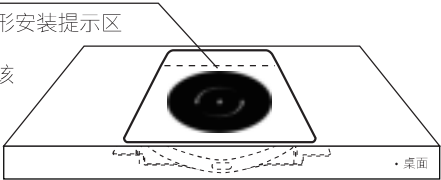

(安装步骤图五)

6

放上手机充电

去除定位辅助卡纸，  
只保留桌贴，  
将手机放置于桌贴中心，  
开始充电；

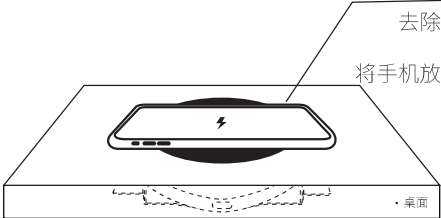

(安装步骤图六)

规格参数

输入：12V 1.5A	充电距离：13-30mm
输出：10W (MAX)	尺寸：φ112*12mm

注：请选择安装在大理石、木板、玻璃等非金属材质，厚度在 30mm 内的桌面

安全须知

- 1. 请勿强硬拉扯电源线，避免电源线断裂或脱落。
- 2. 请勿将 C30 自行拆卸或投入火中、水中，避免造成短路漏电。
- 3. 请勿将 C30 在高温、潮湿或腐蚀性环境下使用，避免损坏电路出现漏电现象。

注意事项

- 1. 请使用支持 QC3.0 及以上协议的电源适配器，否则可能引起充电不稳定。
- 2. 请勿在无线充桌贴上放置金属杂物或磁卡，可能会引起损坏或充电器不工作。
- 3. 请使用过程中如果遇到接收线圈或发射版过热停止充电，请移开充电设备，待冷却后重试。

常见问题解答

- 1. 无线充电比较慢。  
手机本身或者外置接收线圈允许无线充电电流大小不一样，或者手机充电时应用程序运行耗电大，建议减少或关闭应用程序。
- 2. 充电发热。  
无线充电过程中接收线圈或发射版出现发热为正常现象，建议调整充电位置。
- 3. 手机无线充电不工作。  
如果指示灯亮绿灯，请挪动手机位置至导磁桌贴中心。  
如果指示灯不亮，请检查插头是否正确连接并充电。  
如果指示灯闪烁，请确认使用的充电头为 QC3.0 及以上充电头。
- 4. 主机安装正确，手机放置位置正确，指示灯不亮或闪红灯，手机不充电。  
主机故障，联系售后维修。

产品售后指南

感谢您购买我公司 C30 隔空无线充，为了确保您得到可靠的售后服务，请认真阅读以下保修说明。

保修范围

产品在正常使用过程中出现不能正常工作或正常使用时出现故障，并经过我公司认定后可享受我公司的售后服务承诺。

以下情况不在保修范围之内：

- 1. 配件不保修；
- 2. 因用户操作不当导致故障的；
- 3. 因意外灾害、人为损坏、自行拆卸、拆封标及非本公司授权维修中心维修等引起故障的；

注：因用户操作不当所导致的损坏移动设备、甚至带来危险，我公司一概不承担任何责任。

超期维修

产品超过保修期，客户仍享受维修服务，但需缴纳维修工本费、材料费等。

