

iZBT50 - QSG (English)
Size: 5.10 x 1.50 mm (folded 10.2 x 1.50 mm)
Material: **157g Art paper**
Color: 1C + 1C (black)

July 21, 2022

iHome

SWEEEDREAMS SOOTHER WITH CRY SENSOR



Model: iZBT50

QUESTIONS? visit www.ihome.com

OVERVIEW

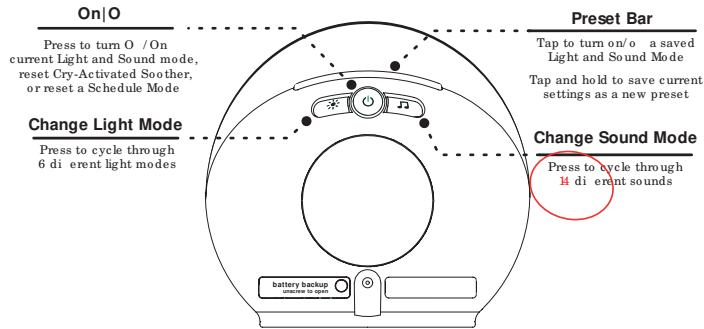

REMOTE CONTROL

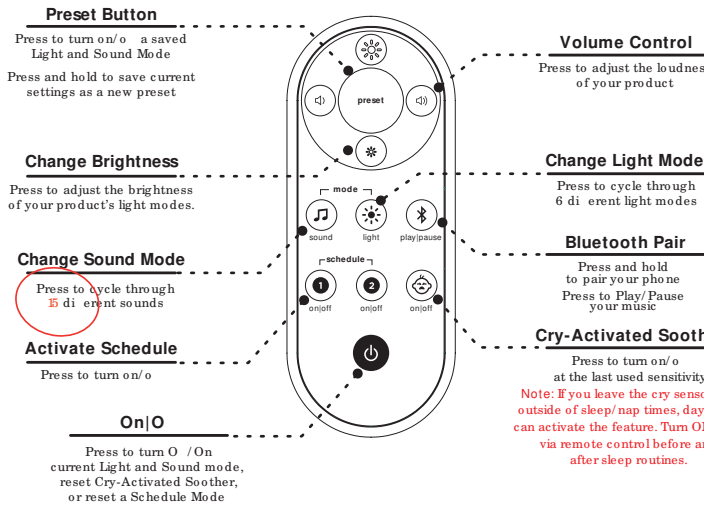

BOTTOM CONTROLS (FOR ADVANCED FEATURES)

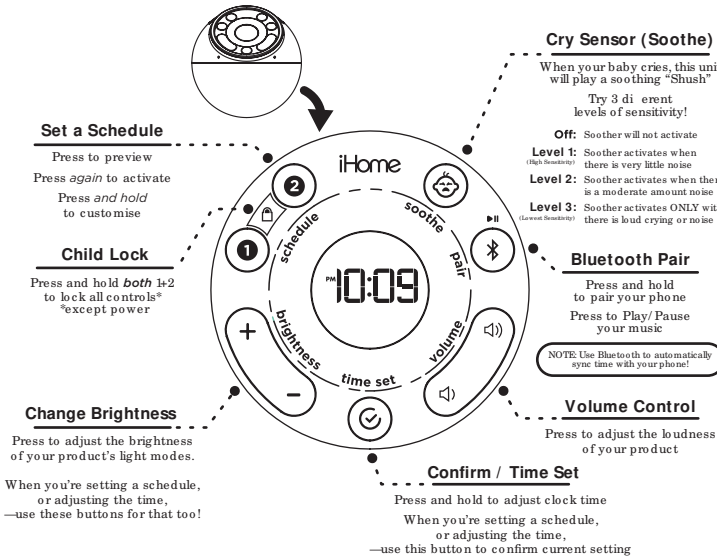

DISPLAY

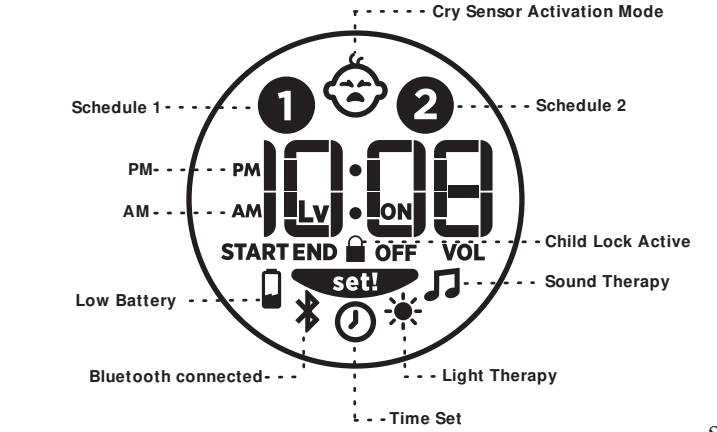

GETTING STARTED

1. Connecting the Unit

Connect the included AC adapter to the DC jack located on the back of the unit and connect the other end to a working wall outlet not controlled by a light switch. Remove the battery pull tab from the **back** of the unit.

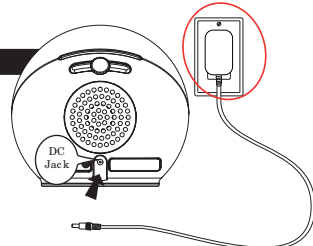

2. Connecting to Bluetooth

• Turn on your Bluetooth device and make it 'discoverable' by turning on Bluetooth mode.

• Press and hold the Bluetooth Pairing Button on the bottom of the iZBT50 unit, or on the remote control, until the Bluetooth Pairing Icon flashes to indicate the unit is in pairing mode.

• Select 'iHome iZBT50' on your device's Bluetooth menu to connect!

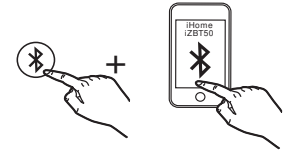

3. Setting Your Clock

Auto Time Sync (via Bluetooth)

Automatically sync the clock time of the unit to your iPhone or iOS device over Bluetooth. The time will sync when you first pair and re-link your device over time.

NOTE: Does not work with Android devices

Manually Setting the Time

- Press and hold the Time Set Button on the bottom of the unit until the display flashes and a beep sound. Release the Time Set Button.
- Press the - or + Buttons to select 12 or 24 hour display mode and press Time Set to confirm.
- Press the - or + Buttons to adjust the hour, and tap Time Set to confirm. (Make sure to set correct AM/PM time). The AM/PM indicators appear on the left side of the display.
- Press the - or + Buttons to adjust the minute, and tap Time Set to confirm.

LIGHT THERAPY

Press the Light Button repeatedly to cycle through light therapy modes:

Rest - Red Light mode for falling asleep
Glow - Rainbow spectrum slow fade
One Color - Pick your favorite color
Sun Light - Adjustable lamp for reading or sleep
Candle - Warm calming mood lighting effect
0

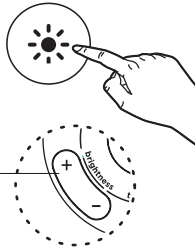

NOTE: Press & Hold to Turn OFF current Light Therapy Mode

SOUND THERAPY

Press the Sound Button repeatedly to cycle through sound therapy modes:

Sleep
Air Focus
Quiet Drive
Shush Meditation
Lullaby
Brahms Silent Night
Twinkle Morning Light
Nature
Ocean Storm
Nature River
OFF



NOTE: Press & Hold to Turn OFF current Sound Therapy Mode

CRY-SENSOR (SOOTHE MODE)

Activate the Cry-Sensor Mode to sense when your baby is crying and automatically play a soothing 'Shushing' voice to calm your baby and help training for improved sleep (both parents & baby).

Try 3 different levels of sensitivity!

Off: Soother will not activate
Level 1: Soother activates when there is very little noise
Level 2: Soother activates when there is a moderate amount of noise
Level 3: Soother activates ONLY with there is loud crying or noise
(Lowest Sensitivity)

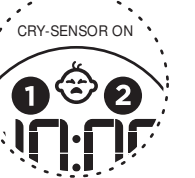

NOTE: Cry Activation mode cannot be armed while in Bluetooth mode. If Sounds Therapy is ON, the maximum volume will be limited to aid in sensing when your baby is crying.

HOW TO SAVE A PRESET

The unit allows you to store a preset to easily access your favorite light, sound, and sleep mode combinations using the remote control.

- When your preferred light, sound, and sleep modes are active, press and hold the Preset Button or tap the preset bar to activate your preset at any time.
- Tap the preset bar to turn on your preset at any time.

SETTING SCHEDULE 1 & 2

Customize up to two programs of light/sound with a start and end time. 1. Press and hold the 1 OR 2 for 2 seconds to begin. The hour digit will flash.

SET THE START TIME

- Press the - OR + to set the 'start' hour to the desired time. The AM/PM indicator appears to the left of the display. Press to confirm.
- Press the - OR + Buttons to adjust the minute of the 'start' minute to the desired time. Press to confirm.

SET THE END TIME

- Press the - OR + Buttons to schedule the 'end' hour to the desired time. Press to confirm.
- Press the - OR + Buttons to schedule the 'end' minute to the desired time. Press to confirm.

SET THE SOUND MODE

- Press the - OR + Buttons to select a preferred sound (1-15 tones). Press to confirm.
- Press the - OR + Buttons to adjust the volume (1-15). Press to confirm.

SET THE LIGHT MODE

- Press the - OR + Buttons to select 1 of 5 different light modes. Press to confirm.
- Press the - OR + Buttons to select brightness level (1-20). Press to confirm.

DONE!

- When set, Schedule 1/2 will display the respective 1 / 2 icons on the display and will activate between the respective Start/End times.
- Press 1 OR 2 to suspend active schedule and reset for next day.

USING THE CHILD LOCK

When the child-lock feature is active, only Power ON/OFF will function on the unit.

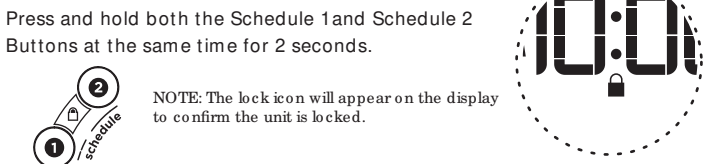

REMOTE CONTROL BATTERY

The remote control is powered by a CR2032 button cell battery. To replace the battery:

- Use a Phillips screwdriver to open the battery compartment door located on the back of the remote control.
- Insert a fresh CR-2032 battery, checking that the polarity matches the markings on the battery slot.
- Replace the compartment door. Do not overtighten the screw.

USING REMOTE CONTROL

This is an RF remote control that allows for simple control of the unit through walls or any direction without getting up or waking your baby (CR2032 battery included).

NOT WORKING? If the remote is not working, first try to replace the included battery. If it still isn't working, it likely needs to be re-paired to the unit (each remote is paired to your unit).

MANUALLY PAIRING THE REMOTE:

In standby mode, press and hold both the "+" and "volume +" bottom buttons on unit for 6 seconds, the LCD will show "PAIR". Press any remote control button within 1 minute as a pairing signal. After pairing successful, your remote control should be able to operate the unit.

BATTERY BACK-UP

The unit uses a CR-2450 back-up battery to provide continuous alarm operation and clock settings in the event of a temporary power failure. Remove the battery pull tab before use. When the low battery icon flashes on the clock display, it is time to replace the back-up battery. The battery compartment is located on the back of the unit.

- Make sure the AC adapter is connected, or you will lose your time and alarm settings during battery replacement.
- Use a Phillips screwdriver to open the battery compartment door.
- Insert a fresh CR-2450 battery, checking that the polarity match the markings on the unit. Replace the compartment door. Do not overtighten.

WARNING

- Do not ingest the battery, Chemical Burn Hazard. This product contains a coin/button cell battery. If the coin/button cell battery is swallowed, it can cause severe internal burns in just 2 hours and can lead to death.
- Keep new and used batteries away from children. If the battery compartment does not close securely, stop using the product and keep it away from children. If you think batteries might have been swallowed or placed inside any part of the body, seek immediate medical attention.
- CAUTION - RISK OF EXPLOSION IF BATTERY IS REPLACED BY AN INCORRECT TYPE. DISPOSE OF USED BATTERIES ACCORDING TO THE INSTRUCTIONS.

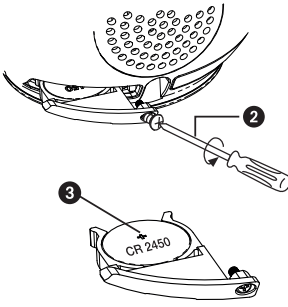

IMPORTANT SAFETY INSTRUCTIONS

Please heed all warnings, read and follow all instructions and keep these instructions handy for future reference.

- Do not use this product near water.
 - Unplug unit and clean only with damp cloth. Stronger cleaning agents, such as Benzene, thinner or similar materials can damage the surface of the unit.
 - Do not block any ventilation openings. Install in accordance with the manufacturer's instructions.
 - Heat - This product should be situated away from heat sources such as radiators, heat registers, stoves or other appliances (including amplifiers) that produce heat.
 - Only use attachments/ accessories specified by the manufacturer.
 - Unplug this product during lightning storms or when unused for long periods of time.
 - Damage Requiring Service - This product should be serviced by qualified service personnel when:
 - Plug has been damaged.
 - Objects have fallen into or liquid has been spilled into the enclosure.
 - The unit has been exposed to rain. The unit has been dropped or the enclosure damaged.
 - The unit exhibits a marked change in performance or does not operate normally.
 - No naked flame sources, such as lighted candles, should be placed on this product.
 - Attention should be drawn to the environmental aspects of battery disposal. Many electronics retailers now recycle batteries and other electronic components at no charge. To find a drop-off location near you, visit www.call2recycle.com.
 - This product is suitable for use in tropical and/or moderate climates.
 - Do not place product or remote within reach of baby or children.
- WARNING:
- To reduce the risk of fire or electric shock, do not expose this product to rain or moisture.
 - Do not dispose of batteries in the household trash or fire.
 - The mains plug of power adaptor is used as the disconnect device, it shall remain readily operable.

MAINTENANCE

- Place the unit on a level surface away from sources of direct sunlight or excessive heat.
- Protect your furniture when placing your unit on a natural wood and lacquered finish. A cloth or other protective material should be placed between it and the furniture.

FCC Information

This equipment complies with FCC RF radiation exposure limits set forth for an uncontrolled environment. This device complies with Part 15 of the FCC Rules, operation is subject to the following two conditions: (1) This device may not cause harmful interference, and (2) this device must accept any interference received, including interference that may cause undesired operation.

• Warning: Changes or modifications to this unit not expressly approved by the party responsible for compliance could void the user's authority to operate the equipment.
• NOTE: This equipment has been tested and found to comply with the limits for a Class B digital device, pursuant to Part 15 of the FCC Rules. These limits are designed to provide reasonable protection against harmful interference in a residential installation. This equipment generates, uses and can radiate radio frequency energy and, if not installed and used in accordance with the instructions, may cause harmful interference to radio communications. However, there is no guarantee that interference will not occur in a particular installation. If this equipment does cause harmful interference to radio or television reception, which can be determined by turning the equipment off and on, the user is encouraged to try to correct the interference by one or more of the following measures:

- Reorient or relocate the receiving antenna.
- Increase the separation between the equipment and receiver.
- Connect the equipment into an outlet on a circuit different from that to which the receiver is connected.
- Consult the dealer or an experienced radio/TV technician for help.

The main unit (not remote control) should be installed and operated with minimum distance 20cm (8in) between the radiator & your body.

ISED Information

This equipment complies with IC RSS-102 radiation exposure limits set forth for an uncontrolled environment. This device contains licence-exempt transmitter(s)/receiver(s) that comply with Innovation, Science and Economic Development Canada's licence-exempt RSS(s). Operation is subject to the following two conditions:

(1) This device may not cause interference.
(2) This device must accept any interference, including interference that may cause undesired operation of the device.
The device complies with ISED RF exposure requirement, users can obtain Canadian information on RF exposure and compliance. The main unit (not remote control) should be installed and operated with a minimum distance of 20 cm between the radiator and your body. Any Changes or modifications not expressly approved by the party responsible for compliance could void the user's authority to operate the equipment.
Cet équipement est conforme aux limites d'exposition aux radiations IC CNR-102 établies pour un environnement non contrôlé. L'émetteur/récepteur exempt de licence contenu dans le présent appareil est conforme aux CNR d'Innovation, Sciences et Développement économique Canada applicables aux appareils radio exempts de licence. L'exploitation est autorisée aux deux conditions suivantes:
(1) L'appareil ne doit pas produire de brouillage;
(2) L'appareil doit accepter tout brouillage radioélectrique subi, même si le brouillage est susceptible d'en compromettre le fonctionnement.
L'appareil est conforme aux exigences d'exposition RF ISED, les utilisateurs peuvent obtenir des informations canadiennes sur l'exposition aux RF et la conformité.
L'unité principale (pas de télécommande) doit être installée et utilisée avec une distance minimale de 20 cm entre le radiateur et votre corps. Tout changement ou modification non expressément approuvé par la partie responsable de la conformité peut annuler l'autorité de l'utilisateur à utiliser l'équipement.
CAN ICES-3(B) / NMB-3(B)

WARRANTY

For product support information and warranty please visit:
www.ihome.com/support

© 2022 SDI Technologies, Inc. All rights reserved.
Questions? Visit www.ihome.com

iZBT50 QSG-072 R2-A

Printed in China