



32-1258

170MHz Single Channel Wireless Microphone System

Thank you for purchasing your 170MHz Single Channel Wireless Microphone System from **RadioShack**. Your system will transmit microphone signals while you move freely up to 200 feet away from the receiver.



connecting the receiver

1. Set **POWER** to **OFF** and adjust the volume to minimum.
2. Connect the 9V AC adapter to the receiver's **DC 9V** jack. Plug the other end into a standard AC outlet.
3. Use a shielded audio cable (not included) to connect the **LINE** jack on your receiver to the **LINE/AUX** jack on your PA amplifier, tape deck, mixer or other input port.

CAUTION
RISK OF ELECTRIC SHOCK
DO NOT OPEN

WARNING: To reduce the risk of fire or shock hazard, do not expose this product to rain or moisture.

CAUTION: TO REDUCE THE RISK OF ELECTRIC SHOCK, DO NOT REMOVE THE COVER OR BACK. NO USER-SERVICEABLE PARTS INSIDE. REFER SERVICING TO QUALIFIED PERSONNEL.

The lightning symbol is intended to alert you to the presence of uninsulated, dangerous voltage within this product's enclosure that might be of sufficient magnitude to constitute a risk of electric shock. Do not open the product's case.

The exclamation symbol is intended to inform you that important operating and maintenance instructions are included in the literature accompanying this product.

NOTE If you are using your amplifier's **LINE/AUX IN**, connect the **MICROPHONE** jack on your receiver to the **MICROPHONE** jack on your amplifier with a 1/4" audio cable (not included). You can connect both output jacks to an amplifier and a tape recorder to record the microphone signals at the same time you are listening to the audio.

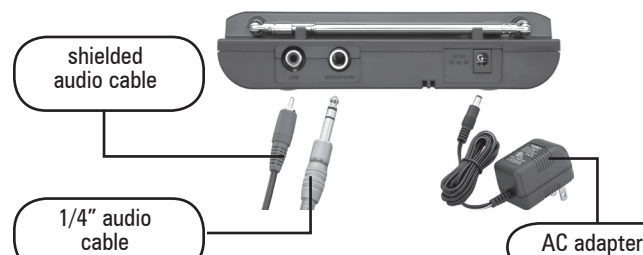

installing batteries for the microphone

1. Unscrew the microphone grille to loosen it and remove the battery cover.
2. Insert two AA batteries.
3. Replace the battery cover and screw the microphone grille when completed.



battery notes

- When the indicator on the microphone becomes dim, replace the batteries.
- Dispose of old batteries promptly and properly.
- Do not burn or bury batteries.
- Use only fresh batteries of the required size and recommended type.
- Do not mix batteries of different sizes or types.
- If you do not plan to use your microphone system for a month or more, remove the batteries. Batteries can leak chemicals that can damage electronic parts.

using the microphone system

1. Press **POWER** on the receiver to turn it on. The **POWER** indicator will light up.
2. Fully extend the receiver's antenna.
3. Turn on your PA amplifier, tape deck mixer or other audio system. Set their volume to moderate level.
4. Set the microphone's **OFF/MUTE/TALK** switch to **TALK**. The **READY** indicator will light up.

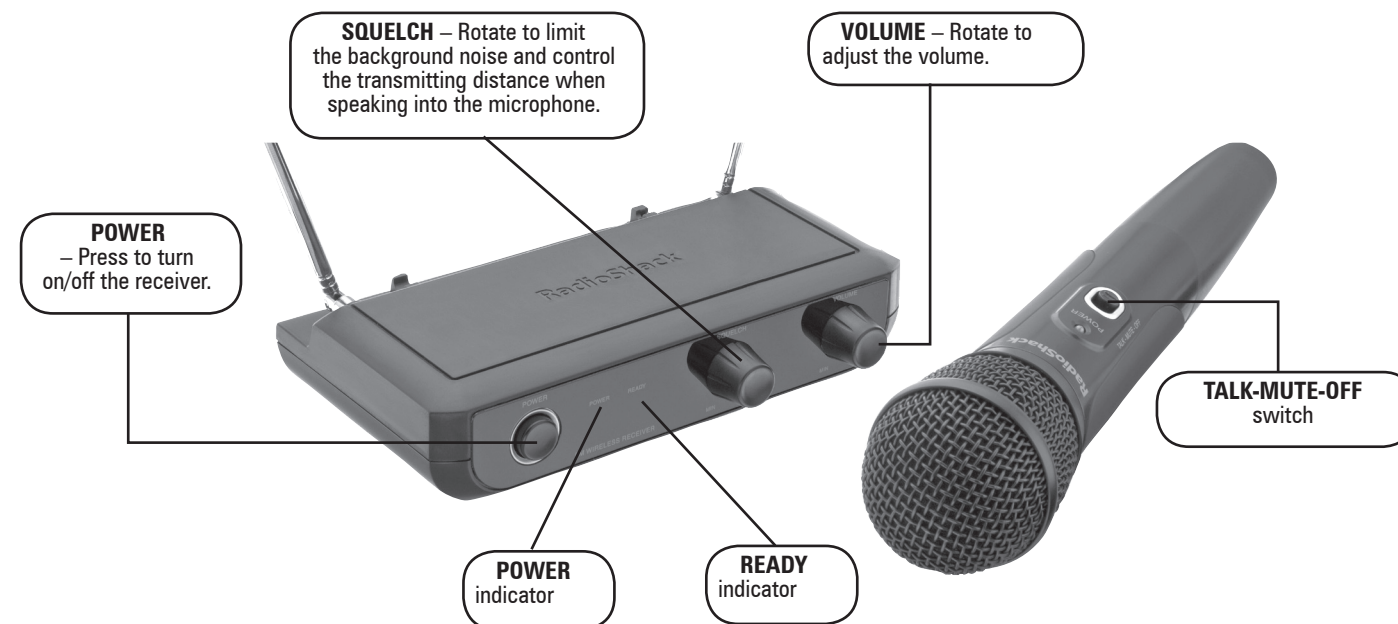

5. Speak at a normal level and adjust **VOLUME** on the receiver.
6. If you want to momentarily turn off the microphone, set the **OFF/MUTE/TALK** to **MUTE**. Use **MUTE** to avoid the popping noise that might occur if you turn **OFF/MUTE/TALK** to **OFF** and then back to **TALK**.
7. Rotate **SQUELCH** to control the transmitting distance. Turn to minimum to increase the transmitting distance.

NOTE When you finish using the system, be sure to turn the **OFF/MUTE/TALK** switch on the microphone to **OFF** mode to save battery power.

specifications

Frequency 169.505MHz, 170.245MHz or 171.905MHz
Transmitter:
RF Power 10dBm
Sensitivity 106 dB SPL at 7KHz FM
Operating Range 200 feet (Typical)
Power Source (microphone) Two AA Batteries

Receiver

Sensitivity with S/N 20dB 1uV
S/N ratio at 1mV RF input 75dB
Image Rejection 55dB
Line Output 510mV
Microphone Output 10mV
Frequency Response 120---13000Hz
Power Requirement AC-DC adapter 9V@250mA

NOTE: Specifications are typical; individual units may vary. Specifications are subject to change and improvement without notice.

the FCC wants you to know

Warning: Modifying, tampering with, or adjusting this unit, or replacing any transmitter component (crystal, semiconductor, etc.) may result in a violation of the FCC rules.

This equipment has been tested and found to comply with the limits for a Class B digital device, pursuant to Part 15 of the FCC Rules. These limits are designed to provide reasonable protection against harmful interference in a residential installation. This equipment generates, uses, and can radiate radio frequency energy and, if not installed and used in accordance with the instructions, may cause harmful interference to radio communications. However, there is no guarantee that interference will not occur in a particular installation. If this equipment does cause harmful interference to radio or television reception, which can be determined by turning the equipment off and on, the user is encouraged to try to correct the interference by one or more of the following measures:

- Reorient or relocate the receiving antenna.
- Increase the separation between the equipment and receiver.
- Connect the equipment into an outlet on a circuit different from that to which the receiver is connected.

Consult your local **RadioShack** store or an experienced radio/TV technician for help.

If you cannot eliminate the interference, the FCC requires that you stop using your microphone system. Changes or modifications not expressly approved by **RadioShack** may cause interference and void the user's authority to operate the equipment.

This device complies with Part 15 of the FCC Rules. Operation is subject to the condition that this device may not cause harmful interference.

This wireless microphone system complies with Part 90 of the FCC Rules. There are three frequencies available for the system. You must obtain a license for each frequency you plan to use before operating your system. One license can include both frequencies. Visit <http://wireless.fcc.gov/uls/>, or call your local FCC office to apply for your license. Your ability to obtain a license will depend on how you plan to use the system.

For RF exposure

"IMPORTANT NOTE: To comply with the FCC RF exposure compliance requirements, no change to the antenna or the device is permitted. Any change to the antenna or the device could result in the system exceeding the RF exposure requirements."

For devices less than 200mW ERP

SAFETY INFORMATION

Your wireless microphone contains a low power transmitter. When the EUT is powered on, it sends out radio frequency (RF) signals. In August 1996, the Federal Communications Commissions (FCC) adopted RF exposure guidelines with safety levels for wireless devices.

IMPORTANT

To maintain compliance with the FCC's RF exposure guidelines, hold the transmitter and antenna at least 1 inch (2.5 centimetres) from your face and speak in a normal voice, with the antenna pointed up and away from the face. Ensure that the antenna is at least 1 inch (2.5 centimetres) from your body when you are using your wireless microphone.

Use only the supplied antenna. Unauthorized antennas, modifications, or attachments could damage the transmitter and may violate FCC regulations.

what's included

microphone
9V AC adapter

receiver
user's guide

limited one-year warranty

This product is warranted by **RadioShack** against manufacturing defects in material and workmanship under normal use for one (1) year from the date of purchase from **RadioShack** company-owned stores and authorized **RadioShack** franchisees and dealers. For complete warranty details and exclusions, check with your local **RadioShack** store.

RadioShack Customer Relations
300 **RadioShack** Circle, Fort Worth, TX 76102

04/04