

INSIGNIA™

QUICK SETUP GUIDE

2.0-Channel 20 in. Soundbar

NS-HTSB20S

PACKAGE CONTENTS

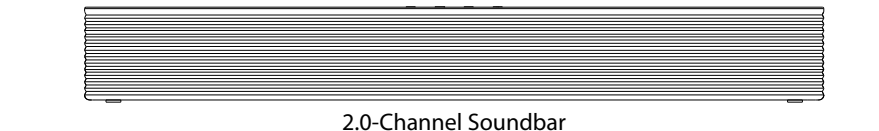

Mounting template



3.5 mm audio cable



Digital optical cable



Mounting hardware

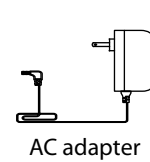

AC adapter



Remote control



AAA batteries (2)



Quick Setup Guide

Before using your new product, please read these instructions to prevent any damage.



Flat size (W × H): 40.81 × 8.27 in. (1036.57 × 210.06 mm)
Final folded size: 5.83 × 8.27 in. (148.082 × 210.06 mm)

FEATURES

- 2.0-channel soundbar delivers a superior listening experience
- Low-profile design is only 20.08 in. (51 cm) wide, allowing for placement in smaller areas
- Versatile hook-up options include digital optical, 3.5 mm AUX, USB and Bluetooth
- 30 total watts of RMS power supports louder, cleaner-sounding audio
- Bluetooth capability with memory pairing offers streaming functionality
- Three sound modes (Standard, Theater and News) provide a customized audio experience
- Included remote control grants you wireless control
- USB port offers playback for WAV or MP3 audio files
- Mounting capability provides space-saving options

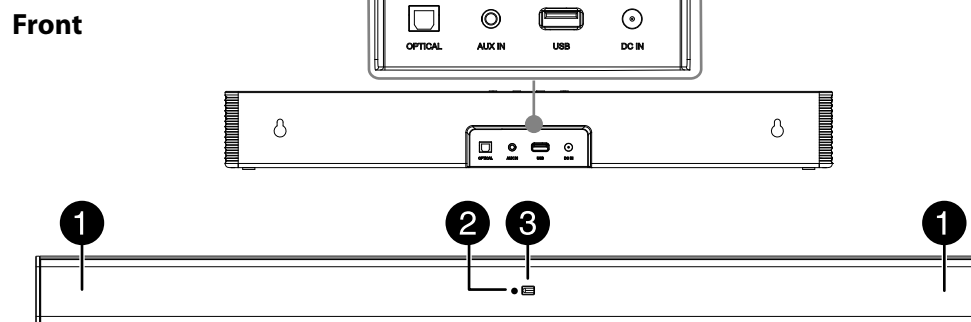
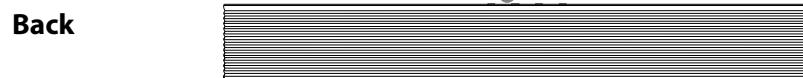
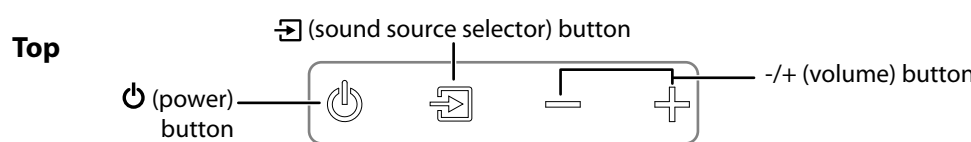

#	ITEM	DESCRIPTION
1	Speaker	Left and right speakers
2	Status indicator	Different color LEDs indicate the following: <ul style="list-style-type: none">Red - Standby modeBlue - Bluetooth mode (blinks while pairing)Orange - AUX modeGreen - Digital optical modePurple - USB modeTurquoise - Bass mode (blinking)Green/Blue/Red (blinking) - DSP (Digital Signal Processing) mode
3	Remote control sensor	Detects signals from the remote control. Do not block.

REMOTE CONTROL

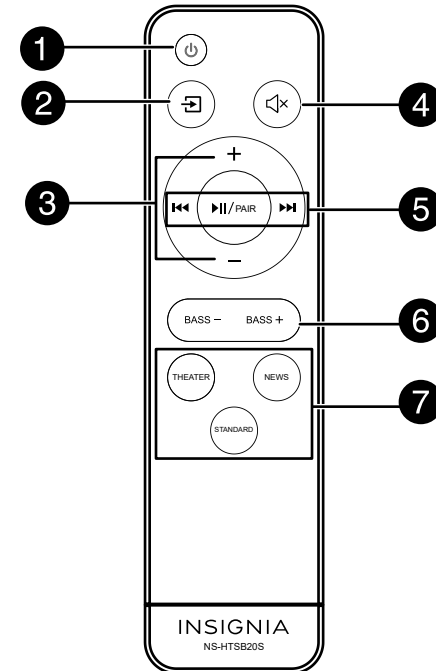

Remote control

#	ITEM	DESCRIPTION
1	(power) button	Press to turn on your soundbar.
2	(sound source selector) button	Press repeatedly to cycle through the available sound sources.
3	+/- (volume) buttons	Press to increase or decrease your soundbar's volume.
4	⏏ (mute) button	Press to mute the sound from your soundbar. Press again to restore the sound.
5	⏮ / ⏪ / PAIR / ⏩ / ⏭ (Bluetooth/USB) buttons	When a Bluetooth or USB source is selected, press to control playback with the following buttons: ⏮ (previous) / ⏪ (play/pause) / ⏩ (next) PAIR : press and hold for three seconds to disconnect Bluetooth.
6	BASS +/- button	Press to turn on the bass frequency enhancement, then use the BASS +/- buttons to adjust the bass volume level. The Status indicator on your soundbar blinks turquoise when activated. Note : This feature won't work in NEWS mode.
7	THEATER/STANDARD/NEWS (sound mode) buttons	Press to select the sound mode. The Status indicator on your soundbar blinks three times in sequence green > blue > red. STANDARD - general music or TV shows listening. THEATER - optimize movie sound for a theater setting. NEWS - optimize spoken voice or dialog for TV news and more.

CONNECTING YOUR SOUNDBAR

Look at the back of your sound source device, such as a TV, DVD/Blu-ray player, or cable box, to identify your audio OUT jacks or check the documentation that came with your sound source device to determine if it has Bluetooth capability.

Choose one of the connection options that fits your sound source. You can connect several devices and switch the sound source as required.

Note: Turn off all devices while you are making connections.

Digital optical connection

- Remove the caps from both ends of the optical cable.
- Connect one end of the included digital optical cable to the **OPTICAL** jack on your soundbar.
- Connect the other end into the Digital Optical Output jack on your source device.
- Change the device's audio output to the PCM format (typically found in audio settings). See the documentation that came with your sound source device for more information.
- Press the (sound source selector) button on your soundbar or on the remote control repeatedly until the source indicator turns green.

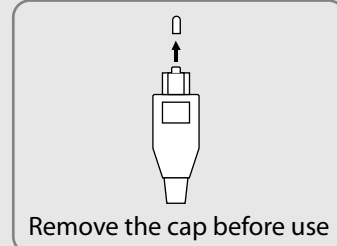

Remove the cap before use

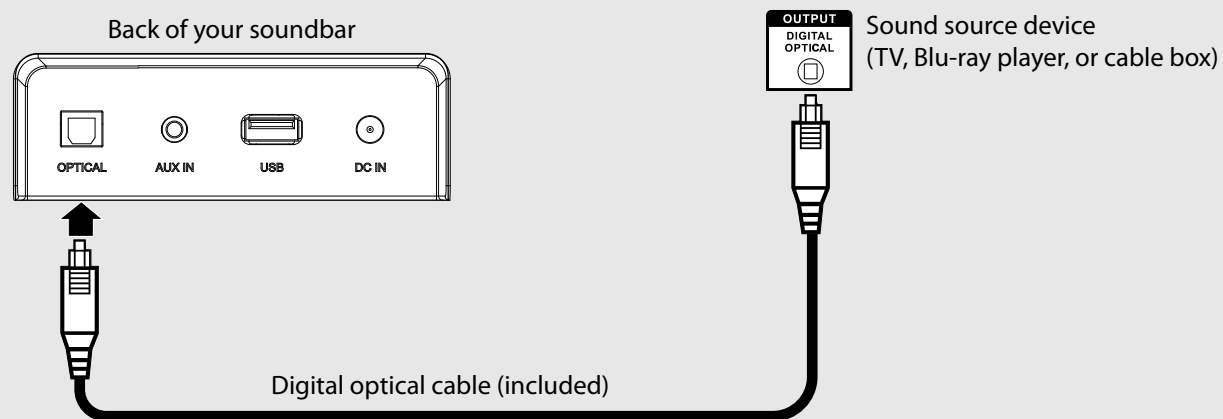

USB sound source connection

- Plug a USB thumbdrive (with MP3 or WAV files) into the USB port on the back of your soundbar.
 - Plug in your soundbar, then turn it on.
 - Press the (sound source selector) button on your soundbar or on the remote control repeatedly until the source indicator turns purple.
 - Control USB playback by pressing the ⏮ (previous) / ⏪ (play/pause) / **PAIR** / ⏩ (next) buttons on the remote control.
- Note:** If playback doesn't begin immediately, press the ⏪ (play/pause) / **PAIR** / buttons on the remote control.

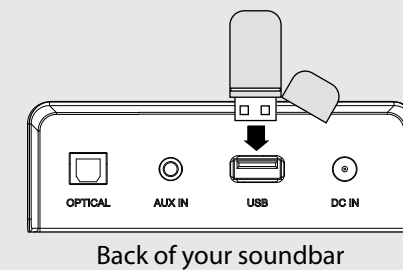

Back of your soundbar

3.5 mm AUX connection

- Connect one end of the included 3.5 mm audio cable into the **AUX IN** jack on your soundbar, then connect the other end of the AUX cable to the headphone or AUX Output jack on your sound source device.
- Press the (sound source selector) button on your soundbar or on the remote control repeatedly until the source indicator turns orange.

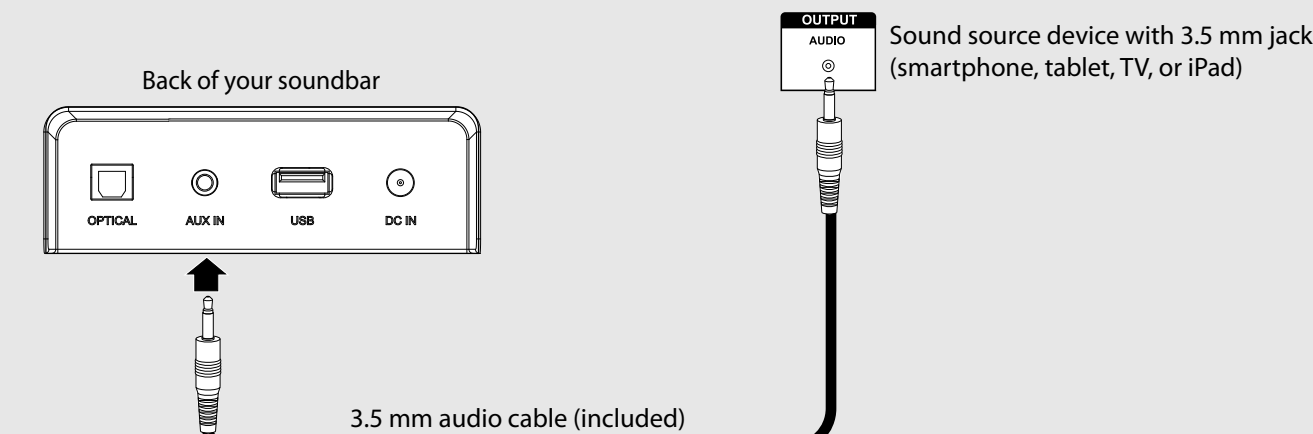

CONNECTING YOUR SOUNDBAR USING BLUETOOTH

Pairing your devices

- Turn on your soundbar.
- Place your Bluetooth device within 30 ft. (10 m) of your soundbar.
- Press the (sound source selector) button on your soundbar or on the remote control repeatedly until the source indicator blinks blue.
- Navigate to your device's Bluetooth settings, turn on Bluetooth, then search for available devices. See the documentation that came with your sound source device for more information on pairing.
- On your Bluetooth device, select **NS-HTSB20S** from the device list. Repeat steps 1-4 if **NS-HTSB20S** is not displayed.
- If a PIN code is requested, enter **0000**.
- When pairing is completed, the LED lights solid blue.

Notes:

- Some devices, such as an iPhone, connect immediately after pairing so the Bluetooth indicator on your soundbar remains on. Other devices, such as notebook computers, may ask you if you wish to connect. In this instance, the Bluetooth indicator continues to blink until a connection is established.
- When you turn on your soundbar, it automatically connects to the last connected device if that device is in range. To connect to a different paired device, turn off Bluetooth or unpair from the currently paired device and manually connect to the other paired device.
- When a call is received while playing music through a phone, the music stops automatically.
- When the call ends, depending on the setting of your phone, the current track may resume playback.

Disconnecting your devices

Turn off the Bluetooth function on your device.

Note: For more information about using Bluetooth, see the documentation that came with your Bluetooth devices.

CONNECTING THE AC POWER ADAPTER

IMPORTANT: Before you connect your soundbar to an audio source, you need to connect it to the provided power adapter.

CAUTION: Make sure that the electrical outlet matches the input requirements of 100-240V AC at 50/60Hz before connecting.

- Connect one end of the cable from the AC power adapter into the DC IN jack on your soundbar, then plug the AC power adapter into a power outlet or surge protector.

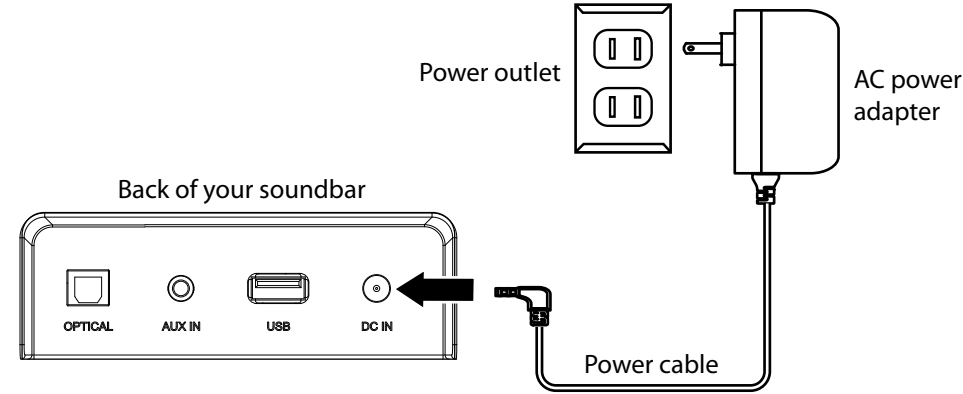

USING YOUR SOUNDBAR

Using the remote control

- Install two AAA batteries (included) into the battery compartment.
- Point the remote control directly at the remote control sensor on the front of your soundbar. You must be within approximately 50 ft. (15 m) of your soundbar.

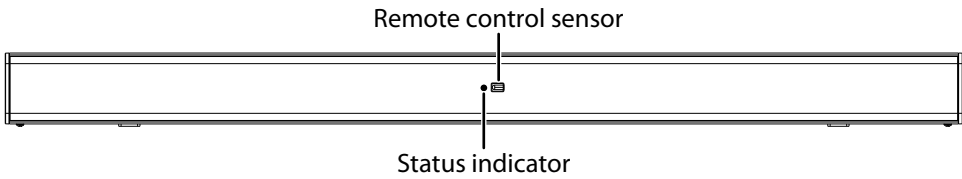

Listening to your soundbar

- Press the **⏻** (power) button on your soundbar or remote control. The power indicator turns off and the source indicator lights.

- Turn on the sound source device connected to your soundbar and begin playback.

- Press the **⏮** (sound source selector) button on your soundbar repeatedly to select the sound source or on the remote control until you hear sound from your soundbar.

Note: If you use the **OPTICAL** jack, you must change your device's audio output setting to PCM format. Refer to the manual that came with your sound source device for additional information.

- Adjust the volume on your soundbar or the sound source device to a comfortable level.

WARNING: Continuous use of high-volume sound may permanently damage your hearing.

- Press the **⏻** (power) button to turn off your soundbar. The power indicator lights red.

IR remote learning function (optional)

Your soundbar can learn 13 button codes from most remote controls, so you can easily control the sound with both the soundbar remote and the TV remote. You can also replace the soundbar remote with another remote.

Programming using the Manual Sequence Learning Mode:

- Point your soundbar's remote control (or the remote you want to program) within 4 in. (10 cm) of the remote control sensor on your soundbar.
- Press and hold the soundbar's **⏻** (power) button from standby for five seconds to turn on the Manual Sequence Learning mode. The Status indicator blinks red rapidly and the soundbar starts to learn.
- Short-press the button on your soundbar's remote control that you want the other remote control to learn. The Status indicator blinks blue once.
- Short-press the button on the other remote control you want to teach. The Status indicator blinks green once. The other remote control has learned the remote function.

Repeat steps 3 and 4 to learn more remote buttons you want.

Programming using the Preset Sequence Learning Mode:

- Point your soundbar's remote control (or the remote you want to program) within 4 in. (10 cm) of the remote control sensor on your soundbar.
- Press and hold your soundbar's **⏻** (power) button from standby for two seconds to turn on the Preset Sequence Learning mode. The Status indicator blinks red slowly and your soundbar starts to learn the buttons in the following sequence: Volume - > Volume + > **⏮** (mute) > **BASS +** > **BASS -** > **⏻** (power) > **THEATER/STANDARD/NEWS** (sound mode) > **⏮** (sound source selector) > **⏮** (play/pause) > **⏮** (previous) > **⏭** (next).
- Short press the button on the remote you want to program. The status indicator blinks blue once when your soundbar receives this button.
- Short press the same button again. The status indicator blinks green once when your sound bar receives the command from the remote you want to program.

Repeat steps 3 and 4 to teach additional functions in the sequence to the remote you want to program, or short-press the **⏮** (sound source selector) button on the soundbar so the learning function on current button will be skipped. The soundbar will auto exit the learning mode if there is no operation for 20 seconds, or you can press and hold the **⏮** (sound source selector) button on the soundbar for two seconds to exit the learning mode.

Deleting all learned remote codes:

Press and hold the **⏻** (power) button for 10 seconds to clear all learned codes. The Status indicator blinks white two times when all the learned remote codes are cleared.

Notes:

- If the Status indicator blinks orange, your soundbar can't learn the button code. Try another button or another remote control.
- During IR learning mode, short press the **⏮** (sound source selector) button to skip current learning button code. Press and hold the **⏮** (sound source selector) button two seconds to exit the learning mode.

MOUNTING YOUR SOUNDBAR

If you want to mount your soundbar below a wall-mounted flat screen TV, see your online *User Guide* or follow the instructions on the mounting template (included) using the mounting hardware (included).

TROUBLESHOOTING

The power doesn't come on.

- Make sure that the AC adapter is securely plugged into the power outlet and your soundbar.
- Make sure that your soundbar is turned on. It doesn't turn on automatically when you turn on your TV or other sound source.

The remote control doesn't work.

- Remove any obstacles between the remote control and the IR sensor on your soundbar.
- The remote control batteries may be exhausted. Replace them.
- Move closer to your soundbar. The remote control is only effective to approximately 50 ft. (15 m) from your soundbar and within 30° on either side.

The sound is breaking up or buzzing.

- Make sure that you are connected to an audio out jack on your sound source. The jack doesn't send audio out if it is an input jack.
- Make sure that all connections are secure and cables are not broken or damaged.
- If you're using the OPTICAL jack, make sure that the source device's sound source is set to the PCM format. See the documentation that came with the sound source device (such as a TV or DVD/Blu-ray player) for additional information.
- Connect to a different source device (such as a TV or DVD/Blu-ray player) to see if the buzzing still occurs. If it doesn't, this may indicate an issue with the original source device.

- Use a different connection method (for example, try OPTICAL jack instead of the AUX IN jack) between your soundbar and the source device to make sure that the jacks on both devices are still working.
- Make sure that the audio cable you're using is not damaged or broken. Try using another one.

I can hear sound from both my TV and my soundbar.

- Turn off or mute the internal speakers of your TV. See your TV's *User Guide* for instructions.

My TV remote doesn't control my soundbar.

- Make sure that your soundbar has learned your TV remote's button codes. See IR Remote Learning Functions for instructions for setup.
- Universal remotes only control your soundbar's volume. Use the controls on your soundbar or the remote that came with it to change your soundbar's sound source or sound mode.
- Make sure that you aim your universal remote at the remote sensor on the front of your soundbar.
- Make sure that you select the correct source on your universal remote.

There is no sound or very low sound.

- Make sure that you're connected to an audio out jack on your sound source. The jack doesn't send audio out if it is an input jack.
- Make sure that the volume level of your soundbar is set to an adequate level.
- Make sure that the volume level isn't muted. Press the **⏮** (mute) button on the remote control to restore the sound output.
- Make sure that the correct sound source is selected. Press the **⏮** (sound source selector) button on your soundbar or on your remote control repeatedly to switch to the correct sound source.
- Make sure that the power is on and all connections are secure.
- Make sure that the volume is turned up on your sound source.
- If you are using the **OPTICAL** jack, make sure that the source device's sound source is set to the PCM format. See the documentation that came with the sound source device (such as a TV or DVD/Blu-ray player) for additional information.
- Make sure that the audio cable you're using isn't damaged or broken. Try using another one.
- Make sure that the sound source device is outputting sound to your soundbar.

There is no sound or low volume in Bluetooth mode.

- Make sure that your Bluetooth device is turned on, Bluetooth is turned on, and **NS-HTSB20S** is selected.
- Turn up the volume on your soundbar.
- Turn up the volume on your Bluetooth device.
- Make sure that your Bluetooth device is not muted.
- Make sure that you're playing music from your Bluetooth device.
- Make sure that you have selected the Bluetooth source on your soundbar.
- Make sure that your Bluetooth device is not paired to a different Bluetooth speaker or other device.

My soundbar won't connect to my Bluetooth device.

- Shorten the distance between your soundbar and your Bluetooth device.
- Turn your devices off, then on. Re-pair your soundbar and your Bluetooth device.
- Make sure that your soundbar isn't paired to another Bluetooth device.
- Make sure that your soundbar and Bluetooth device are both in pairing mode.
- Make sure that you have selected **NS-HTSB20S** on your Bluetooth device.

My Bluetooth device keeps unpairing.

- Shorten the distance between your soundbar and your Bluetooth device.
- If the battery on your Bluetooth device is low, recharge the battery.

"NS-HTSB20S" doesn't appear on my Bluetooth device.

- Shorten the distance between your soundbar and your Bluetooth device.
- Put your soundbar into pairing mode, then refresh your list of Bluetooth devices. For more information, see the documentation that came with your Bluetooth device.
- Make sure that your Bluetooth device is visible to other devices. For more information, see the documentation that came with your Bluetooth device.

The sound is lagging or I hear an echo.

- Turn off or mute the internal speakers on your TV or adjust your TV's audio delay settings. See your TV's *User Guide* for instructions.

ONE-YEAR LIMITED WARRANTY

Visit www.insigniaproducts.com for details.

CONTACT INSIGNIA:

For customer service, call 877-467-4289 (U.S. and Canada)

www.insigniaproducts.com

INSIGNIA is a trademark of Best Buy and its affiliated companies
Distributed by Best Buy Purchasing, LLC
7601 Penn Ave South, Richfield, MN 55423 U.S.A.
©2024 Best Buy. All rights reserved.