



U171 User Manual

1.Preface

Thanks for purchasing the Gsou U171 Ultra portable Bluetooth® speaker. Please take the time to follow the instructions in this User manual carefully. If you have any queries, please call our national service hotline: 400-0985-400

2.Warnings and Cautions

1. To reduce the risk of fire or electric shock, be sure the electrical circuits are not overloaded.
2. To reduce the risk of electronic shock, be sure not to plug the adapter with wet hands.
3. Unplug the power cable if your device is smoking or abnormal and turn to professional assist from your nearest service center, be sure not detach the device yourself.
4. To reduce the risk of fire or electric shock, do not expose this product to rain or moisture. Liquids can cause a failure and/or a fire hazard.
5. The power cable and audio cable can not be twisted or dragged in case of short circuit.
6. Do not place any naked flame sources, such as lighted candles, on or near the apparatus.
7. The safety temperature of Lithium Battery should not exceed 80°C

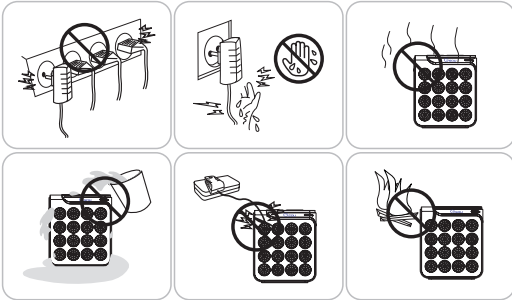

3. Standard Accessories

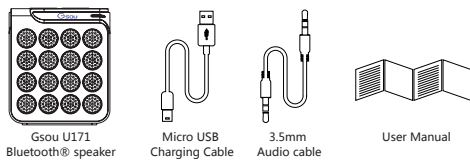

4. Structure Introduction

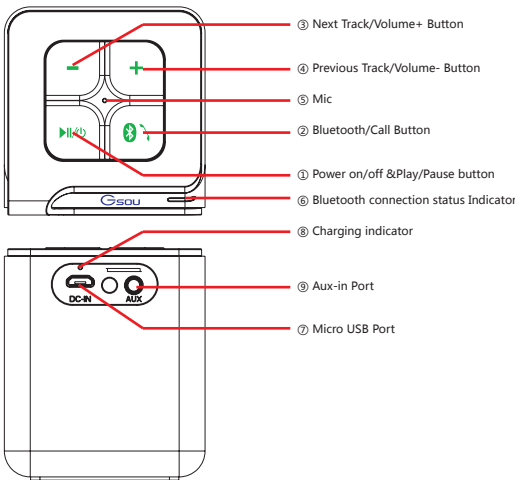

5. Indicator instruction

Blue indicator flashes	status of waiting for connecting
Blue indicator remains steadily on	connected to Bluetooth® source or connected to aux in devices
Low power indicator flashes	battery voltage lower than 3.3V , Red light flashes means your speaker needs to be charged
Red charging indicator light	Red indicator is on when charging , and off when fully charged .

6. Operation steps

Connecting your devices using Bluetooth

- 1.Press ① to turn on your speaker,it will be in Bluetooth mode automatically and be ready for connecting.The bluetooth connection indicator ⑥will flash
- 2.Open the Bluetooth settings on your devices.Your device should automatically discover the U171 device.Connect to it and blue indicator remains to indicate a successful connection.
- 3.Play your music and enjoy the loud but clear sound from your U171

- 4.Long press ③④ to adjust volume. Short press for previous or next track
- 5.Short press⑤ to answer call. Long press to reject call
- 6.Charging indicator flashes for charging. Apply USB cable to connect speaker and adapter.Red indicator on during charging and off for fully charged.

Connecting your PC using Bluetooth

- Make sure your laptop with the bluetooth function
- 1.Start your laptop,search the bluetooth device by” Start-Setting -Control Panel”
 - 2.Start the Bluetooth searching function of your laptop,blue light flashes when searching the Audio-in device
 - 3.Blue indicator light remains steadily on after connecting successfully
 - 4.You can play the audio music of the laptop by U171 Bluetooth speaker

AUX-in

Your speaker comes with a standard 3.5mm Aux in port for connecting with other non-bluetooth audio devices.Plug one end of the audio cable to the AUX in port of the speaker and connect the other end to the earphone port of your audio device.

7. How to charge

Using a USB cable to connect to a computer or buy USB charger

8. Specifications

Dimensions	L:W:H: 70.5x62.0x64.3mm
Weight	210g
Bluetooth protocol and profile	A2DP , AVRCP , HFE , HFP
Frequency range	2.402-2.480GHz (2.4G ISM)
Speaker	Φ45mm 4Ω 3W Dual-coil
RMS	5W
Frequency response	90HZ-20KHZ
Sensitivity	80db
S/N	≥80db
Distortion	≤0.3%
Battery	Built in 500mAh Li-battery
Working Current	Max≤600mA
Working voltage	3.3V -4.2V
DC output	DC 5V

9. Trouble shooting and FAQ

1. Bluetooth Pairing and Connecting

- Pairing occurs when two Bluetooth® devices communicate with each other and establish a Connection .
- Connecting occurs when two Bluetooth ®devices are matched and ready to share data .
- The two devices can be shared under the connecting status , pairing speaker can not work .

2. Your mobile search the Gsou U171, but the speaker it’ s not playing

- Make sure your speaker is in the Bluetooth mode
- Remove the speaker from the other pairing device then pair the mobile and the speaker again
- Make sure you have connected the two devices

3. After Installing the USB Bluetooth adapter on the PC , the PC still can not connect with the speaker

- Make sure your Bluetooth adapter is functioning properly .
- On the PC , right-click on the Bluetooth icon and select the option to add a new connection or device , which will make the computer search for available Bluetooth devices .

- Make sure your use “ Bluetooth AV audio” instead of “ Realtek HD audio output” on your PC
- Restart your PC and search for connections again
- Turn your Bluetooth speaker off and back on

4. Audio is intermittent after establishing a Bluetooth connection

- Make sure your music file is not of poor quality
- Please make sure there is no barrier between the two devices, e.g. Metal objects , walls and other obstacles .
- Move your Bluetooth device and /or Gsou U171 speaker from any device that generates electromagnetic interference, such as another Bluetooth device, cordless phone, microwave oven or wireless router.

* Kindly Reminder

1. In order to save electricity and protect the environment, the loudspeaker supports Intelligent sleep mode when the power is on. If the speaker still has not connected automatically within 15 minutes , please restart your speaker .
2. Compatibility: This speaker is compatible with most major brands and models of Bluetooth mobile phones. However, there may be a few individual Bluetooth mobile phones with which it is not compatible. If you experience any compatibility issues with this speaker, please call our customer service hotline for help.

10. Limited Warranty

Your Gsou U171 Bluetooth® speaker is covered by a limited warranty. It is backed by 1 year performance warranty against any manufacturing defects in material or workmanship from the date of original purchase. This warranty entitles the purchaser to get the product repaired or replaced under the following conditions:

- The warranty applies to the original purchaser, Proof of original purchase is required**
- The warranty does not cover the damage caused by misuse, abuse or improper storage.**
- In no event shall Gsou be responsible for any direct, incidental, consequential or other damages of any kind.**

11. Statement

The Gsou trademark and logo are registered trademarks of Gsou Technology (Shenzhen)Co.,Ltd. All Rights Reserved. All other trademarks, logos or service marks are the property of their respective owners.

12.FCCWarnings ⚠

This device complies with Part 15 of the FCC Rules. Operation is subject to the following two conditions:

(1) this device may not cause harmful interference, and (2) this device must accept any interference received, including interference that may cause undesired operation.Changes or modifications not expressly approved by the party responsible for compliance could void the user's authority to operate the equipment.

NOTE: This equipment has been tested and found to comply with the limits for a Class B digital device, pursuant to Part 15 of the FCC Rules. These limits are designed to provide reasonable protection against harmful interference in a residential installation. This equipment generates, uses and can radiate radio frequency energy and, if not installed and used in accordance with the instructions, may cause harmful interference to radio communications. However,there is no guarantee that interference will not occur in a particular installation.

If this equipment does cause harmful interference to radio or television reception,which can be determined by turning the equipment off and on, the user is encouraged to try to correct the interference by one or more of the following measures:

– Reorient or relocate the receiving antenna.

- Increase the separation between the equipment and receiver.
 - Connect the equipment into an outlet on a circuit differentfrom that to which the receiver is connected.
 - Consult the dealer or an experienced radio/TV technician for help.
- FCC RF warning statement: The device has been evaluated to meet general RF exposure requirement. The device can be used in portable exposure condition without restriction.