

Atlas Pro

DIGITAL
WIRELESS INTERCOM



Table of Contents

I Contents I

Caution	02
Certificate	03
Introduction	
Product Image	04
Function	
Power	05
Current Setting Display	05
Volume Setting	06
User Number Setting	06
Channel Setting	07
Pairing(Grouping)	08
Noise Cancel	09
Beep Sound	09
Display Brightness	10
Mic Volume Level	10
Device Version Info	11
PA Mode (PTT button)	11
Mic Mute	11
Rotation	12
Side Tone	12
How to reset case of malfunction	13
How to charge	13
FAQ	14
Specifications and Caution	15

Caution

Atlas Pro operates in the license-free 900MHz ISM band.
Atlas Pro subject to the Rules and Regulations of the FCC.

This device complies with part 15 of the FCC rules. Operation is subject to the following two conditions: (1) This device may not cause harmful interference, and (2) this device must accept any interference received, including interference that may cause undesired operation.

NOTE: THE GRANTEE IS NOT RESPONSIBLE FOR ANY CHANGES OR MODIFICATIONS NOT EXPRESSLY APPROVED BY THE PARTY RESPONSIBLE FOR COMPLIANCE. SUCH MODIFICATIONS COULD VOID THE USER'S AUTHORITY TO OPERATE THE EQUIPMENT.

NOTE: This equipment has been tested and found to comply with the limits for a Class B digital device, pursuant to part 15 of the FCC Rules. These limits are designed to provide reasonable protection against harmful interference in a residential installation. This equipment generates uses and can radiate radio frequency energy and, if not installed and used in accordance with the instructions, may cause harmful interference to radio communications. However, there is no guarantee that interference will not occur in a particular installation.

If this equipment does cause harmful interference to radio or television reception, which can be determined

by turning the equipment off and on, the user is encouraged to try to correct the interference by one or more of the following measures:

- Reorient or relocate the receiving antenna.
- Increase the separation between the equipment and receiver.
- Connect the equipment into an outlet on a circuit different from that to which the receiver is connected.
- Consult the dealer or an experienced radio/TV technician for help.

Caution

- * Do not put sharp, hard materials into the connector hole when using this product.
- * Do not put apart or repair Atlas Pro yourself.
- * Do not leave Atlas Pro in a vehicle in hot or cold weather.
- * Leaving Atlas Pro in a closed area for a long period of time may result in deformation or malfunction of this product.
- * For charging use only the provided charger & cable. Using a third party charger may cause explosion, fire or malfunction.
- * Stop using Atlas Pro immediately if you smell something like smoke from this.
- * Stop using Atlas Pro immediately when exposed to risk of fire and call the customer center and consult if you can use Atlas Pro at the environment.
- * Please do not use third party's components.
- * If you use a third party component, it could cause breakdown or malfunction.
- * Be careful not to apply strong pressure on this product, which may cause breakdown or damage to the product.
- * If dirt slips in, the quality could decline, so make sure to clean the product with soft cloth often.
- * If Atlas Pro submerges under water, don't put apart or repair it yourself. Please turn the power off and call our customer service center.

Certification :

Identification Code : Shown below Model Name: Shown Below
Company Name: Input Rating: Shown Below
Manufacturer/Country: Date of Manufacture: Separately
Date of manufacturing: Marked Shown
Separately

Model Name	Input Rating	Identification Code

Introduction

Product Image

▶ LEFT



▶ RIGHT



Function

1. Power

Power on, off with PWR button

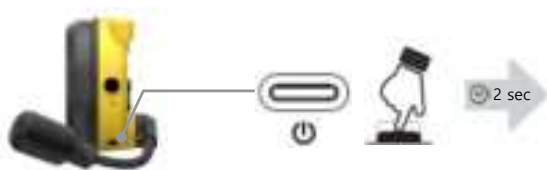

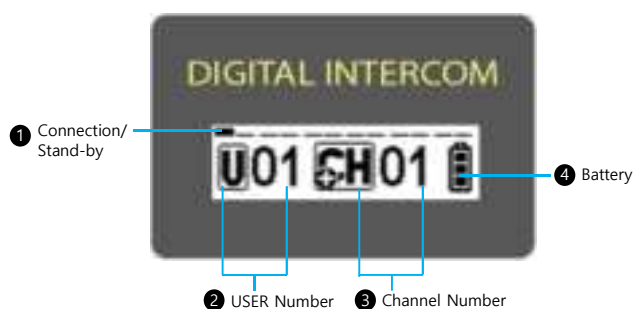

2. Current Setting Display

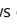
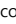

1. Connection/Stand-By : Twelve bars on the upper display shows connection  or stand-by .

2. User Number : it shows the user number that your device is set to.

3. Channel :  means the current channel number that your device is set to. If you are a master device,  is displayed.

4. Battery : It indicates current battery level. When battery is running low, the battery ICON is blinking.

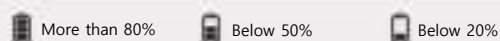

Note

If device is left in standby mode for half hour, it is automatically turned off for power-saving.

Standby status means the device is ready for pairing (No connection)

Function

3. Volume Setting

Volume level ranges from 0 to 8.



Note

Volume 0 means no audio volume

4. User Number Setting

User Number ranges from User 1 to User 12.

Each device takes one user number, and user number for devices should be different from one another.

STEP 1

Press&hold  button to go to Menu and then choose "8. User".



8. User
9. Information



Press PTT button
to select

STEP 2

Choose between "User 1" and "User 12"



8. User
9. Information
↓
User 1
User 2



Press PTT button
to complete

Note

- There should be one Master Device for group communication.
- Press&hold PTT button for transmission in "PA mode".

Function

5. Channel Setting

Devices should be set to same channel number for communication.
If there are multiple communication groups in the same channel nearby, set channel number different from other groups to avoid potential interference.

STEP 1

Choose between "Channel 1" and "Channel 6"



Select a channel number
by pressing Channel Up or
Down button

Function

6. Pairing (Grouping)

Below pairing procedure should be done to establish communication group.

STEP 1

Pairing is made between a master device and rest devices.
Each device needs to be set to a different user number than others

STEP 2

 Press&hold 'M' button to go to Menu and then select "7. Pairing".



Push PTT button
to select

STEP 3

Once pairing is done, paired devices go to stand-by display.
If you press 'M' button while pairing is being processed, the pairing
is canceled and these devices go to stand-by display.

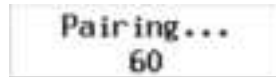

Note

Pairing is cancelled if not done within 60 seconds.

Function

7. Noise Cancel

You can minimize surrounding noise with this function.

STEP 1 Press&hold  button to go to menu and then select " 1. Noise Cancel " 

1.Noise Cancel
2.Beep Sound



Push PTT button
to select

STEP 2 Choose between "0" and "8"
Noise Cancel is off at 0.



Noise Cancel
3



Push PTT button
to select

8. Beep Sound

You can turn on or off warning sound and button sound depending on user's preference.

STEP 1 Press&hold  button to go to menu and select " 5. Beep Sound ". 



2.Beep Sound
3.Brightness



Push PTT button
to select

STEP 2 Choose between "Enable" and "Disable"



Enable
Disable



Push PTT button
to select

Function

9. Display Brightness Setting

You can adjust display brightness level.

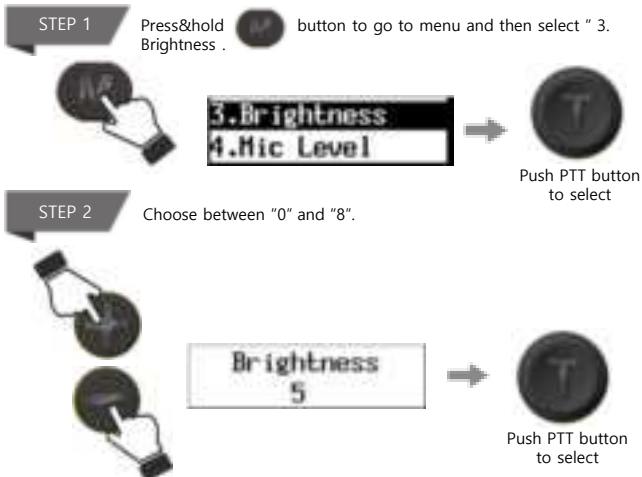

10. Mic Level

You can adjust the Microphone Volume level. With this function your voice transmission is clearer if you set it right, depending on your voice level.

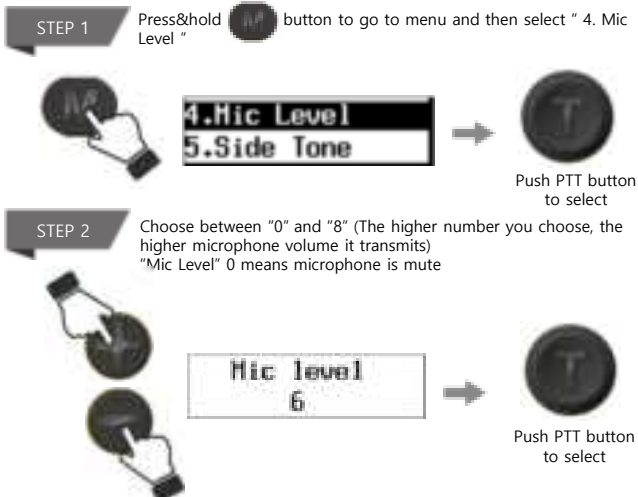

Function

11. Side Tone

You can turn on or off Side Tone function.

If you turn on the Side Tone, you can hear what you are saying at real time.

STEP 1

Press&hold  button to go to menu and then select " 5.Side Tone



5.Side Tone
6.Rotation



Push PTT button
to select

12. Rotation

The menu window returns to the first without stopping at the end number.

STEP 1

Press&hold  button to go to menu and then select " 6.Rotation



5.Rotation
7.Pairing



Push PTT button
to select

13. Information

You can check the device's version

STEP 1

Press&hold  button to go to menu and then select " 8.Information.



8.Information
Exit



Push PTT button
to select

Function

14. PA Mode (PTT Button)

User 1-12 can use PA mode by using below PTT button When it selected "PA Channel".

It can be broadcast during the "Talk Time" time set by the PC Program and re-broadcast after the "Suspend Time" has elapsed. If you set "Alert Time", an alert will occur before the broadcast time expires.

Talk Time: Time to broadcast on PA channel (10~40s)

Alert Time: Warning alarm time before end of broadcast (disable, 1~20s).

Suspend Time: Rest time from the end of broadcast to re-broadcast (5~40s)



15. Mic Mute

User 1~12 can mute microphone by pressing 'M' button shortly. Users only listen if they mute microphone.



Function

16. How to reset in case of malfunction



Press these buttons together at the same time. Then the device goes off.



Note

Be careful not to press these buttons together during normal operation.

17. How to charge

When charging, orange color is displayed and the green light turns on when the device is fully charged.



Note

- Please use only the provided charging adapter or use 5V / 2A adapter or higher than that.
- The battery level indication while on charge could be different from the actual battery level.
- Please make sure to turn off the device before charging it to get it fully charged.

FAQ

Following is the list of frequent questions and answer.

- ❶ I can't communicate with other devices.
 - Check if your device is paired with Master Device.
 - In your group, check if Master Device exists.
- ❷ I cannot join a group communication.
 - Check if other users are connected on the display.
 - Check if there is a Master Device in the group.
 - You might be too far from Master Device to get the signal from it.
 - .
- ❸ I cannot turn on the device.
 - Put your device to the charger for charging and then turn it on.
- ❹ I lost connections sometimes.
 - Check if other users are connected on the display.
 - Check if someone is using the same user number as mind
- ❺ Other users' voice sounds broken.
 - Check if the distance between the users is too far.
- ❻ Other users can barely hear my voice.
 - Check if you set MIC level low.
 - Check if the headset' microphone is a little far from your mouth

Specification & Caution

Frequency	902MHz~928MHz
Transmission Distance	1Km (Line of Sight)
Battery Lifetime	10Hour
Battery	Rechargeable Li-ion 3.7V Battery
Transmission Output	250mW / 1W
Weight	445g
Size	Width(w) : 177mm Height(h) : 220mm Thickness(t) : 84.3mm
Working Temperature	-10/+50°C
Modulation System	FSK
Transmission Method	TDMA

- ※ The function may change without notice for product improvement purpose.
- ※ Transmission distance may vary depending on the surroundings' obstacles and humidity.

I Caution I

Please make sure to read through the below safety requirements before using this product. If these are not followed well, incidents like fire or explosion may happen.

- DO NOT separate / modify the antenna or DO NOT use the modified antenna. It degrades performance of the device, which results in serious breakdown as the intercom generates strong radio wave through the antenna.
- Only the provided charging adapter and headset are acceptable to use with this device, so DO NOT use a third-party adapter and headset. Otherwise, the battery will be damaged and there will be a malfunction of the device.
- Use this device only for communication (NOT for other purposes).
- Do not take apart or modify this device yourself. Otherwise, this could result in a malfunction which our warranty doesn't cover. Also, you might be subject to a penalty according to a relevant communication law.
- Do not change the frequency or use other frequency than the allowed frequency. Otherwise, you might be subject to a penalty according to a relevant communication law.

- * Try not to put strong physical shocking to this device.
- * Keep it out of direct sunlight and high humidity.
- * DO NOT leave the device in a car in the summer.

Warning

I Warning I

-FCC Information to User-

This equipment has been tested and found to comply with the limits for a Class B digital device, pursuant to Part 15 of the FCC Rules. These limits are designed to provide reasonable protection against harmful interference in a residential installation. This equipment generates, uses and can radiate radio frequency energy and, if not installed and used in accordance with the instructions, may cause harmful interference to radio communications. However, there is no guarantee that interference will not occur in a particular installation. If this equipment does cause harmful interference to radio or television reception, which can be determined by turning the equipment off and on, the user is encouraged to try to correct the interference by one of the following measures:

- Reorient or relocate the receiving antenna.
- Increase the separation between the equipment and receiver.
- Connect the equipment into an outlet on a circuit different from that to which the receiver is connected.
- Consult the dealer or an experienced radio/TV technician for help.

-Caution-

Modifications not expressly approved by the party responsible for compliance could void the user's authority to operate the equipment.

-FCC Compliance Information-

This device complies with Part 15 of the FCC Rules. Operation is subject to the following two conditions: (1) This device may not cause harmful interference, and (2) this device must accept any interference received, including interference that may cause undesired operation.

This device was tested in compliance with FCC RF Exposure limit (0 mm distance from human head (limit 1.6 W/kg @ 1g SAR) and extremity (limit 4.0 W/kg @ 10g SAR))