

1. Power Key  
2. Feeding Key  
3. Power Light  
4. Alarm Light  
5. Mini USB Port  
6. Serial Interface  
7. Charging Port  
8. Hook

### Understand the Printer

- Streamlined appearance, portable and size, can hang on the chest and work on desk
- Easy to load paper and use
- Can load roll paper with 50mm diameter
- NO 18650 battery with 2200mAh/3.7V which can charge use imported cells having long recharge life
- Charging and printing at the same time
- One efficient convenient and intelligent printing time and best printing effect
- USB/Bluetooth interfaces (Standard)
- Bluetooth BT1.1 & BLE 4.0, can be linked by Android/iOS phone
- USB support USB Printing way, which is convenient to develop and test
- ESC/POS printing command
- OS2312 similar style
- Support DLL, SDK and App Demo which support customer application development



### Device Mode

**Opening mode:** Press power key for 2s, and power light is always bright with one buzzer.  
**Closing mode:** Press power key for 2s at opening mode, and then power light and alarm light will be off.  
**Bluetooth is be connected:** Opening device, bluetooth light will flash 2s.  
**Bluetooth connecting:** Blue light is always bright.  
**Low electricity:** indicator of each low time short beeps.  
**Without paper or overhead:** Alarm light will flash with indirect short beeps.  
**Changing in opening mode:** Power light will be always bright in charging; when finished, power light will be off.

### Paper Roll Installation

Easy to load paper and use  
Can hold roll paper with 50mm diameter

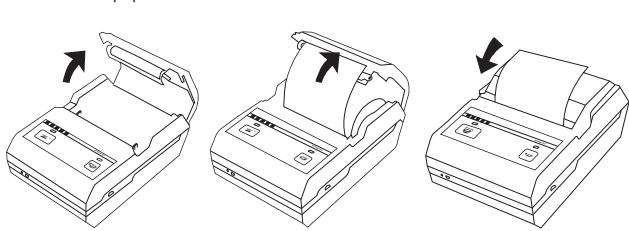

### Basic Operation

**Open device:** press power key for 2s  
**Close device:** press power key for 2s when opening  
**Feeding:** press feeding key when opening  
**Get ID:** press power and feeding key in the same time at closing mode  
**Self test:** under power off status, press power key first, then press the feek key, for awhile, it will ring 3 times, then it is successful.  
**Battery Activation:** Every time after loading the batteries, charge for a second to activate it.

### RF pairing process

The device has been validated to meet general RF exposure requirement. The device can be used in portable exposure condition without restriction.

**Bluetooth Thermal Printer**  
Bluetooth Thermal Printer  
NAME: \_MET\_  
MODE: BLE068F1100

ID NAME

### Specification

Printing Method: Thermal Line Printing  
Print Density: 384 dot / line  
Print Speed: 50mm/s  
Interface: USB+ Bluetooth  
Paper Width: 50mm  
Roll Diameter: 50mm  
Paper Thickness: 0.08-0.09mm  
Print Command: ESC/POS  
Character Size: 24\*24 point  
Bar Code Type: CODE39, CODE128  
Input Buffer: 10K bytes  
Power Adapter: Input AC120V, output DC5V/1A  
Lithium battery: 2200mAh (3.7V)  
Charging time: 3 hours  
Working Environment: Temperature 0°C ~30°C, humidity 20%~85%  
Storage Environment: Temperature -20°C~60°C, humidity 5%~95%  
Mechanical Properties: 50MM  
Operating System: Android, iOS, (Windows, Win98, Win10/2000, WinNT, WinXP, WinVista, Win7, Win8, Linux)



### FCC STATEMENT

1. This device complies with Part 15 of the FCC Rules. Operation is subject to the following two conditions:  
(1) This device may not cause harmful interference.  
(2) This device must accept any interference received, including interference that may cause undesired operation.
2. Changes or modifications not expressly approved by the party responsible for compliance could void the user's authority to operate the equipment.

NOTE: This equipment has been tested and found to comply with the limits for a Class B digital device, pursuant to Part 15 of the FCC Rules. These limits are designed to provide reasonable protection against harmful interference in a residential installation. The equipment generates uses and can radiate radio frequency energy and, if not installed and used in accordance with the instructions, may cause harmful interference to radio communications. However, there is no guarantee that interference will not occur in a particular installation. If this equipment does cause harmful interference to radio communications, which can be determined by turning the equipment off and on, the user is encouraged to try to correct the interference by one or more of the following measures:  
• Reorient or relocate the receiving antenna.  
• Increase the separation between the equipment and receiver.  
• Connect the equipment into an outlet on a circuit different from that to which the receiver is connected.  
• Consult the dealer or an experienced radio/TV technician for help.

### Warranty Card

### Warranty Item

In warranty period, product have property fault for non-human damage and is confirmed by After-sales Service Center, you can enjoy the attached services:

**47 days**  
Since you get the goods within 7 days, product appear quality problem, you can choose to return of goods and we will return the product cost.

**60 days**  
Since you get the goods within 30 days, product appear quality problem, you can choose to change same type product for free.

**12 months**  
Since you get the goods within 12 months, product appear quality problem, you can choose to maintain for free.

Service outside the warranty range, we will make relevant service charge.  
Charge standard: Replacement fee+ Technical service fee.  
Our company own final interpretation of the warranty item.

portable printer

### Not Warranty Items

- Conforming one of following situations, it can not enjoy warranty item. And according to user's agreement, After-sales Service Center will make replacement cost and repair fee.
- No "Three Guarantees" certificate, no valid invoice or over the valid period of product.
  - Product have damages because you haven't followed the user's guide to use. Or you privately disassemble, maintain and change system software which cause damages or abnormal situation.
  - Altering privately and tear the product code, or the product code of warranty voucher is different with the product.
  - Causing damages for inevitable natural disaster and so on.
  - Causing damages for inevitable human damage.
  - Changing with wrong battery model will risk burning.
  - Please deal with the used batteries as instruction.
  - Only applicable to the safe use of areas below 2000m above sea level at an altitude of 2000m or more, there may be security risk.
  - It must be used for away the situation.
- This is A level product, may cause radio interference in our life. Under this situation, Please do something enable to avoid radio interference.

### "Three Guarantees" certificate

#### Information of customers

Name: \_\_\_\_\_ Telephone number: \_\_\_\_\_ Email: \_\_\_\_\_

Carded address: \_\_\_\_\_

#### Maintenance records

Time	fault phenomenon	cause of fault	handling	maintenance person

### Storage precautions :

1. The printer should be kept away from water and avoid direct sunlight from sunlight, light and heat. Prohibit any liquid, powder and metal into the printer, or easily lead to damage to the printer.
2. Excessive ambient temperature (above 30 °) or too low ambient temperature (below 5 degrees) will decrease the quality of the printer.
3. Excessive ambient humidity (above 85% relative humidity) or too low ambient humidity (20% relative humidity below) can decrease the quality of the printer.
4. Do not open the paper compartment cover during printing, as this may cause the printer to malfunction.
5. Using poor print paper or too long paper may cause print quality to deteriorate or even damage the printer.
6. If there are ink stains on the print head, using a soft cotton or cotton swab, dipped in a little alcohol to wipe it clean to prevent the print head from being worn.

### Portable thermal printer

User's Guide

