

Instruction Manual

A30

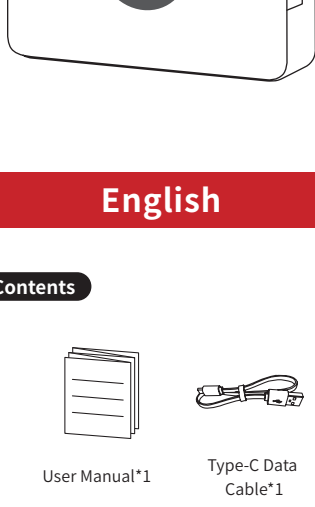

English

01. Package Contents



Printer*1



User Manual*1

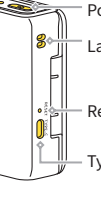

Type-C Data Cable*1

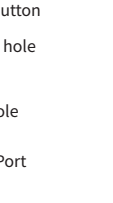

Label Paper*1

Note:

Random supplies are included with the purchase of a single machine, and the label ribbon is already installed in the machine.

02. Label Printer Component Overview

Front



Back

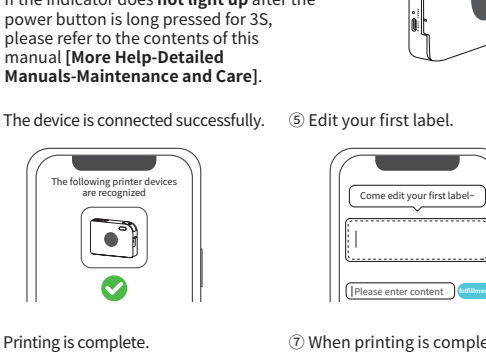

Inside

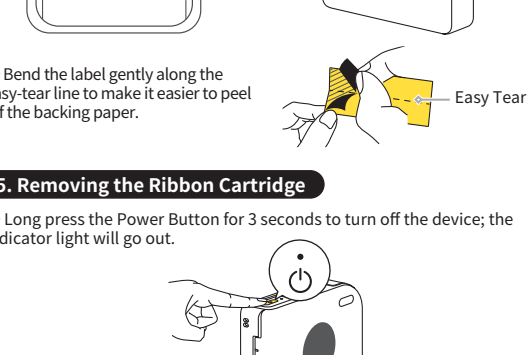

03. Downloading the App

Method I:

Please install the "Print Master" App from Google Play or the App Store prior to using the printer.

Method II:

You can also download the App by scanning the QR code directly.



GET IT ON
Google Play



Download on the
App Store

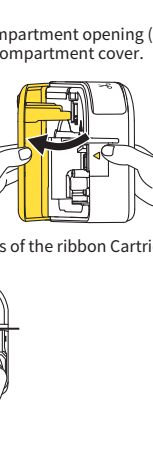

Download the App by scanning the QR code directly

04. Instructions for use

① Make sure that the "Print Master" app has been installed.

② Open the App.

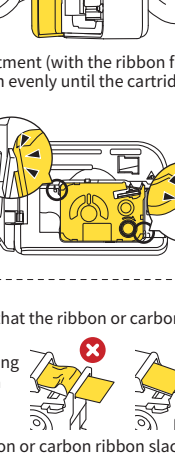
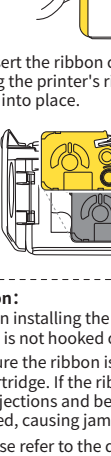

③ Long press the power button for 3s to turn on the device.

a. If the indicator light appears **green** after the power button is long pressed for 3S, but the app prompts connection failure, please check the contents of this manual [**More Help-Detailed Manuals-FAQ-App Permission Statement**].

b. If the indicator light appears **red** after the power button is pressed and held down for 3S, please refer to the contents of [**More Help - Indicator Light Indication**] in this manual.

c. If the indicator does **not light up** after the power button is long pressed for 3S, please refer to the contents of this manual [**More Help-Detailed Manuals-Maintenance and Care**].

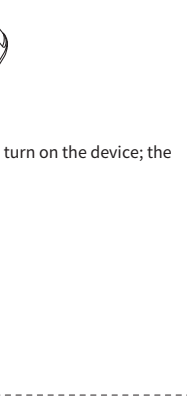

④ The device is connected successfully.

⑤ Edit your first label.

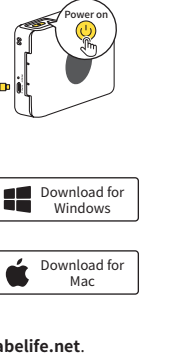

⑥ Printing is complete.

⑦ When printing is complete, press the cutter to remove the label.

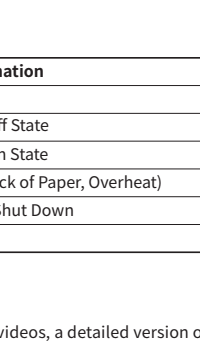
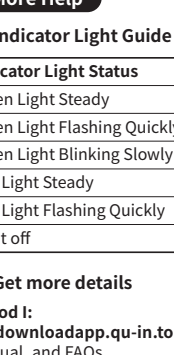

⑧ Bend the label gently along the easy-tear line to make it easier to peel off the backing paper.

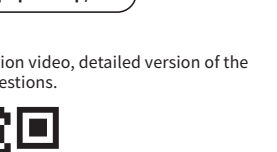

05. Removing the Ribbon Cartridge

① Long press the Power Button for 3 seconds to turn off the device; the indicator light will go out.

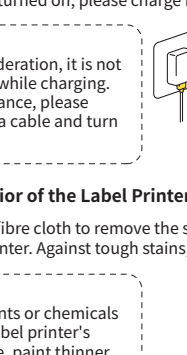

② As shown, place your finger on the ribbon compartment opening (below the ribbon exit) and gently pull to open the ribbon compartment cover.

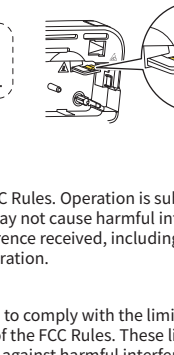
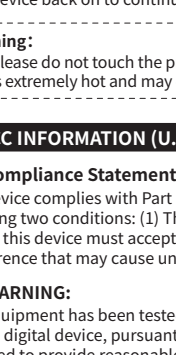

③ As shown, place your fingers on the both sides of the ribbon Cartridge and remove it.

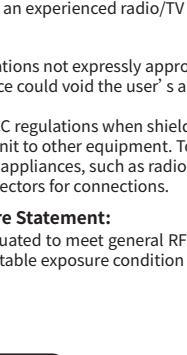

06. Installing the Ribbon Cartridge

① After removing the packaging, check if the front end of the ribbon is bent or has gone through the guide slot properly. If not, please thread it through as shown.

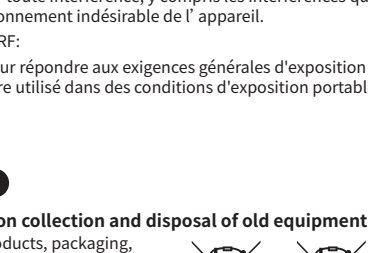

② As shown, place your finger on the ribbon compartment opening (below the ribbon exit) and gently pull to open the ribbon compartment cover.

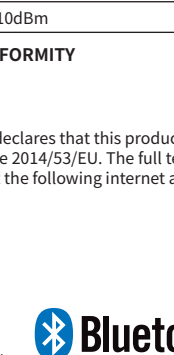
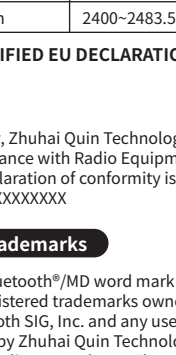

③ Insert the ribbon cartridge into the compartment (with the ribbon front end facing the printer's ribbon exit), pressing down evenly until the cartridge latch locks into place.



Caution:

1. When installing the ribbon cartridge, ensure that the ribbon or carbon ribbon is not hooked on the printhead.

2. Ensure the ribbon is taut before gently inserting the cartridge. If the ribbon is loose, it may catch on projections and bend or wrinkle when being installed, causing jams.

3. Please refer to the diagram to adjust the ribbon or carbon ribbon slack.

① To fix the ribbon slack, pull the ribbon out of the guide slot.

② To fix the carbon ribbon slack, turn the gear in the direction of the arrow until the carbon ribbon is tightened.

④ Close the ribbon compartment cover.

⑤ Long press the power button for 3 seconds to turn on the device; the indicator light will stay green.

Caution:

① When changing the label paper to a die-cut label, please click the power button to position the label. Continuous paper does not require label positioning.

② Positioning label paper can prevent issues such as incomplete printing, missing print, and misaligned printing.

07. Computer Printing with Data Cable

① Long press 3S to turn on the device, and use the supplied cable to connect to the computer.

② Open the link: A30.phomemo.com

Download for Windows

Download for Mac

③ Install the Labelife editing software.

For a more detailed tutorial go to: <https://labelife.net>.

08. More Help

8.1 Indicator Light Guide

Indicator Light Status	Status Explanation
Green Light Steady	On/Charged
Green Light Flashing Quickly	Charging in Off State
Green Light Blinking Slowly	Charging in On State
Red Light Steady	Error State(Lack of Paper, Overheat)
Red Light Flashing Quickly	Preparing to Shut Down
Light off	Off-state

8.2 Get more details

Method I:

Visit downloadapp.qu-in.top/Ph for how-to videos, a detailed version of the eManual, and FAQs.

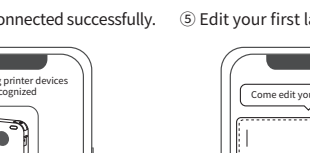

Method II:

Please scan the code to view the operation video, detailed version of the electronic manual, frequently asked questions.

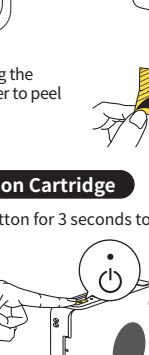

09. Maintenance and Care

9.1 Charging

- * Please check and ensure the product and your hands are dry. Connect to a 5V DC, 2A USB AC power adapter using the provided USB cable. Then, plug the device into a power socket and charge until the light stays on.
- * For optimal battery performance, please charge at least every 2-3 months.
- * When the Indicator Light is red and flashing quickly, the device will turn off in 10 seconds. Please charge immediately to ensure smooth operation.
- * If the device cannot be turned on, please charge for 1 hour.

Caution:

① For battery life consideration, it is not recommended to print while charging.

② Prior to any maintenance, please disconnect the USB data cable and turn off the label printer.

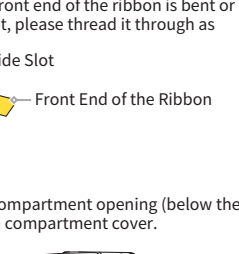

9.2 Cleaning the exterior of the Label Printer

- * Please use a soft microfibre cloth to remove the stains and dust from the exterior of the Label Printer. Against tough stains, dampen the cloth to clean.

Caution:

Please do not use solvents or chemicals that may damage the label printer's surface such as benzene, paint thinner, or alcohol.



9.3 Cleaning the Printhead

- * Dirt on the printhead may cause blank lines, blurred print, or missing characters.
- * Wait for 10 minutes after printing for the printhead to cool down completely.
- * Use a cotton swab dabbed with some rubbing alcohol, an alcohol swab (mildly squeezed) or a professional printhead cleaning pen (purchased separately) to wipe the printhead surface back and forth four times.
- * Wait for 5~10 minutes for the alcohol to evaporate completely before turning the device back on to continue printing.

Warning:

Please do not touch the printhead. It is extremely hot and may cause burns.

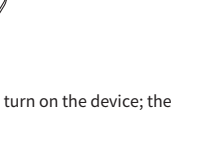

10. FCC INFORMATION (U.S.A.)

FCC Compliance Statement:

This device complies with Part 15 of the FCC Rules. Operation is subject to the following two conditions: (1) This device may not cause harmful interference, and (2) this device must accept any interference received, including interference that may cause undesired operation.

FCC WARNING:

This equipment has been tested and found to comply with the limits for a Class B digital device, pursuant to Part 15 of the FCC Rules. These limits are designed to provide reasonable protection against harmful interference in a residential installation. This equipment generates, uses and can radiate radio frequency energy and, if not installed and used in accordance with the instructions, may cause harmful interference to radio communications. However, there is no guarantee that interference will not occur in a particular installation. If this equipment does cause harmful interference to radio or television reception, which can be determined by turning the equipment off and on, the user is encouraged to try to correct the interference by one of the following measures:

- Reorienting or relocating the receiving antenna.
- Increasing the separation between the equipment and receiver.
- Connecting the equipment to an outlet that is on a different circuit than the radio or TV.
- Consulting the dealer or an experienced radio/TV technician for help.

FCC Caution:

- Any changes or modifications not expressly approved by the party responsible for compliance could void the user's authority to operate this equipment.
- This product satisfies FCC regulations when shielded cables and connectors are used to connect the unit to other equipment. To prevent electromagnetic interference with electric appliances, such as radios and televisions, use shielded cables and connectors for connections.

FCC Radiation Exposure Statement:

The device has been evaluated to meet general RF exposure requirement. The device can be used in portable exposure condition without restriction.

11. ISED NOTICE (Canada)

CAN ICES-003(B)/NMB-003(B)

This device contains licence-exempt transmitter(s)/receiver(s) that comply with Innovation, Science and Economic Development Canada's licence-exempt RSS(s). Operation is subject to the following two conditions: 1. This device may not cause interference. 2. This device must accept any interference, including interference that may cause undesired operation of the device.

RF exposure statement:

The device has been evaluated to meet general RF exposure requirement. The device can be used in portable exposure condition without restriction.

Cet appareil contient un émetteur (S)/ récepteur (S) exempté (S) de licence qui est conforme aux RSS(S) exemptés (S) de licence d'innovation, Science et développement économique Canada. Le fonctionnement est soumis aux deux conditions suivantes: 1. Cet appareil ne peut pas causer d'interférences. 2. Cet appareil doit accepter toute interférence, y compris les interférences qui peuvent causer un fonctionnement indésirable de l'appareil.

Déclaration d'exposition RF:

L'appareil a été évalué pour répondre aux exigences générales d'exposition aux RF. L'appareil peut être utilisé dans des conditions d'exposition portable sans restriction.

12. European Union

Information for users on collection and disposal of old equipment:

These symbols on the products, packaging, and/or accompanying documents mean that used electrical and electronic products should not be mixed with general household waste.

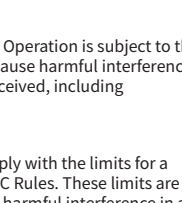

These symbols are only valid in the European Union. If you wish to discard these items, please contact your local authorities or dealer and ask for the correct method of disposal.

For more information about collection and recycling of old products, please contact your local municipality, your waste disposal service or the point of sale where you purchased the items.

Type of wireless	Radio Frequency	Maximum Output Power (EIRP)
Bluetooth	2400~2483.5 MHz	10dBm

SIMPLIFIED EU DECLARATION OF CONFORMITY

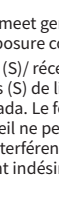

Hereby, Zhuhai Quin Technology Co., Ltd. declares that this product is in compliance with Radio Equipment Directive 2014/53/EU. The full texts of the EU declaration of conformity is available at the following internet address: XXXXXXXXXXXX

13. Trademarks

The Bluetooth®/MD word mark and logos are registered trademarks owned by Bluetooth SIG, Inc. and any use of such marks by Zhuhai Quin Technology Co., Ltd. is under license. Other trademarks and trade names are those of their respective owners.

