

Inrico®

SINCE 2004

PoC RADIO
IN TOUCH TIMELY EVERYWHERE

Professional In High Quality Two Way Radios

INRICO TECHNOLOGIES CO., LTD.
www.inricosolutions.com



T522A

NEW

USER GUIDE



Please read this instruction book carefully before using and keep this with care.

www.inricosolutions.com

Disclaimer

This guide is for reference only and the information in this document is carefully examined, and is believed to be entirely reliable. However, no responsibility is assumed for inaccuracies. Furthermore, the provider reserves the right to make changes to any products herein to improve readability, function, or design. The provider does not assume any liability arising out of the applications or use of any product or circuit described herein; nor does it cover any license under its patent rights, nor the rights of others.

Contents

Unboxing and Device Checking.....	01
Handling Precautions.....	01
Radio Regulations.....	02
Operating Environment Requirement.....	03
Accessories Requirement.....	03
Charging Security.....	03
Battery Care.....	03
Clean and Maintenance.....	05
Product Overview.....	06
Accessories Installation.....	08
Insert SIM Card.....	08
Attaching the Battery.....	08
Removing the Battery.....	09
Installing Antenna.....	09
Attaching/ Removing the Belt Clip.....	10
Attaching the Hand Strip.....	10
Attaching the Headset.....	11
Desktop Charger.....	11
Basic Functions.....	12
Powering Up and Powering Off the Radio.....	12
Volume Adjust.....	12
Headset.....	12
Private Call.....	12
Group Switch.....	12
Status Indicators.....	13
Basic Troubleshooting.....	13
Specification.....	15

Unpacking and Device Checking

Please unbox and take out the device and all accessories carefully, and ensure all lists have been gotten before discarding the cardboard box. If any items are lost or damaged in transit, please contact with our distributors.

Items	Number
PoC Radio	1
Lithium Battery	1
Power Adaptor	1
USB Charging Cable	1
Belt Clip	1
Belt Clip Mounting Screws	2
Antenna	1
Hand Strip	1
User Manual	1

Handling Precautions

Please read the following precautions carefully. It is very important for device users to gain general knowledge and risks.

1. Radio Regulations

The place of civilization provisions that has prohibited the use of wireless devices, don't use the device, otherwise it will lead to interference from other electronic devices or other hazards.

2. Operating Environment Requirement

- Do not use the device or charging the battery in any hazardous areas such as gas, dust, steam, explosive chemical agents, etc.
- Avoid excessive exposure to the extreme dusty, damp and splashing place, or leave it on unstable surface.
- Don't use this device in a thunderstorm in case of equipment malfunction or shock.
- Avoid prolonged time in the sun or placing it near heating appliance like electric heaters, microwave, oven, water heater, fire, candles, etc.
- Please turn off the device while refueling or parking at the gas station.

3. Accessories Requirement

- Do not disassemble your device. Changes or modifications made to this device, not expressly approved by suppliers, could void the user's authority to operate this equipment.

- Reparation by professional technicians, do not disassemble by yourself.
- Manufacturer-approved device and accessories only.

4. Charging Security

- Do not overcharge the battery
Please stop charging if it can't be fully charged within required time. The battery probably overheats, smokes, bursts or suddenly be on fire due to abnormal charging process. When fully charged or not charged, please disconnect the charger and unplug it from the power outlet.
- Please use authorized power adaptor
To comply with warranty terms and avoid damages, charge the battery using a specified charger for best performance.
- Do not use abnormal battery
If the battery is with odd smelly, discolored, deformed, etc., please stop charging or disassemble from the device immediately.
- Do not discard battery in a fire, microwave or high pressure container. The battery probably overheats, smokes, bursts or suddenly be on fire.

5. Battery Care

- (1) Fully Charge Battery Before Initial Use
- Do preserve battery life by switching off a device and removing the batteries when it's not being used, and is not expected to be used for extended periods of time.

- Do practice proper battery storage by keeping batteries in a cool, dry place at normal room temperature.

(2) Properly Store Batteries

- Remove the battery from the device.
- Charge and discharge the battery to 40%-65% if it will not be used for 10 days or more. This can greatly extend the battery life.
- The battery should drop below 65% when it is idle for more than 10 days to prevent it from swelling.
- Store the battery in cool and dry environment that's less than 25 C.

(3) Features of Lithium Battery

- Battery capacity will reduce after multiple charging cycles.
- The battery capacity drops gradually even without being used.
- Longer charging time is required in shady place.
- Charging and storing Lithium battery in warm condition will short its lifespan. Please do not leave them inside the vehicle or near the heater.
- If the battery working time has reduced significantly, please replace the battery immediately in avoidance of fluid leakage.

(4) Lithium Battery Charging

- Connect the device with an AC adapter, power on, the LED turns to red.
- The LED shows green of fully charged.
- The LED is off under high operating temperature, poor contact, or battery damage.





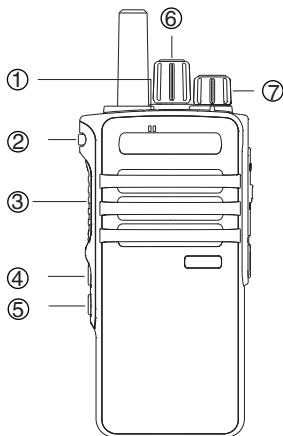

6. Clean and Maintenance

- Before cleaning and maintaining the device: please stop running, turn off the device, and disconnect all connections with other equipment.
- When you do not use the radio, please cover the accessories connector.
- When cleaning the dust, please use soft brush and neutral detergent (no strong corrosive chemicals) to wipe it.
- Please keep the equipment and accessories dry.
- Please do not use the microwave oven or hair dryer or other heating devices for dry them.

Product Overview



1	SOS
2	Function key 1
3	PTT
4	Function key 2
5	Function key 3
6	Channel Switch
7	Power/Volume Knob

Problems		Solutions
	SOS Button	Long press SOS to start SOS. No key works during SOS. SOS lasts for 60 sec. totally. Once SOS starts there is SOS voice prompt which lasts for 4 sec. Then auto group call starts.
	Function key1	Long press function key 1 for voice prompt for version No. Short press function key 1 for voice prompt for remaining time of APK account.
	PTT Button	Press PTT with red indicator on and start talk. Keep 3-4cm away from Microphone while talking. Release PTT key with green indicator on to receive message.
	Function key2	Long press Function key 2 to start Private calls. Then press function Key 2 to select the member. Private call starts by pressing PTT. Once done press PTT talk. End private call by pressing the key again. Short press function key 2 to play back the record of current group. Press function key 2 to select record. 10 records play-back are available for each group.
	Function key3	Short press function key 3 for voice prompt for current group. Long press function key 3 for voice prompt for battery consumption.
	Channel Switch	Rotate group switch key to select group.
	Power/Volume Knob	<ul style="list-style-type: none"> Power On: Turn Volume/Power knob clockwise to power on. Power Off: Turn Volume/Power knob anticlockwise to power off. Turn Volume/Power knob to adjust volume after power-on.

Accessories Installation

1.Insert SIM Card or TF Card.

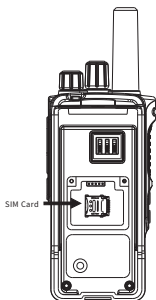

2.Attaching the Battery

Insert the battery properly and press down on the other end of the battery. Then Pull up the battery cover with a "click".

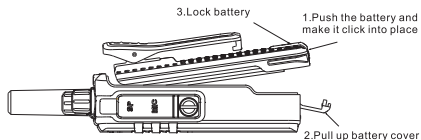

3.Removing the battery

To remove battery, turn off the radio and push upward the lock catch of battery. Then push the battery as arrow pointed and take off the battery.

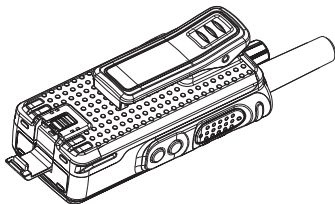

4.Installing Antenna

Screw the antenna into the connector on the top of radio and turn the antenna clockwise to fasten it. Turn the antenna anticlockwise to remove it.

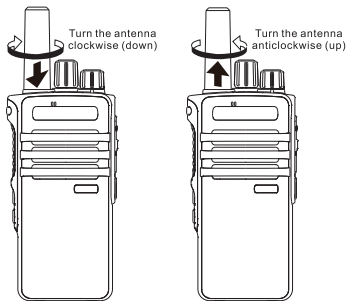

5. Attaching/ Removing the Belt Clip

- Push the belt clip along the "T" slot to the bottom.
- Buckle the buckle, the back clip overall upward exit can be.

Push the belt clip along the "T" slot to the bottom

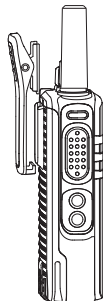

6. Attaching the Hand Strip

Take the tail of sling across the oval hole on the back of handset to install.

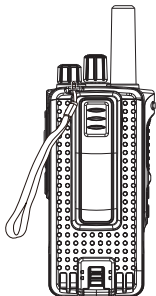

7. Attaching the Headset

Open the cover from the top of device to show the headset sockets. Headset will work immediately after being plugged in.

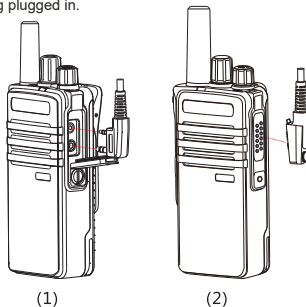

8. Desktop Charger

Charging with desktop charger: The charger must be placed on a flat surface away from flammable materials. Aim the radio at the charging port and place it down into the charging port of the charger base according to the instruction diagram. The battery does not need to be removed from the radio when charging. Please make sure that the radio is safe when charging in the charger base. Please do not put the radio with battery in the charger base when it is not charging.

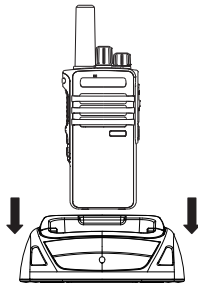

Basic Functions

1.Powering Up and Powering Off the Radio

- Power on: Turn the power /volume knob to power on when power off. During power-off, there is voice prompt. After power on, green indicator is on and then blinks. It is searching network there is voice prompt after successful interhel access
- Power off: Turn the power/volume knob to power off when power off, during power-on, Indicator will be off.

2.Volume Adjust

Increase volume by turning clockwise. And vice versa.

3.Headset

Press PTT key on headset to call and release to cancel call. There is voice prompt for lower battery when it is lower than 3.3V.

4.Private Call

Start private call by long pressing function key 2. Repress function key 2 to select member and talk by pressing PTT key. (Voice prompt for current group member name and its status of on-line/offline. It will be failed if off-line) Temporary group will be auto created.

5.Group Switch

Before switching ON, user needs to revolve the selector to Channel 1 (The default session is Channel 1, revolve to select other sessions. If the session is not available, there will be voice prompt: No Channel).

Status Indicators

LED Indicator	Working Status	Remark
Blinking Red	Low power less than 15%	Flash 3S/time
Blinking Green	Standby	Flash 5S/time
	Searching network	Flash 1S/time
Solid Red	The device is transmitting.	
	The device is charging.	
	The device is receiving.	
Solid Green	The device is powering on.	
	Fully charged	

Basic Troubleshooting

If your device shows following problem during operating, please check the instruction as below. If problems can't be solved, please contact local authorized service.

Problems	Solutions
Unable to Power On	The battery maybe incorrectly installed. - Re-attaching the battery.
	The battery maybe out of power. - Charge or replace the battery.
	The battery may be in poor contact due to dirty or damage. - Clean the electrical contact or replace it.
Buttons Not Working	The buttons may not work temporarily, restart the terminal.
	The buttons are broken, contact the dealer or our company.

Echo or Noise During Connecting	<p>The signal may be weak, make sure the terminal is within network coverage.</p> <p>- Restart the radio and it'll automatically search for better available network.</p> <p>The speaker may be covered, clean the speaker surface.</p>
Unable to Locate	<p>The signal is weak and the radio can't receive the signal.</p> <p>- Move to open and flat area and try again.</p> <p>The SIM card may be incorrectly installed.</p> <p>- Remove and re-insert the SIM card.</p> <p>The SIM card may be not working due to dirt or damage.</p> <p>- Clean the electrical contact or replace it.</p>
Poor Reception	<p>Localized poor coverage due to basement, blocking buildings or destructive interference, and geographical distance from obstacles between your device and the nearest cell tower.</p> <p>- Please move to somewhere with improved signal.</p> <p>Localized network is busy during rush hours.</p> <p>- Please wait for a while before another attempt or try to avoid using in rush hours.</p>
Unable to Charge	<p>The power adapter plug may be damaged or poor contacting.</p> <p>- Pull out and re-plug the adapter.</p> <p>The charging cable connectors may be damaged or poor contact.</p> <p>- Pull out and re-insert the cable.</p>
Less Duration	The duration mostly depends on network service provider settings.
Shorter Standby Time	<p>The battery life becomes shorter in high temperature environment.</p> <p>- Replace a new qualified battery.</p> <p>Power consumption increased in areas with weak signal.</p> <p>- Please temporarily turn off the device.</p>
Can't Connect to Network	<p>The SIM card cannot work properly or cannot be used.</p> <p>- Make sure the SIM card has a balance instead of arrears.</p> <p>The mobile network not available.</p> <p>- Select SIM card network, and contact the operator to activate the cellular network.</p> <p>In areas with poor signal, out of network service, or SIM card is not effective.</p> <p>- Remove the SIM cards, and reinsert them properly, or change another one. Move to somewhere with better network signal or go to the window if you are in the building.</p>

Specification

OS	Android Go
Frequency	GSM: B2/B5
	WCDMA: B2/B5
	FDD: /B2/B4/B5/B7/B12/B13/B66
Support	WIFI BT GPS/GLONASS/BDS(Three choose two)
CPU	MT6739 (1.5GHz 5 mode L+L/L+W DSDS)
Memory	1GB+ 8GB
Working Voltage	3.7V
Battery	4800 mAh
Dimension (H*W*D)	145*64*35mm (Without Antenna & Belt clip)
Weight	≈210g
Working Temperature	-20°C ~ 60°C
Storage Temperature	-40°C ~ 80°C