



## I. Features

- Energy Saving Patent Design.
- Built-in Rechargeable Lithium Battery Pack.
- It has automatic correction function for the displacement generated by braking.
- The built-in control parts of motor are sealed well for better safety.
- It's easy to switch the mode between inching and interlock and control operation direction.
- Electronic limits setting, 6 limits can be set (2 end limits and 4 middle limits).
- Short circuit protection & open circuit protection for sensor.
- Built-in low power Zigbee module and APP intelligent control function.

FCC COMPLIANCE STATEMENT: THIS DEVICE COMPLIES WITH PART 15 OF THE FCC RULES. OPERATION IS SUBJECTED TO THE FOLLOWING TWO CONDITIONS:

(1) this device may not cause harmful interference, and (2) this device must accept any interference received, including interference that may cause undesired operation. Changes or modifications not expressly approved by the party responsible for compliance could void your authority to operate the equipment. This equipment complies with FCC radiation exposure limits set forth for an uncontrolled environment. The distance between user and products should be no less than 20cm. This equipment has been tested and found to comply with the limits for a Class B digital device, pursuant to Part 15 of the FCC Rules. These limits are designed to provide reasonable protection against harmful interference in a residential installation. This equipment generates, uses and can radiate radio frequency energy and, if not installed and used in accordance with the instructions, may cause harmful interference to radio communications.

However, there is no guarantee that interference will not occur in a particular installation. If this equipment does cause harmful interference to radio or television reception, which can be determined by turning the equipment off and on, the user is encouraged to try to correct the interference by one or more of the following measures:

- Reorient or relocate the receiving antenna.
- Increase the separation between the equipment and receiver.
- Connect the equipment into an outlet on a circuit different from that to which the receiver is connected.
- Consult the dealer or an experienced radio/TV technician for help.

This device contains licence-exempt transmitter(s)/receiver(s) that comply with Innovation, Science and Economic Development (ISED) Canada's licence-exempt RSS(s). Operation is subject to the following two conditions: (1) this device may not cause interference, and (2) this device must accept any interference, including interference that may cause undesired operation of the device.

The device has been evaluated to meet general RF exposure requirement.

The distance between user and products should be no less than 20cm.

Cet appareil contient des émetteurs/récepteurs exemptés de licence qui sont conformes aux flux RSS exempts de licence du Canada pour l'innovation, la Science et le développement économique (ISDE). Le fonctionnement est soumis aux deux conditions suivantes: (1) ce dispositif ne peut pas causer d'interférence, et (2) ce dispositif doit accepter toute interférence, y compris les interférences pouvant causer un fonctionnement indésirable du dispositif.

L'appareil a été évalué pour répondre aux exigences générales d'exposition aux RF.

la distance entre l'utilisateur et les produits devraient être au moins 20 cm.

AM35-6/18-ES-E-Z



Inner tube dimensions: 35 mm

AM45-20/12-R-ES-EZ



Inner tube dimensions: 45 mm

## Operation Instruction

### 1. Power ON/OFF

\* After switching off power, the motor will not be able to receive remote signal.

#### Power ON



#### Power OFF



### 2. Programming Preparation

\* If there is no action in 10 seconds, the motor will exit programming automatically.

#### Method A



#### Method B



### 3. Pairing remote

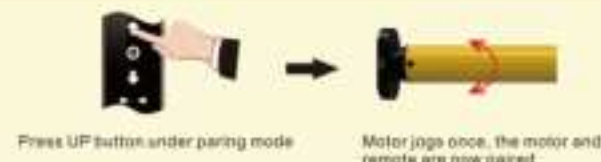

### 4. Change Direction

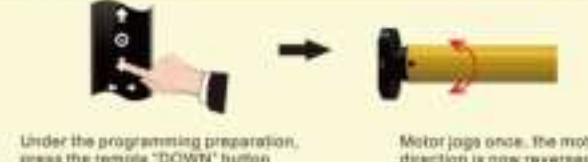

### 5. First limit position setting



### 6. Other limit position setting

\* If there's no any action within 30's, the motor will exit from limit position preparation automatically.



### 7. Limit position fine-tuning

