

装订成册 单页尺寸：140x210mm，材质：157g铜版纸覆哑膜

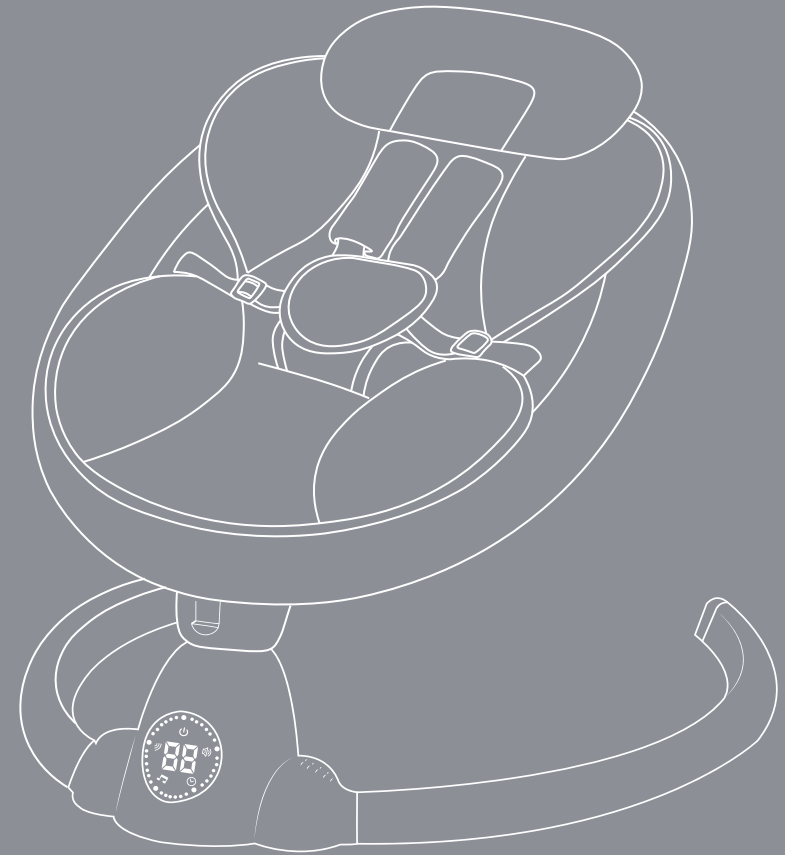

HB25
AUTO SWING CHAIR
USER MANUAL

Please read this manual carefully when using this product
and keep the manual for reference.

Product Contents

Product Introduction	2
Product Specification	2
Product Features	2
Parts Instruction	3
Installation	3
Install the base bracket	3
Assembling & Disassembling	4
For Pillow and Seat Pad	5
For Toy Bar with Toys	6
User Instruction	6
Button Description	6
Motion Lock	7
Seat disassembly	8
Safety Belt Instruction	8
Safety Belt Instruction	9
Remote Control	10
Power Supply	10
WARNING	11
Clean & Maintenance	12
Clean	12
Maintenance	12
Troubleshooting	12
WARNING	13
After-sales Service	14

Product Introduction

Product Specification

Product Name:	AUTO SWING CHAIR
Model Number:	HB25
Input Voltage:	100-240V
Output Voltage:	5V ---
Output Current:	1A
Frequency:	50/60HZ
Application:	Children up to a weight of 9kg .
Main Material:	100% polyester fiber, aviation aluminum base bracket

Product Features:

1. Swinging from side to side, with five gears mimicking human movement.
2. Power supplied by safe 5V low voltage adapter.
3. One-button installation and disassembly, simple and convenient to use.
4. Seat cover made of environmental-friendly super soft fabric and non-textile, cozy, breathable and safe removable and machine washable seat fabric.
5. Made of aluminum alloy base with light weight and strong hardness guaranteeing safety for baby.
6. Controlled by front panel or remote controller, easy to operate.
7. With motion lock and safety belt for protection.
8. With built-in soft nature sounds & Bluetooth enabled for music.

Parts Installation

Make sure that all of the following parts listed are included in the box. If any part is missing, please contact us before operating. No tools are required for assembly.

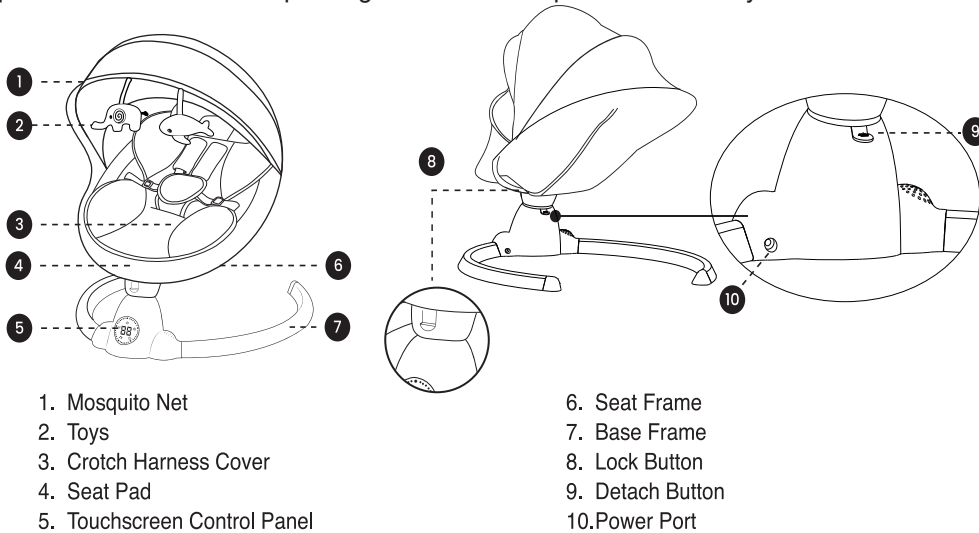

Installation

Assemble Instructions

Install the Base Bracket

1. Insert left and right tube into Base bracket, ensure that the foot tube is aligned with the screw hole of the main engine in the bottom.
2. Fix 4 screws into the foot tube.

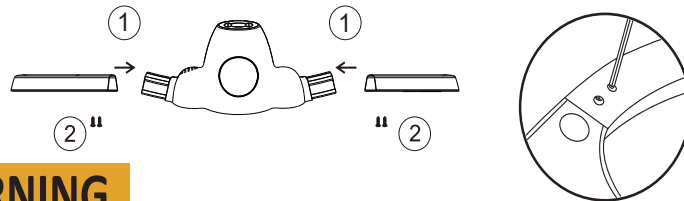

WARNING

Guardian should take good care of your child, prohibit to play accessories and avoid to get hurt or swallow !

Assembling & Disassembling

1. Install the seat frame. (Note: If one end cannot be fitted, reverse the direction and push hard)
2. Assembling: Put the frame in the base with “○” shape components aligned.

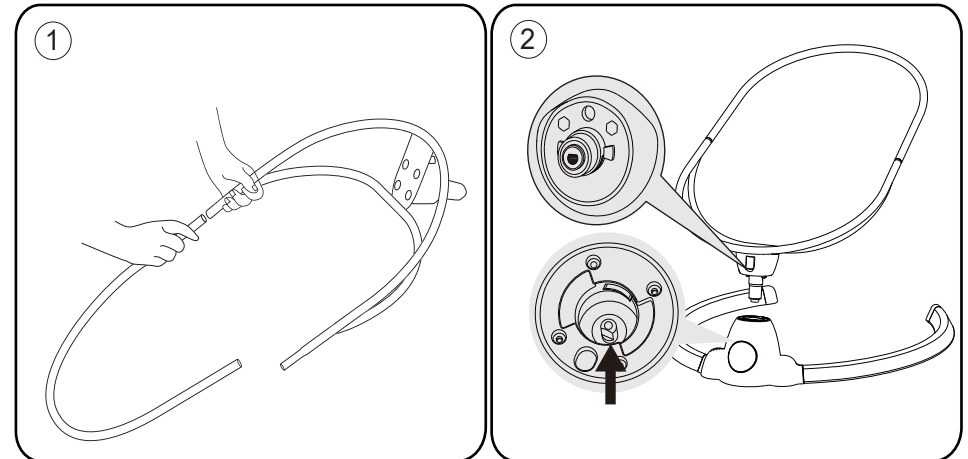

3. Wrap the seat cushion around the seat frame and secure the lock.

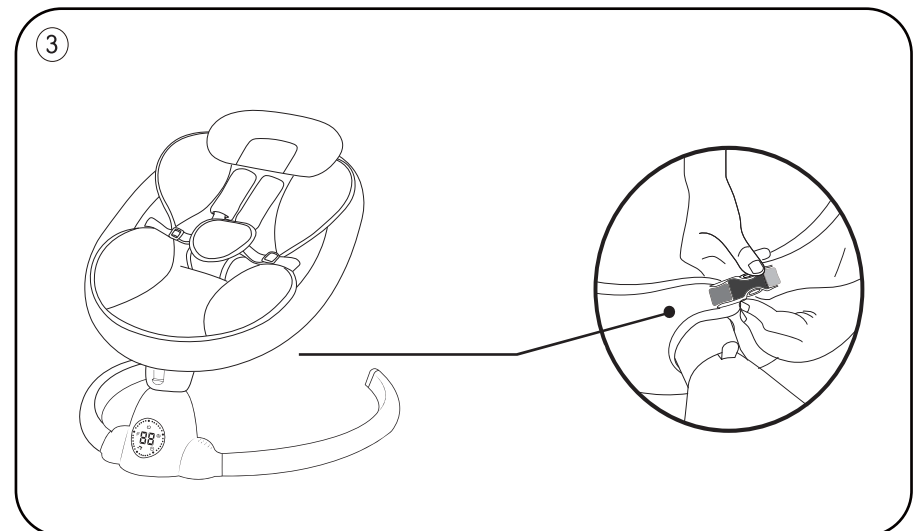

4.Disassembling: Press the sheet metal and pull up the seat frame.

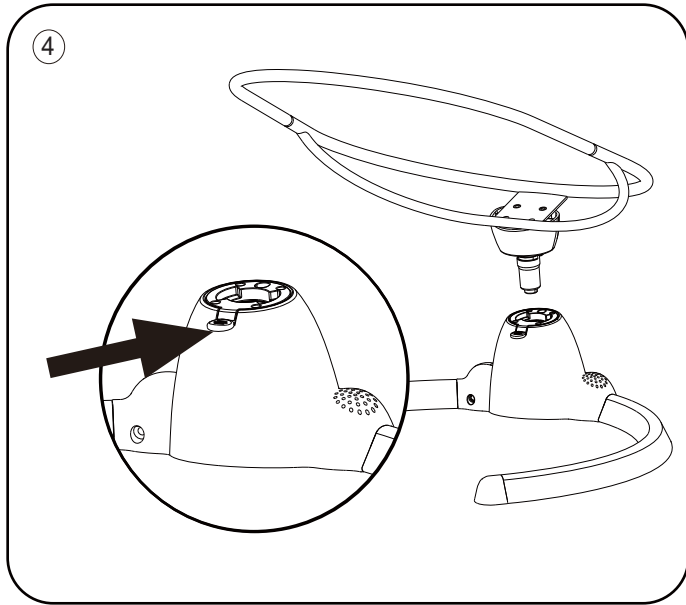

For Pillow and Seat Pad

Installation: Put the seat pad on the seat frame, pull the five-point seat belt across the pad and fasten the buckle.

Attach the pillow to the top retaining ring of the seat frame and fasten the velcro.

Removing: Pull off the velcro to detach the pillow and unfasten the five-point buckle by pressing the center button.

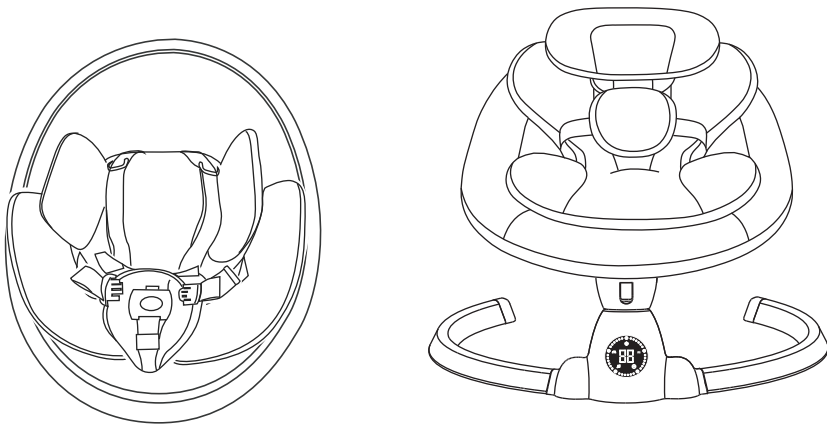

For Toy Bar with Toys



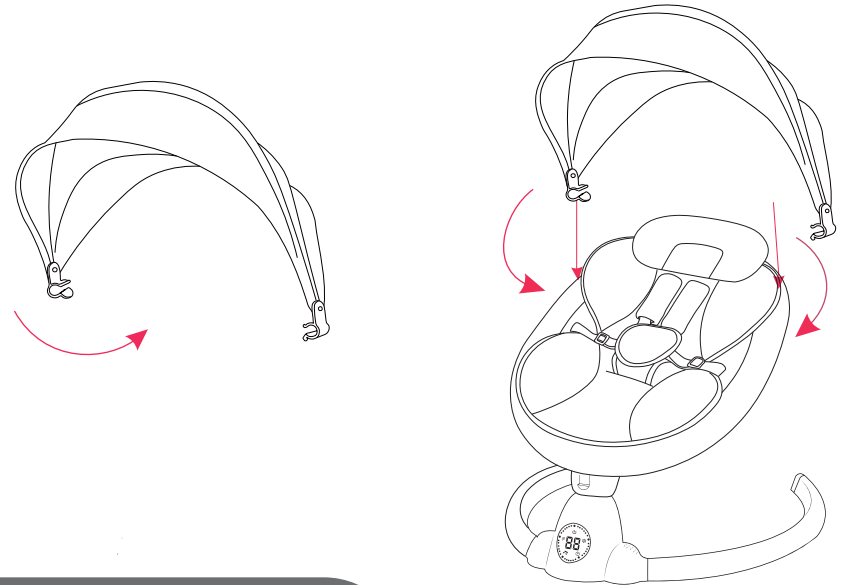

Please clamp the brackets on both sides when installing the mosquito net. Attach the toys on canopy and fasten the clasps to the pipe of the seat frame.

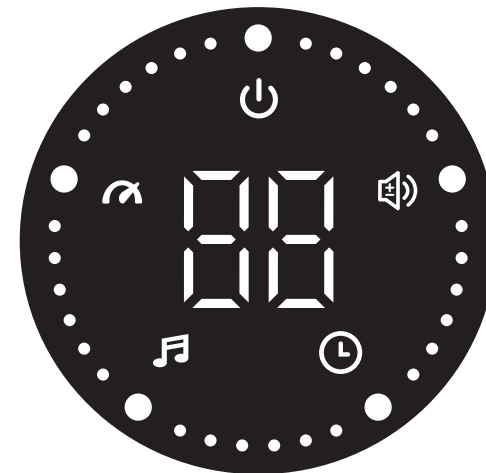

User Instruction

Button Description



-  **ON/OFF:** Touch this button and the indicator light is on.
Touch it again to turn the swing off.
-  **SWING:** Touch the button to make swing gear settings.
There are five swing gears indicated by digital light: 1-2-3-4-5.
-  **TIMER:** Touch the button to set the time.
The first touch will have the swing chair swing for 8 minutes,
the second touch will have it swing for 15 minutes, and the third
will have it swing for 30 minutes.
-  **MUSIC:** Touch the button to play the built-in music.
Click the next song.
Bluetooth music: After connecting, you can play music on your phone.
Click on the screen to switch to the next song.
Long Press: Play / Pause.
*Turn on the bluetooth on smart phone and connect with "HB25"
The swing beeps, and then bluetooth is now connected well.
Then the music from cellphone plays.
*Music priority: Bluetooth>Built-in music
-  **VOLUME+-:** Click: Volume Up (Three Gear Loop).

Motion Lock

Secure the seat in place by switching the lock position. Up is unlock, down is lock. Only for use while automatic swing mechanism is deactivated.

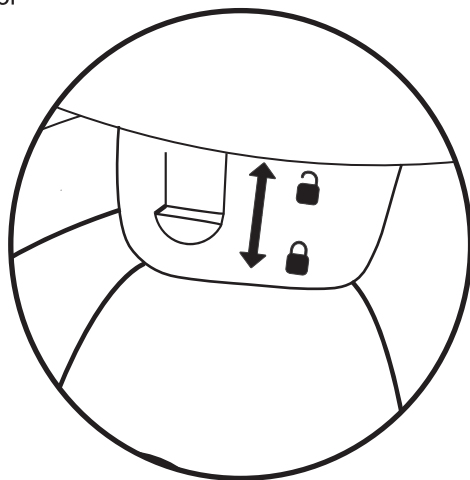

Seat disassembly

To detach the seat frame from the base, pull the detach button then pull out the seat frame.

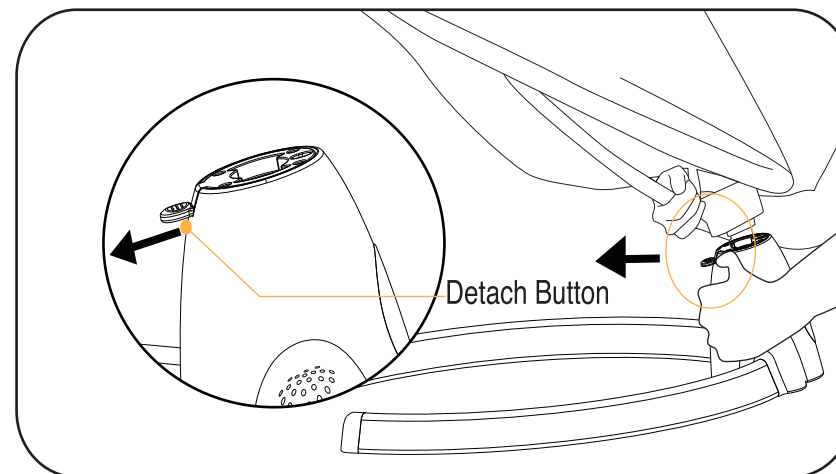

Safety Belt Instruction

Place the baby into the swing and let his arms across the shoulder straps and legs across both sides of crotch support restraint, insert five-point buckle, then turn the crotch support cover up and stick on Velcro.

When you need to take your baby out of swing, press the center button of five-point buckle to release the strap.

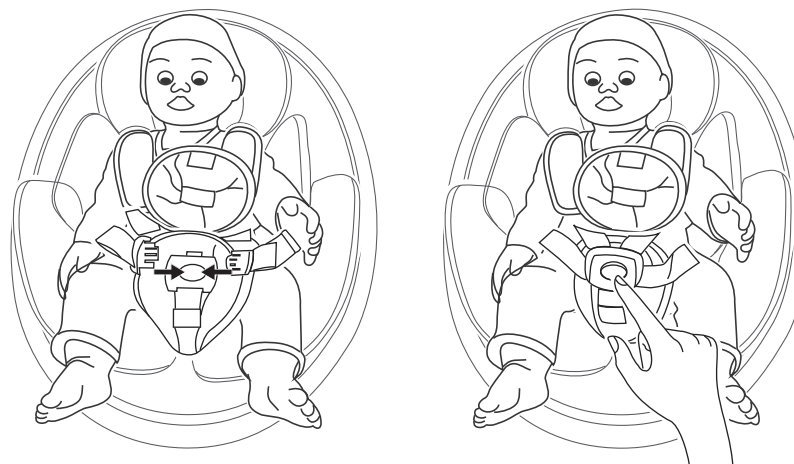

Note: Be sure to use the safety belt correctly when your baby lies on the baby swing and adjust the belt to proper length for the safety of your child.

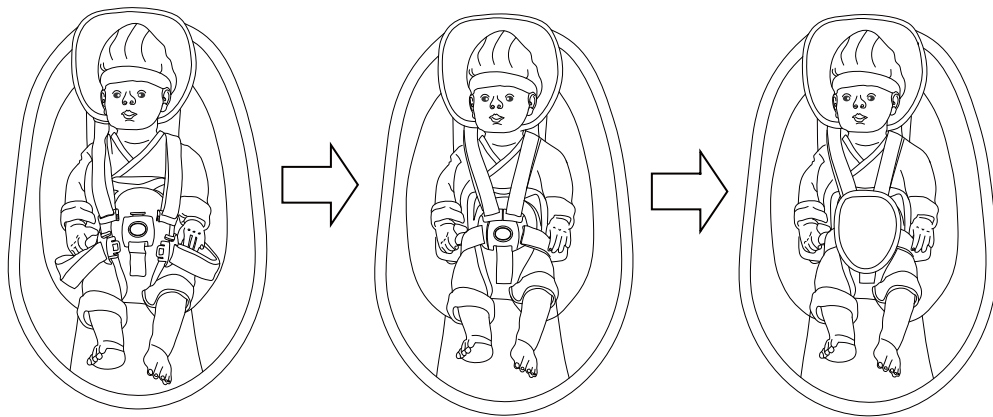

The belt goes through the top hole and then the bottom hole, fasten the belt. Baby sits into the swing chair, buckle up the seat belts.



Remote Control

To avoid using problems with the remote control, please aim it at the touch panel of the baby swing chair, and the best effective distance within 16.4 feet.

- | | | | |
|--|------------------|--|---------------|
| | Power on/off | | Play/pause |
| | Time setting | | Previous song |
| | Next song | | Next song |
| | Volume up | | Volume down |
| | | | |
| | Five swing grade | | |

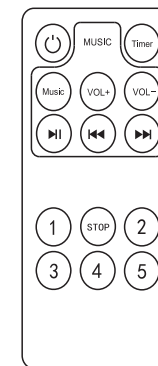

Power Supply

1. DC plug can be inserted into 100-240V~50/60Hz AC power supply.
2. Adapter output parameters: voltage is 5V and current is 1A.

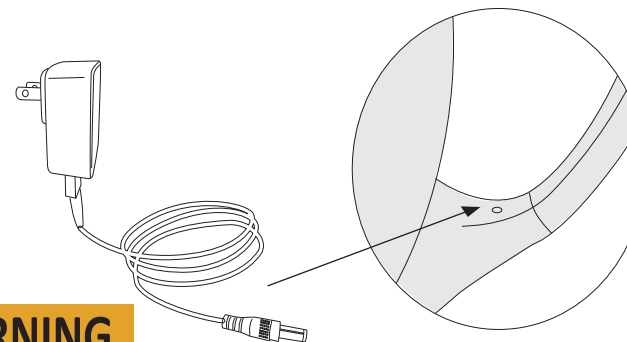

! WARNING

- The power terminals must not be short-circuited
 - Do not use adapters other than those supplied with this product to power the product.
 - Keep children away from working adapter.
 - Check the adapter cable connection regularly.
 - Overheating or fire keep the swing away from heat sources such as radiators stoves or other heat-producing appliances. Do not use extension cords with the AC adaptor. Do not use the swing near water (i.e.: bathtub sink, or laundry tub etc.)
- The product must only be used with the included AC adaptor. The AC adaptor is not a toy. Disconnect the AC adaptor from the swing before cleaning.

⚠ WARNING

- **FALL** and **STRANGULATION HAZARDS**: Infants have suffered head injuries falling from swings and have strangled in straps.
- **ALWAYS** use restraints. Adjust to fit snugly.
- **STOP** using product when infant attempts to climb out (approximately 9 months).
- **Stay** near and watch baby during use. This product is not safe for sleep or unsupervised use. If baby falls asleep, remove baby as soon as possible and place baby on a firm, flat sleep surface such as a crib or bassinet.
- **ALWAYS** place swing on floor. Never use on any elevated surface.
- **SUFFOCATION HAZARD**: Young infants have limited head and neck control. If the seat is too upright, infant's head can drop forward and compress the airway.
- **ALWAYS** keep swing seat fully reclined until infant is at least 4 months old AND can hold up head without help.
- **Never** leave the child unattended.
- **Do** not use this product once your child can sit up unaided or weighs more than 15 kg (20 lbs).
- **Do** not move or lift this product with the baby inside it.
- **When** the product is connected to a music player, ensure that the volume of the music player is set to a low value.
- **To** avoid injury ensure that children are kept away when unfolding and folding this product.
- **Do** not let children play with this product.
- **Transformers** used with the infant swing are to be regularly examined for damage to the cord, plug, enclosure and other parts, and in the event of such damage, they shall not be used.
- **The** infant swing shall only be used with the recommended transformer.



FCC Compliance Statement

This device complies with Part 15 of the FCC Rules. Operation is subject to the following two conditions:

- (1) this device may not cause harmful interference, and
- (2) this device must accept any interference received, including interference that may cause undesired operation.

Notes: This equipment has been tested and found to comply with the limits for a Class B digital device, pursuant to Part 15 of the FCC Rules. These limits are designed to provide reasonable protection against harmful interference in a residential installation.

This equipment generates, uses and can radiate radio frequency energy and, if not installed and used in accordance with the instructions, may cause harmful interference to radio communications. However, there is no guarantee that interference will not occur in a particular installation.

If this equipment does cause harmful interference to radio or television reception, which can be determined by turning the equipment off and on, the user is encouraged to try to correct the interference by one or more of the following measures:
Reorient or relocate the receiving antenna.

- Increase the separation between the equipment and receiver.
 - Connect the equipment into an outlet on a circuit different from that to which the receiver is connected.
 - Consult the dealer or an experienced radio/TV technician for help.
 - Caution: changes or modifications not expressly approved by the party responsible for compliance could void the user's authority to operate the equipment.
- This equipment complies with FCC radiation exposure limits set forth for an uncontrolled environment.
This transmitter must not be co-located or operating in conjunction with any other antenna or transmitter.

Clean & Maintenance

Clean

1. Clean the base bracket and seat frame with wet cloth and a mild detergent. Dry thoroughly then. Please do not use corrosive cleaner.
2. Removable and washable fabric.
 - **Seat fabric**: Clean it with wet cloth and a mild detergent, and dry it.
 - **Pillow**: Tear the Velcro off and take the pillow off. Put a little cleaner, wash it gently by hands, and then rinse it with clean water. Hang it avoiding sun exposure.
 - **Seat Pad**: Unbuckle the safety belt to remove, you can put it in the washing machine to clean.

Maintenance

1. Please check this baby swing regularly. Make sure of each part is well connected and well installed. Stop using for poor connection and connect/install it again if necessary.
2. This product contains electronic components, which shall not be used in water or in a humid environment. Please ensure the product is dry, and store it in a cool and dry place, avoiding direct sunshine for a long time.
3. To increase the life of the product, please unplug the power if the product is not used frequently.

Troubleshooting

Fast self-inspection solution below.

No.	Issue	Solution
1	Not energized	1. Check whether the adapter and DC cable are firmly connected. If loose, connect them firmly. 2. DC cable may be damaged. Please contact customer service to replace DC cable.
2	The power lamp keeps flashing/high voltage alarms	Use matchable adapter with an output voltage of 6V, 1A
3	Motion lock stuck	Check the motion lock. Pull it up to unlock the seat frame
4	Overstring/Strike	Power off and restart it again

Note: For other trouble, please contact our customer service for help.
Never disassemble and repair the swing by yourself.

! WARNING

- **INGESTION HAZARD:** This product contains a button cell or coin battery.
- **DEATH** or serious injury can occur if ingested.
- A swallowed button cell or coin battery can cause **internal Chemical Burns** in as little as **2 hours**.
- **KEEP** new and used batteries **OUT OF REACH of CHILDREN**
- **Seek immediate medical attention** if a battery is suspected to be swallowed or inserted inside any part of the body.



- Remove and immediately recycle or dispose of used batteries according to local regulations and keep away from children. Do NOT dispose of batteries in household trash or incinerate.
- Even used batteries may cause severe injury or death.
- Call a local poison control center for treatment information.
- This product contains a CR2025 ,DC 3V coin battery. A coin battery can cause serious internal chemical burns if swallowed.
- Non-rechargeable batteries are not to be recharged.
- Do not force discharge, recharge, disassemble, heat above 132°F(60°C) or incinerate. Doing so may result in injury due to venting, leakage or explosion resulting in chemical burns.
- Ensure the batteries are installed correctly according to polarity (+ and -).
- Do not mix old and new batteries, different brands or types of batteries, such as alkaline, carbon-zinc, or rechargeable batteries.
- Remove and immediately recycle or dispose of batteries from equipment not used for an extended period of time according to local regulations.
- Always completely secure the battery compartment. If the battery compartment does not close securely, stop using the product, remove the batteries, and keep them away from children.

After-sales Service

Thank you for purchasing our products. If there is any quality problem, please contact with the distributor.

Note:

1. From the purchase date, normal users can enjoy one year's free maintenance service for the circuit board components and one year's free maintenance service for the whole machine.
2. Other consumables and accessories are not covered by the warranty.

Non-warranty Coverage:

1. Improper use
2. Damage caused by natural disasters and other irresistible forces

Test Requested	Result
ASTM F2088-24	PASS
CPSC 16 CFR Part 1223	PASS
ASTM F963-23	PASS
For compliance with the test requirement of ASTM F963-23 Standard Consumer Safety Specification on Toy Safety.	PASS
ASTM F963-23 Standard Consumer Safety Specification for Toy Safety	PASS
For compliance with test requirement of the Physical & Mechanical, Flammability test requirement of Title 16, Code of Federal Regulations, Chapter II - Consumer Products Safety Commission of U.S.A (Except chargers & tools and controllers)	PASS
Physical and mechanical tests consisting US CPSC 16 CFR 1500.48. US CPSC 16 CFR 1500.49 and US CPSC 16 CFR 1501:	PASS



MADE IN CHINA