

## Four-Channel Wireless Digital Surveillance System

---

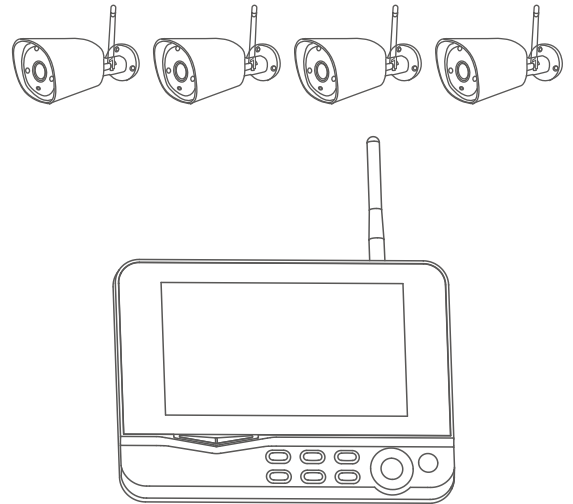

Made in China

Model: 8005BU

Version: 1.0

Thank you for your purchasing of our product. Please read the instructions carefully before use of the produc

Overview	02
Features	02
Packing List	02
Structure	03
Install and Connect	04-05
Operations	06-12
System Settings	13-17
Recording Settings	17
Alarm Settings	18
Attentions	18
Technical Parameters	19
FAQ	20
Troubleshooting	21

## ■ Overview

This product is a home surveillance video recording device. It consists of a camera installed in each of the home's entrances and exits and a receiver with its own 7-inch LCD display. The receiver can simultaneously access the monitoring images of 4 cameras at the same time. It has a human detection function, thus forming a set of home closed monitoring system.

## ■ Features

- The four-channel wireless camera recording system records 1080P real-time videos on all channels, clearer than traditional DVR;
- Each FHD camera captures incredibly clear images records every detail day and night;
- Playback of important evidence or interesting videos on four channels allows you to know actual development of the entire event;
- No wiring, easy installation, automatic pairing, plug and play, up to 20m night visibility;
- Support 4T1R for barrier-free transmission of 400 meters in open space, and support external 128G SD card for video storage;
- Support remote viewing on IOS/Android app and CMS computer client;
- A variety of recording modes are available: manual recording, scheduled recording and motion detection recording;
- 24/7 loop recording by four-channel 1920\*1080P full HD cameras, with rain protection (IP55);
- The receiver comes with a 7-inch matte LCD, allowing for 1024\*600 display, camera resolution 1920\*1080P;
- Software update for receiver and camera through a SD card inserted into the receiver

## ■ Packing List

- ① Camera x (1~4)
- ② 7-inch LCD monitor x 1
- ③ Micro USB to RJ45 adapter x 1
- ④ Network cable x 1
- ⑤ Camera power adapter x (1~4)
- ⑥ Receiver power adapter x1
- ⑦ SD card (optional) x 1
- ⑧ Monitor bracket (optional) x 1
- ⑨ Anchor x 7-16
- ⑩ Screw x 7-16



※ Pictures in the manual are for reference only. Please refer to the actual product.

## ■ Structure

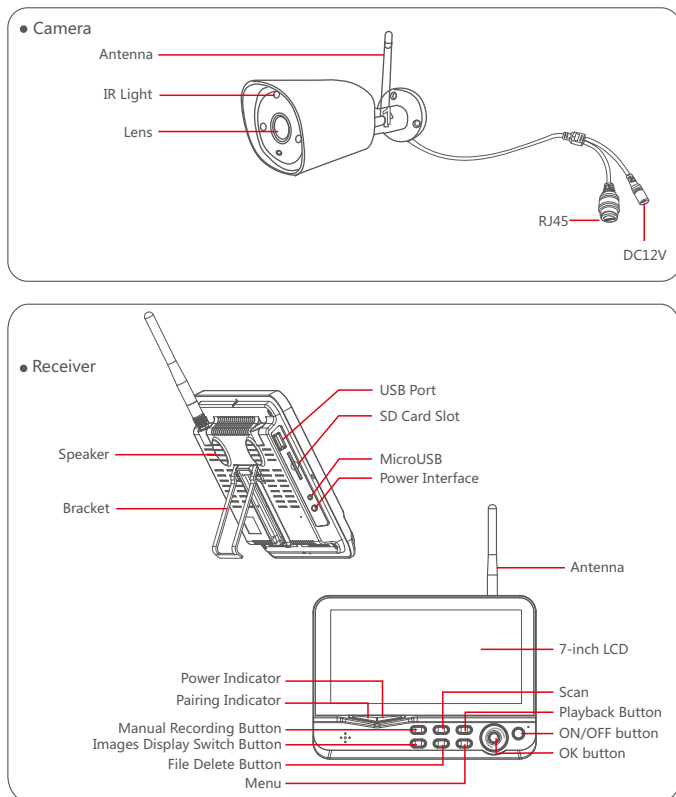

## ■ Install and Connect

1. Install the cameras in place for ideal monitoring and fasten with screws.

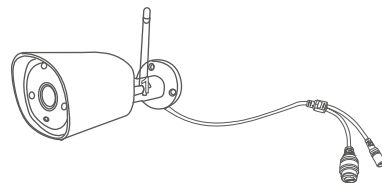

2. Install the receiver in place. The receiver comes with two types of brackets, so there are two ways to install it:

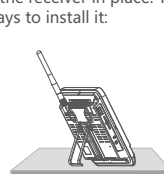

① Stand it on a flat surface



Fasten the bracket to the wall with screws and slide the receiver to snap onto the bracket.



② Mount it to wall (optional)

3. Insert the SD card.

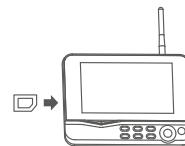

### ⚠ Notice

- ※ The SD card or external storage device does not allow hot swapping.
- ※ Maximum storage capacity is up to 128GB.
- ※ If the SD card to be used in this unit has already been used, format it first before use.
- ※ Please use an SD card with a card speed class of 4 or higher. Otherwise, it cannot be recognized.

## ■ Wireless Connection

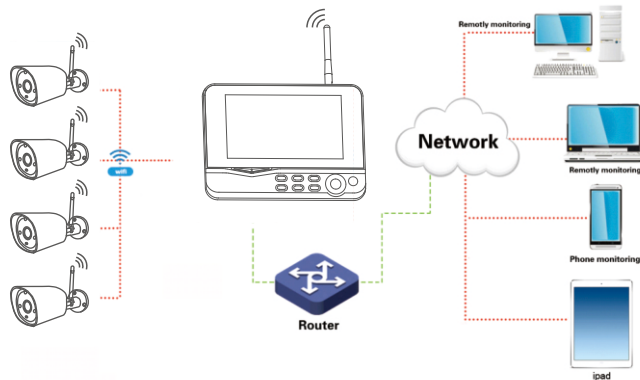

This method is used for Wireless connection. After connection, it can be operated on a Wireless or mobile phone.

### Notes:

1. In the effective range of wireless connection, the cameras can be connected to the receiver. If the distance is too far or there is an obstacle, wired connection is required.
2. The receiver cannot be connected to the router wirelessly. A network cable is required for their connection.

## ■ Operations

### • Basic Operations

1. Connect the camera to mains.



2. Connect the receiver to mains.

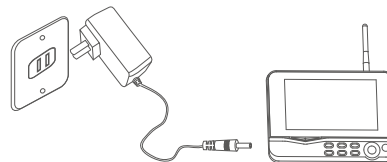

3. After Power on, the cameras and receiver will automatically start up, and then real-time monitoring screen appears as follows:

2013/11/15 09:30 Image display area	1	2013/11/15 09:30 Image display area	2
2013/11/15 09:30 Image display area	3	2013/11/15 09:30 Image display area	4

**Note:** The receiver can only connect up to 4 cameras; pairing has been completed by default at the factory. If they have not been paired, please complete pairing according to the description of "Pairing" on page 15.

## • CMS Client Download

1. Open the browser on PC and enter <http://www.goseeview.com> in the address bar to visit the official website of GOSCAM.
2. Go to "Services and Support" -> "Download Center" -> "Home Security" -> "NVR", download the "CMS Setup" and install it to your PC.

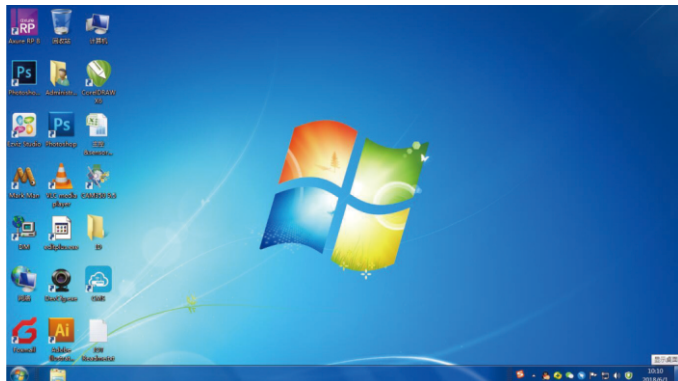

## • Mobile APP Download

You can use your mobile phone to scan the QR codes below, or search "Goseeview" in App Store or Google Play to download and Install the APP. Then, run the APP and take a few minutes to register an account.



Goseeview



Android



ios

## • CMS Client Operations

- **Login:** Double-click on the CMS app icon on the desktop to turn on the app and log in to the system; Initial ID is "admin" and there is no password.

User login

☐ Remember password
 ☐ Auto login

Login

Forget Password?

## • Add Device: ( Select 1 of the 3 methods)

1. After login, click "Device Management" at the bottom of the screen. Connect LAN Cable, the system will automatically search for devices. Tick the camera to be added by adding a mark "✓" in the "☐" and click "Add".

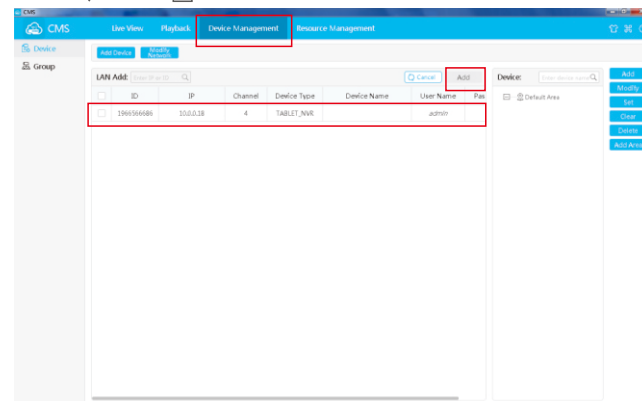

2. After login, click "Add" in the upper right corner of the screen to bring up a dialog box (as shown below). Select "IP/DDNS", enter the IP address of the receiver in the IP/DDNS field (the IP address of the receiver can be acquired in the "System Settings" — Wired Network") and select "NVR" in the Type field. Then, click "Finish".

**Note:** 1. The IP address of the receiver is valid only when it is connected to the network and open automatic access is opened.

2. If the adding fails, try replacing the port number, which is optional for "80、10000".

3. After login, click "Add" in the upper right corner of the screen to bring up a dialog box (as shown below). Select "Cloud ID", and enter the ID number of the receiver in the Cloud ID field (the ID number of the receiver is the last 10 digits found in "System Settings—System Information" - "UID"). Then, click "Finish".

**Note:** In the three methods as described above for device adding, after the device is added, you need to return to the "Device List" in the upper right corner of the home page to double-click or right-click "Connect Video".

### • Delete Device:

1. After login, click "Device Management" at the bottom of the screen, and select the device you want to delete in the upper right of the screen. Then, click "Delete" on the right and click "OK" in the pop-up dialog.

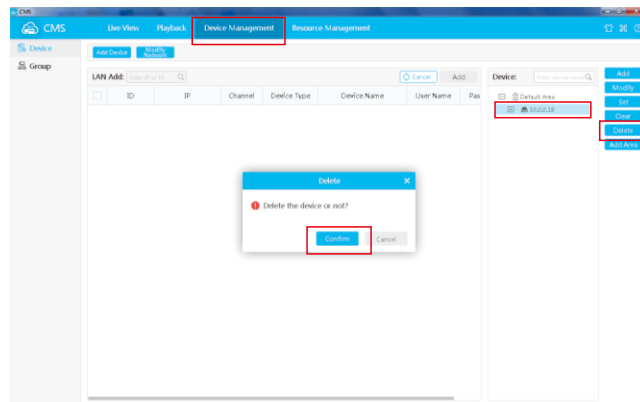

### • Mobile APP Operations

#### • Add Device: ( Select 1 of the 2 methods)

1. After registration, check the "Device Connected to Internet" on the screen, and enter the ID number of the receiver in the "Cloud ID" field (the ID number of the receiver is last 10 digits found in "System Settings—System Information" - "UID"). Then, click "Save".

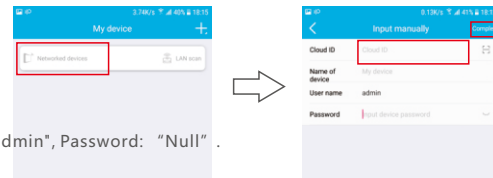

**Note:** ID: "admin", Password: "Null".

2. After registration and login, click “LAN Scan” on the screen. In the LAN state, the system will automatically search for the device. Once a search result appears, click the device you want to add.



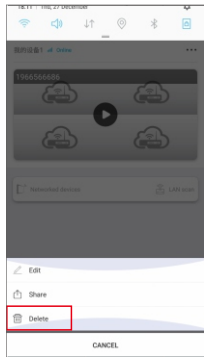

● **Delete Device:**

1. After login, select the device you want to delete and click “●●●” in the upper right of the screen. Then, click “Delete” .

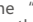

● **Receiver Operations**

● **Manual Recording:**

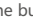
1. In the real-time monitoring state, press the “◀” or “▶” button to select the camera that needs to record video as the current camera;
2. Press the “Recording/Stop Recording” button  on the device, and an icon  appears on the display to indicate that video recording starts.
3. Press the button  again to stop recording.

**Note:** When the video file reaches 8MB in size, the system automatically packs a file. The system is able to conduct multi-channel recording simultaneously (up to 4 channels), and the videos recorded on each channel are saved in a separate video folder.

● **Scheduled Recording:**

As the user sets start and end time in the “Record Setup” menu, the device will automatically conduct video recording according to the set time and type. The specific steps are as follows:

1. Press MENU on the device to enter the menu interface;
2. Press the “◀” or “▶” button to select “Recording Settings” and press OK to enter the interface;
3. Select “Record Setup” and press OK to enter the interface;
4. Press the “▲” or “▼” button to select “Schedule 1-4” , press OK to enter, and set the start and end time:

Record Setup	
Enable	<input checked="" type="checkbox"/>
Channel	1.2.3.4
Weekday	***
Type	Motion,Timer
Time	00 : 00 ~ 23 : 59
OK : Select                      MENU : Back	

Press the “▲” or “▼” button to select the setting item;  
Press the “◀” or “▶” button to set;  
Press OK button to confirm and exit.

5. After setting of various items, the device will automatically conduct video recording according to the set start and end time and type.

● **Video Playback:**

1. In the real-time monitoring state, press the playback button  on the device to enter the video playback interface;
2. Press the “▲” or “▼” button on the device to select (Channel-Date-Time period) the video to be played back, and press OK to play;
3. Press the “◀” or “▶” button to play fast backward and fast forward, press the “▲” or “▼” button to adjust the volume, and press OK again to pause;
4. Press MENU to exit the playback mode.

## ● Motion Detection Recording:

When an object moves within the angle of view of any one of the cameras connected, the device can be triggered for recording. The specific steps are as follows:

1. Press MENU on the device to enter the settings interface.
2. Press the “◀” or “▶” button to select “Alarm Settings” and press OK to enter;
3. Press the “▲” or “▼” button to select the channel to be set in “Channel 1-4”, and press OK to enter;
4. Press the “▲” or “▼” button to select “Motion” and press OK to turn it on (this function is enabled by default);
5. Press the “▲” or “▼” button to select “Mobile APP Alarm” and press OK to turn it on (this function is valid only when the device is connected to the internet and the device has been added in the mobile APP);
6. Press the “▲” or “▼” button to select “Alarm” and press OK to turn it on (this function is enabled by default);
7. Press MENU to go back when the steps have been finished.

## ■ System Settings

1. In the real-time monitoring state, press the “MENU” button on the device to enter the main menu interface;
2. Press the “◀” or “▶” button to select “System Settings”, and press OK to enter the system settings interface;
3. Press the “▲” or “▼” button to select an item and press OK to enter the corresponding settings interface.

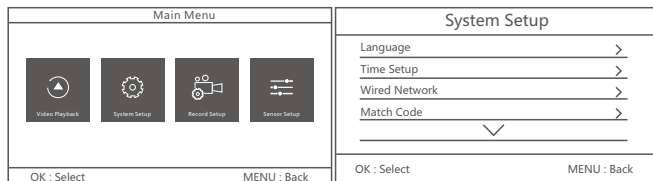

Main Menu Interface

System Settings Interface

System Settings Items	Functions
Language	Set system language;
Time Setup	Set system time and date;
Wired network	Turn on or off “Automatically”; enter network parameters manually; suggest to turn on “Automatically” to get the network parameters.
Match Code	Add/remove camera;
Wireless hotspot	The wireless SSID and password for point-to-point connection between the camera and receiver cannot be set; appropriate regional frequency band can be selected according to different regions;
System info	View system information;
Upgrade	Receiver system upgrade;
Factory settings	Whether or not to restore default settings;
Volume	Adjust the volume;
IPC upgrade	Camera upgrade;

## ● Language Settings

1. Press MENU on the device to enter the menu interface;
2. Press OK to enter the language settings interface;
3. Press the “▲” or “▼” button to select an appropriate language, and press OK to confirm and exit.

## ● Time Settings

1. Press MENU on the device to enter the menu interface;
2. Press OK to enter the time settings interface;
3. If the device has been connected to the Internet, enable the “Time Sync” function;
4. You can also make manual settings. Press the “▲” or “▼” button to select “Time Settings” option and press OK to enter the time settings interface.

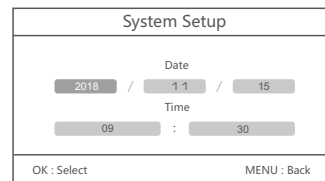

Press the “◀” or “▶” button to select the change item;  
Press OK to confirm;  
Press the “▲” or “▼” button to change;  
Press MENU button to exit the time and date settings interface.



## ● Wired Network Settings

1. Press MENU on the device to enter the menu interface;
2. Press OK to enter the wired network settings interface.
3. Select "Obtain an IP address automatically" and press OK to turn it on. Then, the device will automatically obtain a network IP address; or the IP address can be entered manually.

## ● Add by Pairing Settings

1. After the receiver and camera are powered on, the camera is connected to the receiver by a network cable;
2. Press MENU on the device to enter the menu interface;

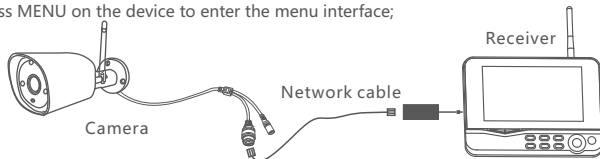

3. Press OK to enter the Match Code Settings interface;
4. After connecting the camera to the receiver by a network cable, press the "▲" or "▼" button to select "Match Code" and press OK to confirm;
5. Press the "▲" or "▼" button to select the "x" on the right side, and press OK to delete the paired camera.
6. After a paired camera has been deleted, if you want to re-pair, just turn on the camera and keep it within an effective range of wireless connection, and then you can complete pairing with no need of a network cable (if you want to avoid pairing again, please turn off the camera);

System Setup				
Camera-1	Matched	0xe01f0008		X
Camera-2	Matched	0xe01f0007		X
Camera-3	Matched	0xe01f0006		X
Camera-4	Matched	0xe01f0005		X
Match Code				
OK : Select		MENU : Back		

## ● Wireless Hotspot Settings

1. Press MENU on the device to enter the menu interface, and press OK to enter the wireless hotspot settings interface;
2. Press the "▲" or "▼" button to select the appropriate "Area and Wireless Channel" , press OK to confirm and exit.

**Note:** This feature is only used for wireless connections between the "Receiver and Camera" .

## ● System Information Settings

1. Press MENU on the device to enter the menu interface, and press OK to enter the system information settings interface;
2. Press MENU to exit.

## ● Upgrade Settings(For Monitor)

1. Press MENU on the device to enter the menu interface, and press OK to enter the upgrade settings interface. Select "Local Upgrade" and press MENU to exit.

**Note:** The upgrade program needs to be downloaded to the storage device and upgraded via USB interface or SD card. Online upgrade is not supported.

## ● Factory Settings

Press MENU on the device to enter the menu interface, and press OK to enter the factory settings interface.

1. **Simple restore:** ignore channel and network configuration
2. **Restore all:** restore all configurations

## ● Volume Output Settings

1. Press MENU on the device to enter the menu interface, and press OK to enter the wireless hotspot settings interface;
2. Press the "▲" or "▼" button to select an appropriate volume (0-4), and press OK to confirm and exit (in the real-time monitoring state, press the "▲" or "▼" button to adjust the volume).

**Note:** The defaulted volume is (2)

## ● IPC Upgrade Settings (For Camera)

1. Press OK to enter the IPC upgrade settings interface.
2. Press the "▲" or "▼" button to select the channel to be upgraded. It is recommended to enable "Allow Downgrade" .
3. Press the "▲" or "▼" button to select "Start" and press OK to confirm.

**Note:** The upgrade program needs to be downloaded to the storage device and upgraded via USB interface or SD card. Online upgrade is not supported.

System Setup	
Info	>
Channel	1
Source	Local Upgrade
Allow Downgrade	<input checked="" type="checkbox"/>
Start	
OK : Select MENU : Back	

## ■ Recording Settings

1. In the real-time monitoring state, press the "MENU" button on the device to enter the main menu interface;
2. Press the "◀" or "▶" button to select "Recording Settings" and press OK to enter the recording settings interface;
3. Press the "▲" or "▼" button to select an item and press OK to enter the settings interface.

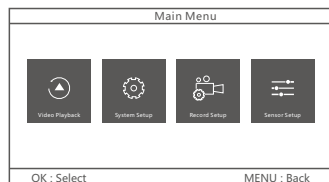

Main Menu Interface

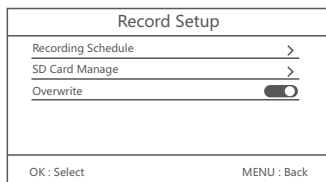

Recording Settings Interface

### ● Recording Schedule Settings

1. Press OK to enter the recording schedule settings interface;
2. Press the "▲" or "▼" button to select the set schedule (1-4), and press OK to confirm and enter;
3. For details, please refer to "Scheduled Recording" (page 13).

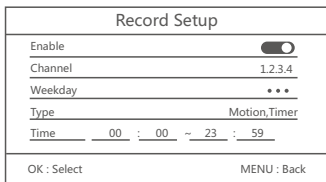
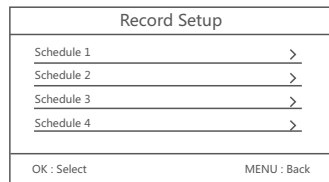

### ● SD Card Management Settings

1. Press OK to enter the SD card management settings interface;
2. This function allows you to view the capacity usage of the SD card and "format" the SD card.

## ■ Alarm Settings

1. In the real-time monitoring state, press the "MENU" button on the device to enter the main menu interface;
2. Press the "◀" or "▶" button to select "Alarm Settings", press OK to enter the alarm setting interface;
3. Press the "▲" or "▼" button to select the channel to be modified (1-4), press OK to enter the setting interface;

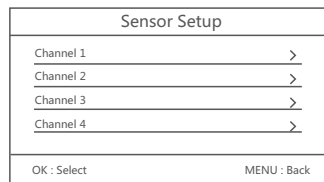

Alarm Settings Menu

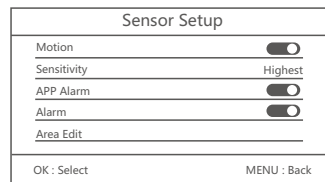

Alarm Settings Menu

4. Select whether to turn on the "Motion, Mobile APP, Alarm (Receiver gives an alarm sound)" alarm.

## ■ Attentions

- Do not place the device at a position where it is easy to fall down or in a place where liquid may easily splash into it.
- When not in use, turn off the camera/monitor.
- The power of this product can be completely turned off only after the power adapter has been unplugged.

## ■ Technical Parameters

Items	Parameters
<b>Cameras</b>	
Image sensor	1/2.9" CMOS
Video pixels	1920 x 1080P
Horizontal viewing angle	H : 85°
Night vision distance	20m (Max.)
IP rating	IP55
Interface	DC JACK ( $\phi$ 5.5mm ) RJ45
Operating voltage	DC 12V/1A
Operating temperature	-10°C~50°C
Operating humidity	15~85%RH
Dimensions (length X width X height)	176x47x46(mm) (without bracket)
<b>Monitor</b>	
Display	7" TFT LCD
Display resolution	1024 x 600
SD card capacity	Up to 128GB
Interfaces	USB 2.0, DC JACK ( $\phi$ 3.5mm ) MicroUSB, SD card
Storage video resolution	1920 x 1080P
Storage format	H.265
Data output	USB 2.0
Operating Voltage	DC 5V
Operating temperature	0°C~40°C
Operating humidity	15~85%RH
Dimensions (length X width X height)	214x26x157 (mm)
<b>RF Characteristics</b>	
Unobstructed transmission distance	400m (4T1R)

※All parameters are subject to minor changes without prior notice.

## ■ FAQ

- Q: Why can't the monitoring images be displayed on the screen after the camera is connected?  
A: 1. Please check if the antennas of camera and receiver are installed or configured in place.  
2. Please check if screen display of the receiver is turned on.  
3. Please check if pairing is successful.
- Q: The recording time has been set or the motion detection recording enabled. When the time arrives or a motion is detected, why is video recording not started?  
A: 1. Please check if a storage card has been inserted.  
2. Please check if the storage medium works.  
3. Hot swapping of storage medium is not supported. So, check if the problem is caused by hot swapping; if it is, please power off the receiver and then power it on again.  
4. Please check if the storage medium is full. If it is full, the automatic override function should be enabled. Check if the function is enabled ( in recording setting).
- Q: When an external HDD is connected via the USB port, why cannot it be recognized?  
A: Currently, the device does not support connection of a mobile HDD for storage.
- Q: When an ID number is entered in the APP to add receiver, adding fails?  
A: Please check the format of the ID number you have entered. A correct ID number is the last 10 digits of the UID number.
- Q: The alarm volume from the motion detection receiver is too large, how to adjust?  
A: In the real-time preview interface, click the "Up" and "Down" arrow buttons to adjust the alarm volume.

## ■ Troubleshooting

Problems	Solutions
LCD does not display monitoring images	Please check if the cameras are turned on.
	Check if the cameras have been "paired".
No videos	Check if the storage medium has been inserted; hot swapping of storage medium is not supported. So, check if the problem is caused by hot swapping.
	Check if the storage medium is full and if the automatic override function is enabled.
	SD card connection failed; it is recommended to use brand SD card, such as Kingston, SanDisk, Panasonic, Kingmax, etc.
	An external mobile HDD is not supported. Please check if it is an external HDD that results in no videos.
Poor image quality	Check if there is interference, such as WIFI interference or interference from other wireless devices.
	Check if the antennas of the cameras and the monitor are installed.

### EU Environmental Protection

Waste electrical products should not be disposed of with household waste. Please recycle where facilities exist. Check with your local authority or retailer for recycling advice.



## ■ FCC Certification Info

Note: This equipment has been tested and found to comply with the limits for a Class B digital device, pursuant to part 15 of the FCC Rules. These limits are designed to provide reasonable protection against harmful interference in a residential installation. This equipment generates, uses and can radiate radio frequency energy and, if not installed and used in accordance with the instructions, may cause harmful interference to radio communications. However, there is no guarantee that interference will not occur in a particular installation. If this equipment does cause harmful interference to radio or television reception, which can be determined by turning the equipment off and on, the user is encouraged to try to correct the interference by one or more of the following measures:

- Reorient or relocate the receiving antenna.
  - Increase the separation between the equipment and receiver.
  - Connect the equipment into an outlet on a circuit different from that to which the receiver is connected.
  - Consult the dealer or an experienced radio/TV technician for help.
- Changes or modifications not expressly approved by the party responsible for compliance could void the user's authority to operate the equipment. This device complies with Part 15 of the FCC Rules. Operation is subject to the following two conditions:

(1) this device may not cause harmful interference, and (2) this device must accept any interference received, including interference that may cause undesired operation.

RF exposure warning :

This equipment complies with FCC radiation exposure limits set forth for an uncontrolled environment. This equipment shall be installed and operated with minimum distance 20cm between the radiator & body.

This device is acting as slave and operating in the 2.4 GHz (2412 ~ 2462 MHz) band.

Ad Hoc function is supported but not able to operate on non-US frequencies.

Do not use the device with the environment which below minimum -30 °C or maximum over 50 °C .

Hereby, we declares that this device is in compliance with the essential requirements and other relevant provisions of Directive 2014/53/EU.

Notice: Observe the national local regulations in the location where the device is to be used.

This device may be restricted for use in some or all member states of the European Union (EU).