

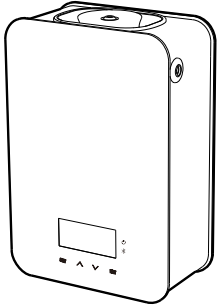

其他备注:

50301-00755

User Manual



APP download



Android system

IOS system

If the QR code cannot be scanned, please search for "Scent Marketing" in Google play or APP store.



02 APP operation

Where to get the app:  
Please search "scent marketing" in Google play or App store.

Note:  
1. Please make sure that the Bluetooth function is turned on;  
2. Please make sure that the location function of the mobile phone is turned on.

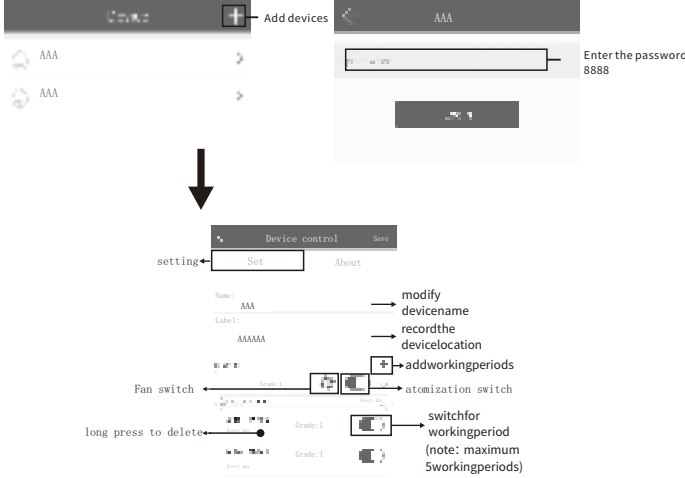

03 Working Periods Setting

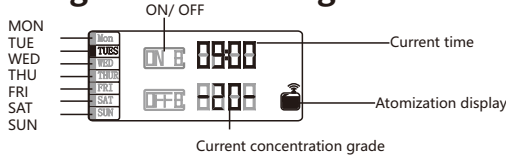

Turn on the power  
Connect the power and turn on the switch with a sound "Beep" coming out, then the screen shows the initial time and the current grade.

Turn off the power  
The screen will be off when turn off the switch and disconnect the power.

Fan control  
Long press and hold ▲ for 3 seconds to turn on the fan, then long press and hold ▼ for 3 seconds to turn off the fan.

Screen lock or unlock  
Screen lock: If there is no any operation in 60s, the screen will be locked automatically.  
Unlock: Tap the SET button and hold for 3 seconds, the screen will be unlock, and screen is lit up.

Current time setting  
1. Tap SET button and hold for 3 seconds until the "beep" sound coming out, you can start to set the working periods.  
2. Tap ▲ or ▼ to select the current working day, then tap ENT to start to set the current time, Tap ▲ or ▼ to adjust the current time, then tap SET to save the setting.  
(show as picture 1)

Concentration Grade setting  
There are 9 grades available. Tap ▲ button to increase the scent concentration. Tap ▼, to decrease the scent concentration. (Shown as picture 2)

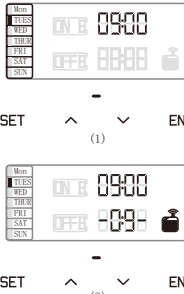

01 Product Overview

Atomizer head

Bottle

DC port

Screws

Lock

LED Screen

bracket

EVA pad

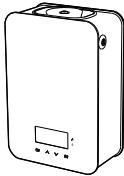

Product Parameters

【 Dimension 】: 255\*175\*89

【 Bottle capacity 】: 180ml

【 Coverage 】: 100m²

【 Material 】: Glass/430 stainless steel/PP/POM/PET/Aluminium alloy

【 N.W. 】: 1880g

【 Power 】: 5.5W

【 Input voltage 】: DC12V

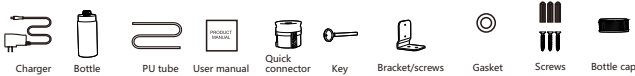

Change Password

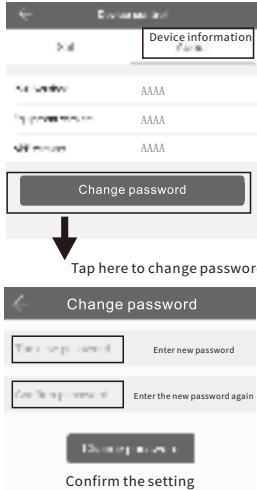

Tap here to change password

Change password

Enter new password

Enter the new password again

Confirm the setting

Working periods setting

1. There are total 5 working periods available (show as picture 3).

2. Tap SET to start setting the first working period, and the working time will be flashing on the screen.

3. Tap ▲ or ▼ to adjust the working time, then confirm by tapping ENT.

4. Tap ENT can turn to the next setting (order: the switch of the current working periods → start/stop working time → grades → working day → the next working period), then you can tap ▲ or ▼ to adjust the current setting. (show as picture 5).

The start working time can not be same with the stop working time, otherwise this working periods will not be displayed on APP.

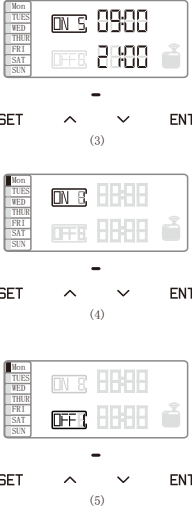

Day	00:00 - 00:00	00:00 - 00:00	00:00 - 00:00	00:00 - 00:00	00:00 - 00:00
Mon	ON/OFF	ON/OFF	ON/OFF	ON/OFF	ON/OFF
Tue	ON/OFF	ON/OFF	ON/OFF	ON/OFF	ON/OFF
Wed	ON/OFF	ON/OFF	ON/OFF	ON/OFF	ON/OFF
Thu	ON/OFF	ON/OFF	ON/OFF	ON/OFF	ON/OFF
Fri	ON/OFF	ON/OFF	ON/OFF	ON/OFF	ON/OFF
Sat	ON/OFF	ON/OFF	ON/OFF	ON/OFF	ON/OFF
Sun	ON/OFF	ON/OFF	ON/OFF	ON/OFF	ON/OFF

(PS: The first working period is factory defaults with start working time 07:00 and stop working time 19:00, others are all with 00:00.)

第1页 共2页

04 Operation Step

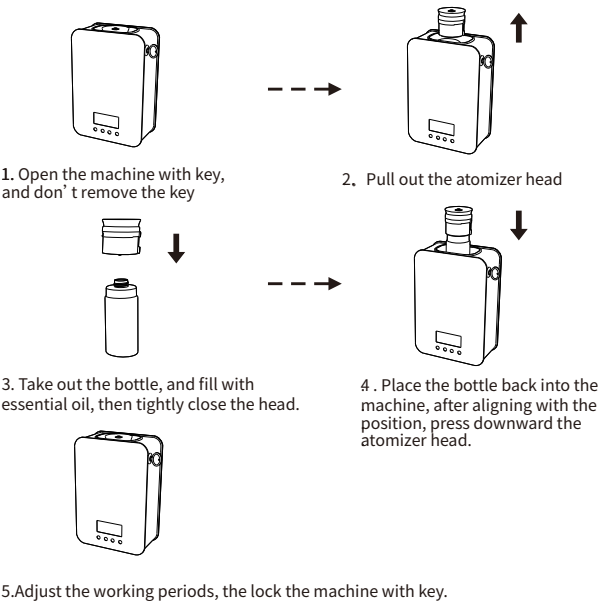

06 installation Guide

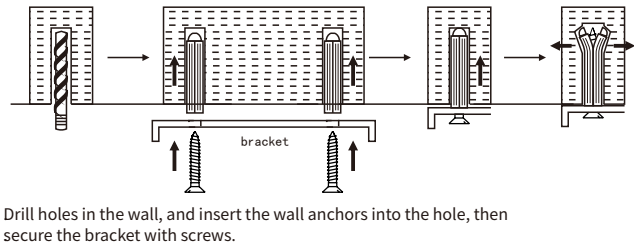

installation Step

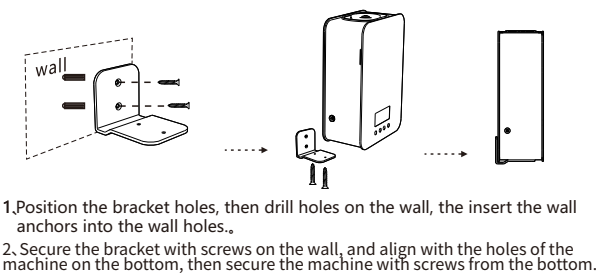

08 Cautions

- 1. Please always keep the machine upright, tilting or placing it flat will cause oil leakage, which will lead to machine damage.
  - 2.Shall not modify, disassemble or repair the machine arbitrarily. Any failure happens, please contact our relevant technicians in time.
  - 3.The machine will not work when it is not in the working periods, even the atomization icon is displayed on the screen.
  - 4.When the screen is in lock status, the button cannot be operated and there is no display on the screen.
  - 5.If the display is garbled, breakdown or other problems, please restart the machine.
- Restore factory setting**  
(Step: Tap the ENT button and hold about 5 seconds until the "beep" sound coming out.)

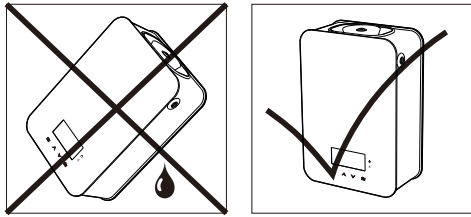

05 Grades and Consumption

Grades	Working time(s)	Stop time(s)	Consumption(g/h)
G1	3S	60S	0.067g/h
G2	7S	60S	0.171g/h
G3	11S	60S	0.257g/h
G4	15S	60S	0.386g/h
G5	19S	60S	0.449g/h
G6	23S	60S	0.532g/h
G7	27S	60S	0.606g/h
G8	31S	60S	0.706g/h
G9	35S	60S	0.716g/h
Customized	Working 3~60s, stop 60s		

▲Increase the grade ▼Decrease the grade  
Note: The data shown above is only for reference, and it is normal for the consumption to fluctuate by 15%.

07 Warning

- To avoid the fire or electric shock, please do not damage, force to bend,yank or heavy load, cut or reprocess the power cable.
- To avoid electric shock, short circuit, fire or other damages.
  - When the power cable is damaged or isn't match with the electrical outlet, please do not use AC power plug.
  - Do not wet the machine or the plug;
  - Shall not use the overloaded power socket, or the broken plug.
- To avoid electric shock, please do not touch the wire and the machine thundering or/and .lightening.
- To avoid any problems, please do not disassembly the machine when machine is working.

09 Trouble shooting

Before ask for after-sale service, please try to handle the following problems based on the solutions.

Problems	Solutions
Do not diffuse	-To check whether the machine switch is turned on. - The air pump may be damaged,please replace a new one. -The air tube on atomizer head may be loose, please tighten it
Weak mist	-The atomized core may be blocked,please clean with alcohol or replace a new one. -To check whether the gasket is damaged or loose, please replace a new one. -To check whether the tube is loose or not, please tighten it.
Oil sprinkle	-To check the machine is tilted or laid down, please keep the machine upright.
Oil leakage	-The bottle cap may be loose, please secure the cap. -The gasket of the atomizer head is damaged or missed.
Abnormal noise	-The air pump may be loose, please tighten it. -The air pump may be damaged, please replace with a new one.

签字受控:

展开尺寸:210\*297mm  
材质:铜版纸150克  
工艺:双面印刷, 过哑膜

#### FCC STATEMENT :

This device complies with Part 15 of the FCC Rules. Operation is subject to the following two conditions:

(1) This device may not cause harmful interference, and

(2) This device must accept any interference received, including interference that may cause undesired operation.

Warning: Changes or modifications not expressly approved by the party responsible for compliance could void the user's authority to operate the equipment.

NOTE: This equipment has been tested and found to comply with the limits for a Class B digital device, pursuant to Part 15 of the FCC Rules. These limits are designed to provide reasonable protection against harmful interference in a residential installation. This equipment generates uses and can radiate radio frequency energy and, if not installed and used in accordance with the instructions, may cause harmful interference to radio communications. However, there is no guarantee that interference will not occur in a particular installation. If this equipment does cause harmful interference to radio or television reception, which can be determined by turning the equipment off and on, the user is encouraged to try to correct the interference by one or more of the following measures:

Reorient or relocate the receiving antenna.

Increase the separation between the equipment and receiver.

Connect the equipment into an outlet on a circuit different from that to which the receiver is connected.

Consult the dealer or an experienced radio/TV technician for help.

#### FCC Radiation Exposure Statement:

This equipment complies with FCC radiation exposure limits set forth for an uncontrolled environment. This equipment should be installed and operated with minimum distance 20cm between the radiator & your body.

European agent: MEGASYSTEMS

address: 55 Amfitheas Avenue 75 64 Paleo Faliro, Athens

<https://megasystems.gr/diffusion-technologies/?lang=en>

Product name: Aroma diffuser

Product model: A311

Manufacturer: Guangzhou Chiyang Scent Technology Co., LTD.

Address: 4F, Building C5, Gaosha Industrial Estate, Zhongyi Village, Zhongcun Town, Panyu Guangzhou, Guangdong, 511495 China

Frequency Range: 2402-2480MHZ

Max. output Power: 0.12dbm

#### SIMPLIFIED EU DECLARATION OF CONFORMITY

The simplified EU declaration of conformity referred to in Article 10(9) shall be provided as follows:

Hereby, Guangzhou Chiyang Scent Technology Co., LTD. declares that radio equipment type Aroma diffuser(A311) is in compliance with Directive 2014/53/EU, and this product is allowed to be used in all EU member states.

The full text of the EU declaration of conformity is available at following

This product can be used across EU member states.