

# 无线蓝牙耳机说明书

产品型号:SK19

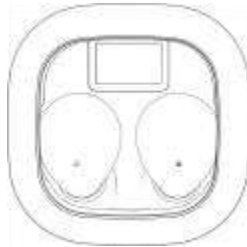

SK19

## 耳机功能操作说明

- 1.开机:长按功能键3秒
- 2.关机:长按功能键6秒
- 3.接听 /挂断:单击功能键
- 4.拒接来电:长按多功能键1.5 秒
- 5.暂停 /播放:双击功能键
- 6.上一曲:三击功能键(随机)
- 7.下一曲:三击功能键(随机)
- 8.音量 +:长按功能键1.5秒(随机)加一格音量
- 9.音量 -:长按功能键1.5秒(随机)减一格音量
- 10.游戏模式:四击功能键(随机)切换游戏模式/音乐模式
- 11.语音助手:四击功能键(随机)激活Siri
- 12.恢复出厂设置:五击功能键(清除配对记录)在 没有连接 手机的状态下操作

## 耳机连接配对操作

耳机充电仓取出来自动开机， 出现红蓝灯交替闪烁， 开始进行设备搜索 如下图所示

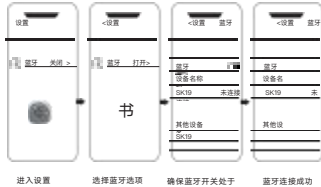

### 充电状态指示

- 1.充电仓电量充满显示100%显示0.00表示低电量， 需要充电
- 2.给充电盒充电时显示屏显示100%比电量， 充满时显示100%
- 3.充电仓给耳机充电的时候， 耳机亮红灯， 仓自灯闪亮
- 4.耳机低电的时候提示(嘟嘟声)表示低电提示

## 产品参数

功能用途	通讯蓝牙耳机， 音乐蓝牙耳机， 双耳通话	
频响范围	20HZ-20KHZ	
阻抗	32Ω	
灵敏度	103 + 3dB AtW000HzAt Q 126V	
蓝牙版本	5.3	
蓝牙接收距离	≤10米	
支持协议	HSP/HFP/ADP/SBC/ACC/AVRCP	
传输频率	2.4GHZ-2.483 5GHZ SMBand	
耳机充电时间	30分钟(耳机)， 约1小时(充电舱)	
播放时间	5-6小时(60%音量)	
通话时间	4-5 H(60%音量)	
续航时间	在蓝牙耳机与手机开启连接状态下通话时长; 约4-5小时(双耳通话);可以给耳机续航3次	
产品工作温度	-10-50℃	
产品存储温度	-20-55℃	

## 产品安全信息

- 在使用本产品前请阅读所有的指示和警告，不规范使用将会给产品或人身安全带来损害。
- 1.产品内含电池，请勿将本产品暴露在强日照或暖炉等过热环境中。请勿将本产品储存在高温,强光及强磁场环境下。
  - 2.产品不可放置在火源附近等恶劣环境中，禁止敲击、投掷、践踏、挤压或投入火中，若出现鼓胀，请勿使用。
  - 3.产品使用环境温度0~45℃。
  - 4.请勿违反产品说明书不恰当使用，造成产品损坏或危及人身财产安全，后果自行承担
  - 5.非专业人员严禁分解本产品，否则可能会导致起火，甚至彻底损坏本产品。
  - 6.请勿使用超出本产品输出电流负载(用电器)，超出负载会自动停止工作。
  - 7.请定期用干净的棉布对耳机充电触点进行清洁,以避免因长期不清洁导致耳机出现无法 充电或开机的情况。
  - 8.请勿将本产品置于水中(或洗衣机中)，若产品出现进水情况，请等待其自然晾干后再使用。



## Wireless headset

### manual Product model

:SK19



SK19

## Headset function operation instructions

1. Power on: Long press the function key for 3 seconds
2. Shutdown: Long press the function key for 6 seconds
3. Answer/end: Click the function key
4. Reject incoming calls: Hold down the multifunction key for 1.5seconds
5. Pause/Play: Double click the function keyPrevious song: Three click function key (random)
7. Next song: Three click function key (random)
8. Volume+: Long press the function key for 1.5 seconds (random)to increase the volume by one grid
9. Volume -: Press and hold the function key for 1.5 seconds (ran-dom) to decrease the volume by one grid
10. Game mode: Four click function key (random) to switch gamemode/music mode
11. Voice Assistant: Activate Siri with four click function keys (random)
12. Restore factory settings: Five click function key (clear pairingrecord) to operate without connecting the phone

## Headset connection pairing operation

When the headset charging compartment is taken out,it will start automatically, and the red and blue lights will flash alternately to start the device search

As shown in the following figure

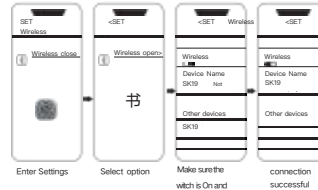

### Charging state indication

- 1.100% of the charging chamber's power display 0.00 indicates low power display and charging is required
- 2.When charging the charging box,the display screen displays 100% specific power, and when fully charged, it displays 100
- 3.When the charging chamber charges the headset, Headphone light red, bin blue light shining
- 4.When the headset is low,the prompt (Beep) indicates low power prompt

## Product safety information

Please read all instructions and warnings before using this product Improper use will damage the product or personal safety.

1.The product contains batteries, Do not expose the product to strong sunlight or overheated environments such as heaters. Do not store this product at high temperature, Under strong light and strong magnetic field.

2.The product cannot be placed near the fire source and other harsh environments, it is forbidden to knock, throw, trample, squeeze or throw into the fire. If there is swelling, do not use it

3. Ambient temperature of the product 0-45°C

4. Do not use the product inappropriately in violation of the product instructions, causing damage to the product or endangering the safety of personal and property, and bear the consequences

5. Non professional personnel are strictly forbidden to disassemble this product, otherwise it may cause fire, or even completely damage this product

6. Do not use loads (electrical appliances) that exceed the output current of this product If the load is exceeded it will automatically stop working

7. Please use clean cotton cloth to clean the headphone charging contact regularly To avoid the situation that the headset cannot be charged or turned on due to long-term uncleanness

8. Do not put this product in water (or washing machine). If the product has water ingress please wait for it to dry naturally before using it

Functional use	Communication headset, music headset, binaural call	
Frequency Response	20HZ-20KHZ	
impedance	32Ω	
sensitivity	103 + 3dB AtW000HzAt Q 126V	
version	5.3	
Communication distance	≤10m	
Support agreement	HSP/HFP/ADP/SBC/ACC/AVRCP	
Transmission frequency	2.4GHZ-2.483 5GHZ SMBand	
Headset charging time	30 minutes (headphones), about 1 hour (charging cabin)	
Playback time	5-6hours (60% volume)	
Talk time	4-5H(60% volume)	
Endurance time	Talk duration when headset and mobilephone are connected, About "4-5hours (binaural call)length of call in connected state" it can run the earphones three times	
Charging voltage/ current		
Product working temperature	-10-50°C	Rated input of earphone dc5v=25ma
Product storage temperature	-20-55°C	Rated input of charging chamber dc5v= 180 mA

	<p>FCC Warning Statement</p> <p>Changes or modifications not expressly approved by the party responsible for compliance could void the user' s authority to operate the equipment. This equipment has been tested and found to comply with the limits for a Class B digital device, pursuant to Part 15 of the FCC Rules. These limits are designed to provide reasonable protection against harmful interference in a residential installation. This equipment generates uses and can radiate radio frequency energy and, if not installed and used in accordance with the instructions, may cause harmful interference to radio communications. However, there is no guarantee that interference will not occur in a particular installation. If this equipment does cause harmful interference to radio or television reception, which can be determined by turning the equipment off and on, the user is encouraged to try to correct the interference by one or more of the following measures:</p> <ul style="list-style-type: none"><li>- - Reorient or relocate the receiving antenna.</li><li>- - Increase the separation between the equipment and receiver.</li><li>- - Connect the equipment into an outlet on a circuit different from that to which the receiver is connected.</li><li>- - Consult the dealer or an experienced radio/TV technician for help.</li></ul>			
--	---	--	--	--

	<p>This device complies with part 15 of the FCC Rules. Operation is subject to the following two conditions: (1) This device may not cause harmful interference, and (2) this device must accept any interference received, including interference that may cause undesired operation.</p> <p>The device has been evaluated to meet general RF exposure requirement. The device can be used in portable exposure condition without restriction.</p>			
--	---	--	--	--