

PHILIPS

Sports Headphones

6000 Series

TAA6219



User manual

Register your product and get support at:
www.philips.com/support

Contents

1	Important safety instructions	2	7	Notice	12
	Hearing safety	2		Declaration of conformity	12
	General information	2		Disposal of your old product and battery	12
2	Your On-ear solar-powered headphones	4		Remove the integrated battery	12
	What's in the box	4		Compliance with EMF	12
	Other devices	4		Environmental information	13
	Overview of your Bluetooth wireless headphones	5		Notice of compliance	13
3	Get started	6	8	Trademarks	15
	Charge the battery				
	App download	7	9	Frequently asked questions	15
	Pair the headphones for the first time	7			
	Pair the headphones with another Bluetooth device	7			
4	Use your headphones	8			
	Connect the headphones to a Bluetooth device	8			
	Multi-point connection	8			
	Power on/off	8			
	Manage your calls and music	9			
	Gaming mode (low latency mode)	9			
	Voice Assistant	9			
	LED indicator status	9			
5	Reset the headphones	11			
6	Technical data	11			

1 Important safety instructions

Hearing safety



Danger

- To avoid hearing damage, limit the time you use headphones at high volume and set the volume to a safe level. The louder the volume, the shorter the safe listening time is.

Be sure to observe the following guidelines when using your headphones.

- Listen at reasonable volumes for reasonable periods of time.
- Be careful not to adjust the volume continuously upwards as your hearing adapts.
- Do not turn up the volume so high that you can't hear what's around you.
- You should use caution or temporarily discontinue use in potentially hazardous situations.
- Excessive sound pressure from headphones and headphones can cause hearing loss.
- Using headphones with both ears covered while driving is not recommended and may be illegal in some areas.
- For your safety, avoid distractions from music or phone calls while in traffic or other potentially dangerous environments.

General information

To avoid damage or malfunction:



Caution

- Do not expose headphones to excessive heat.
- Do not drop your headphones.
- Headphones shall not be exposed to dripping or splashing. (Refer to the IP rating of specific product)
- Do not allow your headphones to be submerged in water.
- Do not charge your headphones when the connector or socket is wet.
- Do not use any cleaning agents containing alcohol, ammonia, benzene, or abrasives.
- Use a clean, damp cloth to clean your headphones - especially the sound conduits and the microphone holes - regularly and avoid buildup of substances such as sweat or earwax.
- If any sweat or water droplets are left in the sound conduits, air holes or microphone holes, the sound level will temporarily drop or cut out entirely. This is not a malfunction. Use a soft, damp cloth to dry the headphones thoroughly. Alternatively, remove the earbud tips, turn the sound conduits downward and gently tap the headphones about five times on a dry cloth or similar to remove any water collected inside.
- Be sure the headphones are completely dry before charging and using. Avoid using disposable alcohol pads or other substances for cleaning.
- The integrated battery shall not be exposed to excessive heat such as sunshine, fire or the like.
- Danger of explosion if battery is incorrectly replaced. Replace only with the same or equivalent type.
- To achieve the specific IP rating, the charging slot cover must be closed.
- Disposal of a battery into fire or a hot oven, or mechanically crushing or cutting a battery, can result in an explosion.
- Leaving a battery in an extremely high temperature surrounding environment can result in an explosion or the leakage of flammable liquid or gas.
- A battery subjected to extremely low air pressure may result in an explosion or the leakage of flammable liquid or gas.
- Replacement of a battery with an incorrect type risks severely damaging the headphones and the battery (for example, in the case of some lithium battery types).
- If the headphones are not used for a long time, the rechargeable battery will begin to lose its charge. To avoid this loss, please fully charge the battery at least once every three months.

- To avoid risk of fire, the equipment is supplied only by external power source which output shall comply with PS1 (with output capacity less than or equal to 15W).

Operating and storage temperatures and humidity

- Store in a place where the temperature is between -20°C (-4°F) and 55°C (131 °F) with up to 90% relative humidity.
- 0-45 °C for charging operating ambient temperature;
0-55°C for discharging operating ambient temperature.
- Battery life may be shorter in high or low temperature conditions.

2 Your On-ear solar-powered headphones

Congratulations on your purchase, and welcome to Philips! To fully benefit from the support that Philips offers, register your product at www.philips.com/support. With these Philips headphones, you can:

- Enjoy convenient wireless handsfree clear calls
- Enjoy and control great sound music wirelessly
- Switch between calls and music
- Sunlight to electric light, these headphones recharge whenever they're exposed to light
- Cool and comfy on-ear fit for Run, walk, roller skate

What's in the box



On-ear solar-powered headphones
Philips TAA6219



Quick start guide



Global Warranty



Safety leaflet

Other devices

A mobile phone or device (e.g. notebook, tablet, Bluetooth adapters, MP3 players etc) which supports Bluetooth and is compatible with the headphones (see 'Technical data' on page 9).

Overview of your On-ear solar-powered headphones

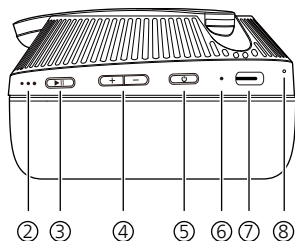
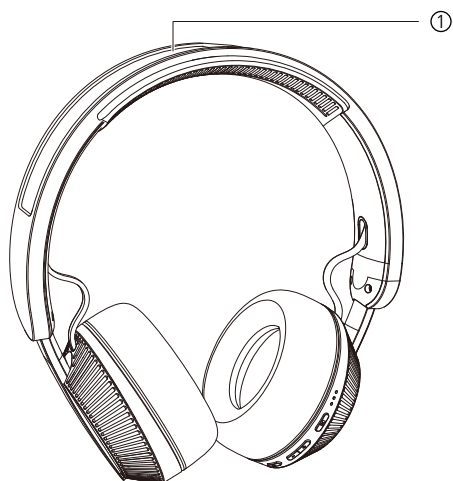

- ① Solar panel
- ② Light source LED indicator
- ③ MFB (Multi-function button)
- ④ Volume + / Volume -
- ⑤ PWB (Power button)
- ⑥ Bluetooth / Charge LED indicator
- ⑦ Type C charging slot
- ⑧ Mic

3 Get started

Charge the battery



Note

- Before you use your headphones, place them in the charging box and charge the battery for 2.5 hours for optimum battery capacity and lifetime.
- Finish your call before charging. Connecting the headphones to charge will power them off.
- If the headset is not used for a long time, the rechargeable battery will begin to lose its charge. To avoid this loss, please fully charge the battery at least once every three months.

Charging headphones by power source

Plug one end of the USB-C cable into the headphone and the other end into the power source.

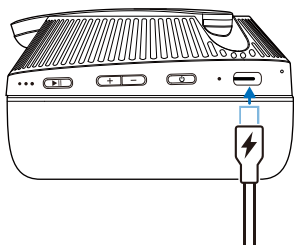

LED turns white during charging and turns off when the headphones are fully charged.



Tip

- Normally, a full charge takes 2.5 hours.

Charging headphones by any sources of light

Headphones built-in solar cell, it can be charged by any sources of light.

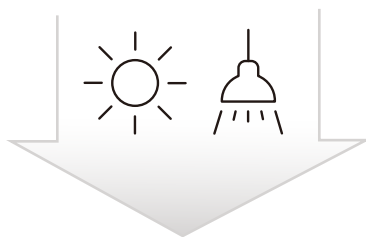

Solar panel charging one hour in cloudy day can play music up to 2 hours.



Note

- Where the temperature is lower than 0°C (32°F) or higher than 45°C (113 °F) can't charge headphones what ever by power source or solar energy.

App download

Scan the QR code/press 'Download' button or search 'Philips Headphones' in the Apple App Store or Google Play to download the app.

Get Connected



philips.to/headapp

The Philips Headphones App puts you in charge of the music you are listening to. You can customize the sound so that your music and calling experience always best suit your needs.

Pair the headphones with your Bluetooth device for the first time

- 1 Make sure that the headphones are fully charged and powered off.
- 2 Press and hold PWB for 2 seconds until the blue and white LED flash quickly.
 - The headphones remain in pairing mode for 5 minutes.
- 3 Turn on the Bluetooth function of your Bluetooth device.
- 4 Pair the headphones with the mobile phone. For detailed information, refer to the user manual of your mobile phone.

The following example shows you how to pair the headphones with your Bluetooth device.

- 1 Turn on the Bluetooth function of your Bluetooth device, select **Philips TAA6219**.
- 2 Enter the headphones' password "0000" (4 zeros) if prompted. For those devices featuring Bluetooth 3.0 or higher, there is no need to enter a password.



Philips TAA6219

Pair the headphones with another Bluetooth device

If you want to pair another Bluetooth device with the headphones, just put them into pairing mode, press **Volume +** and **Volume -** button for 4 seconds at the same time, then discover the second device as per normal pairing.

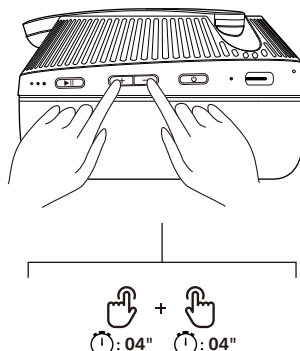

4 Use your headphones

Connect the headphones to your Bluetooth device

- 1 Turn on your mobile phone/ Bluetooth device.
- 2 Press and hold the PWB button to turn the headphones on.
 - ↳ The blue LED is on for 1 second
 - ↳ The headphones are reconnected to the last connected mobile phone/ Bluetooth device automatically. If the last one is not available, the headphones will be in pairing mode



Tip

- If you turn on the mobile phone/Bluetooth device or activate the Bluetooth feature after turn on the headphones, you have to reconnect the headphones and mobile phone/Bluetooth device manually.



Note

- If the headphones fail to connect to any Bluetooth device within range of 5 minutes, it will switch off automatically to save the battery life.

Multi-point connection

Pairing

- Pairing the headphones to two devices, e.g. mobile phone and notebook.

Switch between device

- At anytime, you can only listen to music from one device. Another device will be for phone call.
- Pause the audio from one device and then start play audio from the another device.



Note

- When streaming audio from Device 1, receiving a call from Device 2 will automatically pause Device 1 playback. And the call will be routed automatically to headphones.
- Ending the call will automatically resume playback from device 1.

Power on/off

Task	Button	Operation
Turn the headphones on	PWB	Press and hold 2s
Turn the headphones off	PWB	Press and hold 2s

Manage your calls and music

Music control

Task	Button	Operation
Play or pause music	MFB	Press once
Adjust volume up	+	Press once
Adjust volume down	-	Press once
Next track	+	Long press
Previous track	-	Long press

Call control

Task	Button	Operation
Answer	MFB	Press once
Reject a call / hang up a call	MFB	Press and hold for one second
Switch caller during a call	MFB	Press once

Gaming mode (low latency mode)

Task	Button	Operation
Gaming mode on	PWB	Double click
Gaming mode off	PWB	Double click

Voice Assistant

Task	Button	Operation
Trigger Voice (Siri/Google) Assistant	MFB	Press & holding for 1 second
Stop Voice Assistant	MFB	Press once

LED indicator status

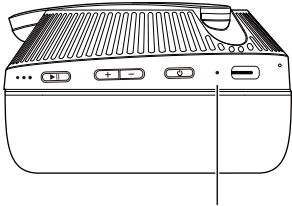

Bluetooth / Charge LED indicator

Charge LED indicator

When charging	Indicator
Battery low	Blue LED flash until off
Charging	White LED lights up until fully charged

Bluetooth LED indicator

Headphones status	Indicator
Waiting for pairing	Blue and white LED flash alternately
Connected to a Bluetooth device	White LED blinks once

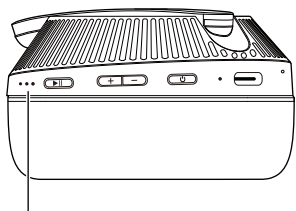

Light source
LED indicator

Light source LED indicator

Light source intensity	Indicator
At night or indoor	One LED flashes
Rainy day	One LED on
Near windows (indoor) in sunny day or cloudy day	Two LEDs on
Cloudy day	Three LEDs on

5 Reset the headphones

If you encounter any pairing or connection issue, you can follow the following procedure to reset your headphones to factory default settings.

- 1 On your Bluetooth device, go to the Bluetooth menu and remove Philips **TAA6219** from the device list.
- 2 Turn off the Bluetooth function of your Bluetooth device.
- 3 Press both **volume+** and **volume-** on the headphones for 4 seconds at the same time.

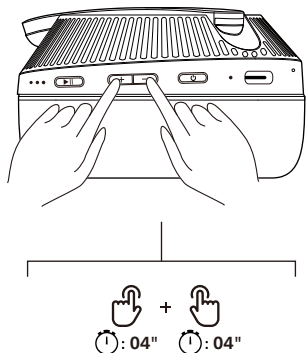

- 4 Follow steps in "Use your headphones- **Pair the headphones with your Bluetooth device for the first time.**"
- 5 Pair the headphones with your Bluetooth device, select Philips **TAA6219**.

6 Technical data

- Music time: 80 hours
- Talk time: 60 hours
- Standby time: 600 hours
- Charging time: 2.5 hours
- Rechargeable lithium polymer battery (650 mAh)
- Bluetooth version: 5.4
- Compatible Bluetooth profiles:
 - HFP (Hands-Free Profile)
 - A2DP (Advanced Audio Distribution Profile)
 - AVRCP (Audio Video Remote Control Profile)
- Supported audio codec: SBC, AAC
- Frequency range: 2.402-2.480 GHz
- Transmitter power: < 10 dBm
- Operating range: Up to 10 meters (33 feet)
- 1 AI mic
- Auto power off
- Low battery warning: available
- Built-in solar cell
- Solar panel charging 1 hour play time: ≈2 hours
 - ↳ Illumination >100000 Lux
 - ↳ Cloudy day charge time between 10:00am-16:00pm
- Removeable and washable cooling gel earpads

Note

- Specifications are subject to change without notice.

7 Notice

Declaration of conformity

Hereby, TP Vision Europe B.V. declares that the product is in compliance with the essential requirements and other relevant provisions of RED Directive 2014/53/EU and UK Radio Equipment Regulations SI 2017 No 1206. You can find the Declaration of Conformity on www.philips.com/support.

Disposal of your old product and battery



Your product is designed and manufactured with high quality materials and components which can be recycled and reused.



This symbol on a product means that the product is covered by European Directive 2012/19/EU.



This symbol means that the product contains batteries covered by European Regulation (EU) 2023/1542 which cannot be disposed of with normal household waste. Inform yourself about the local separate collection system for electrical and electronic products and batteries. Follow local rules and never dispose of the product and batteries with normal household waste. Correct disposal of old products and batteries helps prevent negative consequences for the environment and human health.

Remove the integrated battery

If there is no collection/recycling system for electronic products in your country, you can protect the environment by removing and recycling the battery before disposing of the headphones.

- Make sure the headphones are disconnected before removing the battery.

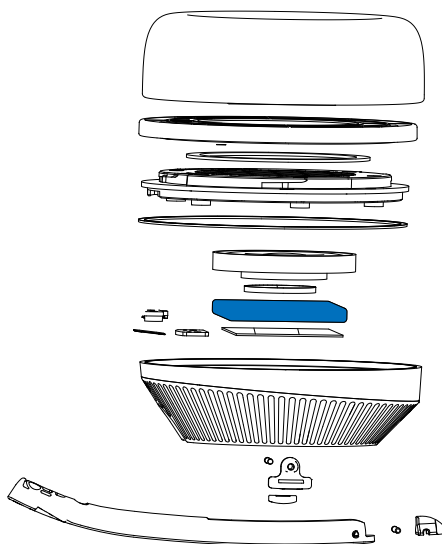

Compliance with EMF

This product complies with all applicable standards and regulations regarding exposure to electromagnetic fields.

Environmental information

All unnecessary packaging has been omitted.

Your system consists of materials which can be recycled and reused if disassembled by a specialized company. Please observe the local regulations regarding the disposal of packaging materials, exhausted batteries and old equipment.

Notice of compliance

The device complies with the FCC rules, Part 15. Operation is subject to the following two conditions:

- 1. This device may not cause harmful interference, and**
- 2. This device must accept any interference received, including interference that may cause undesired operation.**

FCC rules

This equipment has been tested and found to comply with the limits for a Class B digital device, pursuant to part 15 of the FCC Rules. These limits are designed to provide reasonable protection against harmful interference in a residential installation. This equipment generates, uses and can radiate radio frequency energy and, if not installed and used in accordance with the instruction manual, may cause harmful interference to radio communications. However, there is no guarantee that interference will not occur in a particular installation. If this equipment does cause harmful interference to radio or television reception, which can be determined by turning the equipment off and on, the user is encouraged to try to correct the

interference by one or more of the following measures:

- Reorient or relocate the receiving antenna
- Increase the separation between equipment and receiver
- Connect the equipment into an outlet on a circuit different from that to which the receiver is connected
- Consult the dealer or an experienced radio/TV technician for help

FCC Radiation Exposure Statement:

This equipment complies with FCC radiation exposure limits set forth for an uncontrolled environment.

This transmitter must not be co-located or operated in conjunction with any other antenna or transmitter.

Caution: The user is cautioned that changes or modifications not expressly approved by the party responsible for compliance could void the user's authority to operate the equipment.

Canada:

This device contains licence-exempt transmitter(s)/receiver(s) that comply with Innovation, Science and Economic Development Canada's licence-exempt RSS(s). Operation is subject to the following two conditions: (1) this device may not cause harmful interference, and (2) This device must accept any interference received, including interference that may cause undesired operation of the device.
CAN ICES-(B)/NMB-(B)

IC Radiation Exposure Statement:

This equipment complies with Canada radiation exposure limits set forth for uncontrolled environments. This transmitter must not be co-located or operating in conjunction with any other antenna or transmitter.

Avis de conformité

Cet appareil satisfait aux règlements de la FCC partie 15 du Code of Federal Regulations. Son fonctionnement est assujéti aux deux conditions suivantes :

1. **Cet appareil ne doit pas causer d'interférence préjudiciable et**
2. **l'appareil doit accepter toute interférence reçue, y compris les interférences qui peuvent causer un fonctionnement non désiré.**

Règlement de la FCC

Cet équipement a été testé et jugé compatible avec les limites s'appliquant aux appareils numériques de la classe B, conformément à l'article 15 du règlement de la FCC. Ces limites ont été définies pour fournir une protection raisonnable contre les interférences nuisibles dans le cadre d'une installation résidentielle. Cet équipement génère, utilise et peut émettre de l'énergie radiofréquence et, s'il n'est pas installé ni utilisé conformément aux instructions, peut causer des interférences gênantes pour les communications radio.

Rien ne garantit toutefois que des interférences ne surviendront pas dans une installation particulière. Si cet équipement cause des interférences nuisibles pour la réception de la radio ou de la télévision, ce qui peut être déterminé en mettant l'équipement hors tension puis sous tension, l'utilisateur devra essayer de corriger ces interférences en effectuant une ou plusieurs des opérations suivantes :

- Déplacez l'antenne de réception.
- Augmentez la distance entre l'équipement et le récepteur.
- Branchez l'équipement à une prise d'un circuit autre que celui sur lequel le récepteur est branché.
- Consultez le détaillant ou un technicien de radiotélévision expérimenté.

Canada :

Le présent appareil est conforme aux CNR d'Industrie Canada applicables aux appareils radio exempts de licence. L'exploitation est autorisée aux deux conditions suivantes : (1) l'appareil ne doit pas produire de brouillage, et (2) l'utilisateur de l'appareil doit accepter tout brouillage radioélectrique subi, même si le brouillage est susceptible d'en compromettre le fonctionnement.
CAN ICES-(B)/NMB-(B)

Déclaration d'IC sur l'exposition aux radiations:

Cet équipement est conforme aux limites d'exposition aux radiations définies par le Canada pour des environnements non contrôlés.

Cet émetteur ne doit pas être installé au même endroit ni utilisé avec une autre antenne ou un autre émetteur.

8 Trademarks

Bluetooth

The Bluetooth® word mark and logos are registered trademarks owned by Bluetooth SIG, Inc. and any use of such marks by MMD Hong Kong Holding Limited is under license. Other trademarks and trade names are those of their respective owners.

Siri

Siri is a trademark of Apple Inc., registered in the U.S. and other countries.

Google

Google and Google Play are trademarks of Google LLC.

9 Frequently asked questions

My On-ear solar-powered headphones do not turn on.

The battery level is low. Charge the headphones.

I cannot pair my On-ear solar-powered headphones with my Bluetooth device.

The Bluetooth is disabled. Enable the Bluetooth feature on your Bluetooth device and turn on the Bluetooth device before you turn on the headphones.

The Bluetooth device cannot find the headphones.

- The headphones may be connected to a previously paired device. Turn off the connected device or move it out of range.
- Pairing may have been reset or the headphones have been previously paired with another device. Pair the headphones with the Bluetooth device again as described in the user manual. (see 'Pair the headphones with your Bluetooth device for the first time' on page 6).

My On-ear solar-powered headphones are connected to a Bluetooth stereo-enabled mobile phone, but music only plays on the mobile phone speaker.

Refer to the user manual of your mobile phone. Select to listen to music through the headphones.

The audio quality is poor and crackling noise can be heard.

- The Bluetooth device is out of range. Reduce the distance between your headphones and Bluetooth device, or remove obstacles between them.
- Charge your headphones.

The audio quality is poor when streaming from a mobile phone, is very slow or streaming does not work at all.

Make sure your mobile phone not only supports (mono) HFP but also supports A2DP and is BT4.0x (or higher) compatible (see 'Technical data' on page 11).

I hear but cannot control music on my Bluetooth device (e.g. play/pause/skip forward/backward).

Make sure the Bluetooth audio source supports AVRCP (see 'Technical data' on page 11).

The volume level of the headphones is too low.

Some Bluetooth devices cannot link the volume level with the headphones through volume sync. In this case, you have to adjust the volume on your Bluetooth device independently to achieve an appropriate volume level.

I cannot connect the headphones to another device, what do I do?

- Make sure the Bluetooth function of the previous paired device is turned off.
- Repeat the pairing procedure on your second device (see 'Pair the headphones with your Bluetooth device for the first time' on page 6).

Clean your headphones regularly.

- Use a clean, damp cloth to clean your headphones - especially the sound conduits and the microphone holes - regularly and avoid buildup of substances such as sweat or earwax.
- If any sweat or water droplets are left in the sound conduits, air holes or microphone holes, the sound level will temporarily drop or cut out entirely. This is not a malfunction. Use a soft, damp cloth to dry the headphones thoroughly. Alternatively, turn the sound conduits downward and gently tap the headphones about five times on a dry cloth or similar to remove any water collected inside.
- Be sure the headphones are completely dry before charging and using. Avoid using disposable alcohol pads or other substances for cleaning.

Charge your headphones regularly.

If the headset is not used for a long time, the rechargeable battery will begin to lose its charge. To avoid this loss, please fully charge the battery at least once every three months.

For further support, visit www.philips.com/support



MMD Hong Kong Holding Limited. All rights reserved. Specifications are subject to change without notice.

Philips and the Philips Shield Emblem are registered trademarks

of Koninklijke Philips N.V. and are used under license. This product has been manufactured by and is sold under the responsibility of MMD Hong Kong Holding Limited or one of its affiliates, and

MMD Hong Kong Holding Limited is the warrantor in relation to this product. All other company and product names may be trademarks of their respective companies with which they are associated.

