



## USER MANUAL



FC CE RoHS  
Made in China

### SAFETY POINTERS

- We recommend that you follow the instructions outlined in this manual. We care about your safety and experience, so read on before using your new earbuds!
- Be aware of any sharp edges, uneven surfaces, or metal parts/accessories included in the packaging—we want to prevent any possible injuries.
- Don't try to modify, repair or dismantle your earbuds! Doing so may cause undesired effects (e.g., electric shocks, product breakdown, or fire hazards.)

- Do not use any diluents or solvents to clean your Kronies True Wireless Earbuds.
- Be practical when using your earbuds—don't wear them in situations that require the full attention of your hearing like driving.

### PARTS AND STUFF

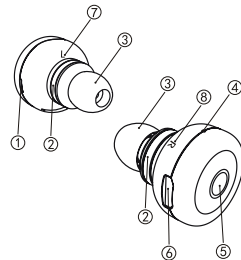

1. Indicator Light
2. Rubber Ring
3. Ear Tips
4. Microphone
5. Multifunction Key
6. USB Input
7. Left Bud
8. Right Bud

### ACCESSORIES

**EAR TIPS:** To make sure you get the best sound possible, try out each sized ear tip to find which one fits best.

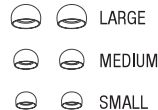

**CHARGING CABLE:** This item includes a dual micro USB cable for easy and simultaneous charging of your Kronies.

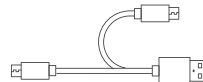

### GETTING STARTED

We recommend fully charging your earbuds before using them for the first time. Using the included charging cable, plug your earbuds into any USB port with a 5V/1A output.

### LED INDICATOR LIGHT

*Solid RED:* Charging

*OFF:* Fully charged

*Flashing RED:* Low battery

*Flashing WHITE:*

Powered on, ready for pairing

### POWER ON/OFF

*Power On:* Press and hold the multifunction button on both Kronies for roughly 2 seconds until the indicator light flashes white and you hear a tone.

*Power Off:* Press and hold the multifunction button on both Kronies for 5 seconds until the LED flashes red.

## WIRELESS PAIRING

1. *TWS pairing:* Hold and press both earbuds simultaneously for 4 seconds until you see a white LED flash quickly on both earbuds. After TWS paired, the LED light on one earbud will flash white while the other will be solid. Please note: Earbuds come with TWS pairing.
2. *Pairing with devices in TWS Mode:* After fully charging, power on both earbuds, the LED light on one earbud will flash white. Switch on the Bluetooth on your devices and select “Kronies” to pair. When paired, LEDs on both

earbuds will be solid white and off while playing music.

3. *Pairing with devices with Mono Mode:* Just power on one earbud and then following the same processes as #2.

Note: Functions of buttons are limited in Mono Mode

## CALLING

*Answer/End a call:* Press the multifunction button once.

*Reject a call:* Press and hold down the multifunction button

## PLAYING MUSIC

*To pause your music:* Press the multifunction button once while music is playing.

*To play your music:* Press the multifunction button once to resume your music.

## ADDITIONAL NOTES

- If your Kronies cannot find any pairing device for 10 minutes, they will power off automatically.
- You must charge your wireless earbuds if they have not been used for more than 3 months.
- Make sure the earbuds stay

within 20 feet of one another.

## WARNINGS

1. Do not keep or store your Kronies in an area too hot or too cold for a long period of time, as it may cause deformation, reduce battery capacity, and even shorten your Kronies' lifespan. Room temp is recommended.
2. Do not attempt to disassemble your wireless earbuds for any reason, as it can create a safety hazard.

3. Keep your Kronies and all accessories out of the reach of children and pets, as small parts can fit in the mouth and cause potential choking.
4. Keep your Kronies out of the water.

## RESET YOUR KRONIES

To reset the earbuds, turn both Kronies are off. Hold and press both earbuds simultaneously for 8 seconds until you see a Red LED light flash 3 times on both earbuds.

## PRODUCT SPECIFICATIONS

Play time: Up to 4 hours

Wireless Range: > 33ft.

Working Voltage: 3.2V - 4.2V

Wireless Frequency Band: 2.4 - 2.48Ghz

Driver: 10mm copper ring  
loudspeaker

Impedance: 16  $\Omega$

Microphone Sensitivity: -40dB  
 $\pm$  2dB

Charging: Dual Micro USB

Size: 0.87 in x 1.10in

[WWW.ORIGAUDIOPROMO.COM](http://WWW.ORIGAUDIOPROMO.COM)

#### FCC Statement

This equipment has been tested and found to comply with the limits for a Class B digital device, pursuant to part 15 of the FCC Rules. These limits are designed to provide reasonable protection against harmful interference in a residential installation. This equipment generates, uses and can radiate radio frequency energy and, if not installed and used in accordance with the instructions, may cause harmful interference to radio communications. However, there is no guarantee that interference will not occur in a particular installation. If this equipment does cause harmful interference to radio or television reception, which can be determined by turning the equipment off and on, the user is encouraged to try to correct the interference by one or more of the following measures:

- Reorient or relocate the receiving antenna.
- Increase the separation between the equipment and receiver.
- Connect the equipment into an outlet on a circuit different from that to which the receiver is connected.
- Consult the dealer or an experienced radio/TV technician for help.

Caution: Any changes or modifications to this device not explicitly approved by manufacturer could void your authority to operate this equipment.

This device complies with part 15 of the FCC Rules. Operation is subject to the following two conditions: (1) This device may not cause harmful interference, and (2) this device must accept any interference received, including interference that may cause undesired operation.