

BHT-9000
Thermostat

User Guide



WiFi type
Baseboard heater

Welcome

Please confirm that this product is suitable for your heating equipment before installation;
*Before installation or maintenance, please make sure to keep the power off;
*Please strictly follow the wiring diagram for wiring installation;
*Installation to the wall, please confirm that the fasteners are suitable for this product;
*Do not pull the cable too hard, otherwise the product will be damaged;
*If a hard plastic wire is used in the installation process, it must be bent to an appropriate angle in advance;
*Please arrange for professionals to install;
*Please contact the after-sales service for equipment failure, please do not try to repair it yourself;
* After installation, please refer to this manual to check again to ensure normal and safe use, and keep this manual properly.

In the box you will find

Thermostat 1pc Screws 2pc User Guide 1pc
QC Passed 1pc Floor Sensor 1pc (Floor Sensor is Optional)

ABOUT YOUR THERMOSTATS

The BHT-9000 -UH is suitable for temperature control of baseboard heaters. By converting electrical energy into thermal energy, the hot air rises to accelerate indoor air convection to achieve a heating effect. It can be used in smart homes, shopping malls, and industrial operations.

FEATURES

On Appearance

- 1. VA display screen, no window, more friendly interface; simple display, energy saving, protect your eyes.
- 2. The metal knob is equipped with touch buttons for temperature control, making operation and setting more convenient;
- 3. The ultra-thin embedded panel perfectly adapts to various walls; the visible thickness on the wall is only 13.1 mm.
- 4. Black and red color scheme & platinum color scheme, light luxury texture, simple and elegant;
- 5. Dynamic background light, showing working status from multiple angles
- 7. Patented buckle installation, no tools required, convenient and worry-free

On Functionality

- 1. Rich functional options, supporting Modbus, WIFI, magnetic cards, etc., to meet your various needs;
- 2. Strict temperature control accuracy (±1°C), providing the warmth you need;
- 3. Power-off protection, safely save all settings;
- 4. Multiple programming mode switching: manual mode/temporary manual mode/weekly programming mode/holiday mode;
- 5. Preset 5+1+1 mode weekly programming setting, 6 time periods can be programmed every day, green and energy-saving, lower cost, more intelligent and environmentally friendly;
- 6. Support window opening detection reminder to better protect your temperature control environment.
- 7. Support the creation of local product groups/sharing to achieve unlimited centralized control/multi-terminal control of the number of products;
- 8. Perfectly compatible with: Xiaodu, Amazon Echo, Google Smart Home, a new voice control experience.

TECHNICAL DATA

Power Supply:95 ~240 VAC, 50~60 Current Load: 16A (electric heating)
Sensor: NTC3950, 10K Accuracy: ±1°F
Set Temp. Range: 41-95°F Room Temp. Range: 41-158°F
Display Temp. Range: 41 ~ 158°F Ambient Temp.: 32~ 113°F
Ambient Humidity: 5 ~ 95 % RH (Non Condensing)
Storage Temp.:23~ 113°F
Power Consumption: <1.5W
Timing Error: < 1%
Shell Material: PC +ABS (Fireproof)
Installation Box: **American shadow box**
Wire Terminals: Wire 2 x 1.5 mm2 or 1 x 2.5 mm2
Protection Class: IP20
Buttons: Capacitive Touch Buttons

DIMENSION (Unit:mm)

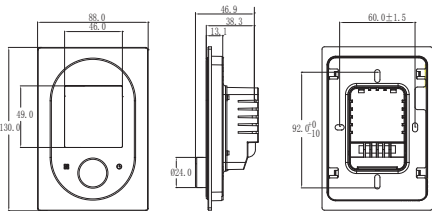

HOME SCREEN QUICK REFERENCE

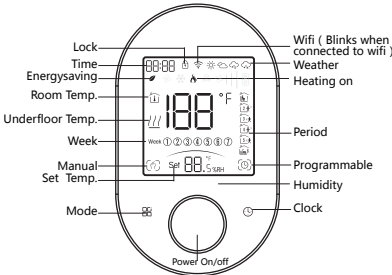

BEFORE WIRING AND INSTALL

- 1. Read these instructions carefully. Failure to follow them could damage the product or cause a hazardous condition.
- 2. Check the ratings given in the instructions and on the product to make sure the product is suitable for your application.
- 3. Installer must be a trained, experienced service technician.
- 4. After installation is complete, check out product operation as provided in these instructions.

CAUTION Electrical Shock or Equipment Damage Hazard.
Can shock individuals or short equipment circuitry.
Disconnect power supply before installation.

WIRING

Note: This thermostat is equipped with American cassette installation

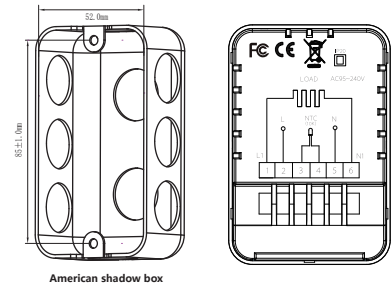

INSTALLATION

Your thermostat fits standard American cassette installation

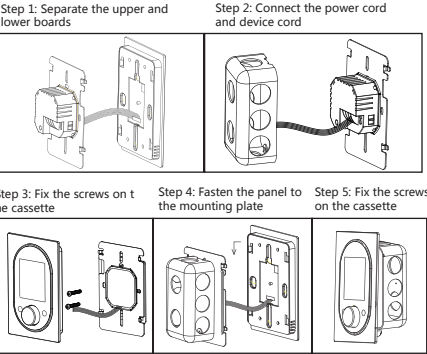

OPERATION

During Power On

- 1.Power On/off: Press the knob to turn the thermostat on/off.
- 2.Manual & Programmable & Temporary manual & holiday mode
Touch to change between manual mode , programme mode ,Temporary manual icon flashes& holiday mode .
- 3.Setting Temperature
In the programming mode, the temperature setting and time setting will be locked. If the user wants to adjust, he must first adjust the thermostat to manual mode by pressing the key.
In the manual mode, the desired temperature can be set by turning the knob.
Press once more to confirm and exit.
- 4.Adjusting/Setting the Clock
Press to set minute, hour and weekday. and adjust the values by turning the knob.
Press once more to confirm and exit.
- 5.Locking your Thermostat
Press and hold the and for 5 seconds to lock/unlock your thermostat. In item 3 of high senior options, you can select full lock or half lock.
- 6.Adjusting/Setting the Programmable Schedules
Press icon four times in a row. You can see "MON TUE WED THU FRI" and "h:m", and the minutes of time are flashing.
Turning the knob to set the minutes;
Press the icon again, the hour of the time will flash, set the hour by turning the knob;
Press the icon again, the temperature setting will flash, set the temperature turning the knob ;
This completes the setting of periods1.

In the same way, complete the settings of periods2, 3, 4,5and 6.
Press the icon once more to enter the Saturday schedule settings (you will see the SAT of the screen).Repeat the above process to set the period and temp. and Sunday schedule.
Press the icon once more to confirm and exit.

Default settings for program schedule

Time display	MON.-FRI. (①②③④⑤ shows on screen)		SAT. (⑥shows on screen)		SUN. (⑦shows on screen)	
	TIME	TEMP.	ON TIME	TEMP.	ON TIME	TEMP.
Period 1	6:00~8:00	20	6:00~8:00	20	6:00~8:00	20
Period 2	8:00~11:30	15	8:00~11:30	20	8:00~11:30	20
Period 3	11:30~13:00	15	11:30~13:00	20	11:30~13:00	20
Period 4	13:30~17:00	15	13:30~17:00	20	13:30~17:00	20
Period 5	17:00~22:00	22	17:00~22:00	20	17:00~22:00	20
Period 6	22:00~6:00	15	22:00~6:00	15	22:00~6:00	15

A separate schedule may be set for weekdays (Mon – Fri) and for weekends (Sat or Sun).
7.Checking the Temperature of Floor Sensor
Press and hold the arrow for 5 seconds to display the temp. of floor sensor. If no external sensor is connected, the thermostat will display "Er".Note: Do not use third-party external sensors, the temperature will be incorrect.

8.Setting the Functions and Options
During power off, Press and hold and for 8 sec. in the order to reach system function. Then press to scroll through the available functions , and use turning the knob to change the available options. All settings are confirmed automatically.

Code	Function	Setting and options	Default
1	Temperature compensation	-9 to 9 °C	-3
2	Deadzone Temp.	01-05°C	01
3	Button Locking	0:All buttons are locked except power button. 1:All buttons are locked.	1
4	Sensor typer	In: Internal Sensor(to control the temp.) Ou: External Sensor (to control the temp.) AL: Internal&External Sensor (Internal sensor to control the temp, external sensor to limit the temp.)	AL
5	Min.Set Temp.	05-15°C	05
6	Max.Set Temp.	15-45°C	35
7	Low temp. protection setting	00-10°C	00
8	High temp. protection setting.	25-70°C	45
9	Energy saving Mode	0:OFF 1:ON	0
10	Economy temp.	10-30°C	20
11	Window detection	0:OFF 1:ON	0
12	Open window to check temp.	02-04°C	02
13	Window detection time	02-30 min	15
14	Window detection cycle time	10-60 min	30
15	°C/°F switching	0: °C 1: °F	0
16	Reset	0: No factory reset; 1: Factory reset	0
17	Display brightness	04-99	20
18	Backlight standby on state	00:OFF 01:ON	00
19	Version number		U1

ABOUT WIFI
Wi-Fi Connection

Before using your Wi-Fi thermostat for the first time, you must configure the Wi-Fi signal and settings using your smartphone or tablet. This enables communication between your devices.

Step 1 Download your APP (Fig1-1)



Search for "Smartlife" in Apple Store or Google Play or use a browser to scan the QR code above (Figure 1-2), and complete account registration and installation according to the guidance of the APP.

Step 2. Connect the thermostat

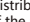
Method 1: Bluetooth network distribution (Fig 2.1-Fig 2.6)
Turn on the Bluetooth switch of the mobile phone and set the thermostat to the WiFi enabled state (Press and hold the  key for 8s when the thermostat is off), see the following tutorial to complete the connection and settings.

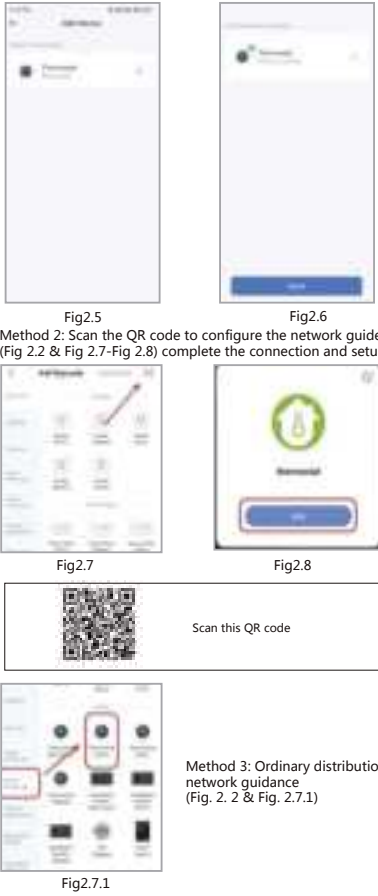
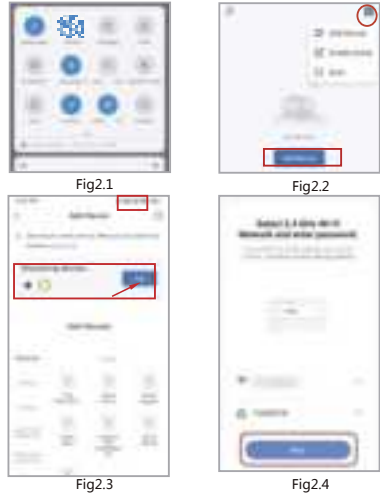

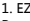
Network distribution mode:
1. EZ Mode
Press and hold the  until the thermostat screen flashes quickly and displays the  icon, and then operate according to the following figure (Fig 2.9-Fig 2.13).

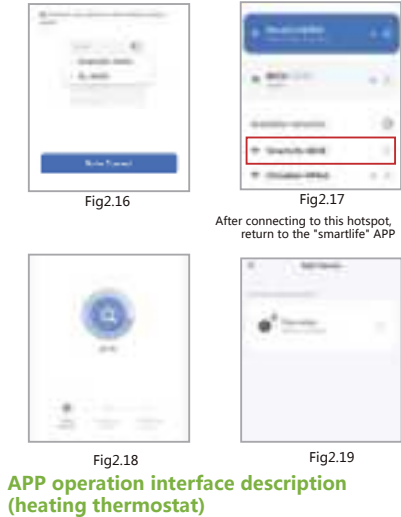
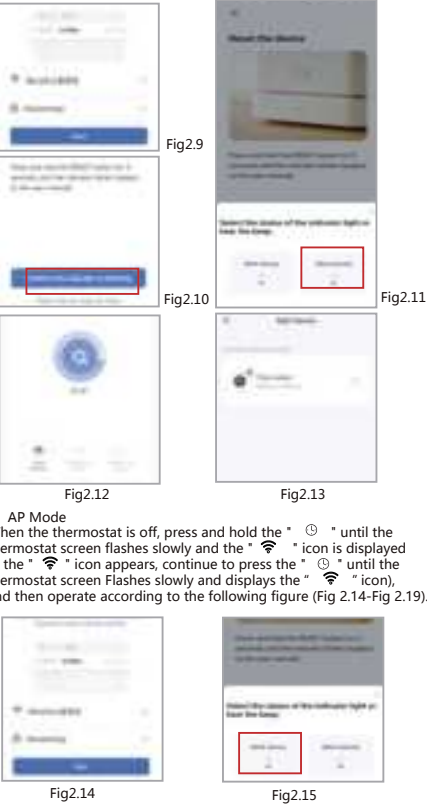

APP operation interface description
(heating thermostat)

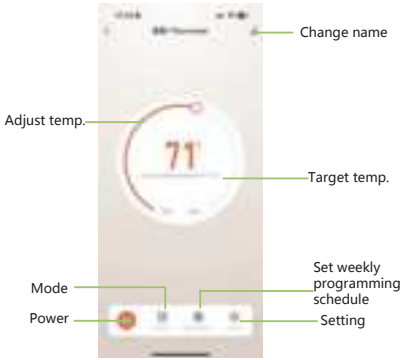

More settings



SIMPLE EXCEPTION HANDLING

No.	Phenomenons	Handling
1	Power is on but without display.	*Check if the terminals between LCD panel and Power Unit Box is loosen.
2	Without output but display works.	* Use a new LC panel or new Power Unit Box to replace the old one.
3	Room Temp. Is a little different from the actual.	* Do temperature calibration in item 1 of high senior options

SERVICE

Your thermostat carries a 24 months warranty from date of purchase. Service out with the warranty period may incur a charge. More detail please contact with us directly.

FCC warning statements:

This equipment has been tested and found to comply with the limits for a Class B digital device, pursuant to part 15 of the FCC Rules. These limits are designed to provide reasonable protection against harmful interference in a residential installation. This equipment generates, uses and can radiate radio frequency energy and, if not installed and used in accordance with the instructions, may cause harmful interference to radio communications. However, there is no guarantee that interference will not occur in a particular installation. If this equipment does cause harmful interference to radio or television reception, which can be determined by turning the equipment off and on, the user is encouraged to try to correct the interference by one or more of the following measures:

- Reorient or relocate the receiving antenna.
- Increase the separation between the equipment and receiver.
- Connect the equipment into an outlet on a circuit different from that to which the receiver is connected.
- Consult the dealer or an experienced radio/TV technician for help.

Caution: Any changes or modifications to this device not explicitly approved by manufacturer could void your authority to operate this equipment.

This device complies with part 15 of the FCC Rules. Operation is subject to the following two conditions: (1) This device may not cause harmful interference, and (2) this device must accept any interference received, including interference that may cause undesired operation.

The device has been evaluated to meet general RF exposure requirement This equipment complies with FCC radiation exposure limits set forth for an uncontrolled environment.

This equipment should be installed and operated with minimum distance 20cm between the radiator & your body.