

Quick Start Guide

Battery-Powered Outdoor Security Camera Tapo C460

*Images may differ from actual products.
7106511687 REV1.0.0 ©2024 TP-Link

1 Charge the Battery

The battery comes partially charged. We recommend that you fully charge the battery before use. This will take about **five and a half** hours.

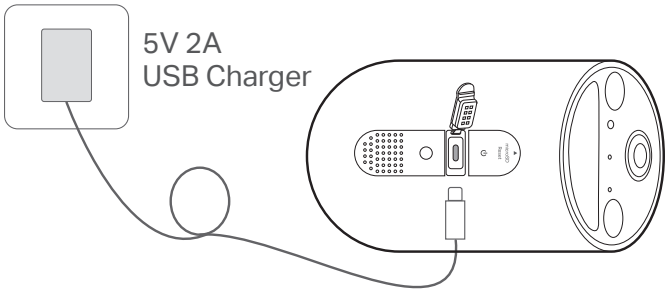



- Note:
1. Peel off film from the camera before use.
 2. Charge the battery using the USB cable in the package. Inappropriate cables may result in slow charging or failure to charge.
 3. Warning: Do not tear off the silicone part by force as it may affect the waterproof performance.
 4. When you plug in the USB charger, the LED should blink amber quickly for 3 seconds. If not, make sure the power is running and check your connection.
 5. Keep the ports firmly covered when not in use to ensure waterproof performance.
 6. The camera may not power up after falling. Plug in the USB charger to power it on again.
 7. Check the battery status on the Tapo app after setup.

2 Set Up the Camera

1. Get the Tapo app from the App Store or Google Play, and log in.



2. Press and hold  on your camera for about 3 seconds to turn it on. Open the Tapo app, tap the  button in the app, and select your model. Then follow the app instructions to set up your camera.

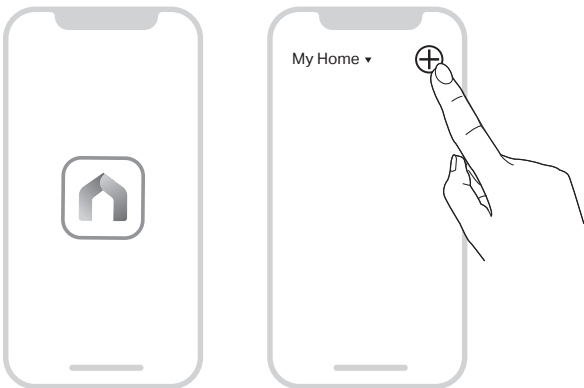

Camera Status LED Indication

Blinking amber quickly for 3 seconds	Plugging in USB charger
Solid red	Starting up
Blinking red and green	Ready for setup
Blinking red slowly	Connecting to Wi-Fi
Solid amber	Connected to Wi-Fi
Solid green	Connected to the cloud
Blinking red quickly	Camera resetting
Blinking green quickly	Camera updating

3 Camera Mounting Tips

1. Avoid placing behind glass. Glass will obstruct the motion sensor of your camera.
2. Choose a proper location to mount your camera, or it will be triggered too often by false alarms.
 - Avoid pointing the camera directly at swaying trees.
 - Avoid pointing the camera directly at vehicles and pedestrians on the road.
 - Avoid pointing the camera directly at street lamps and sunlight.
3. Do not place the camera upside down.
4. Keep the motion sensor level for best results.

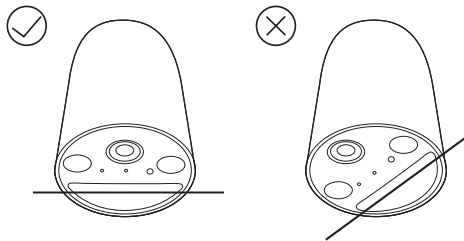

5. Tilt the camera downwards at an angle of about 20°.

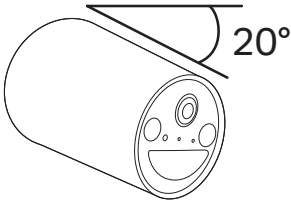

6. Mount your camera to the side so that movement goes across the lens' field of view to better trigger motion detection and AI detection.

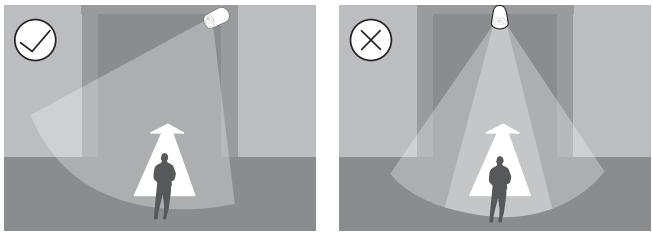

*Do not mount facing the direction of movement.

7. For optimal detection performance, we recommend mounting the camera 7-10 ft (2-3 m) above the ground.

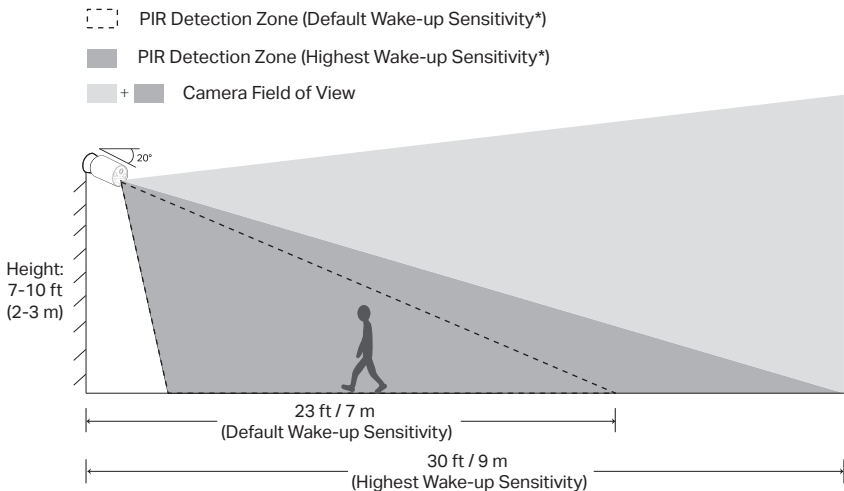

*You can adjust the sensitivity in Camera Settings > Detection > Wake-up Sensitivity. The FOV and PIR detection zone shown is based on camera mounted at 7.2 ft/2.2 m.

4 Mounting Options

Option 1. Set on a Table

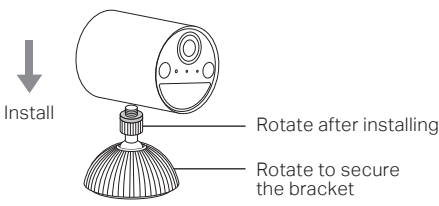

Option 2. Mount to the Wall

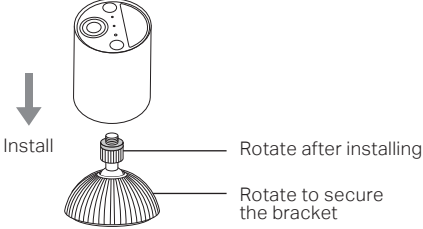

Option 1: Mount to Wall with Bracket

1. Drill Holes

Stick the mounting template of the metal plate to the desired mounting place. Drill 3 holes according to the template.

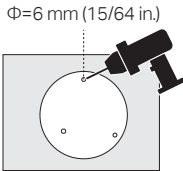

2. Unscrew the Bracket Base

Unscrew the bracket base from the bracket cover.

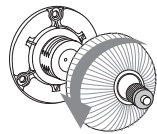

3. Secure Bracket Base

Insert three anchors into the holes and use the screws to affix the bracket base over the anchors. Screw the bracket cover onto the bracket base.

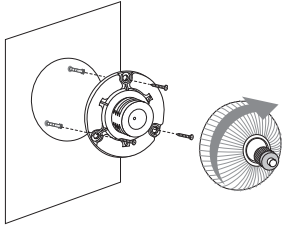

4. Install the Camera

Install the camera on the mounting bracket, and adjust the camera angle.

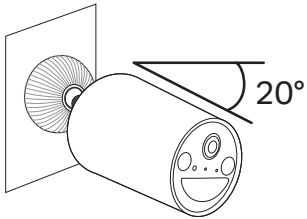
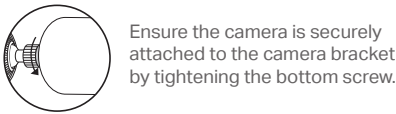

Option 2: Mount to Wall with Metal Plate

1. Drill Holes

Stick the mounting template of the metal plate to the desired mounting place. Drill 3 holes according to the template.

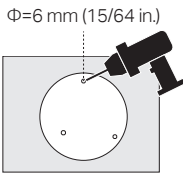

2. Install Camera

Insert 3 anchors into the holes and use the screws to affix the metal plate over the anchors. Then attach the camera to the plate.

Note: Ensure the metal plate's concave-holed side faces the magnetic base. The height of magnetic attraction installation shall not exceed 2m.

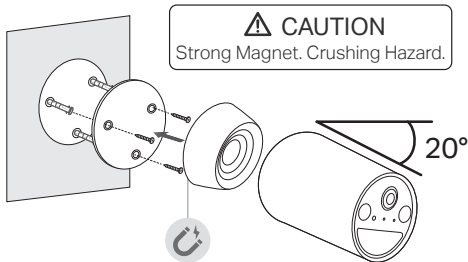

? Have a Tapo Solar Panel?

The Tapo Solar Panel charges your Wire-Free Indoor/Outdoor Security Camera continuously.

1. Install Waterproof Gasket

Insert the waterproof gasket into the camera's charging port. Ensure that the gasket is tightly sealed.

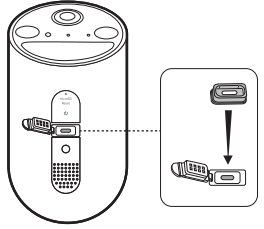

2. Power On Camera

Connect the solar panel by inserting the connector into the charging port until snug.

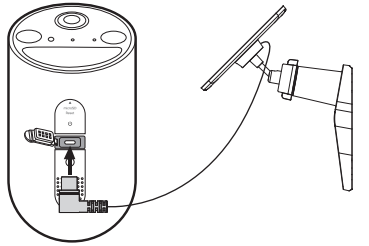

Note: If you use a third-party solar panel to charge this camera, we cannot guarantee the waterproof performance.

Appearance

Front

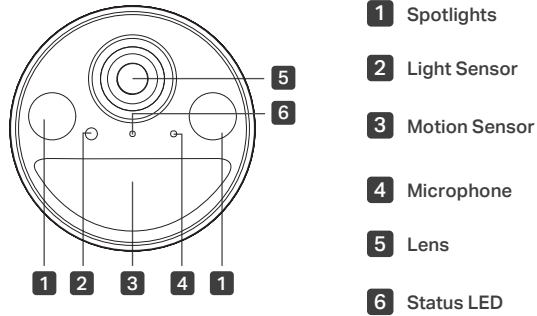

Side

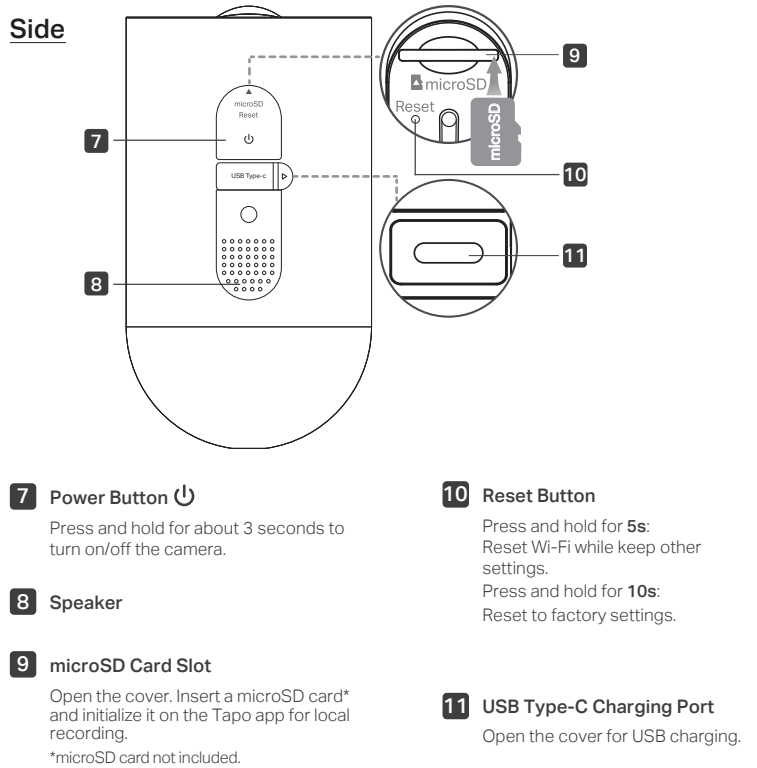

Safety Information

TP-Link hereby declares that the device is in compliance with the essential requirements and other relevant provisions of directives 2014/53/EU, 2009/125/EC, 2011/65/EU and (EU)2015/863. The original EU declaration of conformity may be found at <https://www.tapo.com/support/ce>
TP-Link hereby declares that the device is in compliance with the essential requirements and other relevant provisions of the Radio Equipment Regulations 2017. The original UK declaration of conformity may be found at <https://www.tapo.com/support/ukca/>

- This equipment can be powered only by equipments that comply with Power Source Class 2 (PS2) or Limited Power Source (LPS) defined in the standard of IEC 62368-1.
- Do not use damaged charger or USB cable to charge the device.
- Do not use any other chargers than those recommended.
- Do not use the device where wireless devices are not allowed.
- Adapter shall be easily accessible.
- Use only power supplies which are provided by manufacturer and in the original packing of this product. If you have any questions, please don't hesitate to contact us.
- Keep the device away from fire or hot environments. DO NOT immerse in water or any other liquid.
- Do not disassemble, repair or modify the product.
- Do not place near automatically controlled devices such as fire alarms. Radio waves emitted from this product may cause such devices to malfunction resulting in an accident.
- Observe restrictions on using wireless products in fuel depots, chemical plants or when blasting operations are in progress.
- Do not use liquid to clean the product. Only use a dry cloth.
- Never put metal objects inside the product. If a metal object enters the product turn off the circuit breaker and contact an authorised electrician.
- This product is not intended to be used when providing medical care. Consult the manufacturer of any personal medical devices, such as pacemakers or hearing aids to determine if they are adequately shielded from external RF (radio frequency) energy.
- Do not use this product in health care facilities. Hospitals or health care facilities may be using equipment that could be sensitive to external RF energy.
- Do not place heavy objects on top of the product.
- When you leave the product unused for a long time unplug the product from the power outlet.
- This product may interfere with other electronic products such as TV, radios, personal computers, phones or other wireless devices.

- Operating Temperature: -20°C ~ 45°C (-4°F ~ 113°F)
- Adapter should be used indoors where the ambient temperature is lower than or equal to 40°C.

CAUTION!

Avoid replacement of a battery with an incorrect type that can defeat a safeguard. Avoid disposal of a battery into fire or a hot oven, or mechanically crushing or cutting of a battery, that can result in an explosion. Do not leave a battery in an extremely high temperature surrounding environment that can result in an explosion or the leakage of flammable liquid or gas; Do not leave a battery subjected to extremely low air pressure that may result in an explosion or the leakage of flammable liquid or gas.

Please read and follow the above safety information when operating the device. We cannot guarantee that no accidents or damage will occur due to improper use of the device. Please use this product with care and operate at your own risk.

OPERATING FREQUENCY(the maximum transmitted power)
2412MHz -2472MHz(20dBm). 5150 MHz -5250 MHz(20.3dBm). 5250 MHz -5350 MHz (19.66dBm). 5470 MHz -5725 MHz (19.72dBm)

This device meets the EU requirements (2014/53/EU Article 3.1a) on the limitation of exposure of the general public to electromagnetic fields by way of health protection.

Attention: In Great Britain, the operation in the frequency range 5150MHz - 5350MHz is only permitted indoors. Attention: In EU member states, EFTA countries and Northern Ireland, the operation in the frequency range 5150MHz - 5350MHz is only permitted indoors.

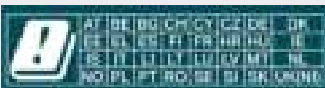

USA Statement

This equipment has been tested and found to comply with the limits for a Class B digital device, pursuant to part 15 of the FCC Rules. These limits are designed to provide reasonable protection against harmful interference in a residential installation. This equipment generates, uses and can radiate radio frequency energy and, if not installed and used in accordance with the instructions, may cause harmful interference to radio communications. However, there is no guarantee that interference will not occur in a particular installation. If this equipment does cause harmful interference to radio or television reception, which can be determined by turning the equipment off and on, the user is encouraged to try to correct the interference by one or more of the following measures:

- Reorient or relocate the receiving antenna.
- Increase the separation between the equipment and receiver.
- Connect the equipment into an outlet on a circuit different from that to which the receiver is connected.
- Consult the dealer or an experienced radio/TV technician for help.

FCC Radiation Exposure Statement

This device complies with FCC radiation exposure limits set forth for an uncontrolled environment and it also complies with Part 15 of the FCC RF Rules. This equipment must be installed and operated in accordance with provided instructions and the antenna(s) used for this transmitter must be installed to provide a separation distance of at least 20 cm from all persons and must not be co-located or operating in conjunction with any other antenna or transmitter. End-users and installers must be provided with antenna installation instructions and consider removing the no-collocation statement.

This device complies with Part 15 of the FCC Rules. Operation is subject to the following two conditions:

- (1) this device may not cause harmful interference, and
- (2) this device must accept any interference received, including interference that may cause undesired operation.

Caution!
Any changes or modifications not expressly approved by the party responsible for compliance could void the user's authority to operate the equipment.

Canada Statement

This device contains licence-exempt transmitter(s)/receiver(s) that comply with Innovation, Science and Economic Development Canada's licence-exempt RSS(s).

Operation is subject to the following two conditions:

- (1) This device may not cause interference.
- (2) This device must accept any interference, including interference that may cause undesired operation of the device.

L'émetteur/récepteur exempt de licence contenu dans le présent appareil est conforme aux CNR d'Innovation, Sciences et Développement économique Canada applicables aux appareils radio exempts de licence. L'exploitation est autorisée aux deux conditions suivantes :

- 1) L'appareil ne doit pas produire de brouillage;
- 2) L'appareil doit accepter tout brouillage radioélectrique subi, même si le brouillage est susceptible d'en compromettre le fonctionnement.

The device meets the exemption from the routine evaluation limits of RSS 102 and compliance with RSS-102 RF exposure, users can obtain Canadian information on RF exposure and compliance.
Le dispositif rencontre l'exemption des limites courantes d'évaluation dans de RSS 102 et la conformité à l'exposition de RSS-102 rf, utilisateurs peut obtenir l'information canadienne sur l'exposition et la conformité de rf.

This transmitter must not be co-located or operating in conjunction with any other antenna or transmitter. This equipment should be installed and operated with a minimum distance of 20 centimeters between the radiator and your body.
Cet émetteur ne doit pas être Co-placé ou ne fonctionnant en même temps qu'aucune autre antenne ou émetteur. Cet équipement devrait être installé et actionné avec une distance minimum de 20 centimètres entre le radiateur et votre corps.

for devices with detachable antenna(s), the maximum antenna gain permitted for devices in the bands 5250-5350 MHz and 5470-5725 MHz shall be such that the equipment still complies with the e.i.r.p. limit;
le gain maximal d'antenne permis pour les dispositifs utilisant les bandes 5250-5350 MHz et 5470-5725 MHz doit se conformer à la limite de p.i.r.e.;