

## Smart Watch

### Quick Tour



Please read the manual carefully before use  
and keep it properly for future use

## Watch management

- Packing list
- Appearance introduction
- Screen operation
- Key operation
- Paired connection
- Charge
- Features
- NFC

## Headphone management

- Handling and wearing headphones
- Paired connection
- Gesture control headphones

## More guidance

- Precautions
- Performance parameters
- Frequently Asked Questions
- After-sales service instructions
- Warranty Card

## Packing list

Watch host x 1    Charging Cable x 1  
watch strap x 1    quick guide x 1

## Appearance introduction

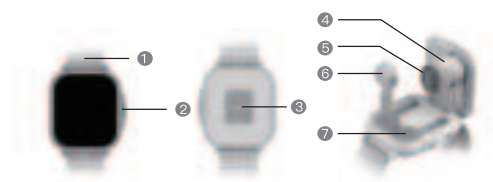

- ① wristband
- ② Function keys Power key
- ③ sensor
- ④ Right earphone
- ⑤ The left ear of the watch cover hangs
- ⑥ left earphone
- ⑦ Headphone compartment

※ In order to make the measurement more accurate, please wear the watch on your wrist away from the wrist bones and wear it snugly against your skin. But don't be too tight

## Screen operation

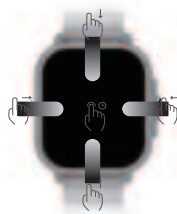

Slide down: message notification

Swipe up: Control Center

Swipe right: shortcut function

Swipe left: function menu

Long press: switch dials

Screen-holding: Cover the screen with your palm

## Key operation



Function keys Power key

- ❶ Power on: Press and hold for 3 seconds until the screen lights up
- ❷ Power on: Press and hold for 3 seconds until the screen lights up
- ❸ Short press to light up the screen
- ❹ Double-click the button to enter menu mode

※ If power on fails after long pressing the power button for 3 seconds, please charge and try again.

## Paired connection

### Download App



Scan the QR code to download and install

Download the App: Search in the App Store for IOS system phones "Heylink", Android and Hongmeng system phones can be purchased from other application providers. Search "Heylink" in the store (such as App Store) to download it; or scan the code to download Download and install

### Make a pair

#### Method one

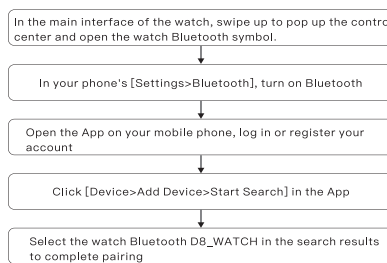

## Method two

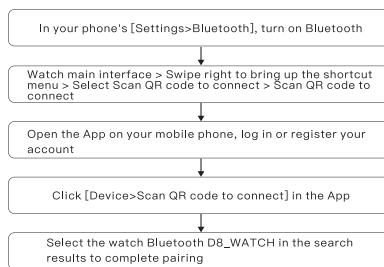

- ※ Please keep the power of the watch above 20% before pairing to avoid pairing failure due to insufficient power.
- ※ During pairing and connection, make sure the watch's Bluetooth is turned on and within effective connection distance to the watch.
- ※ This device requires Android7.0 and above systems, IOS11 and above systems, Homony3.0 and above systems
- ※ For low-version systems, if the Bluetooth connection fails, you need to manually find D8\_WATCH in the phone settings and connect manually.

## Charge

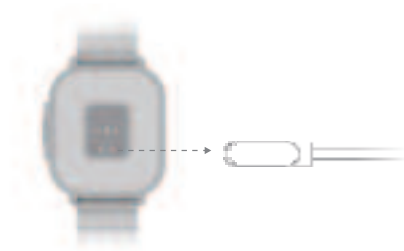

Align the charging cable with the top pin on the bottom case boss until the charging indicator appears on the watch screen.

This device is an all-in-one machine. The back shell and battery are not removable. Please note that the following matters:

1. Do not open or hit the back case of the device.
2. Please do not disassemble, replace or open the battery.
3. Equipment and batteries must be disposed of in compliance with local environmental protection laws.
4. Charging time: 1–2h.

※ Please keep the charging port clean and dry before charging to avoid corrosion of metal contacts and other risks.

## Features

### ① Dial switch



Press and hold on the home screen for 2 seconds to enter the dial switching interface. slide left or right to switch the watch faces to be selected, click to select set the dial.。

### ② Control panel



Swipe on the home screen to bring up the control panel, functionsOverview: charging status of left and right earphones, Bluetooth, supportPaypal, search for mobile phone, battery, brightness adjustment, mobile phoneFlashlight, Do Not Disturb, NFC.

### ③ Fitness records



Displays the number of steps, distance and calories recorded on the dayAccording to the data, the target can be set in the App.

### ④ Sports



Sports mode options: outdoor walking, outdoor running, indoor walking,Badminton, indoor running, outdoor cycling, indoor cycling, triathlonItems, hiking, elliptical machines and more. Click on the icon to start exercising.



#### ⑤ Breathe



The breathing rhythm can be adjusted according to the animation frequency.

#### ⑥ Heart rate



Turn on scheduled detection on the App, enter this interface, and click TestMeasure a single heart rate value, and each detection data will be displayed in the timetable. The corresponding value is generated on the grid.

#### ⑦ Sleep



This interface displays the sleep monitoring status, and the data is updated every day. Connect to the App to upload and save data simultaneously.

#### ⑧ Blood pressure



When entering the blood pressure measurement interface, the green light at the bottom lights up to start measurement. Complete the measurement in 30–60 seconds, the measurement at this time is the basic measurement based on PPG technology.

9 Blood oxygen



When entering the blood pressure measurement interface, the green light at the bottom lights up to start measurement, complete the measurement in 30-60 seconds, the measurement at this time is the basic measurement based on PPG technology.

10 Side menu



Swipe right on the main interface to bring up the side shortcut menu. Calendar, weather, day of the week, connection instructions, shortcuts mark.

11 Map positioning



After the App is successfully connected the current position.

12 Address book



You can add, delete contact.

#### ⑬ Dial



After using the mobile phone to connect to the Bluetooth call, it can be used normally. Dial function.

#### ⑭ Music



Click the middle button to play or pause mobile music. Can also go to previous/next song.

#### ⑮ Weather



After the watch is connected to the App and location permission is enabled, the weather The interface will display real-time weather temperature and weather type.

#### ⑯ Alarm clock



You can set a single alarm clock and a recurring alarm clock

#### 17 Stopwatch



This interface has a stopwatch function and can also set segments Timing.

#### 18 Timer



In the timer function, users can quickly start timing through the system's preset time, or click the custom button to set the time.

#### 19 Information



Turn on the push of relevant information on the App side, and the watch side can receive the corresponding push information (you need to open the Permissions)

#### 20 Looking for mobile phone



When the phone and the App are connected, click to search for the phone. The phone will ring and the watch will display that the search is successful. If the watch is not connected to the App, the watch will prompt that it is not connected.

21 Game centre



Provides a variety of games to choose from.

22 Calculator



Open the calculator to perform calculations.

23 Alipay



Follow the prompts to perform connection binding.Quick payment.

24 Calendar



Check calendar dates to plan your time and use time.

#### Notification function



**Alarm reminder**  
Set and turn on **alarm** reminder.



**Sedentary reminder**  
It can be turned on in the App [Settings>Health Check>Sedentary Reminder].After turning it on, you can set the start, end time, and do not disturb time.



**Incoming call**  
You can answer or reject the **call**.

## Headphone management

### Handling and wearing headphones

#### Take out the headphones

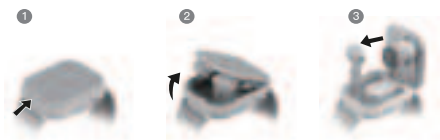

Place your fingers on the clasp and turn upwards

Lift the cover up

Stop when it reaches 90 degrees and take out the headphones

#### Place the headphones

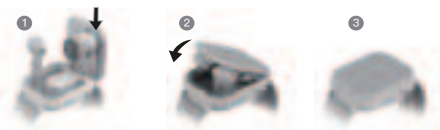

Place the earphones into the groove on the inside of the upper cover (note: the left and right ear directions of the earphones correspond to the left and right directions on the inside of the watch cover directionn

Gently turn the watch cover down. Automatically close

Close the cover

## Paired connection

After taking out the headset, turn on the Bluetooth of your phone, find the headset Bluetooth D8-TWS, and click to connect.

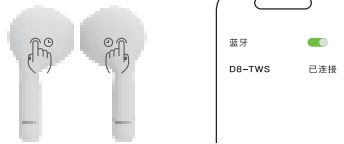

## Gesture control headphones

Wear on both ears

Music status: Click the left or right ear to play or pause/triple-click the voice assistant; double-click the previous song on the left ear/long press to decrease the volume, double-click the next song on the right ear/long press to increase the volume.

One ear wear

Music status: Double-click the next song, long-press to increase the volume, and the other settings are the same as for both ears.

Call: single click to answer/hang up, long press to reject; long press to increase volume during the call.

Press and hold for 5 seconds to turn on the phone, and it will automatically pair when it comes out of the warehouse. After connecting once, it will automatically connect to the phone and turn the sound into headphones when it comes out of the warehouse.

It will automatically shut down if Bluetooth is not connected for a certain period of time after leaving the warehouse.



## Notes

- ❶ Please do not disassemble, repair or retrofit the product without authorization.
- ❷ Please do not crash the product with force, or else the product may be damaged.
- ❸ Please keep it away from high-intensity magnetic field, direct sun light or high temperature.
- ❹ The product shall not be used for diagnosis, treatment and prevention of diseases.
- ❺ The waterproof level of this product is non-waterproof and cannot be immersed in water.
- ❻ Please do not keep the watchband too tight. Please keep it clean where the watch contacts your skin.
- ❼ In order to prevent damage, children should use the product under the guidance of parents.

## Performance Parameters

Product name: SMART WATCH

Model: D8

Display screen: 2.01TFT color screen, 240×296 pixel resolution

Waterproofing grade: Not waterproof

Sensor: triaxial G-sensor

Maximum endurance: 5-7 days

Operating temperature: -10°C~50°C

Battery type: polymer lithium battery

## FAQ

### Fail to start the watch

- Press the power switch for more than 3s.
- Maybe the battery level is too low. Please charge the battery timely.

### The bluetooth is cannot be connected

- Please restart the watch and connect again.
- Please restart the mobile phone bluetooth and connect again.
- Do not connect your mobile phone to other bluetooth device at the same time.

### **The measurement of heart rate/blood oxygen is inaccurate**

- General, it is caused by poor contact between the watch sensor and human body.
- Please ensure that the sensor contacts the wrist well during measurement.
- Please keep your body still and the watch attached to your wrist tightly during measurement.
- For people who have dark skin color and have thick hair on the arm, please open intensified measurement through [device>intensified measurement] on the App.

### **Sleep data is not accurate enough**

- Sleep monitoring simulates the status of natural sleep and getting up of human, and you should wear it as usual.
- If you sleep too late or you do not wear the watch until you go to sleep, there may be some error.
- It does not monitor the sleep data during daytime. The default time for sleep monitoring is from 9:30 in the evening to 12:00 at noon on the next day.

※ For more frequently asked questions, please view [My>FAQ] on the App.

### **After-sale Service**

Dear user, thank you for using the product. We are glad to provide the following after-sales services for you:

You can return goods for quality problems within 7 days after purchasing the product,  
We can exchange goods for you for quality problems within 30 days.

During the use of product, return of goods will not be accepted under one of the following conditions:

- 1.Damages to the product due to falling off during the use.
- 2.Breakdown of product due to disassembly and transformation without authorization.
- 3.Breakdown of product caused by improper service environment which does not accord with the product requirements.
- 4.Damages to the product caused by force majeure (such as fire and earthquake).

Warranty Card

User information

Name : ..... Telephone : .....

Postcode : ..... Email : .....

Mailing address : .....

Sales information

Sales unit : ..... Telephone : .....

Invoice number : ..... Date of purchase : .....

Sales address : .....

Product information

Product name : ..... Product model : .....

FCC Warning:

This equipment has been tested and found to comply with the limits for a Class B digital device, pursuant to part 15 of the FCC Rules. These limits are designed to provide reasonable protection against harmful interference in a residential installation. This equipment generates, uses and can radiate radio frequency energy and, if not installed and used in accordance with the instructions, may cause harmful interference to radio communications. However, there is no guarantee that interference will not occur in a particular installation. If this equipment does cause harmful interference to radio or television reception, which can be determined by turning the equipment off and on, the user is encouraged to try to correct the interference by one or more of the following measures:

- Reorient or relocate the receiving antenna.
- Increase the separation between the equipment and receiver.
- Connect the equipment into an outlet on a circuit different from that to which the receiver is connected.
- Consult the dealer or an experienced radio/TV technician for help.

Caution: Any changes or modifications to this device not explicitly approved by manufacturer could void your authority to operate this equipment.

This device complies with part 15 of the FCC Rules. Operation is subject to the following two conditions:

(1) This device may not cause harmful interference, and (2) this device must accept any interference received, including interference that may cause undesired operation.

This equipment complies with FCC radiation exposure limits set forth for an uncontrolled environment. This equipment should be installed and operated with minimum distance 0cm between the radiator and your body.