

FCC Statement

Warning: Changes or modifications to this unit not expressly approved by the party responsible for compliance could void the user's authority to operate the equipment.

NOTE: This equipment has been tested and found to comply with the limits for a Class B digital device, pursuant to Part 15 of the FCC Rules. These limits are designed to provide reasonable protection against harmful interference in a residential installation. This equipment generates, uses and can radiate radio frequency energy and, if not installed and used in accordance with the instructions, may cause harmful interference to radio communications.

However, there is no guarantee that interference will not occur in a particular Installation. If this equipment does cause harmful interference to radio or television reception, which can be determined by turning the equipment off and on, the user is encouraged to try to correct the interference by one or more of the following measures:

- Reorient or relocate the receiving antenna.
- Increase the separation between the equipment and receiver.
- Connect the equipment into an outlet on a circuit different from that to which the receiver is connected.
- Consult the dealer or an experienced radio/TV technician for help.

This device complies with Part 15 of the FCC Rules. Operation is subject to the following two conditions:

- (1) This device may not cause harmful interference.
- (2) This device must accept any interference received, including Interference that may cause undesired operation.

ISED Regulatory Compliance

This device contains license-exempt transmitter(s)/receiver(s) that comply with Innovation, Science and Economic Development Canada's license-exempt RSS(s). Operation is subject to the following two conditions:

1. This device may not cause interference.
2. This device must accept any interference, including interference that may cause undesired operation of the device.

L'émetteur/récepteur exempt de licence contenu dans le présent appareil est conforme aux CNR d'Innovation, Sciences et Développement économique Canada applicables aux appareils radio exempts de licence. L'exploitation est autorisée aux deux conditions suivantes :

1. *L'appareil ne doit pas produire de brouillage;*
2. *L'appareil doit accepter tout brouillage radioélectrique subi, même si le brouillage est susceptible d'en compromettre le fonctionnement.*

RF Exposure Compliance

This equipment complies with FCC/IC radiation exposure limits set forth for an uncontrolled environment.

This equipment should be installed and operated with minimum distance 20cm between the radiator and your body.

Cet équipement est conforme aux limites d'exposition aux radiations FCC/IC établies pour un environnement non contrôlé.

Cet équipement doit être installé et utilisé avec une distance minimale de 20 cm entre le radiateur et votre corps.

EU Compliance

VuPoint (Europe) Company Limited declares that the equipment complies with Directive 2014/53/EU.

Full declaration text available at:

www.toucansolution.com/pages/certificate



VuPoint Solutions, Inc. (USA):
710 Nogales Street, City of Industry, CA 91748

VuPoint (Europe) Company Limited:
Innovation Center, Longbridge Technology Park,
Longbridge, Birmingham B31 2TS



For additional info, visit our website at www.toucansolution.com

©2022 VUPOINT SOLUTIONS, INC. All Rights Reserved.
The Toucan logo and Toucan are trademarks or registered trademarks of VuPoint Solutions Inc. in the United States and other countries. The Bluetooth® word mark and logos are registered trademarks owned by Bluetooth SIG, Inc. Product names, logos, brands and other trademarks referred to herein are the property of their respective trademark holders. All trademarks remain the property of their respective holders, and are used only to describe the products or services being provided. These trademark holders are not affiliated with VuPoint Solutions, Inc. They do not sponsor or endorse VuPoint Solutions, Inc's products or services.



Thank You
for Purchasing
**VIDEO
CONFERENCE
SYSTEM HD**

SC100

What's in the Box

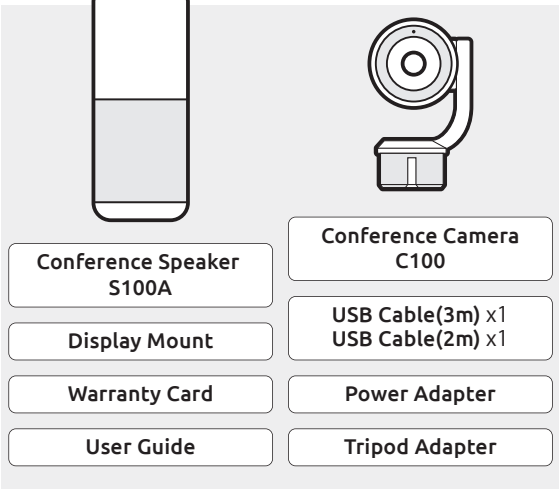

Getting to know your
Video Conference System HD SC100

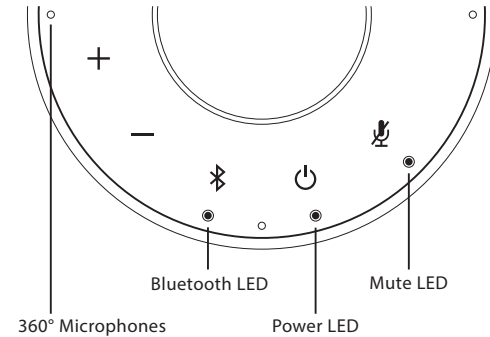

- + Volume up**
Tap to increase volume
- Volume down**
Tap to reduce volume
- Bluetooth**
Connect with new Bluetooth device
Press and hold to enter Bluetooth pairing mode to connect with a new Bluetooth device
Disconnect or reconnect with Bluetooth device
Tap to disconnect or reconnect with a paired Bluetooth device
- Power On/Off**
Press and hold to turn S100 on/off
- Mute**
Mute microphone
Tap to mute or unmute microphone
Voice guidance
Press and hold 10s to turn voice guidance on/off

Getting Started

1 Turn on SC100

- Remove the top cover of S100A conference speaker and snap in C100 conference camera module.
- Plug the included power adapter into a power outlet and connect the other end to S100A
- Press and hold [⏻] on the top of the speaker for 1 second to turn S100A on and 2 seconds to turn it off.

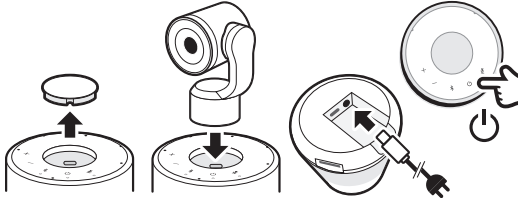

2 Connect SC100 to your computer

- Plug the included USB cable into your computer and connect the end with the type-C connector to SC100.
- Select S100A as the default microphone and speaker source. Select C100 as the default camera source.

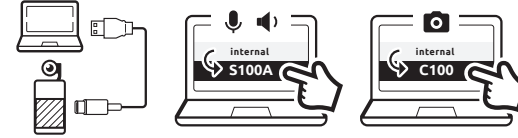

3 Connect SC100 with a Bluetooth Device (Audio Only)

- Press and hold [🔊] for 2 seconds until the Bluetooth LED on S100A begins flashing. You will hear connection guidance voice prompts.
- Enable Bluetooth on your Bluetooth device.
- Select S100A from the list of available Bluetooth devices to connect.
- You will hear a successful connection message from S100A.
- Tap [🔊] to disconnect with connecting Bluetooth device.

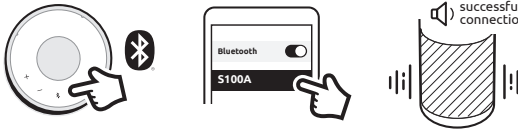

4 Mute/Unmute

- Tap [🔊] while calling to mute or unmute the microphone.

Mount C100 on Display

- Snap C100 into tripod adapter and attach it to the included display mount.
- Mount C100 on top of the display and adjust the camera view to correct position.
- Plug the included USB cable into either USB port at the bottom of S100A and connect the other end with the type-C connector to C100
- Select S100A and C100 as the default audio and video source on your computer

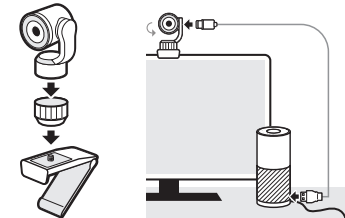

USB3.0 Port Maximum Output Rating: DC5V/500mA



For detailed product information, set up procedures and FAQ's please visit our website: www.toucansolution.com or scan the QR code.