

The following features are available in this PDF document.



### **Quick Keyword Search**

Enter the keyword in the search box and hit the search button



### **Quick Jump between Chapters**

Click the title of a specific chapter on the Contents to jump to it

\*Reading software such as Adobe Reader is needed to support the functions above.



# **ZHIYUN CINEPEER C100**

User Guide

# Contents

□ Brief Introduction	
Brief Introduction	1
□ Product List	
Product List	3
□ Get to Know ZHIYUN CINEPEER C100	
Get to Know ZHIYUN CINEPEER C100	5
□ Charging	
Charging	6
□ Installing Modifiers	
Installing and Removing the Barn Doors	7
Installing and Removing the Diffuser	9
Installing and Removing the Grid	10
Installing and Removing the Light Clamp	11
Installing and Removing the Stick Light Connector	12
□ How to Use ZHIYUN CINEPEER C100	
Buttons and Dials	13
Operation Instruction	14
□ Firmware Upgrade	
□ Product Specifications	
□ Disclaimer and Warnings	
Reading Tips	22
Safe Operation Instructions	22

☐ Warranty Card

Warranty Period . . . . . 23

Warranty Exclusions . . . . . 23

Warranty Claim Procedure . . . . . 23





☐ Contact Card

## Brief Introduction

The ZHIYUN CINEPEER C100 is a high-intensity, portable handheld LED fill light. Despite its compact size, it boasts powerful performance and offers various features, including adjustable color temperature, green-magenta value, hue, and color saturation. It comes with multiple full-color light effects, allowing for effortless and creative shooting. With its modifiers, users can precisely and swiftly shape the lighting. This product has wide applications in video recording, live streaming, still-life photography, wedding photography, artistic light painting, and other scenarios. The key highlights of the product are as follows:

1. Lightweight, portable, easy to operate, and with outstanding performance.
2. High power, high brightness, high color rendering index, strong fill light performance, accurately reproducing true colors of objects.
3. Comes with music mode and various pixel effects, allowing for more creative shooting.
4. Supports multiple power supply options, eliminating battery life concerns.
5. Supports Bluetooth mesh networking, and remote dimming via the app, enhancing lighting efficiency and convenience of operation.
6. Equipped with a U-shaped frosted light shade, providing a soft light effect.
7. Supports handheld, tripod mounting, light stand installation, multi-light combination, and clamp mounting, offering various installation options.
8. Features DynaVort Cooling System with excellent heat dissipation performance.
9. Rich modifiers for more efficient light shaping.

### **WARNING**

-  This product is not waterproof. Prevent contact with any kind of liquid with the ZHIYUN CINEPEER C100. Never use the product in the rain or a humid environment.
-  If water accidentally enters the device when using, please stop using it immediately and contact the company or authorized maintenance personnel for maintenance, and continue to use it only when the maintenance is finished.
-  Do not expose this product to corrosive chemicals, inflammable and explosive materials.
-  Do not touch the heating part when the product is working to avoid getting burned.

- ⚠ Do not wrap or block the fans to avoid cooling effect damage.
- ⚠ Do not turn the product directly to the eyes to avoid eyesight damage.
- ⚠ Do not expose this product to an environment above 40°C .
- ⚠ Battery safety precautions:
  - ① It is strictly prohibited to use batteries that are not provided by ZHIYUN.  
If you need to replace the battery, please contact ZHIYUN or designated agents. ZHIYUN will not be responsible for any battery accidents or equipment malfunctions caused by using batteries that are not officially provided by ZHIYUN.
  - ② If the battery bulges, leaks, or has other abnormalities, please stop using it immediately and contact ZHIYUN customer service or designated agents for further processing.
  - ③ Do not completely discharge the battery and store it for a long time to prevent the battery from entering an over-discharged state and causing damage to the battery cell, which may make it impossible to recover and reuse.

### BE CAREFUL

1. This product is a high-precision control device. Damage may be caused to the product if dropped or subject to external force, and this may result in malfunction.
2. Please keep your hands dry while using the product and use a soft dry cloth for cleaning.
3. Keep this product out of the reach of children.
4. When not using this product, please disconnect the external power supply.
5. Do not place any other items on top of this product to avoid damage to this product.
6. Protect the product from dust and sand during use.
7. Before storing this product, please make sure it is completely cooled and store it in a dry and ventilated place.
8. Do not disassemble this product on your own. In the event of malfunctions, it should be repaired by ZHIYUN or authorized maintenance personnel.

**Product List**

Before using this product, please check carefully that all the following items are included in the product package. In case that any item is found missing, please contact ZHIYUN or your local selling agent.



Main Device x1

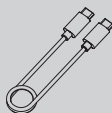

USB Type C Cable x1



Barn Doors x1

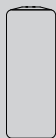

Diffuser x1

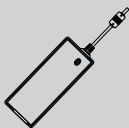

DC Power Adapter x1\*

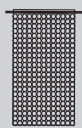

Power Adapter Organizer Bag x1\*



Grids x1\*



Light Clamp x1\*

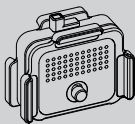

Stick Light Connector x1\*\*

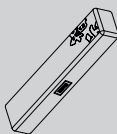

Storage Bag x1



Quick Start Guide x1

Items marked “\*\*” are only included in ZHIYUN CINEPEER C100 COMBO package.  
Items marked “\*\*\*” should be purchased separately.



## Get to Know ZHIYUN CINEPEER C100

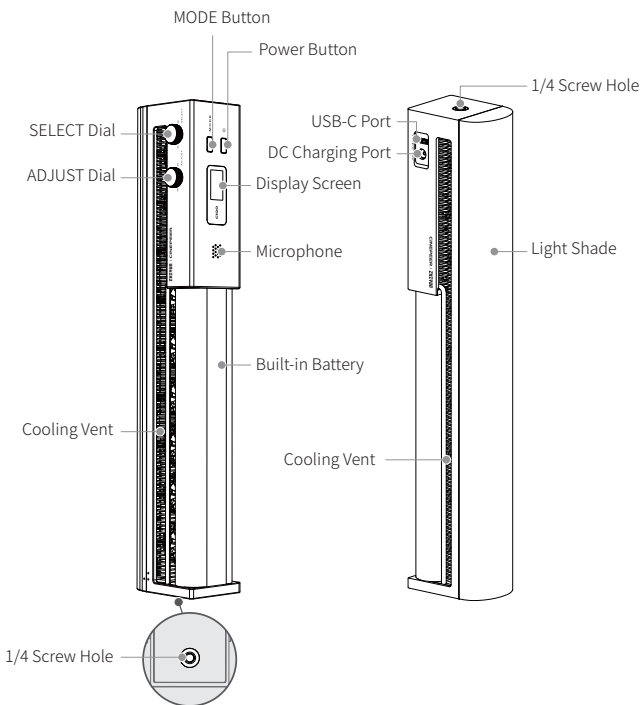

## Charging

CINEPEER C100 adopts high-capacity built-in lithium battery, providing a solidly long runtime. The battery level is displayed on the screen. The following methods show how to charge your CINEPEER C100 (you can still use the light when charging):

- ① Charging with USB adapter: Use a Type-C cable to connect the USB adapter to the Type-C port of the CINEPEER C100 and plug the USB adapter into an AC socket. It is recommended to use a USB adapter that meets the PD fast charging protocol and is higher than 100W in power. When charging while in use, the USB adapter prioritizes power supply for the light. Any remaining power will be used to charge the battery, with a maximum charging power of 35W.
- ② Charging with DC power adapter: Connect the DC Power Adapter to the DC charging port and an AC socket to charge C100.

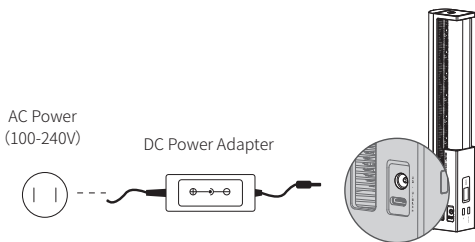
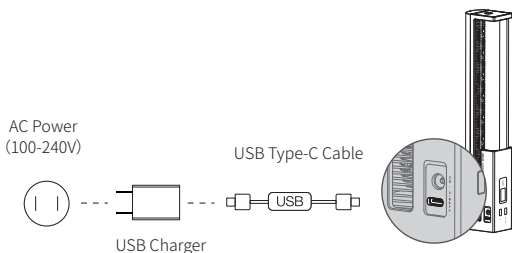

- 💡 ① It is recommended to fully charge C100 before using it. Low battery might impair the product performance.
- ② USB adapter is not provided.
- ③ You can use a power adapter organizer bag to pack up the DC adapter and hang it in a suitable place to prevent it from being stepped on.

## Installing and Removing the Barn Doors

### Installing:

Install the barn doors onto the ZHIYUN CINEPEER C100 as shown in the figure ① , until the end of the barn doors is level with the end of the light body. Press down the two U-shaped clips on the barn doors ② until the light body is fully inserted into the U-shaped clips, completing the installation. Adjust the position of the side panels as needed for use ③ .

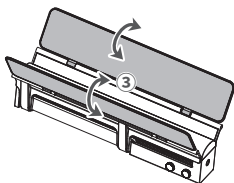
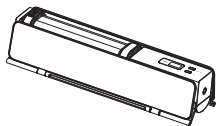
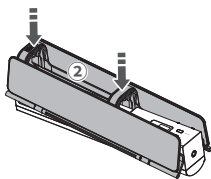
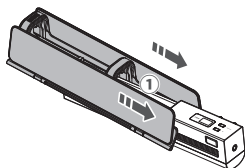

**Removing:**

Fold the side panels of the barn doors to the position shown in the figure ① . Hold the side panels with both hands, and at the same time, use your thumbs to push the light body from the outside of the U-shaped clip above the barn doors ② . Use the same method to push the middle part of the light body out of the U-shaped clip of the barn doors. Finally, remove the barn doors from the light body in the direction shown in the figure ③ .

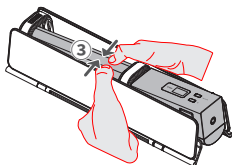
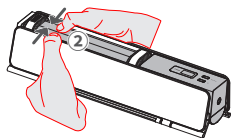
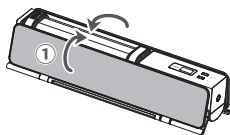

## Installing and Removing the Diffuser

### Installing:

Install the barn doors to the light and expand the barn doors to both sides to their vertical state ① . Attach the diffuser to the barn doors side panels until the diffuser completely covers the LED chips ② . Push the barn doors outward to put up the diffuser ③ .

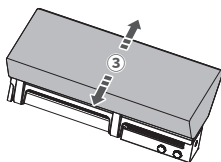
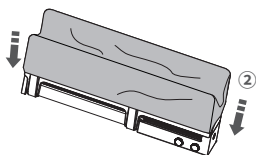
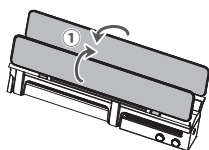

### Removing

Push the side panels inward until the spacing of two side panels becomes smaller ① and remove the diffuser from the barn doors ② .

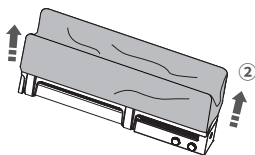
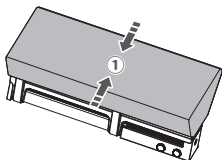

## Installing and Removing the Grids

### Installing:

Install the barn doors to the light and expand the barn doors to both sides to their vertical state ① . Loosen the straps and make sure both sides of the grids are aligned with the barn doors ② . Push the grid to engage in the barn doors ③ and stick the straps to the other side of the grid.

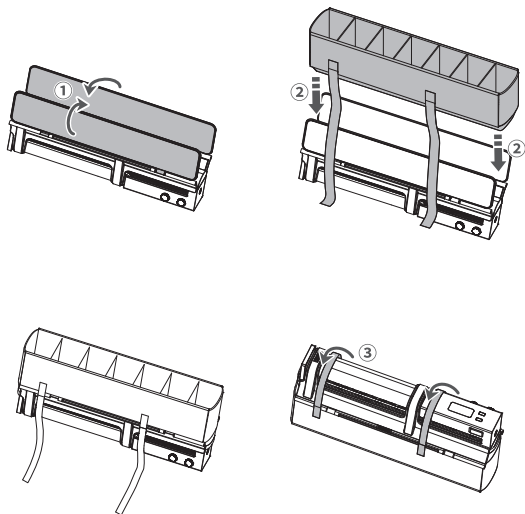

### Removing:

Loosen the straps ① and remove the grid from the barn doors ② .

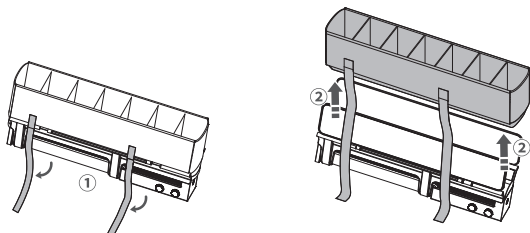

## Installing and Removing the Light Clamp

Install the light clamp onto the ZHIYUN CINEPEER C100 and tighten it, then install the whole assembly onto the crossbar of the C-stand adapter. When disassembling, remove the light and the light clamp assembly from the crossbar of the C-stand adapter, then remove the light clamp from the light body.

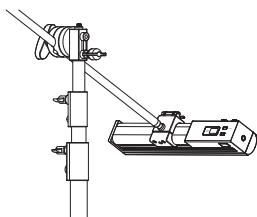
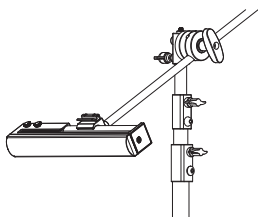
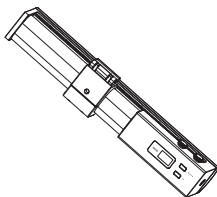
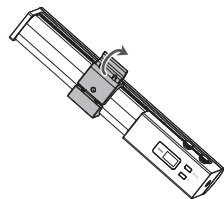

💡 Light stand, C-stand and its adapter are not provided and need to be prepared separately.

## Installing and Removing the Stick Light Connector

Unlock the stick light connector ① and separate it ② . Install the two parts to two stick lights respectively ③ , join two stick lights together with the connector, and the connector will lock automatically ④ . When disassembling, unlock the stick light connector and separate two stick lights, then remove the connector from the stick light.

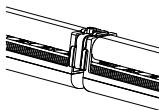
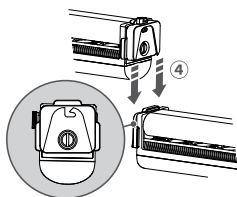
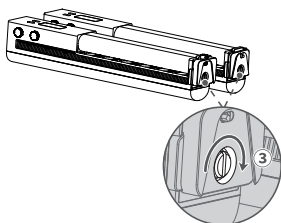
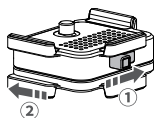



⚠ DO NOT stare at the LED chips when the device is operating.

⚠ The IP rating of the outer case is IP20.

💡 ① During the use of the light, when the temperature rises to a certain degree, the fan will automatically turn on for heat dissipation.

② When the temperature is too high, the high-temperature protection mechanism of the light will be activated to ensure the safe use of the light.

## Buttons and Dials

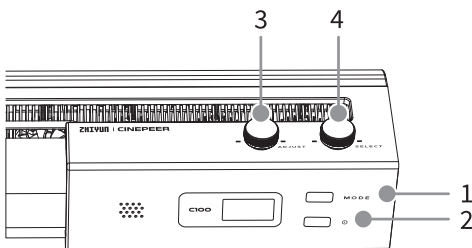

### 1. MODE Button:

Single press:

Cycle through the modes.

Double press:

Return to the previous mode.

### 2. Power Button:

Single press+long press:

Turn on the light

Long press: Turn off the light

Double press: Lock/unlock the buttons and dials

Triple press: Reset Bluetooth

### 3. ADJUST Dial:

Turn: Adjust parameters.

Single press: Quickly adjust parameters.

Confirm (when in submenu)

### 4. SELECT Dial:

Turn: Switch options. (when in submenu)

## Operation Instruction

### 1. CCT Mode Settings

Single press MODE button to switch to CCT mode. Turn the SELECT dial to switch to brightness/color temperature/Green-Magenta options. Single press or turn the ADJUST dial to adjust the chosen value.

Brightness adjustment range: 0-100%

Color temperature adjustment range: 2700K-6500K;

G/M adjustment range: -10-10;

CCT 	
BRT:	100°
CCT:	5500K
G/M:	-2

### 2. HSI Mode Settings

Single press MODE dial to switch to HSI mode. Turn the SELECT dial to switch to hue/saturation/intensity options. Single press or turn the ADJUST dial to adjust the value.

Hue adjustment range: 0-100%

Saturation adjustment range: 0° -360°

Intensity adjustment range: 0-100%

HSI 	
DIM:	100%
HUE:	120°
SAT:	100%

### 3. RGB Mode Settings

Single press MODE button to switch to RGB mode. Turn the SELECT dial to switch to RGB options. Single press or turn the ADJUST dial to adjust the value.

RGB adjustment range: 0-100%

Brightness adjustment range: 0-100%

RGB		
R:	100%	
G:	30%	
B:	50%	▼

### 4. FX Pixel Mode Settings

Single press MODE button to switch to FX Pixel mode. Turn the SELECT dial to switch to FX/brightness/speed options. Single press/turn the ADJUST dial to adjust the chosen value.

**Effect Types:** Color Fade, Color Chase, Mono Move, Bi-Color Move, Tricolor Move, Rainbow Move

FX Pixel		
FX:	COLOR FADE	
DIM:	100%	
SPD:	5	▼

 The adjustable parameters vary under different light effects and the operation steps are similar. The “color fade” effect is used as an example to demonstrate the operation steps above.

## 5. FX Mode Settings

Single press MODE button to switch to FX mode. Turn the SELECT dial to switch to FX/brightness/speed/color temperature options. Single press/turn the Adjust dial to adjust the chosen value.

**Effect Types:** SOS, Paparazzi, Candle, Bad Bulb, TV, Lightning, CCT Pulse, CCT Loop, CCT Flash, HUE Loop, HUE Pulse, HUE Flash, Police Car, Disco, Fireworks

FX		
FX:	SOS	
DIM:	100%	
SPD:	5	▼

 The parameter values in a single light effect are only effective for that light effect.

## 6. Music Mode Settings

Single press MODE button to switch to Music mode. Turn the SELECT dial to switch to brightness/number of colors/color options. Single press/turn the ADJUST dial to adjust the chosen value.

Brightness adjustment range: 0-100%

Number of colors: 1-7

Color adjustment range: 0° -360°

Music		
DIM:	100%	
CLN:	2	
CL1:	120°	▼

## 7. Menu Settings

Single press MODE button to switch to menu interface. Turn the SELECT dial to switch to language/Bluetooth reset options. Turn the ADJUST dial to adjust the chosen value and press the ADJUST dial once to confirm.

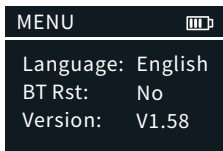

 Under the "MENU" option, you can also check the firmware version information for the ZHIYUN CINEPEER C100.

You can use “Zhiyun Led Tools” or “ZY Vega” to perform the ZHIYUN CINEPEER C100 firmware upgrade.

Method 1:

1. Visit the official website of ZHIYUN ([www.zhiyun-tech.com](http://www.zhiyun-tech.com)), go to the ZHIYUN CINEPEER C100 product page, click "Download", find the Zhiyun Led Tools and the firmware and download.
2. Unzip the firmware for the files with the ".ptz" file extension.
3. Connect the Type-C firmware upgrade port of ZHIYUN CINEPEER C100 to the USB port of the computer with the USB Type-C cable.
4. Open "Zhiyun Led Tools", click "Open", and click "Firmware Upgrade". Click "Browse" under "Path" to select the latest firmware downloaded (with the ".ptz" file extension), and click "Upgrade" at the bottom to upgrade firmware. ZHIYUN CINEPEER C100 will automatically turn off when the upgrade is finished.

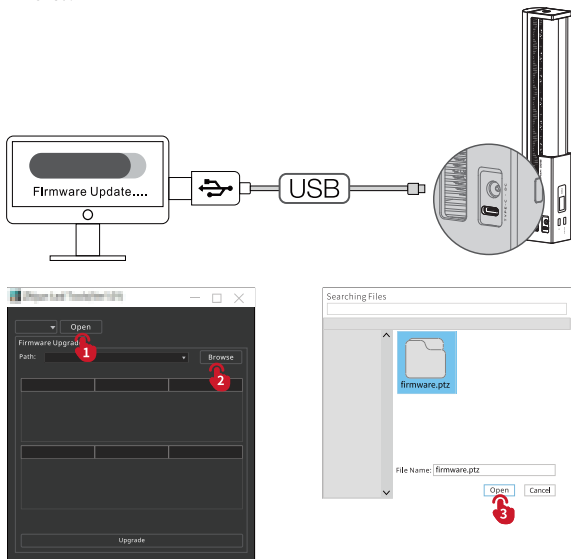

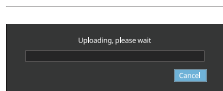
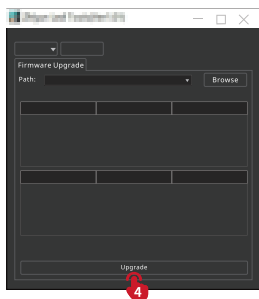

## Method 2:

The firmware of the ZHIYUN CINEPEER C100 can be upgraded using the "ZY Vega" app. For more detailed instructions, please visit the ZHIYUN official website at [www.zhiyun-tech.com](http://www.zhiyun-tech.com) and watch the related video tutorials for the ZHIYUN CINEPEER C100.

- ① When using Method 1 for the upgrade, please wait until the screen displays that the upgrade is finished, then you can plug out the USB Type-C cable.
- ② Before upgrading the firmware, please ensure that the ZHIYUN FIVERAY C100 has more than 50% power remaining. You cannot exit the app interface or access in the background during the upgrading process. Pay attention to the prompts on the app.

Product Model: PL113

<b>Battery Capacity</b>	6S/4500mAh	
<b>Max Power</b>	100W	
<b>Color Temperature Range</b>	2700K-6500K	
<b>Dimming Range</b>	0-100%	
<b>RGB Range</b>	0° -360°	
<b>CRI/TLCI</b>	CRI $\geq$ 95 TLCI $\geq$ 98	
<b>LED Chip</b>	208pcs cool&warm +96pcs RGB	
<b>Illuminance (Max power, without modifier)</b>	3870(lux)	Lab Data 1
<b>Charging Time (PD fast charging)</b>	3H 53min	Lab Data 2
<b>Charging Time (DC)</b>	3H 22min	Lab Data 3
<b>R Illuminance</b>	815(lux)	Lab Data 4
<b>G Illuminance</b>	1750(lux)	
<b>B Illuminance</b>	564(lux)	
<b>Runtime (Max power)</b>	54min	Lab Data 5
<b>Operation Temperature</b>	-10°C -40°C	
<b>Product Size</b>	361*58.7*72.5mm	
<b>Product Net Weight</b>	1337g	
<b>Power Adapter Rated Output (V/A)</b>	24V/5A	



Lab Data 1: The data was tested under the following conditions: 25°C temperature, indoor illuminance lower than 0.1lux, test distance 1m, and the color temperature is set at 4300K with 100% brightness. The illuminance is 3870 lux. The actual illuminance varies under different conditions.

Lab Data 2: This data was tested under the condition of an ambient temperature of 25° C, using a 25W PD fast charger. The charging time is 3H 53min. The actual charging time may vary due to different environmental conditions. The lower the charging environment temperature, the smaller the charging current, and the longer the charging time will be extended.

Lab Data 3: This data was tested under the condition of an ambient temperature of 25° C, and the DC charging power is 28W. The charging time is 3H 22min. The actual charging time may vary due to different environmental conditions. The lower the charging environment temperature, the smaller the charging current, and the longer the charging time will be extended.

Lab Data 4: With 25°C temperature, indoor illuminance lower than 0.1lux, and 1m test distance, set the product at 100% saturation and 100% brightness, and the red/green/blue illuminance is 815(lux)/1750(lux)/564(lux). The actual red/green/blue illuminance varies under different conditions.

Lab Data 5: This data was tested under the condition of an ambient temperature of 25° C, with the fill light fully charged, in CCT mode, with a color temperature of 4300k, and a brightness of 100%. The continuous working time is 54 minutes. The actual continuous working time may vary due to different usage times of the fill light, the number of battery charge and discharge cycles, and battery activity. The longer the fill light is used, the more battery charge and discharge cycles, the lower the battery activity, and the continuous use time will be shortened accordingly.

The above data is gathered from internal experiments of ZHIYUN laboratories. Under different scenarios, data is different to some extent. Please refer to the actual use.

Thank you for purchasing this product. The information contains herein affects your safety, legitimate rights and obligation. Please read this instruction carefully to ensure proper configuration before use. Failure to read and follow this instruction and warnings herein may result in serious injury to you or bystanders, or damage to your device or property. Guilin Zhishen Information Technology Co., Ltd (hereinafter referred to as "ZHIYUN") reserves all rights for final explanation of this instruction and other documents related to this product. The information is subject to update without notice. Please visit [www.zhiyun-tech.com](http://www.zhiyun-tech.com) to obtain the latest product information.

By using this product, you hereby signify that you have read this document carefully and that you understand and agree to abide by the terms and conditions herein. You agree that you are solely responsible for your own conduct while using this product, and for any consequences thereof. You agree to use this product only for purposes that are proper and in accordance with all terms, precautions, practices, policies and guidelines ZHIYUN has made and may make available.

ZHIYUN accepts no liability for damage, injury or any legal responsibility incurred directly or indirectly from the use of this product. Users shall observe safe and lawful practices including, but not limited to, those set forth herein.

ZHIYUN™ is the trademark of Guilin Zhishen Information Technology Co., Ltd and its affiliates. All product names or trademarks referred to herein are trademarks or registered trademarks of their respective holders.

### Reading Tips

Legends:  Hints and Tips  Important

### Safe Operation Instructions

Read the ENTIRE User Guide to become familiar with the features of this product before operating. Failure to operate the product correctly can result in damage to the product or personal property and cause serious injury. This is a sophisticated product. It must be operated with caution and common sense and requires some basic mechanical ability. Failure to operate this product in a safe and responsible manner could result in injury or damage to the product or other property. This product is not intended for use by children without direct adult supervision. DO NOT use with incompatible components or in any way otherwise as mentioned or instructed in the product documents provided by ZHIYUN. The safety guidelines herein contain instructions for safety, operation and maintenance. It is essential to read and follow all of the instructions and warnings in the User Guide, prior to assembly, setup or use, in order to operate the product correctly and avoid damage or serious injury.

### Warranty Period

1. Customers are entitled to replacement or free repair service in case of quality deficits found in the product within 15 days upon receipt of the product.
2. Customers are entitled to free repair service from ZHIYUN for any product proven defective in material or workmanship that results in product failure during normal consumer usage and conditions within the valid warranty period, which is 12 months counting from the date of selling. However, warranty period varies by product component and country of purchase. Please contact our after-sales service team on ZHIYUN official website or your place of purchase for detailed warranty information.

### Warranty Exclusions

1. Products subjected to unauthorized repair, misuse, collision, neglect, mishandling, soaking, accident, and unauthorized alteration.
2. Products subjected to improper use or whose labels or security tags have been torn off or altered.
3. Products whose warranty has expired.
4. Products damaged due to force majeure, such as fire, flood, lightning, etc.

### Warranty Claim Procedure

1. If failure or any problem occurs to your product after purchase, please contact a local agent for assistance, or you can always contact ZHIYUN's customer service through email at [info@zhiyun-tech.com](mailto:info@zhiyun-tech.com) or website at [www.zhiyun-tech.com](http://www.zhiyun-tech.com).
2. Your local agent or ZHIYUN's customer service will guide you through the whole service procedure regarding any product issue or problem you have encountered. ZHIYUN reserves the right to reexamine damaged or returned products.

**Customer Information**

Customer Name:

Phone Number:

Address:

**Sales Information**

Sales date:

Product Serial Number:

Distributor Name:

Distributor's Contact Number:

**First Maintenance Record**

Service Date:

Repairman Signature:

Cause of Problem:

Service Result:

☐ Solved☐ Unsolved☐ Refunded/Replaced



Website



Weibo



Vimeo



Google+



Facebook  
(Zhiyun Support)



Facebook  
(Zhiyun Tech)



Youku



Youtube



Wechat



Instagram

Tel: +86 400 900 6868

USA Hotline: +1 808-319-6137, 9:00-18:00 GMT-7, Mon-Fri

Europe Hotline: +49 (0) 61018132180, 10:00-17:00 GMT+1, Mon-Fri

Web: [www.zhiyun-tech.com](http://www.zhiyun-tech.com)

E-mail: [info@zhiyun-tech.com](mailto:info@zhiyun-tech.com)

Address: 09 Huangtong Road, Tieshan Industrial Zone, Qixing District, Guilin, 541004, Guangxi, China

## Certificate of Quality

This product is confirmed to meet quality standards and permitted for sale after strict inspection.

QC Inspector: \_\_\_\_\_



For full product information, please visit ZHIYUN's official website: Content on [www.zhiyun-tech.com](http://www.zhiyun-tech.com) is subject to update without notice.

ZHIYUN™ is a trademark of ZHISHEN

All product names or brands referred to hereunder may be trademarks or registered trademarks of their respective holders.

Copyright © 2024 ZHISHEN. All rights reserved.

This device complies with part 15 of the FCC Rules. Operation is subject to the following two conditions: (1) This device may not cause harmful interference, and (2) this device must accept any interference received, including interference that may cause undesired operation. Any Changes or modifications not expressly approved by the party responsible for compliance could void the user's authority to operate the equipment.

Note: This equipment has been tested and found to comply with the limits for a Class B digital device, pursuant to part 15 of the FCC Rules. These limits are designed to provide reasonable protection against harmful interference in a residential installation. This equipment generates uses and can radiate radio frequency energy and, if not installed and used in accordance with the instructions, may cause harmful interference to radio communications. However, there is no guarantee that interference will not occur in a particular installation. If this equipment does cause harmful interference to radio or television reception, which can be determined by turning the equipment off and on, the user is encouraged to try to correct the interference by one or more of the following measures:

- Reorient or relocate the receiving antenna.
- Increase the separation between the equipment and receiver.
- Connect the equipment into an outlet on a circuit different from that to which the receiver is connected.
- Consult the dealer or an experienced radio/TV technician for help

-  
-

FCC Radiation Exposure Statement:

This equipment complies with FCC radiation exposure limits set forth for an uncontrolled environment. This equipment should be installed and operated with minimum distance 20cm between the radiator & your body.

ZHIYUN-TECH.COM