

Tire Pressure Monitoring System | Mata 1 & Mata 1E



Product Manual

Welcome

Thank you for purchasing Promata TPMS! Promata TPMS is an innovative safety accessory which provides drivers with information for tire pressure and tire temperature. The product warns the user of leakage, high/low tire pressure, low sensor battery, high tire temperature while driving. Promata TPMS also helps drivers maintain sufficient levels of tire pressure for safer driving and reducing tire wear.

▲ For Your Safety

Before using the product, please read and follow the manual instructions carefully.

1. This product must be correctly installed before use. Avoid damaging the sensor and the wheel when installing. Internal sensors should be installed according to manual instructions by a professional auto-technician.
2. This product is a safety accessory and cannot prevent puncture or tire leakage. Please react promptly to the product warning signals and resolve abnormal tire conditions before getting back on the road.
3. The user is responsible for safe driving, taking care of their vehicle, and ensuring the correct installation and use of the product. Sinotek assumes no liability for damages and losses.
4. When placed on the dashboard under strong sunlight, the display may heat up quickly. Be careful when handling the display.

5. All sensors are already paired to the display in the factory. Users DO NOT need to pair the sensors to use this product for the first time.

If trailer sensors are detected, the display switches between car view and trailer view. Spare tire pressure can be checked by pressing **⏏** twice.

Quick check: press **⏏** to switch from 4-wheel view → trailer view → spare tire view.

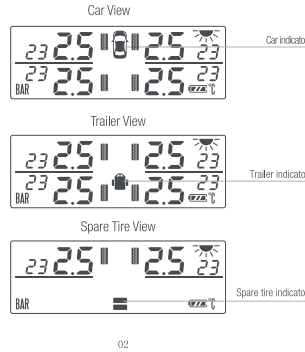

02

Charging the Display

Charge the display via solar power or 5V micro USB. When charging via solar power, the solar charging indicator will light up.

For first-time use, please charge the display via micro USB for 3 hours.

Display ON/OFF

To turn on the display: hold **⏏** button for 3 seconds.

To turn off the display: hold **⏏** button for 3 seconds.

Automatic sleep: After 4 minutes without detecting vehicle vibration, the display will sleep automatically.

Automatic wake-up: The display will wake up automatically when it detects vibration.

05

4. Press **⏏** or **⏏** to choose the desired low pressure alarm threshold.

5. Short press **⏏** move onto the next set of axial wheels (e.g. car rear axial wheels).

Follow the same instructions to set the high/low pressure alarm threshold for car rear axial wheels, trailer front axial wheels, and trailer rear axial wheels.

Note: There are no specific high/low pressure settings for spare tires.

Spare tire 1 follows the trailer front axial wheels set.

Spare tire 2 follows the trailer rear axial wheels set.

Spare tire alarm will beep 15 times for high/low tire pressure and then fall silent.

Factory Settings

HI: 3.0 BAR / 43 PSI

LO: 2.0 BAR / 29 PSI

High Temperature Alarm

1. Enter Settings Mode and rotate to High Temperature Alarm Setting.

2. Press **⏏** or **⏏** to choose the desired high temperature alarm threshold.

3. Move onto other settings by short pressing **⏏**, or exit Settings Mode.

Factory Setting: 80°C/176°F

08

TPMS Warning Signals

When the unit detects abnormal tire conditions or low sensor battery, it will emit audio beeps and visual warning. Press any button to temporarily silence the alarm.

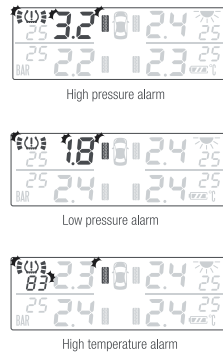

03

3 Function Settings

Settings Mode

- 1) Enter Settings Mode: Hold **⏏** button till you hear a 'beep' sound, then short press **⏏** button to rotate through the functions, press **⏏** or **⏏** to make a choice.
- 2) Exit Settings Mode: Hold **⏏** button till you hear two 'beep' sounds.

Functions Rotation

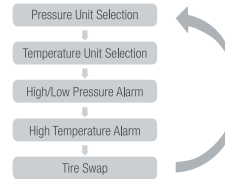

Pressure Unit Selection

1. Enter Settings Mode, "BAR" or "PSI" will flash.
2. Press **⏏** or **⏏** to choose between BAR or PSI.
3. Move onto other settings by short pressing **⏏**, or exit Settings Mode.

06

Tire Swap Function

The below example performs tire swap on the front right wheel and the rear right wheel of the vehicle:

1) Original Tire Pressure.



2) Enter Settings Mode, rotate to Tire Swap. "C1" and " " will flash.

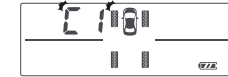

3) Press **⏏** button once to select the first wheel (e.g. front right wheel) for Tire Swap. "C1" and the selected wheel " " will flash.

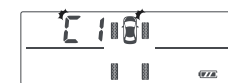

09

1 Package Contents

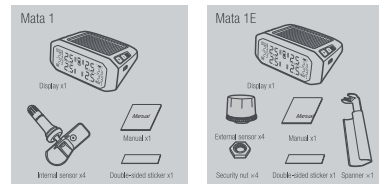

2 Display

A Brief Look

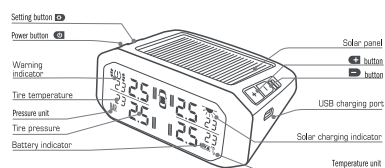

01

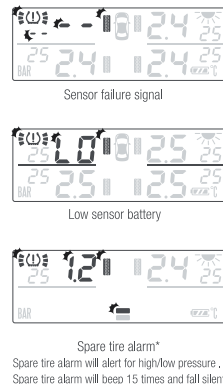

04

Temperature Unit Selection

1. Enter Settings Mode and rotate to Temperature Unit Selection, "°C" or "°F" will flash.
2. Press **⏏** or **⏏** to choose between °C or °F.
3. Move onto other settings by short pressing **⏏**, or exit Settings Mode.

High and Low Pressure Alarm

Users are able to customise 4 sets of high/low pressure alarms, including: car front axial wheels [H/L], car rear axial wheels [H/L], trailer front axial wheels [H/L], and trailer rear axial wheels [H/L].

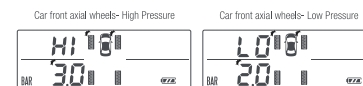

1. Enter Settings Mode and rotate to High Pressure Alarm settings [H] for the car front axial wheels.
2. Press **⏏** or **⏏** to choose the desired high pressure alarm threshold.
3. Short press **⏏** to go to Low Pressure Alarm settings [L] for the car front axial wheels.

07

4) Press **⏏** once "C2" and " " will flash.

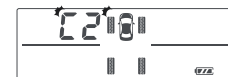

5) Press **⏏** button to select the second wheel (e.g. rear right wheel) for Tire Swap. "C2" and the selected wheel " " will flash.

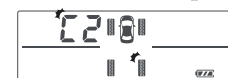

6) Press **⏏** once, Tire Swap is done, BAR or PSI will start flashing on the screen. Then, hold **⏏** till you hear two beeps to exit Settings Mode.



10

4 Installation

Sensor Installation Internal Sensor Installation- Mata 1

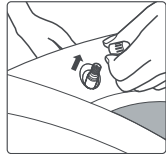

i. Remove the original tire valve

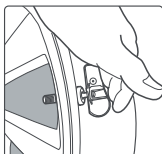

ii. Install the internal sensor

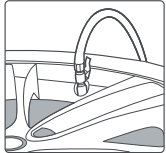

iii. Inflate the tire

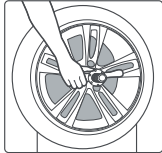

iv. Perform a dynamic wheel balance

⚠ Warning: Do not damage the sensor valve.

11

Display Installation

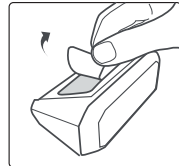

i. Mount the display on the dashboard using double-sided sticker.

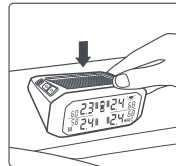

ii. Place the display on the dashboard in the right place.

⚠ Safety Notice

- For first-time use, please charge the display for 3 hours via micro USB.
- DO NOT mount the display on top of the airbag compartment.
- Some products such as DVRs may cause electronic interference. The display should be mounted away from such products.

14

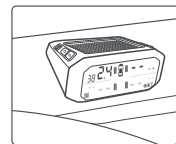

v. Press **+** or **-** to select the next tire position to pair the other sensors.

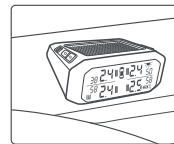

vi. Hold **▶** button to exit sensor programming mode with two 'beep' sounds.

6 Product Specifications

Display

Frequency	Operating temperature	Storage temperature
433.92MHz ±50KHz	-20~+70°C / +4~158 °F	-40~+85°C / +40~185 °F

Factory Default Settings

Default high pressure alarm	3.0 BAR/ 43 PSI
Default low pressure alarm	2.0 BAR/ 29 PSI
Default high temperature value	80°C/ 176°F

Note: Hold **▶** **+** **-** **▶** buttons for 3 seconds to restore factory default settings.

17

Q What to do if I want to upgrade to 10 tires?

A Please purchase extra sensors from authorised store and follow the sensor pairing instructions in this manual to pair the extra sensors to the display.

Q What to do if I've lost a sensor?

A Purchase a new sensor and pair it to the display.

Q What happens if I separate my trailer and my 4-wheel vehicle? Will the display alarm and report sensor failure?

A If the display fails to receive all of the pre-paired tyre signals from the trailer at the same time, it will pause the status of trailer data. The display will not alarm.

Q Where do I find help?

A The first point of contact is your direct seller. For more help, visit our website www.promata.cn.

Q If one of my TPMS sensors becomes lost or damaged, can I just buy a new sensor and pair it to my existing TPMS display?

A Yes, our sensors are interchangeable! An individually purchased sensor needs to be paired to your existing display to work. For sensor pairing instructions, please refer to page 16 to pair this particular sensor.

20

External Sensor Installation - Mata 1E

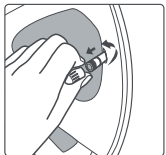

i. Unscrew the valve cap

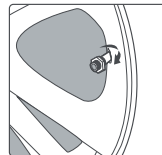

ii. Thread the security nut through

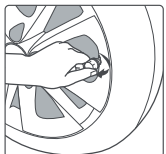

iii. Screw on the sensor

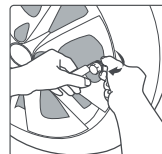

iv. Tighten the nut using the spanner

12

Functional Test after Installation

Users must perform a functional test after installation.



i. Please drive the vehicle over 30km/h (19mph) for a few minutes.

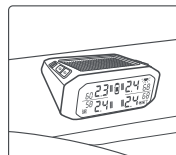

ii. The display should update real-time data automatically. When all tire data is displayed, the installation is a success.

15

User selectable range for alarms

High pressure	Low pressure	High temperature
0.8 BAR ~ 14 BAR / 12 ~ 99 PSI	0.5 BAR ~ 9.9 BAR / 7 ~ 65 PSI	70 ~ 90 °C / 158 ~ 194 °F

Note: *Low pressure threshold cannot be set higher than high pressure threshold.
*When the pressure is more than 9.9BAR, the display can only show data without decimals.
*If the pressure is in PSI, the biggest number is 99PSI which can be shown on the display.

Sensor

	Internal sensor specifications	External sensor specifications
Weight	14g ± 1g	8g ± 1g
Operating frequency	433.92MHz ±50KHz	433.92MHz ±50KHz
Pressure monitoring range	0 ~ 7 BAR/ 0 ~ 99 PSI	0 ~ 6 BAR/ 0 ~ 87 PSI
Pressure accuracy	± 0.1 BAR/ ± 1.5 PSI	± 0.1 BAR/ ± 1.5 PSI
Battery life	6 years	2 years

18

Q After continuous exposure to direct sunlight, the LCD display becomes too dark to see. What should I do?

A Please place the display in the shade. Its screen will brighten up when the temperature falls below 70°C. The LCD becomes dark when the temperature is more than 70°C, this is normal and is not a problem, the LCD display will monitor the sensors even the temperature is more than 70°C.

Q The display warns me of low sensor battery, but it stops after a while. Why is that so?

A There are two cases that the system "think" the sensor battery is low:
1. The sensor battery is low.
2. The temperature is less than -40 °C, the battery can not output normal power, while the battery is good.
In case 1, the user needs to change the battery ASAP.
In case 2, the user does not need to change the battery. So, the display alerts you once and then stops.

Q If I disconnect and reconnect my trailer to my car, do I need to pair the trailer sensors to the display each time?

A No need, When the trailer sensors are close by, the system will be able to automatically detect these sensors and receive tire data.

20

Sensor Battery Changing

Battery replacement is only for external sensors. When the external sensor battery is low, please replace the battery CR1632 for TPMS by following the instructions below:

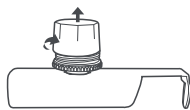

i. Unscrew the sensor cover



ii. Remove the old battery

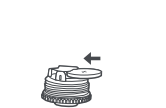

iii. Replace with new CR1632 battery (the + side faces upwards)

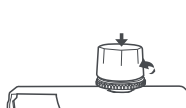

iv. Screw on the sensor cover

Note: Low quality battery may cause poor sensor signals.

13

5 Sensor Pairing

⚠ **WARNING: NO NEED to perform sensor pairing for a new unit!**

Sensor pairing is used to pair a new sensor or a missing sensor to the display. All units come with sensors already paired to the display in the factory.

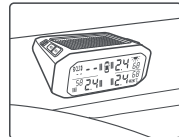

i. Press **▶** button 5 times to enter Sensor Pairing Mode with a "beep" sound.

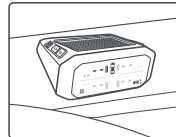

ii. Press **+** or **-** button to select the desired tire position.

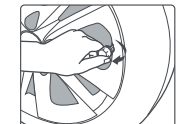

iii. External sensors: screw on the new sensor to the corresponding tire until data shows up on the display with a "beep" sound.
Internal sensors: with sensors installed, inflate or deflate the corresponding tire until data shows up on the display with a "beep". If there is no "beep" sound, please repeat the action.

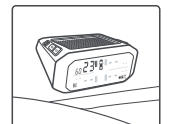

iv. Short press **▶** button once to save the pairing.

16

7 Q & A

Q The display is missing data, what should I do?

A 1. Ensure that all the sensors are present;
2. Ensure there is no electronic interference around (e.g. turn off DVRs);
3. Drive the vehicle over 30 km/h for 5 minutes;
4. Change sensor battery;
5. If data is still missing, commence sensor pairing.

Q Do I need to perform a dynamic wheel balancing?

A After installing internal sensors, dynamic wheel balancing is a must. Dynamic balancing is not required for external sensors.

Q How to silence the display alarm?

A You can press any button to temporarily silence the display, or turn off the display.

Q The display is constantly alarming for low pressure, how to keep it quiet?

A 1. Change the low pressure alarm threshold.
2. Switch off the display by holding the **▶** button.

19

Promata
Automotive

All rights reserved,
Snook Co., Ltd. reserves the rights
to change designs and specifications
for improving the products without
prior notice. Mata1Y8130

www.promata.cn

Federal Communications Commission (FCC) Interference Statement

This equipment has been tested and found to comply with the limits for a Class B digital device, pursuant to Part 15 of the FCC Rules.

These limits are designed to provide reasonable protection against harmful interference in a residential installation. This equipment generate, uses and can radiate radio frequency energy and, if not installed and used in accordance with the instructions, may cause harmful interference to radio communications.

However, there is no guarantee that interference will not occur in a particular installation. If this equipment does cause harmful interference to radio or television reception, which can be determined by turning the equipment off and on, the user is encouraged to try to correct the interference by one of the following measures:

- Reorient or relocate the receiving antenna.
- Increase the separation between the equipment and receiver.
- Connect the equipment into an outlet on a circuit different from that to which the receiver is connected.
- Consult the dealer or an experienced radio/TV technician for help.

This device complies with Part 15 of the FCC Rules. Operation is subject to the following two conditions:

(1) This device may not cause harmful interference, and (2) this device must accept any interference received, including interference that may cause undesired operation.

FCC Caution: Any changes or modifications not expressly approved by the party responsible for compliance could void the user's authority to operate this equipment.

RF exposure warning

This equipment complies with FCC radiation exposure limits set forth for an uncontrolled environment.