

黑白印刷

装订翻页 (按照页码排版)

封面: 0.2MM (157G双铜)

内页: 0.07MM (105G双铜)

88.00 mm

130.00 mm

CREATE A  
BETTER PRIVATE  
CINEMA FOR YOU

#### Opening Remarks

Thank you very much for your support!  
You can learn to use and operate on this projector by reading this manual.  
This projector has powerfully features like compact, convenient etc. It is specifically designed for home, entertainment, business and other occasions.  
The projector let you enjoy the fun of the big screen really anytime and anywhere, and you are also welcome to share your fun and opinions with us.  
If you have any questions about this product, please contact our after-sales department. We are happy to service for you.

#### CATALOGUE

Cautions And Warnings	01-02
List Of Items	03-04
The Remote Control	05-06
Product Details	07-08
Installation And Debugging	09-11
Install The Equipment	12-14
The Software Settings	15-16
Media Player	17-18
Same screen	19-20
Clean And Maintain	21-22
Warranty Card	23-24

#### CAUTIONS AND WARNINGS

- For best effects, it is recommended that you use this product in a dark room.
- Do not install the machine where directly blow by the air conditioner. The water combined or high temperature may cause machine failure.
  - Make sure that there is no dust venting and the ventilation is not blocked. The dust will be blown into the lens.
  - Prevent glass or paper falling into the machine, and do not eat and drink near the machine. It is recommended to keep the lens clean.
  - Do not exceed the use of image, or not place any liquid on the machine.
  - When connecting the projector, please use soft padding to protect the projector during transportation. Please avoid the lens protection cover, not use touch with you hand.
  - During or after the projector, any nearby fire material will become fire source.
  - Do not touch the lens when the machine is powered on, it may cause lens damage to you eyes.

#### NOTICE

Do not open the case. Please entrust qualified professional maintenance personnel for repair and maintenance.

This mark warns there is an anticipated voltage in this unit, which may cause electric shock and fire unless properly used. It is extremely dangerous to touch any parts inside the machine.

Do not touch the lens when the machine is powered on, it may cause lens damage to you eyes.

01

#### INTELLIGENT PROJECTOR

MADE IN CHINA

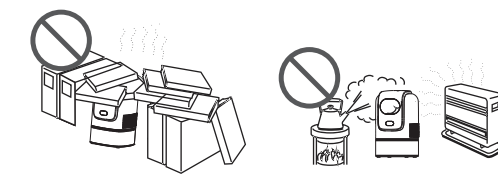

Do not install in poorly ventilated places.

Do not install in hot or humid places.

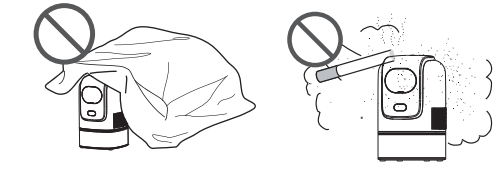

Do not block the ventilation holes.

Do not install in dusty or smoky places.

02

#### LIST OF ITEMS

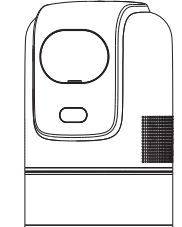

Projector

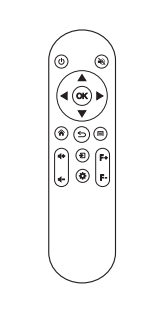

Remote Controller

Thank you very much for purchasing our products.  
Please check whether the physical products received are complete.  
If the products and accessories you receive are not complete, please contact the sales personnel in a timely manner.  
(For specific items, please refer to the actual package.)

03

#### INTELLIGENT PROJECTOR

MADE IN CHINA

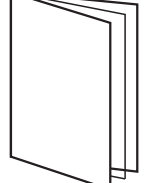

User Manual

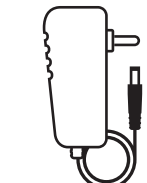

Power Cord

Please use the original power adapter.  
Using a non-original adapter may cause faults such as short circuit of the heat dissipation, lens burning, and so on.

#### THE REMOTE CONTROL

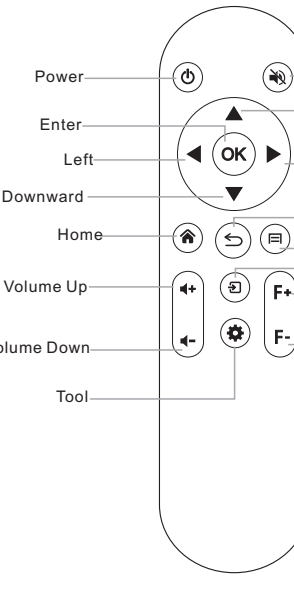

04

#### INTELLIGENT PROJECTOR

MADE IN CHINA

#### Remote Control Description

- Power: To turn on/off the unit.
- Mute: To mute or unmute the projector speaker.
- Menu: To open the menu of applications or files.
- Volume: To increase/decrease the volume.
- Enter: Choose Click.
- Directional Keys: Use the up or down buttons to select OSD items, use the left and right buttons to make adjustments.
- Return: Back to previous menu or close the active window.
- Home Back to homepage.
- Signal source switching: Switching signals or opening/removable disks.
- Before focal length: Adjust the lens focus forward.
- After focal length: Adjust the lens focus backward.
- Tool: Open product settings function.

#### PRODUCT DETAILS

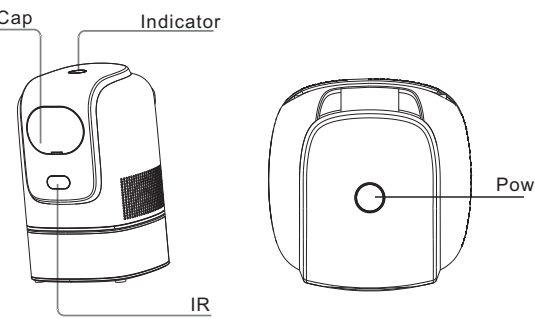

06

#### INTELLIGENT PROJECTOR

MADE IN CHINA

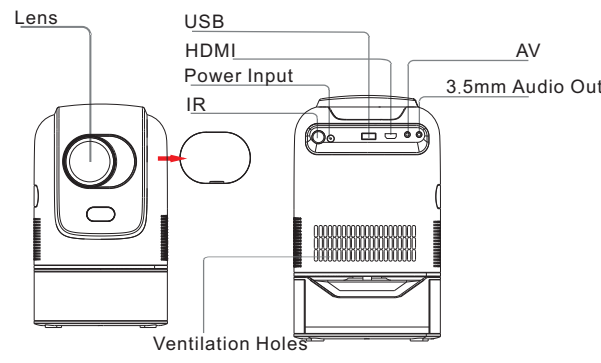

\*Do not place objects within 20cm of the heat dissipation hole.

08

#### INSTALLATION AND DEBUGGING

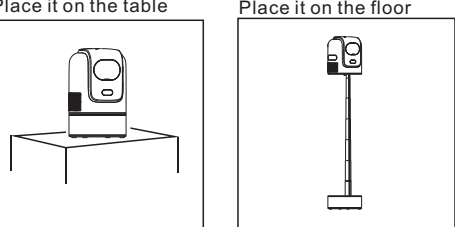

Place it on the table.

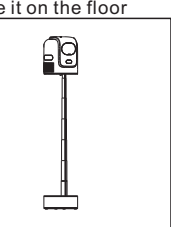

Place it on the floor.

Install on the ceiling.



09

#### INTELLIGENT PROJECTOR

MADE IN CHINA

Focus: When the projection image is blurry (as shown in the right figure), adjust the focus adjustment button on the remote control to move forward or backward to achieve satisfactory imaging results. If satisfactory clarity cannot be achieved through adjustment, please move the machine back and forth appropriately.

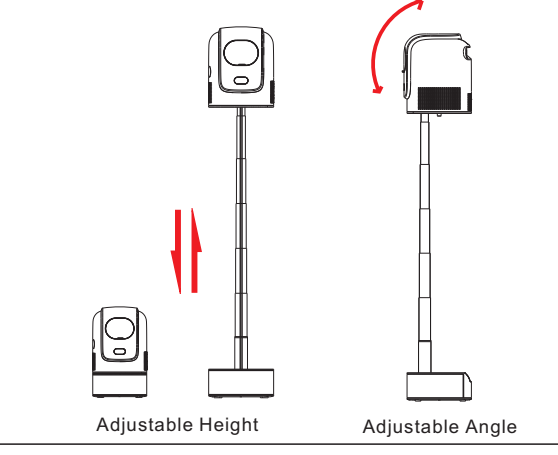

#### INSTALLATION AND DEBUGGING

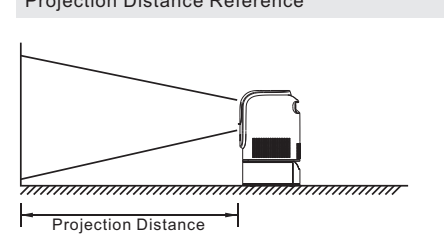

Projection Size (inch)	Projection Distance (m)
55"	1.5 M
65"	2.0 M
80"	2.5 M
95"	3.0 M
105"	3.5 M

How To Power Off  
1. Press the ON/OFF button on the remote control or the power switch on the unit.  
2. Put the lens cap on and store the unit in a dry and cool place.

10

#### INSTALL THE EQUIPMENT

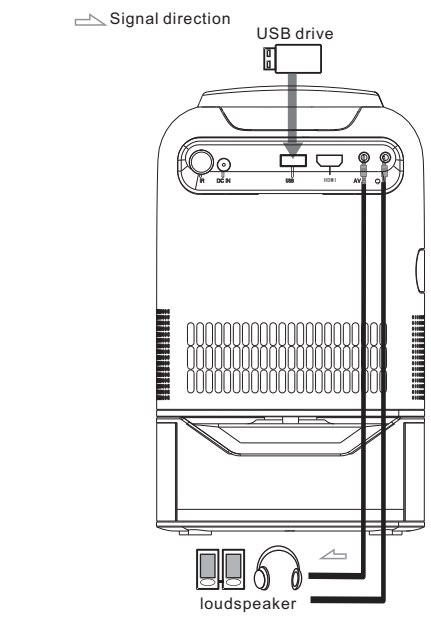

12

#### THE SOFTWARE SETTINGS

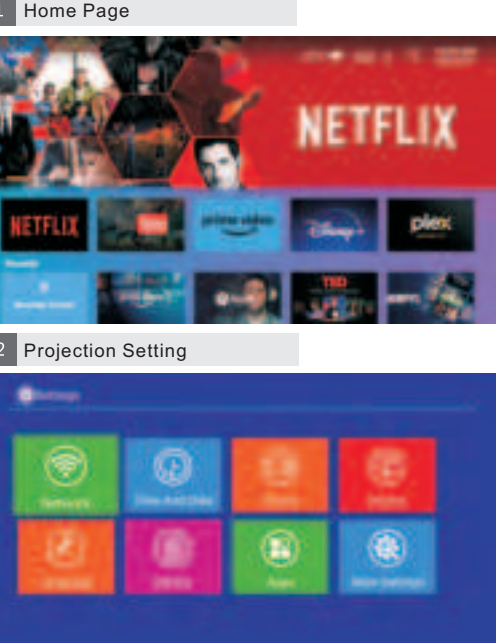

Notes: With the update of system version, there will be differences from the actual interface. Please refer to the displayed interfaces as final.

13

#### INTELLIGENT PROJECTOR

MADE IN CHINA

Wi-Fi Setting  
Select a network and enter a password to connect.



Bluetooth Settings  
Open Bluetooth and select pairing successfully.

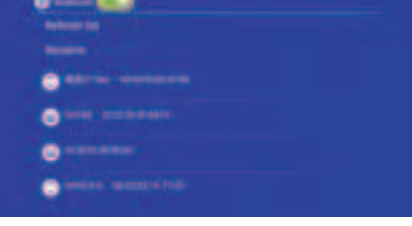

14

#### MEDIA PLAYER

You can play videos, music, or pictures from a storage device in the following ways.

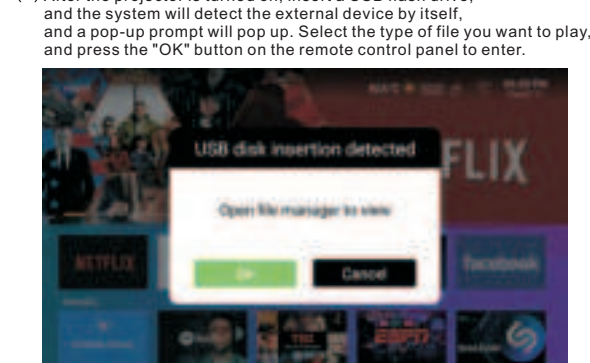

USB disk insertion detected  
Open the folder to view.

Press the signal input button on the remote control and select USB device to turn it on.

15

#### SAME SCREEN

Connect the projector and phone to the same network, then open the HAPPYCast application and follow the prompts.

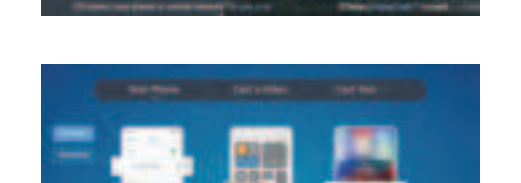

#### CLEAN AND MAINTAIN

Before cleaning, you must make sure that you have unplugged the power plug.

Do not use insecticides or other volatile chemicals on the projector or lens. Do not use rubber or vinyl products to touch the projector. This can damage or cause coating peel off.

1. Clean the Projector  
Wipe with a soft dry cotton cloth. Use a soft cloth dipped in a diluted neutral detergent to wipe it, then with a dry cloth. If you use chemical fiber cloth, please follow the precautions.

2. Dust cleaning of lens  
Use the same method to clean the camera lens. Use the professional hair dryer for the camera on the cleaning paper for the glass's lens. Be careful not to scratch the lens.

3. Dust cleaning at suction and outlet  
The dust in the air inlet and outlet prevents ventilation, which will increase the internal temperature and cause malfunctions. Cleaning guidelines: at least clean once use every 10,000 hours.

Turn off the projector, disconnect the power. Clean the exterior with an electric vacuum cleaner and install a brush head adapter on the vacuum cleaner. Please be careful not to use a vacuum cleaner without an adapter or brush head.

16

#### Product Warranty Description

The after-sales service of projector is strictly based on the "Consumer Rights Protection Law of the People's Republic of China" and "Product Quality Law of the People's Republic of China".

Within 12 months upon purchasing, faults that not caused by improper use of human factors shall be inspected by after-sales service center.

free maintenance service shall be provided for you with valid purchase proof if it's determined as defect that caused by product quality itself.

Non-Warranty Regulations:  
1. Accessories such as Remote Controller, User manual, Power cord are not warranted.

2. Damage caused by self-disassembly or unauthorized maintenance, modification etc.

3. Damage that caused by artificial damage.

4. Period of warranty validity has expired.

#### After-Sale Service Card

Customer Name: \_\_\_\_\_

Customer ID: \_\_\_\_\_

Customer Tel: \_\_\_\_\_

Customer Email: \_\_\_\_\_

Fault Description (Please describe in detail for quick maintenance): \_\_\_\_\_

\_\_\_\_\_

\_\_\_\_\_

\_\_\_\_\_

\_\_\_\_\_

18

#### FCC Statement

This equipment has been tested and found to comply with the limits for a Class B digital device, pursuant to part 15 of the FCC rules. These limits are designed to provide reasonable protection against harmful interference to a residential installation.

This equipment generates, uses and can radiate radio frequency energy and, if not installed and used in accordance with the instructions, may cause harmful interference to radio communications.

However, there is no guarantee that interference will not occur in a particular installation. If this equipment does cause harmful interference to radio or television reception, which can be determined by turning the equipment off and on, the user is encouraged to try to correct the interference by one or more of the following measures:

1. Reorient or relocate the receiving antenna.  
2. Increase the separation between the equipment and receiver.  
3. Connect the equipment to a circuit on a different line from to which the receiver is connected.  
4. Consult the dealer or an experienced radio/TV technician for help.

The equipment complies with Part 15 of the FCC Rules. Operation is subject to the following two conditions:  
(1) This device may not cause harmful interference, and  
(2) This device must accept any interference received, including interference that may cause undesired operation.

The equipment complies with FCC Radiation Exposure Limits set forth for uncontrolled environments. This equipment should be installed and operated with minimum distance 20cm between the radiator and your body.

INTELLIGENT PROJECTOR

19