

8.5cm

51cm

8.5cm

TWS Bluetooth Headphones

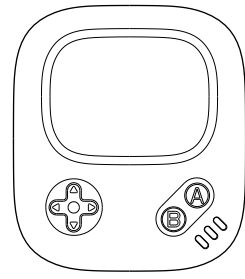

FCC ID: 2AEEF-207

Kindly read this guide before using your new wireless earbuds.
Make sure to keep this document for future reference.

We want the best possible experience for you!

Specifications

Item No.: MINISO-207

Bluetooth Version: V5.3

Speaker: $\Phi 13\text{mm}$ Dynamic driver, $32\Omega \pm 15\%$

Frequency Response: 20Hz-20KHz

Audio Output: 105 $\pm 3\text{db}$

Rechargeable Lithium Polymer Battery

Earbuds: 40mAh*2

Charging Case: 300mAh

Playtime: Earbuds 5.5 hours (60% volume)

Case 16.5 hours (Full Battery)

Input: DC-5V/250mA

Rapid Charge: 10 minutes charging = 2 hours playtime

Range: 30+ft

Protocols: HSP / HFP / A2DP / AVRCP

Codecs: AAC/SBC

Weight: 3.4g per earbud, 38.5g(earbuds+charging case)

IP Rating: IPX4 (earbuds only)

Includes: Disney Wireless Earbuds, Charging Case, Type-C Charging Cable

User Introduction

First Time Set Up: Bluetooth Pairing

Select "MINISO-207" in your device's Bluetooth setting to connect.

Voice prompt "Connected" indicates you are connected.

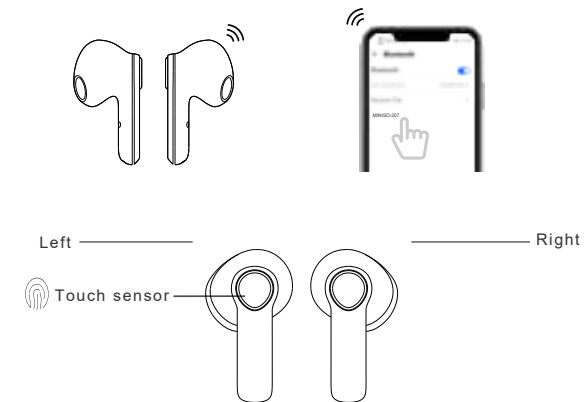

Easy Operation

Previous song: double tap left/right.

Next song: triple tap left/right.

Answer call: single tap left/right.

Reject incoming call/Hang up: press & hold left/right.

Play/Pause: single tap left/right.

Access Siri, Google Now...: press & hold left/right 3 seconds.

1. Take out earbuds.
2. Place the earbud in the ear canal and slightly rotate to adjust for best fit.

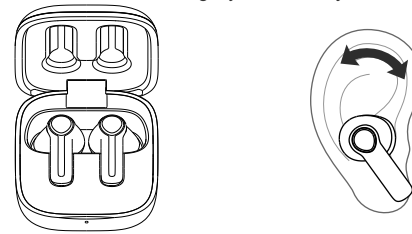

Charging Case LED Indicator

Battery capacity level

Blinking Blue: capacity 30% only or less.

Steady Blue: capacity 30% -100%.

Battery capacity level when case being charged

Blinking Red: capacity up to 30%-95%.

Steady Red: battery full.

It takes 90minutes to charge case's battery fully.

It takes 90minutes to charge earbuds' battery fully.

Earbud Working/charging Time (Battery Full)

Playing Time	5.5 hours (60% volume)
Standby Time	72 hours
Calling Time	4.5 hours
Charging Time	1.5 hours

Note: Earbuds can be full charged for 4 times by full battery case.

Trouble Shooting

No Sound In One Earbud/earbuds Disconnected From Each Other

1. Unpair or ignore "MINISO-207" in Bluetooth device settings.
2. Take both earbuds out of charging case, then keep distance 5cm or less between earbuds.
3. Quick double tap on any one of earbuds, then voice prompt "Dong" in both of them indicates earbuds connect each other successfully.

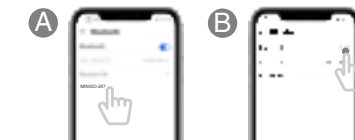

Connection Failure To Bluetooth Device

1. Unpair or ignore "MINISO-207" in Bluetooth device settings.
2. Lock then unlock Bluetooth.
3. Take both earbuds out of charging case while voice prompts "Dong" in both earbuds.
4. Re-select "MINISO-207" in Bluetooth setting.

FCC Warning

This device complies with part 15 of the FCC Rules. Operation is subject to the following two conditions: (1) This device may not cause harmful interference, and (2) this device must accept any interference received, including interference that may cause undesired operation.

Any Changes or modifications not expressly approved by the party responsible for compliance could void the user's authority to operate the equipment. This equipment has been tested and found to comply with the limits for a Class B digital device, pursuant to part 15 of the FCC Rules. These limits are designed to provide reasonable protection against harmful interference in a residential installation.

This equipment generates uses and can radiate radio frequency energy and, if not installed and used in accordance with the instructions, may cause harmful interference to radio communications. However, there is no guarantee that interference will not occur in a particular installation. If this equipment does cause harmful interference to radio or television reception, which can be determined by turning the equipment off and on, the user is encouraged to try to correct the interference by one or more of the following measures:

- Reorient or relocate the receiving antenna.
- Increase the separation between the equipment and receiver.
- Connect the equipment into an outlet on a circuit different from that to which the receiver is connected.
- Consult the dealer or an experienced radio/TV technician for help. The device has been evaluated to meet general RF exposure requirement. The device can be used in portable exposure condition without restriction.